

Byczek Enterprises
3924 W. Devon Avenue
Lincolnwood, IL 60659

Secured Party Name and address(es)
John L. Byczek
1009 Rolling Pass Road
Glenview, IL 60025

For Filing Officer (Date, Time, Number, and Filing Office)

0010494207

2753/0087 21 001 Page 1 of 2

2001-06-07 15:31



0010494207

3:31
3.50

This Statement refers to original Financing Statement No. 96224081
Date filed: March 25, 19 96 Filed with Cook County, Ill.

- A. CONTINUATION
The original financing statement between the foregoing Debtor and Secured Party, bearing the file number shown above, is still effective.
- B. PARTIAL RELEASE
From the collateral described in the financing statement bearing the file number shown above, the Secured Party releases the property indicated below.
- C. ASSIGNMENT
The Secured Party certifies that the Secured Party has assigned to the Assignee whose name and address is shown below, Secured Party's rights under the financing statement bearing the file number shown above in the property indicated below.
- D. TERMINATION
The Secured Party certifies that the Secured Party no longer claims a security interest under the financing statement bearing the file number shown above.
- E. AMENDMENT
The financing statement bearing the above file number, is amended:
 To show the Secured Party's new address as indicated below:
 To show the Debtor's new address as indicated below:
 As set forth below:

FAT C 9714943 JR

(Signature of Debtor, if required) _____ (Debtor) John L. Byczek _____ (Secured Party)

Dated: _____ 19 _____ By: X John L. Byczek _____ (Signature of Secured Party)

(1) Filing Officer Copy - Alphabetical

UNOFFICIAL COPY

RECORDED
INDEXED
MAY 10 1907

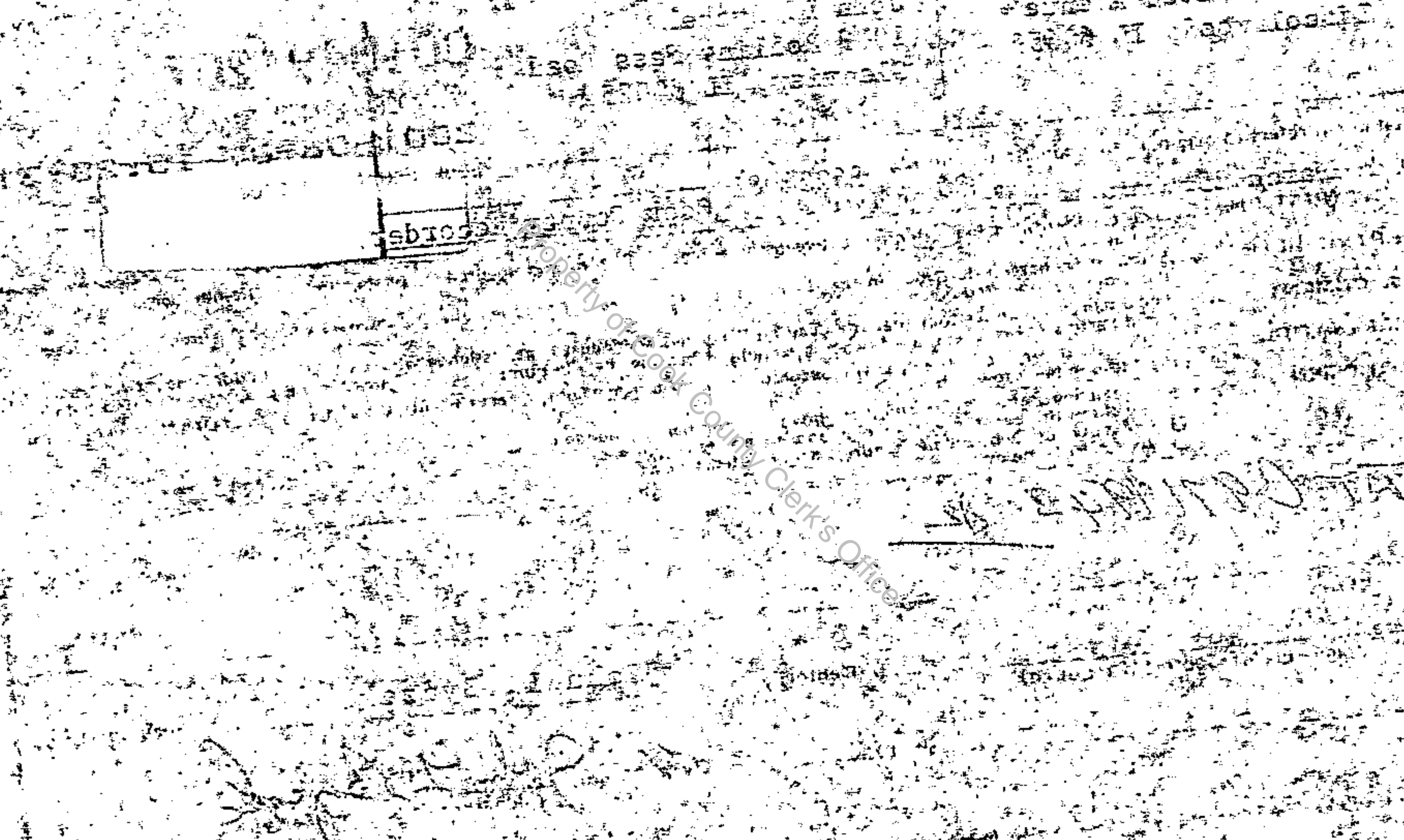

abto

Property of Cook County Clerk's Office

[Illegible signature or initials]

FIRST AMERICAN TITLE INSURANCE COMPANY
30 North La Salle, Suite 300, Chicago, IL 60602

ALTA Commitment
Schedule C

File No.: C9714943

10-35-327-006, 10-35-327-007, 10-35-327-008,

LEGAL DESCRIPTION:

10-35-327-016

PARCEL 1:

LOT 36 (EXCEPT THE NORTH 33 FEET THEREOF AND EXCEPT THE EASTERLY 25 FEET MEASURED AT RIGHT ANGLES TO THE SOUTHEASTERLY LINE OF SAID LOTS) IN JOHN PROESEL ESTATES PARTITION BEING A SUBDIVISION OF THE SOUTH 1/2 OF THE SOUTHWEST 1/4 OF SECTION 35, TOWNSHIP 41 NORTH, RANGE 13 EAST OF THE THIRD PRINCIPAL MERIDIAN, (EXCEPT RAILROAD) IN COOK COUNTY, ILLINOIS.

PARCEL 2:

THE NORTH 8 FEET OF THE EAST AND WEST 16 FOOT PUBLIC ALLEY LYING SOUTH OF LOT 36 AND NORTH OF LOT 37; LYING EAST OF THE WEST LINE OF AFORESAID LOT 36 EXTENDED SOUTH 8 FEET; LYING WEST OF THE EASTERLY LINE OF AFORESAID LOT 36 (BEING THE WESTERLY LINE OF PROESEL AVENUE EXTENDED SOUTHWESTERLY TO THE NORTHEAST CORNER OF AFORESAID LOT 37; ALL IN JOHN PROESEL ESTATE PARTITION BEING A SUBDIVISION OF THE SOUTH 1/2 OF THE SOUTHWEST 1/4 OF SECTION 35, TOWNSHIP 41 NORTH, RANGE 13 EAST OF THE THIRD PRINCIPAL MERIDIAN (EXCEPT RAILROAD RIGHT OF WAY) IN COOK COUNTY, ILLINOIS.

PARCEL 3:

LOT 37 (EXCEPT THE WEST 194.06 FEET AND THE SOUTH 17 FEET TAKEN FOR DEVON AVENUE) IN JOHN PROESEL ESTATES PARTITION BEING A SUBDIVISION OF THE SOUTH 1/2 OF THE SOUTHWEST 1/4 OF SECTION 35, TOWNSHIP 41 NORTH, RANGE 13 EAST OF THE THIRD PRINCIPAL MERIDIAN, (EXCEPT RAILROAD) IN COOK COUNTY, ILLINOIS.

PARCEL 4:

THE SOUTH 8 FEET OF THE EAST AND WEST 16 FOOT PUBLIC ALLEY LYING SOUTH OF LOT 36 AND NORTH 37; LYING EAST OF THE EAST LINE OF THE WEST 194.06 FEET OF LOT 37 EXTENDED NORTH 8 FEET; LYING WEST OF THE EASTERLY LINE OF AFORESAID LOT 36 (BEING THE WESTERLY LINE OF PROESEL AVENUE) EXTENDED SOUTHWESTERLY TO THE NORTHEAST CORNER OF AFORESAID LOT 37; ALL IN JOHN PROESEL ESTATE PARTITION BEING A SUBDIVISION OF THE SOUTH 1/2 OF THE SOUTHWEST 1/4 OF SECTION 35, TOWNSHIP 41 NORTH, RANGE 13 EAST OF THE THIRD PRINCIPAL MERIDIAN (EXCEPT RAILROAD RIGHT OF WAY) IN COOK COUNTY, ILLINOIS.



*Commonly Known As:
3924 W. Belmont
Lincolnwood, IL*

*FATC
30 N. LaSalle St.
Chicago, IL 60602
Ste-300*

UNOFFICIAL COPY

Property of Cook County Clerk's Office

Handwritten notes in the bottom left corner, including the word "FIND" and other illegible scribbles.

Handwritten notes in the bottom right corner, including the words "SEARCHED" and "INDEXED".