

UNOFFICIAL COPY

0011015197

8655/0093 38 001 Page 1 of 11
2001-10-30 13:10:33
Cook County Recorder 41.50

216033-Cook

THIS DOCUMENT WAS PREPARED BY AND
AFTER RECORDING SHOULD BE
RETURNED TO:

Timothy R. Conway
Edward B. Keidan
Conway & Mrowiec
300 South Wacker Drive
Suite 601
Chicago, Illinois 60606



0011015197

IN THE CIRCUIT COURT OF COOK COUNTY, ILLINOIS
COUNTY DEPARTMENT, CHANCERY DIVISION
MECHANICS LIEN SECTION

ALDRIDGE ELECTRIC, INC.,)
ILLINOIS STATE TOLL HIGHWAY AUTHORITY,)
ex rel., ALDRIDGE ELECTRIC, INC.,)

Plaintiffs,)

v.)

ILLINOIS STATE TOLL HIGHWAY AUTHORITY,)
ADESTA COMMUNICATIONS, INC.,)
LUMBERMENS MUTUAL CASUALTY COMPANY,)
AERIE NETWORKS, INC., TOUCH AMERICA, INC.,)
METROMEDIA FIBER NETWORKS, INC.,)
WORLDCOM, INC., ROYAL BANK OF CANADA, As)
Senior And LP Administrative Agent, UNKNOWN)
OWNERS and NON-RECORD CLAIMANTS,)

Defendants.)

No.: 01CH18215

LIS PENDENS NOTICE

Timothy R. Conway and Edward B. Keidan, attorneys for Aldridge Electric, Inc., hereby certify that Aldridge Electric, Inc.'s Complaint to Foreclose Mechanics Lien and Other Relief was filed in the above court on October 29, 2001, and is now pending in said Court and that the Property in Cook County, Illinois affected by said Complaint and cause is described as follows:

Property: portions of the right of way along the Illinois State Toll Highway Authority's Tri-State Tollway 294 south of Lake-Cook Road, continuing to the intersection of the Tri-State Tollway I-294/I-94 and the Northwest Tollway I-90, continuing to Toll Plaza 35 near Cermak Road, in Cook County, Illinois.

UNOFFICIAL COPY

216033 - Cook

Segment 1:

0011015197

The right-of-way along those portions of Interstate Highway 294, approximately 12 miles long, between the boundary of Lake County and Cook County north of the intersection of Interstate Highway 294 and Interstate Highway 94, and the intersection of Interstate Highway 294 and Interstate Highway 90, all in Cook County, Illinois, as shown on the attached Exhibit G.

Also described as:

The right-of-way along those portions of Interstate Highway 294, approximately 12 miles long, between the boundary of Lake County and Cook County north of the intersection of Interstate Highway 294 and Interstate Highway 94, in Section 6, Township 42 North, Range 12 East, and continuing through the following list of Sections, Townships, and Ranges, and ending at the intersection of Interstate Highway 294 and Interstate Highway 90 in Section 4, Township 40 North, Range 12 East, all in Cook County, Illinois, as shown on the attached Exhibit G:

Beginning at the boundary of Lake County and Cook County north of the intersection of Interstate Highway 294 and Interstate Highway 94 in:
Section 6, Township 42 North, Range 12 East, then to
Section 7, Township 42 North, Range 12 East, then to
Section 18, Township 42 North, Range 12 East, then to
Section 17, Township 42 North, Range 12 East, then to
Section 19, Township 42 North, Range 12 East, then to
Section 20, Township 42 North, Range 12 East, then to
Section 29, Township 42 North, Range 12 East, then to
Section 32, Township 42 North, Range 12 East, then to
Section 9, Township 41 North, Range 12 East, then to
Section 16, Township 41 North, Range 12 East, then to
Section 21, Township 41 North, Range 12 East, then to
Section 28, Township 41 North, Range 12 East, then to
Section 33, Township 41 North, Range 12 East, then to
Section 34, Township 41 North, Range 12 East, then to
Section 3, Township 40 North, Range 12 East, then ending in
Section 4, Township 40 North, Range 12 East at
the intersection of Interstate Highway 294 and Interstate Highway 90.

Also described as:

Property: portions of the right of way along the Illinois State Toll Highway Authority's Tri-State Tollway 294 south of Lake-Cook Road, continuing to the intersection of the Tri-State Tollway I-294/I-94 and the Northwest Tollway I-90, continuing to Toll Plaza 35 near Cermak Road, in Cook County, Illinois.

The right-of-way along those portions of Interstate Highway 294, approximately 12 miles long, between the boundary of Lake County and Cook County north of the intersection of Interstate Highway 294 and Interstate Highway 94, at approximately Station Point 655+33, and ending at the intersection of Interstate Highway 294 and Interstate Highway 90, at handhole #90, nine feet south of handhole #91 at Station Point 0+00, as shown on the attached Exhibit G.

Segment 2

The right-of-way along those portions of Interstate Highway 294, approximately 11 miles long, between the intersection of Interstate Highway 294 and Interstate Highway 90, and Plaza 35, all in Cook County, Illinois, as shown on the attached Exhibit G.

Also described as:

The right-of-way along those portions of Interstate Highway 294, approximately 11 miles long, between the intersection of Interstate Highway 294 and Interstate Highway 90, in Section 4, Township 40 North, Range 12 East, and continuing through the following list of Sections, Townships, and Ranges, and ending at Plaza 35 in Section 19, Township 39 North, Range 12 East, all in Cook County, Illinois, as shown on the attached Exhibit G:

Beginning at the intersection of Interstate Highway 294 and Interstate Highway 90 in:

Section 4, Township 40 North, Range 12 East, then to Section 9, Township 40 North, Range 12 East, then to Section 16, Township 40 North, Range 12 East, then to Section 21, Township 40 North, Range 12 East, then to Section 20, Township 40 North, Range 12 East, then to Section 19, Township 40 North, Range 12 East, then to Section 30, Township 40 North, Range 12 East, then to Section 31, Township 40 North, Range 12 East, then to Section 6, Township 39 North, Range 12 East, then to Section 7, Township 39 North, Range 12 East, then to Section 18, Township 39 North, Range 12 East, then ending in Section 19, Township 39 North, Range 12 East, at Toll Plaza 35.

Also described as:

Property: portions of the right of way along the Illinois State Toll Highway Authority's Tri-State Tollway 294 south of Lake-Cook Road, continuing to the intersection of the Tri-State Tollway I-294/I-94 and the Northwest Tollway I-90, continuing to Toll Plaza 35 near Cermak Road, in Cook County, Illinois.

The right-of-way along those portions of Interstate Highway 294, approximately 12 miles long, between the intersection of Interstate Highway 294 and Interstate Highway 90, at approximately Station Point 597+26, and ending at Plaza 35, handhole #131, Station Point 0+00.

As shown on the attached Exhibit G, in Cook County, Illinois, and all fixtures, apparatus, and appurtenances as described in the Complaint.

The Property is commonly known as portions of the right of way along the Illinois State Toll Highway Authority's Tri-State Tollway 294 south of Lake-Cook Road, continuing to the intersection of the Tri-State Tollway I-294/I-94 and the Northwest Tollway I-90, continuing to Toll Plaza 35 near Cermak Road, in Cook County, Illinois.

Dated: October 29, 2001.

ALDRIDGE ELECTRIC, INC.

By: Timothy R. Conway
One of Its Attorneys

Subscribed and sworn to before me
this 29th day of October, 2001.

Susan J. Monroe
Notary Public

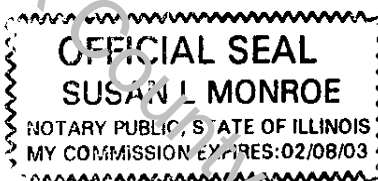

THIS DOCUMENT WAS PREPARED BY AND
AFTER RECORDING SHOULD BE RETURNED TO:

Timothy R. Conway
Edward B. Keidan
Conway & Mrowiec
300 South Wacker Drive, Suite 601
Chicago, Illinois 60606
Phone: (312) 692-1700
Fax: (312) 692-1701
Firm No. 37317

Property: portions of the right of way along the Illinois State Toll Highway Authority's Tri-State Tollway 294 south of Lake-Cook Road, continuing to the intersection of the Tri-State Tollway I-294/I-94 and the Northwest Tollway I-90, continuing to Toll Plaza 35 near Cermak Road, in Cook County, Illinois.

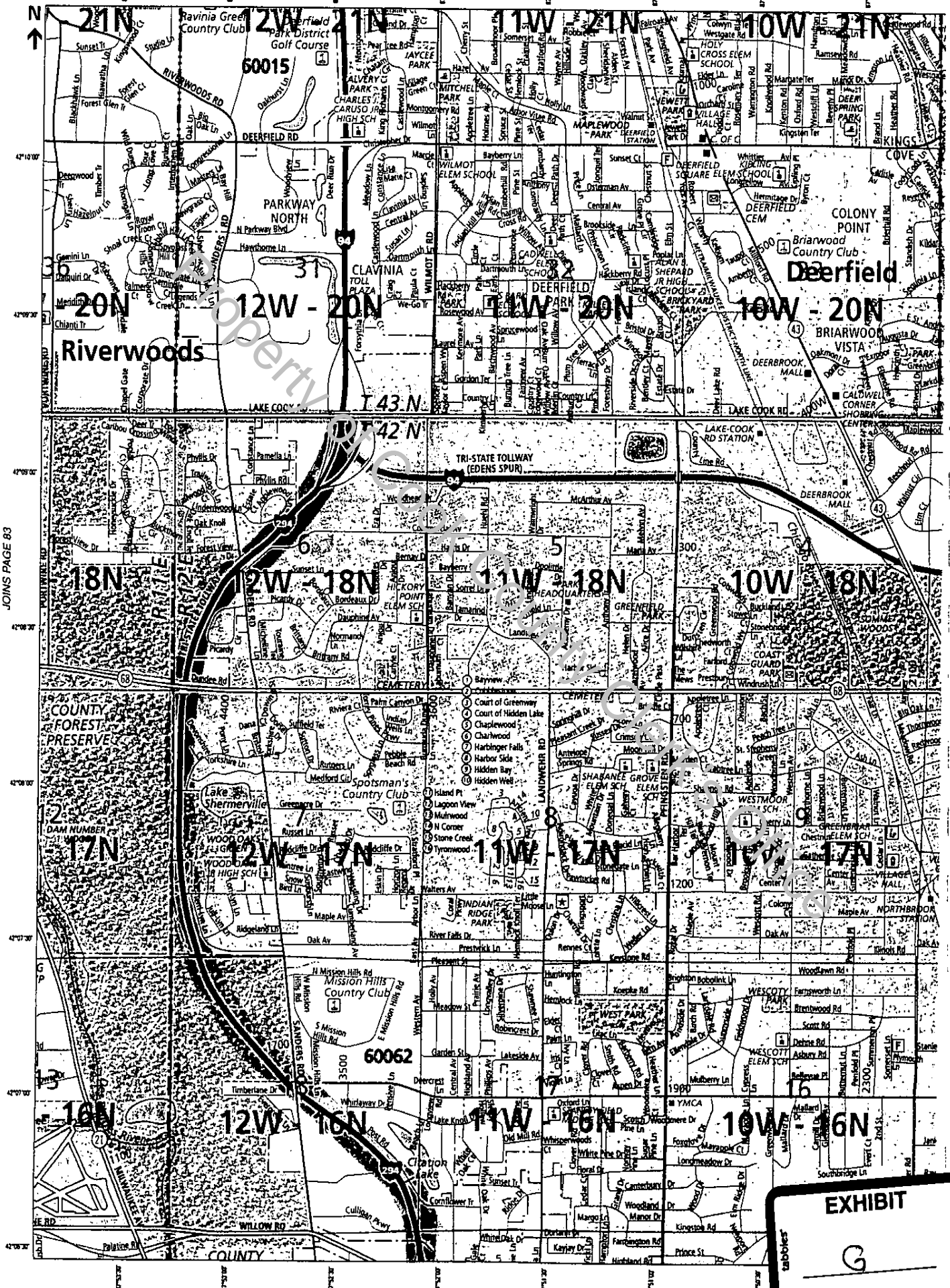

JOINS PAGE 83

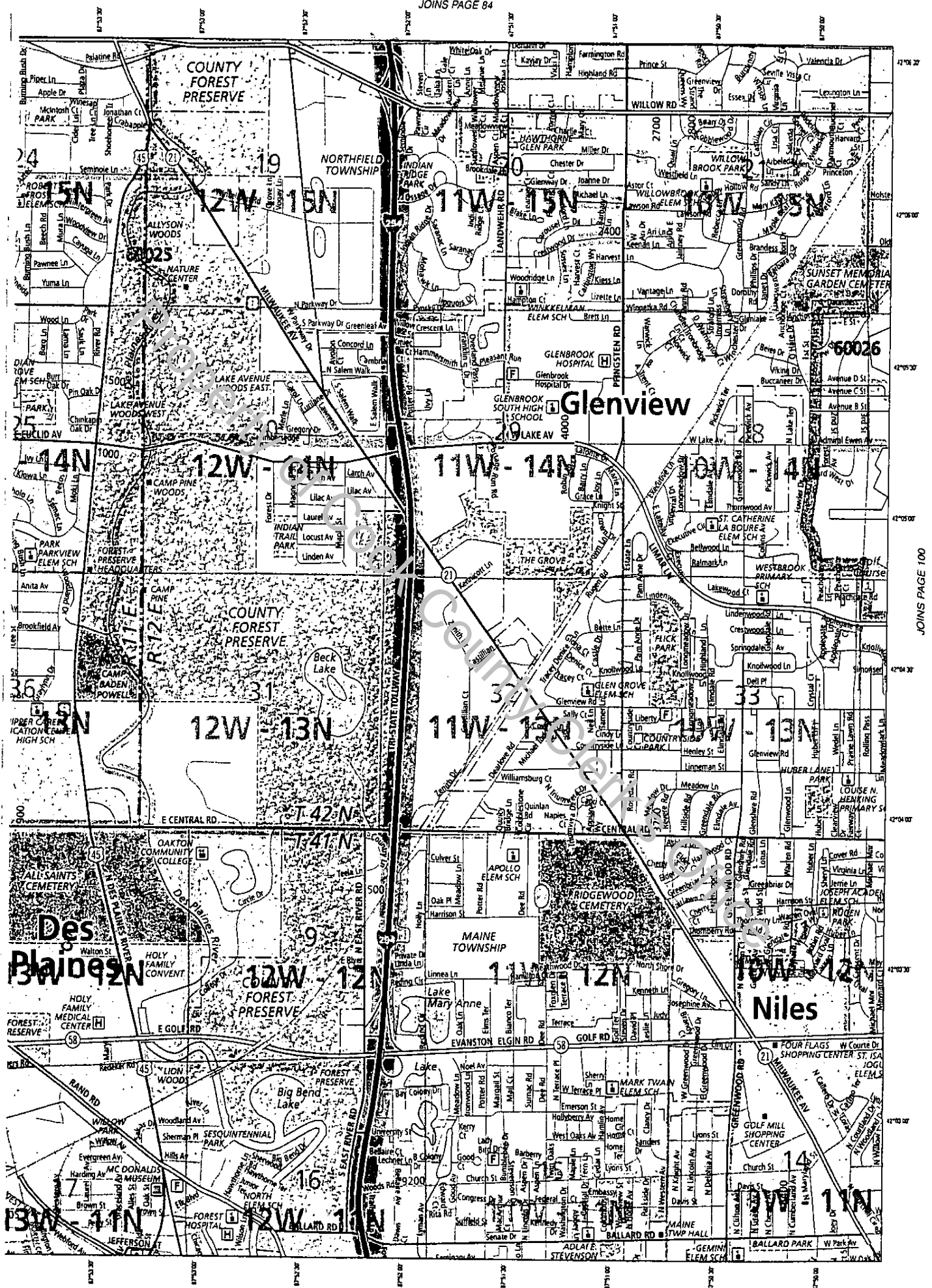

JOINS PAGE 100

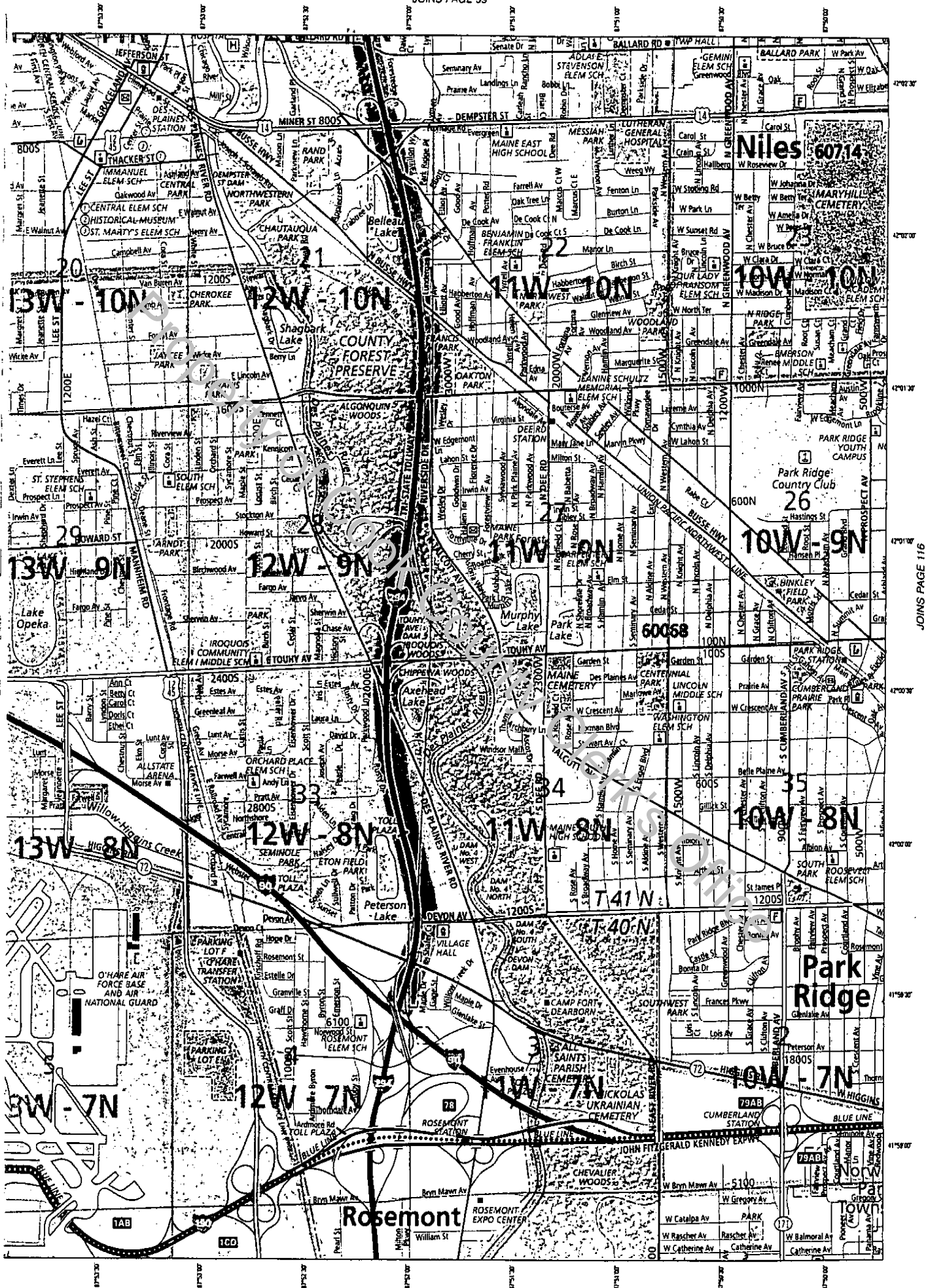

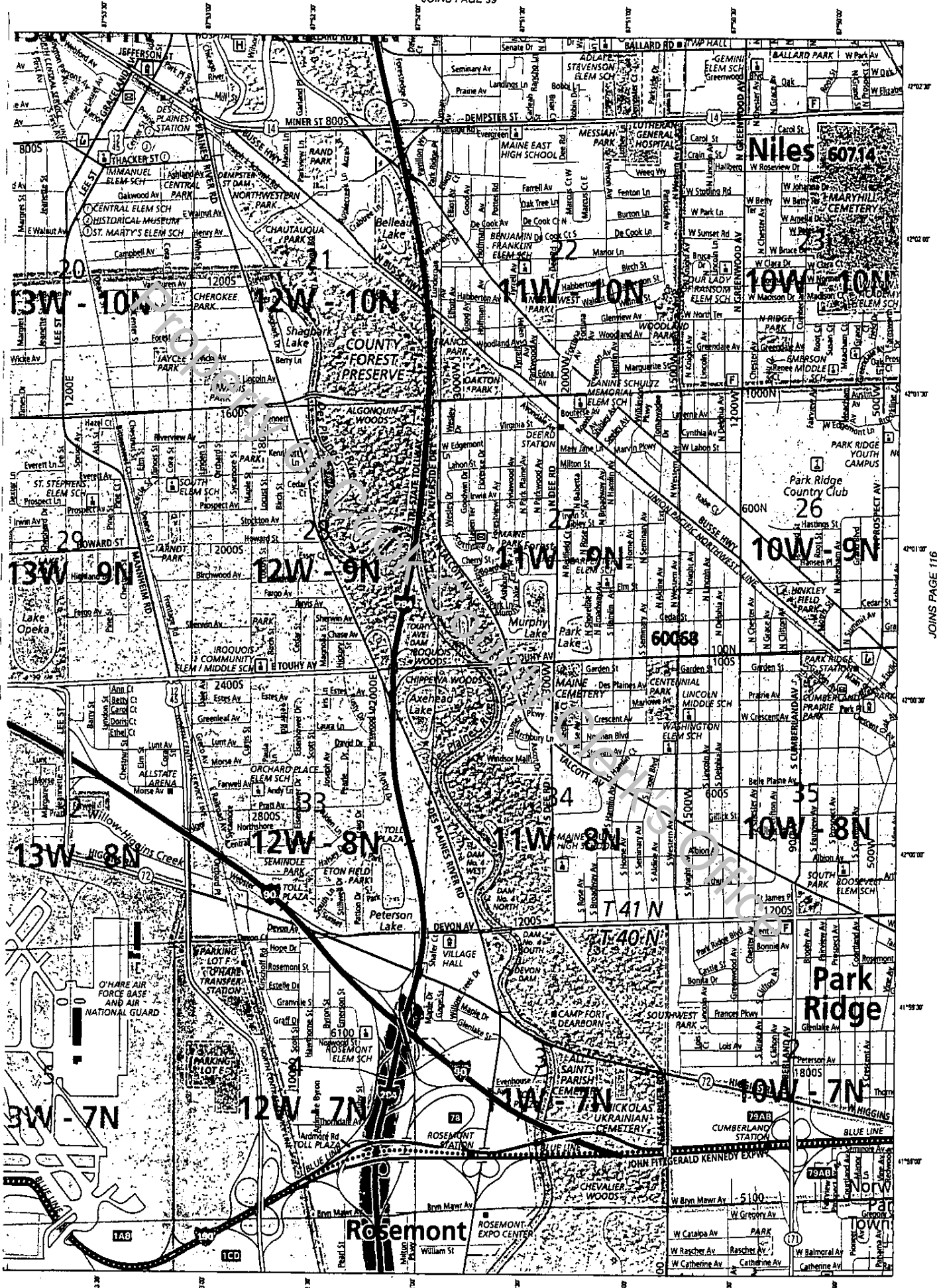

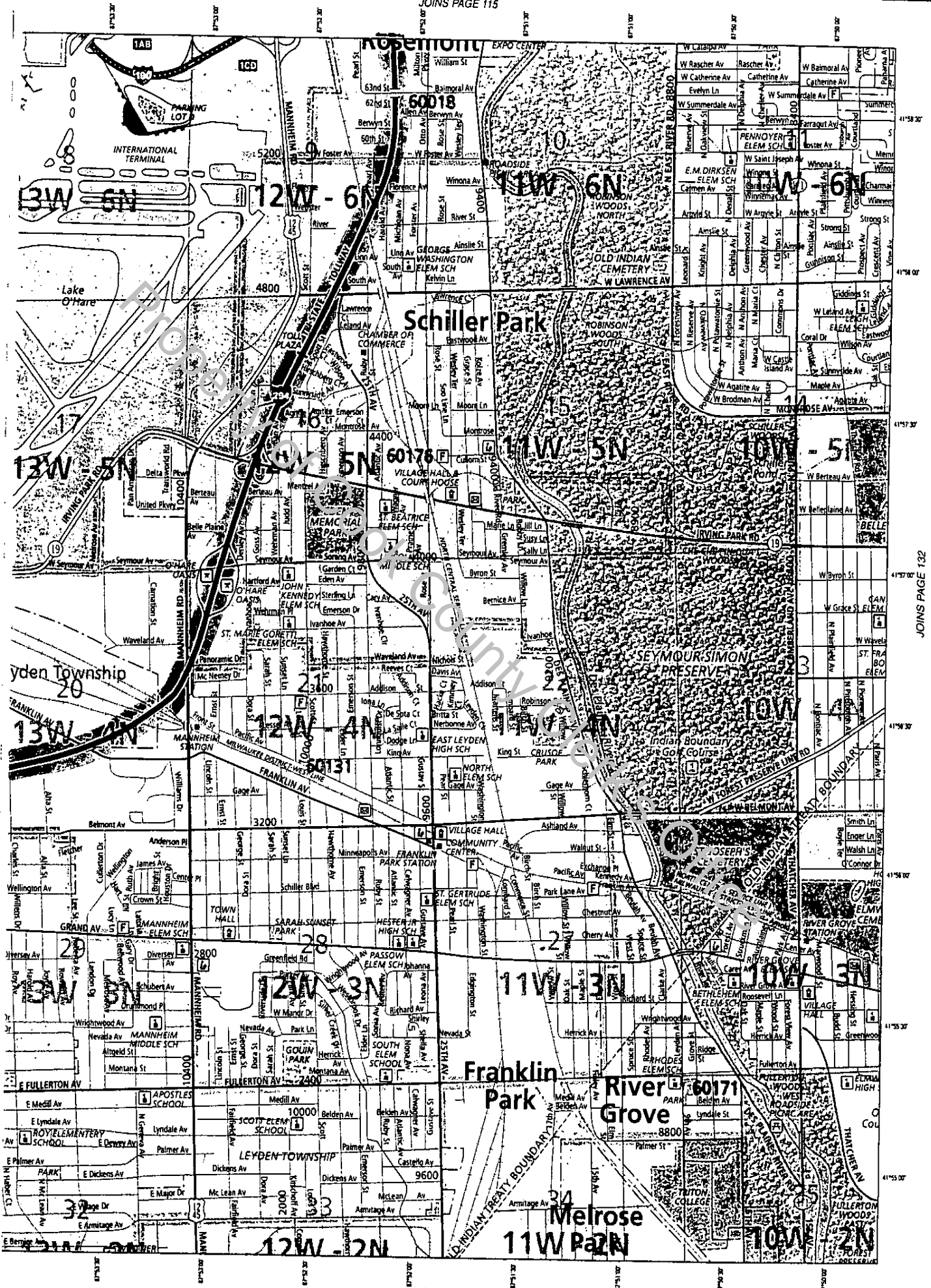

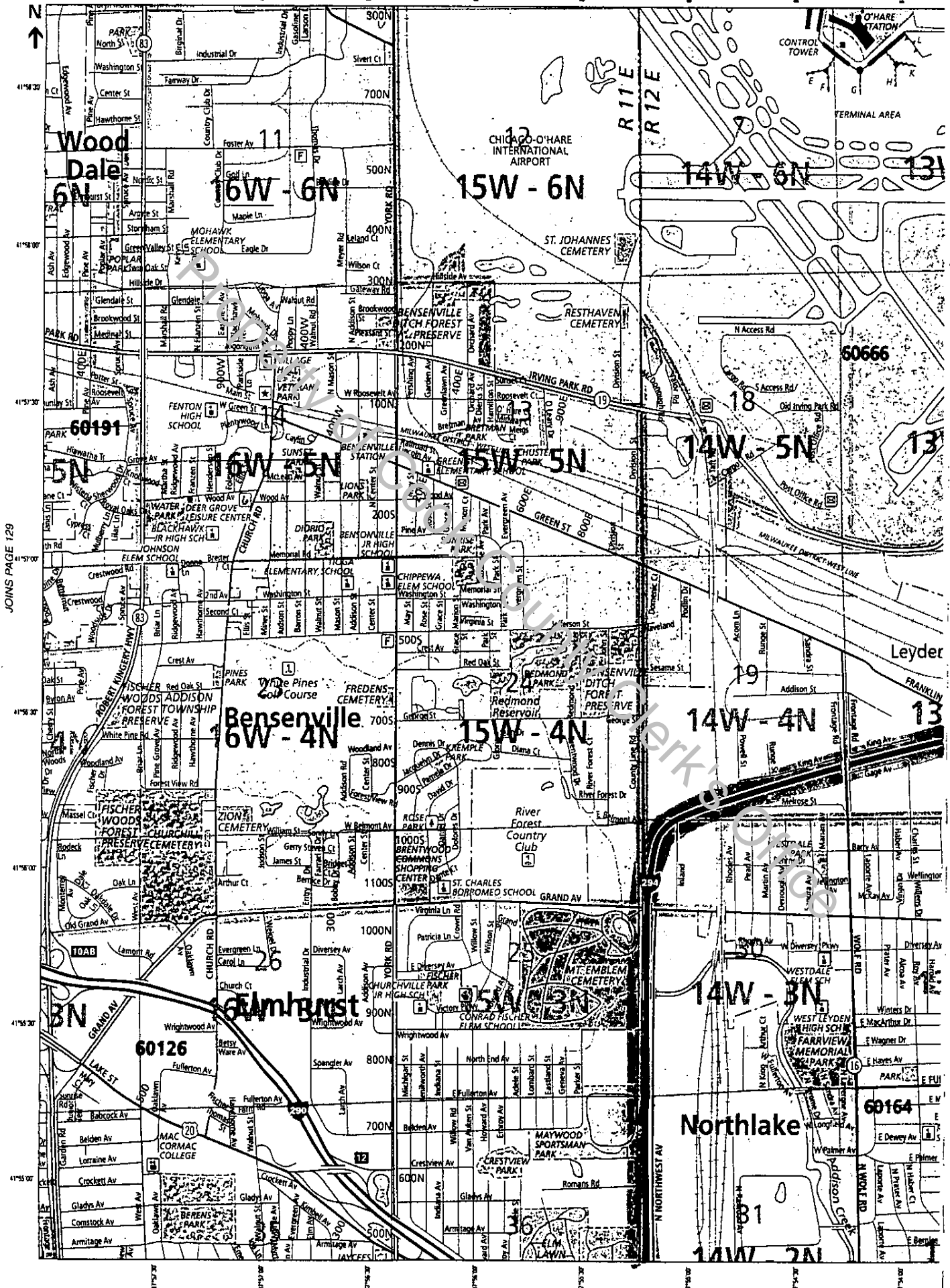

JOINS PAGE 129

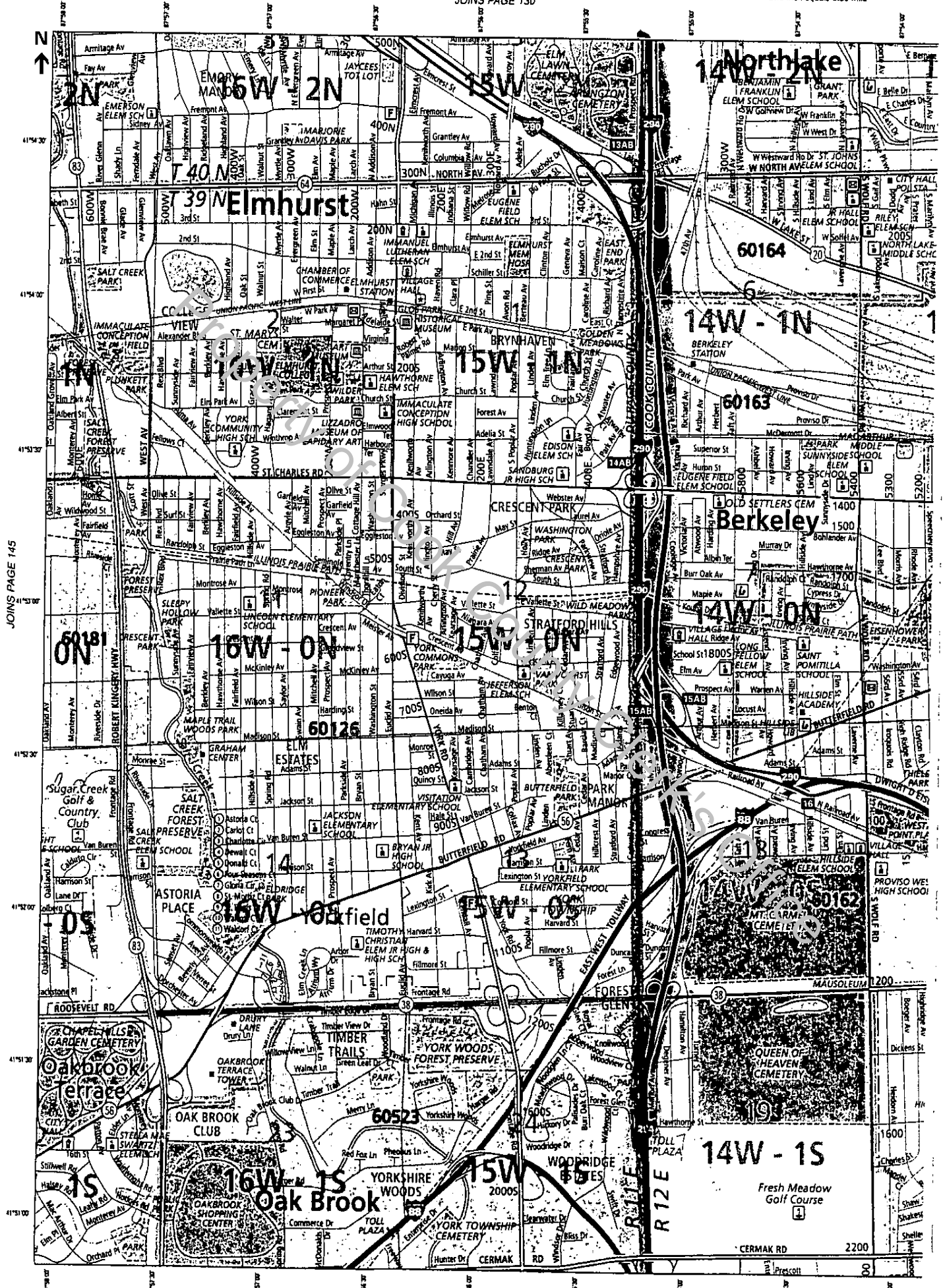

JOINS PAGE 145