

UNOFFICIAL COPY

216102 - COOK

THIS DOCUMENT WAS PREPARED BY AND
AFTER RECORDING SHOULD BE
RETURNED TO:

Timothy R. Conway
Edward B. Keidan
Conway & Mrowiec
300 South Wacker Drive
Suite 601
Chicago, Illinois 60606

0011015198

8655/0094 38 001 Page 1 of 9
2001-10-30 13:12:23
Cook County Recorder 37.50



IN THE CIRCUIT COURT OF COOK COUNTY, ILLINOIS
COUNTY DEPARTMENT, CHANCERY DIVISION
MECHANICS LIEN SECTION

ALDRIDGE ELECTRIC, INC.,)
ILLINOIS STATE TOLL HIGHWAY AUTHORITY,)
ex rel. ALDRIDGE ELECTRIC, INC.,)

Plaintiffs,)

v.)

ILLINOIS STATE TOLL HIGHWAY AUTHORITY,)
ADESTA COMMUNICATIONS, INC.,)
LUMBERMENS MUTUAL CASUALTY COMPANY,)
WORLDCOM, INC., AERIE NETWORKS, INC.,)
ROYAL BANK OF CANADA, AS SENIOR AND)
LP ADMINISTRATIVE AGENT, UNKNOWN)
OWNERS and NON-RECORD CLAIMANTS,)

Defendants.)

01CH18214

No.: _____

LIS PENDENS NOTICE

Timothy R. Conway and Edward B. Keidan, attorneys for Aldridge Electric, Inc., hereby certify that Aldridge Electric, Inc.'s Complaint to Foreclose Mechanics Lien and Other Relief was filed in the above court on October 30, 2001, and is now pending in said Court and that the Property in Cook County, Illinois affected by said Complaint and cause is described as follows:

Property: portions of the right of way along the Illinois State Toll Highway Authority's Interstate Toll Highway 294 from the Cermak Toll Plaza to a point near Ridgeland Avenue.

The right-of-way along those portions of Interstate Highway 294, approximately 17 miles long, between Plaza 35 (the Cermak toll plaza), and handhole #184A southeast of Ridgeland Avenue, all in Cook County, Illinois, as shown on the attached Exhibit G.

Also described as:

The right-of-way along those portions of Interstate Highway 294, approximately 17 miles long, between Plaza 35 (the Cermak toll plaza) in Section 19, Township 39 North, Range 12 East, and continuing through the following list of Sections, Townships, and Ranges, and ending at handhole #184A southeast of Ridgeland Avenue in Section 29, Township 37 North, Range 13 East, all in Cook County, Illinois, as shown on the attached Exhibit G:

Beginning at Plaza 35, in:

Section 19, Township 39 North, Range 12 East, then to Section 30, Township 39 North, Range 12 East, then to Section 25, Township 39 North, Range 12 East, then to Section 30, Township 39 North, Range 12 East, then to Section 31, Township 39 North, Range 12 East, then to Section 6, Township 38 North, Range 12 East, then to Section 7, Township 38 North, Range 12 East, then to Section 18, Township 38 North, Range 12 East, then to Section 19, Township 38 North, Range 12 East, then to Section 20, Township 38 North, Range 12 East, then to Section 29, Township 38 North, Range 12 East, then to Section 28, Township 38 North, Range 12 East, then to Section 27, Township 38 North, Range 12 East, then to Section 34, Township 38 North, Range 12 East, then to Section 35, Township 38 North, Range 12 East, then to Section 36, Township 38 North, Range 12 East, then to Section 1, Township 37 North, Range 12 East, then to Section 12, Township 37 North, Range 12 East, then to Section 7, Township 37 North, Range 13 East, then to Section 18, Township 37 North, Range 13 East, then to Section 19, Township 37 North, Range 13 East, then to Section 20, Township 37 North, Range 13 East, then ending in Section 29, Township 37 North, Range 13 East at handhole #184A southeast of Ridgeland Avenue.

Also described as:

Property: portions of the right of way along the Illinois State Toll Highway Authority's Interstate Toll Highway 294 from the Cermak Toll Plaza to a point near Ridgeland Avenue.

The right-of-way along those portions of Interstate Highway 294, approximately 17 miles long, between Plaza 35 (the Cermak toll plaza), at handhole #131, Station Point 1576+87, and ending at handhole #184A southeast of Ridgeland Avenue, Station Point 713+30.

As shown on the attached Exhibit G, in Cook County, Illinois, and all fixtures, apparatus, and appurtenances as described in the Complaint.

The Property is commonly known as portions of the right of way along the Illinois State Toll Highway Authority's Tollway 294 from the Cermak Toll Plaza to a point near Ridgeland Avenue.

Dated: October 30, 2001.

ALDRIDGE ELECTRIC, INC.

By: Timothy R. Conway
One of Its Attorneys

Subscribed and sworn to before me
this 30th day of October, 2001.

Susan S. Monroe
Notary Public

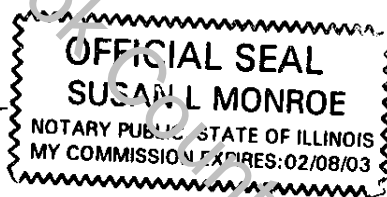

THIS DOCUMENT WAS PREPARED BY AND
AFTER RECORDING SHOULD BE RETURNED TO:

Timothy R. Conway
Edward B. Keidan
Conway & Mrowiec
300 South Wacker Drive, Suite 601
Chicago, Illinois 60606
Phone: (312) 692-1700
Fax: (312) 692-1701
Firm ID No.: 31737

Property: portions of the right of way along the Illinois State Toll Highway Authority's Interstate Toll Highway 294 from the Cermak Toll Plaza to a point near Ridgeland Avenue.

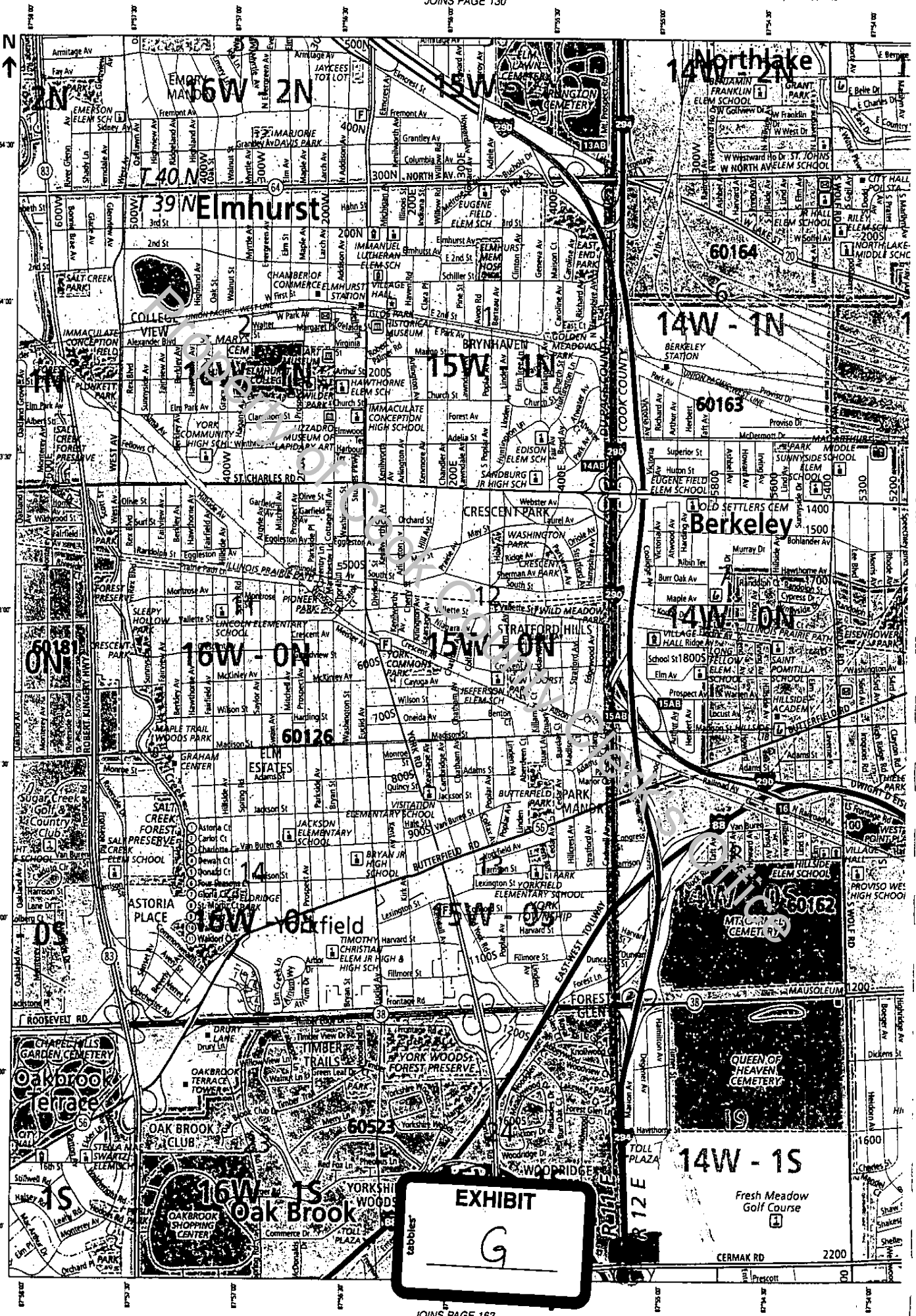

EXHIBIT
G

14W - 1S

Fresh Meadow Golf Course

14W - 1N

12E

CERMAK RD 2200

14W - 10N

Berkeley

14W - 1N

14 Northlake

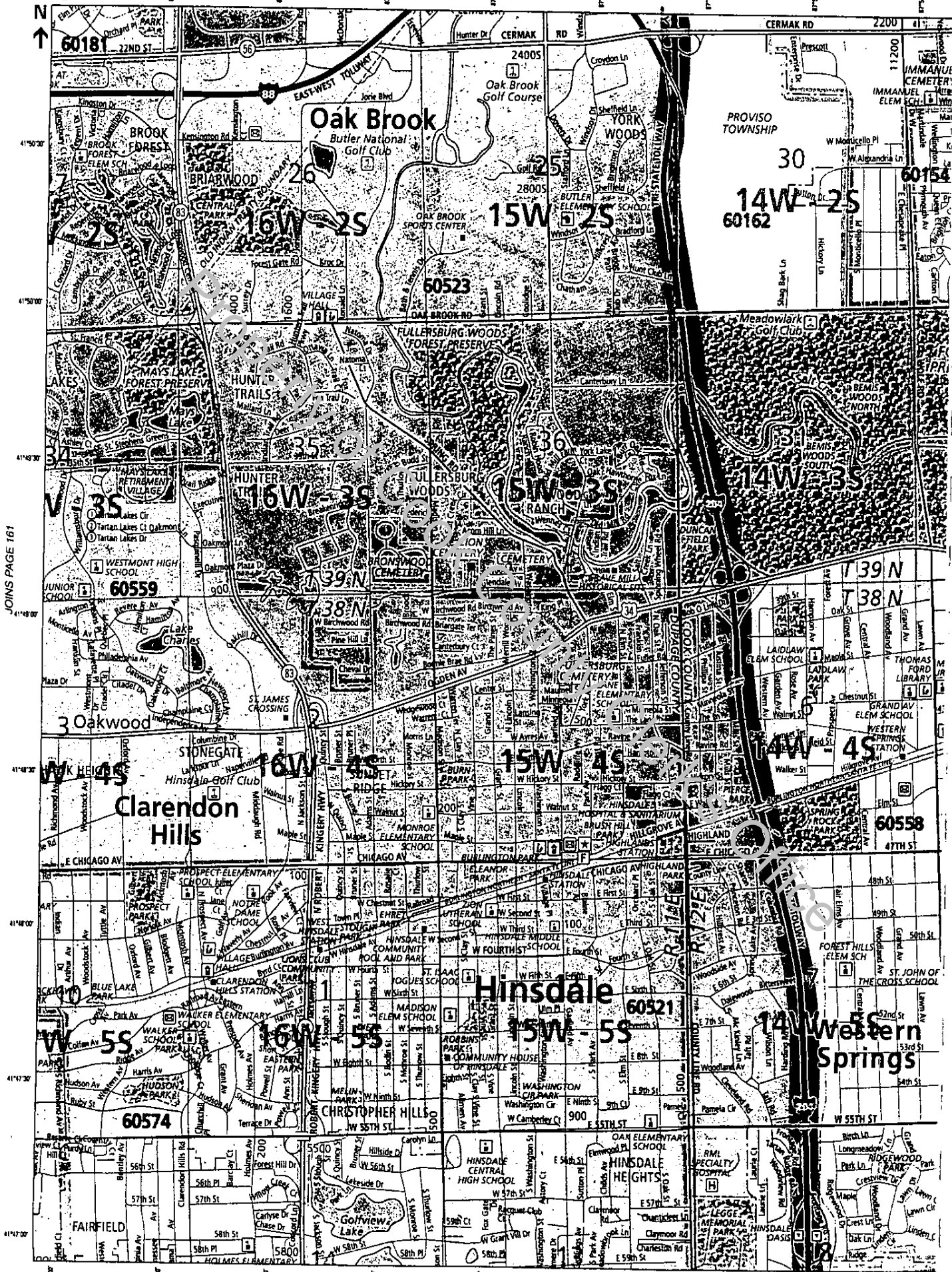
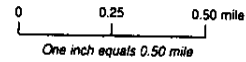

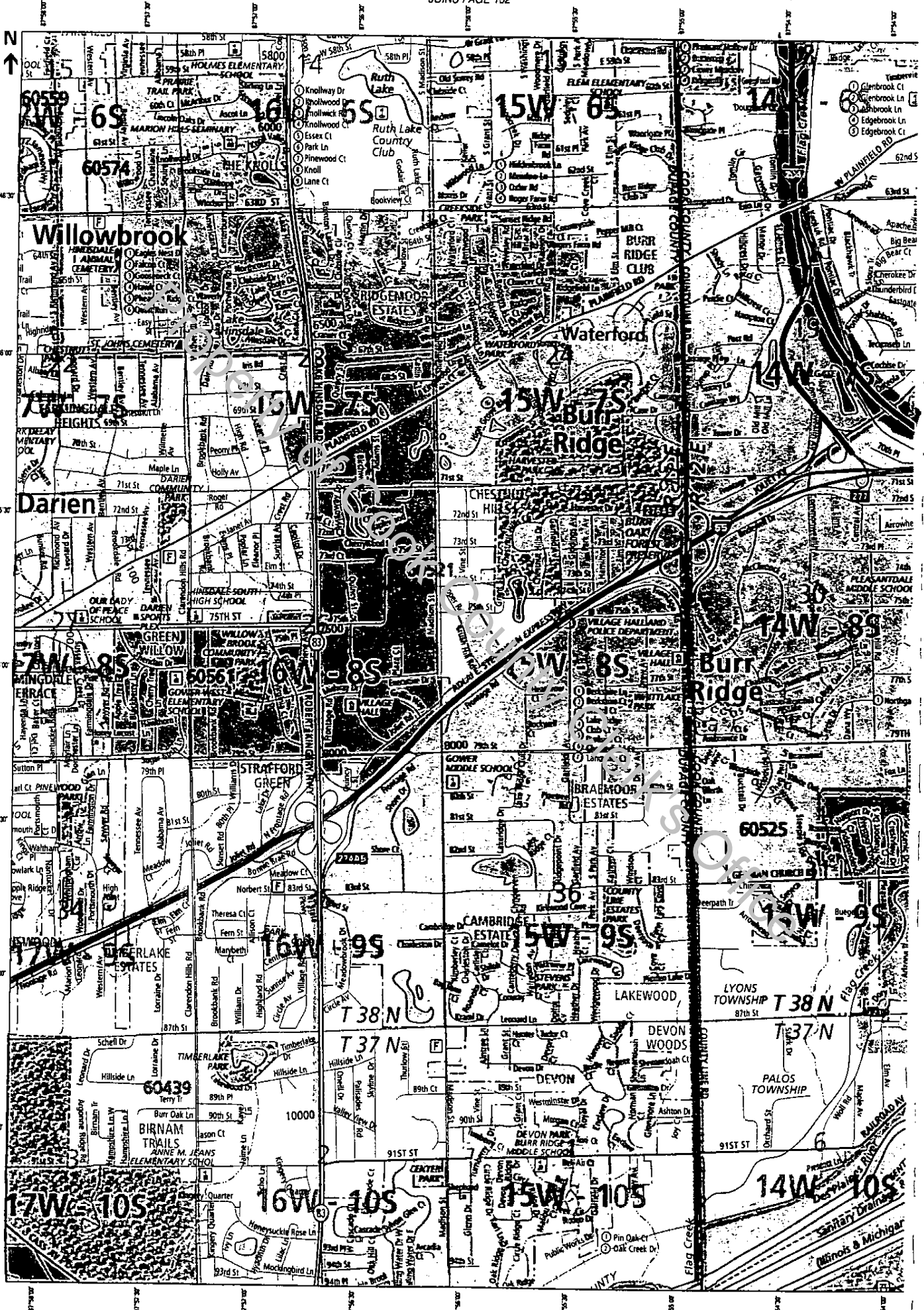

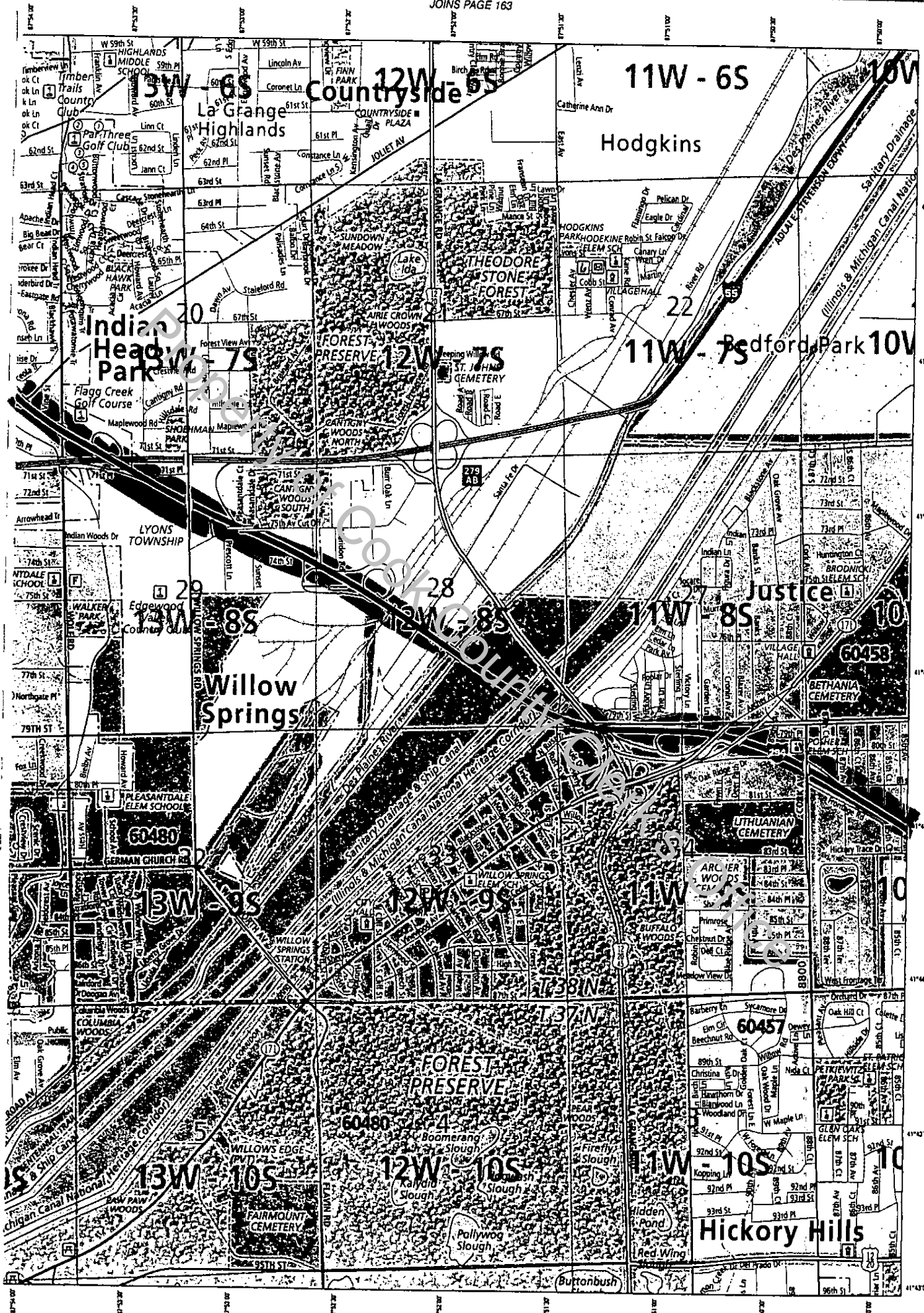

JOINS PAGE 180

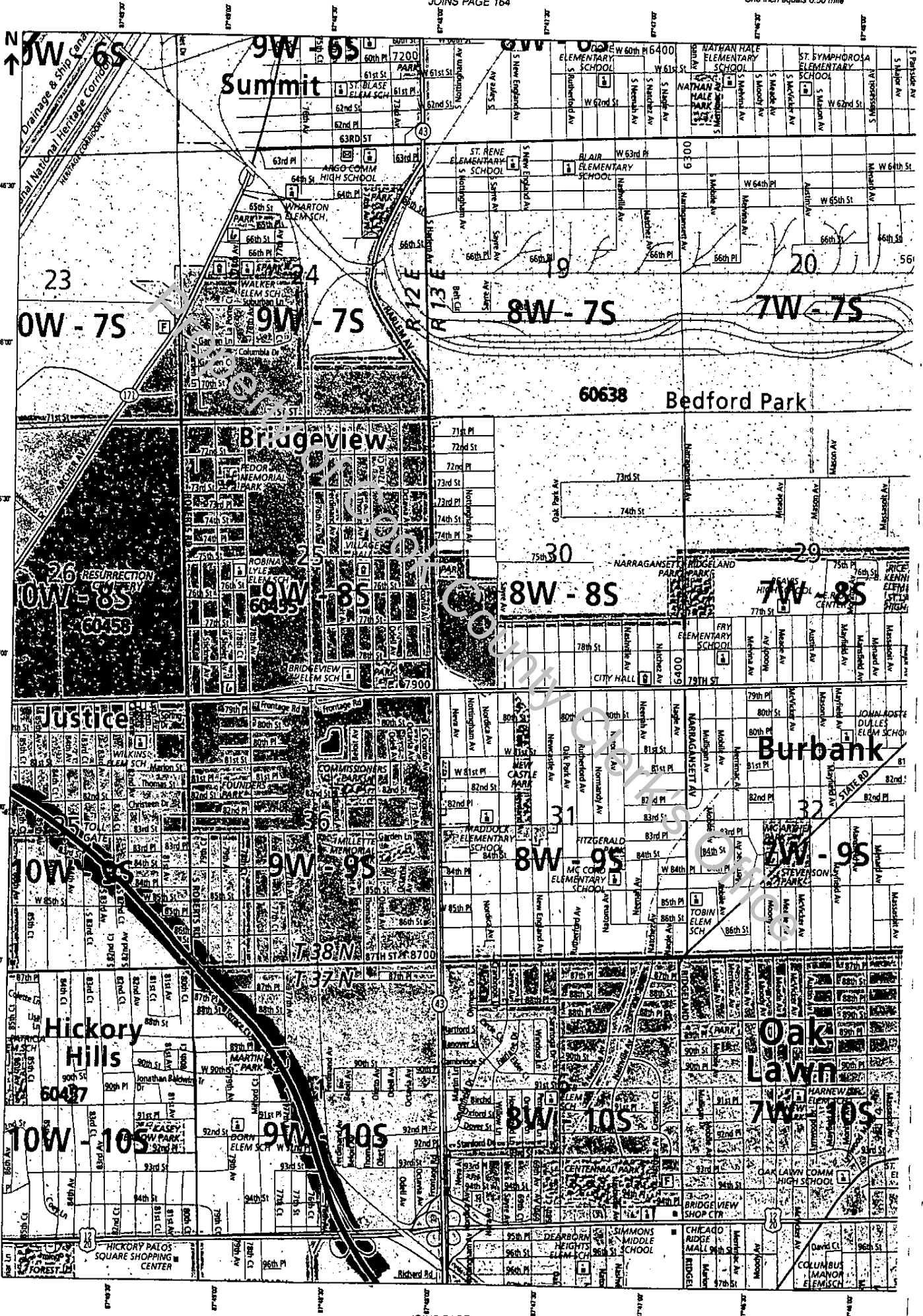

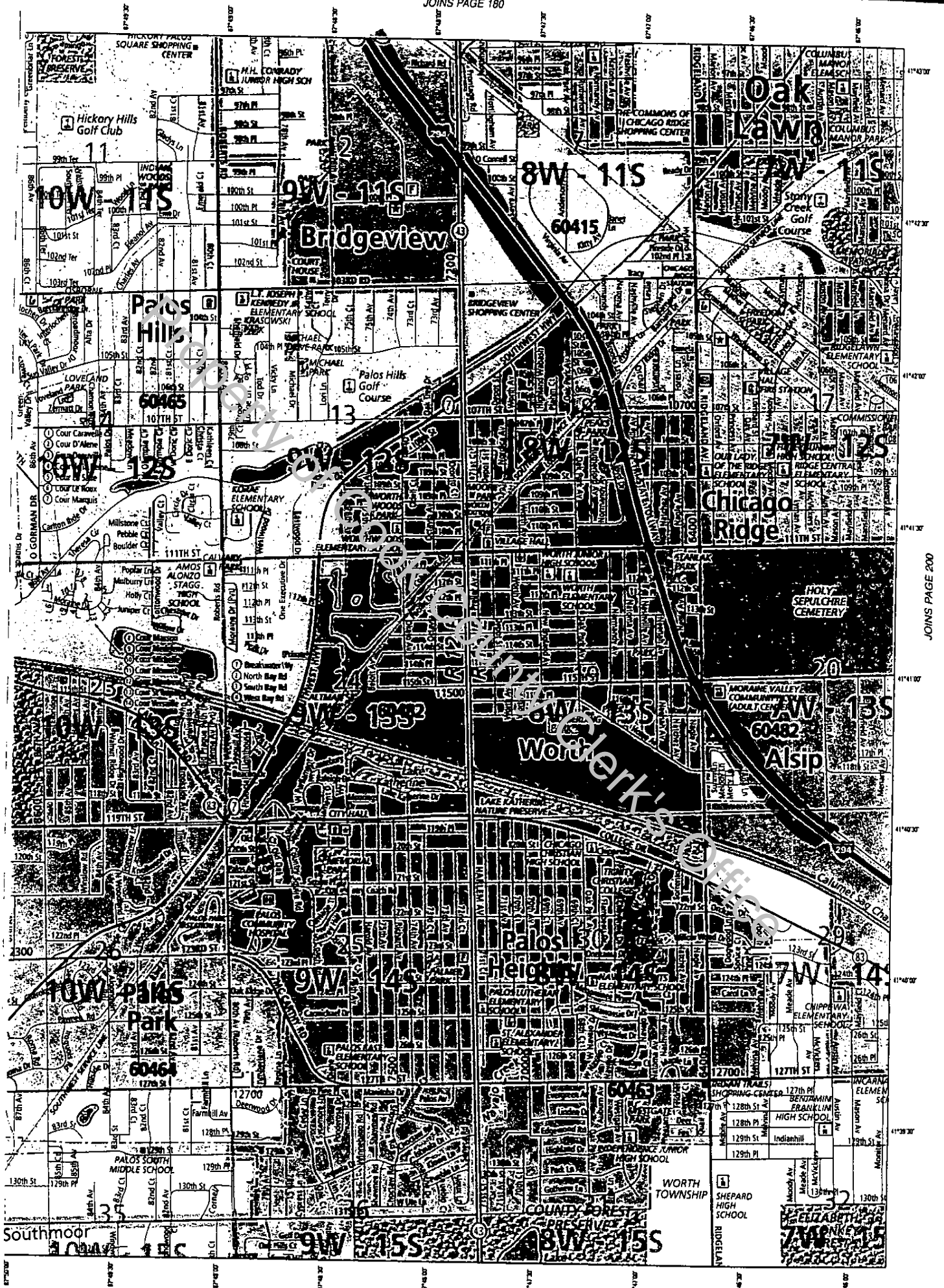

JOINS PAGE 200