

# UNOFFICIAL COPY

0011015199

8655/0095 38 001 Page 1 of 19  
2001-10-30 13:14:37  
Cook County Recorder 57.50

215064 - COOK

THIS DOCUMENT WAS PREPARED BY AND  
AFTER RECORDING SHOULD BE  
RETURNED TO:

Timothy R. Conway  
Edward B. Keidan  
Conway & Mrowiec  
300 South Wacker Drive  
Suite 601  
Chicago, Illinois 60606



IN THE CIRCUIT COURT OF COOK COUNTY, ILLINOIS  
COUNTY DEPARTMENT, CHANCERY DIVISION  
MECHANICS LIEN SECTION

ALDRIDGE ELECTRIC, INC.,  
  
Plaintiffs,

v.

ILLINOIS STATE TOLL HIGHWAY AUTHORITY,  
ADESTA COMMUNICATIONS, INC.,  
WILLIAMS COMMUNICATIONS, INC.,  
ROYAL BANK OF CANADA, As Senior And LP  
Administrative Agent, UNKNOWN OWNERS and  
NON-RECORD CLAIMANTS,

Defendants.

01CH18213

No.: \_\_\_\_\_

### LIS PENDENS NOTICE

Timothy R. Conway and Edward B. Keidan, attorneys for Aldridge Electric, Inc., hereby certify that Aldridge Electric, Inc.'s Complaint to Foreclose Mechanics Lien and Other Relief was filed in the above court on October 29, 2001, and is now pending in said Court and that the Property in Cook County, Illinois affected by said Complaint and cause is described as follows:

Property: portions of the Illinois State Toll Highway Authority's right of way from the intersection of the Tri-State Tollway (I-294/I-94), continuing to the intersection with the Northwest Tollway (I-90), and from the intersection of I-294/I-394 north to approximately Cermak Road in Cook County, Illinois.

# UNOFFICIAL COPY

0011015199

215064 - Cook

## Segment 3

The right-of-way along those portions of Interstate Highway 294, approximately 31 miles long, between Plaza 35 and the intersection of Interstate Highway 294 and Interstate Highway 394, all in Cook County, Illinois, as shown on the attached Exhibit C.

Also described as:

The right-of-way along those portions of Interstate Highway 294, approximately 31 miles long, between Plaza 35 in Section 19, Township 39 North, Range 12 East, and continuing through the following list of Sections, Townships, and Ranges, and ending at the intersection of Interstate Highway 294 and Interstate Highway 394 in Section 26, Township 36 North, Range 14 East, all in Cook County, Illinois, as shown on the attached Exhibit C:

Beginning at Plaza 35 in:

Section 19, Township 39 North, Range 12 East, then to Section 30, Township 39 North, Range 12 East, then to Section 25, Township 39 North, Range 12 East, then to Section 30, Township 39 North, Range 12 East, then to Section 31, Township 39 North, Range 12 East, then to Section 6, Township 38 North, Range 12 East, then to Section 7, Township 38 North, Range 12 East, then to Section 18, Township 38 North, Range 12 East, then to Section 19, Township 38 North, Range 12 East, then to Section 20, Township 38 North, Range 12 East, then to Section 29, Township 38 North, Range 12 East, then to Section 28, Township 38 North, Range 12 East, then to Section 27, Township 38 North, Range 12 East, then to Section 34, Township 38 North, Range 12 East, then to Section 35, Township 38 North, Range 12 East, then to Section 36, Township 38 North, Range 12 East, then to Section 1, Township 37 North, Range 12 East, then to Section 12, Township 37 North, Range 12 East, then to Section 7, Township 37 North, Range 13 East, then to Section 18, Township 37 North, Range 13 East, then to Section 19, Township 37 North, Range 13 East, then to

Property: portions of the Illinois State Toll Highway Authority's right of way from the intersection of the Tri-State Tollway (I-294/I-94), continuing to the intersection with the Northwest Tollway (I-90), and from the intersection of I-294/I-394 north to approximately Cermak Road in Cook County, Illinois.

Section 20, Township 37 North, Range 13 East, then to Section 29, Township 37 North, Range 13 East then to Section 28, Township 37 North, Range 13 East then to Section 27, Township 37 North, Range 13 East then to Section 34, Township 37 North, Range 13 East then to Section 3, Township 36 North, Range 13 East then to Section 2, Township 36 North, Range 13 East then to Section 11, Township 36 North, Range 13 East then to Section 12, Township 36 North, Range 13 East then to Section 13, Township 36 North, Range 13 East then to Section 24, Township 36 North, Range 13 East then to Section 25, Township 36 North, Range 13 East then to Section 30, Township 36 North, Range 14 East then to Section 29, Township 36 North, Range 14 East then to Section 28, Township 36 North, Range 14 East then to Section 27, Township 36 North, Range 14 East then ending in Section 26, Township 36 North, Range 14 East at the intersection of Interstate Highway 294 and Interstate Highway 394.

Also described as:

The right-of-way along those portions of Interstate Highway 294, approximately 31 miles long, between Plaza 35, at handhole #131, Station Point 1576+87, and ending at the intersection of Interstate Highway 294 and Interstate Highway 394, near mile marker 0, Station Point 0+00.

The Cook County Portion of the Land in Segment 3 is shown on the attached Exhibit C.

Segment 1 - Cook County

The right-of-way along those portions of Interstate Highway 294, approximately 12 miles long, between the boundary of Lake County and Cook County north of the intersection of Interstate Highway 294 and Interstate Highway 94, and the intersection of Interstate Highway 294 and Interstate Highway 90, all in Cook County, Illinois, as shown on the attached Exhibit D.

Also described as:

Property: portions of the Illinois State Toll Highway Authority's right of way from the intersection of the Tri-State Tollway (I-294/I-94), continuing to the intersection with the Northwest Tollway (I-90), and from the intersection of I-294/I-394 north to approximately Cermak Road in Cook County, Illinois.

# UNOFFICIAL COPY

0011015199

215064 - Cook

The right-of-way along those portions of Interstate Highway 294, approximately 12 miles long, between the boundary of Lake County and Cook County north of the intersection of Interstate Highway 294 and Interstate Highway 94, in Section 6, Township 42 North, Range 12 East, and continuing through the following list of Sections, Townships, and Ranges, and ending at the intersection of Interstate Highway 294 and Interstate Highway 90 in Section 4, Township 40 North, Range 12 East, all in Cook County, Illinois, as shown on the attached Exhibit D:

Beginning at the boundary of Lake County and Cook County north of the intersection of Interstate Highway 294 and Interstate Highway 94 in:

Section 6, Township 42 North, Range 12 East, then to  
Section 7, Township 42 North, Range 12 East, then to  
Section 18, Township 42 North, Range 12 East, then to  
Section 17, Township 42 North, Range 12 East, then to  
Section 19, Township 42 North, Range 12 East, then to  
Section 20, Township 42 North, Range 12 East, then to  
Section 29, Township 42 North, Range 12 East, then to  
Section 32, Township 42 North, Range 12 East, then to  
Section 9, Township 41 North, Range 12 East, then to  
Section 16, Township 41 North, Range 12 East, then to  
Section 21, Township 41 North, Range 12 East, then to  
Section 28, Township 41 North, Range 12 East, then to  
Section 33, Township 41 North, Range 12 East, then to  
Section 34, Township 41 North, Range 12 East, then to  
Section 3, Township 40 North, Range 12 East, then ending in  
Section 4, Township 40 North, Range 12 East at  
the intersection of Interstate Highway 294 and Interstate Highway 90.

Also described as:

The right-of-way along those portions of Interstate Highway 294, approximately 12 miles long, between the boundary of Lake County and Cook County north of the intersection of Interstate Highway 294 and Interstate Highway 94, at approximately Station Point 655+33, and ending at the intersection of Interstate Highway 294 and Interstate Highway 90, at handhole #90, nine feet south of handhole #91 at Station Point 0+00.

The Cook County Portion of the Land in Segment 1 is shown on the attached Exhibit D. The Cook County Portion of the Land is shown in Exhibit C and Exhibit D, and all fixtures, apparatus and appurtenances as described in the Complaint.

Property: portions of the Illinois State Toll Highway Authority's right of way from the intersection of the Tri-State Tollway (I-294/I-94), continuing to the intersection with the Northwest Tollway (I-90), and from the intersection of I-294/I-394 north to approximately Cermak Road in Cook County, Illinois.

# UNOFFICIAL COPY

0011015199

215064 - Cook

The Property is commonly known as portions of the Illinois State Toll Highway Authority's right of way from the intersection of the Tri-State Tollway (I-294/I-94), continuing to the intersection with the Northwest Tollway (I-90), and from the intersection of I-294/I-394 north to approximately Cermak Road in Cook County, Illinois.

Dated: October 29, 2001.

ALDRIDGE ELECTRIC, INC.

By: Timothy R. Conway  
One of Its Attorneys

Subscribed and sworn to before me  
this 29<sup>th</sup> day of October, 2001.

Susan L. Monroe  
Notary Public

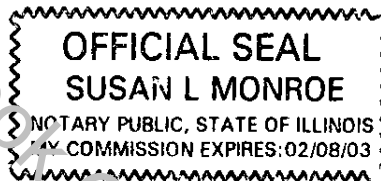

THIS DOCUMENT WAS PREPARED BY AND  
AFTER RECORDING SHOULD BE RETURNED TO:

Timothy R. Conway  
Edward B. Keidan  
Conway & Mrowiec  
300 South Wacker Drive, Suite 601  
Chicago, Illinois 60606  
Phone: (312) 692-1700  
Fax: (312) 692-1701  
Firm ID No.: 31737

Property: portions of the Illinois State Toll Highway Authority's right of way from the intersection of the Tri-State Tollway (I-294/I-94), continuing to the intersection with the Northwest Tollway (I-90), and from the intersection of I-294/I-394 north to approximately Cermak Road in Cook County, Illinois.



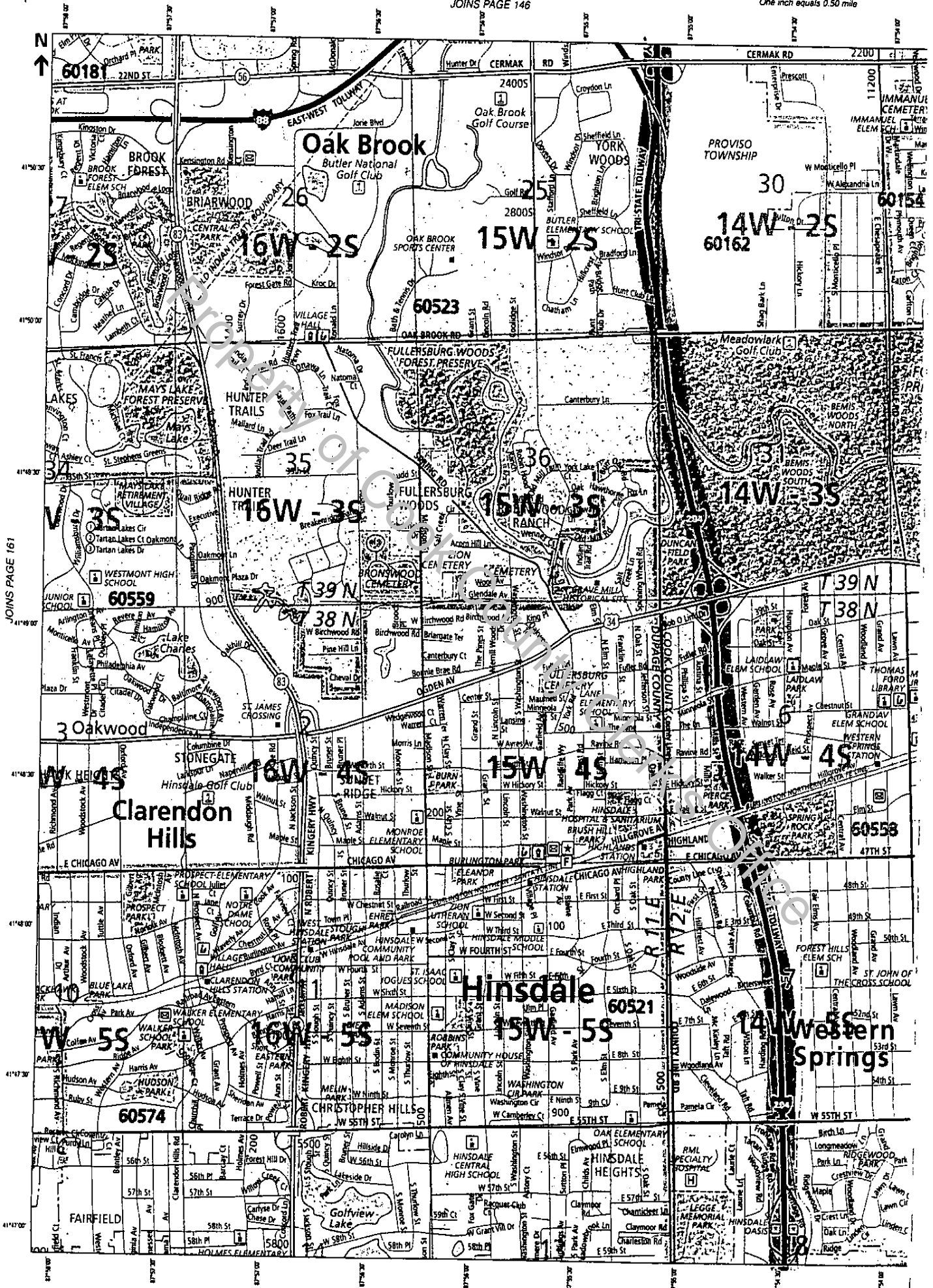

N  
↑

JOINS PAGE 161

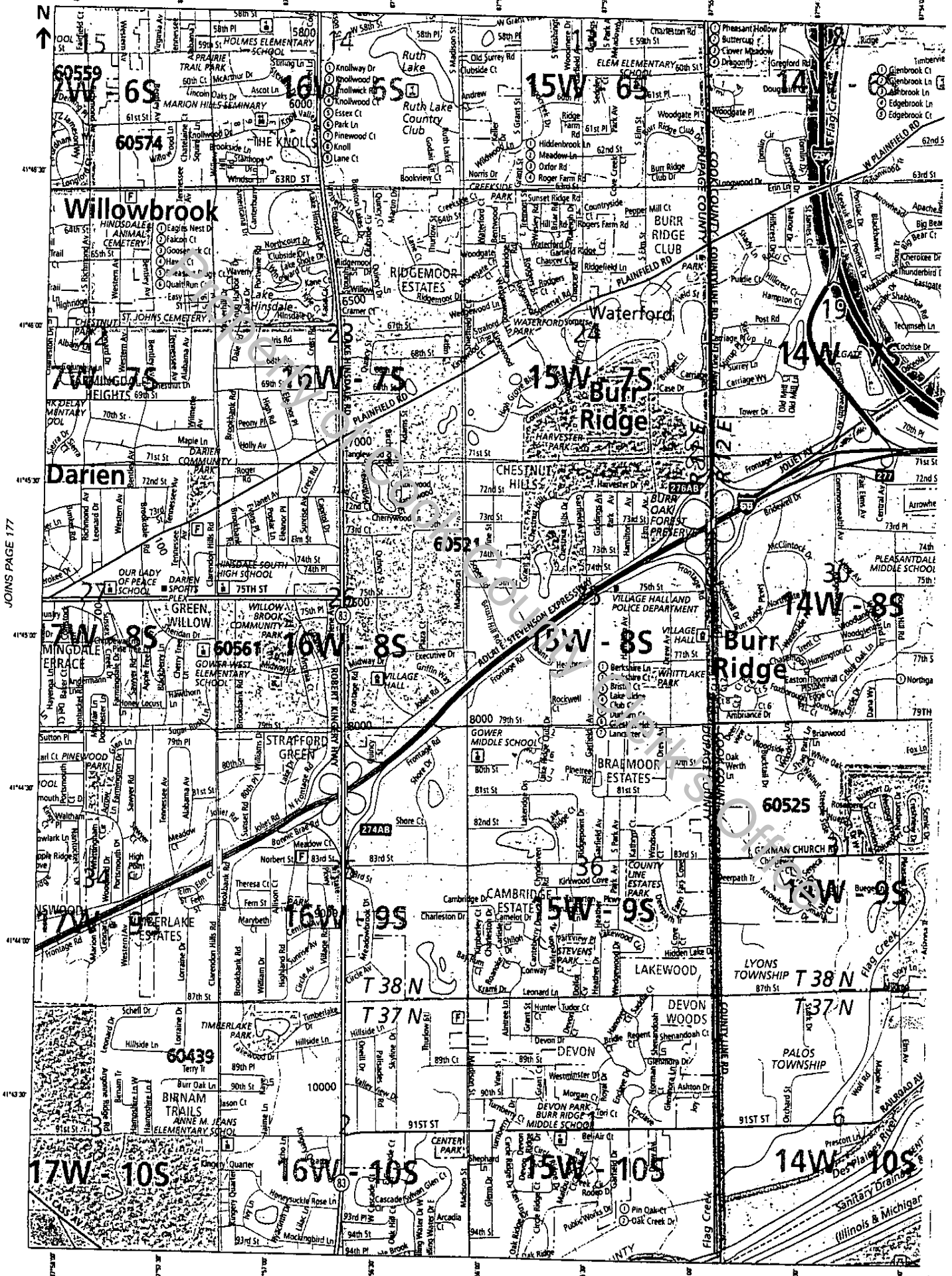

JOINS PAGE 177



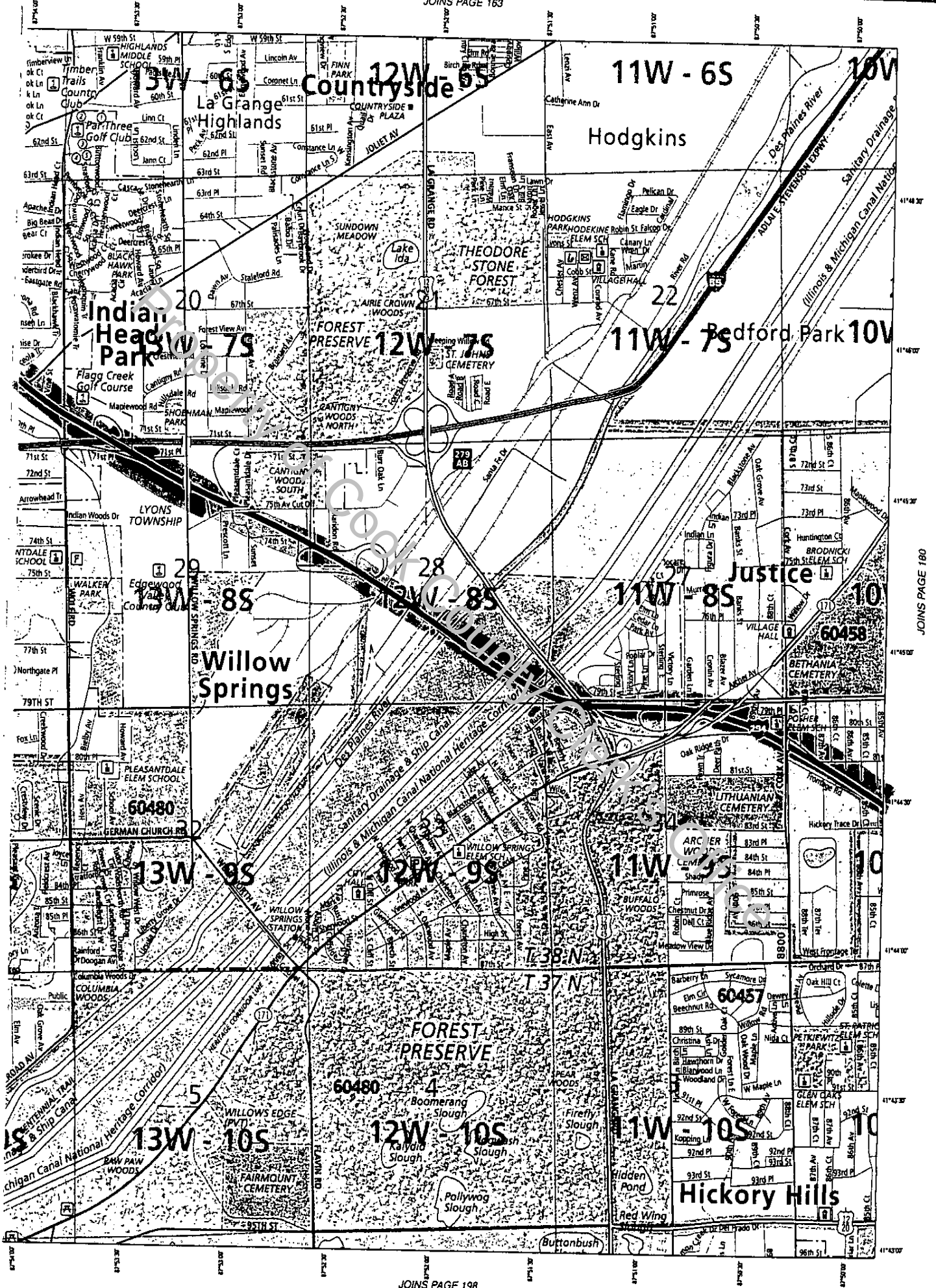

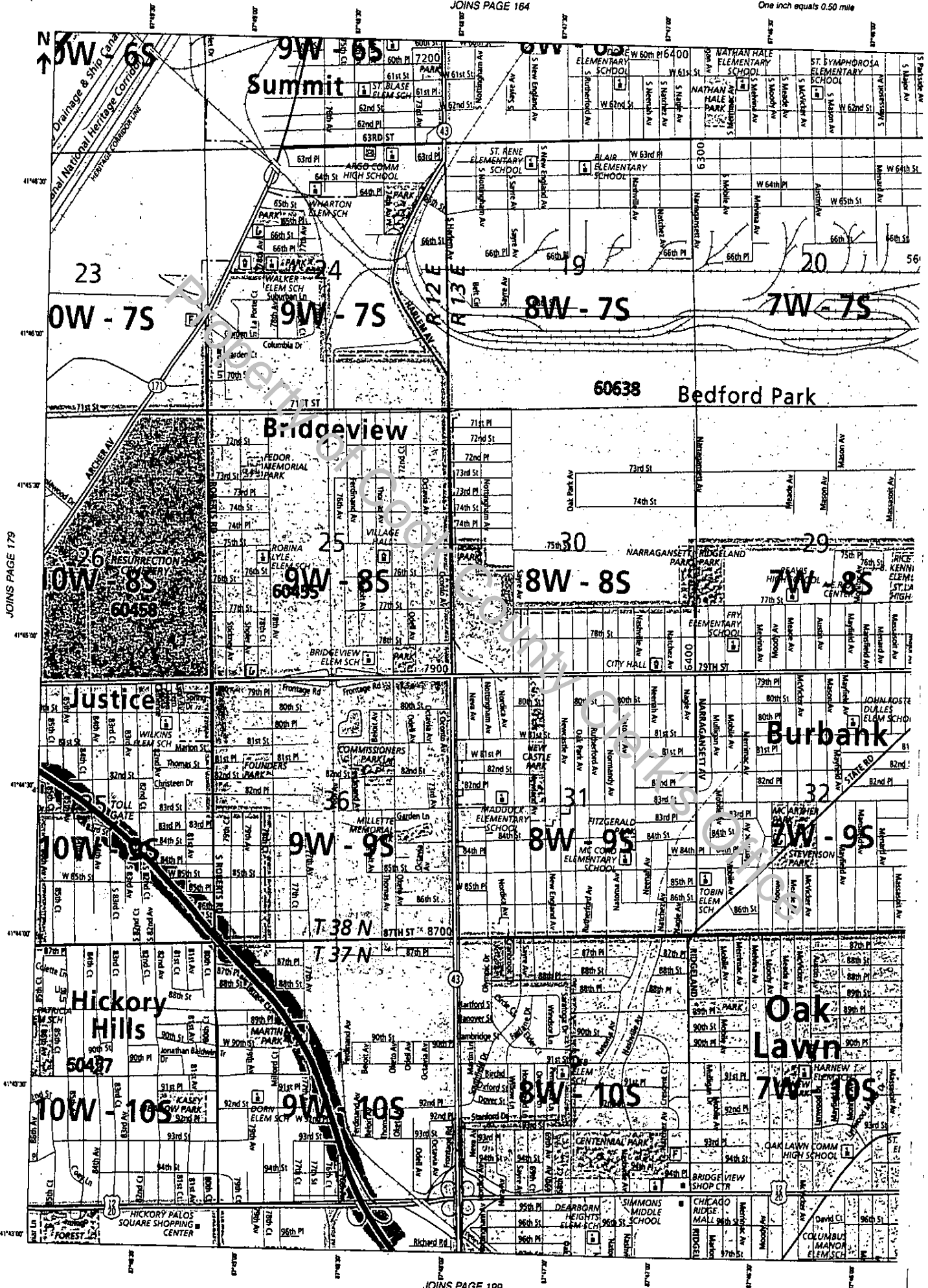



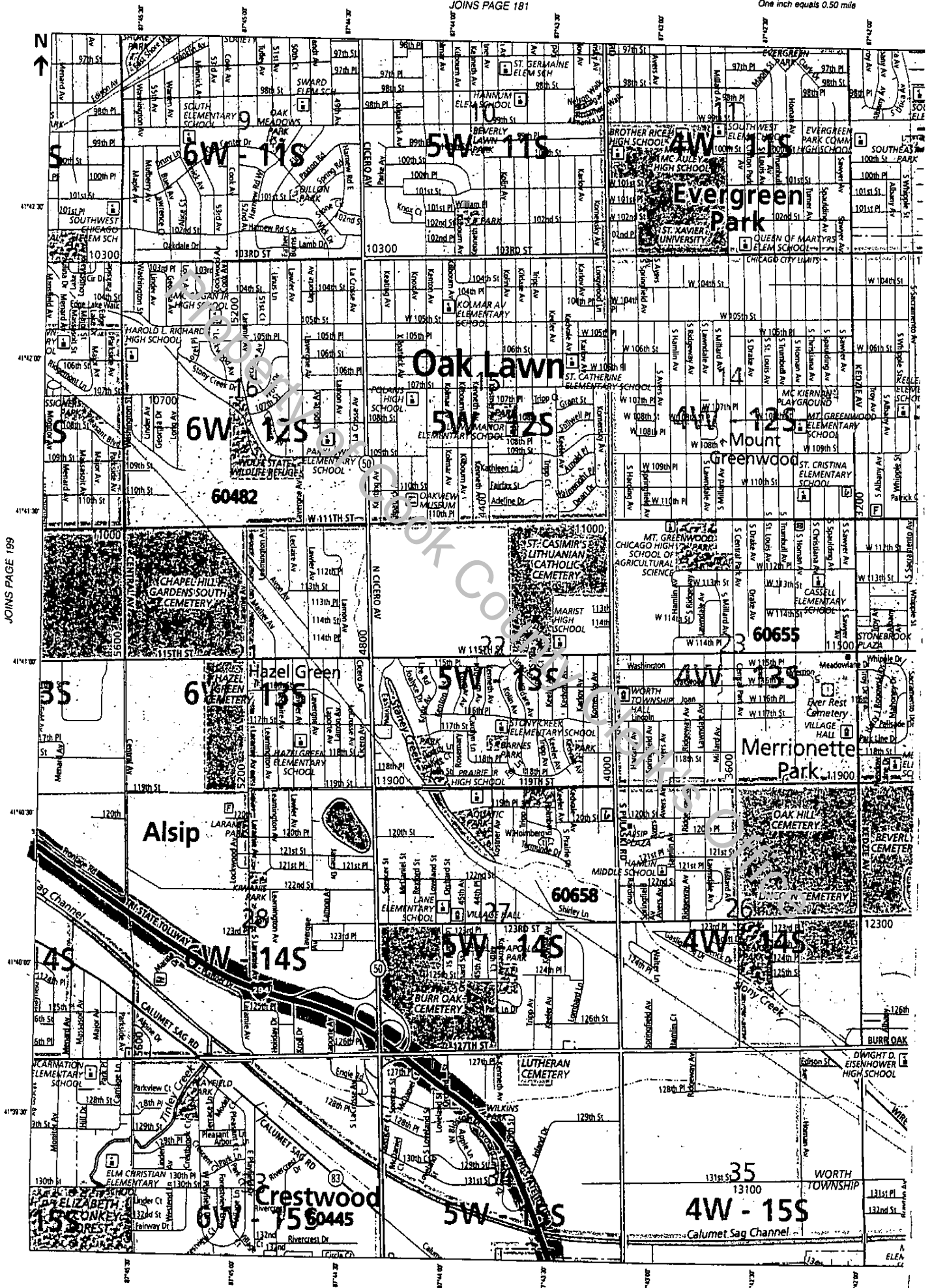

JOINS PAGE 199

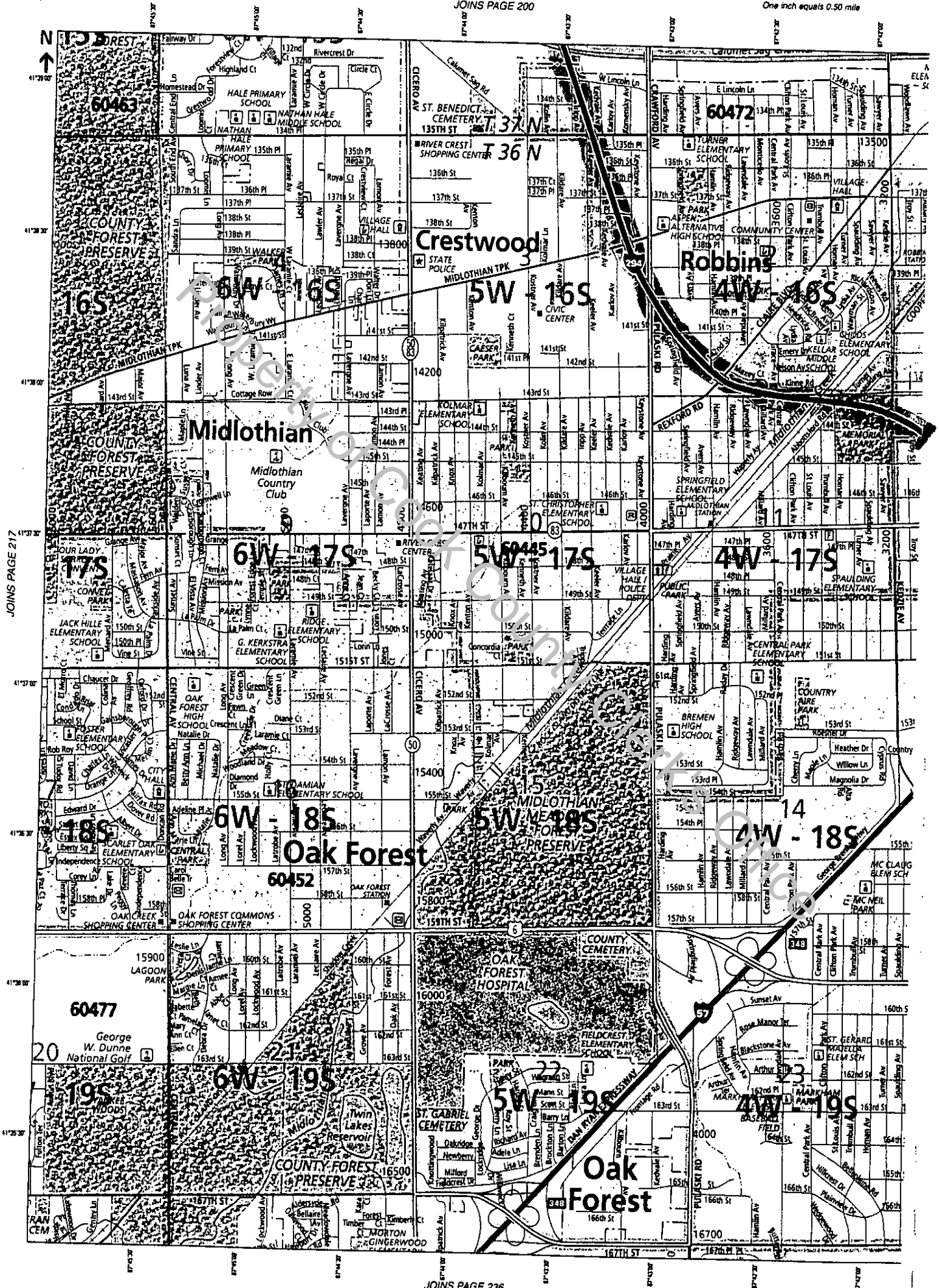

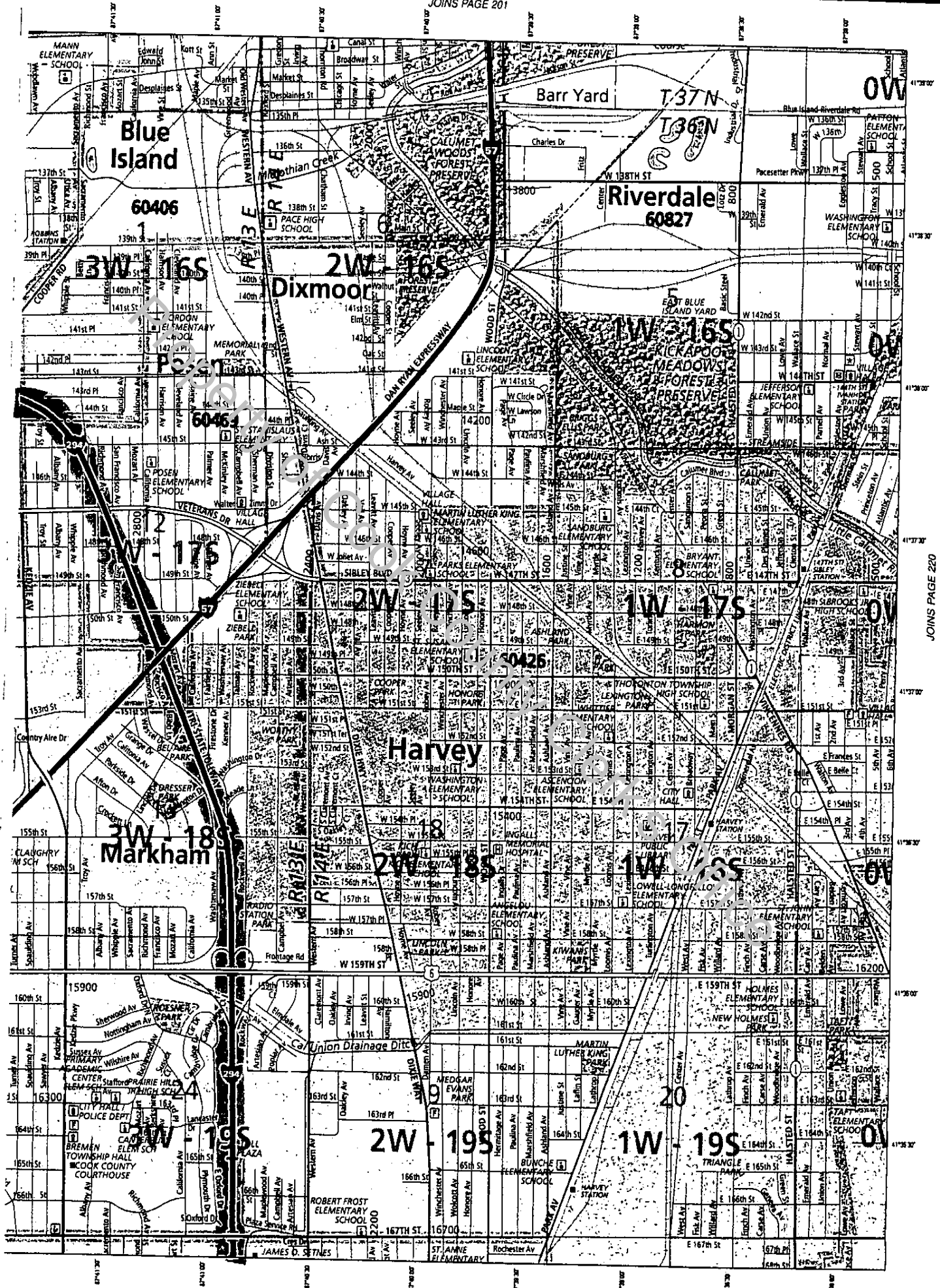

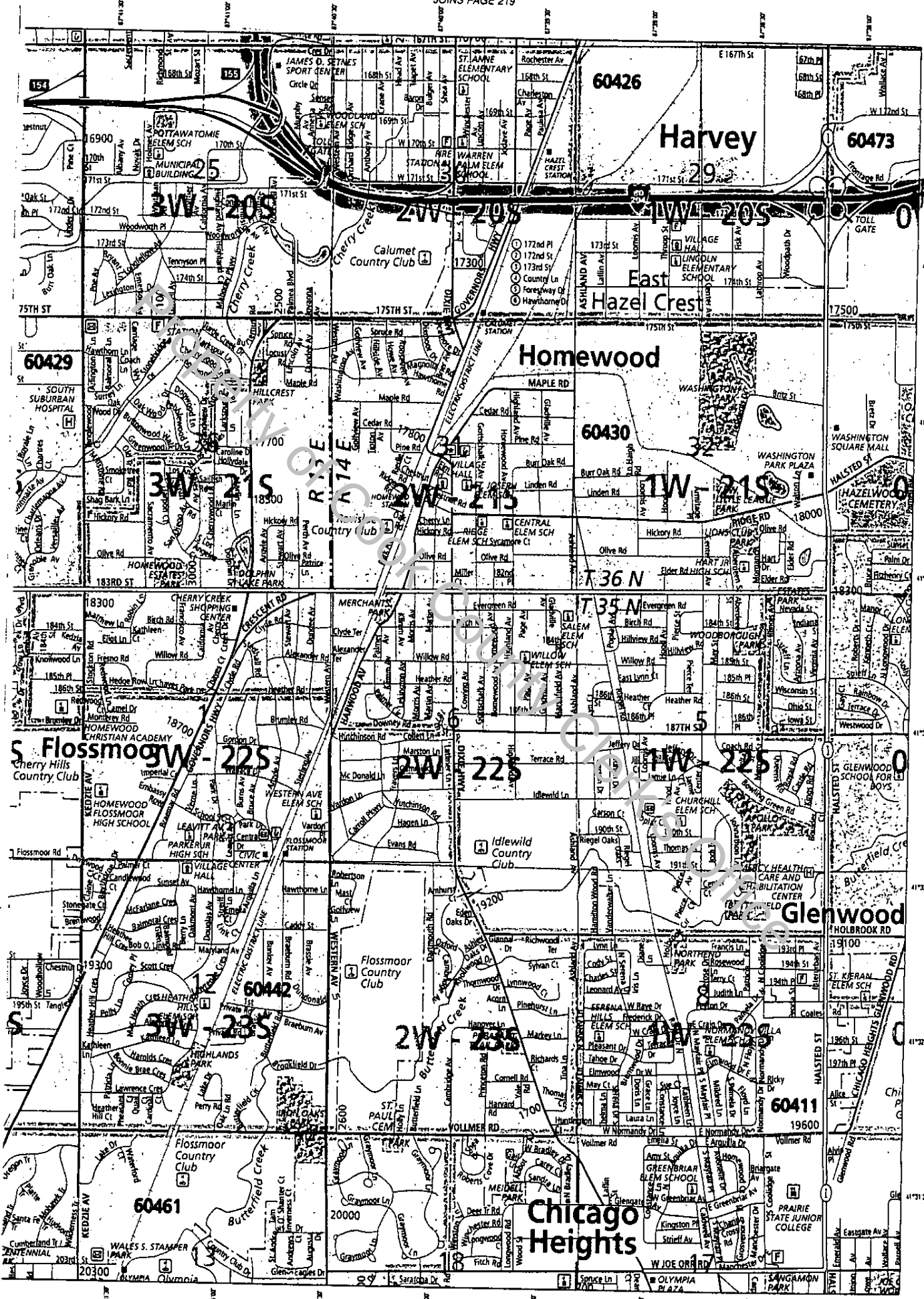

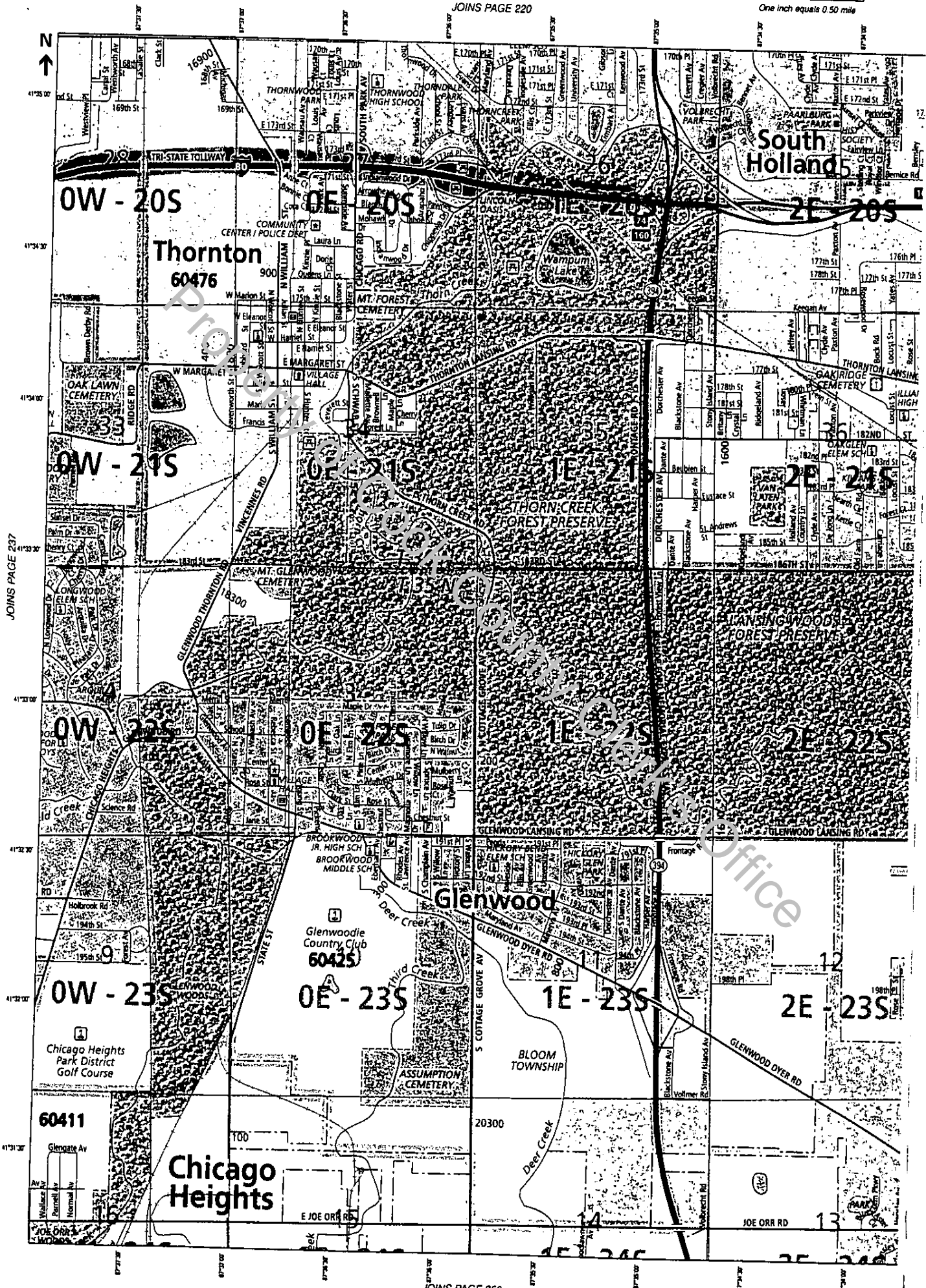

JOINS PAGE 237



01/10/1993

0 0.25 0.50 mile  
One inch equals 0.50 mile

JOINS PAGE 70

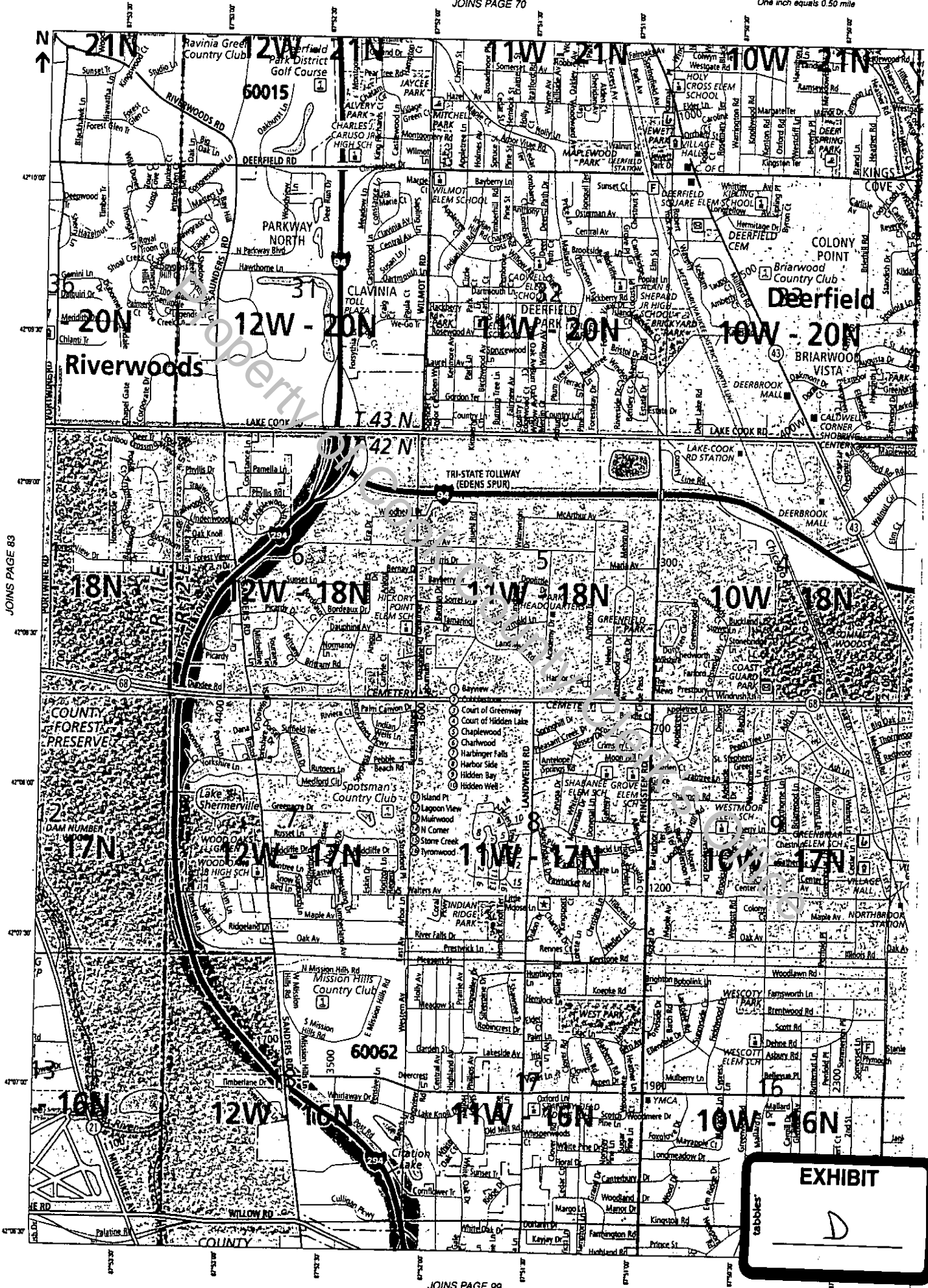

**EXHIBIT**  
D  
tabbles

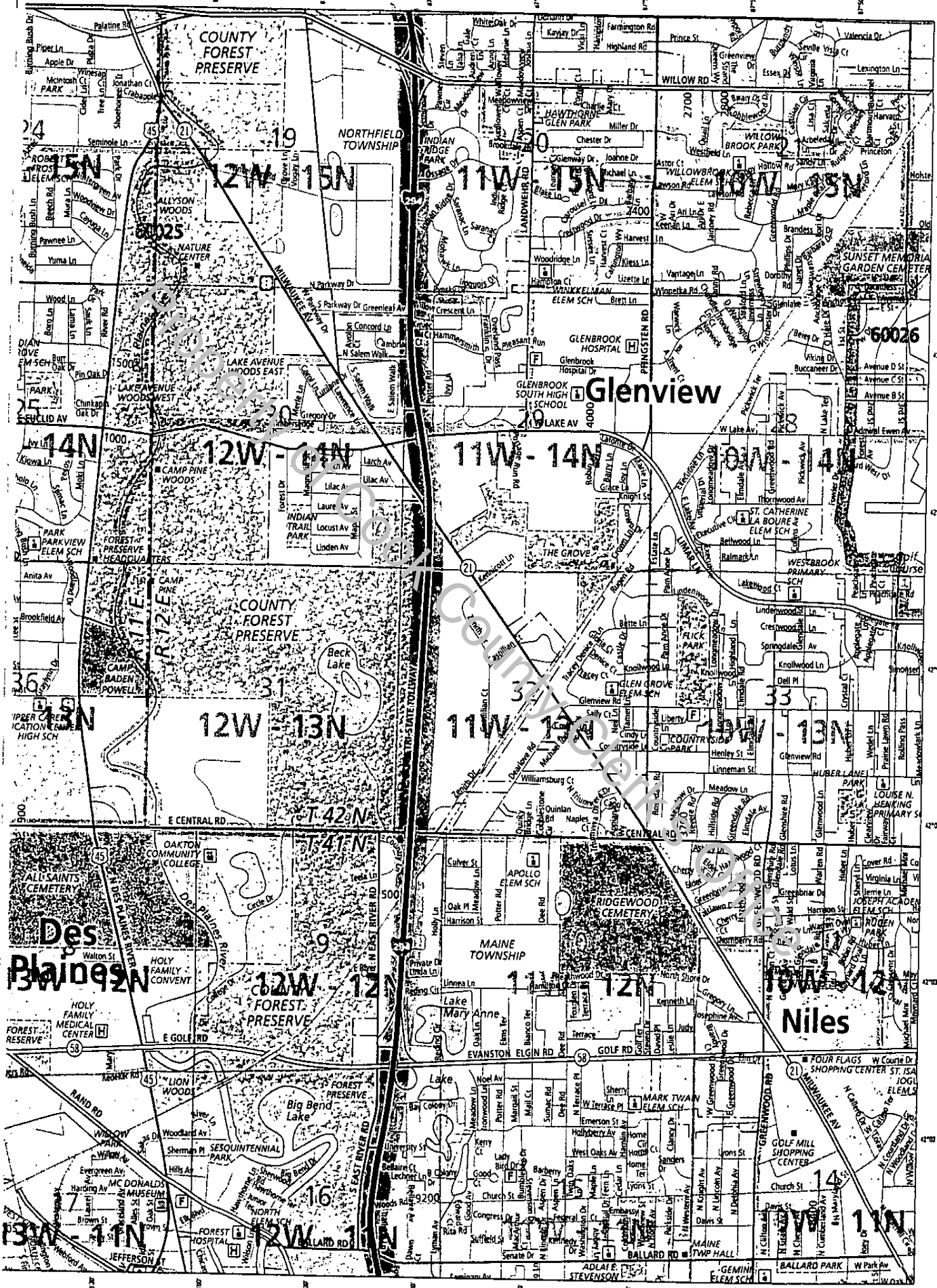

JOINS PAGE 100

