

UNOFFICIAL COPY

0011027529

8709/0173 30 001 Page 1 of 6

2001-11-01 15:47:09

Cook County Recorder 31.50



Document: 6380

When recorded mail to:
AZ Lien Services, Inc.
P.O. Box 36750
Tucson, AZ 85740

**NOTICE AND CLAIM OF LIEN FOR
LABOR, SERVICES, MATERIAL, MACHINERY
FIXTURES, AND/OR TOOLS**

STATE OF **ILLINOIS**

COUNTY OF **COOK**

) ss.
)

The claimant, **NORCRAFT COMPANIES LLC, 3020 Denmark Avenue, Suite 100, Eagan, MN 55121**, claims a lien for labor, services, material, machinery, fixtures, and/or tools as follows:

1. The description of the property to be charged with the lien is:
2448 SOUTHPORT UNIT #2, CHICAGO, ILLINOIS.
TAX NO. 14-29-320-022-0000. THE SOUTH 16 FEET OF LOT 4 AND THE NORTH 9 FEET OF LOT 5 IN BLOCK 1 IN WILLIAM HAHNE'S SUBDIVISION OF THE SOUTHEAST 1/4 OF THE SOUTHWEST 1/4 OF THE SOUTHWEST 1/4 OF SECTION 29, TOWNSHIP 40 NORTH, RANGE 14, EAST OF THE THIRD PRINCIPAL MERIDIAN IN COOK COUNTY, ILLINOIS.
2. The name of the owner or reputed owner of the property is reported to be:
2448 SOUTHPORT, L.L.C., an Illinois Limited Liability Company,
c/o MATANKY REALTY, 1332 North Halsted Street, Suite 300,
Chicago, Illinois 60622 .
3. The person by whom the claimant was employed or to whom claimant furnished material is **ABILITY CONSTRUCTION**, 1332 North Halsted Street #300,
Chicago, Illinois 60622 .

UNOFFICIAL COPY

11027529

Page 2

Document: 6380

4. The name of the Original Contractor or reputed Contractor is reported to be: **ABILITY CONSTRUCTION**, 1332 North Halsted Street #300, Chicago, Illinois 60622 .
5. Claimant provided the following labor, materials, equipment, services, management, and/or work of improvement: **KITCHEN AND BATH CABINETS AND INSTALLATION**
6. The last date said labor, materials, equipment, services, management, and/or work of improvement was provided or performed was: **July 2, 2001**
7. Claimant demands, after deducting just credits and offsets, the sum of **\$5,640.00** and interest and lien fee.
8. The undersigned is the claimant or the agent for the claimant and has knowledge of the facts.

Claimant: **NORCRAFT COMPANIES LLC**



Agent for: **NORCRAFT COMPANIES LLC**

Subscribed, Sworn to and Acknowledged before me this 23rd day of October, 2001

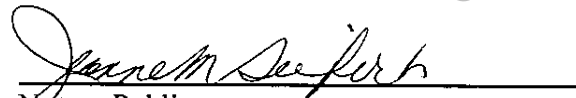
Notary Public

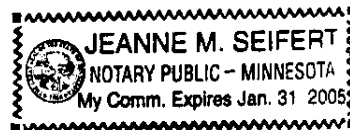

VERIFICATION

I, the undersigned, state that I am the Agent for the claimant in the foregoing claim; that I have reviewed the claim and know the contents thereof; that the same is true; and that it contains, among other things, a correct statement of the demand. I declare under penalty of perjury that the foregoing is true and correct.

Executed on the 23rd day of October, 2001

at Dakota County, State of Minnesota

Claimant: NORCRAFT COMPANIES LLC

[Signature]
Agent for: NORCRAFT COMPANIES LLC

Property of Cook County Clerk's Office



Rebill to
 Norcraft Companies LLC.
 P.O. Box 71381
 Chicago, IL 60694-1381
 Phone (651) 234-3300
 Fax (651) 234-3398

11027529

INVOICE DATE: 6/26/01
 INVOICE NUMBER: 0462237
 CARRIER: WILD
 SALES ORDER: 595541 - 00
 PLANT: Newton, KS
 INTERNAL CODES: 0924TCM0930 01.290210

S 901119
 o 1 ABILITY CONSTRUCTION
 d 1332 N HALSTED #300
 t CHICAGO IL 60622
 o

S 901121
 h 1 ABILITY CONSTRUCTION
 i C/O PREMIER DELIVERY
 P 8455 SO 77TH AVE
 t BRIDGEVIEW IL 60455
 o

Ship to PO#: ANSERT-T
 Sold to PO#:
 Ship date: 6/26/01

Tag Line: 2448 SOUTHPORT #2
 Terms: NET 30 DAYS
 Due date: 7/26/01

QTY	PRODUCT	UNIT PRICE	AMOUNT	QTY	PRODUCT	UNIT PRICE	AMOUNT
	KITCHEN AND BATH CABINETS						
	Product subtotal		5308.23				
	+ Freight		56.79				
	+ Tax		335.31				
	+ Drop charge		.00				
	= Net amount		<u>5700.33</u>				

F.O.B. FACTORY ALL RISK OF LOSS IN TRANSIT IS BUYERS

UNOFFICIAL COPY

Kitchen Proposal:

11027529

Deeke Construction Services

Owner: MIKE AND DAWN ANSERT

Address: 2448 SOUTHPORT UNIT 2

Builder: Ability Construction

Type of Work: Cabinets & Vanities

Scope of Work

We propose to supply and install cabinets and vanities in the above mentioned property as follows:

Base kitchen per contract:

GROUP 2 - 42" - \$ 4,214.

Approved Extras:

Per Attached: \$ 1,426.

Terms of Purchase: 30 days upon completion or upon closing of unit, which ever occurs first.

Prepared By:



Total Amount:

\$ 5,640.

Accepted By:



Date:

UNOFFICIAL COPY

11027529

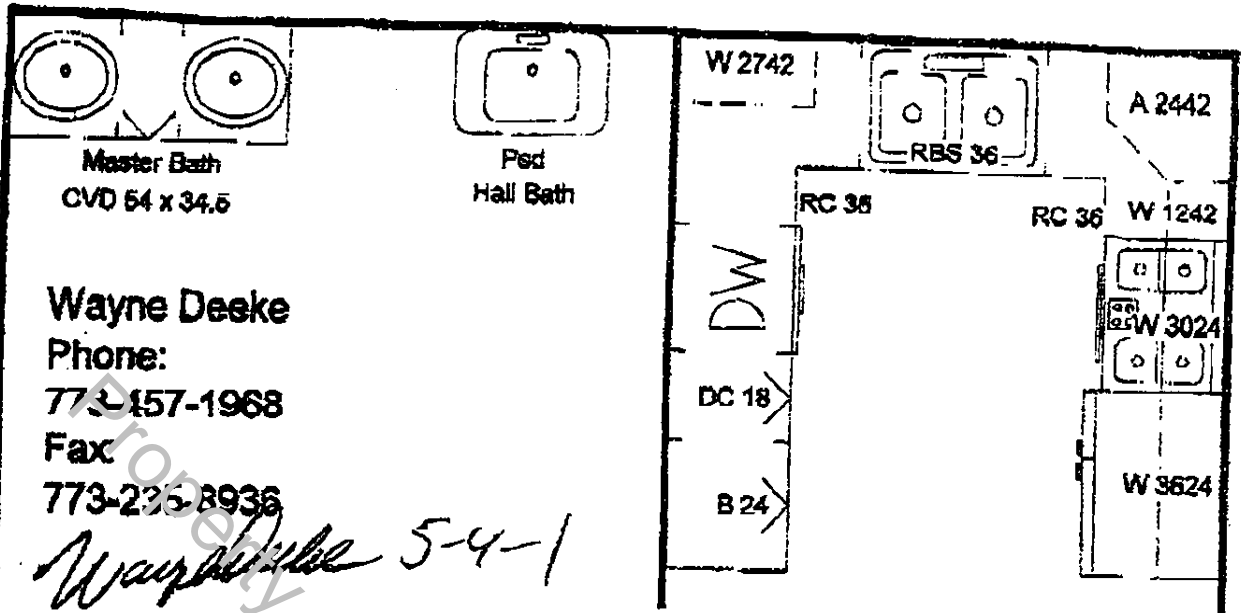

Master Bath
CVD 64 x 34.5

Ped
Hall Bath

Wayne Deeske
Phone:
773-157-1968
Fax:
773-235-8936

Wayne Deeske 5-4-1

Owner: MIKE & DAWN ANSERT

Address: 2448 Southport Unit 2

Kitchen & Bath: Maple Style: Hartford Color: Natural

Extras:

- 1 - Add two RC 36 base cabinets as shown - \$ 820.
- 2 - Add one DC 18 all drawer cabinet - \$ 166.
- 3 - Add Plan B uppers as shown - \$ 640.

*W 2742
A 2442
W 3624*

TOTAL EXTRAS: \$ 1,426.

Alterations to basic design may result in charges from builder or affected contractors.

Approved:

Mike Ansert

Date:

5/4/08