

CLAIM OF LIEN



STATE OF IL
COUNTY OF Cook

BEFORE ME, the undersigned Notary Public, personally appeared Tiny Tim Tree Service LLC who duly sworn says that he is the owner whose address is 310 Busse, Park Ridge and that in accordance with a contract with _____ lienor furnished labor, services or materials consisting of: TREE WORK

on the following described real property in Cook County, State

of _____, described as 2231 Webster, Des Plaines and owned by _____ of a total value of _____ dollars

(\$ 725) of which there remains unpaid \$ 725, and furnished the first of the items on _____, 2001, by _____, and (if required) that the lienor served copies of the notice on the contractor on _____, 2001, by _____, and on the subcontractor 12 on Dec, 2001, by _____.

TINY TIM TREE SERVICE LLC
Lienor

By Paul J. Earlin, MEMBER
Agent P. J. Earlin

On Dec 12, 2001 before me, JAY GOLDENBERG, personally appeared PAUL EARLIN, personally known to me (or proved to me on the basis of satisfactory evidence) to be the person(s) whose name(s) is/are subscribed to the within instrument and acknowledged to me that he/she/they executed the same in his/her/their authorized capacity(ies), and that by his/her/their signature(s) on the instrument the person(s), or the entity upon behalf of which the person(s) acted, executed the instrument.

WITNESS my hand and official seal.

Signature Jay Goldenberg

Affiant _____ Known _____ Produced ID _____

Type of ID drivers license



TINY TIM TREE SERVICE LLC
310 BUSSE #166
PARK RIDGE, IL 60068

(Seal)

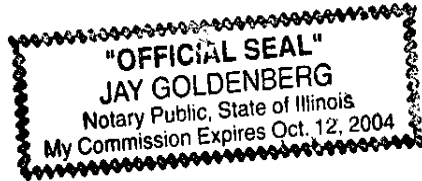

UNOFFICIAL COPY

Property of Cook County Clerk's Office

2234 S. WEBSTER DES PLAINES, IL

09	29	302	014		95	22017
AREA	SUB AREA	BLOCK	PARCEL	UNIT	WARRANT	CODE

OFFICE OF THE CLERK OF COOK COUNTY, ILLINOIS
 PERMANENT REAL ESTATE INDEX NUMBER AND LEGAL DESCRIPTION

AREA SUB-AREA BLOCK PARCEL UNIT
 09- 29- 302- 014

TAX CODE
 22017

1994 DIVISION
 BLOCK PARCEL

1962 DIVISION
 BLOCK PARCEL

1964 DIVISION

1969 DIVISION
 BLOCK PARCEL

S 100FT N 300FT W 220FT E 880FT SW 1/4
 SW 1/4 .506ACS

29 41 12

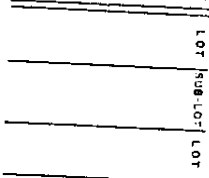

Property of Cook County Clerk's Office

UNOFFICIAL COPY

Property of Cook County Clerk's Office