

UNOFFICIAL COPY

0020516949

2002-05-06 14:47:31

2002-05-06 14:47:31

Cook County Recorder

23.00



**AFFIDAVIT AND CERTIFICATE OF CORRECTION**

STATE OF ILLINOIS )  
 ) SS  
COUNTY OF DUPAGE )

THIS IS TO CERTIFY, THAT I, JAMES L HARPOLE, ILLINOIS PROFESSIONAL LAND SURVEYOR NO. 3190, AM THE SURVEYOR OF RECORD OF WEST POINT MEADOWS UNIT 3, BEING A SUBDIVISION OF PART OF THE SOUTHWEST QUARTER OF THE NORTHEAST QUARTER OF FRACTIONAL SECTION 6, TOWNSHIP 35 NORTH, RANGE 13 EAST OF THE THIRD PRINCIPAL MERIDIAN, LYING NORTH OF THE INDIAN BOUNDARY LINE, ACCORDING TO THE PLAT THEREOF RECORDED MAY 1, 2002 AS DOCUMENT NUMBER 0020498536, IN COOK COUNTY, ILLINOIS.

THE PURPOSE OF THIS CERTIFICATE IS TO:

CHANGE THE LOT NUMBERS LYING EAST OF LOT 33-1 AS FOLLOWS:  
LOT 33-2 READS AS 34-2  
LOT 33-3 READS AS 34-3  
LOT 33-4 READS AS 34-4  
LOT 33-5 READS AS 34-5

31-06-202-019

I HEREBY AUTHORIZE WEST POINT BUILDERS TO RECORD THIS DOCUMENT.

GIVEN UNDER MY HAND AND SEAL IN LISLE, ILLINOIS THIS 2nd DAY OF MAY, A.D., 2002

23  
5.602

*James L Harpole*  
JAMES L. HARPOLE, P.L.S. NO. 3190  
THE BALSAMO/OLSON ENGINEERING COMPANY - LISLE, IL

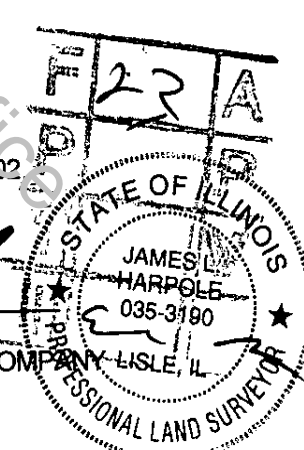

PREPARED BY AND RETURN TO:  
JAMES L. HARPOLE, P.L.S.  
THE BALSAMO/OLSON ENGINEERING COMPANY  
4906 MAIN STREET, SUITE 101  
LISLE, ILLINOIS 60532

UNOFFICIAL COPY

Property of Cook County Clerk's Office



