



Doc#: 0336518134
Eugene "Gene" Moore Fee: \$98.00
Cook County Recorder of Deeds
Date: 12/31/2003 03:12 PM Pg: 1 of 38

This document prepared by and after recording return to:
Adam R. Walker, Esq.
Assistant Corporation Counsel
Department of Law
121 North LaSalle Street, Room 600
Chicago, IL 60602

SUBORDINATION AGREEMENT

This Subordination Agreement ("Agreement") is made and entered into as of December 29, 2003 between the City of Chicago by and through its Department of Planning and Development (the "City"), and Column Financial, Inc., a Delaware corporation (the "Lender").

RECITALS

WHEREAS, Eport 600, L.L.C., a Delaware limited liability company, Eport 600 Riverwalk Owner, L.L.C., a Delaware limited liability company, and Eport 600 Property Owner, L.L.C., a Delaware limited liability company (collectively, the "Developer"), has purchased in fee simple certain properties ("Properties") consisting of those parcels set forth and legally described on Exhibit A hereto. On the Properties and certain rights-of-way adjacent to or in the vicinity thereof, Developer shall commence and complete, or cause to be commenced and completed: (a) the construction and/or rehabilitation of several large mixed-use facilities, totaling approximately 1,700,000 square feet (the "Facility") and related parking facilities (the "Related Parking"), (b) certain enclosed arcade and open air riverwalk improvements (the "Riverwalk Improvements"), (c) certain street and streetscape improvements (the "Street/Streetscape Improvements"), and (d) if approved in writing by the City, perform a certain tenant buildout (the "Tenant Buildout Sub-Project"). The Facility, Related Parking, Riverwalk Improvements, Street/Streetscape Improvements and, if constructed, the Tenant Buildout Sub-Project, are collectively referred to herein as the "Project;" and

 Box 333

UNOFFICIAL COPY

WHEREAS, as part of obtaining financing for the Project, the Developer has granted a certain Mortgage and Security Agreement dated as of March 8, 2001, pursuant to which the Lender has made a loan to the Developer in an amount not to exceed \$130,000,000 (the "Loan"), which Loan is evidenced by a Mortgage Note executed by the Developer in favor of the Lender (the "Note"), and the repayment of the Loan is secured by, among other things, certain liens and encumbrances on the Properties and other property of the Developer pursuant to the following: (i) said Mortgage and Security Agreement dated as of March 8, 2001 and recorded on March 12, 2001 in the office of the Cook County Recorder of Deeds as document number 0010192868 made by the Developer to the Lender, as amended by that certain Modification of Mortgage and Security Agreement dated as of December 21, 2001 by and between the Developer and the Lender, recorded on October 28, 2003 as document number 0330118003 in the office of the Cook County Recorder of Deeds and by that certain Second Modification of Mortgage and Security Agreement and other Loan Documents dated as of October 9, 2003 by and between the Developer and the Lender, recorded on October 28, 2003 as document number 0330118004 in the office of the Cook County Recorder of Deeds; and (ii) Assignment of Leases and Rents recorded on March 12, 2001 in the office of the Cook County Recorder of Deeds as document number 0010192869 made by the Developer to the Lender (all such agreements referred to above and otherwise relating to the Loan referred to herein collectively as the "Loan Documents");

WHEREAS, the Developer desires to enter into a certain Redevelopment Agreement dated the date hereof with the City in order to obtain additional financing for the Project (the "Redevelopment Agreement," referred to herein along with various other agreements and documents related thereto as the "City Agreements");

WHEREAS, pursuant to the Redevelopment Agreement, the Developer will agree to be bound by certain covenants expressly running with the Properties, as set forth in Sections 8.02, 8.06, 8.14 and 8.21 of the Redevelopment Agreement (the "City Encumbrances");

WHEREAS, the City has agreed to enter into the Redevelopment Agreement with the Developer as of the date hereof, subject, among other things, to (a) the execution by the Developer of the Redevelopment Agreement and the recording thereof as an encumbrance against the Property; and (b) the agreement by the Lender to subordinate its liens under the Loan Documents to the City Encumbrances; and

NOW, THEREFORE, for good and valuable consideration, the receipt, adequacy and sufficiency of which are hereby acknowledged, the Lender and the City agree as hereinafter set forth:

1. Subordination. All rights, interests and claims of the Lender in the Property pursuant to the Loan Documents are and shall be subject and subordinate to the City Encumbrances, provided, however, that if Lender shall succeed to the interest of Developer or any successor to Developer and becomes holder of the Loan Documents,

(i) in no event shall Lender or its successors or assigns have any liability under the Redevelopment Agreement or the City Agreements prior to the date Lender or such

UNOFFICIAL COPY

successor or assign shall succeed to the rights of Developer under the Redevelopment Agreement or the City Agreements, nor any liability for claims which the City might have had against Developer, nor shall Lender be liable with respect to any indemnifications given by Developer and, in any event, Lender and its successors or assigns shall have no personal liability as successor to Developer and the City shall look only to the estate and property of Lender or its successors or assigns in the Project for the satisfaction of remedies for the collection of a judgment (or other judicial process) requiring the payment of money in the event of any default by Lender or its successors or assigns as successor Developer under the Redevelopment Agreement and the City Agreements, and no other property or assets of Lender or its successors or assigns shall be subject to levy, execution or other enforcement procedure for the satisfaction of the City's remedies under or with respect to the Redevelopment Agreement and the City Agreements, the relationship of Developer and City thereunder or Developer's use or occupancy of any part of the Project, and

(ii) notwithstanding anything to the contrary set forth in this Agreement, neither Lender nor any of its successors or assigns shall have any liability under, or be subject to any rights of the City against Developer under Section 7.03 of the Redevelopment Agreement except to the extent Lender may have acquired title to a portion of the Project and be obligated to complete the Project pursuant to the terms hereof and in no event shall Lender be liable to the City under Section 7.03(c) of the Redevelopment Agreement except to the extent of City Funds actually received by Lender from the City (other than payments with respect to City Note A or City Note C).

Lender shall in no event have any liability for the payment, performance or completion of any obligations of Developer which are required to be paid, performed or made by Developer under the Redevelopment Agreement unless Lender shall have acquired title to all or a portion of the Developer Properties, in which case Lender's liability shall be limited as set forth in Section 16.03(b) of the Redevelopment Agreement. Notwithstanding anything to the contrary contained herein or in the Redevelopment Agreement, upon acquisition by Lender of any portion of the Developer Properties, Lender shall not be bound by any provision of the Redevelopment Agreement if Lender shall return to the City any amounts disbursed by the City on account of the City Notes, other than City Note A or City Note C, and terminate or cause to be terminated the City's obligation to make future payments under the City Notes (other than City Note A or City Note C).

Except as expressly set forth in the foregoing paragraphs of this Section 1, the Redevelopment Agreement shall be subject and subordinate to the Loan Documents. Nothing herein, however, shall be deemed to limit the Lender's right to receive, and the Developer's ability to make, payments and prepayments of principal and interest on the Note, or to exercise its rights pursuant to the Loan Documents except as provided herein.

2. Estoppel. In order to induce Lender to consent to the Redevelopment Agreement, the City hereby certifies to Lender as follows: (a) the only remedy available to the City for Developer's failure to complete the Housing Related Additional Projects (as defined in the

UNOFFICIAL COPY

Redevelopment Agreement) is the reduction of amounts payable under City Note B pursuant to Section 4.03 of the Redevelopment Agreement; and (b) Developer can elect, in its own discretion, whether or not to complete the Project Sub-Project 114 under the heading Tenant Buildout on Exhibit B-2 (but completion thereof is subject to the prior written approval of the City), and failure to do so will not jeopardize Developer's ability to enjoy its other rights and benefits under the Redevelopment Agreement.

3. City Notes. Until Lender has notified the City in writing that the Loan has been paid in full, the City shall, upon the written direction of Developer to the City: (a) upon issuance of any of the City Notes, deliver the original such City Notes to or as directed in writing by Lender, and (b) make all payments on account of the City Notes by wire transfer to Lender or as otherwise directed by Lender in writing.

4. Notice of Default. Subject to the provisions of Section 16 of the Redevelopment Agreement, the Lender shall use reasonable efforts to give to the City, and the City shall use reasonable efforts to give to the Lender, (a) copies of any notices of default which it may give to the Developer with respect to the Project pursuant to the Loan Documents or the City Agreements, respectively, and (b) copies of waivers, if any, of the Developer's default in connection therewith. Under no circumstances shall the Developer or any third party be entitled to rely upon the agreement provided for herein.

5. Waivers. No waiver shall be deemed to be made by the City or the Lender of any of their respective rights hereunder, unless the same shall be in writing, and each waiver, if any, shall be a waiver only with respect to the specific instance involved and shall in no way impair the rights of the City or the Lender in any other respect at any other time.

6. Governing Law; Binding Effect. This Agreement shall be interpreted, and the rights and liabilities of the parties hereto determined, in accordance with the internal laws and decisions of the State of Illinois, without regard to its conflict of laws principles, and shall be binding upon and inure to the benefit of the respective successors and assigns of the City and the Lender.

7. Section Titles; Plurals. The section titles contained in this Agreement are and shall be without substantive meaning or content of any kind whatsoever and are not a part of the agreement between the parties hereto. The singular form of any word used in this Agreement shall include the plural form.

8. Notices. Any notice required hereunder shall be in writing and addressed to the party to be notified as follows:

If to the City:

City of Chicago Department of Planning and
Development
121 North LaSalle Street, Room 1000
Chicago, Illinois 60602
Attention: Commissioner

UNOFFICIAL COPY

With a copy to: City of Chicago Department of Law
121 North LaSalle Street, Room 600
Chicago, Illinois 60602
Attention: Finance and Economic
Development Division

If to the Lender: Column Financial, Inc.
11 Madison Avenue
New York, NY 10010
Attn: Edmund Taylor

with a copy to: Column Financial, Inc.
11 Madison Avenue
New York, NY 10010
Attn: Adam Raboy

with a copy to: Column Financial, Inc.
One Madison Avenue
New York, NY 10010
Legal and Compliance Department
Attn: Pamela L. McCormack, Esq.
Re: Eport Loan/Adam Raboy

with a copy to: Column Financial, Inc.
227 West Monroe Street - #4310
Chicago, IL 60606
Attn: Timothy J. Meyer

or to such other address as either party may designate for itself by notice. Notice shall be deemed to have been duly given (i) if delivered personally or otherwise actually received, (ii) if sent by overnight delivery service, (iii) if mailed by first class United States mail, postage prepaid, registered or certified, with return receipt requested, or (iv) if sent by facsimile with facsimile confirmation of receipt (with duplicate notice sent by United States mail as provided above). Notice mailed as provided in clause (iii) above shall be effective upon the expiration of three (3) business days after its deposit in the United States mail. Notice given in any other manner described in this paragraph shall be effective upon receipt by the addressee thereof; provided, however, that if any notice is tendered to an addressee and delivery thereof is refused by such addressee, such notice shall be effective upon such tender.

9. Counterparts. This Agreement may be executed in two or more counterparts, each of which shall constitute an original and all of which, when taken together, shall constitute one instrument.

[The remainder of this page is intentionally left blank.]

UNOFFICIAL COPY

IN WITNESS WHEREOF, this Subordination Agreement has been signed as of the date first written above.

COLUMN FINANCIAL, INC., a Delaware corporation

By *Timothy J. Walker*
Its: SENIOR VICE PRESIDENT

CITY OF CHICAGO

By: _____
Its: Commissioner, Department of Planning and Development

ACKNOWLEDGED AND AGREED TO

_____, 2003

EPORT 600, L.L.C., a Delaware limited liability company

By: AG Asset Manager, Inc., its manager

By: _____
Name: _____
Title: _____

EPORT 600 RIVERWALK OWNER, L.L.C., a Delaware limited liability company

By: Eport 600, L.L.C., its managing member

By: AG Asset Manager, Inc., its manager

By: _____
Name: _____
Title: _____

EPORT 600 PROPERTY OWNER, L.L.C., a Delaware limited liability company

By: Eport 600, L.L.C., its managing member

By: AG Asset Manager, Inc., its manager

By: _____
Name: _____
Title: _____

Property of Cook County Clerk's Office

UNOFFICIAL COPY

IN WITNESS WHEREOF, this Subordination Agreement has been signed as of the date first written above.

COLUMN FINANCIAL, INC., a Delaware corporation

By _____
Its:

CITY OF CHICAGO

By: *Maria M. Bell*
Its: Commissioner, Department of
Planning and Development

ACKNOWLEDGED AND AGREED TO

_____, 2003

EPORT 600, L.L.C., a Delaware limited liability company

By: AG Asset Manager, Inc., its manager

By: _____
Name: _____
Title: _____

EPORT 600 RIVERWALK OWNER, L.L.C., a Delaware limited liability company

By: Eport 600, L.L.C., its managing member

By: AG Asset Manager, Inc., its manager

By: _____
Name: _____
Title: _____

EPORT 600 PROPERTY OWNER, L.L.C., a Delaware limited liability company

By: Eport 600, L.L.C., its managing member

By: AG Asset Manager, Inc., its manager

By: _____
Name: _____
Title: _____

Property of Cook County Clerk's Office

UNOFFICIAL COPY

IN WITNESS WHEREOF, this Subordination Agreement has been signed as of the date first written above.

COLUMN FINANCIAL, INC., a Delaware corporation

By _____
Its:

CITY OF CHICAGO

By: _____
Its: Commissioner, Department of
Planning and Development

ACKNOWLEDGED AND AGREED TO

December 29, 200?

EPOR 600, L.L.C., a Delaware limited liability company

By: AG Asset Manager, Inc., its manager

By: Andrew Jacobs
Name: ANDREW JACOBS
Title: VICE PRESIDENT

EPOR 600 RIVERWALK OWNER, L.L.C., a Delaware limited liability company

By: Epor 600, L.L.C., its managing member
By: AG Asset Manager, Inc., its manager

By: Andrew Jacobs
Name: ANDREW JACOBS
Title: VICE PRESIDENT

EPOR 600 PROPERTY OWNER, L.L.C., a Delaware limited liability company

By: Epor 600, L.L.C., its managing member
By: AG Asset Manager, Inc., its manager

By: Andrew Jacobs
Name: ANDREW JACOBS
Title: VICE PRESIDENT

Property of Cook County Clerk's Office

UNOFFICIAL COPY

STATE OF ILLINOIS)
) SS
COUNTY OF COOK)

I, Jane E Price, a notary public in and for the said County, in the State aforesaid, DO HEREBY CERTIFY THAT Tim Meyer, personally known to me to be the Sr V.P of Column Financial, Inc., a Delaware corporation, and personally known to me to be the same person whose name is subscribed to the foregoing instrument, appeared before me this day in person and acknowledged that he/she signed, sealed and delivered said instrument, pursuant to the authority given to him/her by Lender, as his/her free and voluntary act and as the free and voluntary act of the Lender, for the uses and purposes therein set forth.

GIVEN under my hand and notarial seal this 23 day of Dec, 2003

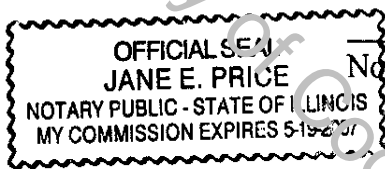

Jane E Price

Notary Public

My Commission Expires 5/19/2007

(SEAL)

Property of Cook County Clerk's Office

UNOFFICIAL COPY

STATE OF ILLINOIS)
) SS
COUNTY OF COOK)

I, the undersigned, a notary public in and for the County and State aforesaid, DO HEREBY CERTIFY THAT Alicia Matus Bay personally known to me to be the _____ Commissioner of the Department of Planning and Development of the City of Chicago, Illinois (the "City") and personally known to me to be the same person whose name is subscribed to the foregoing instrument, appeared before me this day in person and acknowledged that as such _____ Commissioner, (s)he signed and delivered the said instrument pursuant to authority, as his/her free and voluntary act, and as the free and voluntary act and deed of said City, for the uses and purposes therein set forth.

GIVEN under my hand and notarial seal this 18th day of December, 2004.

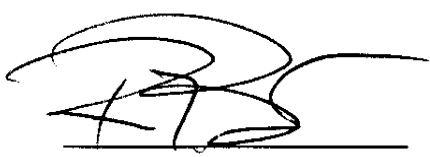

Notary Public

(SEAL)



Property of Cook County Clerk's Office

UNOFFICIAL COPY

EXHIBIT A - LEGAL DESCRIPTION of PROPERTIES

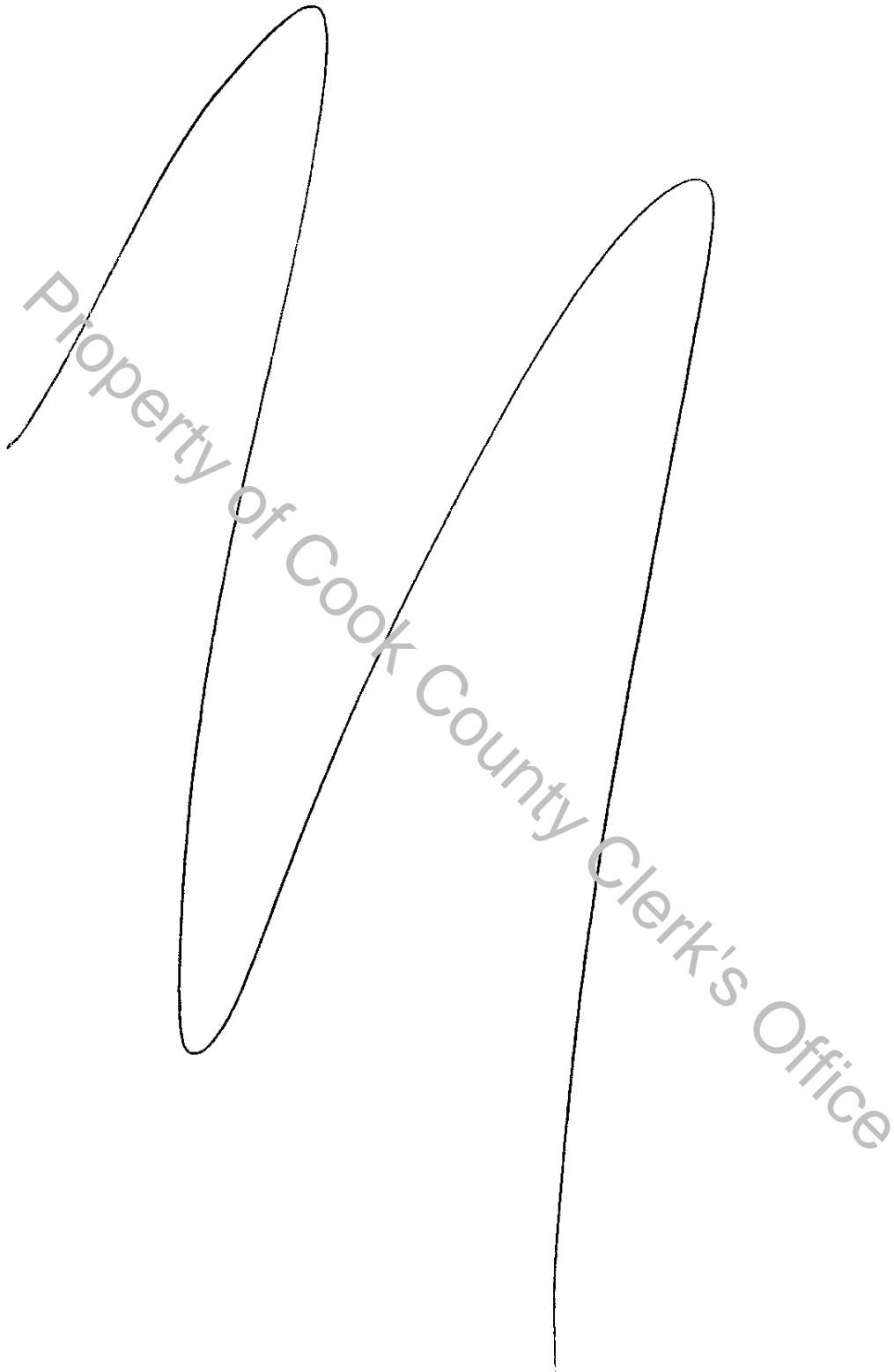

UNOFFICIAL COPY

TIF REDEVELOPMENT AGREEMENT LEGAL DESCRIPTIONS

EPORT 600 PROPERTY OWNER PARCELS SITES E-1 AND PART OF E-2

SOUTH CATALOGUE BUILDING AND RIVER THROUGH 5TH LEVELS OF NORTH CATALOGUE BUILDING

[Note: Parcels 3, 4 and 5 comprise the R-2, 3 – 4, and the 5th Floor levels of portions of the NCAT. These PINs are a result of a tax division of PIN 17-04-300-007. The 007 PIN initially included the NCAT and extended further north to include the area where the 950 N. Kingsbury parking garage is located. A Tax Division Petition of the 007 PIN was filed in 2000 for 2001 Taxes payable in 2002]

PARCEL 3: (Northern Catalog Building)

THAT PART OF LOT 23 TOGETHER WITH LOTS 24, 25, 26 IN BLOCK 96, IN ELSTON'S ADDITION TO CHICAGO, LYING EAST OF DOCK LINE OF THE NORTH BRANCH OF THE CHICAGO RIVER, A SUBDIVISION IN THE WEST HALF OF THE SOUTHWEST QUARTER OF SECTION 4, TOWNSHIP 39 NORTH, RANGE 14 EAST OF THE THIRD PRINCIPAL MERIDIAN, IN COOK COUNTY, ILLINOIS, TOGETHER WITH THE NORTHEASTERLY HALF OF THE VACATED NORTH BRANCH STREET LYING BETWEEN THE SOUTHWESTERLY LINE OF NORTH KINGSBURY STREET AND THE NORTH BRANCH OF THE CHICAGO RIVER, LYING BELOW AN ELEVATION OF 52.00 FEET, CITY OF CHICAGO DATUM, AND BOUNDED AND DESCRIBED AS FOLLOWS: BEGINNING ON THE SOUTHWESTERLY LINE OF NORTH KINGSBURY STREET AT A POINT 504.17 FEET NORTHWESTERLY OF THE INTERSECTION OF SAID SOUTHWESTERLY LINE OF NORTH KINGSBURY STREET AND THE WEST LINE OF NORTH LARRABEE STREET, BEING ALSO THE CENTER LINE OF THE VACATED NORTH BRANCH STREET; THENCE NORTHWESTERLY, ALONG SAID SOUTHWESTERLY LINE OF NORTH KINGSBURY STREET, 312.67 FEET TO THE EXTENSION NORTHEASTERLY OF THE NORTHWESTERLY FACE OF 5 CONCRETE COLUMNS; THENCE SOUTHWESTERLY AT AN ANGLE OF 89 DEGREES, 49 MINUTES, 14 SECONDS TO THE RIGHT WITH THE LAST DESCRIBED LINE, AND ALONG SAID NORTHWESTERLY FACE, 105.08 FEET TO THE NORTHERLY EXTENSION OF THE WEST FACE OF A BRICK WALL; THENCE SOUTHEASTERLY, ALONG THE WESTERLY FACE OF SAID BRICK WALL, AT AN ANGLE OF 90 DEGREES, 18 MINUTES, 00 SECONDS TO THE RIGHT WITH THE LAST DESCRIBED LINE, A DISTANCE OF 1.67 FEET TO THE NORTHWESTERLY FACE OF A 1.00 FOOT BRICK WALL; THENCE SOUTHWESTERLY, ALONG THE NORTHWESTERLY FACE OF A 1.00 FOOT BRICK WALL, PERPENDICULAR TO THE LAST DESCRIBED LINE, A DISTANCE OF 145.64 FEET, TO THE NORTHEASTERLY DOCK LINE OF THE NORTH BRANCH OF THE CHICAGO RIVER; THENCE SOUTHEASTERLY, AT AN ANGLE OF 97 DEGREES, 42 MINUTES, 19 SECONDS TO THE RIGHT WITH THE LAST DESCRIBED LINE AND ALONG SAID NORTHEASTERLY DOCK LINE, 105.62 FEET; THENCE TO THE CENTER LINE OF SAID VACATED NORTH BRANCH STREET; THENCE SOUTHEASTERLY AT AN ANGLE OF 120 DEGREES, 04 MINUTES, 05 SECONDS TO THE RIGHT WITH THE LAST DESCRIBED LINE, AND ALONG SAID CENTERLINE, 335.74 FEET TO THE SOUTHWESTERLY LINE OF NORTH KINGSBURY STREET, AND THE POINT OF BEGINNING.

P.I.N. 17-04-300-023-0000

UNOFFICIAL COPY

AND

PARCEL 4: (Northern Catalog Building)

THAT PART OF LOT 23 TOGETHER WITH LOTS 24, 25, 26 IN BLOCK 96, IN ELSTON'S ADDITION TO CHICAGO, LYING EAST OF DOCK LINE OF THE NORTH BRANCH OF THE CHICAGO RIVER, A SUBDIVISION IN THE WEST HALF OF THE SOUTHWEST QUARTER OF SECTION 4, TOWNSHIP 39 NORTH, RANGE 14 EAST OF THE THIRD PRINCIPAL MERIDIAN, IN COOK COUNTY, ILLINOIS, TOGETHER WITH THE NORTHEASTERLY HALF OF THE VACATED NORTH BRANCH STREET LYING BETWEEN THE SOUTHWESTERLY LINE OF NORTH KINGSBURY STREET AND THE NORTH BRANCH OF THE CHICAGO RIVER, LYING ABOVE AN ELEVATION OF 52.00 FEET AND LYING BELOW AN ELEVATION OF 77.00 FEET, CITY OF CHICAGO DATUM, AND BOUNDED AND DESCRIBED AS FOLLOWS: BEGINNING ON THE SOUTHWESTERLY LINE OF NORTH KINGSBURY STREET AT A POINT 504.17 FEET NORTHWESTERLY OF THE INTERSECTION OF SAID SOUTHWESTERLY LINE OF NORTH KINGSBURY STREET AND THE WEST LINE OF NORTH LARRABEE STREET, BEING ALSO THE CENTER LINE OF THE VACATED NORTH BRANCH STREET; THENCE NORTHWESTERLY, ALONG SAID SOUTHWESTERLY LINE OF NORTH KINGSBURY STREET, 312.67 FEET TO THE EXTENSION NORTHEASTERLY OF THE NORTHWESTERLY FACE OF 5 CONCRETE COLUMNS; THENCE SOUTHWESTERLY AT AN ANGLE OF 89 DEGREES, 49 MINUTES, 14 SECONDS TO THE RIGHT WITH THE LAST DESCRIBED LINE, AND ALONG SAID NORTHWESTERLY FACE, 105.06 FEET TO THE NORTHERLY EXTENSION OF THE WEST FACE OF A BRICK WALL; THENCE SOUTHEASTERLY, ALONG THE WESTERLY FACE OF SAID BRICK WALL, AT AN ANGLE OF 90 DEGREES, 18 MINUTES, 00 SECONDS TO THE RIGHT WITH THE LAST DESCRIBED LINE, A DISTANCE OF 1.67 FEET TO THE NORTHWESTERLY FACE OF A 1.00 FOOT BRICK WALL; THENCE SOUTHWESTERLY, ALONG THE NORTHWESTERLY FACE OF A 1.00 FOOT BRICK WALL, PERPENDICULAR TO THE LAST DESCRIBED LINE, A DISTANCE OF 145.64 FEET TO THE NORTHEASTERLY DOCK LINE OF THE NORTH BRANCH OF THE CHICAGO RIVER; THENCE SOUTHEASTERLY, AT AN ANGLE OF 97 DEGREES, 42 MINUTES, 19 SECONDS TO THE RIGHT WITH THE LAST DESCRIBED LINE AND ALONG SAID NORTHEASTERLY DOCK LINE, 105.62 FEET; THENCE TO THE CENTER LINE OF SAID VACATED NORTH BRANCH STREET; THENCE SOUTHEASTERLY AT AN ANGLE OF 120 DEGREES, 04 MINUTES, 05 SECONDS TO THE RIGHT WITH THE LAST DESCRIBED LINE, AND ALONG SAID CENTERLINE, 335.74 FEET TO THE SOUTHWESTERLY LINE OF NORTH KINGSBURY STREET, AND THE POINT OF BEGINNING.

P.I.N. 17-04-300-024-0000

AND

PARCEL 5: (Northern Catalog Building)

THAT PART OF LOT 23 TOGETHER WITH LOTS 24, 25, 26 IN BLOCK 96, IN ELSTON'S ADDITION TO CHICAGO, LYING EAST OF DOCK LINE OF THE NORTH BRANCH OF THE CHICAGO RIVER, A SUBDIVISION IN THE WEST HALF OF THE SOUTHWEST QUARTER OF SECTION 4, TOWNSHIP 39 NORTH, RANGE 14 EAST OF THE THIRD PRINCIPAL MERIDIAN, IN COOK COUNTY, ILLINOIS, TOGETHER WITH THE NORTHEASTERLY HALF OF THE VACATED NORTH BRANCH STREET LYING BETWEEN THE SOUTHWESTERLY LINE OF NORTH KINGSBURY STREET AND THE NORTH BRANCH OF THE CHICAGO RIVER, LYING

UNOFFICIAL COPY

ABOVE AN ELEVATION OF 77.00 FEET AND LYING BELOW AN ELEVATION OF 89.50 FEET, CITY OF CHICAGO DATUM, AND BOUNDED AND DESCRIBED AS FOLLOWS: BEGINNING ON THE SOUTHWESTERLY LINE OF NORTH KINGSBURY STREET AT A POINT 504.17 FEET NORTHWESTERLY OF THE INTERSECTION OF SAID SOUTHWESTERLY LINE OF NORTH KINGSBURY STREET AND THE WEST LINE OF NORTH LARRABEE STREET, BEING ALSO THE CENTER LINE OF THE VACATED NORTH BRANCH STREET; THENCE NORTHWESTERLY, ALONG SAID SOUTHWESTERLY LINE OF NORTH KINGSBURY STREET, 312.67 FEET TO THE EXTENSION NORTHEASTERLY OF THE NORTHWESTERLY FACE OF 5 CONCRETE COLUMNS; THENCE SOUTHWESTERLY AT AN ANGLE OF 89 DEGREES, 49 MINUTES, 14 SECONDS TO THE RIGHT WITH THE LAST DESCRIBED LINE, AND ALONG SAID NORTHWESTERLY FACE, 105.08 FEET TO THE NORTHERLY EXTENSION OF THE WEST FACE OF A BRICK WALL; THENCE SOUTHEASTERLY, ALONG THE WESTERLY FACE OF SAID BRICK WALL, AT AN ANGLE OF 90 DEGREES, 18 MINUTES, 00 SECONDS TO THE RIGHT WITH THE LAST DESCRIBED LINE, A DISTANCE OF 1.67 FEET TO THE NORTHWESTERLY FACE OF A 1.00 FOOT BRICK WALL; THENCE SOUTHWESTERLY, ALONG THE NORTHWESTERLY FACE OF A 1.00 FOOT BRICK WALL, PERPENDICULAR TO THE LAST DESCRIBED LINE, A DISTANCE OF 145.64 FEET, TO THE NORTHEASTERLY DOCK LINE OF THE NORTH BRANCH OF THE CHICAGO RIVER; THENCE SOUTHEASTERLY, AT AN ANGLE OF 97 DEGREES, 42 MINUTES, 19 SECONDS TO THE RIGHT WITH THE LAST DESCRIBED LINE AND ALONG SAID NORTHEASTERLY DOCK LINE, 105.62 FEET; THENCE TO THE CENTER LINE OF SAID VACATED NORTH BRANCH STREET; THENCE SOUTHEASTERLY AT AN ANGLE OF 120 DEGREES, 04 MINUTES, 05 SECONDS TO THE RIGHT WITH THE LAST DESCRIBED LINE, AND ALONG SAID CENTERLINE, 335.74 FEET TO THE SOUTHWESTERLY LINE OF NORTH KINGSBURY STREET, AND THE POINT OF BEGINNING.

P.I.N. 17-04-300-025-0000

AND

[Note: Parcels 6, 7 and 8 are the result of a division of PIN 17-04-300-020-0000 which was created out of PIN 17-04-300-008-0000. Parcels 6, 7 and 8 comprise the R-2, 3, 4, and the 5th Floor levels of certain portions of the NCAT.]

PARCEL 6: (Northern Catalog Building)

THAT PART OF LOTS 1, 2, 3, AND 4 IN ELSTON'S ADDITION TO CHICAGO, LYING EAST OF DOCK LINE OF THE NORTH BRANCH OF THE CHICAGO RIVER, A SUBDIVISION IN THE WEST HALF OF THE SOUTHWEST QUARTER OF SECTION 4, TOWNSHIP 39 NORTH, RANGE 14 EAST OF THE THIRD PRINCIPAL MERIDIAN, IN COOK COUNTY, ILLINOIS, TOGETHER WITH THE SOUTHWESTERLY HALF OF THE VACATED NORTH BRANCH STREET LYING BETWEEN THE SOUTHWESTERLY LINE OF NORTH KINGSBURY STREET AND THE NORTH BRANCH OF THE CHICAGO RIVER, LYING BELOW AN ELEVATION OF 52.00, CITY OF CHICAGO DATUM, AND BOUNDED AND DESCRIBED AS FOLLOWS: BEGINNING ON THE SOUTHWESTERLY LINE OF NORTH KINGSBURY STREET AT A POINT 415.68 FEET NORTHWESTERLY OF THE INTERSECTION OF SAID SOUTHWESTERLY LINE OF NORTH KINGSBURY STREET AND THE WEST LINE OF NORTH LARRABEE STREET, BEING ALSO THE EXTENSION NORTHEASTERLY OF THE CENTERLINE OF A 1.00 FOOT BRICK WALL; THENCE NORTHWESTERLY, ALONG SAID SOUTHWESTERLY LINE OF NORTH KINGSBURY STREET, 88.49 FEET TO THE CENTER LINE OF SAID VACATED NORTH BRANCH STREET; THENCE NORTHWESTERLY AT AN ANGLE OF 127 DEGREES, 53 MINUTES, 38 SECONDS TO

UNOFFICIAL COPY

THE RIGHT WITH THE LAST DESCRIBED LINE, AND ALONG SAID CENTER LINE, 335.74 FEET, TO THE NORTHEASTERLY DOCK LINE OF THE NORTH BRANCH OF THE CHICAGO RIVER; THENCE SOUTHEASTERLY, AT AN ANGLE OF 59 DEGREES, 55 MINUTES, 55 SECONDS TO THE RIGHT WITH THE LAST DESCRIBED LINE AND ALONG SAID NORTHEASTERLY DOCK LINE, 35.99 FEET; THENCE CONTINUING ALONG SAID NORTHEASTERLY DOCK LINE, AT AN ANGLE OF 173 DEGREES, 36 MINUTES, 50 SECONDS TO THE RIGHT WITH THE LAST DESCRIBED LINE, 252.69 FEET; THENCE CONTINUING ALONG SAID NORTHEASTERLY DOCK LINE, AT AN ANGLE OF 176 DEGREES, 02 MINUTES, 23 SECONDS TO RIGHT WITH THE LAST DESCRIBED LINE, 2.15 FEET; SOUTHEASTERLY AT AN ANGLE OF 122 DEGREES, 31 MINUTES, 41 SECONDS TO THE RIGHT WITH THE LAST DESCRIBED LINE, 9.55 FEET TO THE CENTERLINE OF A 1.00 FOOT BRICK WALL; THENCE NORTHEASTERLY AT AN ANGLE OF 149 DEGREES, 54 MINUTES, 45 SECONDS TO THE RIGHT WITH THE LAST DESCRIBED LINE, AND ALONG SAID CENTERLINE, 267.99 FEET TO THE SOUTHWESTERLY LINE OF NORTH KINGSBURY AND POINT OF BEGINNING.

P.I.N. 17-04-300-027-0000

AND

PARCEL 7: (Northern Catalog Building)

THAT PART OF LOTS 1, 2, 3, AND 4 IN FLSTON'S ADDITION TO CHICAGO, LYING EAST OF DOCK LINE OF THE NORTH BRANCH OF THE CHICAGO RIVER, A SUBDIVISION IN THE WEST HALF OF THE SOUTHWEST QUARTER OF SECTION 4, TOWNSHIP 39 NORTH, RANGE 14 EAST OF THE THIRD PRINCIPAL MERIDIAN, IN COOK COUNTY, ILLINOIS, TOGETHER WITH THE SOUTHWESTERLY HALF OF THE VACATED NORTH BRANCH STREET LYING BETWEEN THE SOUTHWESTERLY LINE OF NORTH KINGSBURY STREET AND THE NORTH BRANCH OF THE CHICAGO RIVER, LYING ABOVE AN ELEVATION OF 52.00 FEET AND LYING BELOW AN ELEVATION OF 77.00 FEET, CITY OF CHICAGO DATUM, AND BOUNDED AND DESCRIBED AS FOLLOWS: BEGINNING ON THE SOUTHWESTERLY LINE OF NORTH KINGSBURY STREET AT A POINT 415.68 FEET NORTHWESTERLY OF THE INTERSECTION OF SAID SOUTHWESTERLY LINE OF NORTH KINGSBURY STREET AND THE WEST LINE OF NORTH LARRABEE STREET, BEING ALSO THE EXTENSION NORTHEASTERLY OF THE CENTERLINE OF A 1.00 FOOT BRICK WALL; THENCE NORTHWESTERLY, ALONG SAID SOUTHWESTERLY LINE OF NORTH KINGSBURY STREET, 88.49 FEET TO THE CENTER LINE OF SAID VACATED NORTH BRANCH STREET; THENCE NORTHWESTERLY AT AN ANGLE OF 127 DEGREES, 53 MINUTES, 38 SECONDS TO THE RIGHT WITH THE LAST DESCRIBED LINE, AND ALONG SAID CENTER LINE, 335.74 FEET, TO THE NORTHEASTERLY DOCK LINE OF THE NORTH BRANCH OF THE CHICAGO RIVER; THENCE SOUTHEASTERLY, AT AN ANGLE OF 59 DEGREES, 55 MINUTES, 55 SECONDS TO THE RIGHT WITH THE LAST DESCRIBED LINE AND ALONG SAID NORTHEASTERLY DOCK LINE, 35.99 FEET; THENCE CONTINUING ALONG SAID NORTHEASTERLY DOCK LINE, AT AN ANGLE OF 173 DEGREES, 36 MINUTES, 50 SECONDS TO THE RIGHT WITH THE LAST DESCRIBED LINE, 252.69 FEET; THENCE CONTINUING ALONG SAID NORTHEASTERLY DOCK LINE, AT AN ANGLE OF 176 DEGREES, 02 MINUTES, 23 SECONDS TO RIGHT WITH THE LAST DESCRIBED LINE, 2.15 FEET; SOUTHEASTERLY AT AN ANGLE OF 122 DEGREES, 31 MINUTES, 41 SECONDS TO THE RIGHT WITH THE LAST DESCRIBED LINE, 9.55 FEET TO THE CENTERLINE OF A 1.00 FOOT BRICK WALL; THENCE NORTHEASTERLY AT AN ANGLE OF 149 DEGREES, 54 MINUTES, 45 SECONDS TO THE RIGHT WITH THE LAST DESCRIBED LINE, AND ALONG SAID CENTERLINE, 267.99 FEET TO THE SOUTHWESTERLY LINE OF NORTH KINGSBURY AND POINT OF BEGINNING.

UNOFFICIAL COPY

P.I.N. 17-04-300-028-0000

AND

PARCEL 8: (Northern Catalog Building)

THAT PART OF LOTS 1, 2, 3, AND 4 IN ELSTON'S ADDITION TO CHICAGO, LYING EAST OF DOCK LINE OF THE NORTH BRANCH OF THE CHICAGO RIVER, A SUBDIVISION IN THE WEST HALF OF THE SOUTHWEST QUARTER OF SECTION 4, TOWNSHIP 39 NORTH, RANGE 14 EAST OF THE THIRD PRINCIPAL MERIDIAN, IN COOK COUNTY, ILLINOIS, TOGETHER WITH THE SOUTHWESTERLY HALF OF THE VACATED NORTH BRANCH STREET LYING BETWEEN THE SOUTHWESTERLY LINE OF NORTH KINGSBURY STREET AND THE NORTH BRANCH OF THE CHICAGO RIVER, LYING ABOVE AN ELEVATION OF 77.00 FEET AND LYING BELOW AN ELEVATION OF 89.50 FEET, CITY OF CHICAGO DATUM, AND BOUNDED AND DESCRIBED AS FOLLOWS: BEGINNING ON THE SOUTHWESTERLY LINE OF NORTH KINGSBURY STREET AT A POINT 415.68 FEET NORTHWESTERLY OF THE INTERSECTION OF SAID SOUTHWESTERLY LINE OF NORTH KINGSBURY STREET AND THE WEST LINE OF NORTH LARRABEE STREET, BEING ALSO THE EXTENSION NORTHEASTERLY OF THE CENTERLINE OF A 1.00 FOOT BRICK WALL; THENCE NORTHWESTERLY, ALONG SAID SOUTHWESTERLY LINE OF NORTH KINGSBURY STREET, 88.49 FEET TO THE CENTER LINE OF SAID VACATED NORTH BRANCH STREET; THENCE NORTHWESTERLY AT AN ANGLE OF 127 DEGREES, 53 MINUTES, 38 SECONDS TO THE RIGHT WITH THE LAST DESCRIBED LINE, AND ALONG SAID CENTER LINE, 375.74 FEET, TO THE NORTHEASTERLY DOCK LINE OF THE NORTH BRANCH OF THE CHICAGO RIVER; THENCE SOUTHEASTERLY, AT AN ANGLE OF 59 DEGREES, 55 MINUTES, 55 SECONDS TO THE RIGHT WITH THE LAST DESCRIBED LINE AND ALONG SAID NORTHEASTERLY DOCK LINE, 35.99 FEET; THENCE CONTINUING ALONG SAID NORTHEASTERLY DOCK LINE, AT AN ANGLE OF 173 DEGREES, 36 MINUTES, 50 SECONDS TO THE RIGHT WITH THE LAST DESCRIBED LINE, 252.69 FEET; THENCE CONTINUING ALONG SAID NORTHEASTERLY DOCK LINE, AT AN ANGLE OF 176 DEGREES, 02 MINUTES, 23 SECONDS TO RIGHT WITH THE LAST DESCRIBED LINE, 2.15 FEET; SOUTHEASTERLY AT AN ANGLE OF 122 DEGREES, 31 MINUTES, 41 SECONDS TO THE RIGHT WITH THE LAST DESCRIBED LINE, 9.55 FEET TO THE CENTERLINE OF A 1.00 FOOT BRICK WALL; THENCE NORTHEASTERLY AT AN ANGLE OF 149 DEGREES, 54 MINUTES, 45 SECONDS TO THE RIGHT WITH THE LAST DESCRIBED LINE, AND ALONG SAID CENTERLINE, 267.99 FEET TO THE SOUTHWESTERLY LINE OF NORTH KINGSBURY AND POINT OF BEGINNING.

P.I.N. 17-04-300-029-0000

AND

[Note: Parcels 9, 10 and 11 are the result of a division of PIN 17-04-300-018-0000 which was created out of PIN 17-04-300-008-0000. Parcels 9, 10 and 11 comprise the R-2, 3 - 4, and the 5th Floor levels of certain portions of the NCAT.]

PARCEL 9: (Northern Catalog Building)

THAT PART OF LOT 5, LYING EAST OF THE DOCK LINE OF THE NORTH BRANCH OF THE CHICAGO RIVER IN ASSESSORS PLAT OF LOTS 5 AND 6 IN BLOCK 95 OF ELSTON'S ADDITION TO CHICAGO, SECTION 4, TOWNSHIP 39 NORTH, RANGE 14 EAST OF THE THIRD

UNOFFICIAL COPY

PRINCIPAL MERIDIAN, IN COOK COUNTY, ILLINOIS, AND LYING BELOW AN ELEVATION OF 52.00 FEET, CITY OF CHICAGO DATUM, AND BOUNDED AND DESCRIBED AS FOLLOWS: BEGINNING ON THE SOUTHWESTERLY LINE OF NORTH KINGSBURY STREET AT A POINT 415.68 FEET NORTHWESTERLY OF THE INTERSECTION OF SAID SOUTHWESTERLY LINE OF NORTH KINGSBURY STREET AND THE WEST LINE OF NORTH LARRABEE STREET, BEING ALSO THE EXTENSION NORTHEASTERLY OF THE CENTERLINE OF A 1.00 FOOT BRICK WALL; THENCE SOUTHWESTERLY, AT AN ANGLE OF 89 DEGREES, 55 MINUTES, 12 SECONDS TO THE RIGHT WITH THE LAST DESCRIBED LINE ALONG SAID CENTER LINE OF SAID 1.00 FOOT BRICK WALL, A DISTANCE OF 267.99 FEET TO THE POINT OF BEGINNING; THENCE NORTHWESTERLY AT AN ANGLE OF 149 DEGREES, 54 MINUTES, 45 SECONDS TO THE LEFT WITH THE LAST DESCRIBED LINE, 9.55 FEET TO THE NORTHEASTERLY DOCK LINE OF THE NORTH BRANCH OF THE CHICAGO RIVER; THENCE SOUTHEASTERLY ALONG SAID DOCK LINE, AT AN ANGLE OF 57 DEGREES, 28 MINUTES, 19 SECONDS TO THE RIGHT WITH THE LAST DESCRIBED LINE AND ALONG SAID NORTHEASTERLY DOCK LINE, 4.79 FEET TO THE EXTENSION SOUTHWESTERLY OF THE CENTER LINE OF SAID 1.00 FOOT BRICK WALL; THENCE NORTHEASTERLY AT AN ANGLE OF 92 DEGREES, 26 MINUTES, 26 SECONDS TO THE RIGHT WITH THE LAST DESCRIBED LINE, AND ALONG SAID CENTERLINE, 8.06 FEET TO THE POINT OF BEGINNING.

AND

P.I.N. 17-04-300-031-0000

AND

PARCEL 10: (Northern Catalog Building)

THAT PART OF LOT 5, LYING EAST OF THE DOCK LINE OF THE NORTH BRANCH OF THE CHICAGO RIVER IN ASSESSORS PLAT OF LOTS 5 AND 6 IN BLOCK 95 OF ELSTON'S ADDITION TO CHICAGO, SECTION 4, TOWNSHIP 39 NORTH, RANGE 14 EAST OF THE THIRD PRINCIPAL MERIDIAN, IN COOK COUNTY, ILLINOIS, AND LYING ABOVE AN ELEVATION OF 52.00 FEET, AND BELOW AN ELEVATION OF 77.00 FEET, CITY OF CHICAGO DATUM, AND BOUNDED AND DESCRIBED AS FOLLOWS: BEGINNING ON THE SOUTHWESTERLY LINE OF NORTH KINGSBURY STREET AT A POINT 415.68 FEET NORTHWESTERLY OF THE INTERSECTION OF SAID SOUTHWESTERLY LINE OF NORTH KINGSBURY STREET AND THE WEST LINE OF NORTH LARRABEE STREET, BEING ALSO THE EXTENSION NORTHEASTERLY OF THE CENTERLINE OF A 1.00 FOOT BRICK WALL; THENCE SOUTHWESTERLY, AT AN ANGLE OF 89 DEGREES, 55 MINUTES, 12 SECONDS TO THE RIGHT WITH THE LAST DESCRIBED LINE ALONG SAID CENTER LINE OF SAID 1.00 FOOT BRICK WALL, A DISTANCE OF 267.99 FEET TO THE POINT OF BEGINNING; THENCE NORTHWESTERLY AT AN ANGLE OF 149 DEGREES, 54 MINUTES, 45 SECONDS TO THE LEFT WITH THE LAST DESCRIBED LINE, 9.55 FEET TO THE NORTHEASTERLY DOCK LINE OF THE NORTH BRANCH OF THE CHICAGO RIVER; THENCE SOUTHEASTERLY ALONG SAID DOCK LINE, AT AN ANGLE OF 57 DEGREES, 28 MINUTES, 19 SECONDS TO THE RIGHT WITH THE LAST DESCRIBED LINE AND ALONG SAID NORTHEASTERLY DOCK LINE, 4.79 FEET TO THE EXTENSION SOUTHWESTERLY OF THE CENTER LINE OF SAID 1.00 FOOT BRICK WALL; THENCE NORTHEASTERLY AT AN ANGLE OF 92 DEGREES, 26 MINUTES, 26 SECONDS TO THE RIGHT WITH THE LAST DESCRIBED LINE, AND ALONG SAID CENTERLINE, 8.06 FEET TO THE POINT OF BEGINNING.

P.I.N. 17-04-300-032-0000

UNOFFICIAL COPY

AND

PARCEL 11: (Northern Catalog Building)

THAT PART OF LOT 5, LYING EAST OF THE DOCK LINE OF THE NORTH BRANCH OF THE CHICAGO RIVER IN ASSESSORS PLAT OF LOTS 5 AND 6 IN BLOCK 95 OF ELSTON'S ADDITION TO CHICAGO, SECTION 4, TOWNSHIP 39 NORTH, RANGE 14 EAST OF THE THIRD PRINCIPAL MERIDIAN, IN COOK COUNTY, ILLINOIS, AND LYING ABOVE AN ELEVATION OF 77.00 FEET, AND BELOW AN ELEVATION OF 89.50 FEET, CITY OF CHICAGO DATUM, AND BOUNDED AND DESCRIBED AS FOLLOWS: BEGINNING ON THE SOUTHWESTERLY LINE OF NORTH KINGSBURY STREET AT A POINT 415.68 FEET NORTHWESTERLY OF THE INTERSECTION OF SAID SOUTHWESTERLY LINE OF NORTH KINGSBURY STREET AND THE WEST LINE OF NORTH LARRABEE STREET, BEING ALSO THE EXTENSION NORTHEASTERLY OF THE CENTERLINE OF A 1.00 FOOT BRICK WALL; THENCE SOUTHWESTERLY, AT AN ANGLE OF 89 DEGREES, 55 MINUTES, 12 SECONDS TO THE RIGHT WITH THE LAST DESCRIBED LINE ALONG SAID CENTER LINE OF SAID 1.00 FOOT BRICK WALL, A DISTANCE OF 267.99 FEET TO THE POINT OF BEGINNING; THENCE NORTHWESTERLY AT AN ANGLE OF 149 DEGREES, 54 MINUTES, 45 SECONDS TO THE LEFT WITH THE LAST DESCRIBED LINE, 9.55 FEET TO THE NORTHEASTERLY DOCK LINE OF THE NORTH BRANCH OF THE CHICAGO RIVER; THENCE SOUTHEASTERLY ALONG SAID DOCK LINE, AT AN ANGLE OF 57 DEGREES, 28 MINUTES, 19 SECONDS TO THE RIGHT WITH THE LAST DESCRIBED LINE AND ALONG SAID NORTHEASTERLY DOCK LINE, 4.79 FEET TO THE EXTENSION SOUTHWESTERLY OF THE CENTER LINE OF SAID 1.00 FOOT BRICK WALL; THENCE NORTHEASTERLY AT AN ANGLE OF 92 DEGREES, 26 MINUTES, 26 SECONDS TO THE RIGHT WITH THE LAST DESCRIBED LINE, AND ALONG SAID CENTERLINE, 8.06 FEET TO THE POINT OF BEGINNING.

P.I.N. 17-04-300-033-0000

AND

PARCEL 12: (Southern Catalog Building)

THAT PART OF LOTS 2, 3 AND 4 LYING EAST OF THE DOCK LINE OF THE NORTH BRANCH OF THE CHICAGO RIVER IN BLOCK 95 OF ELSTON'S ADDITION TO CHICAGO, IN SECTION 4, TOWNSHIP 39 NORTH, RANGE 14 EAST OF THE THIRD PRINCIPAL MERIDIAN, IN COOK COUNTY, ILLINOIS, BOUNDED AND DESCRIBED AS FOLLOWS: BEGINNING AT THE SOUTHEAST CORNER OF LOT 4; THENCE NORTHWESTERLY ALONG THE NORTHEASTERLY LINES OF SAID LOTS 4, 3 AND 2, A DISTANCE OF 155.14 FEET TO A POINT ON THE NORTHEASTERLY LINE OF SAID LOT 2; THENCE SOUTHWESTERLY ALONG A LINE FORMING AN ANGLE OF 89 DEGREES 55 MINUTES 12 SECONDS FROM SOUTHEAST TO SOUTHWEST WITH THE LAST DESCRIBED SOUTHWESTERLY LINE, SAID LINE ALSO BEING THE CENTERLINE OF A 12 INCH THICK BRICK WALL AND THE EXTENSION THEREOF, A DISTANCE OF 267.99 FEET TO THE SOUTH LINE OF LOT 4; THENCE EAST ALONG THE SOUTH LINE OF LOT 4, A DISTANCE OF 309.47 FEET TO THE POINT OF BEGINNING.

P.I.N. 17-04-300-019-0000

AND

UNOFFICIAL COPY

[NOTE: Parcel 13 was created out of the 17-04-300-008 PIN]

PARCEL 13: (Southern Catalog Building)

THAT PART OF LOTS 5 AND 6, LYING EAST OF THE DOCK LINE OF THE NORTH BRANCH OF THE CHICAGO RIVER IN BLOCK 95 OF ELSTON'S ADDITION TO CHICAGO, IN SECTION 4, TOWNSHIP 39 NORTH, RANGE 14 EAST OF THE THIRD PRINCIPAL MERIDIAN, IN COOK COUNTY, ILLINOIS, BOUNDED AND DESCRIBED AS FOLLOWS: BEGINNING AT THE SOUTHEAST CORNER OF SAID LOT 6; THENCE NORTH ALONG THE EAST LINE OF SAID LOTS 6 AND 5, BEING ALSO THE WEST LINE OF LARRABEE STREET, A DISTANCE OF 330.60 FEET TO THE INTERSECTION WITH THE SOUTHWESTERLY LINE OF N. KINGSBURY STREET; THENCE NORTHWESTERLY ALONG SAID SOUTHWESTERLY LINE, BEING ALSO THE NORTHEASTERLY LINE OF SAID LOT 5, A DISTANCE OF 260.55 FEET TO A POINT ON THE NORTHEAST CORNER OF LOT 5; THENCE WESTERLY ALONG THE NORTH LINE OF LOT 5, A DISTANCE OF 309.47 FEET; THENCE SOUTHWESTERLY ON AN ANGLE TO THE LEFT OF 30 DEGREES 05 MINUTES 15 SECONDS, A DISTANCE OF 8.06 FEET TO SAID DOCK LINE; THENCE SOUTHEASTERLY ALONG SAID DOCK LINE, A DISTANCE OF 174.59 FEET TO A BEND; THENCE SOUTHEASTERLY ALONG SAID DOCK LINE, A DISTANCE 207.60 FEET TO A BEND; THENCE SOUTHEASTERLY ALONG SAID DOCK LINE, A DISTANCE OF 231.32 FEET TO THE SOUTH LINE OF SAID LOT 6, BEING ALSO THE NORTH LINE OF W. CHICAGO AVENUE; THENCE EAST ALONG SAID LINE, A DISTANCE OF 203.28 FEET TO THE POINT OF BEGINNING, EXCEPTING THEREFROM THE EAST 32 FEET OF LOT 5 AND THE EAST 50 FEET OF LOT 6.

P.I.N. 17-04-300-017-0000

AND

PARCEL 14: (Southern Catalog Building)

THAT PART OF LOT 5 IN BLOCK 95 IN ELSTON'S ADDITION TO CHICAGO, SITUATED IN THE SOUTHWEST QUARTER OF THE SOUTHWEST QUARTER OF SECTION 4, TOWNSHIP 39 NORTH, RANGE 14 EAST OF THE THIRD PRINCIPAL MERIDIAN, BOUNDED AND DESCRIBED AS FOLLOWS: BEGINNING ON THE SOUTH LINE OF LOT 5 AT A POINT 32.0 FEET WEST OF THE SOUTHEAST CORNER THEREOF AND RUNNING, THENCE NORTH PARALLEL WITH AND 32.0 FEET WEST OF THE EAST LINE OF SAID LOT 5, A DISTANCE OF 158.12 FEET TO THE SOUTHWESTERLY LINE OF HAWTHORNE AVENUE; THENCE SOUTHEASTERLY ALONG THE SOUTHWEST LINE OF HAWTHORNE AVENUE, A DISTANCE OF 64.0 FEET TO THE EAST LINE OF SAID LOT 5; THENCE SOUTH ALONG SAID EAST LINE OF SAID LOT 5, A DISTANCE OF 102.70 FEET TO THE SOUTHEAST CORNER THEREOF; AND THENCE WEST ALONG THE SOUTH LINE OF SAID LOT 5, A DISTANCE OF 32.0 FEET TO THE PLACE OF BEGINNING IN COOK COUNTY, ILLINOIS.

P.I.N. PART OF 17-04-501-002-0000

AND

UNOFFICIAL COPY

PARCEL 15: (Southern Catalog Building)

THAT EAST 50 FEET OF LOT 6 IN BLOCK 95 IN ELSTON'S ADDITION TO CHICAGO, BEING A PORTION OF THE WEST HALF OF THE SOUTHWEST QUARTER OF SECTION 4, TOWNSHIP 39 NORTH, RANGE 14 EAST OF THE THIRD PRINCIPAL MERIDIAN, IN COOK COUNTY, ILLINOIS.

P.I.N. PART OF 17-04-501-002-0000

BUT EXCEPTING FROM THE AFORESAID PARCELS 3, 6 AND 9, THE PROPERTY BOUNDED AND DESCRIBED AS FOLLOWS: **[THIS EXCEPTS THE LEGAL DESCRIPTION OF THE RIVERWALK OUT FROM THE LEGAL DESCRIPTION OF THE R-2 LEVELS OF THE NORTHERN CATALOGUE BUILDING. NO TAX DIVISION HAS BEEN FILED WITH RESPECT TO THIS SEPARATE LEGAL DESCRIPTION, I.E. THE RIVERWALK DOES NOT HAVE A SEPARATE PIN]**

THAT PART OF LOTS 1, 2, 3, 4 AND 5 IN BLOCK 95 LYING EAST OF THE DOCK LINE OF THE NORTH BRANCH OF THE CHICAGO RIVER TOGETHER WITH LOTS 24, 25, 26 AND A PART OF LOT 23, IN BLOCK 96, LYING EAST OF THE DOCK LINE OF THE NORTH BRANCH OF THE CHICAGO RIVER TOGETHER WITH VACATED BRANCH STREET LYING EAST OF THE DOCK LINE OF THE NORTH BRANCH OF THE CHICAGO RIVER IN ELSTON'S ADDITION TO CHICAGO, IN SECTION 4, TOWNSHIP 39 NORTH, RANGE 14 EAST OF THE THIRD PRINCIPAL MERIDIAN, LYING ABOVE AN ELEVATION OF 4.00 FEET (BEING THE FINISHED SURFACE OF THE RIVER WALK) AND BELOW AN ELEVATION OF 17.25 FEET, CITY OF CHICAGO DATUM, BOUNDED AND DESCRIBED AS FOLLOWS: COMMENCING ON THE SOUTHWESTERLY LINE OF NORTH KINGSBURY STREET AT A POINT 615.84 FEET NORTHWESTERLY OF THE INTERSECTION OF SAID SOUTHWESTERLY LINE OF NORTH KINGSBURY STREET AND THE WEST LINE OF NORTH LARRABEE STREET, THAT POINT BEING ALSO THE EXTENSION NORTHEASTERLY OF THE NORTHWESTERLY FACE OF FIVE CONCRETE COLUMNS; THENCE SOUTHWESTERLY WITH AN ANGLE OF 89 DEGREES, 49 MINUTES, 14 SECONDS TO THE RIGHT WITH THE LAST DESCRIBED LINE, AND ALONG SAID NORTHWESTERLY FACE, 104.87 FEET TO THE NORTHERLY EXTENSION OF THE WEST FACE OF A BRICK WALL; THENCE SOUTHEASTERLY, ALONG THE WESTERLY FACE OF SAID BRICK WALL, AT AN ANGLE OF 90 DEGREES, 18 MINUTES, 00 SECONDS TO THE RIGHT WITH THE LAST DESCRIBED LINE, A DISTANCE OF 1.53 FEET TO THE NORTHWESTERLY FACE OF A 1.00 FOOT BRICK WALL, THENCE SOUTHWESTERLY, ALONG SAID NORTHWESTERLY FACE, PERPENDICULAR TO THE LAST DESCRIBED LINE 124.71 FEET TO THE WEST FACE OF A WALL, AND THE POINT OF BEGINNING; THENCE SOUTHEASTERLY ALONG SAID WEST, FACE BEING ON A LINE FORMING AN ANGLE OF 89 DEGREES, 52 MINUTES, 22 SECONDS TO THE RIGHT WITH THE LAST DESCRIBED LINE, 123.29 FEET TO A POINT TO BE REFERRED TO AS POINT "A"; THENCE FOLLOWING THE FACE OF THE WALL, NORTHEASTERLY, PERPENDICULAR TO THE LAST DESCRIBED LINE, 1.38 FEET TO A BEND POINT IN SAID WALL; THENCE SOUTHEASTERLY, PERPENDICULAR TO THE LAST DESCRIBED LINE, 50.58 FEET; THENCE SOUTHWESTERLY, PERPENDICULAR TO THE LAST DESCRIBED LINE, 13.37 FEET; THENCE SOUTHEASTERLY, PERPENDICULAR TO THE LAST DESCRIBED LINE, 225.89 FEET TO THE CENTER LINE OF A 1.00 FOOT BRICK WALL (SAID POINT BEING 241.58 FEET WEST OF THE WEST LINE OF NORTH KINGSBURY STREET);

UNOFFICIAL COPY

THENCE SOUTHWESTERLY, ALONG SAID CENTERLINE AND ITS EXTENSION, BEING A LINE FORMING AN ANGLE TO THE LEFT WITH THE LAST DESCRIBED LINE OF 90 DEGREES, 04 MINUTES, 48 SECONDS, 34.00 FEET TO THE DOCK LINE OF THE NORTH BRANCH OF THE CHICAGO RIVER TO A POINT TO BE REFERRED TO AS POINT "B"; THENCE NORTHWESTERLY, ALONG SAID DOCK LINE, BEING A LINE FORMING AN ANGLE OF 92 DEGREES, 05 MINUTES, 27 SECONDS TO THE LEFT WITH THE LAST DESCRIBED LINE, 8.08 FEET TO A BEND POINT, SAID BEND POINT TO BE REFERRED TO AS POINT "C"; THENCE NORTHWESTERLY, ALONG A LINE FORMING AN ANGLE OF 176 DEGREES, 11 MINUTES, 31 SECONDS TO THE LEFT WITH THE LAST DESCRIBED LINE, 252.49 FEET TO A BEND POINT; THENCE NORTHWESTERLY, ALONG A LINE FORMING AN ANGLE OF 173 DEGREES, 39 MINUTES, 01 SECONDS TO THE LEFT WITH THE LAST DESCRIBED LINE, 140.75 FEET TO THE NORTH FACE AND ITS EXTENSION OF A BRICK WALL; THENCE NORTHEASTERLY 19.53 FEET TO THE POINT OF BEGINNING,

ALSO

THAT PART OF SAID LOTS LYING ABOVE AN ELEVATION OF 17.25 FEET AND BELOW AN ELEVATION OF 35.00 FEET, CITY OF CHICAGO DATUM, DESCRIBED AS FOLLOWS; COMMENCING AT THE AFORESAID POINT OF BEGINNING; THENCE SOUTHEASTERLY, ALONG A LINE 123.29 FEET TO THE AFORESAID POINT "A" AND POINT OF BEGINNING; THENCE NORTHEASTERLY, PERPENDICULAR TO THE LAST DESCRIBED LINE, 1.38 FEET TO A BEND POINT IN SAID WALL; THENCE SOUTHEASTERLY, PERPENDICULAR TO THE LAST DESCRIBED LINE, 50.58 FEET; THENCE SOUTHWESTERLY, PERPENDICULAR TO THE LAST DESCRIBED LINE, 17.20 FEET; THENCE SOUTHEASTERLY, PERPENDICULAR TO THE LAST DESCRIBED LINE, 89.05 FEET; THENCE SOUTHWESTERLY, PERPENDICULAR TO THE LAST DESCRIBED LINE, 5.33 FEET; THENCE SOUTHEASTERLY, PERPENDICULAR TO THE LAST DESCRIBED LINE, 15.50 FEET; THENCE SOUTHWESTERLY, 21.91 FEET TO THE AFORESAID NORTHEASTERLY DOCK LINE; THENCE NORTHWESTERLY, ALONG SAID NORTHEASTERLY DOCK LINE, BEING A LINE FORMING AN ANGLE OF 88 DEGREES, 21 MINUTES, 46 SECONDS TO THE LEFT WITH THE LAST DESCRIBED LINE, 139.14 FEET TO A BEND POINT; THENCE NORTHWESTERLY, ALONG A LINE FORMING AN ANGLE OF 173 DEGREES, 39 MINUTES, 01 SECONDS TO THE LEFT WITH THE LAST DESCRIBED LINE, 60.50 FEET; THENCE NORTHEASTERLY, ALONG A LINE FORMING AN ANGLE OF 97 DEGREES, 59 MINUTES, 14 SECONDS TO THE LEFT WITH THE LAST DESCRIBED LINE, 15.26 FEET; THENCE SOUTHEASTERLY, PERPENDICULAR TO THE LAST DESCRIBED LINE, 43.87 FEET; THENCE NORTHEASTERLY, PERPENDICULAR TO THE LAST DESCRIBED LINE, 15.42 FEET TO THE AFORESAID POINT "A" AND POINT OF BEGINNING,

ALSO

THAT PART OF SAID LOTS LYING ABOVE AN ELEVATION OF 17.25 FEET AND BELOW AN ELEVATION OF 35.00 FEET, CITY OF CHICAGO DATUM, DESCRIBED AS FOLLOWS; BEGINNING AT THE AFORESAID POINT "B"; THENCE NORTHWESTERLY, 8.08 FEET TO THE AFORESAID POINT "C", THENCE NORTHWESTERLY, ALONG A LINE FORMING AN ANGLE OF 176 DEGREES, 11 MINUTES, 31 SECONDS TO THE LEFT WITH THE LAST DESCRIBED LINE, AND ALONG THE AFORESAID NORTHEASTERLY DOCK LINE, 50.45 FEET; THENCE NORTHEASTERLY, ALONG A LINE FORMING AN ANGLE OF 91 DEGREES, 38 MINUTES, 14 SECONDS TO THE LEFT

UNOFFICIAL COPY

WITH THE LAST DESCRIBED LINE, 29.04 FEET; THENCE SOUTHEASTERLY, PERPENDICULAR TO THE LAST DESCRIBED LINE, 58.46 FEET TO THE CENTERLINE AND ITS EXTENSION OF THE AFORESAID BRICK WALL; THENCE SOUTHWESTERLY, ALONG A LINE FORMING AN ANGLE OF 90 DEGREES, 04 MINUTES, 48 SECONDS TO THE LEFT WITH THE LAST DESCRIBED LINE, 30.17 FEET TO THE POINT OF BEGINNING, ALL IN COOK COUNTY, ILLINOIS.

BUT EXCEPTING FROM THE AFORESAID PARCELS 12 AND 13, THE PROPERTY BOUNDED AND DESCRIBED AS FOLLOWS: [NOTE: THIS EXCEPTS THE RIVERWALK OUT FROM THE SCAT]

THAT PART OF LOTS 4, 5 AND 6 IN BLOCK 95 IN ELSTON'S ADDITION TO CHICAGO, IN SECTION 4, TOWNSHIP 39 NORTH, RANGE 14 EAST OF THE THIRD PRINCIPAL MERIDIAN, LYING EAST OF THE DOCK LINE OF THE NORTH BRANCH OF THE CHICAGO RIVER, LYING ABOVE AN ELEVATION OF 4.00 FEET (BEING THE FINISHED SURFACE OF THE RIVER WALK) AND BELOW AN ELEVATION OF 17.25 FEET, CITY OF CHICAGO DATUM, BOUNDED AND DESCRIBED AS FOLLOWS: BEGINNING AT THE INTERSECTION OF THE WEST FACE OF A WALL AND THE NORTH RIGHT OF WAY LINE OF CHICAGO AVENUE, BEING A POINT 172.37 FEET WEST OF THE WEST LINE OF NORTH LARRABEE STREET; THENCE NORTHERLY, ALONG SAID WEST FACE AND ITS EXTENSION, BEING A LINE FORMING AN ANGLE OF 90 DEGREES, 38 MINUTES, 47 SECONDS TO THE LEFT WITH SAID NORTH RIGHT OF WAY LINE, 55.46 FEET TO A BEND POINT; THENCE NORTHWESTERLY, ALONG A LINE FORMING AN ANGLE OF 135 DEGREES, 00 MINUTES, 00 SECONDS TO THE RIGHT WITH THE LAST DESCRIBED LINE, 24.75 FEET TO A BEND POINT; THENCE NORTHERLY, ALONG A LINE FORMING AN ANGLE OF 135 DEGREES, 00 MINUTES, 00 SECONDS TO THE LEFT WITH THE LAST DESCRIBED LINE, 87.15 FEET TO A BEND POINT; THENCE NORTHWESTERLY, ALONG A LINE FORMING AN ANGLE OF 135 DEGREES, 00 MINUTES, 00 SECONDS TO THE RIGHT WITH THE LAST DESCRIBED LINE, 24.75 FEET TO A BEND POINT; THENCE NORTHERLY, ALONG A LINE FORMING AN ANGLE OF 135 DEGREES, 00 MINUTES, 00 SECONDS TO THE LEFT WITH THE LAST DESCRIBED LINE, 57.11 FEET TO A BEND POINT; THENCE NORTHWESTERLY, ALONG A LINE FORMING AN ANGLE OF 149 DEGREES, 29 MINUTES, 58 SECONDS TO THE RIGHT WITH THE LAST DESCRIBED LINE, 58.09 FEET TO A BEND POINT; THENCE SOUTHWESTERLY, PERPENDICULAR TO THE LAST DESCRIBED LINE, 8.58 FEET TO A BEND POINT; THENCE NORTHWESTERLY, PERPENDICULAR TO THE LAST DESCRIBED LINE, 122.50 FEET TO A BEND POINT, SAID POINT TO BE REFERRED TO AS POINT "A"; THENCE SOUTHWESTERLY, PERPENDICULAR TO THE LAST DESCRIBED LINE, 9.08 FEET TO A BEND POINT, SAID POINT TO BE REFERRED TO AS POINT "B"; THENCE NORTHWESTERLY, PERPENDICULAR TO THE LAST DESCRIBED LINE, 211.72 FEET TO THE CENTER LINE OF A 1.00 FOOT BRICK WALL (SAID POINT BEING 245.00 FEET WEST OF THE WEST LINE OF NORTH KINGSBURY STREET AS MEASURED ALONG SAID CENTERLINE BEING A LINE FORMING AN ANGLE OF 89 DEGREES, 55 MINUTES, 12 SECONDS FROM SOUTHEAST TO SOUTHWEST WITH THE SOUTHWESTERLY LINE OF NORTH KINGSBURY STREET AT A POINT ON SAID SOUTHWESTERLY LINE 415.69 FEET, AS MEASURED ALONG SAID SOUTHWESTERLY LINE, NORTHWESTERLY FROM ITS INTERSECTION WITH THE WEST LINE OF NORTH LARRABEE STREET); THENCE SOUTHWESTERLY, ALONG SAID CENTERLINE AND ITS EXTENSION, BEING A LINE FORMING AN ANGLE OF 90 DEGREES, 08 MINUTES,

UNOFFICIAL COPY

23 SECONDS TO THE RIGHT WITH THE LAST DESCRIBED LINE, 30.58 FEET TO THE NORTHEASTERLY DOCK LINE OF THE NORTH BRANCH OF THE CHICAGO RIVER; THENCE SOUTHEASTERLY, ALONG SAID DOCK LINE, AT AN ANGLE OF 87 DEGREES, 54 MINUTES, 34 SECONDS TO THE RIGHT WITH THE LAST DESCRIBED LINE, 181.53 FEET; THENCE CONTINUING SOUTHEASTERLY, ALONG SAID NORTHEASTERLY DOCK LINE AT AN ANGLE OF 178 DEGREES, 39 MINUTES, 02 SECONDS TO THE RIGHT WITH THE LAST DESCRIBED LINE, 200.22 FEET; THENCE CONTINUING, SOUTHEASTERLY, ALONG SAID NORTHEASTERLY DOCK LINE AT AN ANGLE OF 154 DEGREES, 49 MINUTES, 20 SECONDS TO THE LEFT WITH THE LAST DESCRIBED LINE, 231.02 FEET TO THE NORTH LINE OF CHICAGO AVENUE; THENCE EASTERLY, ALONG SAID NORTH LINE, 32.28 FEET TO THE POINT OF BEGINNING,

ALSO

THAT PART OF SAID LOTS 4, 5 AND 6, LYING ABOVE AN ELEVATION OF 17.25 FEET AND BELOW AN ELEVATION OF 35.00 FEET, CITY OF CHICAGO DATUM, BOUNDED AND DESCRIBED AS FOLLOWS: COMMENCING AT THE INTERSECTION OF THE NORTHEASTERLY DOCK LINE OF THE CHICAGO RIVER AND THE NORTH LINE OF CHICAGO AVENUE (SAID POINT BEING 204.65 FEET WEST OF THE WEST LINE OF LARRABEE STREET); THENCE NORTHWESTERLY, ALONG SAID DOCK LINE, 17.54 FEET TO THE NORTH FACE AND ITS EXTENSION OF A WALL AND THE POINT OF BEGINNING; THENCE EASTERLY, ALONG SAID NORTH FACE, BEING ON A LINE FORMING AN ANGLE OF 81 DEGREES, 22 MINUTES, 38 SECONDS TO THE LEFT WITH THE LAST DESCRIBED LINE, 25.91 FEET TO THE WEST FACE OF A WALL; THENCE NORTHERLY, ALONG SAID WEST FACE, PERPENDICULAR TO THE LAST DESCRIBED LINE, 46.76 FEET TO A BEND POINT; THENCE NORTHWESTERLY, ALONG A LINE FORMING AN ANGLE OF 135 DEGREES, 00 MINUTES, 00 SECONDS TO THE RIGHT WITH THE LAST DESCRIBED LINE, 12.02 FEET TO A BEND POINT; THENCE NORTHERLY, ALONG A LINE FORMING AN ANGLE OF 135 DEGREES, 00 MINUTES, 00 SECONDS TO THE LEFT WITH THE LAST DESCRIBED LINE, 87.15 FEET TO A BEND POINT; THENCE NORTHWESTERLY, ALONG A LINE FORMING AN ANGLE OF 135 DEGREES, 00 MINUTES, 00 SECONDS TO THE RIGHT WITH THE LAST DESCRIBED LINE, 24.75 FEET TO A BEND POINT; THENCE NORTH, ALONG A LINE FORMING AN ANGLE OF 135 DEGREES, 00 MINUTES, 00 SECONDS TO THE LEFT WITH THE LAST DESCRIBED LINE, 57.11 FEET TO A BEND POINT; THENCE NORTHWESTERLY, ALONG A LINE FORMING AN ANGLE OF 149 DEGREES, 29 MINUTES, 58 SECONDS TO THE RIGHT WITH THE LAST DESCRIBED LINE, 58.09 FEET TO A BEND POINT; THENCE SOUTHWESTERLY, ALONG THE FACE OF A WALL AND ITS EXTENSION, PERPENDICULAR TO THE LAST DESCRIBED LINE, 33.23 FEET TO THE AFORESAID NORTHEASTERLY DOCK LINE; THENCE SOUTHEASTERLY, ALONG SAID DOCK LINE AT AN ANGLE OF 86 DEGREES, 42 MINUTES, 00 SECONDS TO THE RIGHT WITH THE LAST DESCRIBED LINE, 47.09 FEET TO A BEND POINT; THENCE SOUTHEASTERLY, ALONG A LINE FORMING AN ANGLE OF 154 DEGREES, 49 MINUTES, 20 SECONDS TO THE LEFT WITH THE LAST DESCRIBED LINE, 213.48 FEET TO THE POINT OF BEGINNING,

ALSO

THAT PART OF SAID LOTS 4, 5 AND 6, LYING ABOVE AN ELEVATION OF 17.25 FEET AND BELOW AN ELEVATION OF 35.00 FEET, CITY OF CHICAGO DATUM, BOUNDED

UNOFFICIAL COPY

AND DESCRIBED AS FOLLOWS: COMMENCING AT THE AFORESAID POINT "A"; THENCE SOUTHWESTERLY 9.08 FEET TO THE AFORESAID POINT "B" AND THE POINT OF BEGINNING; THENCE NORTHWESTERLY, PERPENDICULAR TO THE LAST DESCRIBED LINE, 105.00 FEET; THENCE SOUTHWESTERLY, PERPENDICULAR TO THE LAST DESCRIBED LINE, 26.92 FEET TO THE AFORESAID NORTHEASTERLY DOCK LINE; THENCE SOUTHEASTERLY, ALONG A LINE FORMING AN ANGLE OF 88 DEGREES, 02 MINUTES, 57 SECONDS TO THE RIGHT WITH THE LAST DESCRIBED LINE, 74.66 FEET; THENCE SOUTHEASTERLY, ALONG A LINE FORMING AN ANGLE OF 178 DEGREES, 39 MINUTES, 02 SECONDS TO THE RIGHT WITH THE LAST DESCRIBED LINE, 30.43 FEET; THENCE NORTHEASTERLY, ALONG A LINE FORMING AN ANGLE OF 93 DEGREES, 18 MINUTES, 00 SECONDS TO THE RIGHT WITH THE LAST DESCRIBED LINE, 22.63 FEET TO THE POINT OF BEGINNING,

ALSO

THAT PART OF SAID LOTS 4, 5 AND 6, LYING ABOVE AN ELEVATION OF 17.25 FEET AND BELOW AN ELEVATION OF 35.00 FEET, CITY OF CHICAGO DATUM, BOUNDED AND DESCRIBED AS FOLLOWS: COMMENCING AT THE AFORESAID POINT "A"; THENCE SOUTHWESTERLY 9.08 FEET TO THE AFORESAID POINT "B"; THENCE NORTHWESTERLY, PERPENDICULAR TO THE LAST DESCRIBED LINE, 157.50 FEET TO THE POINT OF BEGINNING; THENCE CONTINUING NORTHWESTERLY, ALONG THE PROJECTION OF THE LAST DESCRIBED LINE, 54.22 FEET TO THE CENTER LINE OF THE AFORESAID 1.0 BRICK WALL; THENCE SOUTHWESTERLY, ALONG SAID CENTERLINE AND ITS EXTENSION, BEING A LINE FORMING AN ANGLE OF 90 DEGREES, 08 MINUTES, 23 SECONDS TO THE RIGHT WITH THE LAST DESCRIBED LINE, 30.58 FEET TO THE AFORESAID NORTHEASTERLY DOCK LINE; THENCE SOUTHEASTERLY, ALONG A LINE FORMING AN ANGLE OF 87 DEGREES, 54 MINUTES, 34 SECONDS TO THE RIGHT WITH THE LAST DESCRIBED LINE, 54.33 FEET; THENCE NORTHEASTERLY, ALONG A LINE FORMING AN ANGLE OF 91 DEGREES, 57 MINUTES, 14 SECONDS TO THE RIGHT WITH THE LAST DESCRIBED LINE, 28.71 FEET TO THE POINT OF BEGINNING, IN COOK COUNTY, ILLINOIS.

UNOFFICIAL COPY

EPORT 600 PROPERTY OWNER PARCELS (CONTINUED)

CERTAIN LEVELS OF 950 KINGSBURY PARKING GARAGE AND A 7.58' STRIP OF LAND EAST OF THE 950 PARKING GARAGE

[NOTE: The 950 N. Kingsbury Parking Garage was originally part of the 17-04-300-007 PIN. The garage is now the 17-04-300-022 PIN. The 022 PIN includes the Riverwalk behind the garage and the "Domain Balcony Parcel" and a portion of the 950 parking garage now owned by River Village Lofts. A tax division to separate the Eport 600 Property Owner parcels from the Eport 600 Riverwalk Owner parcels and the Domain Balcony parcel and the River Village Lofts parcel has not been filed.

River Village Lofts has recorded a Declaration of Condominium creating 78 parking condominium units out of their space in the garage. The act of recording that Declaration starts the process of creating separate PINs for those parking units.

The Domain Balcony parcel is part of Domain condominium. Certain terraces and balconies on the north end of Domain are located in the Domain Balcony Parcel. The Domain Condominium Declaration was recorded in July, 2002 and has been amended several times. When all the residential condominium units in Domain that are located on the north side of Domain are legally in the condominium, individual PINs will be generated for those units. Those PINs will include the terraces and balconies located in the Domain Balcony Parcel since they are limited common elements appurtenant to those residential units.]

TRACT 1: A TRACT OF LAND BEING THAT PART OF LOTS 21, 22 AND 23, IN BLOCK 96 IN ELSTON'S ADDITION TO CHICAGO, A SUBDIVISION IN THE WEST HALF OF THE SOUTHWEST QUARTER OF SECTION 4, TOWNSHIP 39 NORTH, RANGE 14, EAST OF THE THIRD PRINCIPAL MERIDIAN, IN COOK COUNTY, ILLINOIS, LYING BETWEEN THE SOUTHWESTERLY LINE OF NORTH KINGSBURY STREET AND THE NORTH BRANCH OF THE CHICAGO RIVER, BOUNDED AND DESCRIBED AS FOLLOWS: COMMENCING ON THE SOUTHWESTERLY LINE OF NORTH KINGSBURY STREET AT A POINT 816.84 FEET NORTHWESTERLY OF THE INTERSECTION OF SAID SOUTHWESTERLY LINE OF NORTH KINGSBURY STREET AND THE WEST LINE OF NORTH LARRABEE STREET, SAID POINT BEING ALSO THE EXTENSION NORTHEASTERLY OF THE NORTHWESTERLY FACE OF FIVE (5) CONCRETE COLUMNS; THENCE SOUTHWESTERLY, AT AN ANGLE OF 89 DEGREES, 49 MINUTES, 14 SECONDS TO THE RIGHT WITH THE LAST DESCRIBED LINE, AND ALONG SAID NORTHWESTERLY FACE, 7.58 FEET TO THE POINT OF BEGINNING; THENCE CONTINUING SOUTHWESTERLY, ALONG THE LAST DESCRIBED LINE, 97.29 FEET TO THE NORTHERLY EXTENSION OF THE WEST FACE OF A BRICK WALL; THENCE SOUTHEASTERLY, ALONG THE WESTERLY FACE OF SAID BRICK WALL, AT AN ANGLE OF 90 DEGREES, 18 MINUTES, 00 SECONDS TO THE RIGHT WITH THE LAST DESCRIBED LINE, A DISTANCE OF 1.53 FEET TO THE NORTHWESTERLY FACE OF A 1.00 FOOT BRICK WALL; THENCE SOUTHWESTERLY, ALONG SAID NORTHWESTERLY FACE, PERPENDICULAR TO THE LAST DESCRIBED LINE, A DISTANCE OF 117.38 FEET; THENCE NORTHWESTERLY AT AN ANGLE OF 90 DEGREES, 14 MINUTES, 41 SECONDS TO THE LEFT WITH THE LAST DESCRIBED LINE 24.82 FEET; THENCE NORTHEASTERLY, PERPENDICULAR TO THE LAST DESCRIBED LINE, 8.07 FEET; THENCE NORTHWESTERLY AT AN ANGLE OF 100 DEGREES, 07 MINUTES, 04 SECONDS TO THE RIGHT WITH THE LAST DESCRIBED LINE, 95.18 FEET;

UNOFFICIAL COPY

THENCE NORTHEASTERLY AT AN ANGLE OF 100 DEGREES, 00 MINUTES, 00 SECONDS TO THE LEFT WITH THE LAST DESCRIBED LINE, 190.13 FEET, TO A POINT 7.58 FEET SOUTHWESTERLY OF THE SOUTHWESTERLY LINE OF NORTH KINGSBURY STREET; THENCE SOUTHEASTERLY, ALONG A LINE PARALLEL WITH SAID SOUTHWESTERLY LINE OF NORTH KINGSBURY STREET, 116.99 FEET TO THE POINT OF BEGINNING; EXCEPTING FROM SAID TRACT THAT PART BOUNDED AND DESCRIBED AS FOLLOWS AND LYING BELOW THE ELEVATIONS, CITY OF CHICAGO DATUM, HEREIN DESCRIBED; BEGINNING AT THE NORTHEASTERLY CORNER OF SAID TRACT AT AN ELEVATION OF 33.08 FEET; THENCE WESTERLY, ALONG THE NORTHERLY LINE OF SAID TRACT, A SLOPE DISTANCE OF 190.35 FEET TO A POINT HAVING AN ELEVATION OF 23.92 FEET; THENCE SOUTHEASTERLY, AT AN ANGLE OF 100 DEGREES, 00 MINUTES, 00 SECONDS TO THE RIGHT WITH THE LAST DESCRIBED LINE, A SLOPE DISTANCE OF 59.43 FEET TO A POINT HAVING AN ELEVATION OF 22.12 FEET; THENCE NORTHEASTERLY, ALONG A LINE 58.50 FEET SOUTHEASTERLY OF AND PARALLEL WITH THE NORTHERLY LINE OF SAID TRACT OF LAND, A SLOPE DISTANCE OF 200.85 FEET TO A POINT HAVING AN ELEVATION OF 35.00 FEET, SAID POINT BEING ON THE NORTHEASTERLY LINE OF SAID TRACT OF LAND; THENCE NORTHWESTERLY A SLOPE DISTANCE OF 58.53 FEET TO THE POINT OF BEGINNING; ALSO EXCEPTING THAT PART OF SAID TRACT OF LAND BOUNDED AND DESCRIBED AS FOLLOWS AND LYING BELOW THE ELEVATIONS, CITY OF CHICAGO DATUM, HEREIN DESCRIBED, BEGINNING AT THE INTERSECTION OF THE NORTHEASTERLY LINE OF SAID TRACT OF LAND AND THE SOUTHEASTERLY LINE OF THE NORTHWESTERLY 58.50 FEET OF SAID TRACT OF LAND AT AN ELEVATION OF 12.00 FEET; THENCE SOUTHWESTERLY, ALONG THE SOUTHEASTERLY LINE OF THE NORTHWESTERLY 58.50 FEET OF SAID TRACT OF LAND, A SLOPE DISTANCE OF 200.88 FEET TO A POINT HAVING AN ELEVATION OF 25.33 FEET; THENCE SOUTHEASTERLY AT AN ANGLE OF 100 DEGREES, 00 MINUTES, 00 SECONDS TO THE RIGHT WITH THE LAST DESCRIBED LINE, A SLOPE DISTANCE OF 35.86 FEET TO A POINT HAVING AN ELEVATION OF 22.92 FEET; THENCE SOUTHWESTERLY, AT AN ANGLE OF 100 DEGREES, 07 MINUTES, 04 SECONDS TO THE LEFT WITH THE LAST DESCRIBED LINE, 8.07 FEET TO A POINT HAVING AN ELEVATION OF 22.92 FEET; THENCE SOUTHEASTERLY, AT RIGHT ANGLES TO THE LAST DESCRIBED LINE, 24.82 FEET TO THE SOUTHEASTERLY LINE OF SAID TRACT OF LAND AT AN ELEVATION OF 22.92 FEET; THENCE NORTHEASTERLY, ALONG SAID SOUTHEASTERLY LINE, A SLOPE DISTANCE OF 117.55 FEET TO A BEND POINT IN SAID SOUTHEASTERLY LINE AT AN ELEVATION OF 16.68 FEET; THENCE NORTHWESTERLY, ALONG THE WESTERLY FACE AND ITS EXTENSION OF A BRICK WALL, 1.53 FEET TO A POINT ON THE SOUTHERLY LINE OF SAID TRACT OF LAND, AT AN ELEVATION OF 16.68 FEET; THENCE NORTHEASTERLY, ALONG SAID SOUTHERLY LINE, A SLOPE DISTANCE OF 97.43 FEET TO A POINT ON THE NORTHEASTERLY LINE OF SAID TRACT OF LAND AT AN ELEVATION OF 11.50 FEET; THENCE NORTHWESTERLY, A SLOPE DISTANCE OF 58.49 FEET TO THE POINT OF BEGINNING; ALSO EXCEPTING THAT PART OF SAID TRACT OF LAND BOUNDED AND DESCRIBED AS FOLLOWS AND LYING BELOW THE ELEVATIONS, CITY OF CHICAGO DATUM, HEREIN DESCRIBED; COMMENCING AT THE INTERSECTION OF THE NORTHEASTERLY LINE OF SAID TRACT OF LAND AND THE SOUTHEASTERLY LINE OF THE NORTHWESTERLY 58.50 FEET OF SAID TRACT OF LAND; THENCE SOUTHWESTERLY, ALONG THE SOUTHEASTERLY LINE OF THE NORTHWESTERLY 58.50 FEET, A DISTANCE OF 140.51 FEET TO A POINT HAVING AN ELEVATION OF 31.40 FEET AND THE POINT OF BEGINNING; THENCE CONTINUING SOUTHWESTERLY, ALONG THE LAST DESCRIBED LINE, A SLOPE DISTANCE OF 60.40 FEET TO A POINT HAVING AN ELEVATION OF 35.33 FEET; THENCE SOUTHWESTERLY AT AN ANGLE OF 100 DEGREES, 00 MINUTES, 00 SECONDS TO THE RIGHT WITH THE LAST DESCRIBED LINE, A SLOPE DISTANCE OF 19.85 FEET TO A POINT HAVING AN ELEVATION OF 34.01 FEET; THENCE NORTHEASTERLY, AT

UNOFFICIAL COPY

AN ANGLE OF 80 DEGREES, 00 MINUTES, 00 SECONDS TO THE RIGHT WITH THE LAST DESCRIBED LINE, A SLOPE DISTANCE OF 60.33 FEET TO A POINT HAVING AN ELEVATION OF 31.21 FEET; THENCE NORTHEASTERLY A SLOPE DISTANCE OF 19.80 FEET TO THE POINT OF BEGINNING; ALSO EXCEPTING FROM SAID TRACT OF LAND THAT PART LYING ABOVE AN ELEVATION OF 102.17 FEET OF THE NORTHEASTERLY 49.83 FEET, THAT PART LYING ABOVE AN ELEVATION OF 105.33 FEET OF THE SOUTHWESTERLY 66.00 FEET OF THE NORTHEASTERLY 115.83 FEET AND THAT PART LYING ABOVE AN ELEVATION OF 102.17 FEET EXCEPTING THE NORTHEASTERLY 115.83 FEET OF SAID TRACT OF LAND.

[Following is the legal description of a 7.58 strip of land east of the garage, owned by Eport 600 Property Owner, L.L.C.]

TRACT 3: THE EASTERLY 7.58 FEET OF THE FOLLOWING TRACT OF LAND: THAT PART OF LOTS 21, 22 AND 23, IN BLOCK 96 IN ELSTON'S ADDITION TO CHICAGO, A SUBDIVISION IN THE WEST HALF OF THE SOUTHWEST QUARTER OF SECTION 4, TOWNSHIP 39 NORTH, RANGE 14, EAST OF THE THIRD PRINCIPAL MERIDIAN, IN COOK COUNTY, ILLINOIS, LYING BETWEEN THE SOUTHWESTERLY LINE OF NORTH KINGSBURY STREET AND THE NORTH BRANCH OF THE CHICAGO RIVER, BOUNDED AND DESCRIBED AS FOLLOWS: BEGINNING ON THE SOUTHWESTERLY LINE OF NORTH KINGSBURY STREET AT A POINT 816.84 FEET NORTHWESTERLY OF THE INTERSECTION OF SAID SOUTHWESTERLY LINE OF NORTH KINGSBURY STREET AND THE WEST LINE OF NORTH LARRABEE STREET, SAID POINT BEING ALSO THE EXTENSION NORTHEASTERLY OF THE NORTHWESTERLY FACE OF FIVE (5) CONCRETE COLUMNS; THENCE SOUTHWESTERLY, AT AN ANGLE OF 89 DEGREES, 49 MINUTES, 14 SECONDS TO THE RIGHT WITH THE LAST DESCRIBED LINE, AND ALONG SAID NORTHWESTERLY FACE, 104.37 FEET TO THE NORTHERLY EXTENSION OF THE WEST FACE OF A BRICK WALL; THENCE SOUTHEASTERLY, ALONG THE WESTERLY FACE OF SAID BRICK WALL, AT AN ANGLE OF 90 DEGREES, 18 MINUTES, 00 SECONDS TO THE RIGHT WITH THE LAST DESCRIBED LINE, A DISTANCE OF 1.53 FEET TO THE NORTHWESTERLY FACE OF A 1.00 FOOT BRICK WALL; THENCE SOUTHWESTERLY, ALONG SAID NORTHWESTERLY FACE, PERPENDICULAR TO THE LAST DESCRIBED LINE, A DISTANCE OF 117.38 FEET; THENCE NORTHWESTERLY AT AN ANGLE OF 90 DEGREES, 14 MINUTES, 41 SECONDS TO THE LEFT WITH THE LAST DESCRIBED LINE 24.82 FEET; THENCE NORTHEASTERLY, PERPENDICULAR TO THE LAST DESCRIBED LINE, 8.07 FEET; THENCE NORTHWESTERLY AT AN ANGLE OF 100 DEGREES, 07 MINUTES, 04 SECONDS TO THE RIGHT WITH THE LAST DESCRIBED LINE, 95.18 FEET; THENCE NORTHEASTERLY AT AN ANGLE OF 100 DEGREES, 00 MINUTES, 00 SECONDS TO THE LEFT WITH THE LAST DESCRIBED LINE, 197.61 FEET, TO THE SOUTHWESTERLY LINE OF NORTH KINGSBURY STREET; THENCE SOUTHEASTERLY, ALONG SAID SOUTHWESTERLY LINE, 116.96 FEET TO THE POINT OF BEGINNING.

TRACT 1 AND TRACT 3 ARE PART OF P.I.N.

17-04-300-022-0000

UNOFFICIAL COPY

EPORT 600 RIVERWALK OWNER PARCELS SITES E-1 AND E-2

(Note: following legal descriptions pertain to the Riverwalk levels in the South and North Catalogue building and the strip of Riverwalk land west of the 950 Kingsbury parking garage.)

PARCEL 1 (Southern Catalog Building):

THAT PART OF LOTS 4, 5 AND 6 IN BLOCK 95 IN ELSTON'S ADDITION TO CHICAGO, IN SECTION 4, TOWNSHIP 39 NORTH, RANGE 14 EAST OF THE THIRD PRINCIPAL MERIDIAN, LYING EAST OF THE DOCK LINE OF THE NORTH BRANCH OF THE CHICAGO RIVER, LYING ABOVE AN ELEVATION OF 4.00 FEET (BEING THE FINISHED SURFACE OF THE RIVER WALK) AND BELOW AN ELEVATION OF 17.25 FEET, CITY OF CHICAGO DATUM, BOUNDED AND DESCRIBED AS FOLLOWS: BEGINNING AT THE INTERSECTION OF THE WEST FACE OF A WALL AND THE NORTH RIGHT OF WAY LINE OF CHICAGO AVENUE, BEING A POINT 172.37 FEET WEST OF THE WEST LINE OF NORTH LARRABEE STREET; THENCE NORTHERLY, ALONG SAID WEST FACE AND ITS EXTENSION, BEING A LINE FORMING AN ANGLE OF 90 DEGREES, 38 MINUTES, 47 SECONDS TO THE LEFT WITH SAID NORTH RIGHT OF WAY LINE, 55.46 FEET TO A BEND POINT; THENCE NORTHWESTERLY, ALONG A LINE FORMING AN ANGLE OF 135 DEGREES, 00 MINUTES, 00 SECONDS TO THE RIGHT WITH THE LAST DESCRIBED LINE, 24.75 FEET TO A BEND POINT; THENCE NORTHERLY, ALONG A LINE FORMING AN ANGLE OF 135 DEGREES, 00 MINUTES, 00 SECONDS TO THE LEFT WITH THE LAST DESCRIBED LINE, 87.15 FEET TO A BEND POINT; THENCE NORTHWESTERLY, ALONG A LINE FORMING AN ANGLE OF 135 DEGREES, 00 MINUTES, 00 SECONDS TO THE RIGHT WITH THE LAST DESCRIBED LINE, 24.75 FEET TO A BEND POINT; THENCE NORTHERLY, ALONG A LINE FORMING AN ANGLE OF 135 DEGREES, 00 MINUTES, 00 SECONDS TO THE LEFT WITH THE LAST DESCRIBED LINE, 57.11 FEET TO A BEND POINT; THENCE NORTHWESTERLY, ALONG A LINE FORMING AN ANGLE OF 149 DEGREES, 29 MINUTES, 58 SECONDS TO THE RIGHT WITH THE LAST DESCRIBED LINE, 58.09 FEET TO A BEND POINT; THENCE SOUTHWESTERLY, PERPENDICULAR TO THE LAST DESCRIBED LINE, 8.58 FEET TO A BEND POINT; THENCE NORTHWESTERLY, PERPENDICULAR TO THE LAST DESCRIBED LINE, 122.50 FEET TO A BEND POINT, SAID POINT TO BE REFERRED TO AS POINT "A"; THENCE SOUTHWESTERLY, PERPENDICULAR TO THE LAST DESCRIBED LINE, 9.08 FEET TO A BEND POINT, SAID POINT TO BE REFERRED TO AS POINT "B"; THENCE NORTHWESTERLY, PERPENDICULAR TO THE LAST DESCRIBED LINE, 211.72 FEET TO THE CENTER LINE OF A 1.00 FOOT BRICK WALL (SAID POINT BEING 245.00 FEET WEST OF THE WEST LINE OF NORTH KINGSBURY STREET AS MEASURED ALONG SAID CENTERLINE BEING A LINE FORMING AN ANGLE OF 89 DEGREES, 55 MINUTES, 12 SECONDS FROM SOUTHEAST TO SOUTHWEST WITH THE SOUTHWESTERLY LINE OF NORTH KINGSBURY STREET AT A POINT ON SAID SOUTHWESTERLY LINE 415.69 FEET, AS MEASURED ALONG SAID SOUTHWESTERLY LINE, NORTHWESTERLY FROM ITS INTERSECTION WITH THE WEST LINE OF NORTH LARRABEE STREET); THENCE SOUTHWESTERLY, ALONG SAID CENTERLINE AND ITS EXTENSION, BEING A LINE FORMING AN ANGLE OF 90 DEGREES, 08 MINUTES, 23 SECONDS TO THE RIGHT WITH THE LAST DESCRIBED LINE, 30.58 FEET TO THE NORTHEASTERLY DOCK LINE OF THE NORTH BRANCH OF THE CHICAGO RIVER; THENCE SOUTHEASTERLY, ALONG SAID DOCK LINE, AT AN ANGLE OF 87 DEGREES, 54 MINUTES, 34 SECONDS TO THE RIGHT WITH THE LAST DESCRIBED LINE, 181.53 FEET; THENCE CONTINUING SOUTHEASTERLY, ALONG SAID NORTHEASTERLY DOCK LINE AT AN ANGLE OF 178 DEGREES, 39 MINUTES, 02 SECONDS

UNOFFICIAL COPY

TO THE RIGHT WITH THE LAST DESCRIBED LINE, 200.22 FEET; THENCE CONTINUING, SOUTHEASTERLY, ALONG SAID NORTHEASTERLY DOCK LINE AT AN ANGLE OF 154 DEGREES, 49 MINUTES, 20 SECONDS TO THE LEFT WITH THE LAST DESCRIBED LINE, 231.02 FEET TO THE NORTH LINE OF CHICAGO AVENUE; THENCE EASTERLY, ALONG SAID NORTH LINE, 32.28 FEET TO THE POINT OF BEGINNING,

ALSO: THAT PART OF SAID LOTS 4, 5 AND 6, LYING ABOVE AN ELEVATION OF 17.25 FEET AND BELOW AN ELEVATION OF 35.00 FEET, CITY OF CHICAGO DATUM, BOUNDED AND DESCRIBED AS FOLLOWS: COMMENCING AT THE INTERSECTION OF THE NORTHEASTERLY DOCK LINE OF THE CHICAGO RIVER AND THE NORTH LINE OF CHICAGO AVENUE (SAID POINT BEING 204.65 FEET WEST OF THE WEST LINE OF LARRABEE STREET); THENCE NORTHWESTERLY, ALONG SAID DOCK LINE, 17.54 FEET TO THE NORTH FACE AND ITS EXTENSION OF A WALL AND THE POINT OF BEGINNING; THENCE EASTERLY, ALONG SAID NORTH FACE, BEING ON A LINE FORMING AN ANGLE OF 81 DEGREES, 22 MINUTES, 38 SECONDS TO THE LEFT WITH THE LAST DESCRIBED LINE, 25.91 FEET TO THE WEST FACE OF A WALL; THENCE NORTHERLY, ALONG SAID WEST FACE, PERPENDICULAR TO THE LAST DESCRIBED LINE, 46.76 FEET TO A BEND POINT; THENCE NORTHWESTERLY, ALONG A LINE FORMING AN ANGLE OF 135 DEGREES, 00 MINUTES, 00 SECONDS TO THE RIGHT WITH THE LAST DESCRIBED LINE, 12.02 FEET TO A BEND POINT; THENCE NORTHERLY, ALONG A LINE FORMING AN ANGLE OF 135 DEGREES, 00 MINUTES, 00 SECONDS TO THE LEFT WITH THE LAST DESCRIBED LINE, 87.15 FEET TO A BEND POINT; THENCE NORTHWESTERLY, ALONG A LINE FORMING AN ANGLE OF 135 DEGREES, 00 MINUTES, 00 SECONDS TO THE RIGHT WITH THE LAST DESCRIBED LINE, 24.75 FEET TO A BEND POINT; THENCE NORTH, ALONG A LINE FORMING AN ANGLE OF 135 DEGREES, 00 MINUTES, 00 SECONDS TO THE LEFT WITH THE LAST DESCRIBED LINE, 57.11 FEET TO A BEND POINT; THENCE NORTHWESTERLY, ALONG A LINE FORMING AN ANGLE OF 149 DEGREES, 29 MINUTES, 58 SECONDS TO THE RIGHT WITH THE LAST DESCRIBED LINE, 58.09 FEET TO A BEND POINT; THENCE SOUTHWESTERLY, ALONG THE FACE OF A WALL AND ITS EXTENSION, PERPENDICULAR TO THE LAST DESCRIBED LINE, 33.23 FEET TO THE AFORESAID NORTHEASTERLY DOCK LINE; THENCE SOUTHEASTERLY, ALONG SAID DOCK LINE AT AN ANGLE OF 86 DEGREES, 42 MINUTES, 00 SECONDS TO THE RIGHT WITH THE LAST DESCRIBED LINE, 47.09 FEET TO A BEND POINT; THENCE SOUTHEASTERLY, ALONG A LINE FORMING AN ANGLE OF 154 DEGREES, 49 MINUTES, 20 SECONDS TO THE LEFT WITH THE LAST DESCRIBED LINE, 213.48 FEET TO THE POINT OF BEGINNING,

ALSO: THAT PART OF SAID LOTS 4, 5 AND 6, LYING ABOVE AN ELEVATION OF 17.25 FEET AND BELOW AN ELEVATION OF 35.00 FEET, CITY OF CHICAGO DATUM, BOUNDED AND DESCRIBED AS FOLLOWS: COMMENCING AT THE AFORESAID POINT "A"; THENCE SOUTHWESTERLY 9.08 FEET TO THE AFORESAID POINT "B" AND THE POINT OF BEGINNING; THENCE NORTHWESTERLY, PERPENDICULAR TO THE LAST DESCRIBED LINE, 105.00 FEET; THENCE SOUTHWESTERLY, PERPENDICULAR TO THE LAST DESCRIBED LINE, 26.92 FEET TO THE AFORESAID NORTHEASTERLY DOCK LINE; THENCE SOUTHEASTERLY, ALONG A LINE FORMING AN ANGLE OF 88 DEGREES, 02 MINUTES, 57 SECONDS TO THE RIGHT WITH THE LAST DESCRIBED LINE, 74.66 FEET; THENCE SOUTHEASTERLY, ALONG A LINE FORMING AN ANGLE OF 178 DEGREES, 39 MINUTES, 02 SECONDS TO THE RIGHT WITH THE LAST DESCRIBED LINE, 30.43 FEET; THENCE NORTHEASTERLY, ALONG A LINE FORMING AN ANGLE OF 93 DEGREES, 18 MINUTES, 00 SECONDS TO THE RIGHT WITH THE LAST DESCRIBED LINE, 22.63 FEET TO THE POINT OF BEGINNING,

UNOFFICIAL COPY

ALSO: THAT PART OF SAID LOTS 4, 5 AND 6, LYING ABOVE AN ELEVATION OF 17.25 FEET AND BELOW AN ELEVATION OF 35.00 FEET, CITY OF CHICAGO DATUM, BOUNDED AND DESCRIBED AS FOLLOWS: COMMENCING AT THE AFORESAID POINT "A"; THENCE SOUTHWESTERLY 9.08 FEET TO THE AFORESAID POINT "B"; THENCE NORTHWESTERLY, PERPENDICULAR TO THE LAST DESCRIBED LINE, 157.50 FEET TO THE POINT OF BEGINNING; THENCE CONTINUING NORTHWESTERLY, ALONG THE PROJECTION OF THE LAST DESCRIBED LINE, 54.22 FEET TO THE CENTER LINE OF THE AFORESAID 1.0 BRICK WALL; THENCE SOUTHWESTERLY, ALONG SAID CENTERLINE AND ITS EXTENSION, BEING A LINE FORMING AN ANGLE OF 90 DEGREES, 08 MINUTES, 23 SECONDS TO THE RIGHT WITH THE LAST DESCRIBED LINE, 30.58 FEET TO THE AFORESAID NORTHEASTERLY DOCK LINE; THENCE SOUTHEASTERLY, ALONG A LINE FORMING AN ANGLE OF 87 DEGREES, 54 MINUTES, 34 SECONDS TO THE RIGHT WITH THE LAST DESCRIBED LINE, 54.33 FEET; THENCE NORTHEASTERLY, ALONG A LINE FORMING AN ANGLE OF 91 DEGREES, 57 MINUTES, 14 SECONDS TO THE RIGHT WITH THE LAST DESCRIBED LINE, 28.71 FEET TO THE POINT OF BEGINNING, IN COOK COUNTY, ILLINOIS.

PART OF PINs: 17-04-300-017-0000; 17-04-300-019-0000

AND

PARCEL 2 (Northern Catalog Building):

THAT PART OF LOTS 1, 2, 3, 4 AND 5 IN BLOCK 95 LYING EAST OF THE DOCK LINE OF THE NORTH BRANCH OF THE CHICAGO RIVER TOGETHER WITH LOTS 24, 25, 26 AND A PART OF LOT 23, IN BLOCK 96, LYING EAST OF THE DOCK LINE OF THE NORTH BRANCH OF THE CHICAGO RIVER TOGETHER WITH VACATED BRANCH STREET LYING EAST OF THE DOCK LINE OF THE NORTH BRANCH OF THE CHICAGO RIVER IN ELSTON'S ADDITION TO CHICAGO, IN SECTION 4, TOWNSHIP 39 NORTH, RANGE 14 EAST OF THE THIRD PRINCIPAL MERIDIAN, LYING ABOVE AN ELEVATION OF 4.00 FEET (BEING THE FINISHED SURFACE OF THE RIVER WALK) AND BELOW AN ELEVATION OF 17.25 FEET, CITY OF CHICAGO DATUM, BOUNDED AND DESCRIBED AS FOLLOWS: COMMENCING ON THE SOUTHWESTERLY LINE OF NORTH KINGSBURY STREET AT A POINT 816.84 FEET NORTHWESTERLY OF THE INTERSECTION OF SAID SOUTHWESTERLY LINE OF NORTH KINGSBURY STREET AND THE WEST LINE OF NORTH LARRABEE STREET, THAT POINT BEING ALSO THE EXTENSION NORTHEASTERLY OF THE NORTHWESTERLY FACE OF FIVE CONCRETE COLUMNS; THENCE SOUTHWESTERLY WITH AN ANGLE OF 89 DEGREES, 49 MINUTES, 14 SECONDS TO THE RIGHT WITH THE LAST DESCRIBED LINE, AND ALONG SAID NORTHWESTERLY FACE, 104.87 FEET TO THE NORTHERLY EXTENSION OF THE WEST FACE OF A BRICK WALL; THENCE SOUTHEASTERLY, ALONG THE WESTERLY FACE OF SAID BRICK WALL, AT AN ANGLE OF 90 DEGREES, 18 MINUTES, 00 SECONDS TO THE RIGHT WITH THE LAST DESCRIBED LINE, A DISTANCE OF 1.53 FEET TO THE NORTHWESTERLY FACE OF A 1.00 FOOT BRICK WALL, THENCE SOUTHWESTERLY, ALONG SAID NORTHWESTERLY FACE, PERPENDICULAR TO THE LAST DESCRIBED LINE 124.71 FEET TO THE WEST FACE OF A WALL, AND THE POINT OF BEGINNING; THENCE SOUTHEASTERLY ALONG SAID WEST FACE BEING ON A LINE FORMING AN ANGLE OF 89 DEGREES, 52 MINUTES, 22 SECONDS TO THE RIGHT WITH THE LAST DESCRIBED LINE, 123.29 FEET TO A POINT TO BE REFERRED TO AS POINT "A"; THENCE FOLLOWING THE FACE OF THE WALL, NORTHEASTERLY, PERPENDICULAR TO THE LAST DESCRIBED LINE, 1.38 FEET TO A BEND POINT IN SAID WALL; THENCE SOUTHEASTERLY, PERPENDICULAR TO THE LAST DESCRIBED LINE, 50.58 FEET; THENCE SOUTHWESTERLY, PERPENDICULAR TO THE LAST DESCRIBED LINE, 13.37 FEET; THENCE SOUTHEASTERLY, PERPENDICULAR

UNOFFICIAL COPY

TO THE LAST DESCRIBED LINE, 225.89 FEET TO THE CENTER LINE OF A 1.00 FOOT BRICK WALL (SAID POINT BEING 241.58 FEET WEST OF THE WEST LINE OF NORTH KINGSBURY STREET); THENCE SOUTHWESTERLY, ALONG SAID CENTERLINE AND ITS EXTENSION, BEING A LINE FORMING AN ANGLE TO THE LEFT WITH THE LAST DESCRIBED LINE OF 90 DEGREES, 04 MINUTES, 48 SECONDS, 34.00 FEET TO THE DOCK LINE OF THE NORTH BRANCH OF THE CHICAGO RIVER TO A POINT TO BE REFERRED TO AS POINT "B"; THENCE NORTHWESTERLY, ALONG SAID DOCK LINE, BEING A LINE FORMING AN ANGLE OF 92 DEGREES, 05 MINUTES, 27 SECONDS TO THE LEFT WITH THE LAST DESCRIBED LINE, 8.08 FEET TO A BEND POINT, SAID BEND POINT TO BE REFERRED TO AS POINT "C"; THENCE NORTHWESTERLY, ALONG A LINE FORMING AN ANGLE OF 176 DEGREES, 11 MINUTES, 31 SECONDS TO THE LEFT WITH THE LAST DESCRIBED LINE, 252.49 FEET TO A BEND POINT; THENCE NORTHWESTERLY, ALONG A LINE FORMING AN ANGLE OF 173 DEGREES, 39 MINUTES, 01 SECONDS TO THE LEFT WITH THE LAST DESCRIBED LINE, 140.75 FEET TO THE NORTH FACE AND ITS EXTENSION OF A BRICK WALL; THENCE NORTHEASTERLY 109.53 FEET TO THE POINT OF BEGINNING,

ALSO: THAT PART OF SAID LOTS LYING ABOVE AN ELEVATION OF 17.25 FEET AND BELOW AN ELEVATION OF 35.00 FEET, CITY OF CHICAGO DATUM, DESCRIBED AS FOLLOWS; COMMENCING AT THE AFORESAID POINT OF BEGINNING; THENCE SOUTHEASTERLY, ALONG A LINE 123.29 FEET TO THE AFORESAID POINT "A" AND POINT OF BEGINNING; THENCE NORTHEASTERLY, PERPENDICULAR TO THE LAST DESCRIBED LINE, 1.38 FEET TO A BEND POINT IN SAID WALL; THENCE SOUTHEASTERLY, PERPENDICULAR TO THE LAST DESCRIBED LINE, 50.58 FEET; THENCE SOUTHWESTERLY, PERPENDICULAR TO THE LAST DESCRIBED LINE, 17.20 FEET; THENCE SOUTHEASTERLY, PERPENDICULAR TO THE LAST DESCRIBED LINE, 89.05 FEET; THENCE SOUTHWESTERLY, PERPENDICULAR TO THE LAST DESCRIBED LINE, 5.33 FEET; THENCE SOUTHEASTERLY, PERPENDICULAR TO THE LAST DESCRIBED LINE, 15.50 FEET; THENCE SOUTHWESTERLY, 21.91 FEET TO THE AFORESAID NORTHEASTERLY DOCK LINE; THENCE NORTHWESTERLY, ALONG SAID NORTHEASTERLY DOCK LINE, BEING A LINE FORMING AN ANGLE OF 88 DEGREES, 21 MINUTES, 46 SECONDS TO THE LEFT WITH THE LAST DESCRIBED LINE, 139.14 FEET TO A BEND POINT; THENCE NORTHWESTERLY, ALONG A LINE FORMING AN ANGLE OF 173 DEGREES, 39 MINUTES, 01 SECONDS TO THE LEFT WITH THE LAST DESCRIBED LINE, 60.50 FEET; THENCE NORTHEASTERLY, ALONG A LINE FORMING AN ANGLE OF 97 DEGREES, 59 MINUTES, 14 SECONDS TO THE LEFT WITH THE LAST DESCRIBED LINE, 15.26 FEET; THENCE SOUTHEASTERLY, PERPENDICULAR TO THE LAST DESCRIBED LINE, 43.87 FEET; THENCE NORTHEASTERLY, PERPENDICULAR TO THE LAST DESCRIBED LINE, 15.42 FEET TO THE AFORESAID POINT "A" AND POINT OF BEGINNING,

ALSO: THAT PART OF SAID LOTS LYING ABOVE AN ELEVATION OF 17.25 FEET AND BELOW AN ELEVATION OF 35.00 FEET, CITY OF CHICAGO DATUM, DESCRIBED AS FOLLOWS; BEGINNING AT THE AFORESAID POINT "B"; THENCE NORTHWESTERLY, 8.08 FEET TO THE AFORESAID POINT "C", THENCE NORTHWESTERLY, ALONG A LINE FORMING AN ANGLE OF 176 DEGREES, 11 MINUTES, 31 SECONDS TO THE LEFT WITH THE LAST DESCRIBED LINE, AND ALONG THE AFORESAID NORTHEASTERLY DOCK LINE, 50.45 FEET; THENCE NORTHEASTERLY, ALONG A LINE FORMING AN ANGLE OF 91 DEGREES, 38 MINUTES, 14 SECONDS TO THE LEFT WITH THE LAST DESCRIBED LINE, 29.04 FEET; THENCE SOUTHEASTERLY, PERPENDICULAR TO THE LAST DESCRIBED LINE, 58.46 FEET TO THE CENTERLINE AND ITS EXTENSION OF THE AFORESAID BRICK WALL; THENCE SOUTHWESTERLY, ALONG A LINE FORMING AN ANGLE OF 90 DEGREES, 04 MINUTES, 48

UNOFFICIAL COPY

SECONDS TO THE LEFT WITH THE LAST DESCRIBED LINE, 30.17 FEET TO THE POINT OF BEGINNING, ALL IN COOK COUNTY, ILLINOIS.

BUT LESS AND EXCEPT FROM THE AFORESAID PARCELS 1 AND 2 THE WESTERN THREE (3) FEET OF PARCELS 1 AND 2. [Note: This exception takes out the "Marina" parcel from the Riverwalk parcel]

PART OF PINs: 17-04-300-023-0000; 17-04-300-027-0000 and 17-04-300-031-0000

Legal Description of Eport Riverwalk Owner Strip of land behind 950 Kingsbury garage

THAT PART OF LOTS 21, 22 AND 23 IN BLOCK 96 IN ELSTON'S ADDITION TO CHICAGO, A SUBDIVISION IN THE WEST HALF OF THE SOUTHWEST QUARTER OF SECTION 4, TOWNSHIP 39 NORTH, RANGE 14 EAST OF THE THIRD PRINCIPAL MERIDIAN, IN COOK COUNTY, ILLINOIS, LYING BETWEEN THE SOUTHWESTERLY LINE OF NORTH KINGSBURY STREET AND THE NORTH BRANCH OF THE CHICAGO RIVER, BOUNDED AND DESCRIBED AS FOLLOWS: COMMENCING ON THE SOUTHWESTERLY LINE OF NORTH KINGSBURY STREET AT A POINT 816.84 FEET NORTHWESTERLY OF THE INTERSECTION OF SAID SOUTHWESTERLY LINE OF NORTH KINGSBURY STREET AND THE WEST LINE OF NORTH LARRABEE STREET, SAID POINT BEING ALSO THE EXTENSION NORTHEASTERLY OF THE NORTHWESTERLY FACE OF FIVE (5) CONCRETE COLUMNS; THENCE SOUTHWESTERLY, AT AN ANGLE OF 89 DEGREES, 49 MINUTES, 14 SECONDS TO THE RIGHT WITH THE LAST DESCRIBED LINE, AND ALONG SAID NORTHWESTERLY FACE 104.87 FEET TO THE NORTHERLY EXTENSION OF THE WEST FACE OF THE BRICK WALL; THENCE SOUTHEASTERLY ALONG THE WESTERLY FACE OF SAID BRICK WALL, AT AN ANGLE OF 90 DEGREES, 18 MINUTES, 00 SECONDS TO THE RIGHT WITH THE LAST DESCRIBED LINE, A DISTANCE OF 1.53 FEET TO THE NORTHWESTERLY FACE OF A 1.00 FOOT BRICK WALL; THENCE SOUTHWESTERLY, ALONG SAID NORTHWESTERLY FACE, PERPENDICULAR TO THE LAST DESCRIBED LINE, A DISTANCE OF 117.38 FEET TO THE POINT OF BEGINNING; THENCE CONTINUING SOUTHWESTERLY ALONG THE LAST DESCRIBED LINE 26.86 FEET TO THE NORTHEASTERLY DOCK LINE OF THE NORTH BRANCH OF THE CHICAGO RIVER; THENCE NORTHWESTERLY AT AN ANGLE OF 82 DEGREES, 08 MINUTES, 24 SECONDS TO THE LEFT WITH THE LAST DESCRIBED LINE, AND ALONG SAID NORTHEASTERLY DOCK LINE, 0.99 FEET; THENCE CONTINUING ALONG SAID DOCK LINE, AT AN ANGLE OF 178 DEGREES, 24 MINUTES, 38 SECONDS TO THE LEFT WITH THE LAST DESCRIBED LINE, 119.19 FEET; THENCE NORTHEASTERLY AT AN ANGLE OF 99 DEGREES, 34 MINUTES, 36 SECONDS TO THE LEFT WITH THE LAST DESCRIBED LINE, A DISTANCE OF 31.44 FEET; THENCE SOUTHEASTERLY AT AN ANGLE OF 80 DEGREES, 00 MINUTES, 00 SECONDS TO THE LEFT WITH THE LAST DESCRIBED LINE, A DISTANCE OF 95.18 FEET; THENCE SOUTHWESTERLY AT AN ANGLE OF 100 DEGREES, 07 MINUTES, 04 SECONDS TO THE LEFT WITH THE LAST DESCRIBED LINE, 8.07 FEET; THENCE SOUTHEASTERLY, PERPENDICULAR TO THE LAST DESCRIBED LINE, 24.82 FEET TO THE POINT OF BEGINNING.

BUT LESS AND EXCEPT FROM THE AFORESAID PARCEL THE WESTERN THREE (3) FEET OF SUCH PARCEL.

PART OF PIN 17-04-300-022-0000

UNOFFICIAL COPY

**EXCERPTS FROM THE DOCUMENT GRANTING AN
EASEMENT FROM
MW-CPAG MARINA HOLDINGS, L.L.C. TO
EPORT 600 RIVERWALK OWNER, L.L.C.
OVER A MARINA PARCEL RUNNING ADJACENT TO
THE CHICAGO RIVER AND
ADJACENT TO THE RIVERWALK SITE**

**AMENDED AND RESTATED DECLARATION OF COVENANTS, CONDITIONS,
RESTRICTIONS AND EASEMENTS AND OPERATING AGREEMENT**

THIS AMENDED AND RESTATED DECLARATION OF COVENANTS, CONDITIONS, RESTRICTIONS AND EASEMENTS AND OPERATING AGREEMENT is made and entered into as of the ~~15th~~ day of October, 2002 (the "Effective Date"), by and among ~~EPORT 600 PROPERTY OWNER, L.L.C.~~, a Delaware limited liability company ("Eport") (in its capacity as owner of the Owner A Property (as hereinafter defined)), ~~DOMAIN OWNER, L.L.C.~~, a Delaware limited liability company ("Domain") (in its capacity as partial owner of the Owner B Property (as hereinafter defined)), MW-CPAG HOLDINGS, L.L.C., a Delaware limited liability company ("MW-CPAG") (in its capacity as owner of the Owner C Property (as hereinafter defined)), EPORT 600 RIVERWALK OWNER, L.L.C., a Delaware limited liability company ("Eport Riverwalk Owner") (in its capacity as owner of the Owner D Property (as hereinafter defined)), MW-CPAG MARINA HOLDINGS, L.L.C., a Delaware limited liability company ("Marina") (in its capacity as owner of the Owner E Property (as hereinafter defined)) and DOMAIN CONDOMINIUM ASSOCIATION, an Illinois not-for-profit corporation ("Domain Cond.") (in its capacity as the condominium association for a portion of the Owner B Property).

...

6.2 Grant of Easements. The following Easements in favor of the Owner D Property are hereby granted:

...

(k) Riverwalk.

...

(ii) Owner E hereby grants in favor of Owner D and the general public a non-exclusive easement for ingress and egress for Persons in, over, on, across and through the Owner E Property to permit access to and from the Riverwalk. Owner D acknowledges and agrees that it is currently intended that the Owner D Property be renovated and developed by Owner D to become a Riverwalk and if such Riverwalk is not constructed as contemplated by Section 27 then this Easement shall be limited to providing access to and from the retail facilities and/or restaurants located in the Owner A Catalog Building but which are adjacent to and/or abut the Owner D Property and providing emergency exit and access through the Owner E Property from the Owner D Property.

(iii) Owner E hereby grants to Owner D an exclusive easement on, over and across such portion of the Owner E Property on which all or any portion of the Riverwalk is constructed pursuant to the Riverwalk Plans and/or Marina Plans for the use, construction, replacement and Maintenance of the Riverwalk (it being acknowledged that (x) portions of the Riverwalk may be constructed on the Owner E Property as contemplated by the Riverwalk Plans and/or Marina Plans and (y) Owner D shall be responsible for the Maintenance of the Riverwalk as set forth in Section 9.1).

UNOFFICIAL COPY

MW-CPAG MARINA HOLDINGS, L.L.C.

RIVERWALK SITE EASEMENT PARCEL

THE WESTERN THREE (3) FEET OF [THE RIVERWALK] THE FOLLOWING PARCEL 1, PARCEL 2 and PARCEL 3

PARCEL 1 (Southern Catalog Building):

THAT PART OF LOTS 4, 5 AND 6 IN BLOCK 95 IN ELSTON'S ADDITION TO CHICAGO, IN SECTION 4, TOWNSHIP 39 NORTH, RANGE 14 EAST OF THE THIRD PRINCIPAL MERIDIAN, LYING EAST OF THE DOCK LINE OF THE NORTH BRANCH OF THE CHICAGO RIVER, LYING ABOVE AN ELEVATION OF 4.00 FEET (BEING THE FINISHED SURFACE OF THE RIVER WALK) AND BELOW AN ELEVATION OF 17.25 FEET, CITY OF CHICAGO DATUM, BOUNDED AND DESCRIBED AS FOLLOWS: BEGINNING AT THE INTERSECTION OF THE WEST FACE OF A WALL AND THE NORTH RIGHT OF WAY LINE OF CHICAGO AVENUE, BEING A POINT 172.37 FEET WEST OF THE WEST LINE OF NORTH LARRABEE STREET; THENCE NORTHERLY, ALONG SAID WEST FACE AND ITS EXTENSION, BEING A LINE FORMING AN ANGLE OF 90 DEGREES, 18 MINUTES, 47 SECONDS TO THE LEFT WITH SAID NORTH RIGHT OF WAY LINE, 55.46 FEET TO A BEND POINT; THENCE NORTHWESTERLY, ALONG A LINE FORMING AN ANGLE OF 135 DEGREES, 00 MINUTES, 00 SECONDS TO THE RIGHT WITH THE LAST DESCRIBED LINE, 24.75 FEET TO A BEND POINT; THENCE NORTHERLY, ALONG A LINE FORMING AN ANGLE OF 135 DEGREES, 00 MINUTES, 00 SECONDS TO THE LEFT WITH THE LAST DESCRIBED LINE, 87.15 FEET TO A BEND POINT; THENCE NORTHWESTERLY, ALONG A LINE FORMING AN ANGLE OF 135 DEGREES, 00 MINUTES, 00 SECONDS TO THE RIGHT WITH THE LAST DESCRIBED LINE, 24.75 FEET TO A BEND POINT; THENCE NORTHERLY, ALONG A LINE FORMING AN ANGLE OF 135 DEGREES, 00 MINUTES, 00 SECONDS TO THE LEFT WITH THE LAST DESCRIBED LINE, 57.11 FEET TO A BEND POINT; THENCE NORTHWESTERLY, ALONG A LINE FORMING AN ANGLE OF 149 DEGREES, 29 MINUTES, 58 SECONDS TO THE RIGHT WITH THE LAST DESCRIBED LINE, 58.09 FEET TO A BEND POINT; THENCE SOUTHWESTERLY, PERPENDICULAR TO THE LAST DESCRIBED LINE, 8.58 FEET TO A BEND POINT; THENCE NORTHWESTERLY, PERPENDICULAR TO THE LAST DESCRIBED LINE, 122.50 FEET TO A BEND POINT, SAID POINT TO BE REFERRED TO AS POINT "A"; THENCE SOUTHWESTERLY, PERPENDICULAR TO THE LAST DESCRIBED LINE, 9.08 FEET TO A BEND POINT, SAID POINT TO BE REFERRED TO AS POINT "B"; THENCE NORTHWESTERLY, PERPENDICULAR TO THE LAST DESCRIBED LINE, 211.72 FEET TO THE CENTER LINE OF A 1.00 FOOT BRICK WALL (SAID POINT BEING 245.00 FEET WEST OF THE WEST LINE OF NORTH KINGSBURY STREET AS MEASURED ALONG SAID CENTERLINE BEING A LINE FORMING AN ANGLE OF 89 DEGREES, 55 MINUTES, 12 SECONDS FROM SOUTHEAST TO SOUTHWEST WITH THE SOUTHWESTERLY LINE OF NORTH KINGSBURY STREET AT A POINT ON SAID SOUTHWESTERLY LINE 415.69 FEET, AS MEASURED ALONG SAID SOUTHWESTERLY LINE, NORTHWESTERLY FROM ITS INTERSECTION WITH THE WEST LINE OF NORTH LARRABEE STREET); THENCE SOUTHWESTERLY, ALONG SAID CENTERLINE AND ITS EXTENSION, BEING A LINE FORMING AN ANGLE OF 90 DEGREES, 08 MINUTES, 23 SECONDS TO THE RIGHT WITH THE LAST DESCRIBED LINE, 30.58 FEET TO THE NORTHEASTERLY DOCK LINE OF THE NORTH BRANCH OF THE CHICAGO RIVER; THENCE SOUTHEASTERLY, ALONG SAID DOCK LINE, AT AN ANGLE OF 87 DEGREES, 54 MINUTES, 34 SECONDS TO THE RIGHT WITH THE LAST DESCRIBED LINE, 181.53 FEET; THENCE CONTINUING SOUTHEASTERLY, ALONG SAID NORTHEASTERLY DOCK LINE AT AN ANGLE OF 178 DEGREES, 39 MINUTES, 02 SECONDS TO THE RIGHT WITH THE LAST DESCRIBED LINE, 200.22 FEET; THENCE CONTINUING,

UNOFFICIAL COPY

SOUTHEASTERLY, ALONG SAID NORTHEASTERLY DOCK LINE AT AN ANGLE OF 154 DEGREES, 49 MINUTES, 20 SECONDS TO THE LEFT WITH THE LAST DESCRIBED LINE, 231.02 FEET TO THE NORTH LINE OF CHICAGO AVENUE; THENCE EASTERLY, ALONG SAID NORTH LINE, 32.28 FEET TO THE POINT OF BEGINNING,

ALSO: THAT PART OF SAID LOTS 4, 5 AND 6, LYING ABOVE AN ELEVATION OF 17.25 FEET AND BELOW AN ELEVATION OF 35.00 FEET, CITY OF CHICAGO DATUM, BOUNDED AND DESCRIBED AS FOLLOWS: COMMENCING AT THE INTERSECTION OF THE NORTHEASTERLY DOCK LINE OF THE CHICAGO RIVER AND THE NORTH LINE OF CHICAGO AVENUE (SAID POINT BEING 204.65 FEET WEST OF THE WEST LINE OF LARRABEE STREET); THENCE NORTHWESTERLY, ALONG SAID DOCK LINE, 17.54 FEET TO THE NORTH FACE AND ITS EXTENSION OF A WALL AND THE POINT OF BEGINNING; THENCE EASTERLY, ALONG SAID NORTH FACE, BEING ON A LINE FORMING AN ANGLE OF 81 DEGREES, 22 MINUTES, 38 SECONDS TO THE LEFT WITH THE LAST DESCRIBED LINE, 25.91 FEET TO THE WEST FACE OF A WALL; THENCE NORTHERLY, ALONG SAID WEST FACE, PERPENDICULAR TO THE LAST DESCRIBED LINE, 46.76 FEET TO A BEND POINT; THENCE NORTHWESTERLY, ALONG A LINE FORMING AN ANGLE OF 135 DEGREES, 00 MINUTES, 00 SECONDS TO THE RIGHT WITH THE LAST DESCRIBED LINE, 12.02 FEET TO A BEND POINT; THENCE NORTHERLY, ALONG A LINE FORMING AN ANGLE OF 135 DEGREES, 00 MINUTES, 00 SECONDS TO THE LEFT WITH THE LAST DESCRIBED LINE, 87.15 FEET TO A BEND POINT; THENCE NORTHWESTERLY, ALONG A LINE FORMING AN ANGLE OF 135 DEGREES, 00 MINUTES, 00 SECONDS TO THE RIGHT WITH THE LAST DESCRIBED LINE, 24.75 FEET TO A BEND POINT; THENCE NORTH, ALONG A LINE FORMING AN ANGLE OF 135 DEGREES, 00 MINUTES, 00 SECONDS TO THE LEFT WITH THE LAST DESCRIBED LINE, 57.11 FEET TO A BEND POINT; THENCE NORTHWESTERLY, ALONG A LINE FORMING AN ANGLE OF 149 DEGREES, 29 MINUTES, 58 SECONDS TO THE RIGHT WITH THE LAST DESCRIBED LINE, 58.09 FEET TO A BEND POINT, THENCE SOUTHWESTERLY, ALONG THE FACE OF A WALL AND ITS EXTENSION, PERPENDICULAR TO THE LAST DESCRIBED LINE, 33.23 FEET TO THE AFORESAID NORTHEASTERLY DOCK LINE; THENCE SOUTHEASTERLY, ALONG SAID DOCK LINE AT AN ANGLE OF 86 DEGREES, 42 MINUTES, 00 SECONDS TO THE RIGHT WITH THE LAST DESCRIBED LINE, 47.09 FEET TO A BEND POINT; THENCE SOUTHEASTERLY, ALONG A LINE FORMING AN ANGLE OF 154 DEGREES, 49 MINUTES, 20 SECONDS TO THE LEFT WITH THE LAST DESCRIBED LINE, 213.48 FEET TO THE POINT OF BEGINNING,

ALSO: THAT PART OF SAID LOTS 4, 5 AND 6, LYING ABOVE AN ELEVATION OF 17.25 FEET AND BELOW AN ELEVATION OF 35.00 FEET, CITY OF CHICAGO DATUM, BOUNDED AND DESCRIBED AS FOLLOWS: COMMENCING AT THE AFORESAID POINT "A"; THENCE SOUTHWESTERLY 9.08 FEET TO THE AFORESAID POINT "B" AND THE POINT OF BEGINNING; THENCE NORTHWESTERLY, PERPENDICULAR TO THE LAST DESCRIBED LINE, 105.00 FEET; THENCE SOUTHWESTERLY, PERPENDICULAR TO THE LAST DESCRIBED LINE, 26.92 FEET TO THE AFORESAID NORTHEASTERLY DOCK LINE; THENCE SOUTHEASTERLY, ALONG A LINE FORMING AN ANGLE OF 88 DEGREES, 02 MINUTES, 57 SECONDS TO THE RIGHT WITH THE LAST DESCRIBED LINE, 74.66 FEET; THENCE SOUTHEASTERLY, ALONG A LINE FORMING AN ANGLE OF 178 DEGREES, 39 MINUTES, 02 SECONDS TO THE RIGHT WITH THE LAST DESCRIBED LINE, 30.43 FEET; THENCE NORTHEASTERLY, ALONG A LINE FORMING AN ANGLE OF 93 DEGREES, 18 MINUTES, 00 SECONDS TO THE RIGHT WITH THE LAST DESCRIBED LINE, 22.63 FEET TO THE POINT OF BEGINNING,

UNOFFICIAL COPY

ALSO: THAT PART OF SAID LOTS 4, 5 AND 6, LYING ABOVE AN ELEVATION OF 17.25 FEET AND BELOW AN ELEVATION OF 35.00 FEET, CITY OF CHICAGO DATUM, BOUNDED AND DESCRIBED AS FOLLOWS: COMMENCING AT THE AFORESAID POINT "A"; THENCE SOUTHWESTERLY 9.08 FEET TO THE AFORESAID POINT "B"; THENCE NORTHWESTERLY, PERPENDICULAR TO THE LAST DESCRIBED LINE, 157.50 FEET TO THE POINT OF BEGINNING; THENCE CONTINUING NORTHWESTERLY, ALONG THE PROJECTION OF THE LAST DESCRIBED LINE, 54.22 FEET TO THE CENTER LINE OF THE AFORESAID 1.0 BRICK WALL; THENCE SOUTHWESTERLY, ALONG SAID CENTERLINE AND ITS EXTENSION, BEING A LINE FORMING AN ANGLE OF 90 DEGREES, 08 MINUTES, 23 SECONDS TO THE RIGHT WITH THE LAST DESCRIBED LINE, 30.58 FEET TO THE AFORESAID NORTHEASTERLY DOCK LINE; THENCE SOUTHEASTERLY, ALONG A LINE FORMING AN ANGLE OF 87 DEGREES, 54 MINUTES, 34 SECONDS TO THE RIGHT WITH THE LAST DESCRIBED LINE, 54.33 FEET; THENCE NORTHEASTERLY, ALONG A LINE FORMING AN ANGLE OF 91 DEGREES, 57 MINUTES, 14 SECONDS TO THE RIGHT WITH THE LAST DESCRIBED LINE, 23.71 FEET TO THE POINT OF BEGINNING, IN COOK COUNTY, ILLINOIS.

PART OF PINs: 17-04-300-017-0000; 17-04-300-019-0000

AND

PARCEL 2 (Northern Catalog Building):

THAT PART OF LOTS 1, 2, 3, 4 AND 5 IN BLOCK 95 LYING EAST OF THE DOCK LINE OF THE NORTH BRANCH OF THE CHICAGO RIVER TOGETHER WITH LOTS 24, 25, 26 AND A PART OF LOT 23, IN BLOCK 96, LYING EAST OF THE DOCK LINE OF THE NORTH BRANCH OF THE CHICAGO RIVER TOGETHER WITH VACATED BRANCH STREET LYING EAST OF THE DOCK LINE OF THE NORTH BRANCH OF THE CHICAGO RIVER IN ELSTON'S ADDITION TO CHICAGO, IN SECTION 4, TOWNSHIP 39 NORTH, RANGE 14 EAST OF THE THIRD PRINCIPAL MERIDIAN, LYING ABOVE AN ELEVATION OF 4.00 FEET (BEING THE FINISHED SURFACE OF THE RIVER WALK) AND BELOW AN ELEVATION OF 17.25 FEET, CITY OF CHICAGO DATUM, BOUNDED AND DESCRIBED AS FOLLOWS: COMMENCING ON THE SOUTHWESTERLY LINE OF NORTH KINGSBURY STREET AT A POINT 816.84 FEET NORTHWESTERLY OF THE INTERSECTION OF SAID SOUTHWESTERLY LINE OF NORTH KINGSBURY STREET AND THE WEST LINE OF NORTH LARRABEE STREET, THAT POINT BEING ALSO THE EXTENSION NORTHEASTERLY OF THE NORTHWESTERLY FACE OF FIVE CONCRETE COLUMNS; THENCE SOUTHWESTERLY WITH AN ANGLE OF 59 DEGREES, 49 MINUTES, 14 SECONDS TO THE RIGHT WITH THE LAST DESCRIBED LINE, AND ALONG SAID NORTHWESTERLY FACE, 104.87 FEET TO THE NORTHERLY EXTENSION OF THE WEST FACE OF A BRICK WALL; THENCE SOUTHEASTERLY, ALONG THE WESTERLY FACE OF SAID BRICK WALL, AT AN ANGLE OF 90 DEGREES, 18 MINUTES, 00 SECONDS TO THE RIGHT WITH THE LAST DESCRIBED LINE, A DISTANCE OF 1.53 FEET TO THE NORTHWESTERLY FACE OF A 1.00 FOOT BRICK WALL, THENCE SOUTHWESTERLY, ALONG SAID NORTHWESTERLY FACE, PERPENDICULAR TO THE LAST DESCRIBED LINE 124.71 FEET TO THE WEST FACE OF A WALL, AND THE POINT OF BEGINNING; THENCE SOUTHEASTERLY ALONG SAID WEST, FACE BEING ON A LINE FORMING AN ANGLE OF 89 DEGREES, 52 MINUTES, 22 SECONDS TO THE RIGHT WITH THE LAST DESCRIBED LINE, 123.29 FEET TO A POINT TO BE REFERRED TO AS POINT "A"; THENCE FOLLOWING THE FACE OF THE WALL, NORTHEASTERLY, PERPENDICULAR TO THE LAST DESCRIBED LINE, 1.38 FEET TO A BEND POINT IN SAID WALL; THENCE SOUTHEASTERLY, PERPENDICULAR TO THE LAST DESCRIBED LINE, 50.58 FEET; THENCE SOUTHWESTERLY, PERPENDICULAR TO THE LAST DESCRIBED LINE, 13.37 FEET; THENCE SOUTHEASTERLY, PERPENDICULAR

UNOFFICIAL COPY

TO THE LAST DESCRIBED LINE, 225.89 FEET TO THE CENTER LINE OF A 1.00 FOOT BRICK WALL (SAID POINT BEING 241.58 FEET WEST OF THE WEST LINE OF NORTH KINGSBURY STREET); THENCE SOUTHWESTERLY, ALONG SAID CENTERLINE AND ITS EXTENSION, BEING A LINE FORMING AN ANGLE TO THE LEFT WITH THE LAST DESCRIBED LINE OF 90 DEGREES, 04 MINUTES, 48 SECONDS, 34.00 FEET TO THE DOCK LINE OF THE NORTH BRANCH OF THE CHICAGO RIVER TO A POINT TO BE REFERRED TO AS POINT "B"; THENCE NORTHWESTERLY, ALONG SAID DOCK LINE, BEING A LINE FORMING AN ANGLE OF 92 DEGREES, 05 MINUTES, 27 SECONDS TO THE LEFT WITH THE LAST DESCRIBED LINE, 8.08 FEET TO A BEND POINT, SAID BEND POINT TO BE REFERRED TO AS POINT "C"; THENCE NORTHWESTERLY, ALONG A LINE FORMING AN ANGLE OF 176 DEGREES, 11 MINUTES, 31 SECONDS TO THE LEFT WITH THE LAST DESCRIBED LINE, 252.49 FEET TO A BEND POINT; THENCE NORTHWESTERLY, ALONG A LINE FORMING AN ANGLE OF 173 DEGREES, 39 MINUTES, 01 SECONDS TO THE LEFT WITH THE LAST DESCRIBED LINE, 140.75 FEET TO THE NORTH FACE AND ITS EXTENSION OF A BRICK WALL; THENCE NORTHEASTERLY, 19.53 FEET TO THE POINT OF BEGINNING,

ALSO: THAT PART OF SAID LOTS LYING ABOVE AN ELEVATION OF 17.25 FEET AND BELOW AN ELEVATION OF 35.00 FEET, CITY OF CHICAGO DATUM, DESCRIBED AS FOLLOWS; COMMENCING AT THE AFORESAID POINT OF BEGINNING; THENCE SOUTHEASTERLY, ALONG A LINE 123.29 FEET TO THE AFORESAID POINT "A" AND POINT OF BEGINNING; THENCE NORTHEASTERLY, PERPENDICULAR TO THE LAST DESCRIBED LINE, 1.38 FEET TO A BEND POINT IN SAID WALL; THENCE SOUTHEASTERLY, PERPENDICULAR TO THE LAST DESCRIBED LINE, 50.58 FEET; THENCE SOUTHWESTERLY, PERPENDICULAR TO THE LAST DESCRIBED LINE, 17.20 FEET; THENCE SOUTHEASTERLY, PERPENDICULAR TO THE LAST DESCRIBED LINE, 89.05 FEET; THENCE SOUTHWESTERLY, PERPENDICULAR TO THE LAST DESCRIBED LINE, 5.33 FEET; THENCE SOUTHEASTERLY, PERPENDICULAR TO THE LAST DESCRIBED LINE, 15.50 FEET; THENCE SOUTHWESTERLY, 21.91 FEET TO THE AFORESAID NORTHEASTERLY DOCK LINE; THENCE NORTHWESTERLY, ALONG SAID NORTHEASTERLY DOCK LINE, BEING A LINE FORMING AN ANGLE OF 88 DEGREES, 21 MINUTES, 46 SECONDS TO THE LEFT WITH THE LAST DESCRIBED LINE, 139.14 FEET TO A BEND POINT; THENCE NORTHWESTERLY, ALONG A LINE FORMING AN ANGLE OF 173 DEGREES, 39 MINUTES, 01 SECONDS TO THE LEFT WITH THE LAST DESCRIBED LINE, 60.50 FEET; THENCE NORTHEASTERLY, ALONG A LINE FORMING AN ANGLE OF 97 DEGREES, 59 MINUTES, 14 SECONDS TO THE LEFT WITH THE LAST DESCRIBED LINE, 15.26 FEET; THENCE SOUTHEASTERLY, PERPENDICULAR TO THE LAST DESCRIBED LINE, 43.87 FEET; THENCE NORTHEASTERLY, PERPENDICULAR TO THE LAST DESCRIBED LINE, 15.42 FEET TO THE AFORESAID POINT "A" AND POINT OF BEGINNING,

ALSO: THAT PART OF SAID LOTS LYING ABOVE AN ELEVATION OF 17.25 FEET AND BELOW AN ELEVATION OF 35.00 FEET, CITY OF CHICAGO DATUM, DESCRIBED AS FOLLOWS; BEGINNING AT THE AFORESAID POINT "B"; THENCE NORTHWESTERLY, 8.08 FEET TO THE AFORESAID POINT "C", THENCE NORTHWESTERLY, ALONG A LINE FORMING AN ANGLE OF 176 DEGREES, 11 MINUTES, 31 SECONDS TO THE LEFT WITH THE LAST DESCRIBED LINE, AND ALONG THE AFORESAID NORTHEASTERLY DOCK LINE, 50.45 FEET; THENCE NORTHEASTERLY, ALONG A LINE FORMING AN ANGLE OF 91 DEGREES, 38 MINUTES, 14 SECONDS TO THE LEFT WITH THE LAST DESCRIBED LINE, 29.04 FEET; THENCE SOUTHEASTERLY, PERPENDICULAR TO THE LAST DESCRIBED LINE, 58.46 FEET TO THE CENTERLINE AND ITS EXTENSION OF THE AFORESAID BRICK WALL; THENCE SOUTHWESTERLY, ALONG A LINE FORMING AN ANGLE OF 90 DEGREES, 04 MINUTES, 48

UNOFFICIAL COPY

SECONDS TO THE LEFT WITH THE LAST DESCRIBED LINE, 30.17 FEET TO THE POINT OF BEGINNING, ALL IN COOK COUNTY, ILLINOIS.

PART OF PINs: 17-04-300-023-0000; 17-04-300-027-0000 and 17-04-300-031-0000

PARCEL 3 (Riverwalk behind the 950 N. Kingsbury Parking Garage)

THAT PART OF LOTS 21, 22 AND 23 IN BLOCK 96 IN ELSTON'S ADDITION TO CHICAGO, A SUBDIVISION IN THE WEST HALF OF THE SOUTHWEST QUARTER OF SECTION 4, TOWNSHIP 39 NORTH, RANGE 14 EAST OF THE THIRD PRINCIPAL MERIDIAN, IN COOK COUNTY, ILLINOIS, LYING BETWEEN THE SOUTHWESTERLY LINE OF NORTH KINGSBURY STREET AND THE NORTH BRANCH OF THE CHICAGO RIVER, BOUNDED AND DESCRIBED AS FOLLOWS: COMMENCING ON THE SOUTHWESTERLY LINE OF NORTH KINGSBURY STREET AT A POINT 816.84 FEET NORTHWESTERLY OF THE INTERSECTION OF SAID SOUTHWESTERLY LINE OF NORTH KINGSBURY STREET AND THE WEST LINE OF NORTH LARRABEE STREET, SAID POINT BEING ALSO THE EXTENSION NORTHEASTERLY OF THE NORTHWESTERLY FACE OF FIVE (5) CONCRETE COLUMNS; THENCE SOUTHWESTERLY, AT AN ANGLE OF 89 DEGREES, 49 MINUTES, 14 SECONDS TO THE RIGHT WITH THE LAST DESCRIBED LINE, AND ALONG SAID NORTHWESTERLY FACE 104.87 FEET TO THE NORTHERLY EXTENSION OF THE WEST FACE OF THE BRICK WALL; THENCE SOUTHEASTERLY ALONG THE WESTERLY FACE OF SAID BRICK WALL, AT AN ANGLE OF 90 DEGREES, 18 MINUTES, 00 SECONDS TO THE RIGHT WITH THE LAST DESCRIBED LINE, A DISTANCE OF 1.53 FEET TO THE NORTHWESTERLY FACE OF A 1.00 FOOT BRICK WALL; THENCE SOUTHWESTERLY, ALONG SAID NORTHWESTERLY FACE, PERPENDICULAR TO THE LAST DESCRIBED LINE, A DISTANCE OF 117.38 FEET TO THE POINT OF BEGINNING; THENCE CONTINUING SOUTHWESTERLY ALONG THE LAST DESCRIBED LINE 26.86 FEET TO THE NORTHEASTERLY DOCK LINE OF THE NORTH BRANCH OF THE CHICAGO RIVER; THENCE NORTHWESTERLY AT AN ANGLE OF 82 DEGREES, 08 MINUTES, 24 SECONDS TO THE LEFT WITH THE LAST DESCRIBED LINE, AND ALONG SAID NORTHEASTERLY DOCK LINE, 0.99 FEET; THENCE CONTINUING ALONG SAID DOCK LINE, AT AN ANGLE OF 178 DEGREES, 24 MINUTES, 38 SECONDS TO THE LEFT WITH THE LAST DESCRIBED LINE, 119.19 FEET; THENCE NORTHEASTERLY AT AN ANGLE OF 59 DEGREES, 34 MINUTES, 36 SECONDS TO THE LEFT WITH THE LAST DESCRIBED LINE, A DISTANCE OF 31.44 FEET; THENCE SOUTHEASTERLY AT AN ANGLE OF 80 DEGREES, 00 MINUTES, 00 SECONDS TO THE LEFT WITH THE LAST DESCRIBED LINE, A DISTANCE OF 95.8 FEET; THENCE SOUTHWESTERLY AT AN ANGLE OF 100 DEGREES, 07 MINUTES, 04 SECONDS TO THE LEFT WITH THE LAST DESCRIBED LINE, 8.07 FEET; THENCE SOUTHEASTERLY, PERPENDICULAR TO THE LAST DESCRIBED LINE, 24.82 FEET TO THE POINT OF BEGINNING.

PART OF PIN 17-04-300-022-0000