

UNOFFICIAL COPY

94050715

74-05359

This Indenture, made this 30th day of November A.D. 1994 between LaSalle National Trust, N.A. a national banking association Chicago, Illinois as Trustee under the provisions of a Deed or Deeds in Trust, duly recorded and delivered to said Bank in pursuance of a trust agreement dated the 3rd day of January 1992 and known as Trust Number 116838 (the Trustee) and **JEFFREY EISERMAN and HEATHER EISERMAN, his wife, not as joint tenants, nor as tenants in common but as TENANTS BY THE ENTIRETY** (the "Grantee(s)")

(Address of Grantee(s)) 257 East Delaware, #9B
Chicago, Illinois 60611

Witnesseth, that the Trustee, in consideration of the sum of _____
 _____ TEN AND NO/100TH _____ Dollars (\$ 10.00)

and other good and valuable considerations in hand paid, does hereby grant, sell and convey unto the Grantee(s), the following described real estate, situated in Cook County, Illinois, to wit

For the legal description see attached rider, which is expressly incorporated herein and made a part hereof.
 (Exhibit "A")

Property Address 656-60 North Peoria, Unit 2 North
Chicago, Illinois 60622

Permanent Index Number: See attached Exhibit "A"

DEPT-01 RECORDING \$25.50
 T#0011 TRAN 4964 12/16/94 13:51:00
 #3115 + RV *-04-050715
 COOK COUNTY RECORDER

together with the tenements and appurtenances thereunto belonging

To Have And To Hold the same unto the Grantee(s) as aforesaid and to the proper use, benefit and behoof of the Grantee(s) forever.

SUBJECT TO: See attached Exhibit "A"

04050715

This Deed is executed pursuant to and in the exercise of the power and authority granted to and vested in said Trustee by the terms of said Deed or Deeds in Trust delivered to said Trustee in pursuance of the trust agreement above mentioned. This Deed is made subject to the lien of every Trust Deed or Mortgage (if any there be) of record in said county affecting the said real estate or any part thereof given to secure the payment of money and remaining unreleased at the date of the delivery hereof.

In Witness Whereof, the Trustee has caused its corporate seal to be hereto affixed, and has caused its name to be signed to these presents by its ~~Assistant~~ Vice President and attested by its Assistant Secretary, the day and year first above written

Attest:

LaSalle National Trust, N.A.
 as Trustee as aforesaid.

Nancy A. Stack
 Assistant Secretary

By [Signature]
~~Assistant~~ Vice President

| | |
|---|---|
| This instrument was prepared by <u>Nancy A. Stack (jf)</u> | LaSalle National Trust, N.A. Real Estate Trust Department 135 South LaSalle Street Chicago, Illinois 60603-4192 |
|---|---|

2350
[Signature]

LAWYERS TITLE INSURANCE CORPORATION

UNOFFICIAL COPY

State of Illinois
County of Cook

} SS:

the undersigned

a Notary Public in and for said County

in the State aforesaid. **Do Hereby Certify** that

Corinne Bek

~~Assistant~~ Vice President of LaSalle National Trust, N.A. and

Nancy A. Stack

Assistant Secretary thereof, personally known to me to be the same persons whose names are subscribed to the foregoing instrument as such ~~Assistant~~ Vice President and Assistant Secretary respectively, appeared before me this day in person and acknowledged that they signed and delivered said instrument as their own free and voluntary act, and as the free and voluntary act of said Trustee, for the uses and purposes therein set forth; and said Assistant Secretary did also then and there acknowledge that ~~she~~ as custodian of the corporate seal of said Trustee did affix said corporate seal of said Trustee to said instrument as ~~her~~ own free and voluntary act, and as the free and voluntary act of said Trustee for the uses and purposes therein set forth.

Given under my hand and Notarial Seal this 30th day of November, A D 19 94

Patricia E. Edge
Notary Public

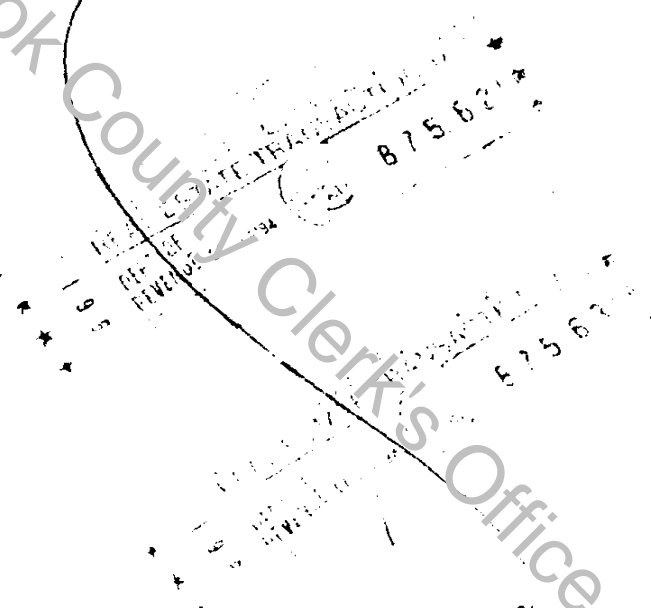
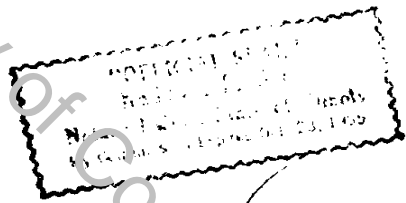

04020719

Box No.

TRUSTEE'S DEED

Address of Party

LaSalle National Trust, N.A.

Trustee
To

MAIL TO:

KEVIN CAREY ATTORNEY AT LAW
1415 W. 55TH
LAGRANGE, IL. 60525

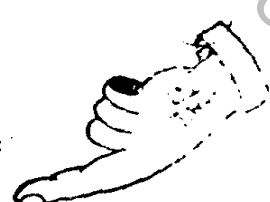

LaSalle National Trust, N.A.
135 South LaSalle Street
Chicago, Illinois 60603-4192

UNOFFICIAL COPY

EXHIBIT "A"

Legal Description

Unit 2 North
656-60 North Peoria Street
Chicago, Illinois 60622

PARCEL 1

Unit 2 North in River West Courts, being more specifically described as follows
The East 20 67 feet of the West 103 68 feet of the North 36 00 feet of the South
97 25 feet of Lots 18, 19, 20 and 21 (taken as a tract), in Block 11, in Phillips and
Fay's Addition to Chicago, containing 3 acres, in the Northeast 1/4 of Section 8,
Township 39 North, Range 14, East of the Third Principal Meridian, in Cook County,
Illinois.

PARCEL 2

Perpetual Easement for Parking over

The East 10 34 feet of the West 93 35 feet of the South 21 67 feet (lying between
plane elevations of +13 61 feet and +22 51 feet, City of Chicago Datum), of Lots 18,
19, 20 and 21 (taken as a tract) in Block 11, in Phillips and Fay's Addition to Chicago,
containing 3 acres, in the Northeast 1/4 of Section 8, Township 39 North, Range 14,
East of the Third Principal Meridian, in Cook County, Illinois

Subject to general real estate taxes not due and payable at the time of closing, the
Association documents, including all amendments and exhibits thereto, applicable
zoning and building laws and ordinances, covenants, conditions and restrictions of
record, public and utility easements, encroachments, of not greater than one foot over
public alleys and/or sidewalks, rights, if any, of persons providing private television
services, acts done or suffered by Purchaser or anyone claiming by, through or under
Purchaser, and any other matters which shall be insured over by the title insurer.

PINS 17-08-221-016
 17-08-221-017
 17-08-221-018
 17-08-221-019
 17-08-221-020

040510735