

UNOFFICIAL COPY



0412016131

Doc#: 0412016131
Eugene "Gene" Moore Fee: \$58.50
Cook County Recorder of Deeds
Date: 04/29/2004 10:34 AM Pg: 1 of 5

When Recorded, Return to:
PEELLE ASSIGNMENT DIVISION
P.O. BOX 30014
RENO, NV 89520-3014

JOB # 9870
Mortgage # 100129100016185
Mortgage # 10012910001637

Prepared By:
NEW CENTURY MORTGAGE CORPORATION
18400 VON KARMAN, SUITE 1000
IRVINE, CA 92612
Loan Number: 0001033939

ASSIGNMENT OF MORTGAGE

12-031

For Value Received, the undersigned holder of a Mortgage (herein "Assignor") whose address is
18400 VON KARMAN, SUITE 1000, IRVINE, CA 92612
does hereby grant, sell, assign, transfer and convey unto

8686118
4773

a corporation organized and existing under the laws of
whose address is
a certain Mortgage dated August 15, 2003
DONALD TOBEL

(herein "Assignee"),

, made and executed by

to and in favor of NEW CENTURY MORTGAGE CORPORATION
property situated in COOK
SEE LEGAL DESCRIPTION ATTACHED HERETO AND MADE A PART HEREOF.

upon the following described
County, State of Illinois:

Parcel ID#: 15-18-211-043

Property Address: 324 NORTH WOLF ROAD, HILLSIDE, ILLINOIS 60162

such Mortgage having been given to secure payment of One Hundred Sixty-Nine Thousand and No/100 -----
----- (\$ 169,000.00)

Recorded: 9/22/03 (Include the Original Principal Amount)
which Mortgage is of record in Book, Volume, or Liber No. , at page (or as No.
0326341011) of the Records of COOK County,
State of Illinois, together with the note(s) and obligations therein described and the money due and to become due thereon with
interest, and all rights accrued or to accrue under such Mortgage.

Illinois Assignment of Mortgage with Acknowledgment

11/97

VMP-995W(IL) (0109).01

Amended 6/00

Page 1 of 2

Initials: _____

VMP MORTGAGE FORMS - (800)521-7291



SW
58
M-4

UNOFFICIAL COPY

8686118
4773
TOBER DONALD
N N

Property of Cook County Clerk's Office

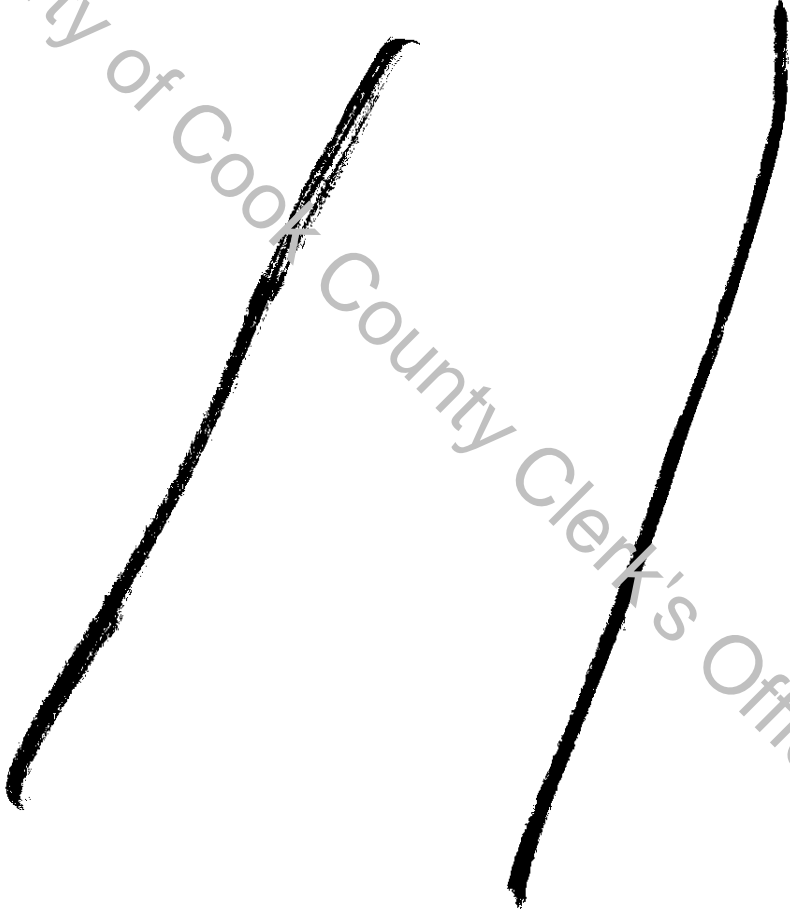

UNOFFICIAL COPY

0001033939

TO HAVE AND TO HOLD the same unto Assignee, its successor and assigns, forever, subject only to the terms and conditions of the above-described Mortgage.

IN WITNESS WHEREOF, the undersigned Assignor has executed this Assignment of Mortgage on **August 22, 2003**

EA
Witness

NEW CENTURY MORTGAGE CORPORATION
(Assignor)

Emily Gioino
Witness

By: [Signature]
(Signature)

Attest **Reina Chavoya**

Magda Villanueva
A.V.P. Shipping Manager

Seal:



State of **CALIFORNIA**
County of **ORANGE**

This instrument was acknowledged before me on **August 22, 2003**
by **Magda Villanueva**

as **A.V.P. Shipping Manager**
NEW CENTURY MORTGAGE CORPORATION

of

Reina Chavoya

Property of Cook County Clerk's Office

UNOFFICIAL COPY

LOTS ~~28~~⁹ AND 30 IN BLOCK 4 IN VENDLEY AND COMPANY'S HILLSIDE ACRES, BEING A SUBDIVISION OF ALL THAT PART SOUTH OF THE INDIAN BOUNDARY LINE AND SOUTH OF THE CENTER LINE OF BUTTERFIELD ROAD OF THE SOUTH EAST QUARTER OF SECTION 7 AND ALL THAT PART OF SECTION 18, TOWNSHIP 39 NORTH, RANGE 12, EAST OF THE THIRD PRINCIPAL MERIDIAN, LYING SOUTH OF THE CENTER LINE OF BUTTERFIELD ROAD, EAST OF THE EAST LINE OF HILLSIDE AVENUE AND NORTH OF THE RIGHT OF WAY OF THE ILLINOIS CENTRAL RAILROAD (MADISON BRANCH), IN COOK COUNTY, ILLINOIS.

Property of Cook County Clerk's Office

UNOFFICIAL COPY

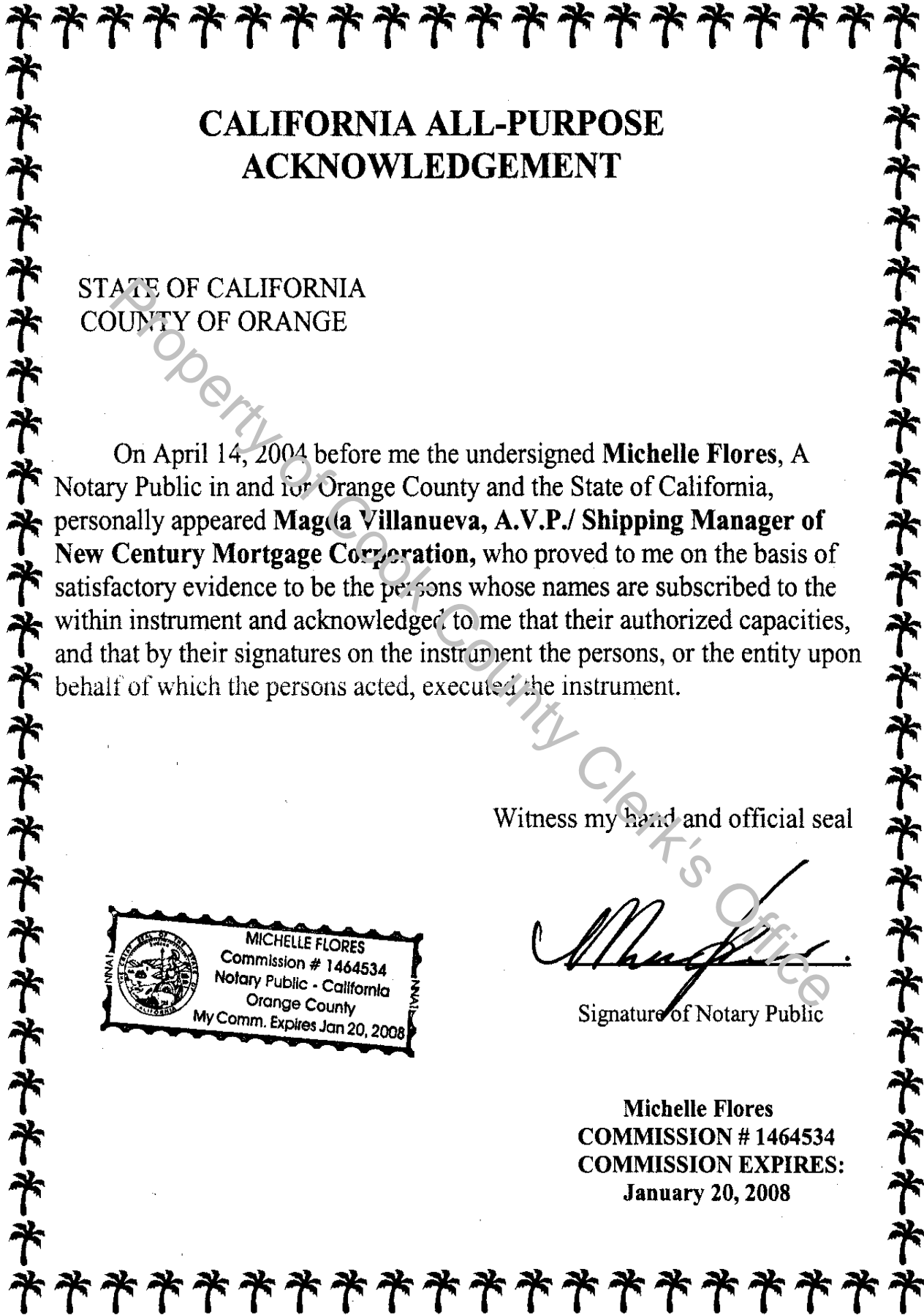

CALIFORNIA ALL-PURPOSE ACKNOWLEDGEMENT

STATE OF CALIFORNIA
COUNTY OF ORANGE

On April 14, 2004 before me the undersigned **Michelle Flores**, A Notary Public in and for Orange County and the State of California, personally appeared **Magda Villanueva, A.V.P./ Shipping Manager of New Century Mortgage Corporation**, who proved to me on the basis of satisfactory evidence to be the persons whose names are subscribed to the within instrument and acknowledged to me that their authorized capacities, and that by their signatures on the instrument the persons, or the entity upon behalf of which the persons acted, executed the instrument.

Witness my hand and official seal

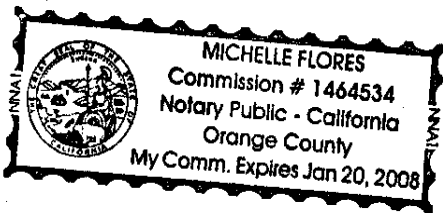

Michelle Flores
Signature of Notary Public

Michelle Flores
COMMISSION # 1464534
COMMISSION EXPIRES:
January 20, 2008