

UNOFFICIAL COPY

PREPARED BY:

Name: Olympia Investments

Address: 3200 South Chicago Road
South Chicago Heights, IL 60411



RETURN TO:

Name: Olympia Investments

Address: ~~533 Ashland Avenue~~ 9440 Enterprise Drive
~~Chicago Heights, IL 60411~~ Mokena, IL 60448

Doc#: 0513147031
Eugene "Gene" Moore Fee: \$30.00
Cook County Recorder of Deeds
Date: 05/11/2005 12:35 PM Pg: 1 of 4

(THE ABOVE SPACE FOR RECORDER'S OFFICE)

LEAKING UNDERGROUND STORAGE TANK ENVIRONMENTAL NOTICE

THE OWNER AND/OR OPERATOR OF THE LEAKING UNDERGROUND STORAGE TANK SYSTEM(S) ASSOCIATED WITH THE RELEASE REFERENCED BELOW, WITHIN 45 DAYS OF RECEIVING THE NO FURTHER REMEDIATION LETTER CONTAINING THIS NOTICE, MUST SUBMIT THIS NOTICE AND THE REMAINDER OF THE NO FURTHER REMEDIATION LETTER TO THE OFFICE OF THE RECORDER OR REGISTRAR OF TITLES OF COOK COUNTY IN WHICH THE SITE DESCRIBED BELOW IS LOCATED.

Illinois EPA Number: 0312945038

LUST Incident No.: 992597

Olympia Investments, the owner and/or operator of the leaking underground storage tank system(s) associated with the above-referenced incident, whose address is 533 Ashland Avenue, Chicago Heights, IL, has performed investigative and/or remedial activities for the site identified as follows and depicted on the attached aerial photo and Site Base Map.

1. Legal Description or Reference to a Plat Showing the Boundaries: That part of lot 6 in circuit court partition of the northeast $\frac{1}{4}$ of section 32, and the west $\frac{1}{2}$ of the northwest $\frac{1}{4}$ of section 33, township 5 north, range 14 east of the third principal meridian commencing at the northeast corner of lot 6 at the intersection of the southerly line of the Sauk Trail Road with the westerly line of the Chicago and Vincennes Road; thence, westerly along the south line of the Sauk Trail Road, 150.00 feet; thence southerly parallel with the westerly line of the Chicago and Vincennes Road, 150.00 feet; thence easterly on a line parallel with the said southerly line of the Sauk Trail Road 150.00 feet; thence northerly along the said westerly line of the Chicago and Vincennes Road to the place of beginning in Cook County, Illinois excepting therefrom that part thereof described as follows:

Beginning at the northeast corner of said lot 6 at the intersection of the southerly line of Sauk Trail Road with the westerly line of Chicago and Vincennes Road; thence on an

UNOFFICIAL COPY

Page 2

assumed bearing of south 83 degrees 23 minutes 10 seconds west along said southerly line of Sauk Trail Road and the north line of said lot 6 a distance of 54.09 feet; thence south 60 degrees 48 minutes 24 seconds east, 66.18 feet to the westerly line of said Chicago and Vincennes Road and the east line of said lot 6; thence north 05 degrees 00 minutes 00 seconds west along said westerly right of way line and said east lot line 38.72 feet to the point of beginning in Cook County, Illinois

2. Common Address: 3200 South Chicago Road, South Chicago Heights, IL
3. Real Estate Tax Index/Parcel Index Number: 32-32-213-005, -018, -020
4. Site Owner: Olympia Investments
5. Land Use Limitation: The land use shall be industrial/commercial. The groundwater under the site shall not be used as a potable water supply.
6. See the attached No Further Remediation Letter for other terms.

TAH:JSR:jk\040421.doc

UNOFFICIAL COPY

E99-144B\CONTAMINATION MAP.DWG

SAUK TRAIL

TEST PIT #1

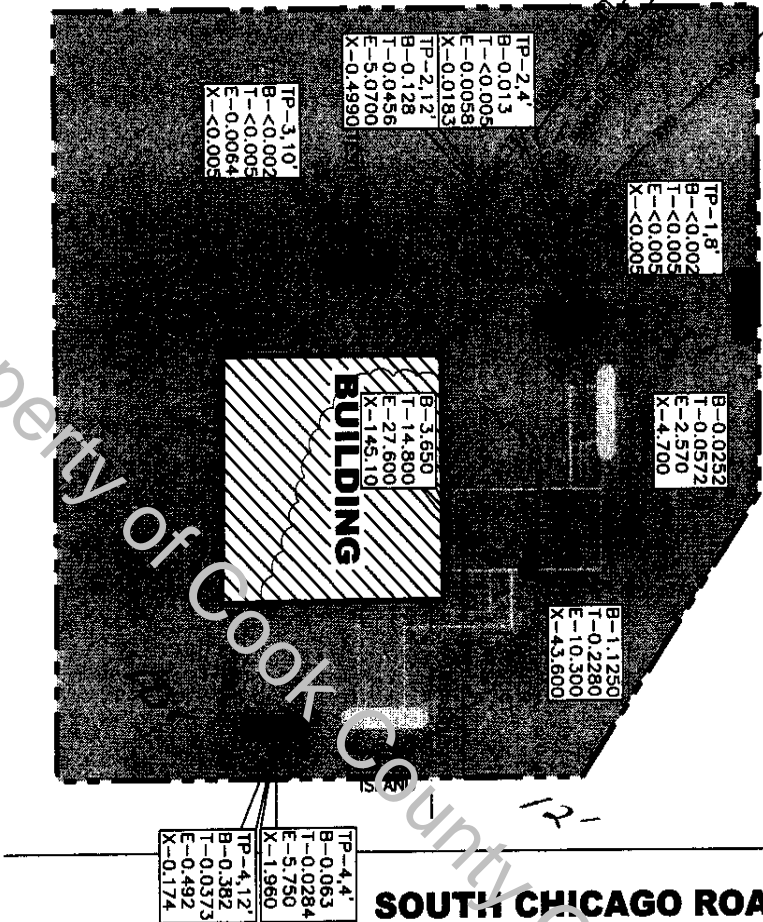

EXTENT OF IMPACTED SOIL
(APPROX. 3900 SF)

NO SAMPLES EXCEED
CALCULATED TER 2
REMEDICATION OBJECTIVES.

ANY EXCAVATED SOIL IN
EXCEEDENCE OF CALCULATED
REMEDICATION OBJECTIVES WILL
BE HANDLED IN ACCORDANCE
WITH APPLICABLE FEDERAL,
STATE AND LOCAL
REGULATIONS.



ELDETRREE, STONEOAK & BROOKINGS, INC.

10269 WEST LINCOLN HIGHWAY
FRANKFORT, ILLINOIS 60423
PHONE: (815) 806-0100 FAX: (815) 806-0966

BTEX SAMPLING MAP

RAINERIS CAR CENTER
3200 SOUTH CHICAGO ROAD
SOUTH CHICAGO HEIGHTS, ILLINOIS

SHEET

1 OF 1

SCALE: 1" = 40'
DATE: JUNE 21, 2004

UNOFFICIAL COPY

USGS

Property of Cook County Clerk's Office



3200 South Chicago Road
South Chicago Heights, Illinois

Map created by
Eldertree Stoneoak & Brookings, Inc.
Scale and positions are approximate
Eldertree S & B File # E99-144B