

UNOFFICIAL COPY

Recording Requested By:
CCO MORTGAGE CORP.



When Recorded Return To:
LINDA JENNINGS
CCO MORTGAGE CORP.
P.O. BOX 6260
Glen Allen, VA 23058-9962

Doc#: 0530816201 Fee: \$26.50
Eugene "Gene" Moore RHSP Fee: \$10.00
Cook County Recorder of Deeds
Date: 11/04/2005 02:34 PM Pg: 1 of 2

SATISFACTION

CCO MORTGAGE CORP. #:0017085739 "MARROULIS" Lender ID:058/0017085739 Cook, Illinois

FOR THE PROTECTION OF THE OWNER, THIS RELEASE SHALL BE FILED WITH THE RECORDER OR THE REGISTRAR OF TITLES IN WHOSE OFFICE THE MORTGAGE OR DEED OF TRUST WAS FILED.

KNOW ALL MEN BY THESE PRESENTS that CHARTER ONE BANK N.A. F.K.A CHARTER ONE BANK, F.S.B. S/B/M TO ADVANCE BANK holder of a certain mortgage made and executed by LINDA R MARROULIS, originally to ADVANCE BANK, in the County of Cook, and the State of Illinois, Dated: 05/09/2003 Recorded: 05/28/2003 in Book/Reel/Liber: N/A Page/Folio: N/A as Instrument No.: 0314833358, does hereby acknowledge that it has received full payment and satisfaction of the same, and in consideration thereof, does hereby cancel and discharge said mortgage.

Legal: LOT 10 IN BLOCK 1 IN LANSING MEADOWS, BEING A SUBDIVISION OF (EXCEPT THE SOUTH 264.0 FEET OF THE WEST 645.0 FEET) AND (EXCEPT THE SOUTH 125.0 FEET OF THE EAST 83.0 FEET) OF THE SOIHWEST 1/4 OF THE NORTHEAST 1/4 OF SECTION 31, TOWNSHIP 36 NORTH, RANGE 15, EAST OF THE THIRD PRINCIPAL MERIDIAN, IN COOK COUNTY, ILLINOIS.

Assessor's/Tax ID No. 30-31-217-010-0000

Property Address: 18037 RIDGEWOOD AVENUE, LANSING, IL 60438

IN WITNESS WHEREOF, the undersigned, by the officer duly authorized, has duly executed the foregoing instrument.

CHARTER ONE BANK N.A. F.K.A CHARTER ONE BANK, F.S.B. S/B/M TO ADVANCE BANK
On October 20th, 2005

By: 
BETSY S. MORANO, Authorized Signer

STATE OF Virginia
COUNTY OF Henrico

On October 20th, 2005, before me, EDITH E. MCCRAY, a Notary Public in and for Henrico in the State of Virginia, personally appeared BETSY S. MORANO, Authorized Signer, personally known to me (or proved to me on the basis of satisfactory evidence) to be the person(s) whose name(s) is/are subscribed to the within instrument and acknowledged to me that he/she/they executed the same in his/her/their authorized capacity, and that by his/her/their signature on the instrument the person(s), or the entity upon behalf of which the person(s) acted, executed the instrument.

WITNESS my hand and official seal,



EDITH E. MCCRAY
Notary Expires: 01/31/2007

(This area for notarial seal)

S-4
P-2
M-4
Sueh. Y

UNOFFICIAL COPY

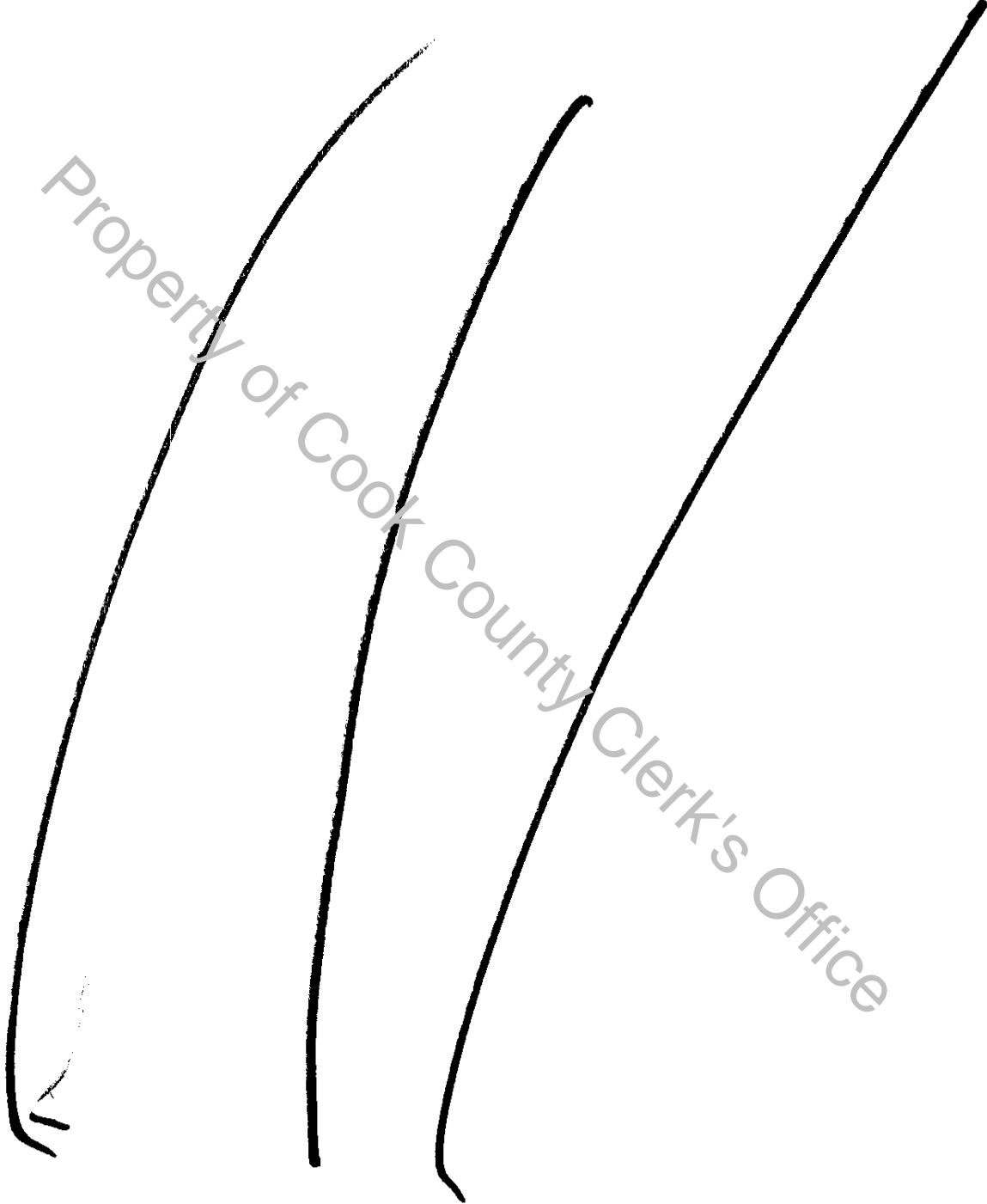
Prepared By: Edith E. Mccray, CCO MORTGAGE CORP. 10561 Telegraph Road, Glen Allen, VA 23059 (800) 234-6002



Property of Cook County Clerk's Office