

UNOFFICIAL COPY

STATE OF ILLINOIS)
)
COUNTY OF COOK)



Doc#: 0617249004 Fee: \$42.00
Eugene "Gene" Moore RHSP Fee: \$10.00
Cook County Recorder of Deeds
Date: 06/21/2006 09:35 AM Pg: 1 of 28

SUBCONTRACTOR'S/SUPPLIER'S AMENDED CLAIM FOR LIEN

The Claimant, LICHTENWALD-JOHNSTON IRON WORKS, INC., of Morton Grove, County of Cook, State of Illinois, hereby files notice and amended claim for lien against TR RIDGE PARTNERS, L.L.C., TR SIENNA, INC., TR DEVELOPMENT WORKSHOP, INC., TR SIENNA PARTNERS, L.L.C. (hereinafter described as "Condominium Building Owners"), and CHURCH STREET OFFICE CENTER LLC ("Office Structure Owner"), CORUS BANK, CIG INTERNATIONAL, LLC, CAPITAL SOURCE FINANCE LLC and HARRIS TRUST & SAVINGS BANK (hereinafter referred to as "Lenders"), and ROSZAK/ADC, LLC ("Contractor") and states:

That prior to July 23, 2004, the Condominium Building Owners owned the land described in Exhibit A hereto, and as of the date of recording of this Amended Claim for Lien, the Office Structure Owner owned the land described in Exhibit B hereto, in the County of Cook and State of Illinois; Roszak/ADC, LLC was the Condominium Building Owners' contractor for the improvement thereof.

That on July 23, 2004, the Contractor entered a subcontract with Claimant pursuant to which Claimant was to provide structural steel and related materials to the Sienna Court Condominium Project and the contiguous Office Structure in Evanston, Illinois, and completed all work pursuant to the subcontract on February 22, 2006.

That notice has been served upon the Owner of said premises in the manner provided by law. This Amended Claim for Lien is intended to correct the parties, amounts and allocation of the amounts set forth in the original Claim for Lien, which was recorded April 18, 2006 with the Cook County Recorder of Deeds as document number 0610845066.

That the Contractor is entitled to credits on account thereof as follows: \$945,228.00, leaving due, unpaid and owing to the Claimant for lienable work, after allowing all credits, the sum of \$103,820.00 pursuant to the contract for the office parking structure and \$105,452.35 for the condominium building, for a total of \$209,272.35 due under the subcontract. Additionally, the Claimant is entitled to the amount of \$275,852.00 for extras on the office parking structure, for a total lienable amount due of \$485,124.35, for which, with interest, the Claimant claims a

Jik

UNOFFICIAL COPY

lien upon said land and improvements under said contract and on the moneys or other considerations due or to become due from the Owners under said contract against said Contractor and Owners. To the extent required by law, Claimant allocates its lien on the condominium building as follows:

\$105,452.35 (amount due on base contract)
65 condominium units = \$1,622.34 per unit

LICHTENWALD-JOHNSTON IRON
WORKS, INC.



By: Its authorized agent
and representative

STATE OF ILLINOIS)

COUNTY OF COOK)

The affiant, Karen A. Berres, being first duly sworn on oath, deposes and says that she is one of the attorneys for the Claimant; that she has read the foregoing notice and amended claim for lien and knows the contents thereof; and that all the statements contained therein are true.

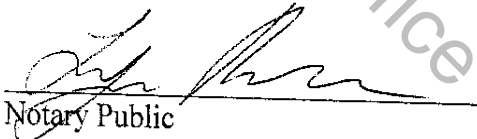

Subscribed and sworn before me this 20th day of June, 2006.

Notary Public

Prepared by/return to:
Karen A. Berres
69 S. Barrington Road
South Barrington, Illinois 60010

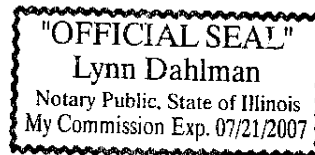

UNOFFICIAL COPY

EXHIBIT "A"
TO THE DECLARATION OF CONDOMINIUM OWNERSHIP FOR
SIENNA COURT CONDOMINIUM

LEGAL DESCRIPTION OF DEVELOPMENT AREA

PARCEL 1:

LOT 1 AND THE WEST 25 FEET OF BARN LOT "D" IN GROVER & CURREY'S SUBDIVISION OF LOT 6 (EXCEPT THE NORTH 2 FEET THEREOF) AND ALL OF LOTS 7 AND 8 OF BLOCK 2 IN E. A. PRATT'S ADDITION TO EVANSTON A SUBDIVISION OF PART OF THE SOUTHWEST 1/4 OF THE NORTHWEST 1/4 OF SECTION 18, TOWNSHIP 41 NORTH, RANGE 14 EAST OF THE THIRD PRINCIPAL MERIDIAN, IN COOK COUNTY, ILLINOIS.

PARCEL 2:

LOTS 1 AND 2 (EXCEPT THE WESTERLY 11 FEET THEREOF); LOT 3 (EXCEPT THE WESTERLY 11 FEET OF THE NORTHERLY 12 FEET THEREOF); LOTS 4 AND 5 AND THE NORTH 2 FEET OF LOT 6; ALL OF LOTS 16, 17, 18, 19, AND 20 AND LOT 21 (EXCEPT THAT PART OF LOT 21 WHICH LIES NORTH AND EAST OF A STRAIGHT LINE DRAWN FROM THE SOUTHEAST CORNER OF SAID LOT 21 TO A POINT ON THE NORTH LINE OF AND 50 FEET WEST OF THE NORTHEAST CORNER OF SAID LOT 21); THE VACATED NORTH-SOUTH PUBLIC ALLEY, LYING BETWEEN SAID LOTS 1 TO 6, INCLUSIVE AND LOTS 16 TO 21, INCLUSIVE; THAT PART OF THE VACATED SOUTH 8 FEET OF CLARK STREET, WHICH LIES EAST OF THE WEST LINE OF SAID LOTS 1 TO 6, INCLUSIVE EXTENDED IN A NORTHEASTERLY DIRECTION AND WEST OF THE SAID LINE DRAWN FROM THE SOUTHEAST CORNER OF SAID LOT 21 TO A POINT ON THE NORTH LINE OF AND 50 FEET WEST OF THE NORTHEAST CORNER OF SAID LOT 21 EXTENDED IN A NORTHWESTERLY DIRECTION; ALSO LOTS "A", "B", "C" AND LOT "D" (EXCEPT THE WEST 25 FEET THEREOF) IN GROVER AND CURREY'S SUBDIVISION OF LOT 6 (EXCEPT THE NORTH 2 FEET THEREOF) AND LOTS 7 AND 8; ALL OF THE AFORESAID PROPERTY BEING LOCATED IN BLOCK 2 IN PRATT'S ADDITION TO EVANSTON, A SUBDIVISION OF PART OF THE SOUTHWEST 1/4 OF THE NORTHWEST 1/4 OF SECTION 18, TOWNSHIP 41 NORTH, RANGE 14, EAST OF THE THIRD PRINCIPAL MERIDIAN, LYING EAST OF RIDGE ROAD AND WEST OF MILWAUKEE DIVISION OF CHICAGO AND NORTHWESTERN RAILWAY, IN COOK COUNTY, ILLINOIS.

Excluding that part of the following described property taken as a tract (i.e., the "Office Garage Parcel"):



UNOFFICIAL COPY**OFFICE PARKING PARCEL 1 AT SUB-BASEMENT LEVEL:**

LOTS 1 AND 2 (EXCEPT THE WESTERLY 11 FEET THEREOF); LOT 3 (EXCEPT THE WESTERLY 11 FEET OF THE NORTHERLY 12 FEET THEREOF); LOTS 4 AND 5 AND THE NORTH 2 FEET OF LOT 6; ALL OF LOTS 16, 17, 18, 19 AND 20 AND LOT 21 (EXCEPT THAT PART OF LOT 21 WHICH LIES NORTH AND EAST OF A STRAIGHT LINE DRAWN FROM THE SOUTHEAST CORNER OF SAID LOT 21 TO A POINT ON THE NORTH LINE OF AND 50 FEET WEST OF THE NORTHEAST CORNER OF SAID LOT 21); THE VACATED NORTH-SOUTH PUBLIC ALLEY, LYING BETWEEN SAID LOTS 1 TO 6, INCLUSIVE AND LOTS 16 TO 21, INCLUSIVE; THAT PART OF THE VACATED SOUTH 8 FEET OF CLARK STREET, WHICH LIES EAST OF THE WEST LINE OF SAID LOTS 1 TO 6, INCLUSIVE EXTENDED IN A NORTHEASTERLY DIRECTION AND WEST OF THE SAID LINE DRAWN FROM THE SOUTHEAST CORNER OF SAID LOT 21 TO A POINT ON THE NORTH LINE OF AND 50 FEET WEST OF THE NORTHEAST CORNER OF SAID LOT 21 EXTENDED IN A NORTHWESTERLY DIRECTION; ALSO LOTS 'A', 'B', 'C' AND LOT 'D' (EXCEPT THE WEST 25 FEET THEREOF) IN GROVER AND CURREY'S SUBDIVISION OF LOT 6 (EXCEPT THE NORTH 2 FEET THEREOF) AND LOTS 7 AND 8; ALL OF THE AFORESAID PROPERTY BEING LOCATED IN BLOCK 2 IN PRATT'S ADDITION TO EVANSTON, A SUBDIVISION OF PART OF THE SOUTHWEST 1/4 OF THE NORTHWEST 1/4 OF SECTION 18, TOWNSHIP 41 NORTH, RANGE 14, EAST OF THE THIRD PRINCIPAL MERIDIAN, LYING EAST OF RIDGE ROAD AND WEST OF MILWAUKEE DIVISION OF CHICAGO AND NORTHWESTERN RAILWAY; ALSO, LOT 1 AND THE WEST 25 FEET OF LOT D IN GROVER AND CURREY'S SUBDIVISION OF LOT 6 (EXCEPT THE NORTH 2 FEET THEREOF) AND LOTS 7 AND 8 IN BLOCK 2 IN PRATT'S ADDITION TO EVANSTON, A SUBDIVISION OF THAT PART OF THE SOUTHWEST 1/4 OF THE NORTHWEST 1/4 OF SECTION 18, TOWNSHIP 41 NORTH, RANGE 14, EAST OF THE THIRD PRINCIPAL MERIDIAN, LYING EAST OF RIDGE ROAD AND WEST OF MILWAUKEE DIVISION OF CHICAGO AND NORTHWESTERN RAILWAY, TAKEN AS A TRACT LYING BELOW A HORIZONTAL PLANE HAVING AND ELEVATION OF +15.00 CITY OF EVANSTON DATUM AND LYING ABOVE A HORIZONTAL PLANE HAVING AND ELEVATION OF +5.00 CITY OF EVANSTON DATUM AND LYING WITHIN ITS HORIZONTAL BOUNDARIES PROJECTED VERTICALLY AND DESCRIBED AS FOLLOWS: COMMENCING AT THE SOUTHEAST CORNER OF SAID TRACT; THENCE NORTH 90°00'00" WEST, ALONG THE SOUTH LINE THEREOF, 296.02 FEET TO THE POINT OF BEGINNING; THENCE NORTH 00°01'00" EAST 63.75 FEET; THENCE NORTH 89°38'40" EAST 72.82 FEET; THENCE SOUTH 00°23'06" EAST 64.21 FEET TO THE SOUTH LINE OF SAID TRACT; THENCE NORTH 90°00'00" WEST, ALONG THE SOUTH LINE OF SAID TRACT, 73.37 FEET TO THE POINT OF BEGINNING, IN COOK COUNTY, ILLINOIS.

CONTAINING 4,680 SQUARE FEET, MORE OR LESS.

UNOFFICIAL COPY**OFFICE PARKING PARCEL 2A AT SECOND FLOOR LEVEL:**

LOTS 1 AND 2 (EXCEPT THE WESTERLY 11 FEET THEREOF); LOT 3 (EXCEPT THE WESTERLY 11 FEET OF THE NORTHERLY 12 FEET THEREOF); LOTS 4 AND 5 AND THE NORTH 2 FEET OF LOT 6; ALL OF LOTS 18, 17, 18, 19 AND 20 AND LOT 21 (EXCEPT THAT PART OF LOT 21 WHICH LIES NORTH AND EAST OF A STRAIGHT LINE DRAWN FROM THE SOUTHEAST CORNER OF SAID LOT 21 TO A POINT ON THE NORTH LINE OF AND 50 FEET WEST OF THE NORTHEAST CORNER OF SAID LOT 21); THE VACATED NORTH-SOUTH PUBLIC ALLEY, LYING BETWEEN SAID LOTS 1 TO 6, INCLUSIVE AND LOTS 18 TO 21, INCLUSIVE; THAT PART OF THE VACATED SOUTH 8 FEET OF CLARK STREET, WHICH LIES EAST OF THE WEST LINE OF SAID LOTS 1 TO 6, INCLUSIVE EXTENDED IN A NORTHEASTERLY DIRECTION AND WEST OF THE SAID LINE DRAWN FROM THE SOUTHEAST CORNER OF SAID LOT 21 TO A POINT ON THE NORTH LINE OF AND 50 FEET WEST OF THE NORTHEAST CORNER OF SAID LOT 21 EXTENDED IN A NORTHWESTERLY DIRECTION; ALSO LOTS 'A', 'B', 'C' AND LOT 'D' (EXCEPT THE WEST 25 FEET THEREOF) IN GROVER AND CURREY'S SUBDIVISION OF LOT 6 (EXCEPT THE NORTH 2 FEET THEREOF) AND LOTS 7 AND 8; ALL OF THE AFORESAID PROPERTY BEING LOCATED IN BLOCK 2 IN PRATT'S ADDITION TO EVANSTON, A SUBDIVISION OF PART OF THE SOUTHWEST 1/4 OF THE NORTHWEST 1/4 OF SECTION 18, TOWNSHIP 41 NORTH, RANGE 14, EAST OF THE THIRD PRINCIPAL MERIDIAN, LYING EAST OF RIDGE ROAD AND WEST OF MILWAUKEE DIVISION OF CHICAGO AND NORTHWESTERN RAILWAY; ALSO, LOT 1 AND THE WEST 25 FEET OF LOT D IN GROVER AND CURREY'S SUBDIVISION OF LOT 6 (EXCEPT THE NORTH 2 FEET THEREOF) AND LOTS 7 AND 8 IN BLOCK 2 IN PRATT'S ADDITION TO EVANSTON, A SUBDIVISION OF THAT PART OF THE SOUTHWEST 1/4 OF THE NORTHWEST 1/4 OF SECTION 18, TOWNSHIP 41 NORTH, RANGE 14, EAST OF THE THIRD PRINCIPAL MERIDIAN, LYING EAST OF RIDGE ROAD AND WEST OF MILWAUKEE DIVISION OF CHICAGO AND NORTHWESTERN RAILWAY, TAKEN AS A TRACT LYING BELOW A HORIZONTAL PLANE HAVING AN ELEVATION OF +48.25 CITY OF EVANSTON DATUM AND LYING ABOVE A HORIZONTAL PLANE HAVING AN ELEVATION OF +35.58 CITY OF EVANSTON DATUM AND LYING WITHIN ITS HORIZONTAL BOUNDARIES PROJECTED VERTICALLY AND DESCRIBED AS FOLLOWS: BEGINNING AT THE SOUTHEAST CORNER OF SAID TRACT; THENCE NORTH 90°00'00" WEST, ALONG THE SOUTH LINE THEREOF, 175.10 FEET; THENCE NORTH 00°01'00" EAST 82.55 FEET; THENCE SOUTH 89°59'00" EAST 78.00 FEET; THENCE NORTH 00°01'00" EAST 44.00 FEET; THENCE SOUTH 89°59'00" EAST 42.10 FEET; THENCE SOUTH 00°01'00" WEST 17.89 FEET; THENCE NORTH 89°52'00" EAST 5.52 FEET; THENCE SOUTH 00°01'00" WEST 28.32 FEET; THENCE NORTH 89°59'00" WEST 35.87 FEET; THENCE SOUTH 00°01'00" WEST 35.75 FEET; THENCE SOUTH 89°59'00" EAST 40.67 FEET; THENCE SOUTH 00°01'00" WEST 21.83 FEET; THENCE SOUTH 89°59'00" EAST 55.50 FEET TO THE EAST LINE OF SAID TRACT; THENCE SOUTH 00°01'44" EAST, ALONG THE EAST LINE OF SAID TRACT, 24.92 FEET TO THE POINT OF BEGINNING, IN COOK COUNTY, ILLINOIS.

CONTAINING 11,508 SQUARE FEET, MORE OR LESS.

UNOFFICIAL COPY**OFFICE PARKING PARCEL AT BASEMENT LEVEL:**

LOTS 1 AND 2 (EXCEPT THE WESTERLY 11 FEET THEREOF); LOT 3 (EXCEPT THE WESTERLY 11 FEET OF THE NORTHERLY 12 FEET THEREOF); LOTS 4 AND 5 AND THE NORTH 2 FEET OF LOT 6; ALL OF LOTS 16, 17, 18, 19 AND 20 AND LOT 21 (EXCEPT THAT PART OF LOT 21 WHICH LIES NORTH AND EAST OF A STRAIGHT LINE DRAWN FROM THE SOUTHEAST CORNER OF SAID LOT 21 TO A POINT ON THE NORTH LINE OF AND 50 FEET WEST OF THE NORTHEAST CORNER OF SAID LOT 21); THE VACATED NORTH-SOUTH PUBLIC ALLEY, LYING BETWEEN SAID LOTS 1 TO 6, INCLUSIVE AND LOTS 16 TO 21, INCLUSIVE; THAT PART OF THE VACATED SOUTH 8 FEET OF CLARK STREET, WHICH LIES EAST OF THE WEST LINE OF SAID LOTS 1 TO 6, INCLUSIVE EXTENDED IN A NORTHEASTERLY DIRECTION AND WEST OF THE SAID LINE DRAWN FROM THE SOUTHEAST CORNER OF SAID LOT 21 TO A POINT ON THE NORTH LINE OF AND 50 FEET WEST OF THE NORTHEAST CORNER OF SAID LOT 21 EXTENDED IN A NORTHWESTERLY DIRECTION; ALSO LOTS 'A', 'B', 'C' AND LOT 'D' (EXCEPT THE WEST 25 FEET THEREOF) IN GROVER AND CURREY'S SUBDIVISION OF LOT 8 (EXCEPT THE NORTH 2 FEET THEREOF) AND LOTS 7 AND 8; ALL OF THE AFORESAID PROPERTY BEING LOCATED IN BLOCK 2 IN PRATT'S ADDITION TO EVANSTON, A SUBDIVISION OF PART OF THE SOUTHWEST 1/4 OF THE NORTHWEST 1/4 OF SECTION 18, TOWNSHIP 41 NORTH, RANGE 14, EAST OF THE THIRD PRINCIPAL MERIDIAN, LYING EAST OF RIDGE ROAD AND WEST OF MILWAUKEE DIVISION OF CHICAGO AND NORTHWESTERN RAILWAY; ALSO, LOT 1 AND THE WEST 25 FEET OF LOT D IN GROVER AND CURREY'S SUBDIVISION OF LOT 8 (EXCEPT THE NORTH 2 FEET THEREOF) AND LOTS 7 AND 8 IN BLOCK 2 IN PRATT'S ADDITION TO EVANSTON, A SUBDIVISION OF THAT PART OF THE SOUTHWEST 1/4 OF THE NORTHWEST 1/4 OF SECTION 18, TOWNSHIP 41 NORTH, RANGE 14, EAST OF THE THIRD PRINCIPAL MERIDIAN, LYING EAST OF RIDGE ROAD AND WEST OF MILWAUKEE DIVISION OF CHICAGO AND NORTHWESTERN RAILWAY, TAKEN AS A TRACT LYING BELOW A HORIZONTAL PLANE HAVING AN ELEVATION OF +25.58 CITY OF EVANSTON DATUM AND LYING ABOVE A HORIZONTAL PLANE HAVING AN ELEVATION OF +15.00 CITY OF EVANSTON DATUM AND LYING WITHIN ITS HORIZONTAL BOUNDARIES PROJECTED VERTICALLY AND DESCRIBED AS FOLLOWS: BEGINNING AT THE SOUTHEAST CORNER OF SAID TRACT; THENCE NORTH 90°00'00" WEST, ALONG THE SOUTH LINE THEREOF, 296.02 FEET; THENCE NORTH 00°01'00" EAST, 126.59 FEET; THENCE NORTH 89°38'32" EAST, 198.95 FEET; THENCE SOUTH 00°21'02" EAST, 17.38 FEET; THENCE NORTH 89°49'09" EAST, 18.06 FEET; THENCE SOUTH 00°07'09" EAST, 18.77 FEET; THENCE SOUTH 89°53'08" WEST, 18.84 FEET; THENCE SOUTH 00°29'29" EAST, 7.22 FEET; THENCE NORTH 89°37'51" EAST, 0.80 FEET; THENCE SOUTH 00°22'09" EAST, 34.88 FEET; THENCE NORTH 89°37'51" EAST, 0.69 FEET; THENCE SOUTH 00°18'00" EAST, 2.72 FEET; THENCE NORTH 89°42'00" EAST, 24.47 FEET; THENCE NORTH 00°24'30" WEST, 36.66 FEET; THENCE SOUTH 89°47'34" WEST, 0.38 FEET; THENCE NORTH 00°03'14" WEST, 35.67 FEET; THENCE NORTH 89°56'46" EAST, 8.54 FEET; THENCE NORTH 00°03'14" WEST, 8.88 FEET; THENCE NORTH 89°38'32" EAST, 44.01 FEET; THENCE SOUTH 00°17'21" EAST, 17.54 FEET; THENCE SOUTH 89°46'39" EAST, 19.40 FEET TO THE EAST LINE OF SAID TRACT; THENCE SOUTH 00°01'44" EAST, ALONG THE EAST LINE OF SAID TRACT, 110.89 FEET TO THE POINT OF BEGINNING, IN COOK COUNTY, ILLINOIS.

UNOFFICIAL COPY

CONTAINING 35,635 SQUARE FEET, MORE OR LESS.

OFFICE PARKING PARCEL 1A AT FIRST FLOOR LEVEL:

LOTS 1 AND 2 (EXCEPT THE WESTERLY 11 FEET THEREOF); LOT 3 (EXCEPT THE WESTERLY 11 FEET OF THE NORTHERLY 12 FEET THEREOF); LOTS 4 AND 5 AND THE NORTH 2 FEET OF LOT 6; ALL OF LOTS 16, 17, 18, 19 AND 20 AND LOT 21 (EXCEPT THAT PART OF LOT 21 WHICH LIES NORTH AND EAST OF A STRAIGHT LINE DRAWN FROM THE SOUTHEAST CORNER OF SAID LOT 21 TO A POINT ON THE NORTH LINE OF AND 50 FEET WEST OF THE NORTHEAST CORNER OF SAID LOT 21); THE VACATED NORTH-SOUTH PUBLIC ALLEY, LYING BETWEEN SAID LOTS 1 TO 6, INCLUSIVE AND LOTS 16 TO 21, INCLUSIVE; THAT PART OF THE VACATED SOUTH 8 FEET OF CLARK STREET, WHICH LIES EAST OF THE WEST LINE OF SAID LOTS 1 TO 6, INCLUSIVE EXTENDED IN A NORTHEASTERLY DIRECTION AND WEST OF THE SAID LINE DRAWN FROM THE SOUTHEAST CORNER OF SAID LOT 21 TO A POINT ON THE NORTH LINE OF AND 50 FEET WEST OF THE NORTHEAST CORNER OF SAID LOT 21 EXTENDED IN A NORTHWESTERLY DIRECTION; ALSO LOTS 'A', 'B', 'C' AND LOT 'D' (EXCEPT THE WEST 25 FEET THEREOF) IN GROVER AND CURREY'S SUBDIVISION OF LOT 6 (EXCEPT THE NORTH 2 FEET THEREOF) AND LOTS 7 AND 8; ALL OF THE AFORESAID PROPERTY BEING LOCATED IN BLOCK 2 IN PRATT'S ADDITION TO EVANSTON, A SUBDIVISION OF PART OF THE SOUTHWEST 1/4 OF THE NORTHWEST 1/4 OF SECTION 18, TOWNSHIP 41 NORTH, RANGE 14, EAST OF THE THIRD PRINCIPAL MERIDIAN, LYING EAST OF RIDGE ROAD AND WEST OF MILWAUKEE DIVISION OF CHICAGO AND NORTHWESTERN RAILWAY; ALSO, LOT 1 AND THE WEST 25 FEET OF LOT D IN GROVER AND CURREY'S SUBDIVISION OF LOT 6 (EXCEPT THE NORTH 2 FEET THEREOF) AND LOTS 7 AND 8 IN BLOCK 2 IN PRATT'S ADDITION TO EVANSTON, A SUBDIVISION OF THAT PART OF THE SOUTHWEST 1/4 OF THE NORTHWEST 1/4 OF SECTION 18, TOWNSHIP 41 NORTH, RANGE 14, EAST OF THE THIRD PRINCIPAL MERIDIAN, LYING EAST OF RIDGE ROAD AND WEST OF MILWAUKEE DIVISION OF CHICAGO AND NORTHWESTERN RAILWAY, TAKEN AS A TRACT LYING BELOW A HORIZONTAL PLANE HAVING AN ELEVATION OF +35.58 CITY OF EVANSTON DATUM AND LYING ABOVE A HORIZONTAL PLANE HAVING AN ELEVATION OF +25.58 CITY OF EVANSTON DATUM AND LYING WITHIN ITS HORIZONTAL BOUNDARIES. PROJECTED VERTICALLY AND DESCRIBED AS FOLLOWS: BEGINNING AT THE SOUTHEAST CORNER OF SAID TRACT; THENCE NORTH 90°00'00" WEST ALONG THE SOUTH LINE THEREOF, 296.02 FEET; THENCE NORTH 00°01'00" EAST 126.59 FEET; THENCE SOUTH 89°59'00" EAST 295.92 FEET TO THE EAST LINE OF SAID TRACT; THENCE SOUTH 00°01'44" EAST, ALONG THE EAST LINE OF SAID TRACT, 126.50 FEET TO THE POINT OF BEGINNING (EXCEPT THAT PART THEREOF DESCRIBED AS FOLLOWS: COMMENCING AT THE SOUTHEAST CORNER OF SAID TRACT; THENCE NORTH 90°00'00" WEST, ALONG THE SOUTH LINE THEREOF, 71.60 FEET; THENCE NORTH 00°01'00" EAST 55.52 FEET TO THE POINT OF BEGINNING; THENCE NORTH 89°59'00" WEST 18.33 FEET; NORTH 00°01'00" EAST 27.00 FEET; THENCE SOUTH 89°59'00" EAST 18.33 FEET; THENCE SOUTH 00°01'00" WEST 27.00 FEET TO THE POINT OF BEGINNING), IN COOK COUNTY, ILLINOIS.

CONTAINING 36,958 SQUARE FEET, MORE OR LESS.

UNOFFICIAL COPY**OFFICE PARKING PARCEL 1B AT FIRST FLOOR LEVEL:**

LOTS 1 AND 2 (EXCEPT THE WESTERLY 11 FEET THEREOF); LOT 3 (EXCEPT THE WESTERLY 11 FEET OF THE NORTHERLY 12 FEET THEREOF); LOTS 4 AND 5 AND THE NORTH 2 FEET OF LOT 6; ALL OF LOTS 16, 17, 18, 19 AND 20 AND LOT 21 (EXCEPT THAT PART OF LOT 21 WHICH LIES NORTH AND EAST OF A STRAIGHT LINE DRAWN FROM THE SOUTHEAST CORNER OF SAID LOT 21 TO A POINT ON THE NORTH LINE OF AND 50 FEET WEST OF THE NORTHEAST CORNER OF SAID LOT 21); THE VACATED NORTH-SOUTH PUBLIC ALLEY, LYING BETWEEN SAID LOTS 1 TO 6, INCLUSIVE AND LOTS 16 TO 21, INCLUSIVE; THAT PART OF THE VACATED SOUTH 8 FEET OF CLARK STREET, WHICH LIES EAST OF THE WEST LINE OF SAID LOTS 1 TO 6, INCLUSIVE EXTENDED IN A NORTHEASTERLY DIRECTION AND WEST OF THE SAID LINE DRAWN FROM THE SOUTHEAST CORNER OF SAID LOT 21 TO A POINT ON THE NORTH LINE OF AND 50 FEET WEST OF THE NORTHEAST CORNER OF SAID LOT 21 EXTENDED IN A NORTHWESTERLY DIRECTION; ALSO LOTS 'A', 'B', 'C' AND LOT 'D' (EXCEPT THE WEST 25 FEET THEREOF) IN GROVER AND CURREY'S SUBDIVISION OF LOT 6 (EXCEPT THE NORTH 2 FEET THEREOF) AND LOTS 7 AND 8; ALL OF THE AFORESAID PROPERTY BEING LOCATED IN BLOCK 2 IN PRATT'S ADDITION TO EVANSTON, A SUBDIVISION OF PART OF THE SOUTHWEST 1/4 OF THE NORTHWEST 1/4 OF SECTION 18, TOWNSHIP 41 NORTH, RANGE 14, EAST OF THE THIRD PRINCIPAL MERIDIAN, LYING EAST OF RIDGE ROAD AND WEST OF MILWAUKEE DIVISION OF CHICAGO AND NORTHWESTERN RAILWAY; ALSO, LOT 1 AND THE WEST 25 FEET OF LOT D IN GROVER AND CURREY'S SUBDIVISION OF LOT 6 (EXCEPT THE NORTH 2 FEET THEREOF) AND LOTS 7 AND 8 IN BLOCK 2 IN PRATT'S ADDITION TO EVANSTON, A SUBDIVISION OF THAT PART OF THE SOUTHWEST 1/4 OF THE NORTHWEST 1/4 OF SECTION 18, TOWNSHIP 41 NORTH, RANGE 14, EAST OF THE THIRD PRINCIPAL MERIDIAN, LYING EAST OF RIDGE ROAD AND WEST OF MILWAUKEE DIVISION OF CHICAGO AND NORTHWESTERN RAILWAY, TAKEN AS A TRACT LYING BELOW A HORIZONTAL PLANE HAVING AN ELEVATION OF +36.87 CITY OF EVANSTON DATUM AND LYING ABOVE A HORIZONTAL PLANE HAVING AN ELEVATION OF +25.58 CITY OF EVANSTON DATUM AND LYING WITHIN ITS HORIZONTAL BOUNDARIES PROJECTED VERTICALLY AND DESCRIBED AS FOLLOWS: COMMENCING AT THE SOUTHEAST CORNER OF SAID TRACT; THENCE NORTH 90°00'00" WEST, ALONG THE SOUTH LINE THEREOF, 71.60 FEET; THENCE NORTH 00°01'00" EAST 55.52 FEET TO THE POINT OF BEGINNING; THENCE NORTH 89°59'00" WEST 10.80 FEET; NORTH 00°00'33" WEST 18.15 FEET; THENCE SOUTH 89°52'01" EAST 10.81 FEET; THENCE SOUTH 00°01'00" WEST 18.13 FEET TO THE POINT OF BEGINNING, IN COOK COUNTY, ILLINOIS.

CONTAINING 196 SQUARE FEET, MORE OR LESS.

UNOFFICIAL COPY**OFFICE PARKING PARCEL 2B AT SECOND FLOOR LEVEL:**

LOTS 1 AND 2 (EXCEPT THE WESTERLY 11 FEET THEREOF); LOT 3 (EXCEPT THE WESTERLY 11 FEET OF THE NORTHERLY 12 FEET THEREOF); LOTS 4 AND 5 AND THE NORTH 2 FEET OF LOT 6; ALL OF LOTS 16, 17, 18, 19 AND 20 AND LOT 21 (EXCEPT THAT PART OF LOT 21 WHICH LIES NORTH AND EAST OF A STRAIGHT LINE DRAWN FROM THE SOUTHEAST CORNER OF SAID LOT 21 TO A POINT ON THE NORTH LINE OF AND 50 FEET WEST OF THE NORTHEAST CORNER OF SAID LOT 21); THE VACATED NORTH-SOUTH PUBLIC ALLEY, LYING BETWEEN SAID LOTS 1 TO 6, INCLUSIVE AND LOTS 16 TO 21, INCLUSIVE; THAT PART OF THE VACATED SOUTH 8 FEET OF CLARK STREET, WHICH LIES EAST OF THE WEST LINE OF SAID LOTS 1 TO 6, INCLUSIVE EXTENDED IN A NORTHEASTERLY DIRECTION AND WEST OF THE SAID LINE DRAWN FROM THE SOUTHEAST CORNER OF SAID LOT 21 TO A POINT ON THE NORTH LINE OF AND 50 FEET WEST OF THE NORTHEAST CORNER OF SAID LOT 21 EXTENDED IN A NORTHWESTERLY DIRECTION; ALSO LOTS 'A', 'B', 'C' AND LOT 'D' (EXCEPT THE WEST 25 FEET THEREOF) IN GROVER AND CURREY'S SUBDIVISION OF LOT 6 (EXCEPT THE NORTH 2 FEET THEREOF) AND LOTS 7 AND 8; ALL OF THE AFORESAID PROPERTY BEING LOCATED IN BLOCK 2 IN PRATT'S ADDITION TO EVANSTON, A SUBDIVISION OF PART OF THE SOUTHWEST 1/4 OF THE NORTHWEST 1/4 OF SECTION 18, TOWNSHIP 41 NORTH, RANGE 14, EAST OF THE THIRD PRINCIPAL MERIDIAN, LYING EAST OF RIDGE ROAD AND WEST OF MILWAUKEE DIVISION OF CHICAGO AND NORTHWESTERN RAILWAY; ALSO, LOT 1 AND THE WEST 25 FEET OF LOT D IN GROVER AND CURREY'S SUBDIVISION OF LOT 6 (EXCEPT THE NORTH 2 FEET THEREOF) AND LOTS 7 AND 8 IN BLOCK 2 IN PRATT'S ADDITION TO EVANSTON, A SUBDIVISION OF THAT PART OF THE SOUTHWEST 1/4 OF THE NORTHWEST 1/4 OF SECTION 18, TOWNSHIP 41 NORTH, RANGE 14, EAST OF THE THIRD PRINCIPAL MERIDIAN, LYING EAST OF RIDGE ROAD AND WEST OF MILWAUKEE DIVISION OF CHICAGO AND NORTHWESTERN RAILWAY, TAKEN AS A TRACT LYING BELOW A HORIZONTAL PLANE HAVING AN ELEVATION OF +44.75 CITY OF EVANSTON DATUM AND LYING ABOVE A HORIZONTAL PLANE HAVING AN ELEVATION OF +35.58 CITY OF EVANSTON DATUM AND LYING WITHIN ITS HORIZONTAL BOUNDARIES PROJECTED VERTICALLY AND DESCRIBED AS FOLLOWS: COMMENCING AT THE SOUTHEAST CORNER OF SAID TRACT; THENCE NORTH 90°00'00" WEST, ALONG THE SOUTH LINE THEREOF, 175.10 FEET TO THE POINT OF BEGINNING; THENCE NORTH 90°00'00" WEST, 66.50 FEET; THENCE NORTH 00°32'00" EAST, 64.74 FEET; THENCE NORTH 89°59'00" WEST, 0.69 FEET; THENCE NORTH 00°28'00" EAST, 17.83 FEET; THENCE SOUTH 89°59'00" EAST, 87.06 FEET; THENCE SOUTH 00°01'00" WEST, 82.55 FEET TO THE POINT OF BEGINNING, IN COOK COUNTY, ILLINOIS.

CONTAINING 5,501 SQUARE FEET, MORE OR LESS.

UNOFFICIAL COPY**OFFICE PARKING PARCEL 2 AT SUB-BASEMENT LEVEL:**

LOTS 1 AND 2 (EXCEPT THE WESTERLY 11 FEET THEREOF); LOT 3 (EXCEPT THE WESTERLY 11 FEET OF THE NORTHERLY 12 FEET THEREOF); LOTS 4 AND 5 AND THE NORTH 2 FEET OF LOT 6; ALL OF LOTS 16, 17, 18, 19 AND 20 AND LOT 21 (EXCEPT THAT PART OF LOT 21 WHICH LIES NORTH AND EAST OF A STRAIGHT LINE DRAWN FROM THE SOUTHEAST CORNER OF SAID LOT 21 TO A POINT ON THE NORTH LINE OF AND 50 FEET WEST OF THE NORTHEAST CORNER OF SAID LOT 21); THE VACATED NORTH-SOUTH PUBLIC ALLEY, LYING BETWEEN SAID LOTS 1 TO 6, INCLUSIVE AND LOTS 16 TO 21, INCLUSIVE; THAT PART OF THE VACATED SOUTH 8 FEET OF CLARK STREET, WHICH LIES EAST OF THE WEST LINE OF SAID LOTS 1 TO 6, INCLUSIVE EXTENDED IN A NORTHEASTERLY DIRECTION AND WEST OF THE SAID LINE DRAWN FROM THE SOUTHEAST CORNER OF SAID LOT 21 TO A POINT ON THE NORTH LINE OF AND 50 FEET WEST OF THE NORTHEAST CORNER OF SAID LOT 21 EXTENDED IN A NORTHWESTERLY DIRECTION; ALSO LOTS 'A', 'B', 'C' AND LOT 'D' (EXCEPT THE WEST 25 FEET THEREOF) IN GROVER AND CURREY'S SUBDIVISION OF LOT 8 (EXCEPT THE NORTH 2 FEET THEREOF) AND LOTS 7 AND 8; ALL OF THE AFORESAID PROPERTY BEING LOCATED IN BLOCK 2 IN PRATT'S ADDITION TO EVANSTON, A SUBDIVISION OF PART OF THE SOUTHWEST 1/4 OF THE NORTHWEST 1/4 OF SECTION 18, TOWNSHIP 41 NORTH, RANGE 14, EAST OF THE THIRD PRINCIPAL MERIDIAN, LYING EAST OF RIDGE ROAD AND WEST OF MILWAUKEE DIVISION OF CHICAGO AND NORTHWESTERN RAILWAY; ALSO, LOT 1 AND THE WEST 25 FEET OF LOT 2 IN GROVER AND CURREY'S SUBDIVISION OF LOT 6 (EXCEPT THE NORTH 2 FEET THEREOF) AND LOTS 7 AND 8 IN BLOCK 2 IN PRATT'S ADDITION TO EVANSTON, A SUBDIVISION OF THAT PART OF THE SOUTHWEST 1/4 OF THE NORTHWEST 1/4 OF SECTION 18, TOWNSHIP 41 NORTH, RANGE 14, EAST OF THE THIRD PRINCIPAL MERIDIAN, LYING EAST OF RIDGE ROAD AND WEST OF MILWAUKEE DIVISION OF CHICAGO AND NORTHWESTERN RAILWAY, TAKEN AS A TRACT LYING BELOW A HORIZONTAL PLANE HAVING AND ELEVATION OF +15.00 CITY OF EVANSTON DATUM AND LYING ABOVE A HORIZONTAL PLANE HAVING AND ELEVATION OF +8.00 CITY OF EVANSTON DATUM AND LYING WITHIN ITS HORIZONTAL BOUNDARIES PROJECTED VERTICALLY AND DESCRIBED AS FOLLOWS: COMMENCING AT THE SOUTHEAST CORNER OF SAID TRACT; THENCE NORTH 80°00'00" WEST, ALONG THE SOUTH LINE THEREOF, 296.02 FEET; THENCE NORTH 00°01'00" EAST 63.75 FEET TO THE POINT OF BEGINNING; THENCE NORTH 89°38'40" EAST 173.85 FEET; THENCE NORTH 00°05'28" WEST 62.84 FEET; THENCE SOUTH 89°28'32" WEST 173.73 FEET; THENCE SOUTH 00°01'00" WEST 62.83 FEET TO THE POINT OF BEGINNING, IN COOK COUNTY, ILLINOIS.

CONTAINING 10,920 SQUARE FEET, MORE OR LESS.

UNOFFICIAL COPY**OFFICE PARKING PARCEL 2C AT SECOND FLOOR LEVEL:**

LOTS 1 AND 2 (EXCEPT THE WESTERLY 11 FEET THEREOF); LOT 3 (EXCEPT THE WESTERLY 11 FEET OF THE NORTHERLY 12 FEET THEREOF); LOTS 4 AND 5 AND THE NORTH 2 FEET OF LOT 6; ALL OF LOTS 16, 17, 18, 19 AND 20 AND LOT 21 (EXCEPT THAT PART OF LOT 21 WHICH LIES NORTH AND EAST OF A STRAIGHT LINE DRAWN FROM THE SOUTHEAST CORNER OF SAID LOT 21 TO A POINT ON THE NORTH LINE OF AND 50 FEET WEST OF THE NORTHEAST CORNER OF SAID LOT 21); THE VACATED NORTH-SOUTH PUBLIC ALLEY, LYING BETWEEN SAID LOTS 1 TO 6, INCLUSIVE AND LOTS 16 TO 21, INCLUSIVE; THAT PART OF THE VACATED SOUTH 8 FEET OF CLARK STREET, WHICH LIES EAST OF THE WEST LINE OF SAID LOTS 1 TO 6, INCLUSIVE EXTENDED IN A NORTHEASTERLY DIRECTION AND WEST OF THE SAID LINE DRAWN FROM THE SOUTHEAST CORNER OF SAID LOT 21 TO A POINT ON THE NORTH LINE OF AND 50 FEET WEST OF THE NORTHEAST CORNER OF SAID LOT 21 EXTENDED IN A NORTHWESTERLY DIRECTION; ALSO LOTS 'A', 'B', 'C' AND LOT 'D' (EXCEPT THE WEST 25 FEET THEREOF) IN GROVER AND CURREY'S SUBDIVISION OF LOT 6 (EXCEPT THE NORTH 2 FEET THEREOF) AND LOTS 7 AND 8; ALL OF THE AFORESAID PROPERTY BEING LOCATED IN BLOCK 2 IN PRATT'S ADDITION TO EVANSTON, A SUBDIVISION OF PART OF THE SOUTHWEST 1/4 OF THE NORTHWEST 1/4 OF SECTION 18, TOWNSHIP 41 NORTH, RANGE 14, EAST OF THE THIRD PRINCIPAL MERIDIAN, LYING EAST OF RIDGE ROAD AND WEST OF MILWAUKEE DIVISION OF CHICAGO AND NORTHWESTERN RAILWAY; ALSO, LOT 1 AND THE WEST 25 FEET OF LOT D IN GROVER AND CURREY'S SUBDIVISION OF LOT 6 (EXCEPT THE NORTH 2 FEET THEREOF) AND LOTS 7 AND 8 IN BLOCK 2 IN PRATT'S ADDITION TO EVANSTON, A SUBDIVISION OF THAT PART OF THE SOUTHWEST 1/4 OF THE NORTHWEST 1/4 OF SECTION 18, TOWNSHIP 41 NORTH, RANGE 14, EAST OF THE THIRD PRINCIPAL MERIDIAN, LYING EAST OF RIDGE ROAD AND WEST OF MILWAUKEE DIVISION OF CHICAGO AND NORTHWESTERN RAILWAY, TAKEN AS A TRACT LYING BELOW A HORIZONTAL PLANE HAVING AN ELEVATION OF +55.50 CITY OF EVANSTON DATUM AND LYING ABOVE A HORIZONTAL PLANE HAVING AN ELEVATION OF +35.58 CITY OF EVANSTON DATUM AND LYING WITHIN ITS HORIZONTAL BOUNDARIES PROJECTED VERTICALLY AND DESCRIBED AS FOLLOWS: COMMENCING AT THE SOUTHEAST CORNER OF SAID TRACT; THENCE NORTH 90°00'00" WEST, ALONG THE SOUTH LINE THEREOF, 241.60 FEET TO THE POINT OF BEGINNING; THENCE NORTH 90°00'00" WEST, ALONG THE SOUTH LINE THEREOF, 54.42 FEET; THENCE NORTH 00°01'00" EAST 64.75 FEET; THENCE SOUTH 89°52'00" EAST 8.34 FEET; THENCE NORTH 00°01'00" EAST 17.83 FEET; THENCE SOUTH 89°59'00" EAST 12.75 FEET; THENCE SOUTH 00°01'00" WEST 17.83 FEET; THENCE SOUTH 89°59'00" EAST 33.33 FEET; THENCE SOUTH 00°01'00" WEST 84.74 FEET TO THE POINT OF BEGINNING (EXCEPT THAT PART THEREOF LYING ABOVE A HORIZONTAL PLANE HAVING AN ELEVATION OF +49.33 CITY OF EVANSTON DATUM AND LYING WITHIN ITS HORIZONTAL BOUNDARIES PROJECTED VERTICALLY AND DESCRIBED AS FOLLOWS: COMMENCING AT THE SOUTHEAST CORNER OF SAID TRACT; THENCE NORTH 90°00'00" WEST, ALONG THE SOUTH LINE THEREOF, 241.60 FEET; THENCE NORTH 00°01'00" EAST, 52.71 FEET; THENCE SOUTH 89°46'20" WEST, 0.45 FEET TO THE POINT OF BEGINNING; THENCE SOUTH 89°46'20" WEST, 14.22 FEET; THENCE NORTH 00°13'40" WEST, 6.48 FEET; THENCE NORTH 89°46'20" EAST, 14.22 FEET; THENCE SOUTH

UNOFFICIAL COPY

00°13'40" EAST, 6.46 FEET TO THE POINT OF BEGINNING), IN COOK COUNTY, ILLINOIS.

CONTAINING 3,751 SQUARE FEET, MORE OR LESS.

OFFICE PARKING PARCEL 2D AT SECOND FLOOR LEVEL:

LOTS 1 AND 2 (EXCEPT THE WESTERLY 11 FEET THEREOF); LOT 3 (EXCEPT THE WESTERLY 11 FEET OF THE NORTHERLY 12 FEET THEREOF); LOTS 4 AND 5 AND THE NORTH 2 FEET OF LOT 6; ALL OF LOTS 16, 17, 18, 19 AND 20 AND LOT 21 (EXCEPT THAT PART OF LOT 21 WHICH LIES NORTH AND EAST OF A STRAIGHT LINE DRAWN FROM THE SOUTHEAST CORNER OF SAID LOT 21 TO A POINT ON THE NORTH LINE OF AND 50 FEET WEST OF THE NORTHEAST CORNER OF SAID LOT 21); THE VACATED NORTH-SOUTH PUBLIC ALLEY, LYING BETWEEN SAID LOTS 1 TO 6, INCLUSIVE AND LOTS 16 TO 21, INCLUSIVE; THAT PART OF THE VACATED SOUTH 8 FEET OF CLARK STREET, WHICH LIES EAST OF THE WEST LINE OF SAID LOTS 1 TO 6, INCLUSIVE EXTENDED IN A NORTHEASTERLY DIRECTION AND WEST OF THE SAID LINE DRAWN FROM THE SOUTHEAST CORNER OF SAID LOT 21 TO A POINT ON THE NORTH LINE OF AND 50 FEET WEST OF THE NORTHEAST CORNER OF SAID LOT 21 EXTENDED IN A NORTHWESTERLY DIRECTION; ALSO LOTS 'A', 'B', 'C' AND LOT 'D' (EXCEPT THE WEST 25 FEET THEREOF) IN GROVER AND CURREY'S SUBDIVISION OF LOT 8 (EXCEPT THE NORTH 2 FEET THEREOF) AND LOTS 7 AND 8; ALL OF THE AFORESAID PROPERTY BEING LOCATED IN BLOCK 2 IN PRATT'S ADDITION TO EVANSTON, A SUBDIVISION OF PART OF THE SOUTHWEST 1/4 OF THE NORTHWEST 1/4 OF SECTION 18, TOWNSHIP 41 NORTH, RANGE 14, EAST OF THE THIRD PRINCIPAL MERIDIAN, LYING EAST OF RIDGE ROAD AND WEST OF MILWAUKEE DIVISION OF CHICAGO AND NORTHWESTERN RAILWAY; ALSO, LOT 1 AND THE WEST 25 FEET OF LOT D IN GROVER AND CURREY'S SUBDIVISION OF LOT 8 (EXCEPT THE NORTH 2 FEET THEREOF) AND LOTS 7 AND 8 IN BLOCK 2 IN PRATT'S ADDITION TO EVANSTON, A SUBDIVISION OF THAT PART OF THE SOUTHWEST 1/4 OF THE NORTHWEST 1/4 OF SECTION 18, TOWNSHIP 41 NORTH, RANGE 14, EAST OF THE THIRD PRINCIPAL MERIDIAN, LYING EAST OF RIDGE ROAD AND WEST OF MILWAUKEE DIVISION OF CHICAGO AND NORTHWESTERN RAILWAY, TAKEN AS A TRACT LYING BELOW A HORIZONTAL PLANE HAVING AN ELEVATION OF +41.00 CITY OF EVANSTON DATUM AND LYING ABOVE A HORIZONTAL PLANE HAVING AN ELEVATION OF +35.62 CITY OF EVANSTON DATUM AND LYING WITHIN ITS HORIZONTAL BOUNDARIES PROJECTED VERTICALLY AND DESCRIBED AS FOLLOWS: COMMENCING AT THE SOUTHEAST CORNER OF SAID TRACT; THENCE NORTH 90°00'00" WEST, ALONG THE SOUTH LINE THEREOF, 298.02 FEET; THENCE NORTH 00°01'00" EAST 82.59 FEET TO THE POINT OF BEGINNING; THENCE NORTH 00°01'00" EAST 44.00 FEET; THENCE SOUTH 89°59'00" EAST 122.42 FEET; THENCE SOUTH 00°01'00" WEST 44.00 FEET; THENCE NORTH 89°59'00" WEST 122.42 FEET TO THE POINT OF BEGINNING, IN COOK COUNTY, ILLINOIS.

CONTAINING 5,386 SQUARE FEET, MORE OR LESS.

UNOFFICIAL COPY**OFFICE PARKING PARCEL 2E AT SECOND FLOOR LEVEL:**

LOTS 1 AND 2 (EXCEPT THE WESTERLY 11 FEET THEREOF); LOT 3 (EXCEPT THE WESTERLY 11 FEET OF THE NORTHERLY 12 FEET THEREOF); LOTS 4 AND 5 AND THE NORTH 2 FEET OF LOT 6; ALL OF LOTS 16, 17, 18, 19 AND 20 AND LOT 21 (EXCEPT THAT PART OF LOT 21 WHICH LIES NORTH AND EAST OF A STRAIGHT LINE DRAWN FROM THE SOUTHEAST CORNER OF SAID LOT 21 TO A POINT ON THE NORTH LINE OF AND 50 FEET WEST OF THE NORTHEAST CORNER OF SAID LOT 21); THE VACATED NORTH-SOUTH PUBLIC ALLEY, LYING BETWEEN SAID LOTS 1 TO 6, INCLUSIVE AND LOTS 18 TO 21, INCLUSIVE; THAT PART OF THE VACATED SOUTH 8 FEET OF CLARK STREET, WHICH LIES EAST OF THE WEST LINE OF SAID LOTS 1 TO 6, INCLUSIVE EXTENDED IN A NORTHEASTERLY DIRECTION AND WEST OF THE SAID LINE DRAWN FROM THE SOUTHEAST CORNER OF SAID LOT 21 TO A POINT ON THE NORTH LINE OF AND 50 FEET WEST OF THE NORTHEAST CORNER OF SAID LOT 21 EXTENDED IN A NORTHWESTERLY DIRECTION; ALSO LOTS 'A', 'B', 'C' AND LOT 'D' (EXCEPT THE WEST 25 FEET THEREOF) IN GROVER AND CURREY'S SUBDIVISION OF LOT 6 (EXCEPT THE NORTH 2 FEET THEREOF) AND LOTS 7 AND 8; ALL OF THE AFORESAID PROPERTY BEING LOCATED IN BLOCK 2 IN PRATT'S ADDITION TO EVANSTON, A SUBDIVISION OF PART OF THE SOUTHWEST 1/4 OF THE NORTHWEST 1/4 OF SECTION 18, TOWNSHIP 41 NORTH, RANGE 14, EAST OF THE THIRD PRINCIPAL MERIDIAN, LYING EAST OF RIDGE ROAD AND WEST OF MILWAUKEE DIVISION OF CHICAGO AND NORTHWESTERN RAILWAY; ALSO, LOT 1 AND THE WEST 25 FEET OF LOT D IN GROVER AND CURREY'S SUBDIVISION OF LOT 6 (EXCEPT THE NORTH 2 FEET THEREOF) AND LOTS 7 AND 8 IN BLOCK 2 IN PRATT'S ADDITION TO EVANSTON, A SUBDIVISION OF THAT PART OF THE SOUTHWEST 1/4 OF THE NORTHWEST 1/4 OF SECTION 18, TOWNSHIP 41 NORTH, RANGE 14, EAST OF THE THIRD PRINCIPAL MERIDIAN, LYING EAST OF RIDGE ROAD AND WEST OF MILWAUKEE DIVISION OF CHICAGO AND NORTHWESTERN RAILWAY, TAKEN AS A TRACT LYING BELOW A HORIZONTAL PLANE HAVING AN ELEVATION OF +44.50 CITY OF EVANSTON DATUM AND LYING ABOVE A HORIZONTAL PLANE HAVING AN ELEVATION OF +35.58 CITY OF EVANSTON DATUM AND LYING WITHIN ITS HORIZONTAL BOUNDARIES PROJECTED VERTICALLY AND DESCRIBED AS FOLLOWS: COMMENCING AT THE SOUTHEAST CORNER OF SAID TRACT; THENCE NORTH 90°00'00" WEST, ALONG THE SOUTH LINE THEREOF, 176.10 FEET; THENCE NORTH 00°01'00" EAST 82.55 FEET; THENCE SOUTH 89°59'00" EAST 1.50 FEET TO THE POINT OF BEGINNING; THENCE NORTH 00°01'00" EAST 44.00 FEET; THENCE SOUTH 89°59'00" EAST 76.50 FEET; THENCE SOUTH 00°01'00" WEST 44.00 FEET; THENCE NORTH 89°59'00" WEST 76.50 FEET TO THE POINT OF BEGINNING, IN COOK COUNTY, ILLINOIS.

CONTAINING 3,366 SQUARE FEET, MORE OR LESS.

UNOFFICIAL COPY**OFFICE PARKING PARCEL 2F AT SECOND FLOOR LEVEL:**

LOTS 1 AND 2 (EXCEPT THE WESTERLY 11 FEET THEREOF); LOT 3 (EXCEPT THE WESTERLY 11 FEET OF THE NORTHERLY 12 FEET THEREOF); LOTS 4 AND 5 AND THE NORTH 2 FEET OF LOT 6; ALL OF LOTS 16, 17, 18, 19 AND 20 AND LOT 21 (EXCEPT THAT PART OF LOT 21 WHICH LIES NORTH AND EAST OF A STRAIGHT LINE DRAWN FROM THE SOUTHEAST CORNER OF SAID LOT 21 TO A POINT ON THE NORTH LINE OF AND 50 FEET WEST OF THE NORTHEAST CORNER OF SAID LOT 21); THE VACATED NORTH-SOUTH PUBLIC ALLEY, LYING BETWEEN SAID LOTS 1 TO 6, INCLUSIVE AND LOTS 16 TO 21, INCLUSIVE; THAT PART OF THE VACATED SOUTH 8 FEET OF CLARK STREET, WHICH LIES EAST OF THE WEST LINE OF SAID LOTS 1 TO 6, INCLUSIVE EXTENDED IN A NORTH-EASTERLY DIRECTION AND WEST OF THE SAID LINE DRAWN FROM THE SOUTHEAST CORNER OF SAID LOT 21 TO A POINT ON THE NORTH LINE OF AND 50 FEET WEST OF THE NORTHEAST CORNER OF SAID LOT 21 EXTENDED IN A NORTH-WESTERLY DIRECTION; ALSO LOTS 'A', 'B', 'C' AND LOT 'D' (EXCEPT THE WEST 25 FEET THEREOF) IN GROVER AND CURREY'S SUBDIVISION OF LOT 6 (EXCEPT THE NORTH 2 FEET THEREOF) AND LOTS 7 AND 8; ALL OF THE AFORESAID PROPERTY BEING LOCATED IN BLOCK 2 IN PRATT'S ADDITION TO EVANSTON, A SUBDIVISION OF PART OF THE SOUTHWEST 1/4 OF THE NORTHWEST 1/4 OF SECTION 18, TOWNSHIP 41 NORTH, RANGE 14, EAST OF THE THIRD PRINCIPAL MERIDIAN, LYING EAST OF RIDGE ROAD AND WEST OF MILWAUKEE DIVISION OF CHICAGO AND NORTHWESTERN RAILWAY; ALSO, LOT 1 AND THE WEST 25 FEET OF LOT D IN GROVER AND CURREY'S SUBDIVISION OF LOT 6 (EXCEPT THE NORTH 2 FEET THEREOF) AND LOTS 7 AND 8 IN BLOCK 2 IN PRATT'S ADDITION TO EVANSTON, A SUBDIVISION OF THAT PART OF THE SOUTHWEST 1/4 OF THE NORTHWEST 1/4 OF SECTION 18, TOWNSHIP 41 NORTH, RANGE 14, EAST OF THE THIRD PRINCIPAL MERIDIAN, LYING EAST OF RIDGE ROAD AND WEST OF MILWAUKEE DIVISION OF CHICAGO AND NORTHWESTERN RAILWAY, TAKEN AS A TRACT LYING BELOW A HORIZONTAL PLANE HAVING AN ELEVATION OF +43.55 CITY OF EVANSTON DATUM AND LYING ABOVE A HORIZONTAL PLANE HAVING AN ELEVATION OF +35.58 CITY OF EVANSTON DATUM AND LYING WITHIN ITS HORIZONTAL BOUNDARIES PROJECTED VERTICALLY AND DESCRIBED AS FOLLOWS: COMMENCING AT THE SOUTHEAST CORNER OF SAID TRACT; THENCE NORTH 90°00'00" WEST, ALONG THE SOUTH LINE THEREOF, 296.02 FEET; THENCE NORTH 00°01'00" EAST 64.75 FEET; THENCE SOUTH 89°59'00" EAST 8.34 FEET; THENCE NORTH 00°01'00" EAST 17.83 FEET; THENCE SOUTH 89°59'00" EAST 12.75 FEET TO THE POINT OF BEGINNING; THENCE SOUTH 00°01'00" WEST 17.83 FEET; THENCE SOUTH 89°59'00" EAST 32.65 FEET; THENCE NORTH 00°26'00" EAST 17.83 FEET; THENCE NORTH 89°59'00" WEST 32.78 FEET TO THE POINT OF BEGINNING (EXCEPT THAT PART THEREOF LYING ABOVE A HORIZONTAL PLANE HAVING AN ELEVATION OF +42.54 CITY OF EVANSTON DATUM AND LYING WITHIN ITS HORIZONTAL BOUNDARIES PROJECTED VERTICALLY AND DESCRIBED AS FOLLOWS: COMMENCING AT THE SOUTHEAST CORNER OF SAID TRACT; THENCE NORTH 90°00'00" WEST, ALONG THE SOUTH LINE THEREOF, 296.02 FEET; THENCE NORTH 00°01'00" EAST 64.75 FEET; THENCE SOUTH 89°59'00" EAST 8.34 FEET; THENCE NORTH 00°01'00" EAST 17.83 FEET; THENCE SOUTH 89°59'00" EAST 12.75 FEET; THENCE SOUTH 89°59'00" EAST 7.95 FEET TO THE POINT OF BEGINNING; THENCE SOUTH 00°03'03" WEST 6.66 FEET; THENCE SOUTH 89°59'00" EAST 7.05 FEET; THENCE NORTH 00°03'03" EAST 6.66 FEET; THENCE

UNOFFICIAL COPY

NORTH 89°59'00" WEST 7.05 FEET TO THE POINT OF BEGINNING), IN COOK COUNTY, ILLINOIS.

CONTAINING 583 SQUARE FEET, MORE OR LESS.

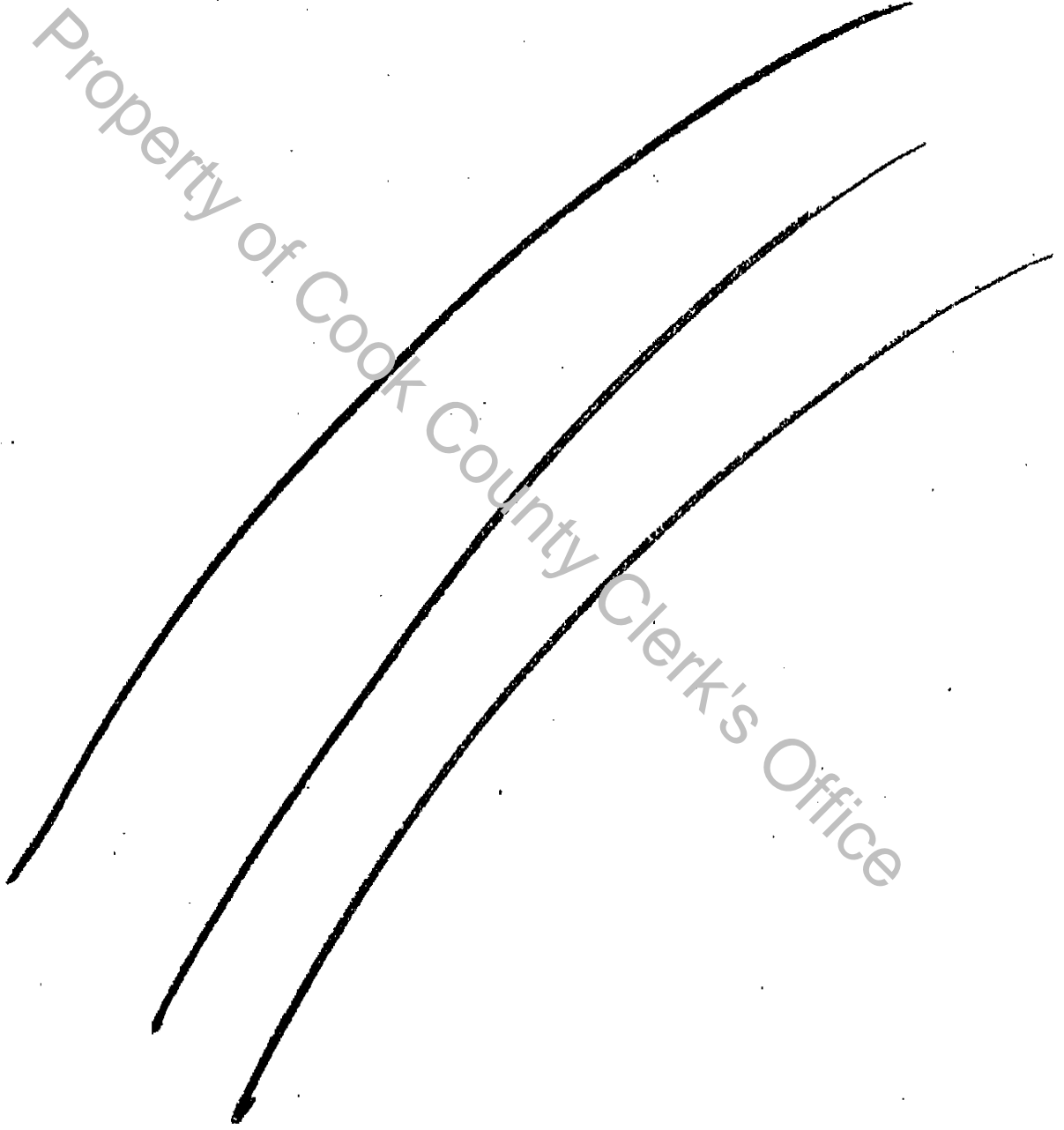

Property of Cook County Clerk's Office

UNOFFICIAL COPY**OFFICE PARKING PARCEL 1 AT SUB-BASEMENT LEVEL:**

LOTS 1 AND 2 (EXCEPT THE WESTERLY 11 FEET THEREOF); LOT 3 (EXCEPT THE WESTERLY 11 FEET OF THE NORTHERLY 12 FEET THEREOF); LOTS 4 AND 5 AND THE NORTH 2 FEET OF LOT 6; ALL OF LOTS 16, 17, 18, 19 AND 20 AND LOT 21 (EXCEPT THAT PART OF LOT 21 WHICH LIES NORTH AND EAST OF A STRAIGHT LINE DRAWN FROM THE SOUTHEAST CORNER OF SAID LOT 21 TO A POINT ON THE NORTH LINE OF AND 50 FEET WEST OF THE NORTHEAST CORNER OF SAID LOT 21); THE VACATED NORTH-SOUTH PUBLIC ALLEY, LYING BETWEEN SAID LOTS 1 TO 6, INCLUSIVE AND LOTS 18 TO 21, INCLUSIVE; THAT PART OF THE VACATED SOUTH 8 FEET OF CLARK STREET, WHICH LIES EAST OF THE WEST LINE OF SAID LOTS 1 TO 6, INCLUSIVE EXTENDED IN A NORTHEASTERLY DIRECTION AND WEST OF THE SAID LINE DRAWN FROM THE SOUTHEAST CORNER OF SAID LOT 21 TO A POINT ON THE NORTH LINE OF AND 50 FEET WEST OF THE NORTHEAST CORNER OF SAID LOT 21 EXTENDED IN A NORTHWESTERLY DIRECTION; ALSO LOTS 'A', 'B', 'C' AND LOT 'D' (EXCEPT THE WEST 25 FEET THEREOF) IN GROVER AND CURREY'S SUBDIVISION OF LOT 6 (EXCEPT THE NORTH 2 FEET THEREOF) AND LOTS 7 AND 8; ALL OF THE AFORESAID PROPERTY BEING LOCATED IN BLOCK 2 IN PRATT'S ADDITION TO EVANSTON, A SUBDIVISION OF PART OF THE SOUTHWEST 1/4 OF THE NORTHWEST 1/4 OF SECTION 18, TOWNSHIP 41 NORTH, RANGE 14, EAST OF THE THIRD PRINCIPAL MERIDIAN LYING EAST OF RIDGE ROAD AND WEST OF MILWAUKEE DIVISION OF CHICAGO AND NORTHWESTERN RAILWAY; ALSO, LOT 1 AND THE WEST 25 FEET OF LOT D IN GROVER AND CURREY'S SUBDIVISION OF LOT 6 (EXCEPT THE NORTH 2 FEET THEREOF) AND LOTS 7 AND 8 IN BLOCK 2 IN PRATT'S ADDITION TO EVANSTON, A SUBDIVISION OF THAT PART OF THE SOUTHWEST 1/4 OF THE NORTHWEST 1/4 OF SECTION 18, TOWNSHIP 41 NORTH, RANGE 14, EAST OF THE THIRD PRINCIPAL MERIDIAN, LYING EAST OF RIDGE ROAD AND WEST OF MILWAUKEE DIVISION OF CHICAGO AND NORTHWESTERN RAILWAY, TAKEN AS A TRACT LYING BELOW A HORIZONTAL PLANE HAVING AN ELEVATION OF +15.00 CITY OF EVANSTON DATUM AND LYING ABOVE A HORIZONTAL PLANE HAVING AN ELEVATION OF +5.00 CITY OF EVANSTON DATUM AND LYING WITHIN ITS HORIZONTAL BOUNDARIES PROJECTED VERTICALLY AND DESCRIBED AS FOLLOWS: COMMENCING AT THE SOUTHEAST CORNER OF SAID TRACT; THENCE NORTH 90°00'00" WEST ALONG THE SOUTH LINE THEREOF, 296.02 FEET TO THE POINT OF BEGINNING; THENCE NORTH 00°01'00" EAST 63.75 FEET; THENCE NORTH 89°38'40" EAST 72.92 FEET; THENCE SOUTH 00°23'06" EAST 64.21 FEET TO THE SOUTH LINE OF SAID TRACT; THENCE NORTH 90°00'00" WEST, ALONG THE SOUTH LINE OF SAID TRACT, 73.37 FEET TO THE POINT OF BEGINNING, IN COOK COUNTY, ILLINOIS.

CONTAINING 4,680 SQUARE FEET, MORE OR LESS.

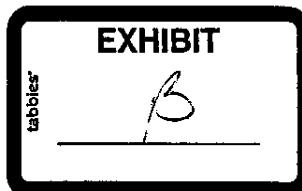

UNOFFICIAL COPY**OFFICE PARKING PARCEL 2A AT SECOND FLOOR LEVEL:**

LOTS 1 AND 2 (EXCEPT THE WESTERLY 11 FEET THEREOF); LOT 3 (EXCEPT THE WESTERLY 11 FEET OF THE NORTHERLY 12 FEET THEREOF); LOTS 4 AND 5 AND THE NORTH 2 FEET OF LOT 6; ALL OF LOTS 16, 17, 18, 19 AND 20 AND LOT 21 (EXCEPT THAT PART OF LOT 21 WHICH LIES NORTH AND EAST OF A STRAIGHT LINE DRAWN FROM THE SOUTHEAST CORNER OF SAID LOT 21 TO A POINT ON THE NORTH LINE OF AND 60 FEET WEST OF THE NORTHEAST CORNER OF SAID LOT 21); THE VACATED NORTH-SOUTH PUBLIC ALLEY, LYING BETWEEN SAID LOTS 1 TO 6, INCLUSIVE AND LOTS 18 TO 21, INCLUSIVE; THAT PART OF THE VACATED SOUTH 8 FEET OF CLARK STREET, WHICH LIES EAST OF THE WEST LINE OF SAID LOTS 1 TO 8, INCLUSIVE EXTENDED IN A NORTHEASTERLY DIRECTION AND WEST OF THE SAID LINE DRAWN FROM THE SOUTHEAST CORNER OF SAID LOT 21 TO A POINT ON THE NORTH LINE OF AND 50 FEET WEST OF THE NORTHEAST CORNER OF SAID LOT 21 EXTENDED IN A NORTHWESTERLY DIRECTION; ALSO LOTS 'A', 'B', 'C' AND LOT 'D' (EXCEPT THE WEST 25 FEET THEREOF) IN GROVER AND CURREY'S SUBDIVISION OF LOT 6 (EXCEPT THE NORTH 2 FEET THEREOF) AND LOTS 7 AND 8; ALL OF THE AFORESAID PROPERTY BEING LOCATED IN BLOCK 2 IN PRATT'S ADDITION TO EVANSTON, A SUBDIVISION OF PART OF THE SOUTHWEST 1/4 OF THE NORTHWEST 1/4 OF SECTION 18, TOWNSHIP 41 NORTH, RANGE 14, EAST OF THE THIRD PRINCIPAL MERIDIAN, LYING EAST OF RIDGE ROAD AND WEST OF MILWAUKEE DIVISION OF CHICAGO AND NORTHWESTERN RAILWAY; ALSO, LOT 1 AND THE WEST 25 FEET OF LOT D IN GROVER AND CURREY'S SUBDIVISION OF LOT 6 (EXCEPT THE NORTH 2 FEET THEREOF) AND LOTS 7 AND 8 IN BLOCK 2 IN PRATT'S ADDITION TO EVANSTON, A SUBDIVISION OF THAT PART OF THE SOUTHWEST 1/4 OF THE NORTHWEST 1/4 OF SECTION 18, TOWNSHIP 41 NORTH, RANGE 14, EAST OF THE THIRD PRINCIPAL MERIDIAN, LYING EAST OF RIDGE ROAD AND WEST OF MILWAUKEE DIVISION OF CHICAGO AND NORTHWESTERN RAILWAY, TAKEN AS A TRACT LYING BELOW A HORIZONTAL PLANE HAVING AN ELEVATION OF +48.25 CITY OF EVANSTON DATUM AND LYING ABOVE A HORIZONTAL PLANE HAVING AN ELEVATION OF +35.58 CITY OF EVANSTON DATUM AND LYING WITHIN ITS HORIZONTAL BOUNDARIES PROJECTED VERTICALLY AND DESCRIBED AS FOLLOWS: BEGINNING AT THE SOUTHEAST CORNER OF SAID TRACT; THENCE NORTH 90°00'00" WEST, ALONG THE SOUTH LINE THEREOF, 176.10 FEET; THENCE NORTH 00°01'00" EAST 82.65 FEET; THENCE SOUTH 89°59'00" EAST 78.00 FEET; THENCE NORTH 00°01'00" EAST 44.00 FEET; THENCE SOUTH 89°59'00" EAST 42.10 FEET; THENCE SOUTH 00°01'00" WEST 17.69 FEET; THENCE NORTH 89°52'00" EAST 5.52 FEET; THENCE SOUTH 00°01'00" WEST 28.32 FEET; THENCE NORTH 89°59'00" WEST 35.87 FEET; THENCE SOUTH 00°01'00" WEST 35.75 FEET; THENCE SOUTH 89°59'00" EAST 40.87 FEET; THENCE SOUTH 00°01'00" WEST 21.83 FEET; THENCE SOUTH 89°59'00" EAST 55.50 FEET TO THE EAST LINE OF SAID TRACT; THENCE SOUTH 00°01'44" EAST, ALONG THE EAST LINE OF SAID TRACT, 24.92 FEET TO THE POINT OF BEGINNING, IN COOK COUNTY, ILLINOIS.

CONTAINING 11,506 SQUARE FEET, MORE OR LESS.

UNOFFICIAL COPY**OFFICE PARKING PARCEL AT BASEMENT LEVEL:**

LOTS 1 AND 2 (EXCEPT THE WESTERLY 11 FEET THEREOF); LOT 3 (EXCEPT THE WESTERLY 11 FEET OF THE NORTHERLY 12 FEET THEREOF); LOTS 4 AND 5 AND THE NORTH 2 FEET OF LOT 6; ALL OF LOTS 16, 17, 18, 19 AND 20 AND LOT 21 (EXCEPT THAT PART OF LOT 21 WHICH LIES NORTH AND EAST OF A STRAIGHT LINE DRAWN FROM THE SOUTHEAST CORNER OF SAID LOT 21 TO A POINT ON THE NORTH LINE OF AND 50 FEET WEST OF THE NORTHEAST CORNER OF SAID LOT 21); THE VACATED NORTH-SOUTH PUBLIC ALLEY, LYING BETWEEN SAID LOTS 1 TO 6, INCLUSIVE AND LOTS 16 TO 21, INCLUSIVE; THAT PART OF THE VACATED SOUTH 8 FEET OF CLARK STREET, WHICH LIES EAST OF THE WEST LINE OF SAID LOTS 1 TO 6, INCLUSIVE EXTENDED IN A NORTHEASTERLY DIRECTION AND WEST OF THE SAID LINE DRAWN FROM THE SOUTHEAST CORNER OF SAID LOT 21 TO A POINT ON THE NORTH LINE OF AND 50 FEET WEST OF THE NORTHEAST CORNER OF SAID LOT 21 EXTENDED IN A NORTHWESTERLY DIRECTION; ALSO LOTS 'A', 'B', 'C' AND LOT 'D' (EXCEPT THE WEST 25 FEET THEREOF) IN GROVER AND CURREY'S SUBDIVISION OF LOT 6 (EXCEPT THE NORTH 2 FEET THEREOF) AND LOTS 7 AND 8; ALL OF THE AFORESAID PROPERTY BEING LOCATED IN BLOCK 2 IN PRATT'S ADDITION TO EVANSTON, A SUBDIVISION OF PART OF THE SOUTHWEST 1/4 OF THE NORTHWEST 1/4 OF SECTION 18, TOWNSHIP 41 NORTH, RANGE 14, EAST OF THE THIRD PRINCIPAL MERIDIAN, LYING EAST OF RIDGE ROAD AND WEST OF MILWAUKEE DIVISION OF CHICAGO AND NORTHWESTERN RAILWAY; ALSO, LOT 1 AND THE WEST 25 FEET OF LOT D IN GROVER AND CURREY'S SUBDIVISION OF LOT 6 (EXCEPT THE NORTH 2 FEET THEREOF) AND LOTS 7 AND 8 IN BLOCK 2 IN PRATT'S ADDITION TO EVANSTON, A SUBDIVISION OF THAT PART OF THE SOUTHWEST 1/4 OF THE NORTHWEST 1/4 OF SECTION 18, TOWNSHIP 41 NORTH, RANGE 14, EAST OF THE THIRD PRINCIPAL MERIDIAN, LYING EAST OF RIDGE ROAD AND WEST OF MILWAUKEE DIVISION OF CHICAGO AND NORTHWESTERN RAILWAY, TAKEN AS A TRACT LYING BELOW A HORIZONTAL PLANE HAVING AN ELEVATION OF +25.58 CITY OF EVANSTON DATUM AND LYING ABOVE A HORIZONTAL PLANE HAVING AN ELEVATION OF +15.00 CITY OF EVANSTON DATUM AND LYING WITHIN ITS HORIZONTAL BOUNDARIES PROJECTED VERTICALLY AND DESCRIBED AS FOLLOWS: BEGINNING AT THE SOUTHEAST CORNER OF SAID TRACT; THENCE NORTH 90°00'00" WEST, ALONG THE SOUTH LINE THEREOF, 296.02 FEET; THENCE NORTH 00°01'00" EAST, 126.59 FEET; THENCE NORTH 89°38'32" EAST, 198.95 FEET; THENCE SOUTH 00°21'02" EAST, 17.38 FEET; THENCE NORTH 89°49'09" EAST, 16.06 FEET; THENCE SOUTH 00°07'09" EAST, 18.77 FEET; THENCE SOUTH 89°53'08" WEST, 18.84 FEET; THENCE SOUTH 00°28'29" EAST, 7.22 FEET; THENCE NORTH 89°37'51" EAST, 0.80 FEET; THENCE SOUTH 00°22'09" EAST, 34.88 FEET; THENCE NORTH 89°37'51" EAST, 0.69 FEET; THENCE SOUTH 00°18'00" EAST, 2.72 FEET; THENCE NORTH 89°42'00" EAST, 24.47 FEET; THENCE NORTH 00°24'30" WEST, 36.66 FEET; THENCE SOUTH 89°47'34" WEST, 0.38 FEET; THENCE NORTH 00°03'14" WEST, 35.67 FEET; THENCE NORTH 89°56'46" EAST, 8.54 FEET; THENCE NORTH 00°03'14" WEST, 8.68 FEET; THENCE NORTH 89°38'32" EAST, 44.01 FEET; THENCE SOUTH 00°17'21" EAST, 17.54 FEET; THENCE SOUTH 89°46'39" EAST, 19.40 FEET TO THE EAST LINE OF SAID TRACT; THENCE SOUTH 00°01'44" EAST, ALONG THE EAST LINE OF SAID TRACT, 110.89 FEET TO THE POINT OF BEGINNING, IN COOK COUNTY, ILLINOIS.

UNOFFICIAL COPY

CONTAINING 35,635 SQUARE FEET, MORE OR LESS.

OFFICE PARKING PARCEL 1A AT FIRST FLOOR LEVEL:

LOTS 1 AND 2 (EXCEPT THE WESTERLY 11 FEET THEREOF); LOT 3 (EXCEPT THE WESTERLY 11 FEET OF THE NORTHERLY 12 FEET THEREOF); LOTS 4 AND 5 AND THE NORTH 2 FEET OF LOT 6; ALL OF LOTS 16, 17, 18, 19 AND 20 AND LOT 21 (EXCEPT THAT PART OF LOT 21 WHICH LIES NORTH AND EAST OF A STRAIGHT LINE DRAWN FROM THE SOUTHEAST CORNER OF SAID LOT 21 TO A POINT ON THE NORTH LINE OF AND 50 FEET WEST OF THE NORTHEAST CORNER OF SAID LOT 21); THE VACATED NORTH-SOUTH PUBLIC ALLEY, LYING BETWEEN SAID LOTS 1 TO 6, INCLUSIVE AND LOTS 16 TO 21, INCLUSIVE; THAT PART OF THE VACATED SOUTH 8 FEET OF CLARK STREET, WHICH LIES EAST OF THE WEST LINE OF SAID LOTS 1 TO 6, INCLUSIVE EXTENDED IN A NORTHEASTERLY DIRECTION AND WEST OF THE SAID LINE DRAWN FROM THE SOUTHEAST CORNER OF SAID LOT 21 TO A POINT ON THE NORTH LINE OF AND 50 FEET WEST OF THE NORTHEAST CORNER OF SAID LOT 21 EXTENDED IN A NORTHWESTERLY DIRECTION; ALSO LOTS 'A', 'B', 'C' AND LOT 'D' (EXCEPT THE WEST 25 FEET THEREOF) IN GROVER AND CURREY'S SUBDIVISION OF LOT 8 (EXCEPT THE NORTH 2 FEET THEREOF) AND LOTS 7 AND 8; ALL OF THE AFORESAID PROPERTY BEING LOCATED IN BLOCK 2 IN PRATT'S ADDITION TO EVANSTON, A SUBDIVISION OF PART OF THE SOUTHWEST 1/4 OF THE NORTHWEST 1/4 OF SECTION 18, TOWNSHIP 41 NORTH, RANGE 14, EAST OF THE THIRD PRINCIPAL MERIDIAN, LYING EAST OF RIDGE ROAD AND WEST OF MILWAUKEE DIVISION OF CHICAGO AND NORTHWESTERN RAILWAY; ALSO, LOT 1 AND THE WEST 25 FEET OF LOT D IN (GROVER AND CURREY'S SUBDIVISION OF LOT 8 (EXCEPT THE NORTH 2 FEET THEREOF) AND LOTS 7 AND 8 IN BLOCK 2 IN PRATT'S ADDITION TO EVANSTON, A SUBDIVISION OF THAT PART OF THE SOUTHWEST 1/4 OF THE NORTHWEST 1/4 OF SECTION 18, TOWNSHIP 41 NORTH, RANGE 14, EAST OF THE THIRD PRINCIPAL MERIDIAN, LYING EAST OF RIDGE ROAD AND WEST OF MILWAUKEE DIVISION OF CHICAGO AND NORTHWESTERN RAILWAY, TAKEN AS A TRACT LYING BELOW A HORIZONTAL PLANE HAVING AN ELEVATION OF +35.58 CITY OF EVANSTON DATUM AND LYING ABOVE A HORIZONTAL PLANE HAVING AN ELEVATION OF +25.58 CITY OF EVANSTON DATUM AND LYING WITHIN ITS HORIZONTAL BOUNDARIES. PROJECTED VERTICALLY AND DESCRIBED AS FOLLOWS: BEGINNING AT THE SOUTHEAST CORNER OF SAID TRACT; THENCE NORTH 90°00'00" WEST, ALONG THE SOUTH LINE THEREOF, 296.02 FEET; THENCE NORTH 00°01'00" EAST, 128.59 FEET; THENCE SOUTH 89°59'00" EAST 295.92 FEET TO THE EAST LINE OF SAID TRACT; THENCE SOUTH 00°01'44" EAST, ALONG THE EAST LINE OF SAID TRACT, 128.50 FEET TO THE POINT OF BEGINNING (EXCEPT THAT PART THEREOF DESCRIBED AS FOLLOWS: COMMENCING AT THE SOUTHEAST CORNER OF SAID TRACT; THENCE NORTH 90°00'00" WEST, ALONG THE SOUTH LINE THEREOF, 71.60 FEET; THENCE NORTH 00°01'00" EAST 55.52 FEET TO THE POINT OF BEGINNING; THENCE NORTH 89°59'00" WEST 18.33 FEET; NORTH 00°01'00" EAST 27.00 FEET; THENCE SOUTH 89°59'00" EAST 18.33 FEET; THENCE SOUTH 00°01'00" WEST 27.00 FEET TO THE POINT OF BEGINNING), IN COOK COUNTY, ILLINOIS.

CONTAINING 36,958 SQUARE FEET, MORE OR LESS.

UNOFFICIAL COPY

OFFICE PARKING PARCEL 1B AT FIRST FLOOR LEVEL:

LOTS 1 AND 2 (EXCEPT THE WESTERLY 11 FEET THEREOF); LOT 3 (EXCEPT THE WESTERLY 11 FEET OF THE NORTHERLY 12 FEET THEREOF); LOTS 4 AND 5 AND THE NORTH 2 FEET OF LOT 6; ALL OF LOTS 16, 17, 18, 19 AND 20 AND LOT 21 (EXCEPT THAT PART OF LOT 21 WHICH LIES NORTH AND EAST OF A STRAIGHT LINE DRAWN FROM THE SOUTHEAST CORNER OF SAID LOT 21 TO A POINT ON THE NORTH LINE OF AND 50 FEET WEST OF THE NORTHEAST CORNER OF SAID LOT 21); THE VACATED NORTH-SOUTH PUBLIC ALLEY, LYING BETWEEN SAID LOTS 1 TO 6, INCLUSIVE AND LOTS 16 TO 21, INCLUSIVE; THAT PART OF THE VACATED SOUTH 8 FEET OF CLARK STREET, WHICH LIES EAST OF THE WEST LINE OF SAID LOTS 1 TO 6, INCLUSIVE EXTENDED IN A NORTHEASTERLY DIRECTION AND WEST OF THE SAID LINE DRAWN FROM THE SOUTHEAST CORNER OF SAID LOT 21 TO A POINT ON THE NORTH LINE OF AND 50 FEET WEST OF THE NORTHEAST CORNER OF SAID LOT 21 EXTENDED IN A NORTHWESTERLY DIRECTION; ALSO LOTS 'A', 'B', 'C' AND LOT 'D' (EXCEPT THE WEST 25 FEET THEREOF) IN GROVER AND CURREY'S SUBDIVISION OF LOT 6 (EXCEPT THE NORTH 2 FEET THEREOF) AND LOTS 7 AND 8; ALL OF THE AFORESAID PROPERTY BEING LOCATED IN BLOCK 2 IN PRATT'S ADDITION TO EVANSTON, A SUBDIVISION OF PART OF THE SOUTHWEST 1/4 OF THE NORTHWEST 1/4 OF SECTION 18, TOWNSHIP 41 NORTH, RANGE 14, EAST OF THE THIRD PRINCIPAL MERIDIAN, LYING EAST OF RIDGE ROAD AND WEST OF MILWAUKEE DIVISION OF CHICAGO AND NORTHWESTERN RAILWAY; ALSO, LOT 1 AND THE WEST 25 FEET OF LOT 'D' IN GROVER AND CURREY'S SUBDIVISION OF LOT 6 (EXCEPT THE NORTH 2 FEET THEREOF) AND LOTS 7 AND 8 IN BLOCK 2 IN PRATT'S ADDITION TO EVANSTON, A SUBDIVISION OF THAT PART OF THE SOUTHWEST 1/4 OF THE NORTHWEST 1/4 OF SECTION 18, TOWNSHIP 41 NORTH, RANGE 14, EAST OF THE THIRD PRINCIPAL MERIDIAN, LYING EAST OF RIDGE ROAD AND WEST OF MILWAUKEE DIVISION OF CHICAGO AND NORTHWESTERN RAILWAY, TAKEN AS A TRACT LYING BELOW A HORIZONTAL PLANE HAVING AN ELEVATION OF +36.87 CITY OF EVANSTON DATUM AND LYING ABOVE A HORIZONTAL PLANE HAVING AN ELEVATION OF +25.58 CITY OF EVANSTON DATUM AND LYING WITHIN ITS HORIZONTAL BOUNDARIES PROJECTED VERTICALLY AND DESCRIBED AS FOLLOWS: COMMENCING AT THE SOUTHEAST CORNER OF SAID TRACT; THENCE NORTH 90°00'00" WEST, ALONG THE SOUTH LINE THEREOF, 71.60 FEET; THENCE NORTH 00°01'00" EAST 55.52 FEET TO THE POINT OF BEGINNING; THENCE NORTH 89°59'00" WEST 10.80 FEET; NORTH 00°00'33" WEST 18.15 FEET; THENCE SOUTH 89°52'01" EAST 10.81 FEET; THENCE SOUTH 00°01'00" WEST 18.13 FEET TO THE POINT OF BEGINNING, IN COOK COUNTY, ILLINOIS.

CONTAINING 196 SQUARE FEET, MORE OR LESS.

UNOFFICIAL COPY**OFFICE PARKING PARCEL 2B AT SECOND FLOOR LEVEL:**

LOTS 1 AND 2 (EXCEPT THE WESTERLY 11 FEET THEREOF); LOT 3 (EXCEPT THE WESTERLY 11 FEET OF THE NORTHERLY 12 FEET THEREOF); LOTS 4 AND 5 AND THE NORTH 2 FEET OF LOT 6; ALL OF LOTS 16, 17, 18, 19 AND 20 AND LOT 21 (EXCEPT THAT PART OF LOT 21 WHICH LIES NORTH AND EAST OF A STRAIGHT LINE DRAWN FROM THE SOUTHEAST CORNER OF SAID LOT 21 TO A POINT ON THE NORTH LINE OF AND 50 FEET WEST OF THE NORTHEAST CORNER OF SAID LOT 21); THE VACATED NORTH-SOUTH PUBLIC ALLEY, LYING BETWEEN SAID LOTS 1 TO 6, INCLUSIVE AND LOTS 16 TO 21, INCLUSIVE; THAT PART OF THE VACATED SOUTH 8 FEET OF CLARK STREET, WHICH LIES EAST OF THE WEST LINE OF SAID LOTS 1 TO 6, INCLUSIVE EXTENDED IN A NORTHEASTERLY DIRECTION AND WEST OF THE SAID LINE DRAWN FROM THE SOUTHEAST CORNER OF SAID LOT 21 TO A POINT ON THE NORTH LINE OF AND 50 FEET WEST OF THE NORTHEAST CORNER OF SAID LOT 21 EXTENDED IN A NORTHWESTERLY DIRECTION; ALSO LOTS 'A', 'B', 'C' AND LOT 'D' (EXCEPT THE WEST 25 FEET THEREOF) IN GROVER AND CURREY'S SUBDIVISION OF LOT 6 (EXCEPT THE NORTH 2 FEET THEREOF) AND LOTS 7 AND 8; ALL OF THE AFORESAID PROPERTY BEING LOCATED IN BLOCK 2 IN PRATT'S ADDITION TO EVANSTON, A SUBDIVISION OF PART OF THE SOUTHWEST 1/4 OF THE NORTHWEST 1/4 OF SECTION 18, TOWNSHIP 41 NORTH, RANGE 14, EAST OF THE THIRD PRINCIPAL MERIDIAN, LYING EAST OF RIDGE ROAD AND WEST OF MILWAUKEE DIVISION OF CHICAGO AND NORTHWESTERN RAILWAY; ALSO, LOT 1 AND THE WEST 25 FEET OF LOT D IN GROVER AND CURREY'S SUBDIVISION OF LOT 6 (EXCEPT THE NORTH 2 FEET THEREOF) AND LOTS 7 AND 8 IN BLOCK 2 IN PRATT'S ADDITION TO EVANSTON, A SUBDIVISION OF THAT PART OF THE SOUTHWEST 1/4 OF THE NORTHWEST 1/4 OF SECTION 18, TOWNSHIP 41 NORTH, RANGE 14, EAST OF THE THIRD PRINCIPAL MERIDIAN, LYING EAST OF RIDGE ROAD AND WEST OF MILWAUKEE DIVISION OF CHICAGO AND NORTHWESTERN RAILWAY, TAKEN AS A TRACT LYING BELOW A HORIZONTAL PLANE HAVING AN ELEVATION OF +44.75 CITY OF EVANSTON DATUM AND LYING ABOVE A HORIZONTAL PLANE HAVING AN ELEVATION OF +35.58 CITY OF EVANSTON DATUM AND LYING WITHIN ITS HORIZONTAL BOUNDARIES PROJECTED VERTICALLY AND DESCRIBED AS FOLLOWS: COMMENCING AT THE SOUTHEAST CORNER OF SAID TRACT; THENCE NORTH 90°00'00" WEST, ALONG THE SOUTH LINE THEREOF, 175.10 FEET TO THE POINT OF BEGINNING; THENCE NORTH 90°00'00" WEST, 66.50 FEET; THENCE NORTH 00°01'00" EAST, 64.74 FEET; THENCE NORTH 89°59'00" WEST, 0.69 FEET; THENCE NORTH 00°26'00" EAST, 17.83 FEET; THENCE SOUTH 89°59'00" EAST, 67.06 FEET; THENCE SOUTH 00°01'00" WEST, 82.55 FEET TO THE POINT OF BEGINNING, IN COOK COUNTY, ILLINOIS.

CONTAINING 5,501 SQUARE FEET, MORE OR LESS.

UNOFFICIAL COPY**OFFICE PARKING PARCEL 2 AT SUB-BASEMENT LEVEL:**

LOTS 1 AND 2 (EXCEPT THE WESTERLY 11 FEET THEREOF); LOT 3 (EXCEPT THE WESTERLY 11 FEET OF THE NORTHERLY 12 FEET THEREOF); LOTS 4 AND 5 AND THE NORTH 2 FEET OF LOT 6; ALL OF LOTS 16, 17, 18, 19 AND 20 AND LOT 21 (EXCEPT THAT PART OF LOT 21 WHICH LIES NORTH AND EAST OF A STRAIGHT LINE DRAWN FROM THE SOUTHEAST CORNER OF SAID LOT 21 TO A POINT ON THE NORTH LINE OF AND 50 FEET WEST OF THE NORTHEAST CORNER OF SAID LOT 21); THE VACATED NORTH-SOUTH PUBLIC ALLEY, LYING BETWEEN SAID LOTS 1 TO 6, INCLUSIVE AND LOTS 16 TO 21, INCLUSIVE; THAT PART OF THE VACATED SOUTH 8 FEET OF CLARK STREET, WHICH LIES EAST OF THE WEST LINE OF SAID LOTS 1 TO 6, INCLUSIVE EXTENDED IN A NORTHEASTERLY DIRECTION AND WEST OF THE SAID LINE DRAWN FROM THE SOUTHEAST CORNER OF SAID LOT 21 TO A POINT ON THE NORTH LINE OF AND 50 FEET WEST OF THE NORTHEAST CORNER OF SAID LOT 21 EXTENDED IN A NORTHWESTERLY DIRECTION; ALSO LOTS 'A', 'B', 'C' AND LOT 'D' (EXCEPT THE WEST 25 FEET THEREOF) IN GROVER AND CURREY'S SUBDIVISION OF LOT 6 (EXCEPT THE NORTH 2 FEET THEREOF) AND LOTS 7 AND 8; ALL OF THE AFORESAID PROPERTY, BEING LOCATED IN BLOCK 2 IN PRATT'S ADDITION TO EVANSTON, A SUBDIVISION OF PART OF THE SOUTHWEST 1/4 OF THE NORTHWEST 1/4 OF SECTION 18, TOWNSHIP 41 NORTH, RANGE 14, EAST OF THE THIRD PRINCIPAL MERIDIAN, LYING EAST OF RIDGE ROAD AND WEST OF MILWAUKEE DIVISION OF CHICAGO AND NORTHWESTERN RAILWAY; ALSO, LOT 1 AND THE WEST 25 FEET OF LOT 'D' IN GROVER AND CURREY'S SUBDIVISION OF LOT 6 (EXCEPT THE NORTH 2 FEET THEREOF) AND LOTS 7 AND 8 IN BLOCK 2 IN PRATT'S ADDITION TO EVANSTON, A SUBDIVISION OF THAT PART OF THE SOUTHWEST 1/4 OF THE NORTHWEST 1/4 OF SECTION 18, TOWNSHIP 41 NORTH, RANGE 14, EAST OF THE THIRD PRINCIPAL MERIDIAN, LYING EAST OF RIDGE ROAD AND WEST OF MILWAUKEE DIVISION OF CHICAGO AND NORTHWESTERN RAILWAY, TAKEN AS A TRACT LYING BELOW A HORIZONTAL PLANE HAVING AND ELEVATION OF +15.00 CITY OF EVANSTON DATUM AND LYING ABOVE A HORIZONTAL PLANE HAVING AND ELEVATION OF +8.00 CITY OF EVANSTON DATUM AND LYING WITHIN ITS HORIZONTAL BOUNDARIES PROJECTED VERTICALLY AND DESCRIBED AS FOLLOWS: COMMENCING AT THE SOUTHEAST CORNER OF SAID TRACT; THENCE NORTH 90°00'00" WEST, ALONG THE SOUTH LINE THEREOF, 296.02 FEET; THENCE NORTH 00°01'00" EAST 63.75 FEET TO THE POINT OF BEGINNING; THENCE NORTH 89°38'40" EAST 173.85 FEET; THENCE NORTH 00°05'26" WEST 62.84 FEET; THENCE SOUTH 89°38'32" WEST 173.73 FEET; THENCE SOUTH 00°01'00" WEST 62.83 FEET TO THE POINT OF BEGINNING, IN COOK COUNTY, ILLINOIS.

CONTAINING 10,920 SQUARE FEET, MORE OR LESS.

UNOFFICIAL COPY**OFFICE PARKING PARCEL 2C AT SECOND FLOOR LEVEL:**

LOTS 1 AND 2 (EXCEPT THE WESTERLY 11 FEET THEREOF); LOT 3 (EXCEPT THE WESTERLY 11 FEET OF THE NORTHERLY 12 FEET THEREOF); LOTS 4 AND 5 AND THE NORTH 2 FEET OF LOT 6; ALL OF LOTS 16, 17, 18, 19 AND 20 AND LOT 21 (EXCEPT THAT PART OF LOT 21 WHICH LIES NORTH AND EAST OF A STRAIGHT LINE DRAWN FROM THE SOUTHEAST CORNER OF SAID LOT 21 TO A POINT ON THE NORTH LINE OF AND 50 FEET WEST OF THE NORTHEAST CORNER OF SAID LOT 21); THE VACATED NORTH-SOUTH PUBLIC ALLEY, LYING BETWEEN SAID LOTS 1 TO 6, INCLUSIVE AND LOTS 16 TO 21, INCLUSIVE; THAT PART OF THE VACATED SOUTH 8 FEET OF CLARK STREET, WHICH LIES EAST OF THE WEST LINE OF SAID LOTS 1 TO 6, INCLUSIVE EXTENDED IN A NORTHEASTERLY DIRECTION AND WEST OF THE SAID LINE DRAWN FROM THE SOUTHEAST CORNER OF SAID LOT 21 TO A POINT ON THE NORTH LINE OF AND 50 FEET WEST OF THE NORTHEAST CORNER OF SAID LOT 21 EXTENDED IN A NORTHWESTERLY DIRECTION; ALSO LOTS 'A', 'B', 'C' AND LOT 'D' (EXCEPT THE WEST 25 FEET THEREOF) IN GROVER AND CURREY'S SUBDIVISION OF LOT 6 (EXCEPT THE NORTH 2 FEET THEREOF) AND LOTS 7 AND 8; ALL OF THE AFORESAID PROPERTY BEING LOCATED IN BLOCK 2 IN PRATT'S ADDITION TO EVANSTON, A SUBDIVISION OF PART OF THE SOUTHWEST 1/4 OF THE NORTHWEST 1/4 OF SECTION 18, TOWNSHIP 41 NORTH, RANGE 14, EAST OF THE THIRD PRINCIPAL MERIDIAN, LYING EAST OF RIDGE ROAD AND WEST OF MILWAUKEE DIVISION OF CHICAGO AND NORTHWESTERN RAILWAY; ALSO, LOT 1 AND THE WEST 25 FEET OF LOT D IN GROVER AND CURREY'S SUBDIVISION OF LOT 6 (EXCEPT THE NORTH 2 FEET THEREOF) AND LOTS 7 AND 8 IN BLOCK 2 IN PRATT'S ADDITION TO EVANSTON, A SUBDIVISION OF THAT PART OF THE SOUTHWEST 1/4 OF THE NORTHWEST 1/4 OF SECTION 18, TOWNSHIP 41 NORTH, RANGE 14, EAST OF THE THIRD PRINCIPAL MERIDIAN, LYING EAST OF RIDGE ROAD AND WEST OF MILWAUKEE DIVISION OF CHICAGO AND NORTHWESTERN RAILWAY, TAKEN AS A TRACT LYING BELOW A HORIZONTAL PLANE HAVING AN ELEVATION OF +55.50 CITY OF EVANSTON DATUM AND LYING ABOVE A HORIZONTAL PLANE HAVING AN ELEVATION OF +35.58 CITY OF EVANSTON DATUM AND LYING WITHIN ITS HORIZONTAL BOUNDARIES PROJECTED VERTICALLY AND DESCRIBED AS FOLLOWS: COMMENCING AT THE SOUTHEAST CORNER OF SAID TRACT; THENCE NORTH 90°00'00" WEST, ALONG THE SOUTH LINE THEREOF, 241.60 FEET TO THE POINT OF BEGINNING; THENCE NORTH 90°00'00" WEST, ALONG THE SOUTH LINE THEREOF, 54.42 FEET; THENCE NORTH 00°01'00" EAST 64.75 FEET; THENCE SOUTH 89°59'00" EAST 8.34 FEET; THENCE NORTH 00°01'00" EAST 17.83 FEET; THENCE SOUTH 89°59'00" EAST 12.75 FEET; THENCE SOUTH 00°01'00" WEST 17.83 FEET; THENCE SOUTH 89°59'00" EAST 33.33 FEET; THENCE SOUTH 00°01'00" WEST 64.74 FEET TO THE POINT OF BEGINNING (EXCEPT THAT PART THEREOF LYING ABOVE A HORIZONTAL PLANE HAVING AN ELEVATION OF +49.33 CITY OF EVANSTON DATUM AND LYING WITHIN ITS HORIZONTAL BOUNDARIES PROJECTED VERTICALLY AND DESCRIBED AS FOLLOWS: COMMENCING AT THE SOUTHEAST CORNER OF SAID TRACT; THENCE NORTH 90°00'00" WEST, ALONG THE SOUTH LINE THEREOF, 241.60 FEET; THENCE NORTH 00°01'00" EAST, 52.71 FEET; THENCE SOUTH 89°46'20" WEST, 0.45 FEET TO THE POINT OF BEGINNING; THENCE SOUTH 89°46'20" WEST, 14.22 FEET; THENCE NORTH 00°13'40" WEST, 6.46 FEET; THENCE NORTH 89°46'20" EAST, 14.22 FEET; THENCE SOUTH

UNOFFICIAL COPY

00°13'40" EAST, 6.48 FEET TO THE POINT OF BEGINNING), IN COOK COUNTY, ILLINOIS.

CONTAINING 3,751 SQUARE FEET, MORE OR LESS.

OFFICE PARKING PARCEL 2D AT SECOND FLOOR LEVEL:

LOTS 1 AND 2 (EXCEPT THE WESTERLY 11 FEET THEREOF); LOT 3 (EXCEPT THE WESTERLY 11 FEET OF THE NORTHERLY 12 FEET THEREOF); LOTS 4 AND 5 AND THE NORTH 2 FEET OF LOT 6; ALL OF LOTS 16, 17, 18, 19 AND 20 AND LOT 21 (EXCEPT THAT PART OF LOT 21 WHICH LIES NORTH AND EAST OF A STRAIGHT LINE DRAWN FROM THE SOUTHEAST CORNER OF SAID LOT 21 TO A POINT ON THE NORTH LINE OF AND 50 FEET WEST OF THE NORTHEAST CORNER OF SAID LOT 21); THE VACATED NORTH-SOUTH PUBLIC ALLEY, LYING BETWEEN SAID LOTS 1 TO 6, INCLUSIVE AND LOTS 16 TO 21, INCLUSIVE; THAT PART OF THE VACATED SOUTH 8 FEET OF CLARK STREET, WHICH LIES EAST OF THE WEST LINE OF SAID LOTS 1 TO 6, INCLUSIVE EXTENDED IN A NORTHEASTERLY DIRECTION AND WEST OF THE SAID LINE DRAWN FROM THE SOUTHEAST CORNER OF SAID LOT 21 TO A POINT ON THE NORTH LINE OF AND 50 FEET WEST OF THE NORTHEAST CORNER OF SAID LOT 21 EXTENDED IN A NORTHWESTERLY DIRECTION; ALSO LOTS 'A', 'B', 'C' AND LOT 'D' (EXCEPT THE WEST 25 FEET THEREOF) IN GROVER AND CURREY'S SUBDIVISION OF LOT 6 (EXCEPT THE NORTH 2 FEET THEREOF) AND LOTS 7 AND 8; ALL OF THE AFORESAID PROPERTY BEING LOCATED IN BLOCK 2 IN PRATT'S ADDITION TO EVANSTON, A SUBDIVISION OF PART OF THE SOUTHWEST 1/4 OF THE NORTHWEST 1/4 OF SECTION 18, TOWNSHIP 41 NORTH, RANGE 14, EAST OF THE THIRD PRINCIPAL MERIDIAN, LYING EAST OF RIDGE ROAD AND WEST OF MILWAUKEE DIVISION OF CHICAGO AND NORTHWESTERN RAILWAY; ALSO, LOT 1 AND THE WEST 25 FEET OF LOT D IN GROVER AND CURREY'S SUBDIVISION OF LOT 6 (EXCEPT THE NORTH 2 FEET THEREOF) AND LOTS 7 AND 8 IN BLOCK 2 IN PRATT'S ADDITION TO EVANSTON, A SUBDIVISION OF THAT PART OF THE SOUTHWEST 1/4 OF THE NORTHWEST 1/4 OF SECTION 18, TOWNSHIP 41 NORTH, RANGE 14, EAST OF THE THIRD PRINCIPAL MERIDIAN, LYING EAST OF RIDGE ROAD AND WEST OF MILWAUKEE DIVISION OF CHICAGO AND NORTHWESTERN RAILWAY, TAKEN AS A TRACT LYING BELOW A HORIZONTAL PLANE HAVING AN ELEVATION OF +41.00 CITY OF EVANSTON DATUM AND LYING ABOVE A HORIZONTAL PLANE HAVING AN ELEVATION OF +33.58 CITY OF EVANSTON DATUM AND LYING WITHIN ITS HORIZONTAL BOUNDARIES PROJECTED VERTICALLY AND DESCRIBED AS FOLLOWS: COMMENCING AT THE SOUTHEAST CORNER OF SAID TRACT; THENCE NORTH 90°00'00" WEST, ALONG THE SOUTH LINE THEREOF, 298.02 FEET; THENCE NORTH 00°01'00" EAST 82.59 FEET TO THE POINT OF BEGINNING; THENCE NORTH 00°01'00" EAST 44.00 FEET; THENCE SOUTH 89°59'00" EAST 122.42 FEET; THENCE SOUTH 00°01'00" WEST 44.00 FEET; THENCE NORTH 89°59'00" WEST 122.42 FEET TO THE POINT OF BEGINNING, IN COOK COUNTY, ILLINOIS.

CONTAINING 5,386 SQUARE FEET, MORE OR LESS.

UNOFFICIAL COPY

OFFICE PARKING PARCEL 2E AT SECOND FLOOR LEVEL:

LOTS 1 AND 2 (EXCEPT THE WESTERLY 11 FEET THEREOF); LOT 3 (EXCEPT THE WESTERLY 11 FEET OF THE NORTHERLY 12 FEET THEREOF); LOTS 4 AND 5 AND THE NORTH 2 FEET OF LOT 6; ALL OF LOTS 16, 17, 18, 19 AND 20 AND LOT 21 (EXCEPT THAT PART OF LOT 21 WHICH LIES NORTH AND EAST OF A STRAIGHT LINE DRAWN FROM THE SOUTHEAST CORNER OF SAID LOT 21 TO A POINT ON THE NORTH LINE OF AND 50 FEET WEST OF THE NORTHEAST CORNER OF SAID LOT 21); THE VACATED NORTH-SOUTH PUBLIC ALLEY, LYING BETWEEN SAID LOTS 1 TO 6, INCLUSIVE AND LOTS 16 TO 21, INCLUSIVE; THAT PART OF THE VACATED SOUTH 8 FEET OF CLARK STREET, WHICH LIES EAST OF THE WEST LINE OF SAID LOTS 1 TO 6, INCLUSIVE EXTENDED IN A NORTHEASTERLY DIRECTION AND WEST OF THE SAID LINE DRAWN FROM THE SOUTHEAST CORNER OF SAID LOT 21 TO A POINT ON THE NORTH LINE OF AND 50 FEET WEST OF THE NORTHEAST CORNER OF SAID LOT 21 EXTENDED IN A NORTHWESTERLY DIRECTION; ALSO LOTS 'A', 'B', 'C' AND LOT 'D' (EXCEPT THE WEST 25 FEET THEREOF) IN GROVER AND CURREY'S SUBDIVISION OF LOT 6 (EXCEPT THE NORTH 2 FEET THEREOF) AND LOTS 7 AND 8; ALL OF THE AFORESAID PROPERTY BEING LOCATED IN BLOCK 2 IN PRATT'S ADDITION TO EVANSTON, A SUBDIVISION OF PART OF THE SOUTHWEST 1/4 OF THE NORTHWEST 1/4 OF SECTION 18, TOWNSHIP 41 NORTH, RANGE 14, EAST OF THE THIRD PRINCIPAL MERIDIAN, LYING EAST OF RIDGE ROAD AND WEST OF MILWAUKEE DIVISION OF CHICAGO AND NORTHWESTERN RAILWAY; ALSO, LOT 1 AND THE WEST 25 FEET OF LOT 'D' IN GROVER AND CURREY'S SUBDIVISION OF LOT 6 (EXCEPT THE NORTH 2 FEET THEREOF) AND LOTS 7 AND 8 IN BLOCK 2 IN PRATT'S ADDITION TO EVANSTON, A SUBDIVISION OF THAT PART OF THE SOUTHWEST 1/4 OF THE NORTHWEST 1/4 OF SECTION 18, TOWNSHIP 41 NORTH, RANGE 14, EAST OF THE THIRD PRINCIPAL MERIDIAN, LYING EAST OF RIDGE ROAD AND WEST OF MILWAUKEE DIVISION OF CHICAGO AND NORTHWESTERN RAILWAY, TAKEN AS A TRACT LYING BELOW A HORIZONTAL PLANE HAVING AN ELEVATION OF +44.50 CITY OF EVANSTON DATUM AND LYING ABOVE A HORIZONTAL PLANE HAVING AN ELEVATION OF +35.58 CITY OF EVANSTON DATUM AND LYING WITHIN ITS HORIZONTAL BOUNDARIES PROJECTED VERTICALLY AND DESCRIBED AS FOLLOWS: COMMENCING AT THE SOUTHEAST CORNER OF SAID TRACT; THENCE NORTH 90°00'00" WEST, ALONG THE SOUTH LINE THEREOF, 175.10 FEET; THENCE NORTH 00°01'00" EAST 82.55 FEET; THENCE SOUTH 89°59'00" EAST 1.50 FEET TO THE POINT OF BEGINNING; THENCE NORTH 00°01'00" EAST 44.00 FEET; THENCE SOUTH 89°59'00" EAST 76.50 FEET; THENCE SOUTH 00°01'00" WEST 44.00 FEET; THENCE NORTH 89°59'00" WEST 76.50 FEET TO THE POINT OF BEGINNING, IN COOK COUNTY, ILLINOIS.

CONTAINING 3,368 SQUARE FEET, MORE OR LESS.

UNOFFICIAL COPY**OFFICE PARKING PARCEL 2F AT SECOND FLOOR LEVEL:**

LOTS 1 AND 2 (EXCEPT THE WESTERLY 11 FEET THEREOF); LOT 3 (EXCEPT THE WESTERLY 11 FEET OF THE NORTHERLY 12 FEET THEREOF); LOTS 4 AND 5 AND THE NORTH 2 FEET OF LOT 6; ALL OF LOTS 16, 17, 18, 19 AND 20 AND LOT 21 (EXCEPT THAT PART OF LOT 21 WHICH LIES NORTH AND EAST OF A STRAIGHT LINE DRAWN FROM THE SOUTHEAST CORNER OF SAID LOT 21 TO A POINT ON THE NORTH LINE OF AND 50 FEET WEST OF THE NORTHEAST CORNER OF SAID LOT 21); THE VACATED NORTH-SOUTH PUBLIC ALLEY, LYING BETWEEN SAID LOTS 1 TO 6, INCLUSIVE AND LOTS 16 TO 21, INCLUSIVE; THAT PART OF THE VACATED SOUTH 8 FEET OF CLARK STREET, WHICH LIES EAST OF THE WEST LINE OF SAID LOTS 1 TO 6, INCLUSIVE EXTENDED IN A NORTHEASTERLY DIRECTION AND WEST OF THE SAID LINE DRAWN FROM THE SOUTHEAST CORNER OF SAID LOT 21 TO A POINT ON THE NORTH LINE OF AND 50 FEET WEST OF THE NORTHEAST CORNER OF SAID LOT 21 EXTENDED IN A NORTHWESTERLY DIRECTION; ALSO LOTS 'A', 'B', 'C' AND LOT 'D' (EXCEPT THE WEST 25 FEET THEREOF) IN GROVER AND CURREY'S SUBDIVISION OF LOT 6 (EXCEPT THE NORTH 2 FEET THEREOF) AND LOTS 7 AND 8; ALL OF THE AFORESAID PROPERTY BEING LOCATED IN BLOCK 2 IN PRATT'S ADDITION TO EVANSTON, A SUBDIVISION OF PART OF THE SOUTHWEST 1/4 OF THE NORTHWEST 1/4 OF SECTION 18, TOWNSHIP 41 NORTH, RANGE 14, EAST OF THE THIRD PRINCIPAL MERIDIAN, LYING EAST OF RIDGE ROAD AND WEST OF MILWAUKEE DIVISION OF CHICAGO AND NORTHWESTERN RAILWAY; ALSO, LOT 1 AND THE WEST 25 FEET OF LOT 'D' IN GROVER AND CURREY'S SUBDIVISION OF LOT 6 (EXCEPT THE NORTH 2 FEET THEREOF) AND LOTS 7 AND 8 IN BLOCK 2 IN PRATT'S ADDITION TO EVANSTON, A SUBDIVISION OF THAT PART OF THE SOUTHWEST 1/4 OF THE NORTHWEST 1/4 OF SECTION 18, TOWNSHIP 41 NORTH, RANGE 14, EAST OF THE THIRD PRINCIPAL MERIDIAN, LYING EAST OF RIDGE ROAD AND WEST OF MILWAUKEE DIVISION OF CHICAGO AND NORTHWESTERN RAILWAY, TAKEN AS A TRACT LYING BELOW A HORIZONTAL PLANE HAVING AN ELEVATION OF +43.55 CITY OF EVANSTON DATUM AND LYING ABOVE A HORIZONTAL PLANE HAVING AN ELEVATION OF +35.58 CITY OF EVANSTON DATUM AND LYING WITHIN ITS HORIZONTAL BOUNDARIES PROJECTED VERTICALLY AND DESCRIBED AS FOLLOWS: COMMENCING AT THE SOUTHEAST CORNER OF SAID TRACT; THENCE NORTH 90°00'00" WEST, ALONG THE SOUTH LINE THEREOF, 296.02 FEET; THENCE NORTH 00°01'00" EAST 64.75 FEET; THENCE SOUTH 89°59'00" EAST 8.34 FEET; THENCE NORTH 00°01'00" EAST 17.83 FEET; THENCE SOUTH 89°59'00" EAST 12.75 FEET TO THE POINT OF BEGINNING; THENCE SOUTH 00°01'00" WEST 17.83 FEET; THENCE SOUTH 89°59'00" EAST 32.65 FEET; THENCE NORTH 00°26'00" EAST 17.83 FEET; THENCE NORTH 89°59'00" WEST 32.78 FEET TO THE POINT OF BEGINNING (EXCEPT THAT PART THEREOF LYING ABOVE A HORIZONTAL PLANE HAVING AN ELEVATION OF +42.54 CITY OF EVANSTON DATUM AND LYING WITHIN ITS HORIZONTAL BOUNDARIES PROJECTED VERTICALLY AND DESCRIBED AS FOLLOWS: COMMENCING AT THE SOUTHEAST CORNER OF SAID TRACT; THENCE NORTH 90°00'00" WEST, ALONG THE SOUTH LINE THEREOF, 296.02 FEET; THENCE NORTH 00°01'00" EAST 64.75 FEET; THENCE SOUTH 89°59'00" EAST 8.34 FEET; THENCE NORTH 00°01'00" EAST 17.83 FEET; THENCE SOUTH 89°59'00" EAST 12.75 FEET; THENCE SOUTH 89°59'00" EAST 7.95 FEET TO THE POINT OF BEGINNING; THENCE SOUTH 00°03'03" WEST 6.66 FEET; THENCE SOUTH 89°59'00" EAST 7.05 FEET; THENCE NORTH 00°03'03" EAST 6.66 FEET; THENCE

UNOFFICIAL COPY

NORTH 89°59'00" WEST 7.05 FEET TO THE POINT OF BEGINNING), IN COOK COUNTY, ILLINOIS.

CONTAINING 583 SQUARE FEET, MORE OR LESS.

