

UNOFFICIAL COPY



Doc#: 0619545000 Fee: \$21.50
Eugene "Gene" Moore RHSP Fee:\$10.00
Cook County Recorder of Deeds
Date: 07/14/2008 08:22 AM Pg: 1 of 7

SUBCONTRACTOR'S NOTICE AND CLAIM FOR LIEN ON LEASEHOLD IMPROVEMENT

STATE of ILLINOIS) ss:
COUNTY of COOK)

Claimant, **Terrazzo & Marble Supply Co.**, 77 S. Wheeling Road, Wheeling, IL 60190 of **Cook County, State of Illinois**, hereby files a notice and claim for lien against **Illinois State Toll Highway Authority**, 2700 Ogden Ave., Downers Grove, IL 60515, Owner, **Wilton Partners Tollway LLC**, 11111 Santa Monica Blvd., Suite 500, Los Angeles, CA 90025, Owner's Agent, **R D Roman Company**, 2421 N. Court St., Rockford, IL 61103, Subcontractor, **James McHugh Construction**, 1737 S. Michigan Ave., Chicago, IL 60616, Contractor, and states:

That on **October 26, 2005**, the owner(s) owned the following described land in the County of **Cook**, State of Illinois to wit:

See attached legal description, all in the County of Cook, State of Illinois.

Address of premises: **Lincoln Oasis, Tri-State Tollway 294, South Holland, IL.**

That on **October 26, 2005**, said contractor made a subcontract with claimant to furnish **terroxy tile, related materials and/or labor** for said improvement, and that on **October 26, 2005**, claimant completed delivery of materials and/or labor to the value of **\$8,872.20**.

That said contractor is entitled to credits on account as follows: **\$0.**

leaving a balance due, unpaid and owing to claimant and, after allowing all credits, the sum of **\$8,872.20** for which, with interest, claimant claims a lien on said land and improvement and on the monies or other considerations due or to become due from the owner under said contract against said contractor and owner(s).

Terrazzo & Marble Supply Co.

BY:

ALLAN R. POPPER, Lianguard, Inc., as Agent
for Terrazzo & Marble Supply Co.

File No.: 75694-6-1

SC
M/H
7/19
A/H

UNOFFICIAL COPY

STATE of ILLINOIS) ss.
COUNTY of DuPAGE)

Affiant, Allan R. Popper, being first duly sworn, on oath deposes and says that he is the agent of claimant, and that he has read the foregoing notice and claim for lien and knows the contents thereof; and that all statements therein contained are true.

Allan R. Popper, Lienguard, Inc., as Agent
for Terrazzo & Marble Supply Co.

SUBSCRIBED AND SWORN to before me
on July 12, 2006.

Liza Kulikowski, Notary Public

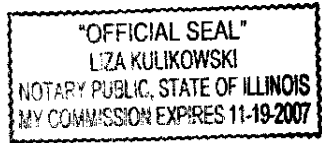

File No: 75694-6-1

Prepared by: Allan R. Popper
Lienguard, Inc.
1000 Jorie Blvd., Ste. 270
Oak Brook IL 60523

Mail to: **Lienguard, Inc.**
1000 Jorie Blvd., Ste. 270
Oak Brook, IL 60523

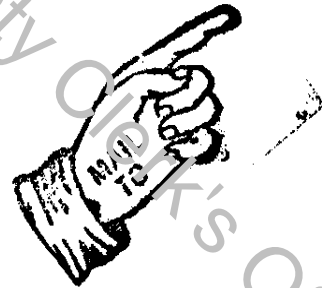

Property of Cook County Clerk's Office

UNOFFICIAL COPY

EXHIBIT A-1

LINCOLN OASIS SITE PLAN

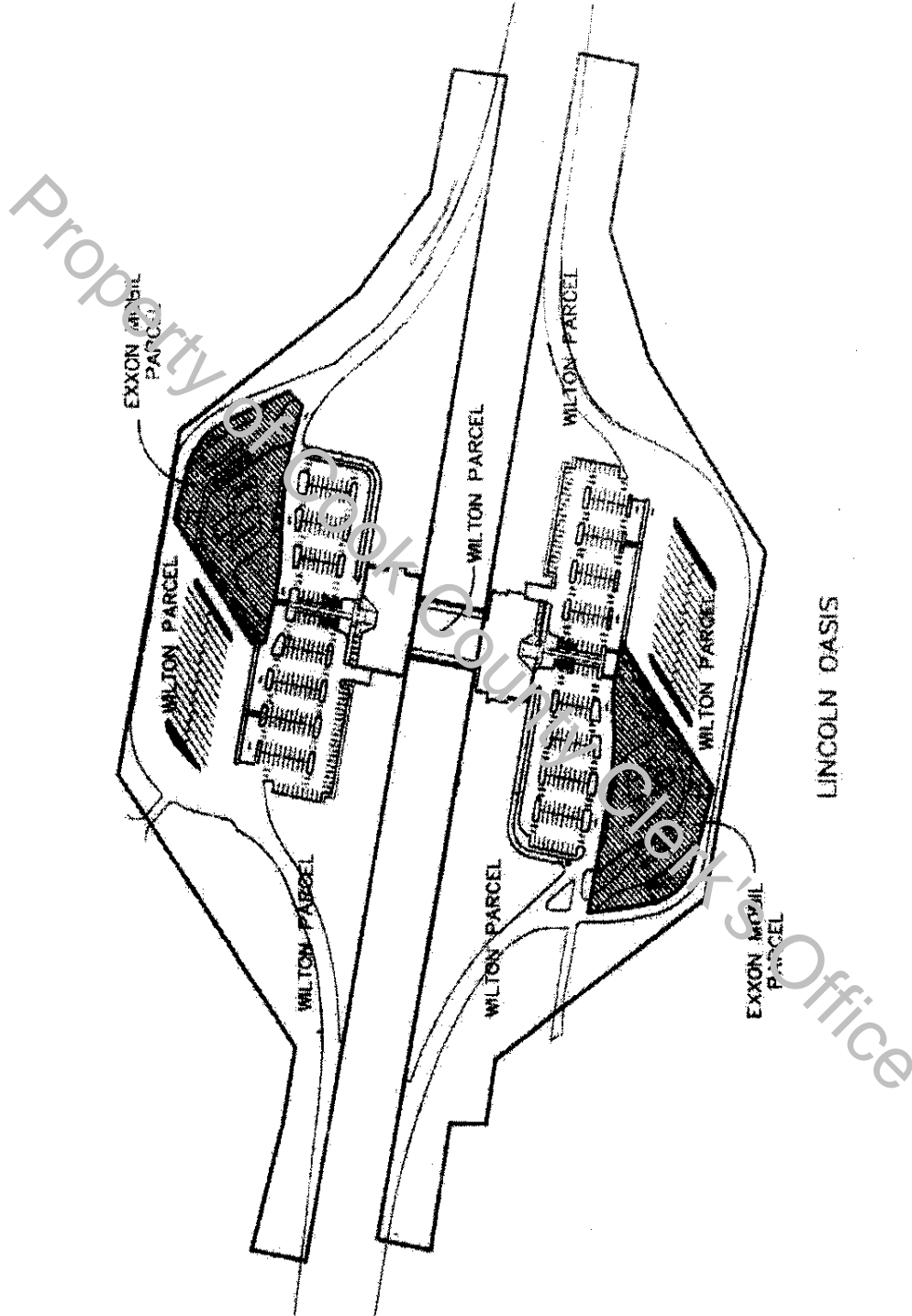

UNOFFICIAL COPY

EXHIBIT B-1

LINCOLN OASIS LEGAL DESCRIPTION

LINCOLN OASIS NET AREA (LESS EXXON/MOBIL LEASE AREAS)

PARCEL 1 (NET AREA SOUTH OF TOLLWAY):

THAT PART OF SECTION 27, AND PART OF THE WEST HALF OF SECTION 26, TOWNSHIP 36 NORTH, RANGE 14 EAST OF THE THIRD PRINCIPAL MERIDIAN, DESCRIBED AS FOLLOWS: COMMENCING AT THE NORTHEAST CORNER OF THE SOUTHEAST QUARTER OF SAID SECTION 27; THENCE SOUTH 89° 45' 16" WEST, 1325.52 FEET ALONG THE NORTH LINE OF SAID SOUTHEAST QUARTER TO THE WEST LINE OF THE EAST HALF OF THE SOUTHEAST QUARTER OF SAID SECTION 27; THENCE SOUTH 00° 50' 08" EAST, 208.69 FEET ALONG SAID WEST LINE AND ALSO BEING THE WEST LINE EXTENDED OF 3RD UNIT TOEPFERS THORNWOOD SUBDIVISION PER DOC. NO. 18145545 FOR THE POINT OF BEGINNING; THENCE SOUTH 81° 47' 07" EAST, 109.04 FEET TO AN ANGLE POINT ON THE NORTHEASTERLY LINE OF SAID 3RD UNIT; THENCE SOUTH 35° 43' 54" EAST, 473.10 FEET ALONG SAID NORTHEASTERLY LINE EXTENDED SOUTHEASTERLY; THENCE SOUTH 79° 53' 47" EAST, 595.00 FEET; THENCE NORTH 56° 05' 06" EAST, 388.97 FEET; THENCE NORTH 71° 13' 57" EAST, 228.25 FEET; THENCE SOUTH 79° 57' 24" EAST, 282.53 FEET; THENCE NORTH 10° 01' 16" EAST, 109.77 FEET TO A POINT ON THE SOUTHERLY RIGHT OF WAY LINE OF THE TRI-STATE TOLLWAY (INTERSTATE 294); THENCE NORTH 79° 58' 44" WEST, 2034.00 FEET ALONG SAID SOUTHERLY RIGHT OF WAY LINE PERPENDICULAR TO THE LAST DESCRIBED COURSE; THENCE SOUTH 10° 01' 16" WEST, 100.39 FEET PERPENDICULAR TO THE LAST DESCRIBED COURSE; THENCE SOUTH 81° 22' 17" EAST, 215.70 FEET TO THE WEST LINE OF THE EAST HALF OF THE SOUTHEAST QUARTER OF SAID SECTION 27 AND ALSO BEING THE WEST LINE EXTENDED NORTH OF 3RD UNIT TOEPFERS THORNWOOD SUBDIVISION PER DOC. NO. 18145545; THENCE SOUTH 00° 50' 08" EAST, 68.01 FEET ALONG SAID WEST LINE TO THE POINT OF BEGINNING, IN COOK COUNTY, ILLINOIS

EXCEPTING THEREFROM

THAT PART OF SOUTHEAST QUARTER OF SECTION 27, TOWNSHIP 36 NORTH, RANGE 14 EAST OF THE THIRD PRINCIPAL MERIDIAN, DESCRIBED AS FOLLOWS: COMMENCING AT THE NORTHEAST CORNER OF THE SOUTHEAST QUARTER OF SAID SECTION 27; THENCE SOUTH 89° 45' 16" WEST, 1325.52 FEET ALONG THE NORTH LINE OF SAID SOUTHEAST QUARTER TO THE WEST LINE OF THE EAST HALF OF THE SOUTHEAST QUARTER OF SAID SECTION 27; THENCE SOUTH 00° 50' 08" EAST, 208.69 FEET ALONG SAID WEST LINE AND ALSO BEING THE WEST LINE EXTENDED OF 3RD UNIT TOEPFERS THORNWOOD SUBDIVISION PER DOC. NO.

UNOFFICIAL COPY

18145545; THENCE SOUTH 81°47' 07" EAST, 109.04 FEET TO AN ANGLE POINT ON THE NORTHEASTERLY LINE OF SAID 3RD UNIT; THENCE SOUTH 35° 43' 54" EAST, 282.27 FEET ALONG SAID NORTHEASTERLY LINE EXTENDED SOUTHEASTERLY; THENCE NORTH 54° 16' 06" EAST, 104.10 FEET FOR THE PLACE OF BEGINNING; THENCE SOUTH 79° 50' 37" EAST, 208.88 FEET TO A POINT OF CURVATURE; THENCE EASTERLY ALONG AN ARC OF A CURVE CONCAVE TO THE EAST, HAVING A RADIUS OF 526.00 FEET, HAVING A CHORD BEARING OF SOUTH 87° 23' 49" EAST, 138.69 FEET TO A POINT OF REVERSE CURVATURE; THENCE EASTERLY ALONG AN ARC OF A CURVE CONCAVE TO THE SOUTH, HAVING A RADIUS OF 200.00 FEET, HAVING A CHORD BEARING OF SOUTH 87° 23' 49" EAST, 52.73 FEET TO A POINT OF TANGENCY; THENCE SOUTH 79° 50' 37" EAST, 63.32 FEET; THENCE SOUTH 55° 14' 16" WEST, 298.79 FEET; THENCE NORTH 79° 06' 12" WEST, 20.00 FEET; THENCE NORTH 74° 03' 14" WEST, 109.44 FEET TO A POINT OF CURVATURE; THENCE NORTHERLY ALONG AN ARC OF A CURVE CONCAVE TO THE NORTHEAST, HAVING A RADIUS OF 100.00 FEET, HAVING A CHORD BEARING OF NORTH 41° 18' 47" WEST, 114.29 FEET TO A POINT OF TANGENCY; THENCE NORTH 08° 34' 21" WEST, 113.20 FEET TO THE PLACE OF BEGINNING, IN COOK COUNTY, ILLINOIS

CONTAINING 545,087 SQUARE FEET (12.513 ACRES), MORE OR LESS.

PARCEL 2 (NET AREA NORTH OF THE TOLLWAY):

THAT PART OF SECTION 27, AND PART OF THE WEST HALF OF SECTION 26, TOWNSHIP 36 NORTH, RANGE 14 EAST OF THE THIRD PRINCIPAL MERIDIAN DESCRIBED AS FOLLOWS: COMMENCING AT THE NORTHEAST CORNER OF THE SOUTHEAST QUARTER OF SAID SECTION 27; THENCE SOUTH 89° 45' 16" WEST, 1325.52 FEET ALONG THE NORTH LINE OF SAID SOUTHEAST QUARTER TO THE WEST LINE OF THE EAST HALF OF THE SOUTHEAST QUARTER OF SAID SECTION 27; THENCE NORTH 00°50' 08" WEST, 169.49 FEET ALONG SAID WEST LINE FOR THE POINT OF BEGINNING; THENCE NORTH 75° 56' 09" WEST, 220.25 FEET; THENCE SOUTH 10° 01' 16" WEST, 100.00 FEET PERPENDICULAR TO THE LAST DESCRIBED COURSE TO THE NORTHERLY RIGHT OF WAY LINE OF THE TRI-STATE TOLLWAY (INTERSTATE 294); THENCE SOUTH 79° 48' 44" EAST, 2034.00 FEET PERPENDICULAR TO THE LAST DESCRIBED COURSE; THENCE NORTH 06° 23' 36" EAST, 100.00 FEET; THENCE NORTH 78° 34' 44" WEST, 212.92 FEET; THENCE NORTH 52° 11' 53" WEST 214.71 FEET; THENCE NORTH 35° 57' 42" WEST, 132.60 FEET TO A POINT ON THE EAST LINE OF THE NORTHEAST QUARTER OF SAID SECTION 27, BEING 145.38 FEET NORTH OF THE SOUTHEAST CORNER OF SAID NORTHEAST QUARTER; THENCE CONTINUING NORTH 35° 57' 42" WEST, 270.51 FEET TO A POINT ON A SOUTHERLY RIGHT OF WAY LINE OF 173RD PLACE PER DOC. NO. 20833974; THENCE NORTH 79° 57' 24" WEST, 595.00 FEET TO AN ANGLE POINT ON SAID SOUTHERLY RIGHT OF WAY LINE; THENCE SOUTH 54° 19' 05" WEST, 558.66 FEET TO AN ANGLE POINT ON SAID SOUTHERLY RIGHT OF WAY LINE; THENCE NORTHWESTERLY ALONG A CURVE TO THE LEFT HAVING A RADIUS OF 5729.58 FEET, AN ARC LENGTH OF 130.12 FEET (CHD BRG. NORTH 80° 27' 36" WEST,

UNOFFICIAL COPY

CHD LENGTH 130.11 FEET) TO A POINT ON THE WEST LINE OF THE EAST HALF OF THE NORTHEAST QUARTER OF SAID SECTION 27, BEING 169.49 FEET NORTH OF THE SOUTHWEST CORNER OF THE EAST HALF OF THE NORTHEAST QUARTER OF SAID SECTION 27, TO THE POINT OF BEGINNING, IN COOK COUNTY, ILLINOIS

EXCEPTING THEREFROM

THAT PART OF THE NORTHEAST QUARTER OF SECTION 27, TOWNSHIP 36 NORTH, RANGE 14 EAST OF THE THIRD PRINCIPAL MERIDIAN DESCRIBED AS FOLLOWS: COMMENCING AT THE NORTHEAST CORNER OF THE SOUTHEAST QUARTER OF SAID SECTION 27; THENCE SOUTH 89° 45' 16" WEST, 1325.52 FEET ALONG THE NORTH LINE OF SAID SOUTHEAST QUARTER TO THE WEST LINE OF THE EAST HALF OF THE SOUTHEAST QUARTER OF SAID SECTION 27; THENCE NORTH 00° 50' 08" WEST, 169.49 FEET ALONG SAID WEST LINE; THENCE NORTH 75° 56' 09" WEST, 220.25 FEET; THENCE SOUTH 10° 01' 16" WEST, 100.00 FEET PERPENDICULAR TO THE LAST DESCRIBED COURSE TO THE NORTHERLY RIGHT OF WAY LINE OF THE TRI-STATE TOLLWAY (INTERSTATE 294); THENCE SOUTH 79° 48' 44" EAST, 2034.00 FEET PERPENDICULAR TO THE LAST DESCRIBED COURSE; THENCE NORTH 06° 23' 36" EAST, 100.00 FEET; THENCE NORTH 78° 34' 44" WEST, 212.92 FEET; THENCE NORTH 52° 11' 53" WEST 214.71 FEET; THENCE NORTH 35° 57' 42" WEST, 132.60 FEET TO A POINT ON THE EAST LINE OF THE NORTHEAST QUARTER OF SAID SECTION 27, BEING 145.38 FEET NORTH OF THE SOUTHEAST CORNER OF SAID NORTHEAST QUARTER; THENCE CONTINUING NORTH 35° 57' 42" WEST, 69.97 FEET; THENCE SOUTH 54° 02' 18" WEST, 60.48 FEET TO THE POINT OF BEGINNING; THENCE SOUTH 41° 13' 37" WEST, 35.54 FEET TO A NONTANGENT CURVE; THENCE WESTERLY ALONG THE ARC OF A CURVE CONCAVE TO THE NORTH, HAVING A RADIUS OF 5321.80 FEET, HAVING A CHORD BEARING OF NORTH 73° 36' 07" WEST, 67.27 FEET TO A POINT OF REVERSE CURVATURE; THENCE WESTERLY ALONG AN ARC OF A CURVE CONCAVE TO THE SOUTH, HAVING A RADIUS OF 290.02 FEET, HAVING A CHORD BEARING OF NORTH 78° 48' 21" WEST, 56.35 FEET TO A POINT OF TANGENCY; THENCE NORTH 84° 22' 19" WEST, 47.35 FEET TO A POINT OF CURVATURE; THENCE WESTERLY ALONG AN ARC OF A CURVE CONCAVE TO THE SOUTH, HAVING A RADIUS OF 580.00 FEET, HAVING A CHORD BEARING OF NORTH 87° 33' 44" WEST, 64.59 FEET TO A POINT OF REVERSE CURVATURE; THENCE WESTERLY ALONG AN ARC OF A CURVE CONCAVE TO THE NORTH, HAVING A RADIUS OF 397.89 FEET, HAVING A CHORD BEARING OF NORTH 83° 51' 38" WEST, 95.72 FEET TO A POINT OF TANGENCY; THENCE NORTH 76° 58' 06" WEST, 77.22 FEET; THENCE NORTH 00° 00' 00" EAST, 24.06 FEET; THENCE NORTH 55° 18' 30" EAST, 250.17 FEET; THENCE SOUTH 80° 03' 39" EAST, 20.00 FEET; THENCE SOUTH 75° 39' 27" EAST, 65.08 FEET TO A POINT OF CURVATURE; THENCE SOUTHEASTERLY ALONG AN ARC OF A CURVE CONCAVE TO THE SOUTHWEST, HAVING A RADIUS OF 125.00 FEET, HAVING A CHORD BEARING OF SOUTH 50° 16' 15" EAST, 110.77 FEET TO A POINT OF TANGENCY; THENCE SOUTH 24° 53' 03" EAST, 128.49 FEET TO THE POINT OF BEGINNING, IN COOK COUNTY, ILLINOIS.

UNOFFICIAL COPY

CONTAINING 525,941 SQUARE FEET (12.074 ACRES), MORE OR LESS.

PARCEL 3 (NEW OVERHEAD RESTAURANT PARCEL):

THAT PART OF THE EAST HALF OF THE SOUTHEAST QUARTER OF SECTION 27, TOWNSHIP 36 NORTH, RANGE 14 EAST OF THE THIRD PRINCIPAL MERIDIAN DESCRIBED AS FOLLOWS: COMMENCING AT THE NORTHEAST CORNER OF THE SOUTHEAST QUARTER OF SAID SECTION 27; THENCE SOUTH 89°45' 16" WEST, 1325.52 FEET ALONG THE NORTH LINE OF SAID SOUTHEAST QUARTER TO THE WEST LINE OF THE EAST HALF OF THE SOUTHEAST QUARTER OF SAID SECTION 27; THENCE SOUTH 00° 50' 08" EAST, 43.79 FEET ALONG SAID WEST LINE TO A POINT ON THE SOUTHERLY RIGHT OF WAY LINE OF THE TRI-STATE TOLLWAY (INTERSTATE 294); THENCE SOUTH 79° 58' 44" EAST, 792.78 FEET ALONG SAID RIGHT OF WAY LINE FOR THE POINT OF BEGINNING; THENCE CONTINUING SOUTH 79° 58' 44" EAST, 103.00 FEET ALONG SAID SOUTHERLY RIGHT OF WAY LINE; THENCE NORTH 10° 05' 11" EAST, 125.00 FEET TO THE NORTHERLY RIGHT OF WAY LINE OF THE TRI-STATE TOLLWAY (INTERSTATE 294); THENCE NORTH 79° 58' 44" WEST, 103.00 FEET ALONG SAID NORTHERLY RIGHT OF WAY LINE; THENCE SOUTH 10° 05' 11" WEST, 125.00 FEET TO A POINT ON SAID SOUTHERLY RIGHT OF WAY LINE TO THE POINT OF BEGINNING, AND LYING BETWEEN THE PLANE OF THE BOTTOM OF ITS UNDERLYING SUPPORT BEAMS UPWARD TO AND THROUGH THE UPPER ELEVATION OF THE BUILDING IMPROVEMENTS AND TO AND THROUGH THE SKY; WITH THE BOTTOM OF THE UNDERLYING SUPPORT BEAMS BEING AT AN ELEVATION OF 624.13, MORE OR LESS, IN COOK COUNTY, ILLINOIS

CONTAINING 12,874 SQUARE FEET (0.296 ACRES), MORE OR LESS.

TOTAL NET AREA CONTAINING 1,083,902 SQUARE FEET (24.883 ACRES), MORE OR LESS.