

UNOFFICIAL COPY



Chicago Title Insurance Company

WARRANTY DEED ILLINOIS STATUTORY

Doc#: 0620818104
Eugene "Gene" Moore Fee: \$28.50
Cook County Recorder of Deeds
Date: 07/27/2005 10:55 AM Pg: 1 of 3



Doc#: 0625845001 Fee: \$32.00
Eugene "Gene" Moore
Cook County Recorder of Deeds
Date: 09/15/2006 08:26 AM Pg: 1 of 5

0625845001

THE GRANTOR(S), Gregory A. Edwards and Karen B. Edwards, husband and wife, of the City of Chicago, County of Cook, State of Illinois for and in consideration of TEN & 00/100 DOLLARS, and other good and valuable consideration in hand paid, CONVEY(S) and Warrant(s) to Teresa Pointer (GRANTEE'S ADDRESS) 1355 South Plymouth Court, Chicago, Illinois 60605 of the County of Cook, all interest in the following described Real Estate situated in the County of Cook in the State of Illinois, to wit:

See Exhibit 'A' attached hereto and made a part hereof

RE-RECORD TO CORRECT LEGAL DESCRIPTION

SUBJECT TO: general taxes for the year 2005 and subsequent years including taxes which may accrue by reason of new or additional improvements during the year(s)

hereby releasing and waiving all rights under and by virtue of the Homestead Exemption Laws of the State of Illinois.

Permanent Real Estate Index Number(s): 20-02-107-026-0000

Address(es) of Real Estate: 4044 South Lake Park, Chicago, Illinois 60653

Dated this 15th day of July, 2005.

Gregory A. Edwards

Karen B. Edwards

City of Chicago
Dept. of Revenue
390054
07/26/2005 09:51 Batch 11860 29



Real Estate
Transfer Stamp
\$6,000.00

ALLIANCE TITLE CO.

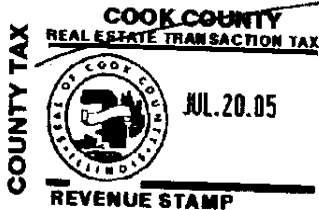

REAL ESTATE TRANSFER TAX
0040000
FP326670

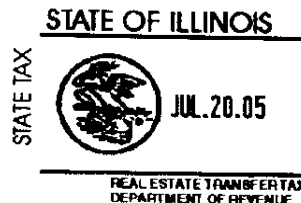

REAL ESTATE TRANSFER TAX
0080000
FP326669

UNOFFICIAL COPY

STATE OF ILLINOIS, COUNTY OF COOK: ss.

I, the undersigned, a Notary Public in and for said County, in the State aforesaid, CERTIFY THAT Gregory A. Edwards and Karen B. Edwards, husband and wife, personally known to me to be the same person(s) whose name(s) are subscribed to the foregoing instrument, appeared before me this day in person, and acknowledged that they signed, sealed and delivered the said instrument as their free and voluntary act, for the uses and purposes therein set forth, including the release and waiver of the right of homestead.

Given under my hand and official seal, this 15th day of July, 2005.

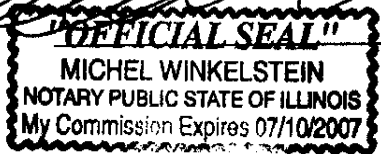

(Notary Public)

Prepared By: Herbert H. Fisher Law Office, P.C.
200 N. Dearborn Street, Suite 1006
Chicago, Illinois 60601-1617

Mail To:
Teresa Pointer
1355 South Plymouth Court
Chicago, Illinois 60605



Name & Address of Taxpayer:
Teresa Pointer
1355 South Plymouth Court
Chicago, Illinois 60605

Property of Cook County Clerk's Office

UNOFFICIAL COPY

EXHIBIT 'A' Legal Description

That part of Lot 8 in Block 13 in Cleaverville in Section 2, Township 38 North, Range 14, East of the Third Principal Meridian, as described as follows:

Commencing at the Southeast Corner of said Lot thence running northerly along the West line of Lake Park Ave. (formerly Lake Ave.) 38 feet thence Westerly parallel with the South line of said Lot 180 feet to the West line of said Lot thence Southerly in the in the West line of said Lot 48 feet to the Southwest Corner of said lot thence Southerly on the West Line of said Lot 48 to the Southwest Corner of said lot then Easterly along the South line of said Lot 180 feet to the place of beginning, in Cook County, Illinois.

Property of Cook County Clerk's Office

UNOFFICIAL COPY

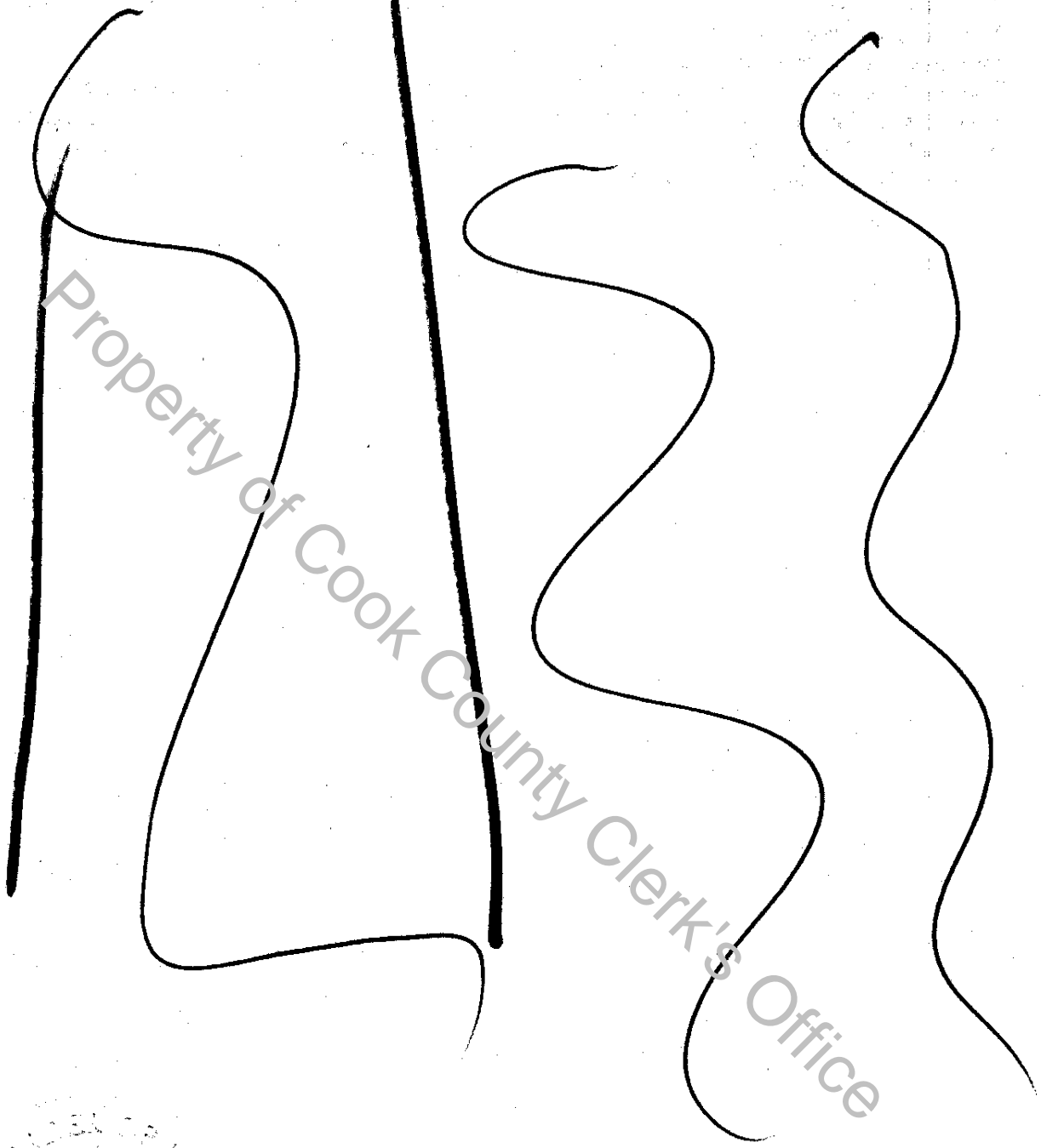

Property of Cook County Clerk's Office

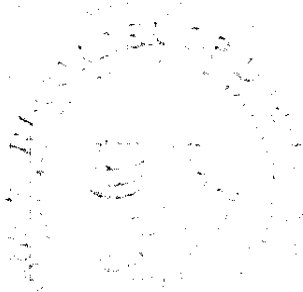

I CERTIFY THAT THIS
IS A TRUE AND CORRECT COPY

OF DOCUMENT #

0520818104

SEP 15 06

A handwritten signature in black ink, appearing to read "George Kent".

RECORDER OF DEEDS, COOK COUNTY

UNOFFICIAL COPY

Ticor Title Insurance

Commitment Number: A05-0724

SCHEDULE C PROPERTY DESCRIPTION

The land referred to in this Commitment is described as follows:

THAT PART OF LOT 8 IN BLOCK 13 IN CLEAVERVILLE IN SECTION 2, TOWNSHIP 38 NORTH, RANGE 14, EAST OF THE THIRD PRINCIPAL MERIDIAN, DESCRIBED AS FOLLOWS:
COMMENCING AT THE SOUTHEAST CORNER OF SAID LOT THENCE RUNNING NORTHERLY ALONG THE WEST LINE OF LAKE PARK AVE. (FORMERLY LAKE AVE.) 48 FEET THENCE WESTERLY PARALLEL WITH THE SOUTH LINE OF SAID LOT 180 FEET TO THE WEST LINE OF SAID LOT THENCE SOUTHERLY IN THE WEST LINE OF SAID LOT 48 FEET TO THE SOUTHWEST CORNER OF SAID LOT THENCE SOUTHERLY ON THE WEST LINE OF SAID LOT 48 FEET TO THE SOUTHWEST CORNER OF SAID LOT THENCE EASTERLY ALONG THE SOUTH LINE OF SAID LOT 180 FEET TO THE PLACE OF BEGINNING, IN COOK COUNTY, ILLINOIS.

p.i.n. #: 20-02-107-026-0000