

UNOFFICIAL COPY



Doc#: 0701017128 Fee: \$28.50
Eugene "Gene" Moore RHSP Fee:\$10.00
Cook County Recorder of Deeds
Date: 01/10/2007 11:29 AM Pg: 1 of 3

Property of Cook County Clerk's Office

Release of Deed**Full****Partial**

Know all Men by these presents, that JPMORGAN CHASE BANK, NA
("Bank") in

consideration of one dollar, and other good and valuable considerations, the receipt whereof is hereby acknowledged, does hereby release, convey and quit claim unto ALAN J ILIFF SUCCESSOR TRUSTEE ON BEHALF OF THE JAMES E ILIFF LIVING TRUST DATED 5-15-91; AND ALAN J ILIFF and its/his/their heirs, legal representatives and assigns, all the right, title, interest, claim or demand whatsoever Bank may have acquired in, through or by a certain Mortgage dated 06/07/06 as Document Number 0618711035 Book NA Page NA recorded/registered in the Recorder's/Registrars Office of COOK County, in the State of Illinois applicable to the property, situated in said County and State, legally described as follows, to-wit:
SEE ATTACHED *& 31 13 400 010 0000

Property Address: 2621 COUNTRY CLUB DR OLYMPIA FIELDS IL 60461

PIN 31 13 303 045 0000 *

For the Protection of the Owner, this Release shall be filed with the Recorder or Registrar of Titles in whose office the Mortgage or Trust of Deed was filed.

UNOFFICIAL COPY



CHECK IF PARTIAL - if checked, the following apply

This Release is deemed and shall be construed solely as partial release of the aforementioned Mortgage and Assignments of Rents, which also covers other property and that the lien of said Mortgage and Assignment of Rents shall continue without abatement or interruption with respect to all of the Bank's right, title and interest in and to any and all other property still remaining subject to said liens and encumbrances.

Dated at LEXINGTON, KY as of 12/08/06

JPMORGAN CHASE BANK, NA

By: JENNIFER KELLY
Its: Mortgage Officer

Attest: NICOLE EDWARDS
Its: Authorized Officer

State of KENTUCKY
County of FAYETTE

I, the undersigned, a Notary Public in and for County in the State aforesaid, DO HEREBY CERTIFY THAT: the persons whose names are subscribed to the foregoing instrument are personally known to me to be duly authorized officers or authorized agents of JPMORGAN CHASE BANK, NA and THAT THEY appeared before me this day in person and severally acknowledged that they signed and delivered the said instrument in writing as duly authorized agents of said corporation and caused the corporate seal of said corporation to be affixed thereto pursuant to authority given by the Board of Directors of said Corporation as their free and voluntary act, and as the free and voluntary act and deed of said corporation for the uses and purposes therein set forth.

GIVEN under my hand and notarial seal, the day and year first above written.

Susan Carol Lainhart
Notary Public

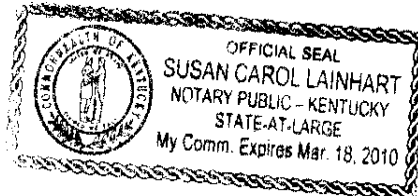

My Commission Expires:

This instrument was prepared by: NICOLE EDWARDS

00414511698406

After recording mail to: Chase Home Finance
LOAN SERVICING CENTER
PO BOX 11606
LEXINGTON KY 40576-9982

UNOFFICIAL COPY

TAX ID 31-13-303-045-0000 & 31-13-400-010-0000

PARCEL 1: LOT 20 IN OLYMPIA WOODS, A SUBDIVISION OF PART OF SECTION 13, TOWN 35 NORTH, RANGE 13, EAST OF THE THIRD PRINCIPAL MERIDIAN, IN COOK COUNTY, ILLINOIS, ACCORDING TO PLAT THEREOF REGISTERED IN THE OFFICE OF THE REGISTRAR OF TITLES OF COOK COUNTY, ILLINOIS, AS DOCUMENT NO. 1458308. PARCEL 2: THAT PART OF THE SOUTHWEST QUARTER OF THE NORTHEAST QUARTER OF SECTION 13, TOWNSHIP 35 NORTH, RANGE 13, EAST OF THE THIRD PRINCIPAL MERIDIAN, IN COOK COUNTY, ILLINOIS, DESCRIBED AS FOLLOWS: BEGINNING AT THE N.W. CORNER OF LOT 18, IN "OLYMPIA WOODS SUBDIVISION," AS PER PINT THEREOF REGISTERED IN THE OFFICE OF THE REGISTRAR OF TITLES OF COOK COUNTY, ILLINOIS, ON THE 24TH DAY OF APRIL,

1953, AS DOCUMENT NO. 1458308: THENCE SOUTH ON THE WEST LINE OF SAID LOT 18, 183.50 FEET TO THE SOUTHWEST CORNER THEREOF, SAID CORNER BEING A COMMON CORNER WITH LOTS 19 AND 20 IN SAID SUBDIVISION; THENCE NORTHWESTERLY ON THE NORTHERLY LINE OF LOT 20, 180 FEET TO THE N.W. CORNER OF SAID LOT 20; THENCE NORTHEASTERLY ALONG A STRAIGHT LINE WHICH MAKES AN ANGLE OF 21 DEGREES 46 MINUTES WITH A LINE BEING THE EXTENSION NORTHEASTERLY OF THE WEST LINE OF LOT 20, WHEN TURNED FROM THE NORTH TO THE EAST, A DISTANCE OF 68.47 FEET TO A POINT; THENCE NORTHERLY ALONG A STRAIGHT LINE WHICH MAKES AN ANGLE OF 137 DEGREES 46 MINUTES WITH THE LAST DESCRIBED LINE, WHEN TURNED FROM THE SOUTHWEST TO THE NORTH, A DISTANCE OF 62 FEET TO A POINT, SAID POINT BEING 112.35 FEET NORTHEAST OF THE NORTHWEST CORNER OF SAID LOT 20, AS MEASURED ALONG SAID EXTENSION NORTHEASTERLY OF THE WEST LINE OF SAID LOT 20; THENCE EAST ALONG A STRAIGHT LINE, 93.80 FEET TO THE POINT OF BEGINNING, IN COOK COUNTY, ILLINOIS.

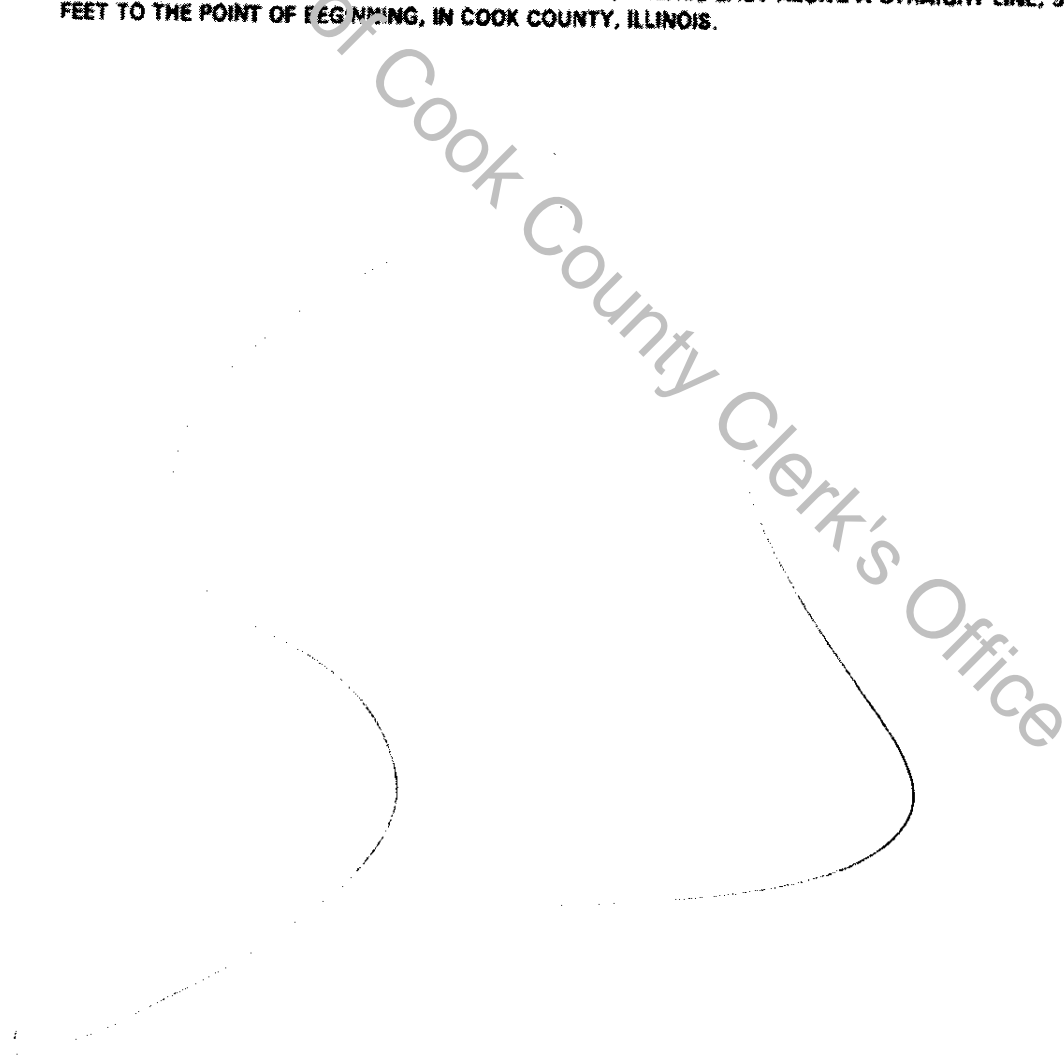

Cook County Clerk's Office