

UNOFFICIAL COPY



Doc#: 0727541149 Fee: \$154.00  
Eugene "Gene" Moore RHSP Fee:\$10.00  
Cook County Recorder of Deeds  
Date: 10/02/2007 02:27 PM Pg: 1 of 66

UPON RECORDING, RETURN TO:

Jill Chesser, Clerk  
Holland & Knight LLP  
2099 Pennsylvania Avenue NW  
Washington, DC 20005

MEMORANDUM OF AMENDED AND RESTATED REAL ESTATE GROUND LEASE, DEED  
AND CONVEYANCE OF FACILITIES

THIS MEMORANDUM OF AMENDED AND RESTATED REAL ESTATE GROUND LEASE AND CONVEYANCE OF FACILITIES (this "Memorandum") is entered into as of October 1, 2007, by and between the UNITED STATES OF AMERICA, DEPARTMENT OF THE NAVY (the "Government" or "DON") whose address is Naval Facilities Engineering Command, Washington Navy Yard, 1322 Patterson Avenue SE, Suite 1000, Washington, DC 20374-5065, Attn: Special Ventures Acquisition Programs - Midwest PPV; and MIDWEST FAMILY HOUSING, LLC an Illinois limited liability company (the "Lessee") whose address is c/o Forest City Residential Group, Inc., 50 Public Square, Terminal Tower, Suite 1360, Cleveland, Ohio 44113-2267, Attn: General Counsel.

WITNESSETH:

WHEREAS, on January 1, 2006, the Government and the Lessee entered into that certain Real Estate Ground Lease and Conveyance of Facilities (the "Original Lease"), whereby the Government (a) leased to Lessee certain land, and (b) granted, sold, deeded, transferred and conveyed, to the Lessee certain improvements, subject to the terms and conditions of the Original Ground Lease; and

A Memorandum of Real Estate Ground Lease, Deed and Conveyance of Facilities commemorating the execution of the Original Ground Lease (the "Original Memorandum") was recorded in (i) the Official Records of Cook County, Illinois on February 1, 2006 as Instrument No. 0603219135 and (ii) the Official Records of Lake County, Illinois on February 3, 2006 as Instrument No. 5941126; and

Box 400

8389452 JFagen D-1  
Cook  
1/2

# UNOFFICIAL COPY

WHEREAS, the Government and Lessee entered into that certain unrecorded Amended and Restated Real Estate Ground Lease and Conveyance of Facilities dated as of October 1, 2007 (the "**Lease**"), pursuant to which the Government, among other things, amended and restated the Original Lease to modify the definition of "land" and "improvements" in the Original Lease and now, pursuant to the Lease, (a) leases, to Lessee the Land (as defined below), and (b) grants, sells, deeds, transfers and conveys, to Lessee the Improvements (as defined below), subject to the terms and conditions of the Lease; and

WHEREAS, the Government and Lessee desire to enter into this Memorandum to be recorded in order that third parties will have notice of the existence of the Lease, including the easements granted therein and the improvements conveyed thereby.

NOW THEREFORE, in consideration of the sum of One Dollar (\$1.00) and other good and valuable consideration paid by Lessee to the Government, the receipt and sufficiency of which are hereby acknowledged, the parties hereby agree as follows:

1. Recitals. The recitals set forth above are hereby incorporated by reference as substantive provisions of this Memorandum.

2. Lease of Land and Conveyance of Improvements. The Government (a) does hereby exclusively lease to Lessee and Lessee hereby leases from the Government, on the terms and conditions set forth in the Lease, certain land, as more particularly described in Exhibit A attached hereto and made a part hereof and situated in Cook and Lake Counties in the State of Illinois (the "**Land**"), together with all and singular the appurtenances, rights, privileges and easements unto the Land belonging or in any way thereto appertaining including, but not limited to, the right of access to and use of the streets, roads, electric, gas, telephone, water and sewer and other utility facilities now or in the future appurtenant to, serving or benefiting the Land (collectively, the "**Appurtenances**"), (b) does hereby grant, sell, deed, transfer and convey to Lessee all facilities and improvements, including the existing residential units and any equipment, alterations, additions, utilities, infrastructure and attached fixtures located in, on and under the Land on the date hereof except for (i) the improvement set forth in Exhibit I of the Lease and (ii) the streets, roads, electric, gas, telephone, water and sewer and other utility facilities for which the Government has retained ownership and maintenance responsibility pursuant to Article 19 of the Lease (the "**Existing Improvements**"), and (c) does hereby grant to Lessee the unrestricted right, subject to any security procedures as may be from time to time established by the Government, which are applicable to nonmilitary third parties uniformly applied, of access to and use of the streets, roads, easements and all electric, telephone, gas, water and sewer and other utility facilities now or in the future appurtenant to, serving or benefiting the Land, the Existing Improvements and/or the Additional Improvements (defined below). Title to the Existing Improvements, all improvements located in, on or under the Land and the Sales Land (as defined in the Lease) that are hereafter constructed by or at the request of Lessee (the "**Additional Improvements**") and the Personal Property (as defined in the Lease) shall vest in and belong to Lessee subject to the terms of the Lease. Upon the Term Expiration Date (as defined below) all Improvements and Personal Property located thereon shall be abandoned in place by Lessee and become the property of the then-owner of the Land. Collectively, the Existing Improvements and the Additional Improvements shall be referred to herein as the "**Improvements.**" Collectively, the Land, the Sales Land, the Improvements and

# UNOFFICIAL COPY

the Appurtenances may be referred to herein as the “**Leased Premises.**” This lease, grant and conveyance shall be subject to all other terms and conditions of the Lease, as set forth therein.

3. Encumbrances. The Lease, the Leased Premises and the Personal Property are subject to those encumbrances disclosed on Exhibit B attached hereto and incorporated herein, and all matters of public record existing as of the date hereof (collectively, the “**Existing Encumbrances**”). The Government has no knowledge of any encumbrances other than Existing Encumbrances. Subject to the provisions of the Lease, the Government shall, at no cost to Lessee, have the further right to create and grant additional easements and rights-of-way over, across and through the Leased Premises, including, without limitation, the right to modify and relocate any of the Existing Encumbrances (the “**Additional Encumbrances**”).

4. Term. The Lease shall be for a term of fifty (50) years (the “**Term**”). The Term began as of January 1, 2006 (the “**Term Beginning Date**”) and will end on December 31, 2055 (the “**Term Expiration Date**”), unless sooner terminated in accordance with the provisions of the Lease, in which case the “Term Expiration Date” shall mean such earlier date of termination.

5. Right of Leasehold Mortgagees. Subject to the terms and conditions of the Lease, the Lease grants to any holder of any mortgage, deed of trust or similar security agreement (a “**mortgage**”) placed by the lessee thereunder on its interest in the Land and Improvements certain rights to receive notices from the Government of defaults of the lessee under the Lease, and further grants to any mortgage holder the right to cure such defaults of the lessee.

6. Subleases and Mortgages. Certain provisions of the Lease limit certain assignments, subleases, mortgages, or any other transfers of the Land and Improvements or any interest therein by the Government, Lessee or any assignee of the lessee’s interest under the Lease.

7. Incorporation of Lease. All of the terms, conditions, provisions, representations, warranties and covenants of the Lease are incorporated into this Memorandum by reference as though set forth in their entirety herein, and the Lease and this Memorandum shall be deemed to constitute but a single instrument. The provisions of this Memorandum are solely for the purpose of giving notice to third parties of lessee’s interest in the Land and Improvements, and the grants and reservations of easements, and shall not be deemed to add to, modify, or limit the provisions of the Lease, and shall be of no force or effect whatsoever in construing the Lease.

8. Counterparts. This Memorandum may be executed in two or more counterparts, each of which shall be deemed an original, but all of which together shall constitute one and the same instrument.

[Remainder of Page Intentionally Left Blank]

# UNOFFICIAL COPY

IN WITNESS WHEREOF, on the date first above written, the Government and Lessee have caused this Memorandum of Amended and Restated Real Estate Ground Lease and Conveyance of Facilities to be executed on their behalf.

**GOVERNMENT:**

UNITED STATES OF AMERICA,  
DEPARTMENT OF THE NAVY, and authorized  
representatives

By:   
Scott D. Forrest, Director  
Special Ventures Acquisition  
Naval Facilities Engineering Command

STATE OF District of Columbia )  
COUNTY OF Columbia )

SS.

On this the 26<sup>th</sup> day of September, 2007, before me personally appeared Scott D. Forrest, Director, Special Ventures Acquisitions Programs, Naval Facilities Engineering Command, on behalf of the United States of America, Department of the Navy, who, being by me duly sworn or affirmed, did say that such person executed the foregoing Memorandum of Amended and Restated Real Estate Ground Lease and Conveyance of Facilities as the free act and deed of such person, and if applicable in the capacity shown, having been duly authorized to execute such instrument in such capacity.

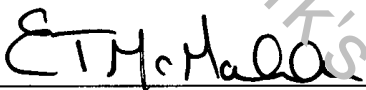
  
Notary Public

Elizabeth T. McMahon  
Notary Public, District of Columbia  
My Commission Expires 3-14-2010

Printed Name of Notary Public

My commission expires: \_\_\_\_\_

[Signature Page to Memorandum of Real Estate Ground Lease and Conveyance of Facilities (Page 1 of 2)]

[Signatures Continue on the Following Page]

# UNOFFICIAL COPY

**LESSEE:**

MIDWEST FAMILY HOUSING, LLC, an Illinois limited liability company

By: Midwest Military Communities, LLC, an Illinois limited liability company, its managing member

By: Forest City Residential Group, Inc., an Ohio corporation, its managing member

By: Thomas W. Henneberry  
Name: Thomas W. Henneberry  
Title: Executive Vice-President

Property of Cook County

STATE OF District of Columbia  
COUNTY OF Washington, DC

On this the 12th day of Sept., 2007, before me personally appeared Thomas W. Henneberry, the Executive Vice-President of Forest City Residential Group, Inc., an Ohio corporation, the managing member of Midwest Military Communities, LLC, an Illinois limited liability company, the managing member of MIDWEST FAMILY HOUSING, LLC, who, being by me duly sworn or affirmed, did say that such person executed the foregoing Memorandum of Amended and Restated Real Estate Ground Lease and Conveyance of Facilities as the free act and deed of such person, and if applicable in the capacity shown, having been duly authorized to execute such instrument in such capacity.

Nina A. Crump  
Notary Public

Printed Name of Notary Public **Nina A. Crump**  
Notary Public, District of Columbia  
My Commission Expires Jan. 1, 2010

My commission expires: \_\_\_\_\_

# UNOFFICIAL COPY

## Consent of Master Trustee

The Bank of New York Trust Company, N.A. (formerly J.P. Morgan Trust Company, National Association), as master trustee (the "Master Trustee"), pursuant to a Master Indenture of Trust dated as of January 1, 2006, as supplemented by a 2006 Series A Indenture dated as of January 1, 2006, by and among Midwest Military Communities, LLC (the "MMC"), Tri Mont Real Estate Advisors, Inc. and Master Trustee, hereby agrees as follows:

1. Master Trustee hereby consents to the Amended and Restated Real Estate Ground Lease and Conveyance of Facilities dated as of October 1, 2007 (the "Amended Ground Lease") by and between the United States of America, Department of the Navy (the "DoN") and Midwest Family Housing, LLC; and

2. Master Trustee has executed multiple counterparts of this Consent and hereby agrees that any such counterpart may be affixed to any memorandum of the Amended Ground Lease placed of record in the States of Illinois, Indiana or Tennessee.

**THE BANK OF NEW YORK TRUST  
COMPANY, N.A., AS MASTER TRUSTEE  
(formerly J.P. Morgan Trust Company National  
Association)**

By:   
Name: Robert Ware  
Title: Assistant Vice President

# UNOFFICIAL COPY

| STATE OF OHIO SS:  
| COUNTY OF CUYAHOGA

I HEREBY CERTIFY that on this \_\_\_\_\_ day of \_\_\_\_\_, 2007, before me, a Notary Public for the state and county described above, personally appeared ROBERT WARE, as A. V. P. of The Bank of New York Trust Company, N.A., as Master Trustee and formerly J.P. Morgan Trust Company, National Association and that on behalf of The Bank of New York Trust Company, N.A., as Master Trustee and formerly J.P. Morgan Trust Company, National Association he executed the within instrument for the uses and purposes therein contained.

IN WITNESS WHEREOF, I have set my hand and Notarial Seal, the day and year first above written.

B. Impala  
Notary Public

**B. IMPALA**  
NOTARY PUBLIC - STATE OF OHIO  
My Commission expires Dec. 15, 2009

My Commission Expires:

# UNOFFICIAL COPY

EXHIBIT A

LEGAL DESCRIPTION

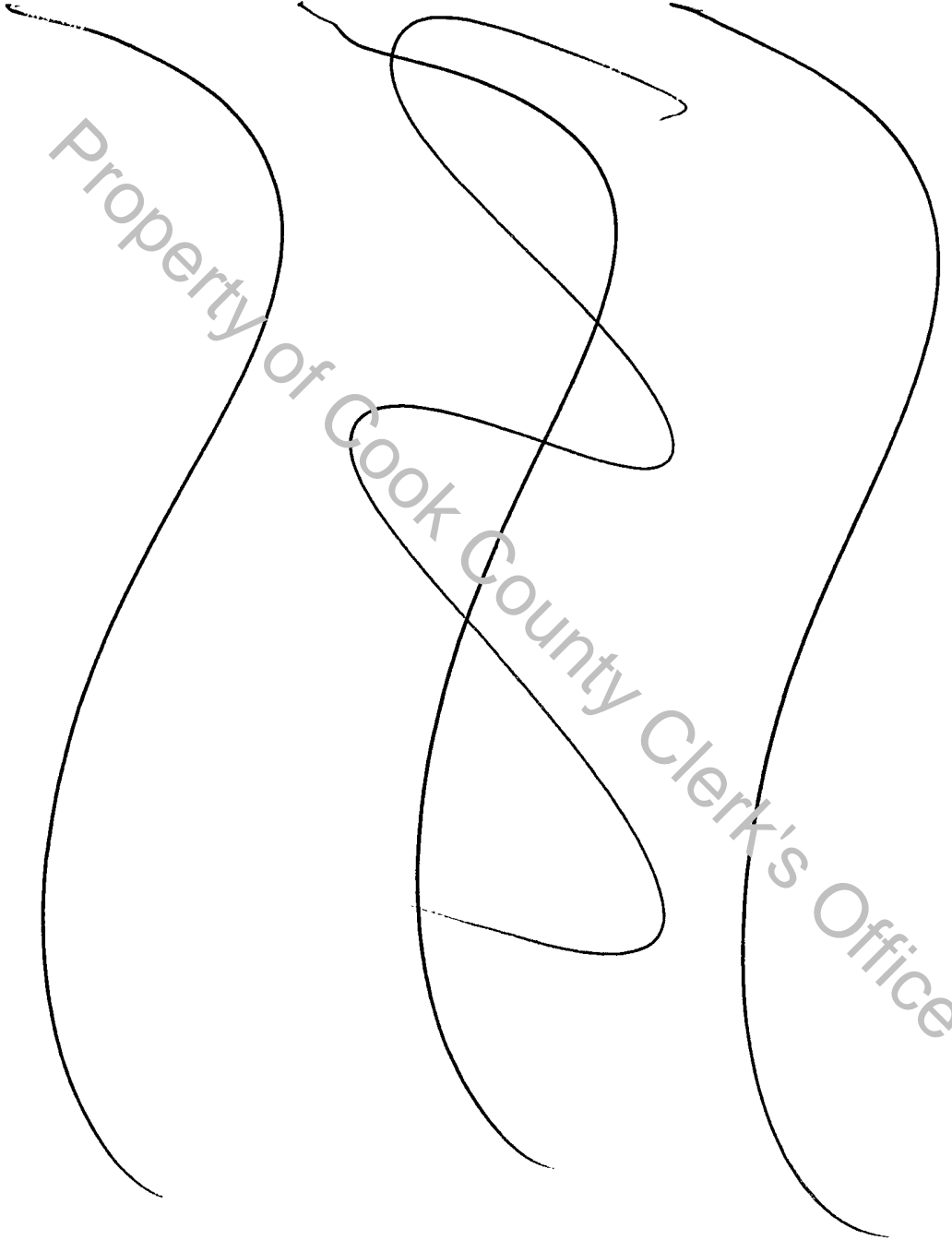



# UNOFFICIAL COPY

PART OF THE SOUTHEAST QUARTER OF SECTION 5 AND THE NORTHEAST QUARTER OF SECTION 8, TOWNSHIP 44 NORTH, RANGE 12 EAST OF THE THIRD PRINCIPAL MERIDIAN, LAKE COUNTY, ILLINOIS, MORE PARTICULARLY DESCRIBED AS FOLLOWS:

COMMENCING AT THE SOUTHWEST CORNER OF THE SOUTHEAST QUARTER OF SAID SECTION 5; THENCE SOUTH 89 DEGREES 43 MINUTES 23 SECONDS EAST, ON THE SOUTH LINE OF SAID SOUTHEAST QUARTER 40.00 FEET TO THE EAST LINE OF LEWIS AVENUE PER EASEMENT FOR PUBLIC HIGHWAY PURPOSES RECORDED OCTOBER 7, 1957 AS DOCUMENT NUMBER 967659 AND THE POINT OF BEGINNING; THENCE NORTH 0 DEGREES 00 MINUTES 52 SECONDS WEST ON SAID EAST LINE 1050.48 FEET TO THE SOUTH LINE OF DOCUMENT NUMBER 1709302, RECORDED MAY 20, 1975, AS SURVEYED; THENCE SOUTH 89 DEGREES 44 MINUTES 26 SECONDS EAST ON SAID SOUTH LINE AS SURVEYED, 929.95 FEET; THENCE SOUTH 0 DEGREES 04 MINUTES 19 SECONDS WEST, 1638.25 FEET; THENCE SOUTH 89 DEGREES 55 MINUTES 41 SECONDS EAST, 1.00 FOOT; THENCE SOUTH 0 DEGREES 04 MINUTES 19 SECONDS WEST, 37.00 FEET; THENCE NORTH 89 DEGREES 55 MINUTES 41 SECONDS WEST, 1.00 FOOT, THENCE SOUTH 0 DEGREES 04 MINUTES 19 SECONDS WEST 623.00 FEET TO THE NORTHERLY LINE OF BUCKLEY ROAD PER DEED RECORDED JULY 18, 1962 AS DOCUMENT NUMBER 1155865, AND AS SHOWN ON PLAT RECORDED AUGUST 15, 1966 AS DOCUMENT NUMBER 2432304; THENCE CONTINUING WESTERLY ON SAID NORTHERLY LINE OF SAID BUCKLEY ROAD THE FOLLOWING ELEVEN DESCRIBED COURSES; SOUTH 83 DEGREES 19 MINUTES 24 SECONDS WEST, 193.91 FEET; THENCE SOUTH 86 DEGREES 11 MINUTES 08 SECONDS WEST, 100.12 FEET; THENCE SOUTH 83 DEGREES 19 MINUTES 24 SECONDS WEST, 260.00 FEET; THENCE SOUTH 87 DEGREES 24 MINUTES 32 SECONDS WEST, 25.59 FEET; THENCE NORTH 2 DEGREES 35 MINUTES 28 SECONDS WEST, 27.00 FEET; THENCE SOUTH 87 DEGREES 24 MINUTES 32 SECONDS WEST, 70.00 FEET; THENCE SOUTH 2 DEGREES 35 MINUTES 28 SECONDS EAST, 27.00 FEET; THENCE SOUTH 87 DEGREES 24 MINUTES 32 SECONDS WEST, 44.77 FEET; THENCE SOUTH 83 DEGREES 19 MINUTES 24 SECONDS WEST, 160.00 FEET; THENCE NORTH 76 DEGREES 07 MINUTES 15 SECONDS WEST, 42.72 FEET; THENCE NORTH 37 DEGREES 17 MINUTES 57 SECONDS WEST, 63.16 FEET TO THE EAST LINE OF LEWIS AVENUE PER EASEMENT FOR PUBLIC HIGHWAY PURPOSES RECORDED OCTOBER 7, 1957 AS DOCUMENT NUMBER 967659; THENCE NORTH 0 DEGREES 07 MINUTES 24 SECONDS EAST ON SAID EAST LINE, 1275.82 FEET TO THE POINT OF BEGINNING, CONTAINING 49.984 ACRES, OR 2,177,312 SQUARE FEET, MORE OR LESS.

# UNOFFICIAL COPY

PART OF THE SOUTHEAST QUARTER OF THE SOUTHWEST QUARTER OF SECTION 5 AND THE SOUTHWEST QUARTER OF SECTION 8, TOWNSHIP 44 NORTH, RANGE 12 EAST OF THE THIRD PRINCIPAL MERIDIAN, LAKE COUNTY, ILLINOIS, MORE PARTICULARLY DESCRIBED AS FOLLOWS:

COMMENCING AT THE NORTHEAST CORNER OF THE NORTHWEST QUARTER OF SAID SECTION 8; THENCE NORTH 89 DEGREES 42 MINUTES 43 SECONDS WEST, ON THE NORTH LINE OF SAID NORTHEAST QUARTER 40.00 FEET TO THE EAST LINE OF LEASE AREA 2 PER DOCUMENT NUMBER 1026984, RECORDED APRIL 15, 1959, ALSO BEING THE WEST LINE OF LEWIS AVENUE PER EASEMENT FOR PUBLIC HIGHWAY PURPOSES RECORDED OCTOBER 7, 1957 AS DOCUMENT NUMBER 967659; THENCE SOUTH 8 DEGREES 07 MINUTES 24 SECONDS WEST ON SAID LEASE LINE 681.60 FEET; THENCE CONTINUING ON A SOUTHERLY LINE OF SAID LEASE SOUTH 80 DEGREES 21 MINUTES 50 SECONDS WEST, 608.81 FEET; THENCE CONTINUING ON AN EASTERLY LINE OF SAID LEASE SOUTH 0 DEGREES 07 MINUTES 24 SECONDS WEST, 275.07 FEET; THENCE SOUTH 31 DEGREES 27 MINUTES 20 SECONDS WEST, 310.22 FEET TO THE NORTHERLY LINE OF PARCEL C OF A PERPETUAL EASEMENT FOR ROADWAY PURPOSES RECORDED JULY 14, 1967 AS DOCUMENT NUMBER 1343737; THENCE NORTH 81 DEGREES 10 MINUTES 53 SECONDS WEST ON SAID NORTHERLY LINE, 291.30 FEET; THENCE CONTINUING ON SAID NORTHERLY LINE WESTERLY 222.60 FEET ON A CURVE CONCAVE TO THE SOUTH, SAID CURVE HAVING A RADIUS OF 2932.23 FEET, THE CHORD OF SAID CURVE BEARS NORTH 83 DEGREES 21 MINUTES 23 SECONDS WEST, A CHORD DISTANCE OF 222.55 FEET TO THE EAST LINE OF GREAT LAKES SUBDIVISION, PER PLAT RECORDED FEBRUARY 11, 1989, AS DOCUMENT NUMBER 4298472; THENCE NORTH 0 DEGREES 03 MINUTES 45 SECONDS EAST ON SAID EAST LINE 381.05 FEET TO THE NORTHERLY LINE OF SAID GREAT LAKES SUBDIVISION; THENCE SOUTH 37 DEGREES 40 MINUTES 52 SECONDS WEST ON SAID NORTHERLY LINE 140.39 FEET TO THE NORTHERLY LINE OF PARCEL B OF A PERPETUAL EASEMENT FOR ROADWAY PURPOSES RECORDED JULY 14, 1967 AS DOCUMENT NUMBER 1343737; THENCE CONTINUING ON SAID NORTHERLY AND EASTERLY LINES OF SAID PERPETUAL EASEMENT THE FOLLOWING NINE DESCRIBED COURSES; NORTH 52 DEGREES 19 MINUTES 08 SECONDS WEST, 55.00 FEET; SOUTH 81 DEGREES 38 MINUTES 47 SECONDS WEST, 82.98 FEET; NORTH 89 DEGREES 42 MINUTES 26 SECONDS WEST, 71.00 FEET; NORTH 83 DEGREES 59 MINUTES 48 SECONDS WEST, 50.25 FEET; NORTH 57 DEGREES 03 MINUTES 09 SECONDS WEST, 77.51 FEET; SOUTH 79 DEGREES 48 MINUTES 40 SECONDS WEST, 40.00 FEET; NORTH 47 DEGREES 03 MINUTES 32 SECONDS WEST, 25.00 FEET; NORTH 10 DEGREES 11 MINUTES 20 SECONDS WEST, 125.00 FEET; NORTH 13 DEGREES 03 MINUTES 05 SECONDS WEST, 100.12 FEET TO THE EASTERLY LINE OF GREEN BAY ROAD; THENCE NORTH 10 DEGREES 11 MINUTES 20 SECONDS WEST ON SAID EAST LINE 457.67 FEET; THENCE CONTINUING ON SAID EAST LINE NORTHERLY 43.02 FEET ON A CURVE CONCAVE TO THE WEST, SAID CURVE HAVING A RADIUS OF 3859.83 FEET, THE CHORD OF SAID CURVE BEARS NORTH 10 DEGREES 30 MINUTES 29 SECONDS WEST, A CHORD DISTANCE OF 43.02 FEET TO THE SOUTH LINE OF AN EASEMENT FOR CONSTRUCTION AND OPERATION OF A TRAFFIC SIGNAL RECORDED SEPTEMBER 14, 1984 AS DOCUMENT NUMBER 2309972; THENCE NORTH 89 DEGREES 40 MINUTES 08 SECONDS EAST ON SAID SOUTH LINE 20.74 FEET TO THE EAST LINE OF SAID EASEMENT; THENCE NORTH 0 DEGREES 19 MINUTES 00 SECONDS WEST ON SAID EAST LINE 60.00 FEET TO THE NORTH LINE OF SAID EASEMENT; THENCE SOUTH 89 DEGREES 40 MINUTES 08 SECONDS WEST ON SAID NORTH LINE 32.37 FEET TO THE EASTERLY LINE OF GREEN BAY ROAD; THENCE NORTHERLY ON SAID EASTERLY LINE 120.99 FEET ON A CURVE CONCAVE TO THE WEST, SAID CURVE HAVING A RADIUS OF 3859.83 FEET, THE CHORD OF SAID CURVE BEARS NORTH 12 DEGREES 37 MINUTES 58 SECONDS WEST, A CHORD DISTANCE OF 120.99 FEET TO THE SOUTH LINE OF FREDERICK H. BARTLETT'S LAKE VIEW ESTATES PER THE PLAT THEREOF RECORDED OCTOBER 15,

# UNOFFICIAL COPY

1925 AS DOCUMENT NUMBER 267110; THENCE SOUTH 89 DEGREES 42 MINUTES 43 SECONDS EAST ON SAID SOUTH LINE 605.27 FEET TO THE EAST LINE OF SAID LAKE VIEW ESTATES, SAID LINE ALSO BEING A WEST LINE OF LEASE AREA 3 PER DOCUMENT NUMBER 1026986, RECORDED APRIL 15, 1959; THENCE NORTH 0 DEGREES 02 MINUTES 26 SECONDS WEST ON SAID EAST LINE 573.88 FEET TO AN ANGLE IN SAID LEASE LINE; THENCE NORTH 89 DEGREES 57 MINUTES 34 SECONDS EAST ON SAID LEASE LINE 70.00 FEET; THENCE NORTH 0 DEGREES 02 MINUTES 26 SECONDS EAST ON SAID LEASE LINE AND ITS EXTENSION 92.44 FEET TO THE SOUTH LINE OF A FIFTEEN FOOT WIDE EASEMENT FOR WATER MAIN DISCLOSED BY LEASE DOCUMENT NUMBER 1026984; THENCE SOUTH 89 DEGREES 01 MINUTE 24 SECONDS WEST ON SAID SOUTHLINE 70.01 FEET SAID EAST LINE OF FREDERICK H. BARTLETS' LAKE VIEW ESTATES; THENCE NORTH 0 DEGREES 02 MINUTES 26 SECONDS WEST ON SAID EAST LINE 620.70 FEET TO A LINE 33.00 FEET SOUTHERLY OF AND PARALLEL WITH THE NORTH LINE OF THE SOUTHEAST QUARTER OF THE SOUTHWEST QUARTER OF SAID SECTION 5; THENCE SOUTH 89 DEGREES 44 MINUTES 20 SECONDS EAST ON SAID PARALLEL LINE 1242.44 FEET TO THE SOUTHWESTERLY LINE OF PARCEL D OF A PERPETUAL EASEMENT FOR ROADWAY PURPOSES RECORDED JULY 14, 1967 AS DOCUMENT NUMBER 1343737; THENCE SOUTH 44 DEGREES 44 MINUTES 43 SECONDS EAST ON SAID SOUTHWESTERLY LINE 42.43 FEET TO THE EAST LINE OF LEASE AREA 2 PER DOCUMENT NUMBER 1026984, RECORDED APRIL 15, 1959, ALSO BEING THE WEST LINE OF LEWIS AVENUE PER EASEMENT FOR PUBLIC HIGHWAY PURPOSES RECORDED OCTOBER 7, 1957 AS DOCUMENT NUMBER 957859; THENCE SOUTH 0 DEGREES 00 MINUTES 52 SECONDS EAST ON SAID WEST LINE (ALSO BEING THE EAST LINE OF LEASE AREA 2) 1256.67 FEET TO THE POINT OF BEGINNING, CONTAINING 78.162 ACRES, OR 3,404,730 SQUARE FEET, MORE OR LESS.

County Clerk's Office

# UNOFFICIAL COPY

G:\Psd\9000\9100\9100.02 - FORRESTAL\9100.02-8 - Forrestal Water Tower\Legal Descriptions\09-25-07 COMPLETE LEGAL.doc

(REVISED PER BALLARD SPAHR ANDREWS & INGERSOLL, LLP COMMENTS AND TO INCLUDE EXCEPTION PARCELS A - F INCLUSIVE)

THAT PART OF THE EAST HALF OF SECTION 7, THE WEST HALF OF SECTION 8, THE WEST HALF OF SECTION 17, AND THE EAST HALF OF SECTION 18, TOWNSHIP 44 NORTH, RANGE 12 EAST OF THE THIRD PRINCIPAL MERIDIAN, DESCRIBED AS FOLLOWS:

BEGINNING AT A 4-1/2" CAST IRON PIPE (FILLED WITH CONCRETE) FOUND AT THE INTERSECTION OF THE WESTERLY LINE OF GREEN BAY ROAD WITH THE NORTHERLY LINE OF THE ELGIN, JOLIET AND EASTERN RAILROAD AS SHOWN ON NORTH SHORE REALTY COMPANY'S LAKE BLUFF SUBDIVISION, RECORDED AS DOCUMENT 281874, LAKE COUNTY, ILLINOIS; THENCE SOUTH 65 DEGREES 16 MINUTES 41 SECONDS WEST (NAD 83) ALONG THE NORTHERLY LINE OF SAID RAILROAD, 2456.68 FEET; THENCE NORTH 11 DEGREES 43 MINUTES 09 SECONDS WEST, 508.94 FEET; THENCE NORTH 12 DEGREES 58 MINUTES 26 SECONDS WEST, 553.92 FEET; THENCE NORTH 13 DEGREES 10 MINUTES 02 SECONDS WEST, 451.95 FEET; THENCE SOUTH 85 DEGREES 23 MINUTES 08 SECONDS WEST, 118.01 FEET; THENCE NORTH 16 DEGREES 23 MINUTES 08 SECONDS WEST, 188.05 FEET; THENCE NORTH 12 DEGREES 25 MINUTES 40 SECONDS WEST, 210.72 FEET; THENCE NORTH 12 DEGREES 27 MINUTES 25 SECONDS WEST, 647.39 FEET; THENCE SOUTH 77 DEGREES 20 MINUTES 24 SECONDS WEST, 102.26 FEET; THENCE NORTH 13 DEGREES 13 MINUTES 02 SECONDS WEST, 140.31 FEET; THENCE NORTH 27 DEGREES 56 MINUTES 08 SECONDS EAST, 9.12 FEET; THENCE NORTH 13 DEGREES 48 MINUTES 49 SECONDS WEST, 732.26 FEET; THENCE NORTH 21 DEGREES 26 MINUTES 30 SECONDS WEST, 33.19 FEET; THENCE NORTH 23 DEGREES 42 MINUTES 02 SECONDS WEST, 77.74 FEET; THENCE NORTH 13 DEGREES 16 MINUTES 07 SECONDS WEST, 158.31 FEET; THENCE NORTH 31 DEGREES 38 MINUTES 41 SECONDS EAST, 25.21 FEET; THENCE NORTH 13 DEGREES 10 MINUTES 02 SECONDS WEST, 477.18 FEET; THENCE NORTH 18 DEGREES 05 MINUTES 36 SECONDS WEST, 203.38 FEET; THENCE NORTH 13 DEGREES 13 MINUTES 52 SECONDS WEST, 246.47 FEET; THENCE NORTH 12 DEGREES 46 MINUTES 57 SECONDS WEST, 346.28 FEET; THENCE NORTH 08 DEGREES 51 MINUTES 43 SECONDS WEST, 57.54 FEET; THENCE NORTH 02 DEGREES 40 MINUTES 43 SECONDS WEST, 465.96 FEET; THENCE NORTH 64 DEGREES 06 MINUTES 45 SECONDS WEST, 49.25 FEET; THENCE NORTH 50 DEGREES 27 MINUTES 27 SECONDS WEST, 82.33 FEET; THENCE NORTH 37 DEGREES 07 MINUTES 13 SECONDS WEST, 41.81 FEET; THENCE NORTH 23 DEGREES 39 MINUTES 52 SECONDS WEST, 59.26 FEET; THENCE NORTH 15 DEGREES 13

# UNOFFICIAL COPY

MINUTES 47 SECONDS WEST, 47.25 FEET; THENCE NORTH 09 DEGREES 21 MINUTES 43 SECONDS WEST, 39.17 FEET; THENCE NORTH 00 DEGREES 08 MINUTES 32 SECONDS EAST, 125.59 FEET; THENCE NORTH 00 DEGREES 22 MINUTES 38 SECONDS EAST, 668.97 FEET; THENCE NORTH 38 DEGREES 48 MINUTES 35 SECONDS EAST, 41.96 FEET; THENCE NORTH 02 DEGREES 03 MINUTES 56 SECONDS EAST, 71.69 FEET; THENCE NORTH 24 DEGREES 08 MINUTES 47 SECONDS EAST, 107.91 FEET; THENCE NORTH 14 DEGREES 11 MINUTES 47 SECONDS WEST, 65.81 FEET; THENCE NORTH 24 DEGREES 41 MINUTES 13 SECONDS WEST, 135.42 FEET TO THE SOUTH LINE OF BUCKLEY ROAD (ALSO KNOWN AS ILLINOIS ROUTE 137) AS MONUMENTED; SAID LINE BEING 50.00 FEET SOUTH OF AND PARALLEL WITH THE CENTERLINE OF BUCKLEY ROAD; THENCE SOUTH 89 DEGREES 41 MINUTES 49 SECONDS EAST, ALONG SAID LINE, 147.14 FEET; THENCE SOUTH 01 DEGREES 15 MINUTES 26 SECONDS WEST, 556.34 FEET; THENCE SOUTH 13 DEGREES 09 MINUTES 46 SECONDS EAST, 231.44 FEET; THENCE NORTH 89 DEGREES 02 MINUTES 09 SECONDS WEST, 35.89 FEET; THENCE SOUTH 17 DEGREES 02 MINUTES 16 SECONDS EAST, 78.91 FEET; THENCE SOUTH 24 DEGREES 32 MINUTES 16 SECONDS EAST, 60.77 FEET; THENCE SOUTH 31 DEGREES 02 MINUTES 17 SECONDS EAST, 49.51 FEET; THENCE SOUTH 30 DEGREES 28 MINUTES 53 SECONDS EAST, 121.79 FEET; THENCE SOUTH 89 DEGREES 45 MINUTES 28 SECONDS EAST, 476.21 FEET; THENCE SOUTH 03 DEGREES 12 MINUTES 46 SECONDS EAST, 379.11 FEET; THENCE SOUTH 89 DEGREES 41 MINUTES 16 SECONDS EAST, 178.02 FEET; THENCE NORTH 00 DEGREES 16 MINUTES 19 SECONDS EAST, 1421.22 FEET TO THE SOUTHERLY LINE OF BUCKLEY ROAD (ALSO KNOWN AS ILLINOIS ROUTE 137); THENCE SOUTH 89 DEGREES 41 MINUTES 49 SECONDS EAST ALONG SAID SOUTHERLY LINE, 551.96 FEET; THENCE SOUTH 00 DEGREES 18 MINUTES 16 SECONDS WEST, 504.05 FEET; THENCE SOUTH 89 DEGREES 54 MINUTES 42 SECONDS EAST, 322.19 FEET; THENCE NORTH 00 DEGREES 14 MINUTES 15 SECONDS EAST, 379.94 FEET; THENCE SOUTH 89 DEGREES 41 MINUTES 49 SECONDS EAST, 1.81 FEET TO THE SOUTHWESTERLY CORNER OF GEORGIA STREET AS DEDICATED; THENCE SOUTH 89 DEGREES 41 MINUTES 49 SECONDS EAST ALONG THE SOUTHERLY LINE OF GEORGIA STREET AS DEDICATED, 74.50 FEET TO THE SOUTHEASTERLY CORNER THEREOF; THENCE NORTH 00 DEGREES 18 MINUTES 11 SECONDS EAST, ALONG THE EASTERLY LINE OF SAID GEORGIA STREET, 70.00 FEET; THENCE NORTH 35 DEGREES 25 MINUTES 07 SECONDS EAST, ALONG SAID LINE, 64.67 FEET TO THE SOUTHERLY LINE OF BUCKLEY ROAD (ALSO KNOWN AS ILLINOIS ROUTE 137); THENCE SOUTH 89 DEGREES 41 MINUTES 49 SECONDS EAST ALONG SAID LINE, 545.00 FEET TO AN ANGLE POINT IN SAID LINE; THENCE SOUTH 83 DEGREES 59 MINUTES 10 SECONDS EAST ALONG SAID LINE, 150.75 FEET TO AN ANGLE POINT IN SAID LINE; THENCE SOUTH 73 DEGREES 18 MINUTES 26 SECONDS EAST ALONG SAID LINE,

# UNOFFICIAL COPY

88.60 FEET TO AN ANGLE POINT IN SAID LINE; THENCE SOUTH 43 DEGREES 02 MINUTES 30 SECONDS EAST, 69.75 FEET TO THE WESTERLY LINE OF GREEN BAY ROAD (ALSO KNOWN AS ILLINOIS ROUTE 131); THENCE SOUTH 10 DEGREES 13 MINUTES 49 SECONDS EAST, ALONG SAID LINE, 134.23 FEET TO A POINT OF CURVATURE; THENCE SOUTHEASTERLY ALONG SAID LINE, BEING A CURVE CONCAVE WESTERLY, HAVING A RADIUS 10701.23, A CHORD BEARING OF SOUTH 08 DEGREES 33 MINUTES 14 SECONDS EAST, A CHORD DISTANCE OF 612.95 FEET, AN ARC LENGTH OF 613.03 FEET TO THE CURVE'S END; THENCE SOUTH 09 DEGREES 45 MINUTES 27 SECONDS EAST ALONG SAID LINE, NOT TANGENT TO THE LAST DESCRIBED COURSE, 99.92 FEET TO AN ANGLE POINT IN SAID LINE; THENCE SOUTH 06 DEGREES 50 MINUTES 45 SECONDS EAST, ALONG SAID LINE, 505.99 FEET; THENCE SOUTH 84 DEGREES 26 MINUTES 10 SECONDS WEST, 532.30 FEET; THENCE SOUTH 02 DEGREES 01 MINUTES 11 SECONDS EAST, 211.02 FEET; THENCE SOUTH 04 DEGREES 34 MINUTES 01 SECONDS EAST, 154.37 FEET; THENCE NORTH 83 DEGREES 06 MINUTES 41 SECONDS EAST, 556.06 FEET TO THE WESTERLY LINE OF SAID GREEN BAY ROAD; THENCE SOUTH 06 DEGREES 50 MINUTES 45 SECONDS EAST, ALONG SAID LINE, 104.00 FEET; THENCE SOUTH 83 DEGREES 06 MINUTES 41 SECONDS WEST, 556.54 FEET; THENCE SOUTH 08 DEGREES 48 MINUTES 50 SECONDS EAST, 203.92 FEET; THENCE SOUTH 11 DEGREES 52 MINUTES 40 SECONDS EAST, 215.10 FEET; THENCE SOUTH 88 DEGREES 08 MINUTES 12 SECONDS EAST, 86.45 FEET; THENCE SOUTH 78 DEGREES 43 MINUTES 00 SECONDS EAST, 99.32 FEET; THENCE NORTH 04 DEGREES 21 MINUTES 32 SECONDS WEST, 167.39 FEET; THENCE NORTH 83 DEGREES 38 MINUTES 57 SECONDS EAST, 343.57 FEET TO THE WESTERLY LINE OF SAID GREEN BAY ROAD; THENCE SOUTH 06 DEGREES 50 MINUTES 45 SECONDS EAST, ALONG SAID LINE, 608.03 FEET; THENCE SOUTH 77 DEGREES 00 MINUTES 15 SECONDS WEST, 473.60 FEET; THENCE SOUTH 13 DEGREES 10 MINUTES 52 SECONDS EAST, 456.25 FEET; THENCE NORTH 77 DEGREES 28 MINUTES 20 SECONDS EAST, 425.41 FEET TO THE WESTERLY LINE OF SAID GREEN BAY ROAD; THENCE SOUTHEASTERLY ALONG SAID LINE, BEING A CURVE CONCAVE EASTERLY, HAVING A RADIUS OF 4420.00 FEET, A CHORD BEARING OF SOUTH 14 DEGREES 44 MINUTES 43 SECONDS EAST, A CHORD DISTANCE OF 903.20 FEET, AN ARC LENGTH OF 904.78 FEET TO A POINT OF REVERSE CURVATURE; THENCE SOUTH 20 DEGREES 37 MINUTES 13 SECONDS EAST ALONG SAID WESTERLY LINE, 305.37 FEET TO A POINT OF CURVATURE; THENCE CONTINUING SOUTHEASTERLY ALONG SAID LINE, BEING A CURVE CONCAVE WESTERLY, HAVING A RADIUS OF 2296.63 FEET, A CHORD BEARING OF SOUTH 14 DEGREES 49 MINUTES 56 SECONDS EAST, A CHORD DISTANCE OF 463.23 FEET, AN ARC LENGTH OF 464.01 FEET TO A POINT OF TANGENCY; THENCE SOUTH 09 DEGREES 02 MINUTES 39 SECONDS

# UNOFFICIAL COPY

EAST, ALONG SAID LINE, 891.71 FEET TO THE POINT OF BEGINNING; ALL IN LAKE COUNTY, ILLINOIS.

EXCEPTING THEREFROM THE FOLLOWING DESCRIBED PROPERTY:

## EXCEPTION NO. 1 (AUTOMOTIVE HOBBY SHOP)

COMMENCING AT A 4-1/2" CAST IRON PIPE (FILLED WITH CONCRETE) FOUND AT THE INTERSECTION OF THE WESTERLY LINE OF GREEN BAY ROAD WITH THE NORTHERLY LINE OF THE ELGIN, JOLIET AND EASTERN RAILROAD AS SHOWN ON NORTH SHORE REALTY COMPANY'S LAKE BLUFF SUBDIVISION, RECORDED AS DOCUMENT 281874, LAKE COUNTY, ILLINOIS; THENCE SOUTH 65 DEGREES 16 MINUTES 41 SECONDS WEST (NAD 83) ALONG THE NORTHERLY LINE OF SAID RAILROAD, 1860.18 FEET; THENCE NORTH 24 DEGREES 43 MINUTES 19 SECONDS WEST AT RIGHT ANGLES TO THE LAST DESCRIBED COURSE, 443.37 FEET FOR A POINT OF BEGINNING; THENCE SOUTH 76 DEGREES 34 MINUTES 35 SECONDS WEST, 134.21 FEET; THENCE NORTH 13 DEGREES 12 MINUTES 48 SECONDS WEST, 452.79 FEET; THENCE NORTH 77 DEGREES 13 MINUTES 57 SECONDS EAST, 136.65 FEET; THENCE SOUTH 12 DEGREES 54 MINUTES 17 SECONDS EAST, 451.24 FEET TO THE POINT OF BEGINNING;

## EXCEPTION NO. 2 (FORRESTAL CHAPEL)

COMMENCING AT A 4-1/2" CAST IRON PIPE (FILLED WITH CONCRETE) FOUND AT THE INTERSECTION OF THE WESTERLY LINE OF GREEN BAY ROAD WITH THE NORTHERLY LINE OF THE ELGIN, JOLIET AND EASTERN RAILROAD AS SHOWN ON NORTH SHORE REALTY COMPANY'S LAKE BLUFF SUBDIVISION, RECORDED AS DOCUMENT 281874, LAKE COUNTY, ILLINOIS; THENCE SOUTH 65 DEGREES 16 MINUTES 41 SECONDS WEST (NAD 83) ALONG THE NORTHERLY LINE OF SAID RAILROAD, 2456.68 FEET; THENCE NORTH 11 DEGREES 43 MINUTES 09 SECONDS WEST, 508.94 FEET; THENCE NORTH 12 DEGREES 58 MINUTES 26 SECONDS WEST, 553.92 FEET; THENCE NORTH 13 DEGREES 10 MINUTES 02 SECONDS WEST, 451.95 FEET; THENCE SOUTH 85 DEGREES 23 MINUTES 08 SECONDS WEST, 118.01 FEET; THENCE NORTH 16 DEGREES 23 MINUTES 08 SECONDS WEST, 188.05 FEET; THENCE NORTH 12 DEGREES 25 MINUTES 40 SECONDS WEST, 210.72 FEET; THENCE NORTH 12 DEGREES 27 MINUTES 25 SECONDS WEST, 628.79 FEET; THENCE NORTH 77 DEGREES 32 MINUTES 35 SECONDS EAST, AT RIGHT ANGLES TO THE LAST DESCRIBED COURSE, 1182.59 FEET FOR THE POINT OF BEGINNING; THENCE NORTH 12 DEGREES 59 MINUTES 40 SECONDS

# UNOFFICIAL COPY

WEST, 327.04 FEET; THENCE NORTH 76 DEGREES 05 MINUTES 41 SECONDS EAST, 95.39 FEET; THENCE NORTH 12 DEGREES 44 MINUTES 41 SECONDS WEST, 95.04 FEET; THENCE NORTH 76 DEGREES 06 MINUTES 03 SECONDS EAST, 22.39 FEET; THENCE NORTH 13 DEGREES 38 MINUTES 41 SECONDS WEST, 41.24 FEET; THENCE NORTH 76 DEGREES 45 MINUTES 58 SECONDS EAST, 166.34 FEET; THENCE SOUTH 13 DEGREES 15 MINUTES 58 SECONDS EAST, 464.78 FEET; THENCE SOUTH 76 DEGREES 47 MINUTES 08 SECONDS WEST, 286.26 FEET TO THE POINT OF BEGINNING;

## EXCEPTION NO. 3 (FAMILY ACTIVITIES CENTER)

COMMENCING AT A 4-1/2" CAST IRON PIPE (FILLED WITH CONCRETE) FOUND AT THE INTERSECTION OF THE WESTERLY LINE OF GREEN BAY ROAD WITH THE NORTHERLY LINE OF THE ELGIN, JOLIET AND EASTERN RAILROAD AS SHOWN ON NORTH SHORE REALTY COMPANY'S LAKE BLUFF SUBDIVISION, RECORDED AS DOCUMENT 281874, LAKE COUNTY, ILLINOIS; THENCE SOUTH 65 DEGREES 16 MINUTES 41 SECONDS WEST (NAD 83) ALONG THE NORTHERLY LINE OF SAID RAILROAD, 2456.68 FEET; THENCE NORTH 11 DEGREES 43 MINUTES 09 SECONDS WEST, 508.94 FEET; THENCE NORTH 12 DEGREES 58 MINUTES 26 SECONDS WEST, 553.92 FEET; THENCE NORTH 13 DEGREES 10 MINUTES 02 SECONDS WEST, 451.95 FEET; THENCE SOUTH 85 DEGREES 23 MINUTES 08 SECONDS WEST, 118.01 FEET; THENCE NORTH 16 DEGREES 23 MINUTES 08 SECONDS WEST, 188.05 FEET; THENCE NORTH 12 DEGREES 25 MINUTES 40 SECONDS WEST, 210.72 FEET; THENCE NORTH 12 DEGREES 27 MINUTES 25 SECONDS WEST, 647.39 FEET; THENCE SOUTH 77 DEGREES 20 MINUTES 24 SECONDS WEST, 102.26 FEET; THENCE NORTH 13 DEGREES 13 MINUTES 02 SECONDS WEST, 140.31 FEET; THENCE NORTH 27 DEGREES 56 MINUTES 08 SECONDS EAST, 9.12 FEET; THENCE NORTH 13 DEGREES 48 MINUTES 49 SECONDS WEST, 732.26 FEET; THENCE NORTH 76 DEGREES 44 MINUTES 04 SECONDS EAST, 1233.33 FEET FOR A POINT OF BEGINNING; THENCE NORTH 02 DEGREES 47 MINUTES 07 SECONDS EAST, 36.51 FEET; THENCE NORTH 37 DEGREES 54 MINUTES 42 SECONDS EAST, 26.61 FEET; THENCE NORTH 60 DEGREES 51 MINUTES 47 SECONDS EAST, 25.58 FEET; THENCE NORTH 76 DEGREES 40 MINUTES 42 SECONDS EAST, 283.77 FEET; THENCE SOUTH 13 DEGREES 18 MINUTES 26 SECONDS EAST, 464.99 FEET; THENCE SOUTH 76 DEGREES 41 MINUTES 34 SECONDS WEST, 337.52 FEET; THENCE NORTH 25 DEGREES 30 MINUTES 13 SECONDS WEST, 11.86 FEET; THENCE NORTH 13 DEGREES 11 MINUTES 40 SECONDS WEST, 394.60 FEET TO THE POINT OF BEGINNING.

## EXCEPTION NO. 4 ([NEW] FORRESTAL SCHOOL PARCEL)



# UNOFFICIAL COPY

COMMENCING AT A 4-1/2" CAST IRON PIPE (FILLED WITH CONCRETE) FOUND AT THE INTERSECTION OF THE WESTERLY LINE OF GREEN BAY ROAD WITH THE NORTHERLY LINE OF THE ELGIN, JOLIET AND EASTERN RAILROAD AS SHOWN ON NORTH SHORE REALTY COMPANY'S LAKE BLUFF SUBDIVISION, RECORDED AS DOCUMENT 281874, LAKE COUNTY, ILLINOIS; THENCE SOUTH 65 DEGREES 16 MINUTES 41 SECONDS WEST (NAD 83) ALONG THE NORTHERLY LINE OF SAID RAILROAD, 2456.68 FEET; THENCE NORTH 11 DEGREES 43 MINUTES 09 SECONDS WEST, 508.94 FEET; THENCE NORTH 12 DEGREES 58 MINUTES 26 SECONDS WEST, 553.92 FEET; THENCE NORTH 13 DEGREES 10 MINUTES 02 SECONDS WEST, 451.95 FEET; THENCE SOUTH 85 DEGREES 23 MINUTES 08 SECONDS WEST, 118.01 FEET; THENCE NORTH 16 DEGREES 23 MINUTES 08 SECONDS WEST, 188.05 FEET; THENCE NORTH 12 DEGREES 25 MINUTES 40 SECONDS WEST, 210.72 FEET; THENCE NORTH 12 DEGREES 27 MINUTES 25 SECONDS WEST, 647.39 FEET; THENCE SOUTH 77 DEGREES 20 MINUTES 24 SECONDS WEST, 102.26 FEET; THENCE NORTH 13 DEGREES 13 MINUTES 02 SECONDS WEST, 140.31 FEET; THENCE NORTH 27 DEGREES 56 MINUTES 08 SECONDS EAST, 9.12 FEET; THENCE NORTH 13 DEGREES 48 MINUTES 49 SECONDS WEST, 732.26 FEET; THENCE NORTH 21 DEGREES 26 MINUTES 30 SECONDS WEST, 33.19 FEET; THENCE NORTH 23 DEGREES 42 MINUTES 02 SECONDS WEST, 77.74 FEET; THENCE NORTH 13 DEGREES 16 MINUTES 07 SECONDS WEST, 158.31 FEET; THENCE NORTH 31 DEGREES 38 MINUTES 41 SECONDS EAST, 25.21 FEET; THENCE NORTH 13 DEGREES 10 MINUTES 02 SECONDS WEST, 278.70 FEET; THENCE NORTH 76 DEGREES 49 MINUTES 58 SECONDS EAST, AT RIGHT ANGLES TO THE LAST DESCRIBED COURSE, 1230.47 FEET FOR A POINT OF BEGINNING; THENCE NORTH 12 DEGREES 59 MINUTES 48 SECONDS WEST, 225.79 FEET; THENCE NORTH 07 DEGREES 10 MINUTES 48 SECONDS WEST, 97.95 FEET; THENCE NORTH 76 DEGREES 47 MINUTES 12 SECONDS EAST, 373.72 FEET; THENCE SOUTH 13 DEGREES 09 MINUTES 48 SECONDS EAST, 323.03 FEET; THENCE SOUTH 76 DEGREES 43 MINUTES 12 SECONDS WEST, 42.44 FEET; THENCE SOUTH 13 DEGREES 10 MINUTES 48 SECONDS EAST, 459.71 FEET; THENCE SOUTH 76 DEGREES 45 MINUTES 12 SECONDS WEST, 158.09 FEET; THENCE NORTH 13 DEGREES 10 MINUTES 48 SECONDS WEST, 78.63 FEET; THENCE SOUTH 76 DEGREES 49 MINUTES 12 SECONDS WEST, 163.13 FEET; THENCE NORTH 12 DEGREES 45 MINUTES 02 SECONDS WEST, 381.06 FEET; THENCE SOUTH 76 DEGREES 35 MINUTES 12 SECONDS WEST, 23.78 FEET TO THE POINT OF BEGINNING.

EXCEPTION NO. 5 (RAILROAD PORTION)

# UNOFFICIAL COPY

THAT PART OF THE NORTHWEST QUARTER OF THE SOUTHWEST QUARTER OF SECTION 17, TOWNSHIP 44 NORTH, RANGE 12 EAST OF THE THIRD PRINCIPAL MERIDIAN LYING NORTHERLY OF THE NORTHERLY LINE OF THE E, J & E RAILWAY.

## EXCEPTION NO. 6 (W.I.C. PARCEL)

COMMENCING AT A 4-1/2" CAST IRON PIPE (FILLED WITH CONCRETE) FOUND AT THE INTERSECTION OF THE WESTERLY LINE OF GREEN BAY ROAD WITH THE NORTHERLY LINE OF THE ELGIN, JOLIET AND EASTERN RAILROAD AS SHOWN ON NORTH SHORE REALTY COMPANY'S LAKE BLUFF SUBDIVISION, RECORDED AS DOCUMENT 281874, LAKE COUNTY, ILLINOIS; THENCE SOUTH 65 DEGREES 16 MINUTES 41 SECONDS WEST (NAD 83) ALONG THE NORTHERLY LINE OF SAID RAILROAD, 2456.68 FEET; THENCE NORTH 11 DEGREES 43 MINUTES 09 SECONDS WEST, 508.94 FEET; THENCE NORTH 12 DEGREES 58 MINUTES 26 SECONDS WEST, 553.92 FEET; THENCE NORTH 13 DEGREES 10 MINUTES 02 SECONDS WEST, 451.95 FEET; THENCE SOUTH 85 DEGREES 23 MINUTES 08 SECONDS WEST, 118.01 FEET; THENCE NORTH 16 DEGREES 23 MINUTES 08 SECONDS WEST, 188.05 FEET; THENCE NORTH 12 DEGREES 25 MINUTES 40 SECONDS WEST, 58.65 FEET; THENCE NORTH 77 DEGREES 34 MINUTES 20 SECONDS EAST, AT RIGHT ANGLES TO THE LAST DESCRIBED COURSE, 660.95 FEET FOR A POINT OF BEGINNING; THENCE NORTH 13 DEGREES 08 MINUTES 23 SECONDS WEST, 230.33 FEET; THENCE NORTH 76 DEGREES 44 MINUTES 52 SECONDS EAST, 110.50 FEET; THENCE SOUTH 13 DEGREES 09 MINUTES 23 SECONDS EAST, 230.33 FEET; THENCE SOUTH 76 DEGREES 44 MINUTES 52 SECONDS WEST, 110.50 FEET TO THE POINT OF BEGINNING.

## EXCEPTION NO. 7 (WATER TOWER PARCEL)

COMMENCING AT A 4-1/2" CAST IRON PIPE (FILLED WITH CONCRETE) FOUND AT THE INTERSECTION OF THE WESTERLY LINE OF GREEN BAY ROAD WITH THE NORTHERLY LINE OF THE ELGIN, JOLIET AND EASTERN RAILROAD AS SHOWN ON NORTH SHORE REALTY COMPANY'S LAKE BLUFF SUBDIVISION, RECORDED AS DOCUMENT 281874, LAKE COUNTY, ILLINOIS; THENCE SOUTH 65 DEGREES 16 MINUTES 41 SECONDS WEST (NAD 83) ALONG THE NORTHERLY LINE OF SAID RAILROAD, 2456.68 FEET; THENCE NORTH 11 DEGREES 43 MINUTES 09 SECONDS WEST, 508.94 FEET; THENCE NORTH 12 DEGREES 58 MINUTES 26 SECONDS WEST, 553.92 FEET; THENCE NORTH 13 DEGREES 10 MINUTES 02 SECONDS WEST, 451.95 FEET; THENCE SOUTH 85 DEGREES 23 MINUTES 08 SECONDS WEST, 118.01 FEET; THENCE NORTH 16 DEGREES 23 MINUTES 08 SECONDS WEST, 188.05 FEET; THENCE NORTH 12 DEGREES

# UNOFFICIAL COPY

25 MINUTES 40 SECONDS WEST, 210.72 FEET; THENCE NORTH 12 DEGREES 27 MINUTES 25 SECONDS WEST, 647.39 FEET; THENCE SOUTH 77 DEGREES 20 MINUTES 24 SECONDS WEST, 102.26 FEET; THENCE NORTH 13 DEGREES 13 MINUTES 02 SECONDS WEST, 140.31 FEET; THENCE NORTH 27 DEGREES 56 MINUTES 08 SECONDS EAST, 9.12 FEET; THENCE NORTH 13 DEGREES 48 MINUTES 49 SECONDS WEST, 732.26 FEET; THENCE NORTH 21 DEGREES 26 MINUTES 30 SECONDS WEST, 33.19 FEET; THENCE NORTH 23 DEGREES 42 MINUTES 02 SECONDS WEST, 77.74 FEET; THENCE NORTH 13 DEGREES 16 MINUTES 07 SECONDS WEST, 158.31 FEET; THENCE NORTH 31 DEGREES 38 MINUTES 41 SECONDS EAST, 25.21 FEET; THENCE NORTH 13 DEGREES 10 MINUTES 02 SECONDS WEST, 477.18 FEET; THENCE NORTH 18 DEGREES 05 MINUTES 36 SECONDS WEST, 203.38 FEET; THENCE NORTH 13 DEGREES 13 MINUTES 52 SECONDS WEST, 246.47 FEET; THENCE NORTH 12 DEGREES 13 MINUTES 57 SECONDS WEST, 346.28 FEET; THENCE NORTH 08 DEGREES 51 MINUTES 43 SECONDS WEST, 57.54 FEET; THENCE NORTH 02 DEGREES 40 MINUTES 43 SECONDS WEST, 465.96 FEET; THENCE NORTH 64 DEGREES 06 MINUTES 45 SECONDS WEST, 49.25 FEET; THENCE NORTH 50 DEGREES 27 MINUTES 27 SECONDS WEST, 82.33 FEET; THENCE NORTH 37 DEGREES 07 MINUTES 13 SECONDS WEST, 41.81 FEET; THENCE NORTH 23 DEGREES 39 MINUTES 52 SECONDS WEST, 59.26 FEET; THENCE NORTH 15 DEGREES 13 MINUTES 47 SECONDS WEST, 47.25 FEET; THENCE NORTH 09 DEGREES 21 MINUTES 43 SECONDS WEST, 39.17 FEET; THENCE NORTH 00 DEGREES 08 MINUTES 32 SECONDS EAST, 125.59 FEET; THENCE NORTH 00 DEGREES 22 MINUTES 38 SECONDS EAST, 668.97 FEET; THENCE NORTH 38 DEGREES 48 MINUTES 35 SECONDS EAST, 41.96 FEET; THENCE NORTH 02 DEGREES 03 MINUTES 56 SECONDS EAST, 71.69 FEET; THENCE NORTH 24 DEGREES 08 MINUTES 17 SECONDS EAST, 107.91 FEET; THENCE NORTH 14 DEGREES 11 MINUTES 47 SECONDS WEST, 65.81 FEET; THENCE NORTH 24 DEGREES 41 MINUTES 13 SECONDS WEST, 135.42 FEET TO THE SOUTH LINE OF BUCKLEY ROAD (ALSO KNOWN AS ILLINOIS ROUTE 137) AS MONUMENTED; SAID LINE BEING 50.00 FEET SOUTH OF AND PARALLEL WITH THE CENTERLINE OF BUCKLEY ROAD; THENCE SOUTH 89 DEGREES 41 MINUTES 49 SECONDS EAST, ALONG SAID LINE, 147.14 FEET; THENCE SOUTH 01 DEGREES 13 MINUTES 26 SECONDS WEST, 556.34 FEET; THENCE SOUTH 13 DEGREES 09 MINUTES 46 SECONDS EAST, 231.44 FEET; THENCE NORTH 89 DEGREES 02 MINUTES 09 SECONDS WEST, 35.89 FEET; THENCE SOUTH 17 DEGREES 02 MINUTES 16 SECONDS EAST, 78.91 FEET; THENCE SOUTH 24 DEGREES 32 MINUTES 16 SECONDS EAST, 60.77 FEET; THENCE SOUTH 31 DEGREES 02 MINUTES 17 SECONDS EAST, 49.51 FEET; THENCE SOUTH 30 DEGREES 28 MINUTES 53 SECONDS EAST, 121.79 FEET; THENCE SOUTH 89 DEGREES 45 MINUTES 28 SECONDS EAST, 476.21 FEET; THENCE SOUTH 03 DEGREES 12 MINUTES 46 SECONDS EAST, 379.11 FEET; THENCE SOUTH 89 DEGREES 41 MINUTES

# UNOFFICIAL COPY

16 SECONDS EAST, 178.02 FEET; THENCE NORTH 00 DEGREES 16 MINUTES 19 SECONDS EAST, 1421.22 FEET TO THE SOUTHERLY LINE OF BUCKLEY ROAD (ALSO KNOWN AS ILLINOIS ROUTE 137); THENCE SOUTH 89 DEGREES 41 MINUTES 49 SECONDS EAST ALONG SAID SOUTHERLY LINE, 551.96 FEET; THENCE SOUTH 00 DEGREES 18 MINUTES 16 SECONDS WEST, 504.05 FEET; THENCE SOUTH 89 DEGREES 54 MINUTES 42 SECONDS EAST, 322.19 FEET; THENCE NORTH 00 DEGREES 14 MINUTES 15 SECONDS EAST, 379.94 FEET; THENCE SOUTH 89 DEGREES 41 MINUTES 49 SECONDS EAST, 1.81 FEET TO THE SOUTHWESTERLY CORNER OF GEORGIA STREET AS DEDICATED; THENCE SOUTH 89 DEGREES 41 MINUTES 49 SECONDS EAST ALONG THE SOUTHERLY LINE OF GEORGIA STREET AS DEDICATED, 74.50 FEET TO THE SOUTHEASTERLY CORNER THEREOF; THENCE NORTH 00 DEGREES 18 MINUTES 17 SECONDS EAST, ALONG THE EASTERLY LINE OF SAID GEORGIA STREET, 70.00 FEET; THENCE NORTH 35 DEGREES 25 MINUTES 07 SECONDS EAST, ALONG SAID LINE, 64.67 FEET TO THE SOUTHERLY LINE OF BUCKLEY ROAD (ALSO KNOWN AS ILLINOIS ROUTE 137); THENCE SOUTH 89 DEGREES 41 MINUTES 49 SECONDS EAST ALONG SAID LINE, 545.00 FEET TO AN ANGLE POINT IN SAID LINE; THENCE SOUTH 83 DEGREES 59 MINUTES 10 SECONDS EAST ALONG SAID LINE, 150.75 FEET TO AN ANGLE POINT IN SAID LINE; THENCE SOUTH 73 DEGREES 18 MINUTES 26 SECONDS EAST ALONG SAID LINE, 88.60 FEET TO AN ANGLE POINT IN SAID LINE; THENCE SOUTH 43 DEGREES 02 MINUTES 30 SECONDS EAST, 69.75 FEET TO THE WESTERLY LINE OF GREEN BAY ROAD (ALSO KNOWN AS ILLINOIS ROUTE 131); THENCE SOUTH 10 DEGREES 13 MINUTES 49 SECONDS EAST, ALONG SAID LINE, 134.23 FEET TO A POINT OF CURVATURE; THENCE SOUTHEASTERLY ALONG SAID LINE, BEING A CURVE CONCAVE WESTERLY, HAVING A RADIUS 10701.23 FEET, A CHORD BEARING OF SOUTH 10 DEGREES 02 MINUTES 29 SECONDS EAST, A CHORD LENGTH OF 57.43 FEET, AN ARC LENGTH OF 57.43 FEET TO THE POINT OF BEGINNING; THENCE CONTINUING SOUTHEASTERLY ALONG SAID LINE, BEING A CURVE CONCAVE WESTERLY, HAVING A RADIUS 10701.23 FEET, A CHORD BEARING OF SOUTH 09 DEGREES 26 MINUTES 38 SECONDS EAST, A CHORD LENGTH OF 165.74 FEET, AN ARC LENGTH OF 165.74 FEET; THENCE SOUTH 79 DEGREES 53 MINUTES 54 SECONDS WEST, 155.02 FEET; THENCE NORTH 10 DEGREES 49 MINUTES 03 SECONDS WEST, 110.32 FEET; THENCE NORTH 81 DEGREES 32 MINUTES 40 SECONDS EAST, 24.93 FEET; THENCE NORTH 00 DEGREES 07 MINUTES 27 SECONDS EAST, 71.47 FEET; THENCE NORTH 86 DEGREES 36 MINUTES 36 SECONDS EAST, 121.52 FEET; TO THE POINT OF BEGINNING; IN LAKE COUNTY, ILLINOIS.

EXCEPTION PARCEL A

# UNOFFICIAL COPY

THAT PART OF THE NORTHWEST QUARTER OF SECTION 17, TOWNSHIP 44 NORTH, RANGE 12 EAST OF THE THIRD PRINCIPAL MERIDIAN, DESCRIBED AS FOLLOWS:

BEGINNING AT A 4-1/2" CAST IRON PIPE (FILLED WITH CONCRETE) FOUND AT THE INTERSECTION OF THE WESTERLY LINE OF GREEN BAY ROAD WITH THE NORTHERLY LINE OF THE ELGIN, JOLIET AND EASTERN RAILROAD AS SHOWN ON NORTH SHORE REALTY COMPANY'S LAKE BLUFF SUBDIVISION, RECORDED AS DOCUMENT 281874, LAKE COUNTY, ILLINOIS; THENCE SOUTH 65 DEGREES 16 MINUTES 41 SECONDS WEST (NAD 83) ALONG THE NORTHERLY LINE OF SAID RAILROAD, 250.00 FEET; THENCE NORTH 13 DEGREES 16 MINUTES 01 SECOND WEST, 82.13 FEET; THENCE NORTH 76 DEGREES 43 MINUTES 59 SECONDS EAST, 247.42 FEET TO THE WESTERLY LINE OF SAID GREEN BAY ROAD; THENCE SOUTH 09 DEGREES 02 MINUTES 39 SECONDS EAST, 32.57 FEET TO THE POINT OF BEGINNING: ALL IN LAKE COUNTY, ILLINOIS.

EXCEPTION PARCEL B

THAT PART OF THE SOUTHEAST QUARTER OF SECTION 7, TOWNSHIP 44 NORTH, RANGE 12 EAST OF THE THIRD PRINCIPAL MERIDIAN, DESCRIBED AS FOLLOWS:

COMMENCING AT A 4-1/2" CAST IRON PIPE (FILLED WITH CONCRETE) FOUND AT THE INTERSECTION OF THE WESTERLY LINE OF GREEN BAY ROAD WITH THE NORTHERLY LINE OF THE ELGIN, JOLIET AND EASTERN RAILROAD AS SHOWN ON NORTH SHORE REALTY COMPANY'S LAKE BLUFF SUBDIVISION, RECORDED AS DOCUMENT 281874, LAKE COUNTY, ILLINOIS; THENCE SOUTH 65 DEGREES 16 MINUTES 41 SECONDS WEST (NAD 83) ALONG THE NORTHERLY LINE OF SAID RAILROAD, 2456.68 FEET; THENCE NORTH 11 DEGREES 43 MINUTES 09 SECONDS WEST, 508.94 FEET; THENCE NORTH 12 DEGREES 58 MINUTES 26 SECONDS WEST, 553.92 FEET; THENCE NORTH 13 DEGREES 10 MINUTES 02 SECONDS WEST, 451.95 FEET; THENCE SOUTH 85 DEGREES 23 MINUTES 08 SECONDS WEST, 118.01 FEET; THENCE NORTH 16 DEGREES 23 MINUTES 08 SECONDS WEST, 188.05 FEET; THENCE NORTH 12 DEGREES 25 MINUTES 40 SECONDS WEST, 210.72 FEET; THENCE NORTH 12 DEGREES 27 MINUTES 25 SECONDS WEST, 647.39 FEET; THENCE SOUTH 77 DEGREES 20 MINUTES 24 SECONDS WEST, 102.26 FEET; THENCE NORTH 13 DEGREES 13 MINUTES 02 SECONDS WEST, 140.31 FEET; THENCE NORTH 27 DEGREES 56 MINUTES 08 SECONDS EAST, 9.12 FEET; THENCE NORTH 13 DEGREES 48 MINUTES 49 SECONDS WEST, 732.26 FEET; THENCE NORTH 21 DEGREES 26 MINUTES 30 SECONDS WEST, 33.19 FEET; THENCE NORTH 23 DEGREES 42 MINUTES 02 SECONDS WEST, 77.74 FEET; THENCE NORTH 13 DEGREES 16 MINUTES 07

# UNOFFICIAL COPY

SECONDS WEST, 158.31 FEET; THENCE NORTH 31 DEGREES 38 MINUTES 41 SECONDS EAST, 25.21 FEET; THENCE NORTH 13 DEGREES 10 MINUTES 02 SECONDS WEST, 477.18 FEET; THENCE NORTH 18 DEGREES 05 MINUTES 36 SECONDS WEST, 203.38 FEET; THENCE NORTH 13 DEGREES 13 MINUTES 52 SECONDS WEST, 246.47 FEET; THENCE NORTH 12 DEGREES 46 MINUTES 57 SECONDS WEST, 346.28 FEET; THENCE NORTH 08 DEGREES 51 MINUTES 43 SECONDS WEST, 57.54 FEET; THENCE NORTH 02 DEGREES 40 MINUTES 43 SECONDS WEST, 87.58 FEET; THENCE NORTH 87 DEGREES 19 MINUTES 17 SECONDS EAST, AT RIGHT ANGLES TO THE LAST DESCRIBED COURSE, 218.82 FEET FOR A POINT OF BEGINNING; THENCE NORTH 00 DEGREES 00 MINUTES 00 SECONDS EAST, 15.00 FEET; THENCE SOUTH 90 DEGREES 00 MINUTES 00 SECONDS EAST, AT RIGHT ANGLES TO THE LAST DESCRIBED COURSE, 15.00 FEET; THENCE SOUTH 00 DEGREES 00 MINUTES 00 SECONDS WEST AT RIGHT ANGLES TO THE LAST DESCRIBED COURSE, 15.00 FEET; THENCE NORTH 90 DEGREES 00 MINUTES 00 SECONDS WEST, AT RIGHT ANGLES TO THE LAST DESCRIBED COURSE, 15.00 FEET TO THE POINT OF BEGINNING; ALL IN LAKE COUNTY, ILLINOIS.

## EXCEPTION PARCEL C

THAT PART OF THE SOUTHEAST QUARTER OF SECTION 7, TOWNSHIP 44 NORTH, RANGE 12 EAST OF THE THIRD PRINCIPAL MERIDIAN, DESCRIBED AS FOLLOWS:

COMMENCING AT A 4-1/2" CAST IRON PIPE (FILLED WITH CONCRETE) FOUND AT THE INTERSECTION OF THE WESTERLY LINE OF GREEN BAY ROAD WITH THE NORTHERLY LINE OF THE ELGIN, JOUET AND EASTERN RAILROAD AS SHOWN ON NORTH SHORE REALTY COMPANY'S LAKE BLUFF SUBDIVISION, RECORDED AS DOCUMENT 281874, LAKE COUNTY, ILLINOIS; THENCE SOUTH 65 DEGREES 16 MINUTES 41 SECONDS WEST (NAD 83) ALONG THE NORTHERLY LINE OF SAID RAILROAD, 2456.68 FEET; THENCE NORTH 11 DEGREES 43 MINUTES 09 SECONDS WEST, 508.94 FEET; THENCE NORTH 12 DEGREES 58 MINUTES 26 SECONDS WEST, 553.92 FEET; THENCE NORTH 13 DEGREES 10 MINUTES 02 SECONDS WEST, 451.95 FEET; THENCE SOUTH 85 DEGREES 23 MINUTES 08 SECONDS WEST, 118.01 FEET; THENCE NORTH 16 DEGREES 23 MINUTES 08 SECONDS WEST, 188.05 FEET; THENCE NORTH 12 DEGREES 25 MINUTES 40 SECONDS WEST, 210.72 FEET; THENCE NORTH 12 DEGREES 27 MINUTES 25 SECONDS WEST, 647.39 FEET; THENCE SOUTH 77 DEGREES 20 MINUTES 24 SECONDS WEST, 102.26 FEET; THENCE NORTH 13 DEGREES 13 MINUTES 02 SECONDS WEST, 140.31 FEET; THENCE NORTH 27 DEGREES 56 MINUTES 08 SECONDS EAST, 9.12 FEET; THENCE NORTH 13 DEGREES 48 MINUTES 49 SECONDS WEST, 732.26 FEET; THENCE NORTH 21 DEGREES 26 MINUTES 30 SECONDS WEST,

# UNOFFICIAL COPY

33.19 FEET; THENCE NORTH 23 DEGREES 42 MINUTES 02 SECONDS WEST, 77.74 FEET; THENCE NORTH 13 DEGREES 16 MINUTES 07 SECONDS WEST, 158.31 FEET; THENCE NORTH 31 DEGREES 38 MINUTES 41 SECONDS EAST, 25.21 FEET; THENCE NORTH 13 DEGREES 10 MINUTES 02 SECONDS WEST, 477.18 FEET; THENCE NORTH 18 DEGREES 05 MINUTES 36 SECONDS WEST, 203.38 FEET; THENCE NORTH 13 DEGREES 13 MINUTES 52 SECONDS WEST, 246.47 FEET; THENCE NORTH 12 DEGREES 46 MINUTES 57 SECONDS WEST, 346.28 FEET; THENCE NORTH 08 DEGREES 51 MINUTES 43 SECONDS WEST, 57.54 FEET; THENCE NORTH 02 DEGREES 40 MINUTES 43 SECONDS WEST, 465.96 FEET; THENCE SOUTH 89 DEGREES 01 MINUTES 50 SECONDS EAST, 614.39 FEET; THENCE SOUTH 89 DEGREES 41 MINUTES 16 SECONDS EAST, 175.02 FEET; THENCE NORTH 00 DEGREES 16 MINUTES 19 SECONDS EAST, 130.47 FEET; THENCE SOUTH 89 DEGREES 53 MINUTES 03 SECONDS EAST, 709.62 FEET FOR A POINT OF BEGINNING; THENCE NORTH 00 DEGREES 00 MINUTES 00 SECONDS EAST, 15.00 FEET; THENCE SOUTH 90 DEGREES 00 MINUTES 00 SECONDS EAST, AT RIGHT ANGLES TO THE LAST DESCRIBED COURSE, 15.00 FEET; THENCE SOUTH 00 DEGREES 00 MINUTES 00 SECONDS WEST, AT RIGHT ANGLES TO THE LAST DESCRIBED COURSE, 15.00 FEET; THENCE NORTH 90 DEGREES 00 MINUTES 00 SECONDS WEST, AT RIGHT ANGLES TO THE LAST DESCRIBED COURSE, 15.00 FEET TO THE POINT OF BEGINNING; ALL IN LAKE COUNTY, ILLINOIS.

## EXCEPTION PARCEL D

THAT PART OF THE NORTHEAST QUARTER OF SECTION 7, TOWNSHIP 44 NORTH, RANGE 12 EAST OF THE THIRD PRINCIPAL MERIDIAN, DESCRIBED AS FOLLOWS:

COMMENCING AT A 4-1/2" CAST IRON PIPE (FILLED WITH CONCRETE) FOUND AT THE INTERSECTION OF THE WESTERLY LINE OF GREEN BAY ROAD WITH THE NORTHERLY LINE OF THE ELGIN, JOLIET AND EASTERN RAILROAD AS SHOWN ON NORTH SHORE REALTY COMPANY'S LAKE BLUFF SUBDIVISION, RECORDED AS DOCUMENT 281874, LAKE COUNTY, ILLINOIS; THENCE SOUTH 65 DEGREES 16 MINUTES 41 SECONDS WEST (NAD 83) ALONG THE NORTHERLY LINE OF SAID RAILROAD, 2456.68 FEET; THENCE NORTH 11 DEGREES 43 MINUTES 09 SECONDS WEST, 508.94 FEET; THENCE NORTH 12 DEGREES 58 MINUTES 26 SECONDS WEST, 553.92 FEET; THENCE NORTH 13 DEGREES 10 MINUTES 02 SECONDS WEST, 451.95 FEET; THENCE SOUTH 85 DEGREES 23 MINUTES 08 SECONDS WEST, 118.01 FEET; THENCE NORTH 16 DEGREES 23 MINUTES 08 SECONDS WEST, 188.05 FEET; THENCE NORTH 12 DEGREES 25 MINUTES 40 SECONDS WEST, 210.72 FEET; THENCE NORTH 12 DEGREES 27 MINUTES 25 SECONDS WEST, 647.39 FEET; THENCE SOUTH 77 DEGREES 20 MINUTES 24 SECONDS WEST, 102.26 FEET; THENCE

# UNOFFICIAL COPY

NORTH 13 DEGREES 13 MINUTES 02 SECONDS, WEST, 140.31 FEET;  
 THENCE NORTH 27 DEGREES 56 MINUTES 08 SECONDS EAST, 9.12 FEET;  
 THENCE NORTH 13 DEGREES 48 MINUTES 49 SECONDS WEST, 732.26  
 FEET; THENCE NORTH 21 DEGREES 26 MINUTES 30 SECONDS WEST,  
 33.19 FEET; THENCE NORTH 23 DEGREES 42 MINUTES 02 SECONDS  
 WEST, 77.74 FEET; THENCE NORTH 13 DEGREES 16 MINUTES 07  
 SECONDS WEST, 158.31 FEET; THENCE NORTH 31 DEGREES 38 MINUTES  
 41 SECONDS EAST, 25.21 FEET; THENCE NORTH 13 DEGREES 10  
 MINUTES 02 SECONDS WEST, 477.18 FEET; THENCE NORTH 18 DEGREES  
 05 MINUTES 36 SECONDS WEST, 203.38 FEET; THENCE NORTH 13  
 DEGREES 13 MINUTES 52 SECONDS WEST, 246.47 FEET; THENCE NORTH  
 12 DEGREES 46 MINUTES 57 SECONDS WEST, 346.28 FEET; THENCE  
 NORTH 08 DEGREES 51 MINUTES 43 SECONDS WEST, 57.54 FEET;  
 THENCE NORTH 02 DEGREES 40 MINUTES 43 SECONDS WEST, 465.96  
 FEET; THENCE SOUTH 89 DEGREES 01 MINUTES 50 SECONDS EAST,  
 614.39 FEET; THENCE SOUTH 89 DEGREES 41 MINUTES 16 SECONDS  
 EAST, 178.02 FEET; THENCE NORTH 00 DEGREES 16 MINUTES 19  
 SECONDS EAST, 530.09 FEET; THENCE SOUTH 89 DEGREES 43 MINUTES  
 41 SECONDS EAST, AT RIGHT ANGLES TO THE LAST DESCRIBED  
 COURSE, 58.17 FEET; THENCE SOUTH 00 DEGREES 16 MINUTES 19  
 SECONDS WEST, AT RIGHT ANGLES TO THE LAST DESCRIBED COURSE,  
 17.43 FEET FOR A POINT OF BEGINNING; THENCE CONTINUING SOUTH  
 00 DEGREES 16 MINUTES 19 SECONDS WEST, 15.00 FEET; THENCE  
 NORTH 89 DEGREES 43 MINUTES 41 SECONDS WEST, AT RIGHT ANGLES  
 TO THE LAST DESCRIBED COURSE, 15.00 FEET; THENCE NORTH 00  
 DEGREES 16 MINUTES 19 SECONDS EAST, AT RIGHT ANGLES TO THE  
 LAST DESCRIBED COURSE, 15.00 FEET; THENCE SOUTH 89 DEGREES 43  
 MINUTES 41 SECONDS EAST, AT RIGHT ANGLES TO THE LAST  
 DESCRIBED COURSE, 15.00 FEET TO THE POINT OF BEGINNING, ALL IN  
 LAKE COUNTY, ILLINOIS.

## EXCEPTION PARCEL E

THAT PART OF THE NORTHEAST QUARTER OF SECTION 7, TOWNSHIP 44  
 NORTH, RANGE 12 EAST OF THE THIRD PRINCIPAL MERIDIAN,  
 DESCRIBED AS FOLLOWS:

COMMENCING AT A 4-1/2" CAST IRON PIPE (FILLED WITH CONCRETE)  
 FOUND AT THE INTERSECTION OF THE WESTERLY LINE OF GREEN BAY  
 ROAD WITH THE NORTHERLY LINE OF THE ELGIN, JOLIET AND EASTERN  
 RAILROAD AS SHOWN ON NORTH SHORE REALTY COMPANY'S LAKE  
 BLUFF SUBDIVISION, RECORDED AS DOCUMENT 281874, LAKE COUNTY,  
 ILLINOIS; THENCE SOUTH 65 DEGREES 16 MINUTES 41 SECONDS WEST  
 (NAD 83) ALONG THE NORTHERLY LINE OF SAID RAILROAD, 2456.68  
 FEET; THENCE NORTH 11 DEGREES 43 MINUTES 09 SECONDS WEST,



# UNOFFICIAL COPY

508.94 FEET; THENCE NORTH 12 DEGREES 58 MINUTES 26 SECONDS WEST, 553.92 FEET; THENCE NORTH 13 DEGREES 10 MINUTES 02 SECONDS WEST, 451.95 FEET; THENCE SOUTH 85 DEGREES 23 MINUTES 08 SECONDS WEST, 118.01 FEET; THENCE NORTH 16 DEGREES 23 MINUTES 08 SECONDS WEST, 188.05 FEET; THENCE NORTH 12 DEGREES 25 MINUTES 40 SECONDS WEST, 210.72 FEET; THENCE NORTH 12 DEGREES 27 MINUTES 25 SECONDS WEST, 647.39 FEET; THENCE SOUTH 77 DEGREES 20 MINUTES 24 SECONDS WEST, 102.26 FEET; THENCE NORTH 13 DEGREES 13 MINUTES 02 SECONDS WEST, 140.31 FEET; THENCE NORTH 27 DEGREES 56 MINUTES 08 SECONDS EAST, 9.12 FEET; THENCE NORTH 13 DEGREES 48 MINUTES 49 SECONDS WEST, 732.26 FEET; THENCE NORTH 21 DEGREES 26 MINUTES 30 SECONDS WEST, 33.19 FEET; THENCE NORTH 23 DEGREES 42 MINUTES 02 SECONDS WEST, 77.74 FEET; THENCE NORTH 13 DEGREES 16 MINUTES 07 SECONDS WEST, 158.31 FEET; THENCE NORTH 31 DEGREES 38 MINUTES 41 SECONDS EAST, 25.21 FEET; THENCE NORTH 13 DEGREES 10 MINUTES 02 SECONDS WEST, 477.18 FEET; THENCE NORTH 18 DEGREES 05 MINUTES 36 SECONDS WEST, 203.38 FEET; THENCE NORTH 13 DEGREES 13 MINUTES 52 SECONDS WEST, 246.47 FEET; THENCE NORTH 12 DEGREES 46 MINUTES 57 SECONDS WEST, 346.28 FEET; THENCE NORTH 08 DEGREES 51 MINUTES 43 SECONDS WEST, 57.54 FEET; THENCE NORTH 02 DEGREES 40 MINUTES 43 SECONDS WEST, 465.96 FEET; THENCE SOUTH 89 DEGREES 01 MINUTES 50 SECONDS EAST, 614.39 FEET; THENCE SOUTH 89 DEGREES 41 MINUTES 16 SECONDS EAST, 178.02 FEET; THENCE NORTH 00 DEGREES 16 MINUTES 19 SECONDS EAST, 440.09 FEET FOR A POINT OF BEGINNING; THENCE CONTINUING NORTH 00 DEGREES 16 MINUTES 19 SECONDS EAST, 90.00 FEET; THENCE SOUTH 89 DEGREES 43 MINUTES 41 SECONDS EAST, AT RIGHT ANGLES TO THE LAST DESCRIBED COURSE, 20.00 FEET; THENCE SOUTH 00 DEGREES 16 MINUTES 19 SECONDS WEST, AT RIGHT ANGLES TO THE LAST DESCRIBED COURSE, 90.00 FEET; THENCE NORTH 89 DEGREES 43 MINUTES 41 SECONDS WEST, AT RIGHT ANGLES TO THE LAST DESCRIBED COURSE, 20.00 FEET TO THE POINT OF BEGINNING; ALL IN LAKE COUNTY, ILLINOIS.

## EXCEPTION PARCEL F

THAT PART OF THE EAST HALF OF SECTION 7, TOWNSHIP 44 NORTH, RANGE 12 EAST OF THE THIRD PRINCIPAL MERIDIAN, DESCRIBED AS FOLLOWS:

COMMENCING AT A 4-1/2" CAST IRON PIPE (FILLED WITH CONCRETE) FOUND AT THE INTERSECTION OF THE WESTERLY LINE OF GREEN BAY ROAD WITH THE NORTHERLY LINE OF THE ELGIN, JOLIET AND EASTERN RAILROAD AS SHOWN ON NORTH SHORE REALTY COMPANY'S LAKE

# UNOFFICIAL COPY

BLUFF SUBDIVISION, RECORDED AS DOCUMENT 281874, LAKE COUNTY, ILLINOIS; THENCE SOUTH 65 DEGREES 16 MINUTES 41 SECONDS WEST (NAD 83) ALONG THE NORTHERLY LINE OF SAID RAILROAD, 2456.68 FEET; THENCE NORTH 11 DEGREES 43 MINUTES 09 SECONDS WEST, 508.94 FEET; THENCE NORTH 12 DEGREES 58 MINUTES 26 SECONDS WEST, 553.92 FEET; THENCE NORTH 13 DEGREES 10 MINUTES 02 SECONDS WEST, 451.95 FEET; THENCE SOUTH 85 DEGREES 23 MINUTES 08 SECONDS WEST, 118.01 FEET; THENCE NORTH 16 DEGREES 23 MINUTES 08 SECONDS WEST, 188.05 FEET; THENCE NORTH 12 DEGREES 25 MINUTES 40 SECONDS WEST, 210.72 FEET; THENCE NORTH 12 DEGREES 27 MINUTES 25 SECONDS WEST, 647.39 FEET; THENCE SOUTH 77 DEGREES 20 MINUTES 24 SECONDS WEST, 102.26 FEET; THENCE NORTH 13 DEGREES 13 MINUTES 02 SECONDS WEST, 140.31 FEET; THENCE NORTH 27 DEGREES 56 MINUTES 08 SECONDS EAST, 9.12 FEET; THENCE NORTH 13 DEGREES 48 MINUTES 49 SECONDS WEST, 732.26 FEET; THENCE NORTH 21 DEGREES 26 MINUTES 30 SECONDS WEST, 33.19 FEET; THENCE NORTH 23 DEGREES 42 MINUTES 02 SECONDS WEST, 77.74 FEET; THENCE NORTH 13 DEGREES 16 MINUTES 07 SECONDS WEST, 158.31 FEET; THENCE NORTH 31 DEGREES 38 MINUTES 41 SECONDS EAST, 25.21 FEET; THENCE NORTH 13 DEGREES 10 MINUTES 02 SECONDS WEST, 477.18 FEET; THENCE NORTH 18 DEGREES 05 MINUTES 36 SECONDS WEST, 203.38 FEET; THENCE NORTH 13 DEGREES 13 MINUTES 52 SECONDS WEST, 246.47 FEET; THENCE NORTH 12 DEGREES 46 MINUTES 57 SECONDS WEST, 346.28 FEET; THENCE NORTH 08 DEGREES 51 MINUTES 43 SECONDS WEST, 57.54 FEET; THENCE NORTH 02 DEGREES 40 MINUTES 43 SECONDS WEST, 465.96 FEET FOR A POINT OF BEGINNING; THENCE NORTH 64 DEGREES 06 MINUTES 45 SECONDS WEST, 49.25 FEET; THENCE NORTH 50 DEGREES 27 MINUTES 27 SECONDS WEST, 82.33 FEET; THENCE NORTH 37 DEGREES 07 MINUTES 13 SECONDS WEST, 41.81 FEET; THENCE NORTH 23 DEGREES 39 MINUTES 52 SECONDS WEST, 59.26 FEET; THENCE NORTH 15 DEGREES 13 MINUTES 47 SECONDS WEST, 47.25 FEET; THENCE NORTH 09 DEGREES 21 MINUTES 43 SECONDS WEST, 39.17 FEET; THENCE NORTH 00 DEGREES 08 MINUTES 32 SECONDS EAST, 125.59 FEET; THENCE NORTH 00 DEGREES 22 MINUTES 38 SECONDS EAST, 668.97 FEET; THENCE NORTH 38 DEGREES 48 MINUTES 33 SECONDS EAST, 41.96 FEET; THENCE NORTH 02 DEGREES 03 MINUTES 56 SECONDS EAST, 71.69 FEET; THENCE NORTH 24 DEGREES 08 MINUTES 47 SECONDS EAST, 107.91 FEET; THENCE NORTH 14 DEGREES 11 MINUTES 47 SECONDS WEST, 65.81 FEET; THENCE NORTH 24 DEGREES 41 MINUTES 13 SECONDS WEST, 135.42 FEET TO THE SOUTH LINE OF BUCKLEY ROAD (ALSO KNOWN AS ILLINOIS ROUTE 137) AS MONUMENTED; SAID LINE BEING 50.00 FEET SOUTH OF AND PARALLEL WITH THE CENTERLINE OF BUCKLEY ROAD; THENCE SOUTH 89 DEGREES 41 MINUTES 49 SECONDS EAST, ALONG SAID LINE, 147.14 FEET; THENCE SOUTH 01 DEGREE 15 MINUTES 26 SECONDS WEST,

# UNOFFICIAL COPY

556.34 FEET; THENCE SOUTH 13 DEGREES 09 MINUTES 46 SECONDS EAST, 231.44 FEET; THENCE NORTH 89 DEGREES 02 MINUTES 09 SECONDS WEST, 35.89 FEET; THENCE SOUTH 17 DEGREES 02 MINUTES 16 SECONDS EAST, 78.91 FEET; THENCE SOUTH 24 DEGREES 32 MINUTES 16 SECONDS EAST, 60.77 FEET; THENCE SOUTH 31 DEGREES 02 MINUTES 17 SECONDS EAST, 49.51 FEET; THENCE SOUTH 30 DEGREES 28 MINUTES 53 SECONDS EAST, 121.79 FEET; THENCE SOUTH 89 DEGREES 45 MINUTES 28 SECONDS EAST, 476.21 FEET; THENCE SOUTH 03 DEGREES 12 MINUTES 46 SECONDS EAST, 379.11 FEET; THENCE NORTH 89 DEGREES 01 MINUTE 50 SECONDS WEST, 614.39 FEET TO THE POINT OF BEGINNING; ALL IN LAKE COUNTY, ILLINOIS.

Property of Cook County Clerk's Office

# UNOFFICIAL COPY

G:\P\data\9000\9100\9100.03 - Fort Sheridan\9100.03-9 LTS\Legal Descriptions\08-24-07 Legal Description-development parcel.doc

THAT PART OF THE SOUTH HALF OF FRACTIONAL SECTION 11, AND THE NORTH HALF OF FRACTIONAL SECTION 14, ALL IN TOWNSHIP 43 NORTH, RANGE 12 EAST OF THE THIRD PRINCIPAL MERIDIAN, IN LAKE COUNTY, ILLINOIS, AND MORE PARTICULARLY DESCRIBED WITH BEARINGS BEING REFERENCED TO THE ILLINOIS STATE PLANE COORDINATE SYSTEM, EAST ZONE (NAD 27), AS FOLLOWS: COMMENCING AT A 6-INCH SQUARE CAST IRON MONUMENT, MARKING THE WEST QUARTER CORNER OF SECTION 14, TOWNSHIP 43 NORTH, RANGE 12 EAST OF THE THIRD PRINCIPAL MERIDIAN; THENCE NORTH 35 DEGREES 24 MINUTES 48 SECONDS EAST 69.09 FEET TO A 5/8 INCH IRON ROD AND PLASTIC CAP MARKING THE INTERSECTION OF THE NORTH RIGHT-OF-WAY LINE OF WALKER AVENUE WITH THE EAST RIGHT-OF-WAY LINE OF LAKEVIEW AVENUE; THENCE WITH THE NORTH RIGHT-OF-WAY LINE OF WALKER AVENUE NORTH 89 DEGREES 46 MINUTES 36 SECONDS EAST 1021.57 FEET, MORE OR LESS, TO AN ALUMINUM CORPS OF ENGINEERS (COE) MONUMENT, STAMPED "FS-5-6A", SAID MONUMENT BEING THE POINT OF BEGINNING; THENCE NORTH 10 DEGREES 28 MINUTES 17 SECONDS WEST 319.13 FEET TO AN ALUMINUM COE MONUMENT, STAMPED "A-1"; THENCE NORTH 37 DEGREES 22 MINUTES 04 SECONDS WEST 410.20 FEET TO AN ALUMINUM COE MONUMENT, STAMPED "A-2", ON THE NORTH SIDE OF TENTH STREET; THENCE NORTH 17 DEGREES 54 MINUTES 40 SECONDS WEST 567.94 FEET, PASSING A STANDARD COE (TYPE III) BRASS DISC, STAMPED "A-2-1" AT 348.02 FEET, TO AN ALUMINUM COE MONUMENT, STAMPED "A-3"; THENCE NORTH 19 DEGREES 58 MINUTES 50 SECONDS WEST 336.09 FEET TO AN ALUMINUM COE MONUMENT, STAMPED "A-4", ON THE NORTH SIDE OF EIGHTH STREET; THENCE NORTH 20 DEGREES 03 MINUTES 51 SECONDS WEST 167.02 FEET TO AN ALUMINUM COE MONUMENT, STAMPED "A-5"; THENCE NORTH 21 DEGREES 31 MINUTES 22 SECONDS WEST 586.47 FEET TO AN ALUMINUM COE MONUMENT, STAMPED "A-6", ON THE NORTH SIDE OF THIRD STREET; THENCE ALONG THE NORTH SIDE OF THIRD STREET NORTH 61 DEGREES 18 MINUTES 14 SECONDS EAST 196.26 FEET TO AN ALUMINUM COE MONUMENT, STAMPED "A-7"; THENCE LEAVING THIRD STREET NORTH 21 DEGREES 21 MINUTES 51 SECONDS WEST 361.09 FEET TO A STANDARD COE (TYPE III) BRASS DISC STAMPED "A-8", SET IN CONCRETE ON THE NORTH SIDE OF SECOND STREET; THENCE ALONG THE NORTH SIDE OF SECOND STREET AND THE NORTHEASTERLY EXTENSION THEREOF, NORTH 68 DEGREES 33 MINUTES 58 SECONDS EAST, 442.18 FEET; THENCE SOUTH 05 DEGREES 52 MINUTES 54 SECONDS WEST, 90.11 FEET; THENCE SOUTH 40 DEGREES 56 MINUTES 45 SECONDS WEST, 90.74 FEET; THENCE SOUTH 21 DEGREES 04 MINUTES 31 SECONDS EAST, 184.59 FEET; THENCE NORTH 63 DEGREES 26 MINUTES 58 SECONDS EAST, 262.75 FEET; THENCE NORTH 20 DEGREES 17 MINUTES 06 SECONDS EAST, 121.04 FEET; THENCE NORTH 31 DEGREES 05 MINUTES 36 SECONDS EAST, 167.74 FEET; THENCE NORTH 24 DEGREES 32 MINUTES 03 SECONDS EAST, 336.90 FEET; THENCE SOUTH 17 DEGREES 20 MINUTES 09 SECONDS EAST, 385.25 FEET; THENCE SOUTH 21 DEGREES 06 MINUTES 41

# UNOFFICIAL COPY

SECONDS EAST, 214.52 FEET; THENCE SOUTH 85 DEGREES 13 MINUTES 43 SECONDS WEST, 119.08 FEET; THENCE SOUTH 03 DEGREES 51 MINUTES 24 SECONDS WEST, 63.56 FEET; THENCE SOUTHWESTERLY ALONG A CURVE CONCAVE WESTERLY, NOT TANGENT TO THE LAST DESCRIBED COURSE, HAVING A RADIUS OF 406.19 FEET, A CHORD BEARING OF SOUTH 02 DEGREES 43 MINUTES 08 SECONDS WEST, A CHORD LENGTH OF 352.49 FEET, AN ARC LENGTH OF 364.61 FEET; THENCE SOUTH 07 DEGREES 33 MINUTES 33 SECONDS EAST, NOT TANGENT TO THE LAST DESCRIBED COURSE, 103.12 FEET; THENCE SOUTHERLY ALONG A CURVE CONCAVE SOUTHWESTERLY, NOT TANGENT TO THE LAST DESCRIBED COURSE, HAVING A RADIUS OF 227.50 FEET, A CHORD BEARING OF SOUTH 12 DEGREES 46 MINUTES 39 SECONDS EAST, A CHORD LENGTH OF 140.38 FEET, AN ARC LENGTH OF 142.71 FEET TO A POINT OF COMPOUND CURVATURE; THENCE SOUTHERLY AND SOUTHWESTERLY ALONG A CURVE CONCAVE NORTHWESTERLY, TANGENT TO THE LAST DESCRIBED COURSE, HAVING A RADIUS OF 402.50 FEET, A CHORD BEARING OF SOUTH 22 DEGREES 22 MINUTES 05 SECONDS WEST, A CHORD LENGTH OF 237.70 FEET, AN ARC LENGTH OF 241.30 FEET; THENCE SOUTH 13 DEGREES 48 MINUTES 24 SECONDS WEST, NOT TANGENT TO THE LAST DESCRIBED COURSE, 39.14 FEET; THENCE SOUTH 44 DEGREES 29 MINUTES 00 SECONDS WEST, 164.86 FEET; THENCE SOUTH 10 DEGREES 29 MINUTES 12 SECONDS EAST, 78.75 FEET; THENCE SOUTHEASTERLY, SOUTHERLY AND SOUTHWESTERLY ALONG A CURVE CONCAVE, SOUTHWESTERLY, NOT TANGENT TO THE LAST DESCRIBED COURSE, HAVING A RADIUS OF 61.50 FEET, A CHORD BEARING OF SOUTH 14 DEGREES 16 MINUTES 19 SECONDS EAST, A CHORD LENGTH OF 100.85 FEET, AN ARC LENGTH OF 118.24 FEET; THENCE SOUTH 21 DEGREES 01 MINUTE 48 SECONDS EAST, 376.51 FEET; THENCE NORTH 65 DEGREES 54 MINUTES 22 SECONDS EAST, 182.64 FEET; THENCE NORTH 31 DEGREES 23 MINUTES 36 SECONDS EAST, 180.93 FEET; THENCE NORTH 19 DEGREES 17 MINUTES 26 SECONDS EAST, 173.61 FEET; THENCE NORTH 17 DEGREES 21 MINUTES 49 SECONDS WEST, 61.59 FEET; THENCE NORTH 28 DEGREES 29 MINUTES 24 SECONDS EAST, 395.57 FEET; THENCE SOUTH 43 DEGREES 26 MINUTES 05 SECONDS EAST, 139.65 FEET; THENCE SOUTH 33 DEGREES 23 MINUTES 44 SECONDS EAST, 536.38 FEET; THENCE SOUTH 61 DEGREES 40 MINUTES 21 SECONDS WEST, 377.36 FEET; THENCE SOUTH 40 DEGREES 42 MINUTES 07 SECONDS WEST, 334.78 FEET; THENCE SOUTH 04 DEGREES 52 MINUTES 28 SECONDS EAST, 264.26 FEET; THENCE SOUTH 21 DEGREES 25 MINUTES 04 SECONDS WEST, 233.35 FEET; THENCE SOUTH 23 DEGREES 27 MINUTES 23 SECONDS EAST, 186.23 FEET; THENCE NORTH 69 DEGREES 56 MINUTES 19 SECONDS EAST, 66.30 FEET; THENCE NORTH 38 DEGREES 14 MINUTES 48 SECONDS EAST, 346.20 FEET; THENCE NORTH 14 DEGREES 35 MINUTES 15 SECONDS EAST, 44.02 FEET; THENCE NORTH 03 DEGREES 18 MINUTES 05 SECONDS EAST, 283.02 FEET; THENCE NORTH 85 DEGREES 20 MINUTES 38 SECONDS EAST, 414.16 FEET; THENCE SOUTH 30 DEGREES 25 MINUTES 08 SECONDS EAST, 96.66 FEET; THENCE SOUTH 26 DEGREES 58 MINUTES 17 SECONDS EAST, 511.90 FEET; THENCE SOUTH 26 DEGREES 50 MINUTES 22

# UNOFFICIAL COPY

SECONDS WEST, 71.78 FEET; THENCE SOUTH 25 DEGREES 32 MINUTES 25 SECONDS EAST, 207.04 FEET TO THE NORTH RIGHT-OF-WAY LINE OF WALKER AVENUE; THENCE SOUTH 89 DEGREES 46 MINUTES 36 SECONDS WEST ALONG SAID NORTH RIGHT-OF-WAY LINE, A DISTANCE OF 1529.04 FEET TO THE POINT OF BEGINNING;

EXCEPT THAT PART DESCRIBED AS FOLLOWS: COMMENCING AT A 6-INCH SQUARE CAST IRON MONUMENT, MARKING THE WEST QUARTER CORNER OF SAID SECTION 14; THENCE NORTH 35 DEGREES 24 MINUTES 48 SECONDS EAST, 69.09 FEET TO A 5/8 INCH IRON ROD AND PLASTIC CAP MARKING THE INTERSECTION OF THE NORTH RIGHT-OF-WAY LINE OF WALKER AVENUE WITH THE EAST RIGHT-OF-WAY LINE OF LAKEVIEW AVENUE; THENCE WITH THE NORTH RIGHT-OF-WAY LINE OF WALKER AVENUE NORTH 89 DEGREES 46 MINUTES 36 SECONDS EAST 1021.57 FEET, MORE OR LESS, TO AN ALUMINUM CORPS OF ENGINEERS (COE) MONUMENT, STAMPED "FS-5-6A"; THENCE LEAVING SAID NORTH RIGHT-OF-WAY LINE, NORTH 10 DEGREES 28 MINUTES 17 SECONDS WEST 319.13 FEET TO AN ALUMINUM COE MONUMENT, STAMPED "A-1"; THENCE NORTH 31 DEGREES 22 MINUTES 04 SECONDS WEST 410.20 FEET TO AN ALUMINUM COE MONUMENT, STAMPED "A-2", ON THE NORTH SIDE OF TENTH STREET; THENCE NORTH 17 DEGREES 54 MINUTES 40 SECONDS WEST 201.59 FEET FOR A POINT OF BEGINNING; THENCE CONTINUING NORTH 17 DEGREES 54 MINUTES 40 SECONDS WEST, 366.40 FEET TO AN ALUMINUM COE MONUMENT, STAMPED "A-3"; THENCE NORTH 19 DEGREES 58 MINUTES 50 SECONDS WEST, 33.56 FEET; THENCE NORTH 84 DEGREES 24 MINUTES 46 SECONDS EAST, 23.30 FEET; THENCE SOUTH 21 DEGREES 01 MINUTES 05 SECONDS EAST, 3.83 FEET; THENCE SOUTHEASTERLY ALONG A CURVE CONCAVE NORTHEASTERLY, NOT TANGENT TO THE LAST DESCRIBED COURSE, HAVING A RADIUS OF 32.00 FEET, A CHORD BEARING OF SOUTH 66 DEGREES 07 MINUTES 19 SECONDS EAST, A CHORD LENGTH OF 45.34 FEET, AN ARC LENGTH OF 50.38 FEET TO A POINT OF TANGENCY; THENCE NORTH 68 DEGREES 46 MINUTES 28 SECONDS EAST, TANGENT TO THE LAST DESCRIBED COURSE, 96.43 FEET; THENCE NORTH 84 DEGREES 24 MINUTES 46 SECONDS EAST, 306.95 FEET TO A POINT THAT IS 27.00 FEET WESTERLY OF (AS MEASURED AT RIGHT ANGLES TO) THE CENTERLINE OF PATTERSON ROAD; THENCE SOUTH 21 DEGREES 01 MINUTES 48 SECONDS EAST, ALONG A LINE THAT IS 27.00 FEET WESTERLY OF AND PARALLEL WITH SAID CENTERLINE, 385.89 FEET; THENCE SOUTH 82 DEGREES 12 MINUTES 27 SECONDS WEST, 480.06 FEET TO THE POINT OF BEGINNING; ALL IN LAKE COUNTY, ILLINOIS.

# UNOFFICIAL COPY

G:\Psddata\9000\9100\9100.03 - Fort Sheridan\9100.03-9 LTS\Legal Descriptions\08-24-07 rev Legal Description-disposition parcel.doc

THAT PART OF THE SOUTH HALF OF SECTION 10, AND PART OF THE SOUTH HALF OF FRACTIONAL SECTION 11, ALL IN TOWNSHIP 43 NORTH, RANGE 12 EAST OF THE THIRD PRINCIPAL MERIDIAN, AND MORE PARTICULARLY DESCRIBED WITH BEARINGS AND VALUES BEING REFERENCED TO THE ILLINOIS STATE PLANE COORDINATE SYSTEM, EAST ZONE (NAD 27), AS FOLLOWS:

COMMENCING AT A 6-INCH SQUARE CAST IRON MONUMENT, MARKING THE WEST QUARTER CORNER OF SECTION 14, TOWNSHIP 43 NORTH, RANGE 12 EAST OF THE THIRD PRINCIPAL MERIDIAN; THENCE WITH THE WEST LINE OF SECTION 14 NORTH 00 DEGREES 03 MINUTES 20 SECONDS EAST, 2642.90 FEET, MORE OR LESS, TO THE NORTHWEST CORNER OF SECTION 14, BEING THE SOUTHEAST CORNER OF AFORESAID SECTION 10, MARKED BY A 10-INCH (DIA.) CONCRETE MONUMENT WITH A CUT "X"; THENCE NORTH 32 DEGREES 10 MINUTES 37 SECONDS WEST 952.54 FEET TO A CORPS OF ENGINEERS (COE) ALUMINUM MONUMENT, STAMPED "A-12", SAID MONUMENT BEING THE POINT OF BEGINNING ON THE SOUTHERN RIM OF BARTLETT RAVINE; THENCE NORTH 12 DEGREES 49 MINUTES 05 SECONDS EAST, 86.63 FEET TO A STANDARD COE (TYPE III) BRASS DISC, STAMPED "A-13"; THENCE NORTH 03 DEGREES 36 MINUTES 44 SECONDS EAST 51.17 FEET TO A STANDARD COE (TYPE III) BRASS DISC, STAMPED "A-14"; THENCE NORTH 01 DEGREES 08 MINUTES 36 SECONDS WEST, 103.97 FEET; THENCE NORTH 60 DEGREES 22 MINUTES 41 SECONDS EAST, 215.71 FEET; THENCE NORTH 20 DEGREES 28 MINUTES 25 SECONDS WEST, 65.98 FEET; THENCE NORTH 79 DEGREES 52 MINUTES 25 SECONDS EAST, 423.95 FEET; THENCE NORTH 68 DEGREES 53 MINUTES 18 SECONDS EAST, 510.19 FEET; THENCE NORTH 24 DEGREES 35 MINUTES 50 SECONDS EAST, 573.17 FEET; THENCE SOUTH 14 DEGREES 47 MINUTES 37 SECONDS EAST, 58.00 FEET; THENCE SOUTH 00 DEGREES 40 MINUTES 38 SECONDS WEST, 146.23 FEET; THENCE SOUTH 16 DEGREES 57 MINUTES 32 SECONDS EAST, 166.79 FEET; THENCE SOUTH 10 DEGREES 03 MINUTES 12 SECONDS EAST, 309.86 FEET; THENCE SOUTH 20 DEGREES 57 MINUTES 08 SECONDS EAST, 272.61 FEET; THENCE SOUTH 29 DEGREES 30 MINUTES 10 SECONDS WEST, 723.31 FEET; THENCE SOUTH 05 DEGREES 52 MINUTES 54 SECONDS WEST, 235.85 FEET TO THE EASTERLY EXTENSION OF THE NORTH LINE OF SECOND STREET; THENCE SOUTH 68 DEGREES 33 MINUTES 58 SECONDS WEST ALONG SAID NORTH LINE, 442.18 TO A STANDARD COE (TYPE III) BRASS DISC STAMPED "A-8", SET IN CONCRETE ON THE NORTH SIDE OF SECOND STREET; THENCE CONTINUING ALONG THE NORTH SIDE OF SECOND STREET SOUTH 68 DEGREES 33 MINUTES 58 SECONDS WEST 79.19 FEET TO AN ALUMINUM COE MONUMENT, STAMPED "A-9"; THENCE LEAVING THE NORTH SIDE OF SECOND STREET AND ALONG THE WEST SIDE OF A PARKING AREA NORTH 20 DEGREES 54 MINUTES 21 SECONDS WEST 500.23 FEET TO A STANDARD COE (TYPE I) BRONZE DISC STAMPED "A-10", SET IN CONCRETE; THENCE SOUTH 69 DEGREES 42 MINUTES 28 SECONDS WEST 334.86 FEET TO

# UNOFFICIAL COPY

AN ALUMINUM COE MONUMENT, STAMPED "A-11", ON THE WEST SIDE OF "B" STREET; THENCE WITH "B" STREET AND PASSING THROUGH A PARKING AREA NORTH 21 DEGREES 25 MINUTES 29 SECONDS WEST 470.06 FEET TO THE POINT OF BEGINNING, IN LAKE COUNTY, ILLINOIS.

Property of Cook County Clerk's Office



# UNOFFICIAL COPY

G:\Psdata\9000\9100\9100.03 - Fort Sheridan\9100.03-9 LTS\Legal Descriptions\08-24-07 legal description additional parcel 1 (pump station parcel).DOC

THAT PART OF THE SOUTH HALF OF FRACTIONAL SECTION 11, TOWNSHIP 43 NORTH, RANGE 12 EAST OF THE THIRD PRINCIPAL MERIDIAN, AND MORE PARTICULARLY DESCRIBED WITH BEARINGS BEING REFERENCED TO THE ILLINOIS STATE PLANE COORDINATE SYSTEM, EAST ZONE (NAD 27), AS FOLLOWS:

COMMENCING AT A 6-INCH SQUARE CAST IRON MONUMENT, MARKING THE WEST QUARTER CORNER OF AFORESAID SECTION 14; THENCE WITH THE WEST LINE OF SECTION 14 NORTH 00 DEGREES 03 MINUTES 20 SECONDS EAST, 2642.90 FEET, MORE OR LESS, TO THE NORTHWEST CORNER OF SECTION 14, BEING THE SOUTHEAST CORNER OF AFORESAID SECTION 10, MARKED BY A 10-INCH (DIA.) CONCRETE MONUMENT WITH A CUT "X"; THENCE NORTH 32 DEGREES 10 MINUTES 37 SECONDS WEST 952.54 FEET TO A CORPS OF ENGINEERS (COE) ALUMINUM MONUMENT, STAMPED "A-12", SAID MONUMENT BEING ON THE SOUTHERN RIM OF BARTLETT RAVINE; THENCE GENERALLY WITH THE SOUTHERN RIM OF SAID BARTLETT RAVINE, SOUTH 45 DEGREES 19 MINUTES 24 SECONDS WEST 182.74 FEET TO A STANDARD COE (TYPE III) BRASS DISC, STAMPED "B-1"; THENCE SOUTH 72 DEGREES 10 MINUTES 37 SECONDS WEST 113.65 FEET TO A STANDARD COE (TYPE III) BRASS DISC, STAMPED "B-2"; THENCE NORTH 74 DEGREES 32 MINUTES 41 SECONDS WEST 54.18 FEET TO A STANDARD COE (TYPE III) BRASS DISC, STAMPED "B-3"; THENCE SOUTH 62 DEGREES 26 MINUTES 58 SECONDS WEST 80.19 FEET TO A STANDARD COE (TYPE III) BRASS DISC, STAMPED "B-4"; THENCE SOUTH 29 DEGREES 30 MINUTES 35 SECONDS WEST 152.61 FEET TO A STANDARD COE (TYPE III) BRASS DISC, STAMPED "B-5"; THENCE SOUTH 48 DEGREES 27 MINUTES 59 SECONDS WEST, 160.41 FEET, THENCE CROSSING BARTLETT RAVINE EXIT ROAD; NORTH 21 DEGREES 24 MINUTES 04 SECONDS WEST 93.57 FEET TO A STANDARD COE (TYPE III) BRASS DISC, STAMPED "B-7", ON THE NORTHERN RIM OF BARTLETT RAVINE; ALSO BEING THE SOUTHERLY LINE OF THE TOWN OF FORT SHERIDAN SUBDIVISION, RECORDED AS DOCUMENT NUMBER 4175879; THENCE NORTH 49 DEGREES 49 MINUTES 41 SECONDS EAST ALONG SAID SOUTHERLY LINE, 146.16 FEET TO A STANDARD COE (TYPE III) BRASS DISC, STAMPED "B-8"; THENCE NORTH 01 DEGREES 55 MINUTES 18 SECONDS WEST ALONG SAID SOUTHERLY LINE, 73.98 FEET TO A STANDARD COE (TYPE III) BRASS DISC, STAMPED "B-9"; THENCE NORTH 12 DEGREES 36 MINUTES 38 SECONDS EAST ALONG SAID SOUTHERLY LINE, 51.54 FEET; THENCE NORTH 65 DEGREES 20 MINUTES 58 SECONDS EAST ALONG SAID SOUTHERLY LINE, 178.09 FEET TO A STANDARD COE (TYPE III) BRASS DISC, STAMPED "B-11"; THENCE SOUTH 72 DEGREES 26 MINUTES 20 SECONDS EAST ALONG SAID SOUTHERLY LINE, 45.68 FEET TO A STANDARD COE (TYPE III) BRASS DISC, STAMPED "B-12"; THENCE NORTH 67 DEGREES 37 MINUTES 58 SECONDS EAST ALONG SAID SOUTHERLY LINE, 92.65 FEET TO A STANDARD

# UNOFFICIAL COPY

COE (TYPE III) BRASS DISC, STAMPED "B-13"; THENCE NORTH 40 DEGREES 04 MINUTES 13 SECONDS EAST ALONG SAID SOUTHERLY LINE, 120.73 FEET TO A STANDARD COE (TYPE III) BRASS DISC, STAMPED "B-14"; THENCE NORTH 07 DEGREES 24 MINUTES 17 SECONDS WEST ALONG SAID SOUTHERLY LINE, 137.63 FEET; THENCE NORTH 06 DEGREES 16 MINUTES 00 SECONDS EAST ALONG SAID SOUTHERLY LINE, 148.31 FEET; THENCE NORTH 09 DEGREES 30 MINUTES 30 SECONDS WEST ALONG SAID SOUTHERLY LINE, 96.89 FEET; THENCE NORTH 21 DEGREES 48 MINUTES 38 SECONDS EAST ALONG SAID SOUTHERLY LINE, 64.35 FEET; THENCE NORTH 41 DEGREES 26 MINUTES 23 SECONDS EAST ALONG SAID SOUTHERLY LINE, 218.09 FEET; THENCE NORTH 79 DEGREES 45 MINUTES 59 SECONDS EAST ALONG SAID SOUTHERLY LINE, 216.55 FEET TO A STANDARD COE (TYPE III) BRASS DISC, STAMPED "B-20"; THENCE NORTH 08 DEGREES 23 MINUTES 25 SECONDS WEST ALONG SAID SOUTHERLY LINE, 90.32 FEET TO A STANDARD COE (TYPE III) BRASS DISC, STAMPED "B-21"; THENCE NORTH 21 DEGREES 52 MINUTES 51 SECONDS EAST ALONG SAID SOUTHERLY LINE, 182.87 FEET TO A STANDARD COE (TYPE III) BRASS DISC, STAMPED "B-22", BEING 50 FEET WEST OF AND NORMAL TO PATTEN ROAD; THENCE NORTH 74 DEGREES 57 MINUTES 40 SECONDS EAST ALONG SAID SOUTHERLY LINE, 76.32 FEET; THENCE SOUTH 21 DEGREES 07 MINUTES 55 SECONDS EAST, 545.62 FEET; THENCE NORTH 79 DEGREES 52 MINUTES 25 SECONDS EAST, 14.71 FEET; THENCE NORTH 68 DEGREES 56 MINUTES 18 SECONDS EAST, 510.19 FEET; THENCE NORTH 24 DEGREES 35 MINUTES 50 SECONDS EAST, 573.17 FEET; THENCE CONTINUING NORTH 24 DEGREES 35 MINUTES 50 SECONDS EAST, 157.58 FEET; THENCE SOUTH 14 DEGREES 47 MINUTES 37 SECONDS EAST, 185.64 FEET; THENCE NORTH 81 DEGREES 50 MINUTES 10 SECONDS EAST, 90.89 FEET TO THE POINT OF BEGINNING; THENCE NORTH 81 DEGREES 51 MINUTES 13 SECONDS EAST, 93.45 FEET; THENCE SOUTH 09 DEGREES 09 MINUTES 41 SECONDS WEST, 134.66 FEET; THENCE NORTH 75 DEGREES 07 MINUTES 35 SECONDS WEST, 89.73 FEET; THENCE NORTH 09 DEGREES 11 MINUTES 57 SECONDS EAST, 97.92 FEET TO THE POINT OF BEGINNING;

IN LAKE COUNTY, ILLINOIS.

# UNOFFICIAL COPY

G:\Psd\9000\9100\9100.03 - Fort Sheridan\9100.03-9 LTS\Legal Descriptions\08-31-07 PHASE 2 PARCEL.DOC

THAT PART OF THE NORTH HALF OF FRACTIONAL SECTION 14, TOWNSHIP 43 NORTH, RANGE 12 EAST OF THE THIRD PRINCIPAL MERIDIAN, IN LAKE COUNTY, ILLINOIS, AND MORE PARTICULARLY DESCRIBED WITH BEARINGS AND VALUES BEING REFERENCED TO THE ILLINOIS STATE PLANE COORDINATE SYSTEM, EAST ZONE (NAD 27), AS FOLLOWS:

COMMENCING AT A 6-INCH SQUARE CAST IRON MONUMENT, MARKING THE WEST QUARTER CORNER OF SECTION 14, TOWNSHIP 43 NORTH, RANGE 12 EAST OF THE THIRD PRINCIPAL MERIDIAN; THENCE NORTH 35 DEGREES 24 MINUTES 48 SECONDS EAST 69.09 FEET TO A 5/8 INCH IRON ROD AND PLASTIC CAP MARKING THE INTERSECTION OF THE NORTH RIGHT-OF-WAY LINE OF WALKER AVENUE WITH THE EAST RIGHT-OF-WAY LINE OF LAKEVIEW AVENUE; THENCE WITH THE NORTH RIGHT-OF-WAY LINE OF WALKER AVENUE NORTH 89 DEGREES 46 MINUTES 36 SECONDS EAST 2800.61 FEET, MORE OR LESS, TO A 6-FOOT STEEL FENCE POST ON THE NORTH RIGHT-OF-WAY LINE OF WALKER AVENUE FOR THE POINT OF BEGINNING; THENCE NORTH 01 DEGREE 21 MINUTES 07 SECONDS WEST, 97.37 FEET; THENCE NORTH 25 DEGREES 32 MINUTES 25 SECONDS WEST, 135.47 FEET; THENCE NORTH 45 DEGREES 11 MINUTES 07 SECONDS WEST, 122.70 FEET; THENCE NORTH 48 DEGREES 10 MINUTES 54 SECONDS WEST, 185.96 FEET; THENCE NORTH 26 DEGREES 58 MINUTES 17 SECONDS WEST, 363.65 FEET; THENCE NORTH 30 DEGREES 25 MINUTES 08 SECONDS WEST, 227.08 FEET; THENCE NORTH 23 DEGREES 13 MINUTES 04 SECONDS WEST, 45.76 FEET; THENCE NORTH 13 DEGREES 48 MINUTES 45 SECONDS WEST, 221.51 FEET; THENCE NORTH 33 DEGREES 23 MINUTES 44 SECONDS WEST, 276.19 FEET; THENCE NORTH 17 DEGREES 08 MINUTES 30 SECONDS WEST, 69.62 FEET; THENCE NORTH 31 DEGREES 58 MINUTES 38 SECONDS WEST, 71.19 FEET; THENCE NORTH 58 DEGREES 30 MINUTES 36 SECONDS WEST, 44.93 FEET; THENCE NORTH 34 DEGREES 20 MINUTES 03 SECONDS WEST, 174.93 FEET; THENCE NORTH 04 DEGREES 43 MINUTES 10 SECONDS WEST, 23.11 FEET; THENCE NORTH 47 DEGREES 07 MINUTES 15 SECONDS WEST, 90.85 FEET; THENCE NORTH 63 DEGREES 17 MINUTES 13 SECONDS WEST, 47.47 FEET; THENCE SOUTH 45 DEGREES 17 MINUTES 08 SECONDS WEST, 54.15 FEET; THENCE SOUTH 28 DEGREES 29 MINUTES 24 SECONDS WEST, 46.75 FEET; THENCE SOUTH 43 DEGREES 26 MINUTES 05 SECONDS EAST, 139.65 FEET; THENCE SOUTH 33 DEGREES 23 MINUTES 44 SECONDS EAST, 536.38 FEET; THENCE SOUTH 61 DEGREES 40 MINUTES 21 SECONDS WEST, 377.36 FEET; THENCE SOUTH 40 DEGREES 42 MINUTES 07 SECONDS WEST, 334.78 FEET; THENCE SOUTH 04 DEGREES 52 MINUTES 28 SECONDS EAST, 264.26 FEET; THENCE SOUTH 21 DEGREES 25 MINUTES 04 SECONDS WEST, 233.35 FEET; THENCE SOUTH 23 DEGREES 27 MINUTES 23 SECONDS

# UNOFFICIAL COPY

EAST, 186.23 FEET; THENCE NORTH 69 DEGREES 56 MINUTES 19 SECONDS EAST, 66.30 FEET; THENCE NORTH 38 DEGREES 14 MINUTES 48 SECONDS EAST, 346.20 FEET; THENCE NORTH 14 DEGREES 35 MINUTES 15 SECONDS EAST, 44.02 FEET; THENCE NORTH 03 DEGREES 18 MINUTES 05 SECONDS EAST, 283.02 FEET; THENCE NORTH 85 DEGREES 20 MINUTES 38 SECONDS EAST, 414.16 FEET; THENCE SOUTH 30 DEGREES 25 MINUTES 08 SECONDS EAST, 96.66 FEET; THENCE SOUTH 26 DEGREES 58 MINUTES 17 SECONDS EAST, 511.90 FEET; THENCE SOUTH 26 DEGREES 50 MINUTES 22 SECONDS WEST, 71.78 FEET; THENCE SOUTH 25 DEGREES 32 MINUTES 25 SECONDS EAST, 207.04 FEET TO THE NORTHERLY LINE OF WALKER ROAD; THENCE NORTH 89 DEGREES 46 MINUTES 35 SECONDS EAST, 250.00 FEET TO THE POINT OF BEGINNING; EXCEPT THAT PART DESCRIBED AS FOLLOWS: COMMENCING AT A 6-INCH SQUARE CAST IRON MONUMENT, MARKING THE WEST QUARTER CORNER OF SECTION 14, TOWNSHIP 43 NORTH, RANGE 12 EAST OF THE THIRD PRINCIPAL MERIDIAN; THENCE NORTH 35 DEGREES 24 MINUTES 48 SECONDS EAST 69.09 FEET TO A 5/8 INCH IRON ROD AND PLASTIC CAP MARKING THE INTERSECTION OF THE NORTH RIGHT-OF-WAY LINE OF WALKER AVENUE WITH THE EAST RIGHT-OF-WAY LIEN OF LAKEVIEW AVENUE; THENCE WITH THE NORTH RIGHT-OF-WAY LINE OF WALKER AVENUE NORTH 89 DEGREES 46 MINUTES 36 SECONDS EAST 280.61 FEET, MORE OR LESS, TO A 6-FOOT STEEL FENCE POST ON THE NORTH RIGHT-OF-WAY LINE OF WALKER AVENUE; THENCE NORTH 01 DEGREE 21 MINUTES 07 SECONDS WEST, 97.37 FEET; THENCE NORTH 25 DEGREES 32 MINUTES 25 SECONDS WEST, 135.47 FEET; THENCE NORTH 45 DEGREES 11 MINUTES 07 SECONDS WEST, 122.70 FEET; THENCE NORTH 48 DEGREES 10 MINUTES 54 SECONDS WEST, 185.96 FEET; THENCE NORTH 26 DEGREES 58 MINUTES 17 SECONDS WEST, 363.65 FEET; THENCE NORTH 30 DEGREES 25 MINUTES 08 SECONDS WEST, 227.08 FEET; THENCE NORTH 23 DEGREES 13 MINUTES 04 SECONDS WEST, 45.76 FEET; THENCE NORTH 13 DEGREES 48 MINUTES 45 SECONDS WEST, 221.51 FEET; THENCE NORTH 33 DEGREES 23 MINUTES 44 SECONDS WEST, 276.19 FEET; THENCE NORTH 17 DEGREES 08 MINUTES 30 SECONDS WEST, 69.62 FEET; THENCE NORTH 31 DEGREES 58 MINUTES 38 SECONDS WEST, 71.19 FEET; THENCE NORTH 58 DEGREES 30 MINUTES 35 SECONDS WEST, 44.93 FEET; THENCE NORTH 34 DEGREES 20 MINUTES 03 SECONDS WEST, 174.93 FEET; THENCE NORTH 04 DEGREES 43 MINUTES 10 SECONDS WEST, 33.11 FEET; THENCE NORTH 47 DEGREES 07 MINUTES 15 SECONDS WEST, 90.85 FEET; THENCE NORTH 63 DEGREES 17 MINUTES 13 SECONDS WEST, 47.47 FEET; THENCE SOUTH 45 DEGREES 17 MINUTES 08 SECONDS WEST, 54.15 FEET; THENCE SOUTH 28 DEGREES 29 MINUTES 24 SECONDS WEST, 46.75 FEET; THENCE SOUTH 43 DEGREES 26 MINUTES 05 SECONDS EAST, 139.65 FEET; THENCE SOUTH 33 DEGREES 23 MINUTES 44 SECONDS EAST, 536.38 FEET; THENCE SOUTH 61 DEGREES 40 MINUTES 21 SECONDS

# UNOFFICIAL COPY

WEST, 377.36 FEET; THENCE SOUTH 40 DEGREES 42 MINUTES 07 SECONDS WEST, 200.50 FEET; THENCE SOUTH 49 DEGREES 17 MINUTES 53 SECONDS EAST, 76.53 FEET TO THE POINT OF BEGINNING; THENCE SOUTH 69 DEGREES 01 MINUTE 39 SECONDS EAST, 42.40 FEET; THENCE SOUTH 20 DEGREES 58 MINUTES 21 SECONDS WEST, 57.69 FEET; THENCE NORTH 69 DEGREES 01 MINUTE 39 SECONDS WEST, 42.40 FEET; THENCE NORTH 20 DEGREES 58 MINUTES 21 SECONDS EAST, 57.69 FEET TO THE POINT OF BEGINNING; ALL IN LAKE COUNTY, ILLINOIS.

Property of Cook County Clerk's Office

# UNOFFICIAL COPY

G:\P\data\9000\9100\9100.03 - Fort Sheridan\9100.03-9 LTS\Legal Descriptions\09-07-07 PHASE 3 PARCEL 1.doc

THAT PART OF THE SOUTH HALF OF FRACTIONAL SECTION 11, AND PART OF THE NORTH HALF OF FRACTIONAL SECTION 14, ALL IN TOWNSHIP 43 NORTH, RANGE 12 EAST OF THE THIRD PRINCIPAL MERIDIAN, AND MORE PARTICULARLY DESCRIBED WITH BEARINGS AND VALUES BEING REFERENCED TO THE ILLINOIS STATE PLANE COORDINATE SYSTEM, EAST ZONE (NAD 27), AS FOLLOWS:

COMMENCING AT A 6-INCH SQUARE CAST IRON MONUMENT, MARKING THE WEST QUARTER CORNER OF AFORESAID SECTION 14; THENCE WITH THE WEST LINE OF SECTION 14 NORTH 00 DEGREES 03 MINUTES 20 SECONDS EAST, 2642.90 FEET, MORE OR LESS, TO THE NORTHWEST CORNER OF SECTION 14, BEING THE SOUTHEAST CORNER OF AFORESAID SECTION 10, MARKED BY A 10-INCH (DIA.) CONCRETE MONUMENT WITH A CUT "X"; THENCE NORTH 32 DEGREES 10 MINUTES 37 SECONDS WEST 952.54 FEET TO A CORPS OF ENGINEERS (COE) ALUMINUM MONUMENT, STAMPED "A-12", SAID MONUMENT BEING ON THE SOUTHERN RIM OF BARTLETT RAVINE; THENCE GENERALLY WITH THE SOUTHERN RIM OF SAID BARTLETT RAVINE, SOUTH 45 DEGREES 19 MINUTES 24 SECONDS WEST 132.74 FEET TO A STANDARD COE (TYPE III) BRASS DISC, STAMPED "B-1"; THENCE SOUTH 72 DEGREES 10 MINUTES 37 SECONDS WEST 113.65 FEET TO A STANDARD COE (TYPE III) BRASS DISC, STAMPED "B-2"; THENCE NORTH 74 DEGREES 32 MINUTES 41 SECONDS WEST 54.18 FEET TO A STANDARD COE (TYPE III) BRASS DISC, STAMPED "B-3"; THENCE SOUTH 62 DEGREES 28 MINUTES 58 SECONDS WEST 80.19 FEET TO A STANDARD COE (TYPE III) BRASS DISC, STAMPED "B-4"; THENCE SOUTH 29 DEGREES 30 MINUTES 35 SECONDS WEST 152.61 FEET TO A STANDARD COE (TYPE III) BRASS DISC, STAMPED "B-5"; THENCE SOUTH 48 DEGREES 27 MINUTES 59 SECONDS WEST, 160.41 FEET; THENCE CROSSING BARTLETT RAVINE EXIT ROAD; NORTH 21 DEGREES 24 MINUTES 04 SECONDS WEST 93.57 FEET TO A STANDARD COE (TYPE III) BRASS DISC, STAMPED "B-7", ON THE NORTHERN RIM OF BARTLETT RAVINE; ALSO BEING THE SOUTHERLY LINE OF THE TOWN OF FORT SHERIDAN SUBDIVISION, RECORDED AS DOCUMENT NUMBER 4175879; THENCE NORTH 49 DEGREES 49 MINUTES 41 SECONDS EAST ALONG SAID SOUTHERLY LINE, 146.16 FEET TO A STANDARD COE (TYPE III) BRASS DISC, STAMPED "B-8"; THENCE NORTH 01 DEGREES 55 MINUTES 18 SECONDS WEST ALONG SAID SOUTHERLY LINE, 73.98 FEET TO A STANDARD COE (TYPE III) BRASS DISC, STAMPED "B-9"; THENCE NORTH 12 DEGREES 36 MINUTES 38 SECONDS EAST ALONG SAID SOUTHERLY LINE, 51.54 FEET; THENCE NORTH 65 DEGREES 20 MINUTES 58 SECONDS EAST ALONG SAID SOUTHERLY LINE, 178.09 FEET TO A STANDARD COE (TYPE III) BRASS DISC, STAMPED "B-11"; THENCE SOUTH 72 DEGREES 26 MINUTES 20 SECONDS EAST ALONG SAID SOUTHERLY LINE, 45.68 FEET TO A STANDARD COE (TYPE III) BRASS DISC, STAMPED "B-12"; THENCE

# UNOFFICIAL COPY

NORTH 67 DEGREES 37 MINUTES 58 SECONDS EAST ALONG SAID SOUTHERLY LINE, 92.65 FEET TO A STANDARD COE (TYPE III) BRASS DISC, STAMPED "B-13"; THENCE NORTH 40 DEGREES 04 MINUTES 13 SECONDS EAST ALONG SAID SOUTHERLY LINE, 120.73 FEET TO A STANDARD COE (TYPE III) BRASS DISC, STAMPED "B-14"; THENCE NORTH 07 DEGREES 24 MINUTES 17 SECONDS WEST ALONG SAID SOUTHERLY LINE, 137.63 FEET; THENCE NORTH 06 DEGREES 16 MINUTES 00 SECONDS EAST ALONG SAID SOUTHERLY LINE, 148.31 FEET; THENCE NORTH 09 DEGREES 30 MINUTES 30 SECONDS WEST ALONG SAID SOUTHERLY LINE, 96.89 FEET; THENCE NORTH 21 DEGREES 48 MINUTES 38 SECONDS EAST ALONG SAID SOUTHERLY LINE, 64.35 FEET; THENCE NORTH 41 DEGREES 26 MINUTES 23 SECONDS EAST ALONG SAID SOUTHERLY LINE, 218.09 FEET; THENCE NORTH 79 DEGREES 45 MINUTES 59 SECONDS EAST ALONG SAID SOUTHERLY LINE, 216.55 FEET TO A STANDARD COE (TYPE III) BRASS DISC, STAMPED "B-20"; THENCE NORTH 08 DEGREES 23 MINUTES 25 SECONDS WEST ALONG SAID SOUTHERLY LINE, 90.32 FEET TO A STANDARD COE (TYPE III) BRASS DISC, STAMPED "B-21"; THENCE NORTH 21 DEGREES 52 MINUTES 51 SECONDS EAST ALONG SAID SOUTHERLY LINE, 182.87 FEET TO A STANDARD COE (TYPE III) BRASS DISC, STAMPED "B-22", BEING 50 FEET WEST OF AND NORMAL TO PATTEN ROAD; THENCE NORTH 74 DEGREES 57 MINUTES 40 SECONDS EAST ALONG SAID SOUTHERLY LINE, 76.32 FEET; THENCE SOUTH 21 DEGREES 07 SECONDS 55 SECONDS EAST, 545.62 FEET; THENCE NORTH 79 DEGREES 52 MINUTES 25 SECONDS EAST, 14.71 FEET; THENCE NORTH 68 DEGREES 56 MINUTES 18 SECONDS EAST, 510.19 FEET; THENCE NORTH 24 DEGREES 35 MINUTES 50 SECONDS EAST, 157.58 FEET; THENCE SOUTH 14 DEGREES 47 MINUTES 37 SECONDS EAST, 185.64 FEET; THENCE SOUTH 06 DEGREES 05 MINUTES 53 SECONDS EAST, 122.10 FEET; THENCE SOUTH 34 DEGREES 45 MINUTES 44 SECONDS WEST, 32.92 FEET; THENCE SOUTH 39 DEGREES 10 MINUTES 15 SECONDS EAST, 86.86 FEET; THENCE SOUTH 03 DEGREES 01 MINUTES 00 SECONDS WEST, 99.00 FEET; THENCE SOUTH 67 DEGREES 55 MINUTES 52 SECONDS EAST, 29.35 FEET; THENCE SOUTH 23 DEGREES 16 MINUTES 35 SECONDS EAST, 90.75 FEET; THENCE SOUTH 16 DEGREES 22 MINUTES 13 SECONDS EAST, 113.52 FEET; THENCE SOUTH 07 DEGREES 44 MINUTES 46 SECONDS EAST, 87.73 FEET; THENCE SOUTH 80 DEGREES 09 MINUTES 53 SECONDS WEST, 54.39 FEET; THENCE SOUTH 35 DEGREES 07 MINUTES 14 SECONDS EAST, 102.60 FEET; THENCE SOUTH 13 DEGREES 03 MINUTES 37 SECONDS EAST, 105.12 FEET; THENCE SOUTH 24 DEGREES 41 MINUTES 51 SECONDS EAST, 82.88 FEET; THENCE SOUTH 32 DEGREES 09 MINUTES 22 SECONDS WEST, 18.35 FEET; THENCE SOUTH 15 DEGREES 28 MINUTES 50 SECONDS EAST, 149.59 FEET; THENCE SOUTH 00 DEGREES 36 MINUTES 16 SECONDS EAST, 121.31

# UNOFFICIAL COPY

FEET; THENCE SOUTH 17 DEGREES 20 MINUTES 09 SECONDS EAST, 604.75 FEET; THENCE SOUTH 21 DEGREES 06 MINUTES 41 SECONDS EAST, 220.37 FEET; THENCE SOUTH 24 DEGREES 54 MINUTES 11 SECONDS EAST, 57.85 FEET; THENCE NORTH 53 DEGREES 44 MINUTES 05 SECONDS WEST, 53.25 FEET; THENCE SOUTH 85 DEGREES 13 MINUTES 43 SECONDS WEST, 78.28 FEET; THENCE NORTH 21 DEGREES 06 MINUTES 41 SECONDS WEST, 214.52 FEET; THENCE NORTH 17 DEGREES 20 MINUTES 09 SECONDS WEST, 385.25 FEET; THENCE SOUTH 24 DEGREES 32 MINUTES 03 SECONDS WEST, 336.90 FEET; THENCE SOUTH 31 DEGREES 05 MINUTES 36 SECONDS WEST, 167.74 FEET; THENCE SOUTH 20 DEGREES 17 MINUTES 06 SECONDS WEST, 121.04 FEET; THENCE SOUTH 63 DEGREES 26 MINUTES 58 SECONDS WEST, 262.75 FEET; THENCE NORTH 21 DEGREES 04 MINUTES 31 SECONDS WEST, 184.59 FEET; THENCE NORTH 40 DEGREES 56 MINUTES 45 SECONDS EAST, 90.74 FEET; THENCE NORTH 05 DEGREES 52 MINUTES 54 SECONDS EAST, 325.96 FEET; THENCE NORTH 29 DEGREES 30 MINUTES 10 SECONDS EAST, 723.31 FEET; THENCE NORTH 20 DEGREES 57 MINUTES 08 SECONDS WEST, 272.61 FEET; THENCE NORTH 10 DEGREES 03 MINUTES 12 SECONDS WEST, 309.86 FEET; THENCE NORTH 16 DEGREES 57 MINUTES 32 SECONDS WEST, 166.79 FEET; THENCE NORTH 00 DEGREES 40 MINUTES 38 SECONDS EAST, 146.23 FEET; THENCE NORTH 14 DEGREES 47 MINUTES 37 SECONDS WEST, 58.00 FEET TO THE POINT OF BEGINNING; IN LAKE COUNTY, ILLINOIS.

Lake County Clerk's Office



# UNOFFICIAL COPY

G:\Psdata\9000\9100\9100.03 - Fort Sheridan\9100.03-9 LTS\Legal Descriptions\08-31-07 EASEMENT A.doc

THAT PART OF THE NORTH HALF OF FRACTIONAL SECTION 14, TOWNSHIP 43 NORTH, RANGE 12 EAST OF THE THIRD PRINCIPAL MERIDIAN, IN LAKE COUNTY, ILLINOIS, AND MORE PARTICULARLY DESCRIBED WITH BEARINGS AND VALUES BEING REFERENCED TO THE ILLINOIS STATE PLANE COORDINATE SYSTEM, EAST ZONE (NAD 27), AS FOLLOWS:

COMMENCING AT A 6-INCH SQUARE CAST IRON MONUMENT, MARKING THE WEST QUARTER CORNER OF SECTION 14, TOWNSHIP 43 NORTH, RANGE 12 EAST OF THE THIRD PRINCIPAL MERIDIAN; THENCE NORTH 35 DEGREES 24 MINUTES 48 SECONDS EAST 69.09 FEET TO A 5/8 INCH IRON ROD AND PLASTIC CAP MARKING THE INTERSECTION OF THE NORTH RIGHT-OF-WAY LINE OF WALKER AVENUE WITH THE EAST RIGHT-OF-WAY LINE OF LAKEVIEW AVENUE; THENCE WITH THE NORTH RIGHT-OF-WAY LINE OF WALKER AVENUE NORTH 89 DEGREES 46 MINUTES 36 SECONDS EAST 2800.61 FEET, MORE OR LESS, TO A 6-FOOT STEEL FENCE POST ON THE NORTH RIGHT-OF-WAY LINE OF WALKER AVENUE; THENCE NORTH 01 DEGREE 21 MINUTES 07 SECONDS WEST, 97.37 FEET; THENCE NORTH 25 DEGREES 32 MINUTES 25 SECONDS WEST, 135.47 FEET; THENCE NORTH 45 DEGREES 11 MINUTES 07 SECONDS WEST, 122.70 FEET; THENCE NORTH 48 DEGREES 10 MINUTES 54 SECONDS WEST, 185.96 FEET; THENCE NORTH 26 DEGREES 58 MINUTES 17 SECONDS WEST, 362.65 FEET; THENCE NORTH 30 DEGREES 25 MINUTES 08 SECONDS WEST, 227.08 FEET; THENCE NORTH 23 DEGREES 13 MINUTES 04 SECONDS WEST, 45.76 FEET; THENCE NORTH 13 DEGREES 48 MINUTES 45 SECONDS WEST, 221.51 FEET; THENCE NORTH 33 DEGREES 23 MINUTES 44 SECONDS WEST, 276.19 FEET; THENCE NORTH 17 DEGREES 08 MINUTES 30 SECONDS WEST, 69.62 FEET; THENCE NORTH 31 DEGREES 58 MINUTES 38 SECONDS WEST, 71.19 FEET; THENCE NORTH 58 DEGREES 30 MINUTES 36 SECONDS WEST, 44.93 FEET; THENCE NORTH 34 DEGREES 20 MINUTES 03 SECONDS WEST, 174.93 FEET; THENCE NORTH 04 DEGREES 43 MINUTES 10 SECONDS WEST, 33.11 FEET; THENCE NORTH 47 DEGREES 07 MINUTES 15 SECONDS WEST, 90.85 FEET; THENCE NORTH 63 DEGREES 17 MINUTES 13 SECONDS WEST, 47.47 FEET; THENCE NORTH 45 DEGREES 17 MINUTES 08 SECONDS EAST, 211.71 FEET; THENCE NORTH 24 DEGREES 21 MINUTES 48 SECONDS WEST, 32.81 FEET TO THE POINT OF BEGINNING; THENCE NORTH 24 DEGREES 21 MINUTES 48 SECONDS WEST, 291.58 FEET; THENCE NORTH 63 DEGREES 12 MINUTES 26 SECONDS EAST, 157 FEET MORE OR LESS TO A POINT ON THE CONTOUR ELEVATION 578.5 FEET MEAN SEA LEVEL (MSL); THENCE SOUTHEASTERLY ALONG SAID SHORE LINE BINDING ON THE MEANDER OF SAID CONTOUR ELEVATION 578.5 FEET (MSL), 400 FEET, MORE OR LESS, TO A LINE THAT BEARS NORTH 57 DEGREES 59 MINUTES 48 SECONDS EAST, FROM THE POINT OF BEGINNING; THENCE SOUTH 57

# UNOFFICIAL COPY

DEGREES 59 MINUTES 48 SECONDS WEST, 117 FEET, MORE OR LESS  
TO THE POINT OF BEGINNING; IN LAKE COUNTY, ILLINOIS.

Property of Cook County Clerk's Office

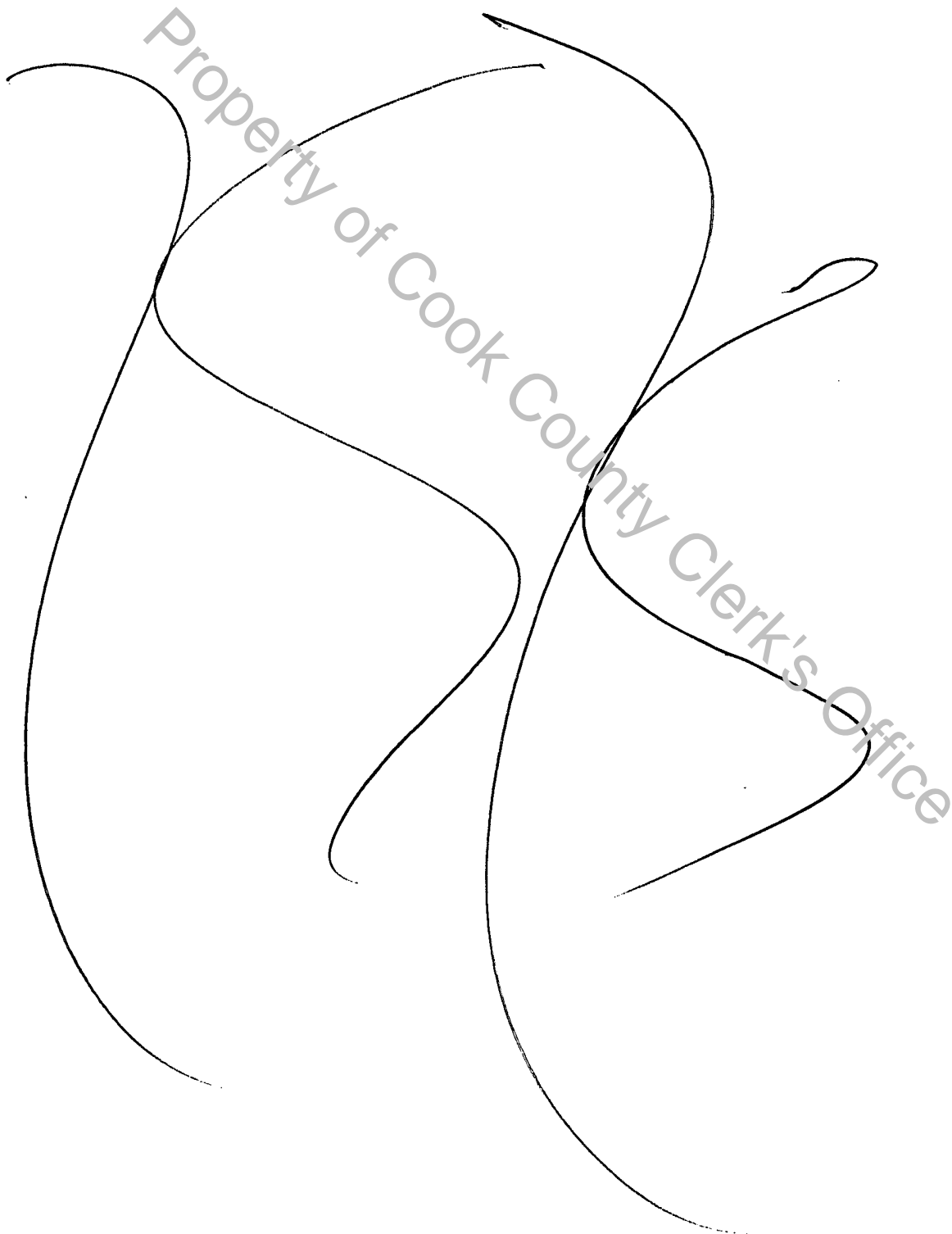

# UNOFFICIAL COPY

G:\Psdata\9000\9100\9100.03 - Fort Sheridan\9100.03-9 LTS\Legal Descriptions\08-24-07 legal description additional parcel 2.doc

THAT PART OF THE NORTH HALF OF FRACTIONAL SECTION 14, TOWNSHIP 43 NORTH, RANGE 12 EAST OF THE THIRD PRINCIPAL MERIDIAN, IN LAKE COUNTY, ILLINOIS, AND MORE PARTICULARLY DESCRIBED WITH BEARINGS BEING REFERENCED TO THE ILLINOIS STATE PLANE COORDINATE SYSTEM, EAST ZONE (NAD 27), AS FOLLOWS:

COMMENCING AT A 6-INCH SQUARE CAST IRON MONUMENT, MARKING THE WEST QUARTER CORNER OF SECTION 14, TOWNSHIP 43 NORTH, RANGE 12 EAST OF THE THIRD PRINCIPAL MERIDIAN; THENCE NORTH 35 DEGREES 24 MINUTES 43 SECONDS EAST 69.09 FEET TO A 5/8 INCH IRON ROD AND PLASTIC CAP MARKING THE INTERSECTION OF THE NORTH RIGHT-OF-WAY LINE OF WALKER AVENUE WITH THE EAST RIGHT-OF-WAY LIEN OF LAKEVIEW AVENUE; THENCE WITH THE NORTH RIGHT-OF-WAY LINE OF WALKER AVENUE NORTH 89 DEGREES 46 MINUTES 36 SECONDS EAST 2800.61 FEET, MORE OR LESS, TO A 6-FOOT STEEL FENCE POST ON THE NORTH RIGHT-OF-WAY LINE OF WALKER AVENUE; THENCE NORTH 01 DEGREE 21 MINUTES 07 SECONDS WEST, 97.37 FEET; THENCE NORTH 25 DEGREES 32 MINUTES 25 SECONDS WEST, 135.47 FEET; THENCE NORTH 45 DEGREES 11 MINUTES 07 SECONDS WEST, 122.70 FEET; THENCE NORTH 48 DEGREES 10 MINUTES 54 SECONDS WEST, 185.96 FEET; THENCE NORTH 20 DEGREES 58 MINUTES 17 SECONDS WEST, 363.65 FEET; THENCE NORTH 30 DEGREES 25 MINUTES 08 SECONDS WEST, 227.08 FEET; THENCE NORTH 25 DEGREES 13 MINUTES 04 SECONDS WEST, 45.76 FEET; THENCE NORTH 13 DEGREES 48 MINUTES 45 SECONDS WEST, 221.51 FEET; THENCE NORTH 33 DEGREES 23 MINUTES 44 SECONDS WEST, 276.19 FEET; THENCE NORTH 17 DEGREES 08 MINUTES 30 SECONDS WEST, 69.62 FEET; THENCE NORTH 31 DEGREES 58 MINUTES 38 SECONDS WEST, 71.19 FEET; THENCE NORTH 58 DEGREES 30 MINUTES 36 SECONDS WEST, 44.93 FEET; THENCE NORTH 34 DEGREES 20 MINUTES 03 SECONDS WEST, 174.93 FEET; THENCE NORTH 04 DEGREES 43 MINUTES 10 SECONDS WEST, 33.11 FEET; THENCE NORTH 47 DEGREES 07 MINUTES 15 SECONDS WEST, 90.85 FEET; THENCE NORTH 63 DEGREES 17 MINUTES 13 SECONDS WEST, 47.47 FEET; THENCE SOUTH 45 DEGREES 17 MINUTES 08 SECONDS WEST, 54.15 FEET; THENCE SOUTH 28 DEGREES 29 MINUTES 24 SECONDS WEST, 46.75 FEET; THENCE SOUTH 43 DEGREES 26 MINUTES 05 SECONDS EAST, 139.65 FEET; THENCE SOUTH 33 DEGREES 23 MINUTES 44 SECONDS EAST, 536.38 FEET; THENCE SOUTH 61 DEGREES 40 MINUTES 21 SECONDS WEST, 377.36 FEET; THENCE SOUTH 40 DEGREES 42 MINUTES 07 SECONDS WEST, 200.50 FEET; THENCE SOUTH 49 DEGREES 17 MINUTES 53 SECONDS EAST, 76.53 FEET TO THE POINT OF BEGINNING; THENCE SOUTH 69 DEGREES 01 MINUTE 39 SECONDS EAST, 42.40 FEET; THENCE SOUTH 20 DEGREES 58 MINUTES 21 SECONDS WEST, 57.69 FEET; THENCE NORTH 69 DEGREES 01 MINUTE 39 SECONDS WEST, 42.40 FEET; THENCE NORTH 20 DEGREES 58 MINUTES 21 SECONDS EAST, 57.69 FEET TO THE POINT OF BEGINNING; ALL IN LAKE COUNTY, ILLINOIS.

# UNOFFICIAL COPY

G:\Psddata\9000\9100\9100.03 - Fort Sheridan\9100.03-9 LTS\Legal Descriptions\08-31-07 PHASE 3 PARCEL 2.doc

THAT PART OF THE SOUTH HALF OF FRACTIONAL SECTION 11, AND PART OF THE NORTH HALF OF FRACTIONAL SECTION 14, ALL IN TOWNSHIP 43 NORTH, RANGE 12 EAST OF THE THIRD PRINCIPAL MERIDIAN, AND MORE PARTICULARLY DESCRIBED WITH BEARINGS AND VALUES BEING REFERENCED TO THE ILLINOIS STATE PLANE COORDINATE SYSTEM, EAST ZONE (NAD 27), AS FOLLOWS:

COMMENCING AT A 6-INCH SQUARE CAST IRON MONUMENT, MARKING THE WEST QUARTER CORNER OF AFORESAID SECTION 14; THENCE WITH THE WEST LINE OF SECTION 14 NORTH 00 DEGREES 03 MINUTES 20 SECONDS EAST, 2642.90 FEET, MORE OR LESS, TO THE NORTHWEST CORNER OF SECTION 14, BEING THE SOUTHEAST CORNER OF AFORESAID SECTION 10, MARKED BY A 10-INCH (DIA.) CONCRETE MONUMENT WITH A CUT "X"; THENCE NORTH 32 DEGREES 10 MINUTES 37 SECONDS WEST 952.54 FEET TO A CORPS OF ENGINEERS (COE) ALUMINUM MONUMENT, STAMPED "A-12", SAID MONUMENT BEING ON THE SOUTHERN RIM OF BARTLETT RAVINE; THENCE GENERALLY WITH THE SOUTHERN RIM OF SAID BARTLETT RAVINE, SOUTH 45 DEGREES 19 MINUTES 24 SECONDS WEST 182.74 FEET TO A STANDARD COE (TYPE III) BRASS DISC, STAMPED "B-1"; THENCE SOUTH 72 DEGREES 10 MINUTES 37 SECONDS WEST 113.65 FEET TO A STANDARD COE (TYPE III) BRASS DISC, STAMPED "B-2"; THENCE NORTH 74 DEGREES 32 MINUTES 41 SECONDS WEST 54.18 FEET TO A STANDARD COE (TYPE III) BRASS DISC, STAMPED "B-3"; THENCE SOUTH 62 DEGREES 28 MINUTES 58 SECONDS WEST 80.19 FEET TO A STANDARD COE (TYPE III) BRASS DISC, STAMPED "B-4"; THENCE SOUTH 29 DEGREES 30 MINUTES 35 SECONDS WEST 152.61 FEET TO A STANDARD COE (TYPE III) BRASS DISC, STAMPED "B-5"; THENCE SOUTH 48 DEGREES 27 MINUTES 59 SECONDS WEST, 160.41 FEET; THENCE CROSSING BARTLETT RAVINE EXIT ROAD; NORTH 21 DEGREES 24 MINUTES 04 SECONDS WEST 93.57 FEET TO A STANDARD COE (TYPE III) BRASS DISC, STAMPED "B-7", ON THE NORTHERN RIM OF BARTLETT RAVINE; ALSO BEING THE SOUTHERLY LINE OF THE TOWN OF FORT SHERIDAN SUBDIVISION, RECORDED AS DOCUMENT NUMBER 4175879; THENCE NORTH 49 DEGREES 49 MINUTES 41 SECONDS EAST ALONG SAID SOUTHERLY LINE, 146.16 FEET TO A STANDARD COE (TYPE III) BRASS DISC, STAMPED "B-8"; THENCE NORTH 01 DEGREES 55 MINUTES 18 SECONDS WEST ALONG SAID SOUTHERLY LINE, 73.98 FEET TO A STANDARD COE (TYPE III) BRASS DISC, STAMPED "B-9"; THENCE NORTH 12 DEGREES 36 MINUTES 38 SECONDS EAST ALONG SAID SOUTHERLY LINE, 51.54 FEET; THENCE NORTH 65 DEGREES 20 MINUTES 58 SECONDS EAST ALONG SAID SOUTHERLY LINE, 178.09 FEET TO A STANDARD COE (TYPE III) BRASS DISC, STAMPED "B-11"; THENCE SOUTH 72 DEGREES 26 MINUTES 20 SECONDS EAST ALONG SAID SOUTHERLY LINE, 45.68 FEET TO A STANDARD COE (TYPE III) BRASS DISC, STAMPED "B-12"; THENCE

# UNOFFICIAL COPY

NORTH 67 DEGREES 37 MINUTES 58 SECONDS EAST ALONG SAID SOUTHERLY LINE, 92.65 FEET TO A STANDARD COE (TYPE III) BRASS DISC, STAMPED "B-13"; THENCE NORTH 40 DEGREES 04 MINUTES 13 SECONDS EAST ALONG SAID SOUTHERLY LINE, 120.73 FEET TO A STANDARD COE (TYPE III) BRASS DISC, STAMPED "B-14"; THENCE NORTH 07 DEGREES 24 MINUTES 17 SECONDS WEST ALONG SAID SOUTHERLY LINE, 137.63 FEET; THENCE NORTH 06 DEGREES 16 MINUTES 00 SECONDS EAST ALONG SAID SOUTHERLY LINE, 148.31 FEET; THENCE NORTH 09 DEGREES 30 MINUTES 30 SECONDS WEST ALONG SAID SOUTHERLY LINE, 96.89 FEET; THENCE NORTH 21 DEGREES 48 MINUTES 38 SECONDS EAST ALONG SAID SOUTHERLY LINE, 64.35 FEET; THENCE NORTH 41 DEGREES 26 MINUTES 23 SECONDS EAST ALONG SAID SOUTHERLY LINE, 218.09 FEET; THENCE NORTH 79 DEGREES 45 MINUTES 59 SECONDS EAST ALONG SAID SOUTHERLY LINE, 216.55 FEET TO A STANDARD COE (TYPE III) BRASS DISC, STAMPED "B-20"; THENCE NORTH 08 DEGREES 23 MINUTES 25 SECONDS WEST ALONG SAID SOUTHERLY LINE, 90.32 FEET TO A STANDARD COE (TYPE III) BRASS DISC, STAMPED "B-21"; THENCE NORTH 21 DEGREES 52 MINUTES 51 SECONDS EAST ALONG SAID SOUTHERLY LINE, 182.87 FEET TO A STANDARD COE (TYPE III) BRASS DISC, STAMPED "B-22", BEING 50 FEET WEST OF AND NORMAL TO PATTEN ROAD; THENCE NORTH 74 DEGREES 57 MINUTES 40 SECONDS EAST ALONG SAID SOUTHERLY LINE, 76.32 FEET; THENCE SOUTH 21 DEGREES 07 MINUTES 55 SECONDS EAST, 458.19 FEET FOR A POINT OF BEGINNING; THENCE SOUTH 78 DEGREES 16 MINUTES 15 SECONDS EAST, 28.11 FEET TO A STANDARD COE (TYPE III) BRASS DISC STAMPED "A-19"; THENCE NORTH 68 DEGREES 56 MINUTES 18 SECONDS EAST, 464.62 FEET TO A STANDARD COE (TYPE III) BRASS DISC STAMPED "A-20"; THENCE NORTH 17 DEGREES 02 MINUTES 32 SECONDS EAST, 390.51 FEET TO A STANDARD COE (TYPE III) BRASS DISC STAMPED "A-21"; THENCE NORTH 06 DEGREES 23 MINUTES 02 SECONDS WEST, 48.98 FEET TO A STANDARD COE (TYPE III) BRASS DISC STAMPED "A-22"; THENCE NORTH 69 DEGREES 20 MINUTES 54 SECONDS EAST, 115.00 FEET TO A STANDARD COE (TYPE III) BRASS DISC STAMPED "A-23"; THENCE NORTH 03 DEGREES 17 MINUTES 01 SECONDS WEST, 226.50 FEET TO A STANDARD COE (TYPE III) BRASS DISC STAMPED "A-24"; THENCE NORTH 14 DEGREES 13 MINUTES 46 SECONDS EAST, 103.98 FEET TO A STANDARD COE (TYPE III) BRASS DISC STAMPED "A-25"; THENCE NORTH 51 DEGREES 16 MINUTES 25 SECONDS EAST, 93.01 FEET TO A STANDARD COE (TYPE III) BRASS DISC STAMPED "A-26"; THENCE SOUTH 14 DEGREES 47 MINUTES 37 SECONDS EAST, 248.36 FEET; THENCE SOUTH 24 DEGREES 35 MINUTES 50 SECONDS WEST, 730.75 FEET; THENCE SOUTH 68 DEGREES 56 MINUTES 18 SECONDS WEST, 510.19 FEET; THENCE SOUTH 79 DEGREES 52 MINUTES 25 SECONDS WEST, 14.71 FEET; THENCE NORTH 21 DEGREES 07 MINUTES 55 SECONDS WEST, 87.43 FEET TO THE POINT OF BEGINNING; IN LAKE COUNTY, ILLINOIS.

# UNOFFICIAL COPY

G:\Psddata\9000\9100\9100.03 - Fort Sheridan\9100.03-1 - LTS\Legal Descriptions\09-14-05 rev Legal Description - parcel c.doc

## PARCEL C

COMMENCING AT A 6-INCH SQUARE CAST IRON MONUMENT MARKING THE NORTH QUARTER CORNER OF AFORESAID SECTION 10; THENCE WITH THE WEST LINE OF THE EAST HALF OF SECTION 10, TOWNSHIP 43 NORTH, RANGE 12 EAST OF THE THIRD PRINCIPAL MERIDIAN; THENCE SOUTH 00 DEGREES 08 MINUTES 20 SECONDS EAST 2678.37 FEET, MORE OR LESS, TO THE NORTHWEST CORNER OF THE SOUTHEAST QUARTER OF SECTION 10, MARKED BY A 6-INCH SQUARE CAST IRON MONUMENT; THENCE SOUTH 02 DEGREES 41 MINUTES 13 SECONDS WEST 1094.17 FEET TO AN ALUMINUM CORPS OF ENGINEERS (COE) MONUMENT, STAMPED "FS-15-C", SAID MONUMENT BEING THE POINT OF BEGINNING OF THIS DESCRIPTION OF PARCEL "C", ON THE EAST RIGHT-OF-WAY LINE OF MCKINLEY ROAD (ILLINOIS HIGHWAY NO. 42); THENCE LEAVING SAID EAST RIGHT-OF-WAY LINE AND WITH THE NORTH LINE FOR PARCEL "C", AS FOLLOWS: NORTH 69 DEGREES 16 MINUTES 14 SECONDS EAST 376.60 FEET TO A STANDARD COE (TYPE I) BRONZE DISC, STAMPED "C-1", SET IN CONCRETE ON THE NORTH SIDE OF WESTOVER ROAD, AND BEING 10 FEET WEST OF AND NORMAL TO THE WESTERN MOST RAILROAD SPUR TRACK; THENCE PARALLELING SAID SPUR TRACK, AS FOLLOWS: SOUTH 25 DEGREES 10 MINUTES 29 SECONDS EAST 464.34 FEET, PASSING AN ALUMINUM COE MONUMENT, STAMPED "C-2", SET IN CONCRETE AT 440.80 FEET, TO A POINT BEING 10 FEET WEST OF AND NORMAL TO SAID SPUR TRACK; THENCE WITH THE ARC OF A 4.0425 DEGREE RAILROAD CURVE TO THE LEFT, HAVING A RADIUS OF 1388.85 FEET AND A CHORD OF SOUTH 30 DEGREES 54 MINUTES 04 SECONDS EAST 277.15 FEET SOUTHEASTERLY 277.61 FEET TO AN ALUMINUM COE MONUMENT, STAMPED "C-3", SET 10 FEET WEST OF AND NORMAL TO SAID SPUR TRACK; THENCE SOUTH 36 DEGREES 37 MINUTES 39 SECONDS EAST 62.94 FEET TO AN ALUMINUM COE MONUMENT, STAMPED "C-4", SET 10 FEET WEST OF AND NORMAL TO SAID SPUR TRACK; THENCE WITH THE ARC OF AN 8.2437 DEGREE RAILROAD CURVE TO THE RIGHT, HAVING A RADIUS OF 660.38 FEET AND A CHORD OF SOUTH 28 DEGREES 03 MINUTES 55 SECONDS EAST 196.64 FEET SOUTHEASTERLY 197.37 FEET TO AN ALUMINUM COE MONUMENT, STAMPED "C-5", SET 10 FEET WEST OF AND NORMAL TO SAID SPUR TRACK; THENCE WITH THE ARC OF A 10.1705 DEGREE RAILROAD CURVE TO THE RIGHT, HAVING A RADIUS OF 557.85 FEET AND A CHORD OF SOUTH 10 DEGREES 06 MINUTES 47 SECONDS EAST 182.03 FEET SOUTHEASTERLY 182.85 FEET TO AN ALUMINUM COE MONUMENT, STAMPED "C-6", SET 10 FEET WEST OF AND NORMAL TO SAID SPUR TRACK; THENCE WITH THE ARC OF A 7.2417 DEGREE RAILROAD CURVE TO THE RIGHT, HAVING A RADIUS OF 746.61 FEET AND A CHORD OF SOUTH 13 DEGREES 07 MINUTES 21 SECONDS WEST 254.66 FEET SOUTHEASTERLY 255.91 FEET TO AN ALUMINUM COE MONUMENT, STAMPED "C-7", SET 10 FEET WEST OF AND NORMAL TO SAID SPUR TRACK; THENCE SOUTH 22 DEGREES 56 MINUTES 31 SECONDS WEST 97.91 FEET TO A

# UNOFFICIAL COPY

STANDARD COE (TYPE 1) BRONZE DISC, STAMPED "C-8", SET 10 FEET WEST OF AND NORMAL TO SAID RAILROAD SPUR TRACK, AND BEING IN THE EAST RIGHT-OF-WAY LINE OF MCKINLEY ROAD; THENCE WITH SAID EAST RIGHT-OF-WAY LINE AND THE ARC OF A 10.7469 DEGREE HIGHWAY CURVE TO THE RIGHT, HAVING A RADIUS OF 533.14 FEET AND A CHORD OF NORTH 45 DEGREES 54 MINUTES 46 SECONDS WEST 306.90 FEET NORTHWESTERLY 311.30 FEET, MORE OR LESS, TO A 5/8-INCH IRON ROD WITH 1 1/4-INCH PLASTIC CAP; THENCE WITH SAID EAST RIGHT-OF-WAY NORTH 29 DEGREES 11 MINUTES 07 SECONDS WEST 3.15 FEET, MORE OR LESS, TO A 5/8-INCH IRON ROD WITH 1 1/4-INCH PLASTIC CAP; THENCE WITH SAID EAST RIGHT-OF-WAY AND THE ARC OF A CURVE TO THE RIGHT, HAVING A RADIUS OF 11,339.20 FEET AND A CHORD BEARING OF NORTH 27 DEGREES 41 MINUTES 08 SECONDS WEST 593.65 FEET NORTHWESTERLY 593.72 FEET, MORE OR LESS, TO A 4-INCH BY 4-INCH CONCRETE RIGHT-OF-WAY MARKER; THENCE WITH SAID EAST RIGHT-OF-WAY NORTH 26 DEGREES 11 MINUTES 08 SECONDS WEST 355.13 FEET, MORE OR LESS, TO A 4-INCH BY 4-INCH CONCRETE RIGHT-OF-WAY MARKER; THENCE WITH SAID EAST RIGHT-OF-WAY AND WITH THE ARC OF A CURVE TO THE LEFT, HAVING A RADIUS OF 11,539.20 FEET AND A CHORD BEARING OF NORTH 26 DEGREES 45 MINUTES 51 SECONDS WEST 230.16 NORTHWESTERLY 230.16 FEET, MORE OR LESS, TO THE POINT OF BEGINNING, CONTAINING 11.48 ACRES, 500,069 SQUARE FEET, MORE OR LESS.

County Clerk's Office

# UNOFFICIAL COPY

G:\Psd\data\9000\9100\9100.03 - Fort Sheridan\9100.03-9 LTS\Legal Descriptions\08-31-07 PHASE 1 BRIDGE  
PARCEL.doc

THAT PART OF THE SOUTH HALF OF SECTION 10, AND PART OF THE SOUTH HALF OF FRACTIONAL SECTION 11, ALL IN TOWNSHIP 43 NORTH, RANGE 12 EAST OF THE THIRD PRINCIPAL MERIDIAN, AND MORE PARTICULARLY DESCRIBED WITH BEARINGS AND VALUES BEING REFERENCED TO THE ILLINOIS STATE PLANE COORDINATE SYSTEM, EAST ZONE (NAD 27), AS FOLLOWS:

COMMENCING AT A 6-INCH SQUARE CAST IRON MONUMENT, MARKING THE WEST QUARTER CORNER OF AFORESAID SECTION 14; THENCE WITH THE WEST LINE OF SECTION 14 NORTH 00 DEGREES 03 MINUTES 20 SECONDS EAST, 2642.90 FEET, MORE OR LESS, TO THE NORTHWEST CORNER OF SECTION 14, BEING THE SOUTHEAST CORNER OF AFORESAID SECTION 10, MARKED BY A 10-INCH (DIA.) CONCRETE MONUMENT WITH A CUT "X"; THENCE NORTH 32 DEGREES 10 MINUTES 37 SECONDS WEST 952.54 FEET TO A CORPS OF ENGINEERS (COE) ALUMINUM MONUMENT, STAMPED "A-12", ON THE SOUTHERN RIM OF BARTLETT RAVINE; THENCE GENERALLY WITH THE SOUTHERN RIM OF SAID BARTLETT RAVINE, SOUTH 45 DEGREES 19 MINUTES 24 SECONDS WEST 182.74 FEET TO A STANDARD COE (TYPE III) BRASS DISC, STAMPED "B-1"; THENCE SOUTH 72 DEGREES 10 MINUTES 37 SECONDS WEST 113.65 FEET TO A STANDARD COE (TYPE III) BRASS DISC, STAMPED "B-2"; THENCE NORTH 74 DEGREES 32 MINUTES 41 SECONDS WEST 54.18 FEET TO A STANDARD COE (TYPE III) BRASS DISC, STAMPED "B-3"; THENCE SOUTH 62 DEGREES 28 MINUTES 58 SECONDS WEST 80.19 FEET TO A STANDARD COE (TYPE III) BRASS DISC, STAMPED "B-4"; THENCE SOUTH 29 DEGREES 30 MINUTES 35 SECONDS WEST 152.61 FEET TO A STANDARD COE (TYPE III) BRASS DISC, STAMPED "B-5"; THENCE SOUTH 48 DEGREES 27 MINUTES 59 SECONDS WEST, 160.41 FEET; THENCE CROSSING BARTLETT RAVINE EXIT ROAD; NORTH 21 DEGREES 24 MINUTES 04 SECONDS WEST 93.57 FEET TO A STANDARD COE (TYPE III) BRASS DISC, STAMPED "B-7", ON THE NORTHERN RIM OF BARTLETT RAVINE; ALSO BEING THE SOUTHERLY LINE OF THE TOWN OF FORT SHERIDAN SUBDIVISION, RECORDED AS DOCUMENT NUMBER 4175879; THENCE NORTH 49 DEGREES 49 MINUTES 41 SECONDS EAST ALONG SAID SOUTHERLY LINE, 146.16 FEET TO A STANDARD COE (TYPE III) BRASS DISC, STAMPED "B-8"; THENCE NORTH 01 DEGREES 55 MINUTES 18 SECONDS WEST ALONG SAID SOUTHERLY LINE, 73.98 FEET TO A STANDARD COE (TYPE III) BRASS DISC, STAMPED "B-9"; THENCE NORTH 12 DEGREES 36 MINUTES 38 SECONDS EAST ALONG SAID SOUTHERLY LINE, 51.54 FEET; THENCE NORTH 65 DEGREES 20 MINUTES 58 SECONDS EAST ALONG SAID SOUTHERLY LINE, 178.09 FEET TO A STANDARD COE (TYPE III) BRASS DISC, STAMPED "B-11"; THENCE SOUTH 72 DEGREES 26 MINUTES 20 SECONDS EAST ALONG SAID SOUTHERLY LINE, 45.68 FEET TO A



# UNOFFICIAL COPY

STANDARD COE (TYPE III) BRASS DISC, STAMPED "B-12"; THENCE NORTH 67 DEGREES 37 MINUTES 58 SECONDS EAST ALONG SAID SOUTHERLY LINE, 92.65 FEET TO A STANDARD COE (TYPE III) BRASS DISC, STAMPED "B-13"; THENCE NORTH 40 DEGREES 04 MINUTES 13 SECONDS EAST ALONG SAID SOUTHERLY LINE, 120.73 FEET TO A STANDARD COE (TYPE III) BRASS DISC, STAMPED "B-14"; THENCE NORTH 07 DEGREES 24 MINUTES 17 SECONDS WEST ALONG SAID SOUTHERLY LINE, 137.63 FEET; THENCE NORTH 06 DEGREES 16 MINUTES 00 SECONDS EAST ALONG SAID SOUTHERLY LINE, 148.31 FEET; THENCE NORTH 09 DEGREES 30 MINUTES 30 SECONDS WEST ALONG SAID SOUTHERLY LINE, 96.89 FEET; THENCE NORTH 21 DEGREES 48 MINUTES 38 SECONDS EAST ALONG SAID SOUTHERLY LINE, 64.35 FEET; THENCE NORTH 41 DEGREES 26 MINUTES 23 SECONDS EAST ALONG SAID SOUTHERLY LINE, 218.09 FEET; NORTH 79 DEGREES 45 MINUTES 59 SECONDS EAST ALONG SAID SOUTHERLY LINE, 216.55 FEET TO A STANDARD COE (TYPE III) BRASS DISC, STAMPED "B-20"; THENCE NORTH 08 DEGREES 23 MINUTES 25 SECONDS WEST ALONG SAID SOUTHERLY LINE, 90.32 FEET TO A STANDARD COE (TYPE III) BRASS DISC, STAMPED "B-21"; THENCE NORTH 21 DEGREES 52 MINUTES 51 SECONDS EAST ALONG SAID SOUTHERLY LINE, 182.87 FEET TO A STANDARD COE (TYPE III) BRASS DISC, STAMPED "B-22", BEING 50 FEET WEST OF AND NORMAL TO PATTEN ROAD; THENCE NORTH 74 DEGREES 57 MINUTES 40 SECONDS EAST ALONG SAID SOUTHERLY LINE, 21.40 FEET TO THE POINT OF BEGINNING; THENCE SOUTH 21 DEGREES 06 MINUTES 44 SECONDS EAST, 540.79 FEET; THENCE NORTH 79 DEGREES 52 MINUTES 25 SECONDS EAST, 55.83 FEET; THENCE NORTH 21 DEGREES 07 MINUTES 55 SECONDS EAST, 545.62 FEET TO THE SOUTHERLY LINE OF SAID TOWN OF FORT SHERIDAN SUBDIVISION; THENCE SOUTH 74 DEGREES 57 MINUTES 40 SECONDS WEST, 54.92 FEET TO THE POINT OF BEGINNING, IN LAKE COUNTY, ILLINOIS.

Survey Office

# UNOFFICIAL COPY

G:\Psdatal9000\9100\9100.01 - Glenview\9100.01-5 - LTS & legal\Legal Descriptions\08-22-07 Legal Description PARCEL 1.doc

## PARCEL 1 (41.065 ACRE PARCEL)

THAT PART OF THE SOUTHEAST QUARTER OF SECTION 21, AND PART OF THE NORTHWEST QUARTER OF SECTION 27, AND PART OF THE NORTH HALF OF SECTION 28, ALL IN TOWNSHIP 42 NORTH, RANGE 12 EAST OF THE THIRD PRINCIPAL MERIDIAN, DESCRIBED AS FOLLOWS: COMMENCING AT THE NORTHEAST CORNER OF THE WEST HALF OF THE NORTHEAST QUARTER OF SAID SECTION 28, HAVING MEASURED ILLINOIS STATE PLANE COORDINATES OF 1977517.989 NORTH AND 1119646.497 EAST; THENCE SOUTH 89 DEGREES 53 MINUTES 05 SECONDS EAST, ALONG THE SOUTH LINE OF THE SOUTHEAST QUARTER OF SAID SECTION 21, A DISTANCE OF 142.50 FEET TO THE WEST LINE OF THE EAST 1188.00 FEET THEREOF FOR THE POINT OF BEGINNING; THENCE NORTH 00 DEGREES 07 MINUTES 08 SECONDS EAST ALONG SAID WEST LINE, 330.00 FEET; THENCE SOUTH 89 DEGREES 53 MINUTES 05 SECONDS EAST, PARALLEL WITH SAID SOUTH LINE OF THE SOUTHEAST QUARTER OF SECTION 21, A DISTANCE OF 785.20 FEET TO THE NORTHWESTERLY CORNER OF LOT 10, GLENVIEW NAVAL AIR STATION SUBDIVISION NO. 2, PER DOCUMENT NUMBER 99313067, COOK COUNTY, ILLINOIS; THENCE SOUTH 23 DEGREES 59 MINUTES 43 SECONDS EAST ALONG THE WESTERLY LINE OF SAID LOT 10 AS MONUMENTED, 169.84 FEET; THENCE SOUTH 89 DEGREES 13 MINUTES 12 SECONDS WEST ALONG SAID WESTERLY LINE, 5.36 FEET; THENCE SOUTH 00 DEGREES 46 MINUTES 48 SECONDS EAST ALONG SAID WESTERLY LINE, 9.25 FEET; THENCE SOUTH 89 DEGREES 00 MINUTES 06 SECONDS WEST ALONG SAID WESTERLY LINE, 6.94 FEET; THENCE SOUTH 00 DEGREES 18 MINUTES 33 SECONDS EAST ALONG SAID WESTERLY LINE, 35.22 FEET; THENCE SOUTH 89 DEGREES 23 MINUTES 18 SECONDS EAST ALONG SAID WESTERLY LINE, 32.03 FEET; THENCE SOUTH 23 DEGREES 59 MINUTES 43 SECONDS EAST ALONG SAID WESTERLY LINE, 141.88 FEET; THENCE SOUTH 88 DEGREES 05 MINUTES 26 SECONDS WEST ALONG SAID WESTERLY LINE, 7.32 FEET; THENCE SOUTH 04 DEGREES 10 MINUTES 12 SECONDS EAST ALONG SAID WESTERLY LINE, 4.95 FEET; THENCE NORTH 89 DEGREES 51 MINUTES 18 SECONDS WEST ALONG SAID WESTERLY LINE, 14.58 FEET; THENCE SOUTH 00 DEGREES 08 MINUTES 42 SECONDS WEST ALONG SAID WESTERLY LINE, 24.56 FEET; THENCE NORTH 89 DEGREES 51 MINUTES 18 SECONDS WEST ALONG SAID WESTERLY LINE, 12.77 FEET; THENCE SOUTH 00 DEGREES 08 MINUTES 42 SECONDS WEST ALONG SAID WESTERLY LINE, 29.53 FEET; THENCE NORTH 89 DEGREES 48 MINUTES 05 SECONDS EAST ALONG SAID WESTERLY LINE, 60.70 FEET; THENCE SOUTH 23 DEGREES 59 MINUTES 43 SECONDS EAST ALONG SAID WESTERLY LINE, 10.89 FEET TO THE SOUTHERNMOST SOUTHWEST CORNER OF SAID LOT 10; THENCE SOUTH 89 DEGREES 59 MINUTES 43 SECONDS EAST ALONG THE SOUTH LINE OF SAID LOT 10, A DISTANCE OF 200.10 FEET TO THE SOUTHEAST CORNER OF SAID LOT 10; SAID CORNER ALSO BEING ON THE WESTERLY LINE OF SHERMER ROAD AS DEDICATED PER DOCUMENT NO. 99313067, AND AS MONUMENTED; THENCE SOUTH 37 DEGREES 37 MINUTES 02 SECONDS EAST, ALONG SAID

# UNOFFICIAL COPY

WESTERLY LINE, 77.28 FEET; THENCE SOUTHERLY ALONG SAID WESTERLY LINE, BEING AN ARC OF A CIRCLE CONVEX EASTERLY AND HAVING A RADIUS OF 238.00 FEET FOR AN ARC DISTANCE OF 20.50 FEET (THE CHORD OF SAID ARC HAVING A BEARING OF SOUTH 19 DEGREES 16 MINUTES 48 SECONDS WEST A DISTANCE OF 20.49 FEET); THENCE SOUTH 21 DEGREES 44 MINUTES 50 SECONDS WEST, ALONG SAID WESTERLY LINE, 82.33 FEET TO A POINT OF CURVE; THENCE SOUTHERLY ALONG SAID WESTERLY LINE, BEING AN ARC OF A CIRCLE CONVEX SOUTHEASTERLY AND HAVING A RADIUS OF 218.00 FEET FOR AN ARC DISTANCE OF 162.88 FEET TO A POINT OF TANGENCY (THE CHORD OF SAID ARC HAVING A BEARING OF SOUTH 43 DEGREES 09 MINUTES 06 SECONDS WEST FOR A DISTANCE OF 159.12 FEET); THENCE SOUTH 64 DEGREES 33 MINUTES 22 SECONDS WEST ALONG SAID WESTERLY LINE, 393.40 FEET TO A POINT OF CURVE; THENCE SOUTHWESTERLY ALONG SAID WESTERLY LINE, BEING AN ARC OF A CIRCLE CONVEX NORTHWESTERLY AND HAVING A RADIUS OF 192.00 FEET FOR AN ARC DISTANCE OF 130.24 FEET TO A POINT OF COMPOUND CURVE (THE CHORD OF SAID ARC HAVING A BEARING OF SOUTH 45 DEGREES 07 MINUTES 21 SECONDS WEST, A DISTANCE OF 127.76 FEET); THENCE SOUTHERLY ALONG SAID WESTERLY LINE, BEING AN ARC OF A CIRCLE CONVEX NORTHWESTERLY AND HAVING A RADIUS OF 298.62 FEET FOR A DISTANCE OF 127.03 FEET TO A POINT OF TANGENCY (THE CHORD OF SAID ARC HAVING A BEARING OF SOUTH 13 DEGREES 30 MINUTES 11 SECONDS WEST, A DISTANCE OF 126.07 FEET); THENCE SOUTH 01 DEGREES 18 MINUTES 51 SECONDS WEST ALONG SAID WESTERLY LINE, 334.77 FEET; THENCE SOUTH 00 DEGREES 11 MINUTES 43 SECONDS WEST ALONG SAID WESTERLY LINE AND ALONG THE WEST LINE OF LOT 11 IN SAID SUBDIVISION, AS MONUMENTED, 892.96 FEET TO AN ANGLE POINT IN THE WESTERLY LINE OF SAID LOT 11; THENCE NORTH 89 DEGREES 55 MINUTES 18 SECONDS WEST, ALONG SAID WESTERLY LINE, 245.47 FEET TO AN ANGLE POINT IN THE WESTERLY LINE OF SAID LOT 11; THENCE SOUTH 00 DEGREES 11 MINUTES 20 SECONDS WEST ALONG SAID WESTERLY LINE, 355.00 FEET; THENCE NORTH 89 DEGREES 54 MINUTES 34 SECONDS WEST ALONG SAID WESTERLY LINE, 477.97 FEET TO AN ANGLE POINT IN THE WESTERLY LINE OF SAID LOT 11; SAID POINT ALSO BEING ON THE EAST LINE OF THE WEST HALF OF THE NORTHEAST QUARTER OF SECTION 28 AFORESAID, 335.0 FEET NORTH OF THE NORTHEAST CORNER OF THE WEST HALF OF THE SOUTHEAST QUARTER OF SECTION 28 (SAID NORTHEAST CORNER ALSO BEING THE SOUTHEAST CORNER OF THE WEST HALF OF THE NORTHEAST QUARTER OF SECTION 28); THENCE NORTH 00 DEGREES 04 MINUTES 55 SECONDS EAST, 649.78 FEET ALONG THE EAST LINE OF SAID WEST HALF OF THE NORTHEAST QUARTER OF SECTION 28 TO THE NORTH LINE OF THE SOUTH 15 ACRES OF THE EAST HALF OF THE SAID WEST HALF OF THE NORTHEAST QUARTER OF SAID SECTION 28 (SAID SOUTH LINE ALSO BEING THE NORTH LINE OF LAKE AVENUE SUBDIVISION RECORDED AUGUST 29, 1974 AS DOCUMENT #22832239); THENCE NORTH 89 DEGREES 53 MINUTES 58 SECONDS WEST, ALONG SAID NORTH LINE, 663.85 FEET TO THE EAST LINE OF THE WEST HALF OF THE WEST HALF OF THE NORTHEAST QUARTER OF SAID SECTION 28 (SAID

# UNOFFICIAL COPY

EAST LINE BEING ALSO THE EAST LINE OF LAKE GREENWOOD INDUSTRIAL PARK, A SUBDIVISION RECORDED SEPTEMBER 10, 1963 AS DOCUMENT #18908088); THENCE NORTH 00 DEGREES 02 MINUTES 18 SECONDS EAST ALONG SAID EAST LINE, 241.01 FEET TO THE NORTH LINE OF THE SOUTH 1226.0 FEET OF THE WEST HALF OF THE NORTHEAST QUARTER OF SAID SECTION 28 (BEING ALSO THE NORTH LINE OF LAKE GREENWOOD INDUSTRIAL PARK AFORESAID); THENCE SOUTH 89 DEGREES 52 MINUTES 52 SECONDS EAST, 302.49 FEET; THENCE SOUTH 00 DEGREES 07 MINUTES 08 SECONDS WEST AT RIGHT ANGLES TO THE LAST DESCRIBED COURSE, 68.83 FEET; THENCE SOUTH 89 DEGREES 52 MINUTES 52 SECONDS EAST AT RIGHT ANGLES TO THE LAST DESCRIBED COURSE, 461.37 FEET; THENCE NORTH 00 DEGREES 07 MINUTES 08 SECONDS EAST AT RIGHT ANGLES TO THE LAST DESCRIBED COURSE, 340.26 FEET; THENCE SOUTH 89 DEGREES 52 MINUTES 52 SECONDS EAST, AT RIGHT ANGLES TO THE LAST DESCRIBED COURSE, 309.38 FEET; THENCE NORTH 00 DEGREES 07 MINUTES 08 SECONDS EAST, AT RIGHT ANGLES TO THE LAST DESCRIBED COURSE, 353.08 FEET; THENCE NORTH 89 DEGREES 52 MINUTES 52 SECONDS WEST, AT RIGHT ANGLES TO THE LAST DESCRIBED COURSE, 44.64 FEET; THENCE NORTH 00 DEGREES 07 MINUTES 08 SECONDS EAST, AT RIGHT ANGLES TO THE LAST DESCRIBED COURSE, 746.90 FEET; THENCE NORTH 89 DEGREES 52 MINUTES 52 SECONDS WEST AT RIGHT ANGLES TO THE LAST DESCRIBED COURSE, 222.79 FEET; THENCE NORTH 00 DEGREES 07 MINUTES 08 SECONDS EAST AT RIGHT ANGLES TO THE LAST DESCRIBED COURSE, 45.05 FEET TO THE POINT OF BEGINNING, IN COOK COUNTY, ILLINOIS.

Cook County Clerk's Office

# UNOFFICIAL COPY

G:\Psd\ata\9000\9100\9100.01 - Glenview\9100.01-5 - LTS & legal\Legal Descriptions\08-23-07 Revised Legal Description - Development Parcel - Parcel 2.doc

## PARCEL 2 - DEVELOPMENT PARCEL

THAT PART OF THE NORTH HALF OF SECTION 28, TOWNSHIP 42 NORTH, RANGE 12 EAST OF THE THIRD PRINCIPAL MERIDIAN, DESCRIBED AS FOLLOWS: COMMENCING AT THE NORTHEAST CORNER OF THE WEST HALF OF THE NORTHEAST QUARTER OF SAID SECTION 28, HAVING MEASURED ILLINOIS STATE PLANE COORDINATE VALUES OF 1977517.989 NORTH AND 1119646.407 EAST; THENCE SOUTH 89 DEGREES 53 MINUTES 05 SECONDS EAST, ALONG THE NORTH LINE OF THE NORTHEAST QUARTER OF SAID SECTION 28, A DISTANCE OF 142.50 FEET TO THE WEST LINE OF THE EAST 1188.00 FEET OF THE SOUTHEAST QUARTER OF SECTION 21, TOWNSHIP 42 NORTH, RANGE 12 EAST OF THE THIRD PRINCIPAL MERIDIAN, FOR A POINT OF BEGINNING; THENCE SOUTH 00 DEGREES 07 MINUTES 08 SECONDS WEST ALONG THE SOUTHERLY EXTENSION OF SAID WEST LINE, 45.05 FEET; THENCE SOUTH 89 DEGREES 52 MINUTES 52 SECONDS EAST AT RIGHT ANGLES TO THE LAST DESCRIBED COURSE, 222.79 FEET; THENCE SOUTH 00 DEGREES 07 MINUTES 08 SECONDS WEST AT RIGHT ANGLES TO THE LAST DESCRIBED COURSE, 746.90 FEET; THENCE SOUTH 89 DEGREES 52 MINUTES 52 SECONDS EAST, AT RIGHT ANGLES TO THE LAST DESCRIBED COURSE, 44.64 FEET; THENCE SOUTH 00 DEGREES 07 MINUTES 08 SECONDS WEST, AT RIGHT ANGLES TO THE LAST DESCRIBED COURSE, 353.08 FEET; THENCE NORTH 89 DEGREES 52 MINUTES 52 SECONDS WEST, AT RIGHT ANGLES TO THE LAST DESCRIBED COURSE, 309.38 FEET; THENCE SOUTH 00 DEGREES 07 MINUTES 08 SECONDS WEST, AT RIGHT ANGLES TO THE LAST DESCRIBED COURSE, 340.26 FEET; THENCE NORTH 89 DEGREES 52 MINUTES 52 SECONDS WEST, AT RIGHT ANGLES TO THE LAST DESCRIBED COURSE, 461.37 FEET; THENCE NORTH 00 DEGREES 07 MINUTES 08 SECONDS EAST, AT RIGHT ANGLES TO THE LAST DESCRIBED COURSE, 68.83 FEET; THENCE NORTH 89 DEGREES 52 MINUTES 52 SECONDS WEST, AT RIGHT ANGLES TO THE LAST DESCRIBED COURSE, 302.49 FEET TO THE NORTHEAST CORNER OF LAKE GREENWOOD INDUSTRIAL PARK, RECORDED AS DOCUMENT NUMBER 18908058, COOK COUNTY, ILLINOIS; THENCE NORTH 89 DEGREES 50 MINUTES 14 SECONDS WEST, ALONG THE NORTHERLY LINE OF SAID SUBDIVISION, 663.88 FEET TO THE NORTHEASTERLY CORNER OF LOT 1 IN FOUR COLUMN'S RESUBDIVISION, RECORDED AS DOCUMENT NUMBER 3167963, COOK COUNTY, ILLINOIS; THENCE NORTH 89 DEGREES 56 MINUTES 28 SECONDS WEST, ALONG THE NORTHERLY LINE OF SAID FOUR COLUMN'S RESUBDIVISION, 218.58 FEET TO A POINT OF CURVATURE; THENCE SOUTHWESTERLY, ALONG SAID NORTHERLY LINE, BEING A CURVE CONCAVE SOUTHERLY, TANGENT TO THE LAST DESCRIBED COURSE, HAVING A RADIUS OF 458.34 FEET, A CHORD BEARING OF SOUTH 71 DEGREES 43 MINUTES 13 SECONDS WEST, A CHORD DISTANCE OF 288.40 FEET, AN ARC LENGTH OF 293.38 FEET TO THE POINT OF TANGENCY OF THE NORTHERLY LINE OF LOT 2 IN SAID RESUBDIVISION, SAID POINT BEING ON THE SOUTHEASTERLY RIGHT-OF-WAY LINE OF THE CHICAGO AND

# UNOFFICIAL COPY

NORTHWESTERN RAILROAD; THENCE NORTH 35 DEGREES 03 MINUTES 52 SECONDS EAST, ALONG SAID SOUTHEASTERLY RIGHT-OF-WAY LINE, 1838.68 FEET TO THE NORTH LINE OF THE NORTHEAST 1/4 OF SAID SECTION 28; THENCE SOUTH 89 DEGREES 53 MINUTES 05 SECONDS EAST ALONG SAID NORTH LINE, 908.74 FEET TO THE POINT OF BEGINNING; ALL IN COOK COUNTY, ILLINOIS.

Property of Cook County Clerk's Office

# UNOFFICIAL COPY

G:\Psdatal9000\9100\9100.02 - FORRESTAL\9100.02-4 - Mainside & Hospital Cove\Legal Descriptions\08-27-07 legal description.doc

## PARCEL 1

THAT PART OF THE SOUTHEAST QUARTER OF SECTION 4 AND THAT PART OF THE NORTHEAST QUARTER OF SECTION 9, BOTH IN TOWNSHIP 44 NORTH, RANGE 12, EAST OF THE THIRD PRINCIPAL MERIDIAN, DESCRIBED AS FOLLOWS: COMMENCING AT THE NORTHEAST CORNER OF LOT 1 IN JOHN L. HAAS SHORE ACRES ESTATES, RECORDED AS DOCUMENT 1765747, LAKE COUNTY, ILLINOIS; SAID POINT ALSO BEING ON THE NORTH LINE OF THE SOUTH HALF OF SAID SECTION 9; THENCE SOUTH 89 DEGREES 56 MINUTES 42 SECONDS EAST, ALONG SAID NORTH LINE, 845.91 FEET; THENCE NORTH 00 DEGREES 03 MINUTES 18 SECONDS EAST, AT RIGHT ANGLES TO THE LAST DESCRIBED COURSE, A DISTANCE OF 1752.49 FEET FOR A POINT OF BEGINNING; SAID POINT OF BEGINNING HAVING MEASURED STATE PLANE COORDINATE VALUES OF 2055804.42 NORTH AND 1119473.59 EAST; THENCE NORTH 79 DEGREES 39 MINUTES 34 SECONDS WEST, 129.02 FEET; THENCE NORTH 16 DEGREES 33 MINUTES 05 SECONDS WEST, 13.96 FEET; THENCE NORTH 00 DEGREES 10 MINUTES 25 SECONDS EAST, 1335.69 FEET; THENCE SOUTH 89 DEGREES 54 MINUTES 52 SECONDS EAST, 79.73 FEET; THENCE NORTH 00 DEGREES 42 MINUTES 09 SECONDS WEST, 112.65 FEET; THENCE NORTH 89 DEGREES 54 MINUTES 30 SECONDS EAST, 135.68 FEET; THENCE SOUTH 01 DEGREES 05 MINUTES 18 SECONDS EAST, 113.14 FEET; THENCE SOUTH 89 DEGREES 38 MINUTES 19 SECONDS EAST, 73.22 FEET; THENCE SOUTH 05 DEGREES 11 MINUTES 42 SECONDS WEST, 103.61 FEET; THENCE SOUTH 23 DEGREES 02 MINUTES 11 SECONDS WEST, 106.19 FEET; THENCE SOUTH 00 DEGREES 06 MINUTES 32 SECONDS WEST, 38.46 FEET; THENCE SOUTH 20 DEGREES 23 MINUTES 48 SECONDS EAST, 79.47 FEET; THENCE SOUTH 37 DEGREES 23 MINUTES 13 SECONDS WEST, 91.94 FEET; THENCE SOUTH 07 DEGREES 27 MINUTES 05 SECONDS EAST, 91.48 FEET; THENCE SOUTH 01 DEGREES 43 MINUTES 19 SECONDS WEST, 126.33 FEET; THENCE SOUTH 15 DEGREES 35 MINUTES 54 SECONDS WEST, 180.77 FEET; THENCE SOUTH 01 DEGREES 27 MINUTES 01 SECONDS WEST, 257.60 FEET; THENCE SOUTH 12 DEGREES 12 MINUTES 49 SECONDS WEST, 113.49 FEET; THENCE SOUTH 03 DEGREES 08 MINUTES 20 SECONDS WEST, 225.30 FEET TO THE POINT OF BEGINNING; CONTAINING 6.603 ACRES (287,610 SQUARE FEET), MORE OR LESS, ALL IN LAKE COUNTY, ILLINOIS.

## PARCEL 2

THAT PART OF THE NORTHEAST QUARTER OF SECTION 9, TOWNSHIP 44 NORTH, RANGE 12, EAST OF THE THIRD PRINCIPAL MERIDIAN, DESCRIBED AS FOLLOWS: COMMENCING AT THE NORTHEAST CORNER

# UNOFFICIAL COPY

OF LOT 1 IN JOHN L. HAAS SHORE ACRES ESTATES, RECORDED AS DOCUMENT 1765747, LAKE COUNTY, ILLINOIS; SAID POINT ALSO BEING ON THE NORTH LINE OF THE SOUTH HALF OF SAID SECTION 9; THENCE SOUTH 89 DEGREES 56 MINUTES 42 SECONDS EAST, ALONG SAID LINE, 460.96 FEET; THENCE NORTH 00 DEGREES 03 MINUTES 18 SECONDS EAST, AT RIGHT ANGLES TO THE LAST DESCRIBED COURSE, 1832.58 FEET FOR A POINT OF BEGINNING; SAID POINT HAVING MEASURED STATE PLANE COORDINATE VALUES OF 2055884.88 NORTH AND 1112088.71 EAST; THENCE NORTH 01 DEGREES 33 MINUTES 52 SECONDS WEST, 163.51 FEET; THENCE NORTH 89 DEGREES 27 MINUTES 09 SECONDS EAST, 109.49 FEET; THENCE SOUTH 00 DEGREES 23 MINUTES 21 SECONDS WEST, 158.40 FEET; THENCE SOUTH 86 DEGREES 38 MINUTES 25 SECONDS WEST, 104.12 FEET TO THE POINT OF BEGINNING; CONTAINING 0.394 ACRES (17,178 SQUARE FEET), MORE OR LESS, ALL IN LAKE COUNTY, ILLINOIS.

## PARCEL 3

THAT PART OF THE NORTHEAST QUARTER OF SECTION 9, TOWNSHIP 44 NORTH, RANGE 12, EAST OF THE THIRD PRINCIPAL MERIDIAN, DESCRIBED AS FOLLOWS: COMMENCING AT THE NORTHEAST CORNER OF LOT 1 IN JOHN L. HAAS SHORE ACRES ESTATES, RECORDED AS DOCUMENT 1765747, LAKE COUNTY, ILLINOIS; SAID POINT ALSO BEING ON THE NORTH LINE OF THE SOUTH HALF OF SAID SECTION 9; THENCE SOUTH 89 DEGREES 56 MINUTES 42 SECONDS EAST, ALONG SAID LINE, 129.09 FEET; THENCE NORTH 00 DEGREES 03 MINUTES 18 SECONDS EAST, AT RIGHT ANGLES TO THE LAST DESCRIBED COURSE, 2199.25 FEET FOR A POINT OF BEGINNING; SAID POINT HAVING MEASURED STATE PLANE COORDINATE VALUES OF 2056251.87 NORTH AND 1118757.19 EAST; THENCE NORTH 00 DEGREES 12 MINUTES 13 SECONDS EAST, 158.52 FEET; THENCE SOUTH 89 DEGREES 48 MINUTES 27 SECONDS EAST, 97.39 FEET; THENCE SOUTH 01 DEGREES 14 MINUTES 03 SECONDS WEST, 159.03 FEET; THENCE NORTH 89 DEGREES 30 MINUTES 57 SECONDS WEST, 94.53 FEET TO THE POINT OF BEGINNING; CONTAINING 0.350 ACRES, (15,235 SQUARE FEET), MORE OR LESS, ALL IN LAKE COUNTY, ILLINOIS.

## PARCEL 4

THAT PART OF THE NORTH HALF OF SECTION 9, TOWNSHIP 44 NORTH, RANGE 12, EAST OF THE THIRD PRINCIPAL MERIDIAN, DESCRIBED AS FOLLOWS: COMMENCING AT THE NORTHEAST CORNER OF LOT 1 IN JOHN L. HAAS SHORE ACRES ESTATES, RECORDED AS DOCUMENT 1765747, LAKE COUNTY, ILLINOIS; SAID POINT ALSO BEING ON THE NORTH LINE OF THE SOUTH HALF OF SAID SECTION 9; THENCE NORTH 89 DEGREES 56 MINUTES 42 SECONDS WEST, ALONG SAID LINE, 57.20



# UNOFFICIAL COPY

FEET; THENCE NORTH 00 DEGREES 03 MINUTES 18 SECONDS EAST, AT RIGHT ANGLES TO THE LAST DESCRIBED COURSE, 2219.28 FEET FOR A POINT OF BEGINNING; SAID POINT HAVING MEASURED STATE PLANE COORDINATE VALUES OF 2056272.07 NORTH AND 1118570.92 EAST; THENCE NORTH 00 DEGREES 32 MINUTES 55 SECONDS EAST, 138.69 FEET; THENCE SOUTH 89 DEGREES 51 MINUTES 33 SECONDS EAST, 143.92 FEET; THENCE SOUTH 00 DEGREES 12 MINUTES 06 SECONDS WEST, 139.47 FEET; THENCE NORTH 89 DEGREES 32 MINUTES 58 SECONDS WEST, 144.76 FEET TO THE POINT OF BEGINNING; CONTAINING 0.461 ACRES, (20,075 SQUARE FEET), MORE OF LESS, ALL IN LAKE COUNTY, ILLINOIS.

## PARCEL 5

THAT PART OF THE NORTH HALF OF SECTION 9, TOWNSHIP 44 NORTH, RANGE 12, EAST OF THE THIRD PRINCIPAL MERIDIAN, DESCRIBED AS FOLLOWS: COMMENCING AT THE NORTHEAST CORNER OF LOT 1 IN JOHN L. HAAS SHORE ACRES ESTATES, RECORDED AS DOCUMENT 1765747, LAKE COUNTY, ILLINOIS; SAID POINT ALSO BEING ON THE NORTH LINE OF THE SOUTH HALF OF SAID SECTION 9; THENCE NORTH 89 DEGREES 56 MINUTES 42 SECONDS WEST, ALONG SAID NORTH LINE, 514.85 FEET; THENCE NORTH 00 DEGREES 03 MINUTES 18 SECONDS EAST, AT RIGHT ANGLES TO THE LAST DESCRIBED COURSE, 1782.09 FEET FOR A POINT OF BEGINNING; SAID POINT HAVING MEASURED STATE PLANE COORDINATE VALUES OF 2055835.32 NORTH AND 1118112.86 EAST; THENCE NORTH 14 DEGREES 46 MINUTES 55 SECONDS WEST, 79.35 FEET; THENCE NORTH 47 DEGREES 21 MINUTES 48 SECONDS EAST, 58.27 FEET; THENCE NORTH 43 DEGREES 53 MINUTES 19 SECONDS EAST, 139.75 FEET; THENCE NORTH 57 DEGREES 42 MINUTES 04 SECONDS EAST, 63.38 FEET; THENCE NORTH 72 DEGREES 16 MINUTES 38 SECONDS EAST, 73.44 FEET; THENCE SOUTH 84 DEGREES 01 MINUTES 35 SECONDS EAST, 111.10 FEET; THENCE SOUTH 70 DEGREES 53 MINUTES 26 SECONDS EAST, 142.70 FEET; THENCE SOUTH 72 DEGREES 18 MINUTES 48 SECONDS EAST, 52.47 FEET; THENCE SOUTH 80 DEGREES 11 MINUTES 57 SECONDS EAST, 146.23 FEET; THENCE SOUTH 22 DEGREES 33 MINUTES 11 SECONDS EAST, 84.39 FEET; THENCE SOUTH 10 DEGREES 05 MINUTES 32 SECONDS WEST, 15.62 FEET; THENCE SOUTH 35 DEGREES 54 MINUTES 06 SECONDS WEST, 20.53 FEET; THENCE SOUTH 74 DEGREES 17 MINUTES 49 SECONDS WEST, 16.17 FEET; THENCE NORTH 71 DEGREES 06 MINUTES 02 SECONDS WEST, 68.83 FEET; NORTH 75 DEGREES 01 MINUTES 26 SECONDS WEST, 36.93 FEET; THENCE NORTH 88 DEGREES 04 MINUTES 36 SECONDS WEST, 44.42 FEET; THENCE NORTH 67 DEGREES 51 MINUTES 34 SECONDS WEST, 85.77 FEET; THENCE NORTH 82 DEGREES 38 MINUTES 19 SECONDS WEST, 120.43 FEET; THENCE NORTH 67 DEGREES 59 MINUTES 32 SECONDS WEST, 46.72 FEET;

# UNOFFICIAL COPY

THENCE SOUTH 63 DEGREES 24 MINUTES 50 SECONDS WEST, 150.12 FEET; THENCE SOUTH 65 DEGREES 24 MINUTES 57 SECONDS WEST, 79.07 FEET; THENCE SOUTH 51 DEGREES 50 MINUTES 30 SECONDS WEST, 61.00 FEET; THENCE SOUTH 64 DEGREES 27 MINUTES 59 SECONDS WEST, 47.60 FEET TO THE POINT OF BEGINNING; CONTAINING 1.933 ACRES, (84,223 SQUARE FEET), MORE OR LESS, ALL IN LAKE COUNTY, ILLINOIS.

## PARCEL 6

THAT PART OF THE NORTHEAST QUARTER OF SECTION 9, TOWNSHIP 44 NORTH, RANGE 12, EAST OF THE THIRD PRINCIPAL MERIDIAN, DESCRIBED AS FOLLOWS: COMMENCING AT THE NORTHEAST CORNER OF LOT 1 IN JOHN L. HAAS SHORE ACRES ESTATES, RECORDED AS DOCUMENT 1765747, LAKE COUNTY, ILLINOIS; SAID POINT ALSO BEING ON THE NORTH LINE OF THE SOUTH HALF OF SAID SECTION 9; THENCE SOUTH 89 DEGREES 56 MINUTES 42 SECONDS EAST, ALONG SAID LINE, 213.83 FEET; THENCE NORTH 00 DEGREES 03 MINUTES 18 SECONDS EAST, AT RIGHT ANGLES TO THE LAST DESCRIBED COURSE, 23.27 FEET TO A POINT HAVING MEASURED STATE PLANE COORDINATE VALUES OF 2054075.81 NORTH AND 1118837.85 EAST; THENCE NORTH 00 DEGREES 16 MINUTES 28 SECONDS EAST, 761.61 FEET; THENCE SOUTH 89 DEGREES 48 MINUTES 37 SECONDS EAST, 140.71 FEET TO THE POINT OF BEGINNING, SAID POINT HAVING MEASURED STATE PLANE COORDINATE VALUES OF 2054836.945 NORTH AND 1118984.213 EAST; THENCE NORTH 00 DEGREES 13 MINUTES 33 SECONDS WEST, 416.56 FEET; THENCE NORTH 87 DEGREES 40 MINUTES 02 SECONDS EAST, 43.26 FEET; THENCE SOUTH 76 DEGREES 34 MINUTES 30 SECONDS EAST, 37.25 FEET; THENCE SOUTH 61 DEGREES 03 MINUTES 49 SECONDS EAST, 24.77 FEET; THENCE SOUTH 03 DEGREES 41 MINUTES 21 SECONDS EAST, 14.94 FEET; THENCE SOUTH 68 DEGREES 04 MINUTES 45 SECONDS EAST, 41.52 FEET; THENCE SOUTH 10 DEGREES 01 MINUTE 10 SECONDS EAST, 90.57 FEET; THENCE SOUTH 27 DEGREES 20 MINUTES 36 SECONDS EAST, 83.28 FEET; THENCE SOUTH 67 DEGREES 29 MINUTES 19 SECONDS WEST, 25.37 FEET; THENCE SOUTH 41 DEGREES 46 MINUTES 49 SECONDS WEST, 50.62 FEET; THENCE SOUTH 20 DEGREES 07 MINUTES 32 SECONDS WEST, 167.16 FEET; THENCE NORTH 89 DEGREES 48 MINUTES 37 SECONDS WEST, 78.37 FEET TO THE POINT OF BEGINNING; CONTAINING 1.275 ACRES (55,518 SQUARE FEET) MORE OR LESS, ALL IN LAKE COUNTY, ILLINOIS.

## PARCEL 7

THAT PART OF THE NORTHEAST QUARTER OF SECTION 9, TOWNSHIP 44 NORTH, RANGE 12, EAST OF THE THIRD PRINCIPAL MERIDIAN, DESCRIBED AS FOLLOWS: COMMENCING AT THE NORTHEAST CORNER

# UNOFFICIAL COPY

OF LOT 1 IN JOHN L. HAAS SHORE ACRES ESTATES, RECORDED AS DOCUMENT 1765747, LAKE COUNTY, ILLINOIS; SAID POINT ALSO BEING ON THE NORTH LINE OF THE SOUTH HALF OF SAID SECTION 9; THENCE SOUTH 89 DEGREES 56 MINUTES 42 SECONDS EAST, ALONG SAID LINE, 213.83 FEET; THENCE NORTH 00 DEGREES 03 MINUTES 18 SECONDS EAST, AT RIGHT ANGLES TO THE LAST DESCRIBED COURSE, 23.27 FEET TO A POINT HAVING MEASURED STATE PLANE COORDINATE VALUES OF 2054075.81 NORTH AND 1118839.85 EAST; THENCE NORTH 00 DEGREES 16 MINUTES 28 SECONDS EAST, 761.61 FEET; THENCE SOUTH 89 DEGREES 48 MINUTES 37 SECONDS EAST, 219.09 FEET; THENCE SOUTH 20 DEGREES 07 MINUTES 32 SECONDS WEST, 17.28 FEET; THENCE SOUTH 12 DEGREES 52 MINUTES 55 SECONDS EAST, 35.89 FEET; THENCE SOUTH 67 DEGREES 52 MINUTES 37 SECONDS EAST, 45.54 FEET; THENCE SOUTH 22 DEGREES 58 MINUTES 09 SECONDS EAST, 41.88 FEET; THENCE SOUTH 88 DEGREES 53 MINUTES 13 SECONDS EAST, 183.39 FEET; THENCE SOUTH 31 DEGREES 30 MINUTES 24 SECONDS WEST, 135.46 FEET; THENCE SOUTH 05 DEGREES 39 MINUTES 01 SECOND WEST, 87.46 FEET; THENCE SOUTH 23 DEGREES 51 MINUTES 30 SECONDS WEST, 56.40 FEET TO THE POINT OF BEGINNING; SAID POINT HAVING MEASURED STATE PLANE COORDINATE VALUES OF 2054472.101 NORTH AND 1119204.310 EAST; THENCE CONTINUING SOUTH 23 DEGREES 51 MINUTES 30 SECONDS WEST, 49.46 FEET; THENCE SOUTH 10 DEGREES 57 MINUTES 17 SECONDS WEST, 68.86 FEET; THENCE SOUTH 07 DEGREES 59 MINUTES 41 SECONDS WEST, 82.02 FEET; THENCE NORTH 88 DEGREES 00 MINUTES 18 SECONDS WEST, 209.48 FEET; THENCE NORTH 00 DEGREES 07 MINUTES 53 SECONDS EAST, 186.70 FEET; THENCE NORTH 89 DEGREES 58 MINUTES 04 SECONDS EAST, 252.88 FEET; TO THE POINT OF BEGINNING; CONTAINING 0.987 ACRES (42,975 SQUARE FEET) MORE OR LESS, ALL IN LAKE COUNTY, ILLINOIS.

RELEASE PROPERTY

THAT PART OF THE NORTHEAST QUARTER OF SECTION 9, TOWNSHIP 44 NORTH, RANGE 12, EAST OF THE THIRD PRINCIPAL MERIDIAN, DESCRIBED AS FOLLOWS: COMMENCING AT THE NORTHEAST CORNER OF LOT 1 IN JOHN L. HAAS SHORE ACRES ESTATES, RECORDED AS DOCUMENT 1765747, LAKE COUNTY, ILLINOIS; SAID POINT ALSO BEING ON THE NORTH LINE OF THE SOUTH HALF OF SAID SECTION 9; THENCE SOUTH 89 DEGREES 56 MINUTES 42 SECONDS EAST, ALONG SAID LINE, 213.83 FEET; THENCE NORTH 00 DEGREES 03 MINUTES 18 SECONDS EAST, AT RIGHT ANGLES TO THE LAST DESCRIBED COURSE, 23.27 FEET FOR A POINT OF BEGINNING, SAID POINT HAVING MEASURED STATE PLANE COORDINATE VALUES OF 2054075.81 NORTH AND 1118839.85 EAST; THENCE NORTH 00 DEGREES 16 MINUTES 28 SECONDS EAST, 532.30 FEET; THENCE NORTH 89 DEGREES 39 MINUTES 25 SECONDS

# UNOFFICIAL COPY

EAST, 60.00 FEET; THENCE NORTH 00 DEGREES 16 MINUTES 28 SECONDS EAST, 35.00 FEET; THENCE SOUTH 89 DEGREES 39 MINUTES 25 SECONDS WEST, 60.00 FEET; THENCE NORTH 00 DEGREES 16 MINUTES 28 SECONDS EAST, 194.31 FEET; THENCE SOUTH 89 DEGREES 48 MINUTES 37 SECONDS EAST, 219.09 FEET; THENCE SOUTH 20 DEGREES 07 MINUTES 32 SECONDS WEST, 17.28 FEET; THENCE SOUTH 12 DEGREES 52 MINUTES 55 SECONDS EAST, 35.89 FEET; THENCE SOUTH 67 DEGREES 52 MINUTES 37 SECONDS EAST, 45.54 FEET; THENCE SOUTH 22 DEGREES 58 MINUTES 09 SECONDS EAST, 41.88 FEET; THENCE SOUTH 88 DEGREES 53 MINUTES 13 SECONDS EAST, 183.39 FEET; THENCE SOUTH 31 DEGREES 30 MINUTES 24 SECONDS WEST, 135.46 FEET; THENCE SOUTH 05 DEGREES 39 MINUTES 01 SECOND WEST, 87.46 FEET; THENCE SOUTH 23 DEGREES 51 MINUTES 30 SECONDS WEST, 105.86 FEET; THENCE SOUTH 10 DEGREES 57 MINUTES 17 SECONDS WEST, 68.86 FEET; THENCE SOUTH 07 DEGREES 36 MINUTES 41 SECONDS WEST, 82.02 FEET; THENCE SOUTH 18 DEGREES 02 MINUTES 46 SECONDS WEST, 80.50 FEET; THENCE SOUTH 01 DEGREE 23 MINUTES 16 SECONDS WEST, 105.12 FEET; THENCE SOUTH 13 DEGREES 54 MINUTES 26 SECONDS WEST, 22.83 FEET; THENCE NORTH 89 DEGREES 40 MINUTES 30 SECONDS WEST, 287.54 FEET TO THE POINT OF BEGINNING;

EXCEPT THAT PART DESCRIBED AS FOLLOWS: COMMENCING AT THE NORTHEAST CORNER OF LOT 1 IN JOHN L. HAAS SHORE ACRES ESTATES, RECORDED AS DOCUMENT 1765747, LAKE COUNTY, ILLINOIS; SAID POINT ALSO BEING ON THE NORTH LINE OF THE SOUTH HALF OF SAID SECTION 9; THENCE SOUTH 89 DEGREES 56 MINUTES 42 SECONDS EAST, ALONG SAID LINE, 213.83 FEET; THENCE NORTH 00 DEGREES 03 MINUTES 18 SECONDS EAST, AT RIGHT ANGLES TO THE LAST DESCRIBED COURSE, 23.27 FEET TO A POINT HAVING MEASURED STATE PLANE COORDINATE VALUES OF 2054075.81 NORTH AND 1118839.85 EAST; THENCE NORTH 00 DEGREES 16 MINUTES 28 SECONDS EAST, 761.61 FEET; THENCE SOUTH 89 DEGREES 48 MINUTES 37 SECONDS EAST, 219.09 FEET; THENCE SOUTH 20 DEGREES 07 MINUTES 32 SECONDS WEST, 17.28 FEET; THENCE SOUTH 12 DEGREES 52 MINUTES 55 SECONDS EAST, 35.89 FEET; THENCE SOUTH 67 DEGREES 52 MINUTES 37 SECONDS EAST, 45.54 FEET; THENCE SOUTH 22 DEGREES 58 MINUTES 09 SECONDS EAST, 41.88 FEET; THENCE SOUTH 88 DEGREES 53 MINUTES 13 SECONDS EAST, 183.39 FEET; THENCE SOUTH 31 DEGREES 30 MINUTES 24 SECONDS WEST, 135.46 FEET; THENCE SOUTH 05 DEGREES 39 MINUTES 01 SECOND WEST, 87.46 FEET; THENCE SOUTH 23 DEGREES 51 MINUTES 30 SECONDS WEST, 56.40 FEET TO THE POINT OF BEGINNING; SAID POINT HAVING MEASURED STATE PLANE COORDINATE VALUES OF 2054472.101 NORTH AND 1119204.310 EAST; THENCE CONTINUING SOUTH 23 DEGREES 51 MINUTES 30 SECONDS WEST, 49.46 FEET; THENCE SOUTH 10 DEGREES 57 MINUTES 17

# UNOFFICIAL COPY

SECONDS WEST, 68.86 FEET; THENCE SOUTH 07 DEGREES 36 MINUTES  
41 SECONDS WEST, 82.02 FEET; THENCE NORTH 88 DEGREES 00  
MINUTES 18 SECONDS WEST, 209.48 FEET; THENCE NORTH 00 DEGREES  
07 MINUTES 53 SECONDS EAST, 186.70 FEET; THENCE NORTH 89  
DEGREES 58 MINUTES 04 SECONDS EAST, 252.88 FEET; TO THE POINT  
OF BEGINNING;

ALL IN LAKE COUNTY, ILLINOIS.

CONTAINING 4.831 ACRES (210,424 SQUARE FEET) MORE OR LESS

Property of Cook County Clerk's Office

# UNOFFICIAL COPY

**EXHIBIT B**

**EXISTING ENCUMBRANCES**

[TO BE ATTACHED]

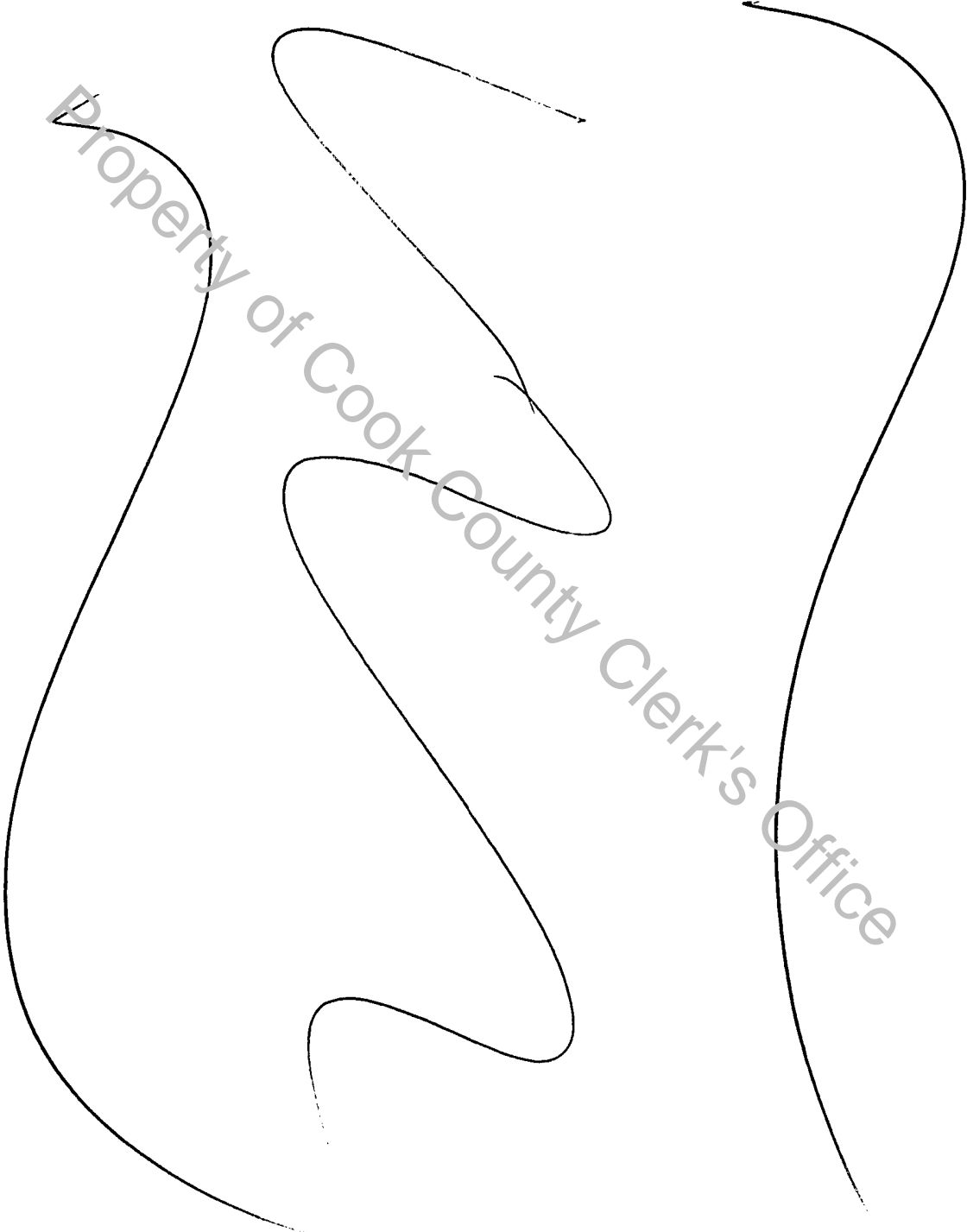

Property of Cook County Clerk's Office

# UNOFFICIAL COPY

## PERMITTED ENCUMBRANCES (Illinois)

Intergovernmental boundary agreement among the cities of Highland Park, Lake Forest, and Highwood dated October 25, 1995 and recorded October 27, 1995 as document number 3740946 concerning the orderly division of the land and territory comprising the Fort Sheridan federal military reserve and the disconnection and annexation of the same into the aforesaid municipalities.

Environmental No Further Remediation Letters contemplated by the Illinois Responsible Property Transfer Act as follow:

- A) recorded October 29, 2001 as document number 4790193 (building 384)
- B) recorded October 29, 2001 as document number 4790194 (building 377)
- C) recorded October 29, 2001 as document number 4790195 (building 368)
- D) recorded October 29, 2001 as document number 4790196 (building 209)
- E) recorded October 29, 2001 as document number 4790197 (building 67)
- F) recorded October 29, 2001 as document number 4790198 (building 494)
- G) recorded October 29, 2001 as document number 4790199 (building 440)
- H) recorded October 29, 2001 as document number 4790200 (building 142)
- I) recorded March 23, 1998 as document number 4105996 (building 117)
- J) recorded March 23, 1998 as document number 4105997 (building 117)

Rights of the Chicago Telephone Company to erect and maintain poles and wires, created by grant from The Board of Highway Commissioners recorded February 20, 1883 as document number 27762.

Rights of The Postal Telegraph Company to construct and maintain a line of telegraph poles created by grant from the Board of Supervisors of Lake County recorded December 3, 1901 as document number 84029.

Reservation of right-of-way contained in deed from Sarah Peck et al to William Duddles dated April 2, 1883, and cited in deed from Gracie Stewart and Nellie Pullman Stewart to the United States of America dated May 19, 1905 and recorded June 10, 1905 as document number 100443. (affects part of the premises in the northeast 1/4 of the northwest 1/4 of section 9)

Easement for utility purposes in favor of Illinois Bell Telephone Company and Public Service Company of Northern Illinois created by grant from Corbetta-Price Co., Inc. recorded July 13, 1951 as document number 732650

Easement for utility purposes in favor of Illinois Bell Telephone Company and Public Service Company of Northern Illinois, created by grant from Corbett-Price Co., Inc. recorded November 7, 1952 as document number 773928.

Easement for utility purposes in favor of North Shore Gas Company created by grant from the United States of America acting by and through the Department of the Navy recorded April 3, 1964 as document number 1220833. (affects the north part of the premises along Buckley Road, also known as Downey Road)

Easement for construction, installation, use, operation, maintenance, repair, and replacement of existing storm water sewers in favor of the State of Illinois, Department of Transportation, created by grant from the United States of America acting by and through the Department of the Navy recorded January 19, 1999 as document number 4279654.

# UNOFFICIAL COPY

Easements in favor of the State of Illinois for the construction, use, maintenance, operation, and repair of a road, created by grant from the United States of America, acting by and through the Department of the Navy, dated March 25, 1963 and recorded July 14, 1967 as document number 1343737, and by grant from the United States of America, acting by and through the Department of the Navy, recorded March 15, 1979 as document number 1983185. (Buckley Road and Green Bay Road)

Provisions in judgment on the declaration of taking entered October 26, 1942 in US District Court, Eastern Division, case no. 48142, recorded October 29, 1942 as document number 570421, providing that the title vested in the United States of America is subject to public utility easements, existing drainage easements, and right of the public to use the boundary roads of the area.

Easement for 16 inch water main disclosed by leases recorded as document numbers 1026984 and 1026989. (affects a 15 foot wide strip running generally east and west across the middle approximately of that portion of the property in section 5)

Easement for steam line disclosed by lease recorded as document number 1026984. (affects a 15 foot wide strip in the northeast corner of the property)

Easement for gas main disclosed by lease recorded as document number 1026984. (affects a 10 foot wide strip in former borrow Avenue, vacated by ordinance recorded as document number 1305900)

Easement in favor of the City of North Chicago for construction and operation of a traffic signal, created by grant from the United States of America recorded September 14, 1984 as document number 2309972. (affects an area at Green Bay Road and Saratoga Street)

Easements in favor of the State of Illinois for construction, use, maintenance, operation, and repair of roads and construction, contained in grant from the United States of America recorded July 14, 1967 as document number 1343737.

Easement in favor of the State of Illinois for highway for Lewis Avenue created by grant from The Administrator of Veterans Affairs recorded October 7, 1957 as document

Easements for utility purposes in favor of Chicago Telephone Company created by grants from Joseph Masterson recorded July 15, 1914 as document number 154231 and November 6, 1914 as document number 156180. (affects that part of the property in the northwest 1/4 of section 8)

Easement in favor of Chicago Telephone Company for utility purposes created by grant from George Herrick and W. Herrick recorded July 15, 1914 as document number 154236. (affects that portion of the property in the north half of section 8)

Easement for utility purposes in favor of Chicago Telephone Company created by grant from McGuire & Orr recorded July 15, 1914 as document number 154255. (affects that portion of the premises in the north half of section 8)



# UNOFFICIAL COPY

Easement in favor of the State of Illinois for highway for Lewis Avenue created by grant from The Administrator of Veterans Affairs recorded October 7, 1957 as document number 967659.

Easement in created by USA recorded April 14, 1961 as document number 1105080.

Ordinance of the City of North Chicago passed February 5, 1951 and recorded February 27, 1951 as document number 721394 establishing a building line of 50 feet along Lewis Avenue, as measured along the center of said street.

Rights of the public, State of Illinois, and municipality to that part of the land if any taken or used for Buckley Road as granted in deed recorded as document number 1155865 and temporary easements for construction, and as shown on plat recorded as document number 2432304, recorded as document number 2471970.

Easement in favor of Chicago Telephone Company for utility purposes created by grant from George Herrick and W. Herrick recorded July 15, 1914 as document number 154236.  
(affects that part of the premises in the north half of section 8)

Easement for utility purposes in favor of Chicago Telephone Company created by grant from W. W. Bulkley recorded July 15, 1914 as document number 154238.  
(affects that part of the premises in the north half of section 8)

Easement for utility purposes in favor of Chicago Telephone Company created by grant from McGuire & Orr recorded July 15, 1914 as document number 154255. (affects that part of the premises in the north 1/2 of section 8)

Easement for construction, installation, operation, maintenance, repair, and replacement of a paved road in favor of The Village of Glenview created by grant from The United States of America dated May 24, 2001 and recorded June 21, 2001 as Document Number 00010545591.  
(Affects an area in the east half of the northeast 1/4 of section 28 immediately south of The Glen Sub No. 2)

Notice of requirements for storm water detention of Metropolitan Water Reclamation District of greater Chicago for Glenview Naval Air Station Redevelopment Project - Phase I, recorded March 19, 1998 as document number 98-214005.

Easement in favor of Commonwealth Edison Company for utility purposes created by grant recorded October 4, 1979 as document number 25178782.  
(affects a portion of the north 10 feet of the premises)

Easement for ingress and egress and construction and maintenance of public utilities over a 10 foot wide strip as set forth in deed from William G. Thiel and Emma M. Thiel to Lester W. Kossow and Violet A. Kossow dated March 10, 1941 and recorded March 25, 1941 as document number 12645787.

Covenant contained in deed from John F. W. Werhane to Vaclav Bezdek dated February 27, 1924 and recorded February 28, 1924 as document number 8298024, that grantee will permit a slough or tilling to be laid.

# UNOFFICIAL COPY

Covenant contained in deed from John F. W. Werhane and Minnie K. Werhane to Jacob H., Reinwald and Gertrude Reinwald dated April 19, 1924 and recorded April 26, 1924 as document number 8385698, that grantee will permit a slough or tiling to be laid.

Agreement between John F. W. Werhane, Minnie K. Werhane, and Edward J. McArdle, trustee, dated June 11, 1927 and recorded July 5, 1927 as document number 9705710 concerning construction of sewer drain.

Property of Cook County Clerk's Office