

# UNOFFICIAL COPY

Recording Requested By:  
GMAC MORTGAGE, LLC

When Recorded Return To:  
DOMINIK SOLTYS  
1620 S MICHIGAN AVE #1001  
CHICAGO, IL 60616



Doc#: 0801604003 Fee: \$28.50  
Eugene "Gene" Moore RHSP Fee:\$10.00  
Cook County Recorder of Deeds  
Date: 01/16/2008 08:06 AM Pg: 1 of 3



### SATISFACTION

GMAC MORTGAGE, LLC #:0601691044 "SOLTYS" Lender ID:10025/1702284014 Cook, Illinois PIF: 12/28/2007  
MERS #: 100196368001006892 LRU #: 1-888-679-6377

**FOR THE PROTECTION OF THE OWNER, THIS RELEASE SHALL BE FILED WITH THE RECORDER OR THE REGISTRAR OF TITLES IN WHOSE OFFICE THE MORTGAGE OR DEED OF TRUST WAS FILED.**

KNOW ALL MEN BY THESE PRESENTS that MORTGAGE ELECTRONIC REGISTRATION SYSTEMS, INC. ("MERS") holder of a certain mortgage, made and executed by DOMINIK SOLTYS AND SLOAN LAVERY, originally to MORTGAGE ELECTRONIC REGISTRATION SYSTEMS, INC ("MERS"), in the County of Cook, and the State of Illinois, Dated: 09/22/2006 Recorded: 09/28/2006 as Instrument No.: 0327141124, does hereby acknowledge that it has received full payment and satisfaction of the same, and in consideration thereof, does hereby cancel and discharge said mortgage. Legal: See Exhibit "A" Attached Hereto And By This Reference Made A Part Hereof

Assessor's/Tax ID No. 17-22-301-022-0000, 17-22-301-023-0000, 17-22-301-024-0000, 17-22-301-025-0000, 17-22-301-026-0000, 17-22-301-027-0000, 17-22-301-028-0000, 17-22-301-029-0000, 17-22-301-030-0000, 17-22-301-052-0000

Property Address: 1620 S MICHIGAN AVE #1001, CHICAGO, IL 60616

IN WITNESS WHEREOF, the undersigned, by the officer duly authorized, has duly executed the foregoing instrument.

MORTGAGE ELECTRONIC REGISTRATION SYSTEMS, INC. ("MERS")

On January 7th, 2008

By:   
ASHLEY JOHNSON, Assistant Secretary



STATE OF Iowa  
COUNTY OF Black Hawk

On January 7th, 2008, before me, H DAHLGREN, a Notary Public in and for Black Hawk in the State of Iowa, personally appeared ASHLEY JOHNSON, Assistant Secretary, personally known to me (or proved to me on the basis of satisfactory evidence) to be the person(s) whose name(s) is/are subscribed to the within instrument and acknowledged to me that he/she/they executed the same in his/her/their authorized capacity, and that by his/her/their signature on the instrument the person(s), or the entity upon behalf of which the person(s) acted, executed the instrument.

WITNESS my hand and official seal,

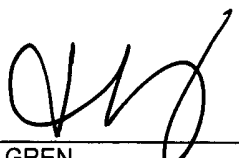

H DAHLGREN  
Notary Expires: 08/23/2010 #748557

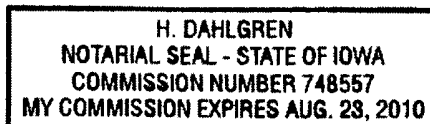

# UNOFFICIAL COPY

Prepared By:

Natesha James, GMAC MORTGAGE, LLC 3451 HAMMOND AVENUE, PO BOX 780, WATERLOO, IA 50704-0780 1-800-766-4622

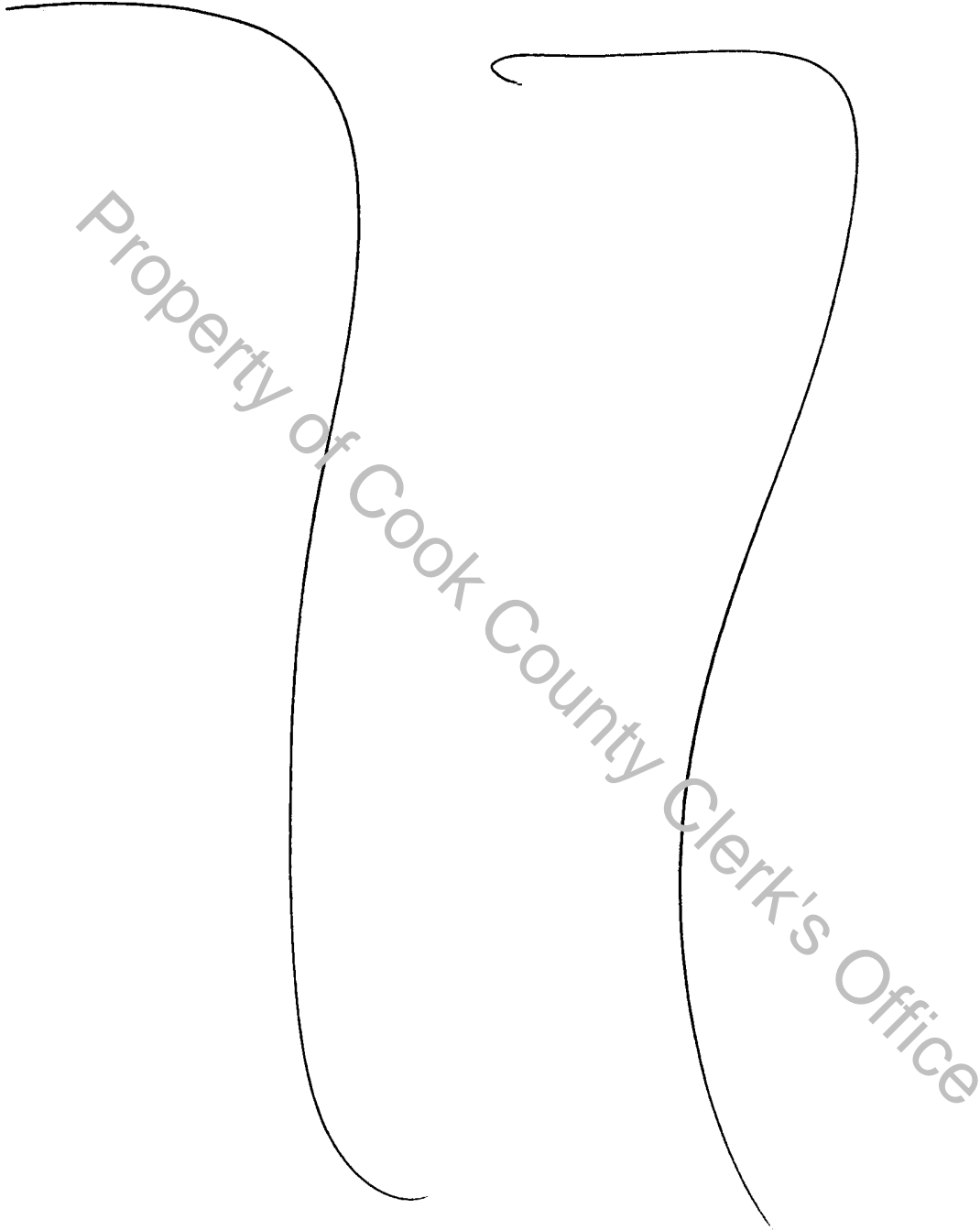

# UNOFFICIAL COPY

**PARCEL 1:**

THE NORTH 25.00 FEET OF LOT 3 IN BLOCK 3 IN CLARKE'S ADDITION TO CHICAGO OF PART OF THE SOUTHWEST FRACTIONAL 1/4 OF SECTION 22, TOWNSHIP 39 NORTH, RANGE 14, EAST OF THE THIRD PRINCIPAL MERIDIAN, IN COOK COUNTY, ILLINOIS.

**PARCEL 2:**

THAT PART OF LOT 3 IN BLOCK 3 IN CLARKE'S ADDITION TO CHICAGO IN THE SOUTHWEST FRACTIONAL 1/4 OF SECTION 22, TOWNSHIP 39 NORTH, RANGE 14, EAST OF THE THIRD PRINCIPAL MERIDIAN, DESCRIBED AS FOLLOWS:

BEGINNING AT A POINT ON THE WEST LINE OF MICHIGAN AVENUE, 25.00 FEET SOUTH OF THE NORTH LINE OF SAID LOT 3; THENCE SOUTH ALONG THE WEST LINE OF MICHIGAN AVENUE TO THE SOUTH LINE OF LOT 3; THENCE NORTH ALONG THE WEST LINE OF SAID LOT TO A POINT 25.00 FEET SOUTH OF THE NORTH LINE OF SAID LOT 3; THENCE EAST ALONG A LINE PARALLEL WITH THE NORTH LINE OF SAID LOT 3 TO THE POINT OF BEGINNING, IN COOK COUNTY, ILLINOIS.

**PARCEL 3:**

ALL OF LOT 4 AND THAT PART OF LOT 5 LYING NORTH OF THE SOUTH 50.65 FEET OF SAID LOT 5 IN BLOCK 3 IN CLARKE'S ADDITION TO CHICAGO, IN THE SOUTHWEST FRACTIONAL QUARTER OF SECTION 22, TOWNSHIP 39 NORTH, RANGE 14 EAST OF THE THIRD PRINCIPAL MERIDIAN, IN COOK COUNTY, ILLINOIS.

**PARCEL 4:**

THE NORTH 28.15 FEET OF THE SOUTH 50.65 FEET OF LOT 5 IN BLOCK 3 IN CLARKE'S ADDITION TO CHICAGO IN THE SOUTHWEST FRACTIONAL 1/4 OF SECTION 22, TOWNSHIP 39 NORTH, RANGE 14 EAST OF THE THIRD PRINCIPAL MERIDIAN, IN COOK COUNTY, ILLINOIS.

**PARCEL 5:**

LOT 6 IN BLOCK 3 IN CLARKE'S ADDITION TO CHICAGO IN THE SOUTHWEST FRACTIONAL 1/4 OF SECTION 22, TOWNSHIP 39 NORTH, RANGE 14 EAST OF THE THIRD PRINCIPAL MERIDIAN, IN COOK COUNTY, ILLINOIS

**PARCEL 6:**

THE NORTH 3 FEET OF LOT 31 IN DEXTER SUBDIVISION OF BLOCK 4 IN THE ASSESSOR'S DIVISION OF THE SOUTHWEST FRACTIONAL 1/4 OF SECTION 22 AFORESAID, IN COOK COUNTY, ILLINOIS.

**PARCEL 7:**

THE SOUTH 22 1/2 FEET OF LOT 5 IN BLOCK 3 IN CLARKE'S ADDITION TO CHICAGO IN THE SOUTHWEST FRACTIONAL 1/4 OF SECTION 22 AFORESAID, ALL IN COOK COUNTY, ILLINOIS

**PARCEL 8:**

THE SOUTH 22 FEET OF LOT 31 AND THE NORTH 1.5 FEET OF LOT 30 IN S. N. DEXTER'S SUBDIVISION OF BLOCK 4 OF ASSESSOR'S DIVISION OF THE SOUTHWEST 1/4 OF SECTION 22, TOWNSHIP 39 NORTH, RANGE 14 EAST OF THE THIRD PRINCIPAL MERIDIAN, IN COOK COUNTY, ILLINOIS

LOAN NUMBER: 0601691044

STATE OF ILLINOIS

PAYOFF DATE: 12/28/2007