

UNOFFICIAL COPY

08129917

1998-12-11 12:00:50
Cook County Recorder 25.50



FOR THE PROTECTION OF THE OWNER, THIS RELEASE SHALL BE FILED WITH THE RECORDER OF DEEDS IN WHOSE OFFICE THE MORTGAGE OR DEED OF TRUST WAS FILED.

COOK COUNTY RECORDER
JESSE WHITE
ROLLING MEADOWS

The above space is for the recorder's use only

KNOW ALL MEN BY THESE PRESENTS, That Corus Bank N.A. F/K/A Madison National Bank of Niles for and in consideration of the Mortgage sum of one dollar, the receipt whereof is hereby confessed, does hereby REMISE, RELEASE, CONVEY and QUIT CLAIM unto Anna Dassonville, being legal representative and assigns, all the right, title, interest, claim or demand whatsoever it may have acquired in, through or by a certain Mortgage bearing date the 10th of August, 1992, and recorded in the Recorder's office of Cook County, in the State of Illinois as Document No. 92612214, to the premises therein described, situated in the County of Cook, in the State of Illinois, to wit:

(see attached)

together with all the appurtenances and privileges thereunto belonging or appertaining.

Permanent Index Number(s): 09-15-100-027-1009

Property Address: 9500 Dee Road, Apt. 201A, Des Plaines, Illinois 60016

IN TESTIMONY WHEREOF, the said, Corus Bank N.A. F/K/A Madison National Bank of Niles, has caused these presents to be signed by its, and attested by its, and its seal to be hereto affixed, this 29th day of September, 1998.

By: [Signature]
Title: _____
Attest: [Signature]
Title: _____

STATE OF ILLINOIS, COUNTY OF COOK

I, the undersigned, a Notary Public in and for said County, in the State aforesaid, DO HEREBY CERTIFY that the above named officers of Corus Bank N.A. F/K/A Madison National Bank of Niles, personally known to me to be the same persons whose names are subscribed to the foregoing instrument as such, respectively, appeared before me this day in person and acknowledged that they signed and delivered the said instrument as their own free and voluntary acts, and as the free and voluntary act of said Bank, for the uses and purposes, therein set forth.

Given under my hand and notarial seal this 29th day of September, 1998.

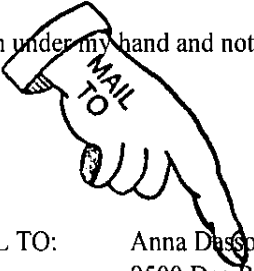

Minal N. Desai
Minal N. Desai Notary Public

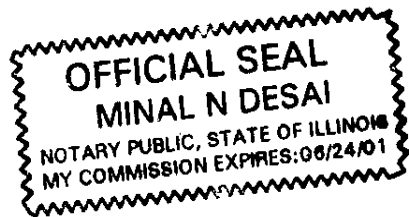

MAIL TO: Anna Dassonville
9500 Dee Road, Apt. 201A, Des Plaines, Illinois 60016
6101 N. SHERIDAN
CHICAGO, IL

PREPARED BY:
CORUS BANK
7727 W. LAKE ST.
RIVER FOREST, IL
60305

3

A

UNOFFICIAL COPY

UNIT NO. 201 A IN COVENTRY PLACE CONDOMINIUM BUILDING NO. 9 AS DELINEATED ON THE SURVEY OF THE FOLLOWING DESCRIBED REAL ESTATE: THAT PART OF THE EAST $\frac{1}{2}$ OF THE NORTH EAST $\frac{1}{4}$ OF THE NORTH WEST $\frac{1}{4}$ OF SECTION 15, TOWNSHIP 41 NORTH, RANGE 12, EAST OF THE THIRD PRINCIPAL MERIDIAN, BOUNDED AND DESCRIBED AS FOLLOWS: COMMENCING AT THE SOUTH-EAST CORNER OF THE NORTH EAST $\frac{1}{4}$ OF THE AFORESAID NORTH WEST $\frac{1}{4}$; THENCE NORTH 527.83 FEET ALONG THE EAST LINE OF SAID NORTHWEST $\frac{1}{4}$; THENCE WEST 155.54 FEET ALONG A LINE DRAWN PERPENDICULARLY TO THE EAST LINE OF SAID NORTHWEST $\frac{1}{4}$, TO THE POINT OF BEGINNING OF THE FOLLOWING DESCRIBED PARCEL OF LAND; THENCE CONTINUING WEST 175.03 FEET ALONG THE WESTERLY EXTENSION OF SAID PERPENDICULAR LINE; THENCE NORTH 73.56 FEET ALONG A LINE DRAWN PARALLEL WITH THE EAST LINE OF THE AFORESAID NORTHWEST $\frac{1}{4}$; THENCE EAST 175.03 FEET ALONG A LINE DRAWN PERPENDICULARLY TO THE EAST LINE OF SAID NORTH WEST $\frac{1}{4}$; THENCE SOUTH 73.56 FEET ALONG A LINE DRAWN PARALLEL WITH THE EAST LINE OF SAID NORTHWEST $\frac{1}{4}$ TO THE HERIN ABOVE DESIGNATED POINT OF BEGINNING, IN COOK COUNTY, ILLINOIS.

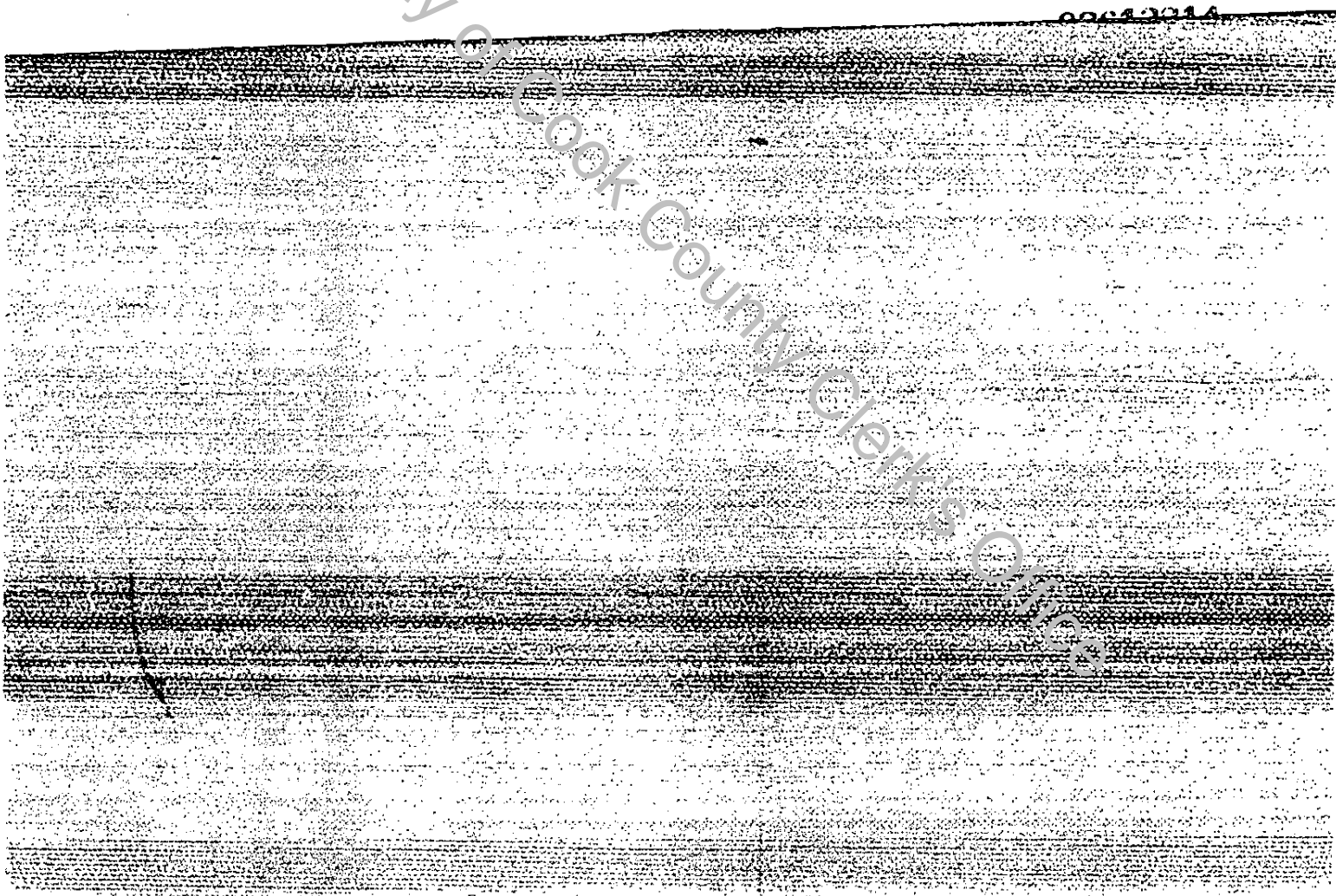

DELANTY AND LAMBERIS AS AN AGENT FOR
COMMONWEALTH LAND TITLE INSURANCE COMPANY
1500 W. SHURE DRIVE, SUITE 120, ARLINGTON HEIGHTS, IL 60004

ALTA Commitment
Schedule A1

File No.: R63957

PROPERTY ADDRESS: 9500 DEE ROAD
UNIT 201 A
DES PLAINES, IL 60016

LEGAL DESCRIPTION

UNIT NO. 201 A IN COVENTRY PLACE CONDOMINIUM BUILDING NO. 9 AS
DELINEATED ON THE SURVEY OF THE FOLLOWING DESCRIBED REAL ESTATE:
THAT PART OF THE EAST 1/2 OF THE NORTHEAST 1/4 OF THE NORTHWEST 1/4 OF
SECTION 15, TOWNSHIP 41 NORTH, RANGE 12, EAST OF THE THIRD PRINCIPAL
MERIDIAN, BOUNDED AND DESCRIBED AS FOLLOWS:
COMMENCING AT THE SOUTHEAST CORNER OF THE NORTHEAST 1/4 OF THE
AFORESAID NORTHWEST 1/4; THENCE NORTH 527.83 FEET ALONG THE EAST LINE
OF SAID NORTHWEST 1/4; THENCE WEST 155.54 FEET ALONG A LINE DRAWN
PERPENDICULARLY TO THE EAST LINE OF SAID NORTHWEST 1/4, TO THE POINT
OF BEGINNING OF THE FOLLOWING DESCRIBED PARCEL OF LAND; THENCE
CONTINUING WEST 175.03 FEET ALONG THE WESTERLY EXTENSION OF SAID
PERPENDICULAR LINE; THENCE NORTH 73.56 FEET ALONG A LINE DRAWN
PARALLEL WITH THE EAST LINE OF THE AFORESAID NORTHWEST 1/4; THENCE
EAST 175.03 FEET ALONG A LINE DRAWN PERPENDICULARLY TO THE EAST LINE OF
SAID NORTHWEST 1/4; THENCE SOUTH 73.56 FEET ALONG A LINE DRAWN
PARALLEL WITH THE EAST LINE OF SAID NORTHWEST 1/4 TO THE HEREINABOVE
DESIGNATED POINT OF BEGINNING, IN COOK COUNTY, ILLINOIS
WHICH SURVEY IS ATTACHED AS EXHIBIT "B" TO THE DECLARATION OF
CONDOMINIUM OWNERSHIP AND OF EASEMENTS, RESTRICTIONS AND COVENANTS FOR
COVENTRY PLACE CONDOMINIUM BUILDING NO. 9, MADE BY HARRIS TRUST AND
SAVINGS BANK, AS TRUSTEE UNDER TRUST NO. 39320 AND RECORDED DECEMBER
31, 1979 AS DOCUMENT NUMBER 25299615, TOGETHER WITH AN UNDIVIDED
7.4221 PERCENT INTEREST IN SAID PARCEL (EXCEPTING FROM SAID PARCEL ALL
THE UNITS THEREOF AS DEFINED AND SET FORTH IN SAID DECLARATION OF
CONDOMINIUM OWNERSHIP AND SURVEY), IN COOK COUNTY, ILLINOIS

PERMANENT INDEX NO.: 09-15-100-027-1009