

UNOFFICIAL COPY



Recording Requested/Prepared By:
Jessie Jelsing
CT Lien Solutions formerly UCC Direct
P.O.Box 29071,
Glendale, CA - 60611
Voice: 800-331-3282

Doc#: 0921515031 Fee: \$114.00
Eugene "Gene" Moore RHSP Fee:\$10.00
Cook County Recorder of Deeds
Date: 08/03/2009 10:03 AM Pg: 1 of 40

When Recorded Return To:
CT Lien Solutions formerly UCC Direct
P.O.Box 29071
Glendale, CA 91209



RELEASE OF MORTGAGE

LOAN #: 343005127 "Rn 120 Company Llc" Cook County Recorder, Illinois

Dated: July 29, 2009

FOR PROTECTION OF OWNER, THIS RELEASE SHALL BE FILED WITH THE RECORDER OR THE REGISTRAR OF TITLES IN WHOSE OFFICE THE MORTGAGE OR DEED OF TRUST WAS FILED.

KNOW ALL MEN BY THESE PRESENTS that the undersigned **WACHOVIA BANK, NATIONAL ASSOCIATION, AS MASTER SERVICER ON BEHALF OF LASALLE BANK, NA, AS TRUSTEE FOR THE BENEFIT OF THE CERTIFICATE HOLDERS OF, COMMERCIAL MORTGAGE PASS-THROUGH CERTIFICATES SERIES LB/UBS 2004 C6 PO BOX 563956 CHARLOTTE, NC 28256-3956** does hereby certify that a certain mortgage executed by **RN 120 COMPANY LLC** to **UBS REAL ESTATE INVESTMENTS INC., LEHMAN BROTHES BANK FSB AND MORGAN STANLEY MORTGAGE CAPITAL INC.** dated **6/14/2004** calling for the original principal sum of dollars (**\$68,350,000.00**), and recorded on **JUNE 18, 2004** in Mortgage Record , page and/or instrument # **0417011218**, of the records in the office of the Recorder of **COOK COUNTY RECORDER, ILLINOIS**, more particularly described as follows, to with:

Loan Amount **\$68,350,000.00**

Tax Parcel ID: **17101160040000**

Property Address: **520 & 540 N Michigan Ave, 516 N Rush St., et al., Chicago, IL 60611**

Legal and/or Assignment: **SEE ATTACHED FOR LEGAL DESCRIPTION**

is hereby fully released and satisfied.

IN WITNESS WHEREOF, the undersigned has hereunto set its corporate hand by its proper officers, they being thereto duly authorized, this **29th** day of **July, 2009**.

SY
M. YES
E

UNOFFICIAL COPY

Dated: July 29, 2009

WACHOVIA BANK, NATIONAL ASSOCIATION, AS MASTER SERVICER ON BEHALF OF, LASALLE BANK, NA, AS TRUSTEE FOR THE BENEFIT OF THE CERTIFICATE HOLDERS OF, COMMERCIAL MORTGAGE PASS-THROUGH CERTIFICATES SERIES LB/UBS 2004 C6 PO BOX 563956 CHARLOTTE, NC 28256-3956

By: 

**ROMMEL CLARIN
ASSISTANT VICE PRESIDENT**

State of **CALIFORNIA**
County of **LOS ANGELES**

On **July 29, 2009**, before me, **Tom Walz** a Notary Public in and for the county of **LOS ANGELES** in the state of **California**, personally appeared **Rommel Clarin, ASSISTANT VICE PRESIDENT OF WACHOVIA BANK, NATIONAL ASSOCIATION, AS MASTER SERVICER ON BEHALF OF, LASALLE BANK, NA, AS TRUSTEE FOR THE BENEFIT OF THE CERTIFICATE HOLDERS OF, COMMERCIAL MORTGAGE PASS-THROUGH CERTIFICATES SERIES LB/UBS 2004 C6 PO BOX 563956 CHARLOTTE, NC 28256-3956**

personally known to me (or proved to me on the basis of satisfactory evidence) to be the person(s) whose name(s) is/are subscribed to the within instrument and acknowledged to me that he/she/they executed the same in his/her/their authorized capacity(ies), and that by his/her/their signature(s) on the instrument the person(s), or the entity on behalf of which the person(s) acted, executed the instrument.

Witness my hand and official seal.



Notary Public
Tom Walz

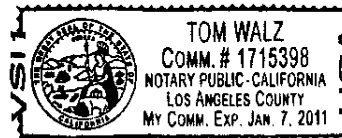

(This area is for notarial seal)

UNOFFICIAL COPY

NATIONAL SURVEY SERVICE, INC.
 PROFESSIONAL LAND SURVEYORS
 30 SOUTH MICHIGAN AVENUE - SUITE 200
 CHICAGO, ILLINOIS 60603-3212
 WEBSITE: www.nssl.net
 PHONE: 312-630-9480
 FAX: 312-630-9484

EXHIBIT "A"

LEGAL DESCRIPTIONS OF GARAGE PARCELS
 LOCATED AT 10 EAST GRAND AVENUE, CHICAGO
 ILLINOIS AND DEPICTED ON DRAWINGS IN
 N125561-SURVEY, PAGES 1 THROUGH 15

S1 SUBTERRANEAN RIGHTS
 L1 LOBBY LEVEL
 L2 FIRST PARKING LEVEL
 L3 SECOND PARKING LEVEL
 L4 THIRD PARKING LEVEL
 L5 FOURTH PARKING LEVEL
 L6 FIFTH PARKING LEVEL
 L7 SIXTH PARKING LEVEL
 L8 SEVENTH PARKING LEVEL
 L9 EIGHTH PARKING LEVEL
 L10 NINTH PARKING LEVEL
 L11 TENTH PARKING LEVEL
 L12 MEETING/POOL LEVEL
 L13 -L23 HOTEL LEVELS
 R1 HOTEL/GARAGE ROOF
 MECHANICAL LEVEL

RN 120 COMPANY, L.L.C.
 UBS REAL ESTATE INVESTMENTS INC.,
 LEHMAN BROTHERS BANK FSB
 MORGAN STANLEY MORTGAGE CAPITAL INC., THEIR SUCCESSORS AND/OR ASSIGNS,
 AS THEY MAY APPEAR,
 FIRST AMERICAN TITLE INSURANCE COMPANY
 NEAR NORTH NATIONAL TITLE CORPORATION

SURVEY NO. N-125561 - SURVEY

MAY 10, 2004

BY

Joseph A. Lim
 ILLINOIS PROFESSIONAL LAND SURVEYOR NO. 3080

UNOFFICIAL COPY

GARAGE PROPERTY

TABLE OF CONTENTS

| | |
|----|---|
| S1 | SUBTERRANEAN RIGHTS GARAGE PARCEL 1-S1 |
| L1 | LOBBY LEVEL GARAGE PARCEL 1 - NORTH LEASE SPACE GARAGE PARCEL 2 GARAGE PARCEL 3 - SOUTH LOBBY, PE-4 & PE-5 GARAGE PARCEL 4 GARAGE PARCEL 5 |
| L2 | FIRST PARKING LEVEL GARAGE PARCEL 1 |
| L3 | SECOND PARKING LEVEL GARAGE PARCEL 1 |
| L4 | THIRD PARKING LEVEL GARAGE PARCEL 1 |
| L5 | FOURTH PARKING LEVEL GARAGE PARCEL 1 |
| L6 | FIFTH PARKING LEVEL GARAGE PARCEL 1 |
| L7 | SIXTH PARKING LEVEL GARAGE PARCEL 1 |

Property of Cook County Clerk's Office

UNOFFICIAL COPY

GARAGE PROPERTY

TABLE OF CONTENTS

- L8 SEVENTH PARKING LEVEL
GARAGE PARCEL 1
- L9 EIGHTH PARKING LEVEL
GARAGE PARCEL 1
- L10 NINTH PARKING LEVEL
GARAGE PARCEL 1
- L11 TENTH PARKING LEVEL
GARAGE PARCEL 1
- L12 MEETING/POOL LEVELS
GARAGE PARCEL 1
- L13-23 HOTEL LEVELS
GARAGE PARCEL 1
- RI GARAGE ROOF/MECHANICAL LEVEL
GARAGE PARCEL 1 (AIR RIGHTS)

NOTE: ELEVATIONS SHOWN ARE IN RELATION TO CITY OF CHICAGO DATUM. CHICAGO CITY DATUM IS 579.48 FEET ABOVE SEA LEVEL DATUM AS DETERMINED BY THE U.S. COAST AND GEODETIC SURVEY (PRESENTLY THE NATIONAL GEODETIC SURVEY) AS DETERMINED BY THE 1929 GENERAL ADJUSTMENT TO THE FIRST ORDER LEVEL NET.

UNOFFICIAL COPY

A large, dark, handwritten scribble consisting of several overlapping, curved lines that form a roughly rectangular shape with jagged edges. The scribble is positioned in the upper center of the page.

Property of Cook County Clerk's Office

S1

SUBTERRANEAN RIGHTS

UNOFFICIAL COPY

G:\legals\L125561\Exhibit A - Garage Property\5561-GP-1-SI.doc
05/19/04

1

GARAGE PARCEL 1-SI (SI SUBTERRANEAN RIGHTS):

THAT PART OF LOTS 9 THROUGH 12, BOTH INCLUSIVE, IN BLOCK 24 IN KINZIE'S ADDITION, TO CHICAGO IN SECTION 10, TOWNSHIP 39 NORTH, RANGE 14 EAST OF THE THIRD PRINCIPAL MERIDIAN, BOUNDED AND DESCRIBED AS FOLLOWS:
COMMENCING AT THE SOUTHWEST CORNER OF LOT 7 IN BLOCK 24 AFORESAID; THENCE NORTH 0 DEGREES 16 MINUTES 11 SECONDS EAST, ALONG THE WEST LINE OF BLOCK 24 AFORESAID, 218.36 FEET TO THE NORTHWEST CORNER OF LOT 6 IN SAID BLOCK 24; THENCE SOUTH 89 DEGREES 42 MINUTES 13 SECONDS EAST, ALONG THE NORTH LINE OF LOTS 5 AND 6 IN BLOCK 24 AFORESAID, 100.16 FEET TO THE NORTHEAST CORNER OF SAID LOT 5; THENCE SOUTH 0 DEGREES 13 MINUTES 09 SECONDS WEST, ALONG THE EAST LINE OF SAID LOT 5 AND ITS SOUTHERLY EXTENSION, 118.14 FEET TO THE NORTHWEST CORNER OF LOT 9 AFORESAID, SAID POINT BEING THE POINT OF BEGINNING OF THE FOLLOWING DESCRIBED PARCEL; THENCE SOUTH 89 DEGREES 43 MINUTES 38 SECONDS EAST, ALONG THE NORTH LINE OF LOTS 9, 10, 11 AND 12 AFORESAID, 200.53 FEET TO THE NORTHEAST CORNER OF SAID LOT 12; THENCE SOUTH 0 DEGREES 07 MINUTES 06 SECONDS WEST, ALONG THE EAST LINE OF SAID LOT 12, BEING ALSO THE EAST LINE OF BLOCK 24 AFORESAID, 100.06 FEET TO THE SOUTHEAST CORNER OF SAID LOT 12; THENCE NORTH 89 DEGREES 45 MINUTES 02 SECONDS WEST, ALONG THE SOUTH LINE OF BLOCK 24 AFORESAID, 200.70 FEET TO THE SOUTHWEST CORNER OF LOT 9 AFORESAID; THENCE NORTH 0 DEGREES 13 MINUTES 09 SECONDS EAST, ALONG THE WEST LINE OF SAID LOT 9, A DISTANCE OF 100.14 FEET TO THE HEREINABOVE DESIGNATED POINT OF BEGINNING;

SAID PARCEL HAVING NO LOWER LIMITS, AND HAVING AS AN UPPER LIMIT A HORIZONTAL PLANE OF ELEVATION +13.50 FEET CHICAGO CITY DATUM, ALL IN COOK COUNTY, ILLINOIS.

AREA = 20,081 SQUARE FEET OR 0.4610 ACRES.

Cook County Clerk's Office

UNOFFICIAL COPY

~~XXXXXXXXXX~~

Property of Cook County Clerk's Office

L1

LOBBY LEVEL

UNOFFICIAL COPY

G:\legals\L125561\Exhibit A - Garage Property\5561-GP-1-L1.doc

05/19/04

1

GARAGE PARCEL 1-L1 -NORTH LEASE SPACE- (L1-LOBBY LEVEL):

THAT PART OF LOTS 5 AND 6, IN BLOCK 24 IN KINZIE'S ADDITION TO CHICAGO IN SECTION 10, TOWNSHIP 39 NORTH, RANGE 14 EAST OF THE THIRD PRINCIPAL MERIDIAN, BOUNDED AND DESCRIBED AS FOLLOWS:

COMMENCING AT THE SOUTHWEST CORNER OF LOT 7 IN BLOCK 24 AFORESAID; THENCE NORTH 0 DEGREES 16 MINUTES 11 SECONDS EAST, ALONG THE WEST LINE OF BLOCK 24 AFORESAID, 158.85 FEET TO A POINT, SAID POINT BEING THE POINT OF BEGINNING OF THE FOLLOWING DESCRIBED PARCEL; THENCE NORTH 0 DEGREES 16 MINUTES 11 SECONDS EAST, ALONG SAID WEST LINE, 59.51 FEET TO THE NORTHWEST CORNER OF LOT 6 AFORESAID; THENCE SOUTH 89 DEGREES 42 MINUTES 13 SECONDS EAST, ALONG THE NORTH LINE OF LOTS 5 AND 6 AFORESAID, 55.24 FEET; THENCE SOUTH 0 DEGREES 14 MINUTES 58 SECONDS WEST, 13.99 FEET; THENCE SOUTH 89 DEGREES 45 MINUTES 02 SECONDS EAST, 17.97 FEET; THENCE SOUTH 0 DEGREES 14 MINUTES 58 SECONDS WEST, 39.77 FEET; THENCE NORTH 89 DEGREES 45 MINUTES 02 SECONDS WEST, 2.69 FEET; THENCE SOUTH 0 DEGREES 14 MINUTES 58 SECONDS WEST, 5.70 FEET; THENCE NORTH 89 DEGREES 45 MINUTES 02 SECONDS WEST, ALONG A LINE DRAWN PARALLEL WITH THE SOUTH LINE OF BLOCK 24 AFORESAID, 70.54 FEET TO THE HEREINABOVE DESIGNATED POINT OF BEGINNING;

SAID PARCEL HAVING AS A LOWER LIMIT A HORIZONTAL PLANE OF +13.50 FEET CHICAGO CITY DATUM AND HAVING AS AN UPPER LIMIT A HORIZONTAL PLANE OF ELEVATION +31.50 FEET CHICAGO CITY DATUM, ALL IN COOK COUNTY, ILLINOIS.

AREA = 4,087.8 SQUARE FEET OR 0.0938 ACRES.

Cook County Clerk's Office

UNOFFICIAL COPY

G:\legals\L125561\Exhibit A - Garage Property\5561-GP-2-L1.doc
05/19/04

1

GARAGE PARCEL 2-L1 (L1-LOBBY LEVEL):

THAT PART OF LOT 5 IN BLOCK 24 IN KINZIE'S ADDITION TO CHICAGO IN SECTION 10, TOWNSHIP 39 NORTH, RANGE 14 EAST OF THE THIRD PRINCIPAL MERIDIAN, BOUNDED AND DESCRIBED AS FOLLOWS:
COMMENCING AT THE SOUTHWEST CORNER OF LOT 7 IN BLOCK 24 AFORESAID; THENCE NORTH 0 DEGREES 16 MINUTES 11 SECONDS EAST, ALONG THE WEST LINE OF BLOCK 24 AFORESAID, 218.36 FEET TO THE NORTHWEST CORNER OF LOT 6, IN BLOCK 24 AFORESAID; THENCE SOUTH 89 DEGREES 42 MINUTES 13 SECONDS EAST, ALONG THE NORTH LINE OF LOT 5 AND 6, IN BLOCK 24 AFORESAID, 78.74 FEET TO THE POINT OF BEGINNING OF THE FOLLOWING DESCRIBED PARCEL; THENCE CONTINUING SOUTH 89 DEGREES 42 MINUTES 13 SECONDS EAST, ALONG SAID NORTH LINE, 21.43 FEET TO THE NORTHEAST CORNER OF SAID LOT 5; THENCE SOUTH 0 DEGREES 13 MINUTES 09 SECONDS WEST, ALONG THE EAST LINE OF SAID LOT 5, A DISTANCE OF 45.71 FEET; THENCE NORTH 89 DEGREES 45 MINUTES 02 SECONDS WEST, 20.60 FEET; THENCE NORTH 0 DEGREES 14 MINUTES 58 SECONDS EAST, PERPENDICULAR TO THE LAST DESCRIBED LINE, 31.73 FEET; THENCE NORTH 89 DEGREES 45 MINUTES 02 SECONDS WEST, 0.85 FEET; THENCE NORTH 0 DEGREES 14 MINUTES 58 SECONDS EAST, 13.99 FEET TO THE HEREINABOVE DESIGNATED POINT OF BEGINNING;

SAID PARCEL HAVING AS A LOWER LIMIT A HORIZONTAL PLANE OF +13.50 FEET CHICAGO CITY DATUM, AND HAVING AS AN UPPER LIMIT A HORIZONTAL PLANE OF ELEVATION +31.50 FEET CHICAGO CITY DATUM, ALL IN COOK COUNTY, ILLINOIS.

AREA = 953.2 SQUARE FEET OR 0.0219 ACRES

Cook County Clerk's Office

UNOFFICIAL COPY

G:\legals\L125561\Exhibit A - Garage Property\5561-GP-3-L1.doc
05/19/04

1

GARAGE PARCEL 3-L1 -SOUTH LOBBY, PE-4 & PE-5- (L1-LOBBY LEVEL):

THAT PART OF LOT 8, IN BLOCK 24 IN KINZIE'S ADDITION TO CHICAGO IN SECTION 10, TOWNSHIP 39 NORTH, RANGE 14 EAST OF THE THIRD PRINCIPAL MERIDIAN, BOUNDED AND DESCRIBED AS FOLLOWS:
COMMENCING AT THE SOUTHWEST CORNER OF LOT 7 IN BLOCK 24 AFORESAID; THENCE SOUTH 89 DEGREES 45 MINUTES 02 SECONDS EAST, ALONG THE SOUTH LINE OF BLOCK 24 AFORESAID, 63.24 FEET TO THE POINT OF BEGINNING OF THE FOLLOWING DESCRIBED PARCEL; THENCE NORTH 0 DEGREES 14 MINUTES 58 SECONDS EAST, PERPENDICULAR TO THE LAST DESCRIBED LINE, 9.12 FEET; THENCE SOUTH 89 DEGREES 45 MINUTES 02 SECONDS EAST, 0.18 FEET; THENCE NORTH 0 DEGREES 14 MINUTES 58 SECONDS EAST, 10.33 FEET; THENCE NORTH 89 DEGREES 45 MINUTES 02 SECONDS WEST, 9.57 FEET; THENCE NORTH 0 DEGREES 14 MINUTES 58 SECONDS EAST, 6.90 FEET; THENCE SOUTH 89 DEGREES 45 MINUTES 02 SECONDS EAST, 9.24 FEET; THENCE NORTH 0 DEGREES 14 MINUTES 58 SECONDS EAST, 3.55 FEET; THENCE SOUTH 89 DEGREES 45 MINUTES 02 SECONDS WEST, 3.51 FEET; THENCE SOUTH 0 DEGREES 14 MINUTES 58 SECONDS WEST, 7.77 FEET; THENCE SOUTH 89 DEGREES 45 MINUTES 02 SECONDS EAST, 7.77 FEET; THENCE SOUTH 89 DEGREES 45 MINUTES 02 SECONDS WEST, 6.72 FEET; THENCE SOUTH 0 DEGREES 14 MINUTES 58 SECONDS WEST, 19.67 FEET TO A POINT ON THE SOUTH LINE OF BLOCK 24 AFORESAID; THENCE NORTH 89 DEGREES 45 MINUTES 02 SECONDS WEST, ALONG SAID SOUTH LINE, 18.90 FEET TO THE HEREINABOVE DESIGNATED POINT OF BEGINNING;

SAID PARCEL HAVING AS A LOWER LIMIT A HORIZONTAL PLANE OF ELEVATION +13.50 FEET CHICAGO CITY DATUM, AND HAVING AS AN UPPER LIMIT A HORIZONTAL PLANE OF ELEVATION +31.50 FEET CHICAGO CITY DATUM, ALL IN COOK COUNTY, ILLINOIS.

AREA = 569.1 SQUARE FEET OR 0.0131 ACRES.

UNOFFICIAL COPY

G:\egals\125561\Exhibit A - Garage Property\5561-GP-4-L1.doc

05/19/04

1

GARAGE PARCEL 4-L1 (L1-LOBBY LEVEL):

THAT PART OF LOTS 11 AND 12, IN BLOCK 24 IN KINZIE'S ADDITION TO CHICAGO IN SECTION 10, TOWNSHIP 39 NORTH, RANGE 14 EAST OF THE THIRD PRINCIPAL MERIDIAN, BOUNDED AND DESCRIBED AS FOLLOWS:

COMMENCING AT THE SOUTHWEST CORNER OF LOT 7 IN BLOCK 24 AFORESAID; THENCE SOUTH 89 DEGREES 45 MINUTES 02 SECONDS EAST, ALONG THE SOUTH LINE OF BLOCK 24 AFORESAID, 208.01 FEET TO THE POINT OF BEGINNING OF THE PARCEL OF LAND HEREIN DESCRIBED; THENCE NORTH 0 DEGREES 14 MINUTES 58 SECONDS EAST, 51.24 FEET; THENCE SOUTH 89 DEGREES 45 MINUTES 02 SECONDS EAST, PERPENDICULAR TO THE LAST DESCRIBED LINE, 24.19 FEET; THENCE NORTH 0 DEGREES 14 MINUTES 58 SECONDS EAST, 21.13 FEET; THENCE SOUTH 89 DEGREES 45 MINUTES 02 SECONDS EAST, 8.24 FEET; THENCE NORTH 0 DEGREES 14 MINUTES 58 SECONDS EAST, 27.71 FEET TO THE POINT OF INTERSECTION WITH THE NORTH LINE OF LOT 11 AFORESAID, SAID POINT BEING 140.16 FEET (AS MEASURED ALONG THE NORTH LINE OF LOTS 9, 10 AND 11 IN BLOCK 24 AFORESAID) EAST OF THE NORTHWEST CORNER OF LOT 9 IN BLOCK 24 AFORESAID; THENCE SOUTH 89 DEGREES 43 MINUTES 38 SECONDS EAST, ALONG THE NORTH LINE OF LOTS 11 AND 12 AFORESAID, 60.37 FEET TO THE NORTHEAST CORNER OF SAID LOT 12; THENCE SOUTH 0 DEGREES 07 MINUTES 06 SECONDS WEST, ALONG THE EAST LINE OF BLOCK 24 AFORESAID, 100.06 FEET TO THE SOUTHEAST CORNER OF LOT 12 AFORESAID; THENCE NORTH 89 DEGREES 45 MINUTES 02 SECONDS WEST, ALONG THE SOUTH LINE OF LOTS 11 AND 12 AFORESAID, 95.07 FEET TO THE HEREINABOVE DESIGNATED POINT OF BEGINNING;

SAID PARCEL HAVING AS A LOWER LIMIT A HORIZONTAL PLANE OF ELEVATION +13.50 FEET CHICAGO CITY DATUM AND HAVING AS AN UPPER LIMIT A HORIZONTAL PLANE OF ELEVATION +31.50 FEET CHICAGO CITY DATUM, ALL IN COOK COUNTY, ILLINOIS.

AREA = 7,888.7 SQUARE FEET OR 0.1811 ACRES.

Cook County Clerk's Office

UNOFFICIAL COPY

G:\legals\L125561\Exhibit A - Garage Property\5561-GP-5-L1.doc

05/19/04

1

GARAGE PARCEL 5-L1 (L1-LOBBY LEVEL):

THAT PART OF LOT 11, IN BLOCK 24 IN KINZIE'S ADDITION TO CHICAGO IN SECTION 10, TOWNSHIP 39 NORTH, RANGE 14 EAST OF THE THIRD PRINCIPAL MERIDIAN, ALL TAKEN AS ONE TRACT BOUNDED AND DESCRIBED AS FOLLOWS:

COMMENCING AT THE SOUTHWEST CORNER OF LOT 7 IN BLOCK 24 AFORESAID; THENCE NORTH 0 DEGREES 16 MINUTES 11 SECONDS EAST, ALONG THE WEST LINE OF BLOCK 24 AFORESAID, 218.36 FEET TO THE NORTHWEST CORNER OF LOT 6 IN BLOCK 24 AFORESAID; THENCE SOUTH 89 DEGREES 42 MINUTES 13 SECONDS EAST, ALONG THE NORTH LINE OF LOTS 5 AND 6 IN BLOCK 24 AFORESAID, 100.16 FEET TO THE NORTHEAST CORNER OF SAID LOT 5; THENCE SOUTH 0 DEGREES 13 MINUTES 09 SECONDS WEST, ALONG THE EAST LINE OF LOT 5 AND ITS SOUTHERLY EXTENSION, 118.14 FEET TO THE NORTHWEST CORNER OF LOT 9 IN BLOCK 24 AFORESAID; THENCE SOUTH 89 DEGREES 43 MINUTES 38 SECONDS EAST, ALONG THE NORTH LINE OF LOTS 9, 10 AND 11, IN BLOCK 24 AFORESAID, 117.91 FEET TO A POINT SAID POINT (HEREINAFTER REFERRED TO AS POINT "A8", SAID POINT ALSO REFERRED TO AS "B5"), BEING 82.62 FEET WEST (AS MEASURED ALONG THE NORTH LINE OF LOTS 11 AND 12 AFORESAID) OF THE NORTHEAST CORNER OF LOT 12 AFORESAID, SAID POINT BEING THE POINT OF BEGINNING OF THE FOLLOWING DESCRIBED PARCEL: THENCE SOUTH 0 DEGREES 14 MINUTES 58 SECONDS WEST, 27.72 FEET TO A POINT (HEREINAFTER REFERRED TO AS POINT "D8", SAID POINT ALSO REFERRED TO AS "A9"); THENCE CONTINUING SOUTH 0 DEGREES 14 MINUTES 58 SECONDS WEST, 11.12 FEET TO A POINT (HEREINAFTER REFERRED TO AS POINT "D9", SAID POINT ALSO REFERRED TO AS "C7"); THENCE SOUTH 0 DEGREES 14 MINUTES 58 SECONDS WEST, 9.92 FEET; THENCE SOUTH 89 DEGREES 45 MINUTES 02 SECONDS EAST, ALONG A LINE DRAWN PARALLEL WITH THE SOUTH LINE OF BLOCK 24 AFORESAID, 14.19 FEET TO POINT (HEREINAFTER REFERRED TO AS POINT "C10"); THENCE NORTH 0 DEGREES 14 MINUTES 58 SECONDS EAST, 9.92 FEET TO A POINT (HEREINAFTER REFERRED TO AS POINT "B10", SAID POINT ALSO REFERRED TO AS "C9"); THENCE CONTINUING NORTH 0 DEGREES 14 MINUTES 58 SECONDS EAST, 11.12 FEET TO A POINT (HEREINAFTER REFERRED TO AS POINT "B9"); THENCE SOUTH 89 DEGREES 45 MINUTES 02 SECONDS EAST, ALONG A LINE DRAWN PARALLEL WITH THE SOUTH LINE OF BLOCK 24 AFORESAID, 8.24 FEET TO A POINT (HEREINAFTER REFERRED TO AS POINT "C8"); THENCE NORTH 0 DEGREE 14 MINUTES 58 SECONDS EAST, 27.71 FEET TO A POINT ON THE NORTH LINE OF LOT 11 AFORESAID, SAID POINT (HEREINAFTER REFERRED TO AS POINT "B8"); THENCE NORTH 89 DEGREES 43 MINUTES 38 SECONDS WEST, ALONG SAID NORTH LINE, 22.25 FEET TO THE HEREINABOVE DESIGNATED POINT OF BEGINNING (POINT "A8");

SAID PARCEL HAVING AS A LOWER LIMIT A HORIZONTAL PLANE OF ELEVATION 13.50 FEET CHICAGO CITY DATUM, AND HAVING AS AN UPPER LIMIT A SERIES OF INCLINED PLANES WHOSE ELEVATIONS ARE SHOWN ON THE TABLE FOLLOWING THE HORIZONTAL LOCATION OF SAID PLANES WHICH ARE DEFINED IN THE FOLLOWING DESCRIBED PARTS OF SAID PARCEL:

PART VIII:

BEGINNING AT THE AFOREMENTIONED POINT "A8"), THENCE SOUTH 0 DEGREES 14 MINUTES 58 SECONDS WEST, 27.72 FEET TO A POINT (HEREINAFTER REFERRED TO AS POINT "D8", SAID POINT ALSO REFERRED TO AS "A9"); THENCE SOUTH 89 DEGREES 45 MINUTES 02 SECONDS EAST, ALONG A LINE DRAWN PARALLEL WITH THE SOUTH LINE OF

UNOFFICIAL COPY

G:\legals\L125561\Exhibit A - Garage Property\5561-GP-5-L1.doc

05/19/04

2

BLOCK 24 AFORESAID, 22.25 FEET TO POINT (HEREINAFTER REFERRED TO AS POINT "C8"); THENCE NORTH 0 DEGREES 14 MINUTES 58 SECONDS EAST, 27.71 FEET TO A POINT ON THE NORTH LINE OF LOT 11 AFORESAID, SAID POINT (HEREINAFTER REFERRED TO AS POINT "B8"); THENCE NORTH 89 DEGREES 43 MINUTES 38 SECONDS WEST, ALONG SAID NORTH LINE, 22.25 FEET TO THE HEREINABOVE DESIGNATED POINT OF BEGINNING (POINT "A8");

ELEVATION TABLE PART VIII

THE AFOREMENTIONED SERIES OF INCLINED PLANES SHALL BE THOSE FORMED BY IRREGULAR QUADRANGULAR SURFACES, (HAVING TWO COMMON VERTICES), LYING ADJACENTLY TO EACH OTHER AND HAVING AS VERTICES THE POINTS WHOSE ELEVATIONS ARE SHOWN IN TABLE BELOW:

| POINT | ELEVATION |
|-------|--------------------|
| | CHICAGO CITY DATUM |
| "A8" | +23.04 |
| "B8" | +20.90 |
| "C8" | +20.88 |
| "D8" | +22.63 |

PART IX:

BEGINNING AT THE AFOREMENTIONED POINT "A9", THENCE SOUTH 0 DEGREES 14 MINUTES 58 SECONDS WEST, 11.12 FEET TO A POINT (HEREINAFTER REFERRED TO AS POINT "D9", SAID POINT ALSO REFERRED TO AS "C7"); THENCE SOUTH 89 DEGREES 45 MINUTES 02 SECONDS EAST, ALONG A LINE DRAWN PARALLEL WITH THE SOUTH LINE OF BLOCK 24 AFORESAID, 14.00 FEET TO POINT (HEREINAFTER REFERRED TO AS POINT "C9", SAID POINT ALSO REFERRED TO AS "B10"); THENCE NORTH 0 DEGREES 14 MINUTES 58 SECONDS EAST, 11.12 FEET TO A POINT (HEREINAFTER REFERRED TO AS POINT "B9"); THENCE NORTH 89 DEGREES 45 MINUTES 02 SECONDS WEST, 14.00 FEET TO THE HEREINABOVE DESIGNATED POINT OF BEGINNING (POINT "A9");

ELEVATION TABLE PART IX

THE AFOREMENTIONED SERIES OF INCLINED PLANES SHALL BE THOSE FORMED BY IRREGULAR QUADRANGULAR SURFACES, (HAVING TWO COMMON VERTICES), LYING ADJACENTLY TO EACH OTHER AND HAVING AS VERTICES THE POINTS WHOSE ELEVATIONS ARE SHOWN IN TABLE BELOW:

| POINT | ELEVATION |
|-------|--------------------|
| | CHICAGO CITY DATUM |
| "A9" | +22.86 |
| "B9" | +21.96 |
| "C9" | +20.93 |
| "D9" | +21.36 |

UNOFFICIAL COPY

G:\legals\L125561\Exhibit A - Garage Property\5561-GP-5-L1.doc
05/19/04

3

PART X:

COMMENCING AT THE AFOREMENTIONED POINT "B10", THENCE NORTH 89 DEGREES 45 MINUTES 02 SECONDS WEST, ALONG A LINE DRAWN PARALLEL WITH THE SOUTH LINE OF BLOCK 24 AFORESAID, 24.08 FEET TO A POINT (HEREINAFTER REFERRED TO AS POINT "A10"), BEING THE POINT OF BEGINNING OF THE FOLLOWING DESCRIBED PART; THENCE SOUTH 0 DEGREES 14 MINUTES 58 SECONDS WEST, 9.92 FEET TO A POINT (HEREINAFTER REFERRED TO AS POINT "D10"); THENCE SOUTH 89 DEGREES 45 MINUTES 02 SECONDS EAST, ALONG A LINE DRAWN PARALLEL WITH THE SOUTH LINE OF BLOCK 24 AFORESAID, 24.08 FEET TO A POINT (HEREINAFTER REFERRED TO AS POINT "C10"); THENCE NORTH 0 DEGREES 14 MINUTES 58 SECONDS EAST, 9.92 FEET TO A POINT (HEREINAFTER REFERRED TO AS POINT "B10"); THENCE NORTH 89 DEGREES 45 MINUTES 02 SECONDS WEST, 24.08 FEET TO THE HEREINABOVE DESIGNATED POINT OF BEGINNING (POINT "A10");

ELEVATION TABLE PART X

THE AFOREMENTIONED SERIES OF INCLINED PLANES SHALL BE THOSE FORMED BY IRREGULAR QUADRANGULAR SURFACES, (HAVING TWO COMMON VERTICES), LYING ADJACENTLY TO EACH OTHER AND HAVING AS VERTICES THE POINTS WHOSE ELEVATIONS ARE SHOWN IN TABLE BELOW:

| POINT | ELEVATION |
|-------|--------------------|
| | CHICAGO CITY DATUM |
| "A10" | +21.64 |
| "B10" | +20.93 |
| "C10" | +20.12 |
| "D10" | +20.24 |

ALL IN COOK COUNTY, ILLINOIS.

AREA = 912.4 SQUARE FEET OR 0.0209 ACRES.

UNOFFICIAL COPY



Property of Cook County Clerk's Office

L2

FIRST PARKING LEVEL

UNOFFICIAL COPY

G:\legals\125561\Exhibit A - Garage Property\5561-GP-1-L2.doc

05/19/04

1

GARAGE PARCEL 1-L2 (L2-FIRST PARKING LEVEL):

THAT PART OF LOTS 5 THROUGH 12, BOTH INCLUSIVE, TOGETHER WITH THAT PART OF THE VACATED 18 FOOT EAST AND WEST ALLEY LYING SOUTH OF AND ADJOINING THE SOUTH LINE OF SAID LOTS 5 AND 6 AND LYING NORTH OF THE NORTH LINE OF SAID LOTS 7 AND 8, IN BLOCK 24 IN KINZIE'S ADDITION TO CHICAGO IN SECTION 10, TOWNSHIP 39 NORTH, RANGE 14 EAST OF THE THIRD PRINCIPAL MERIDIAN, ALL TAKEN AS ONE TRACT BOUNDED AND DESCRIBED AS FOLLOWS:

BEGINNING AT THE SOUTHWEST CORNER OF LOT 7 IN BLOCK 24 AFORESAID; THENCE NORTH 0 DEGREES 16 MINUTES 11 SECONDS EAST, ALONG THE WEST LINE OF BLOCK 24 AFORESAID, 218.36 FEET TO THE NORTHWEST CORNER OF LOT 6 AFORESAID; THENCE SOUTH 0 DEGREES 42 MINUTES 13 SECONDS EAST, ALONG NORTH LINE OF LOTS 5 AND 6 AFORESAID, 54.92 FEET TO A POINT ON THE NORTH LINE OF SAID LOT 5, SAID POINT BEING 45.24 FEET (AS MEASURED ALONG THE NORTH LINE OF LOT 5 AFORESAID) WEST OF ITS NORTHEAST CORNER THEREOF; THENCE SOUTH 0 DEGREES 14 MINUTES 58 SECONDS WEST, 14.49 FEET; THENCE SOUTH 89 DEGREES 45 MINUTES 02 SECONDS EAST, 25.23 FEET; THENCE SOUTH 0 DEGREES 14 MINUTES 58 SECONDS WEST, 32.14 FEET; THENCE SOUTH 89 DEGREES 45 MINUTES 02 SECONDS EAST, 20.05 FEET TO A POINT ON THE EAST LINE OF LOT 5 AFORESAID, SAID POINT BEING 46.61 FEET SOUTH (AS MEASURED ALONG SAID EAST LINE) OF THE NORTHEAST CORNER OF SAID LOT 5; THENCE SOUTH 0 DEGREES 13 MINUTES 09 SECONDS WEST, ALONG SAID EAST LINE AND ITS SOUTHERLY EXTENSION, 71.53 FEET TO A POINT (HEREINAFTER REFERRED TO AS POINT "A4", SAID POINT ALSO REFERRED TO AS "B3" AND "C2") SAID POINT BEING THE NORTHWEST CORNER OF LOT 9 AFORESAID; THENCE SOUTH 89 DEGREES 45 MINUTES 38 SECONDS EAST, ALONG THE NORTH LINE OF LOTS 9, 10, 11 AND 12 AFORESAID, 200.53 FEET TO THE NORTHEAST CORNER OF LOT 12 AFORESAID; THENCE SOUTH 0 DEGREES 07 MINUTES 06 SECONDS WEST, ALONG THE EAST LINE OF SAID LOT 12, BEING ALSO THE EAST LINE OF BLOCK 24 AFORESAID, 100.06 FEET TO THE SOUTHEAST CORNER OF SAID LOT 12; THENCE NORTH 89 DEGREES 45 MINUTES 02 SECONDS WEST, ALONG THE SOUTH LINE OF BLOCK 24 AFORESAID, 237.78 FEET; THENCE NORTH 0 DEGREES 14 MINUTES 58 SECONDS EAST, PERPENDICULAR TO THE LAST DESCRIBED LINE, 19.58 FEET; THENCE NORTH 89 DEGREES 45 MINUTES 02 SECONDS WEST, ALONG A LINE DRAWN PARALLEL WITH THE SOUTH LINE OF BLOCK 24 AFORESAID, 13.26 FEET; THENCE SOUTH 0 DEGREES 14 MINUTES 58 SECONDS WEST, PERPENDICULAR TO THE LAST DESCRIBED LINE, 5.60 FEET; THENCE SOUTH 89 DEGREES 45 MINUTES 02 SECONDS EAST, 2.96 FEET; THENCE SOUTH 0 DEGREES 14 MINUTES 58 SECONDS WEST, 2.03 FEET; THENCE SOUTH 89 DEGREES 45 MINUTES 02 SECONDS EAST, 1.05 FEET; THENCE SOUTH 0 DEGREES 14 MINUTES 58 SECONDS WEST, 11.95 FEET TO A POINT ON THE SOUTH LINE OF BLOCK 24 AFORESAID; THENCE NORTH 89 DEGREES 45 MINUTES 02 SECONDS WEST, ALONG SAID SOUTH LINE, 54.02 FEET TO THE HEREINABOVE DESIGNATED POINT OF BEGINNING;

SAID PARCEL HAVING AS AN UPPER LIMIT A HORIZONTAL PLANE OF ELEVATION +42.50 FEET CHICAGO CITY DATUM AND HAVING AS A LOWER LIMIT A HORIZONTAL PLANE OF ELEVATION +31.50 FEET CHICAGO CITY DATUM, EXCEPT FOR THE FOLLOWING DESCRIBED PARTS OF SAID PARCEL WHERE THE LOWER LIMITS ARE DEFINED BY A SERIES OF INCLINED PLANES WHOSE ELEVATIONS ARE SHOWN ON THE TABLE FOLLOWING THE HORIZONTAL LOCATION OF SAID PLANES:

PART I:

COMMENCING AT THE NORTHEAST CORNER OF LOT 5 IN BLOCK 24 AFORESAID; THENCE SOUTH 0 DEGREES 13 MINUTES 09 SECONDS WEST, ALONG THE EAST LINE OF LOT 5 AFORESAID, 50.27 FEET TO A POINT (HEREINAFTER REFERRED TO AS POINT "B1", SAID

UNOFFICIAL COPY

G:\negals\L125561\Exhibit A - Garage Property\5561-GP-1-L2.doc

05/19/04

2

POINT BEING THE POINT OF BEGINNING OF THE FOLLOWING DESCRIBED PART; THENCE CONTINUING SOUTH 0 DEGREES 13 MINUTES 09 SECONDS WEST, ALONG SAID EAST LINE, 36.46 FEET TO A POINT (HEREINAFTER REFERRED TO AS POINT "C1", SAID POINT ALSO REFERRED TO AS "B2"); THENCE NORTH 89 DEGREES 45 MINUTES 02 SECONDS WEST, ALONG A LINE DRAWN PARALLEL WITH THE SOUTH LINE OF BLOCK 24 AFORESAID, 20.07 FEET TO POINT (HEREINAFTER REFERRED TO AS POINT "D1", SAID POINT ALSO REFERRED TO AS "A2"); THENCE NORTH 0 DEGREES 14 MINUTES 58 SECONDS EAST, 36.46 FEET TO A POINT (HEREINAFTER REFERRED TO AS POINT "A1"); THENCE SOUTH 89 DEGREES 45 MINUTES 02 SECONDS EAST, 20.05 FEET TO THE HEREINABOVE DESIGNATED POINT OF BEGINNING (POINT "B1");

ELEVATION TABLE PART I

THE AFOREMENTIONED SERIES OF INCLINED PLANES SHALL BE THOSE FORMED BY IRREGULAR QUADRANGULAR SURFACES, (HAVING TWO COMMON VERTICES), LYING ADJACENTLY TO EACH OTHER AND HAVING AS VERTICES THE POINTS WHOSE ELEVATIONS ARE SHOWN IN TABLE BELOW:

| POINT | ELEVATION CHICAGO CITY DATUM |
|-------|---------------------------------|
| "A1" | +19.41 |
| "D1" | +19.49 |
| "C1" | +25.65 |
| "D1" | +25.65 |

PART II:

BEGINNING AT THE AFOREMENTIONED POINT "B2", THENCE SOUTH 0 DEGREES 13 MINUTES 09 SECONDS WEST, ALONG THE EAST LINE OF LOT 5 AND ITS SOUTHERLY EXTENSION AFORESAID, 31.41 FEET TO A POINT (HEREINAFTER REFERRED TO AS POINT "C2", SAID POINT ALSO REFERRED TO AS "A4" AND "B3"); THENCE NORTH 89 DEGREES 43 MINUTES 38 SECONDS WEST, ALONG THE NORTH LINE OF LOT 5 AFORESAID, 20.08 FEET TO A POINT (HEREINAFTER REFERRED TO AS POINT "D2"); THENCE NORTH 0 DEGREES 14 MINUTES 58 SECONDS EAST, 31.40 FEET TO A POINT (HEREINAFTER REFERRED TO AS POINT "A2"); THENCE SOUTH 89 DEGREES 45 MINUTES 02 SECONDS EAST, 20.07 FEET TO THE HEREINABOVE DESIGNATED POINT OF BEGINNING (POINT "B2");

ELEVATION TABLE PART II

THE AFOREMENTIONED SERIES OF INCLINED PLANES SHALL BE THOSE FORMED BY IRREGULAR QUADRANGULAR SURFACES, (HAVING TWO COMMON VERTICES), LYING ADJACENTLY TO EACH OTHER AND HAVING AS VERTICES THE POINTS WHOSE ELEVATIONS ARE SHOWN IN TABLE BELOW:

| POINT | ELEVATION CHICAGO CITY DATUM |
|-------|---------------------------------|
| "A2" | +25.65 |
| "B2" | +25.65 |
| "C2" | +29.28 |
| "D2" | +29.69 |

PART III:

UNOFFICIAL COPY

G:\legals\L125561\Exhibit A - Garage Property\5561-GP-1-L2.doc
05/19/04

3

BEGINNING AT THE AFOREMENTIONED POINT "B3", THENCE SOUTH 0 DEGREES 13 MINUTES 09 SECONDS WEST, ALONG THE EAST LINE OF LOT 8 AFORESAID, 49.72 FEET TO A POINT (HEREINAFTER REFERRED TO AS POINT "C3"), SAID POINT ALSO REFERRED TO AS "D4"); THENCE NORTH 89 DEGREES 45 MINUTES 02 SECONDS WEST, ALONG A LINE DRAWN PARALLEL WITH THE SOUTH LINE OF BLOCK 24 AFORESAID, 18.44 FEET TO A POINT (HEREINAFTER REFERRED TO AS POINT "D3"); THENCE NORTH 0 DEGREES 14 MINUTES 58 SECONDS EAST, 49.73 FEET TO A POINT (HEREINAFTER REFERRED TO AS POINT "A3"); THENCE SOUTH 89 DEGREES 43 MINUTES 38 SECONDS EAST, 18.42 FEET TO THE HEREINABOVE DESIGNATED POINT OF BEGINNING (POINT "B3");

ELEVATION TABLE PART III

THE AFOREMENTIONED SERIES OF INCLINED PLANES SHALL BE THOSE FORMED BY IRREGULAR QUADRANGULAR SURFACES, (HAVING TWO COMMON VERTICES), LYING ADJACENTLY TO EACH OTHER AND HAVING AS VERTICES THE POINTS WHOSE ELEVATIONS ARE SHOWN IN TABLE BELOW:

| POINT | ELEVATION CHICAGO CITY DATUM |
|-------|---------------------------------|
| "A3" | +29.69 |
| "B3" | +29.28 |
| "C3" | +30.37 |
| "D3" | +30.50 |

PART IV:

BEGINNING AT THE NORTHWEST CORNER OF LOT 9, IN BLOCK 24 IN KINZIE'S ADDITION TO CHICAGO AFORESAID, SAID POINT HEREINAFTER REFERRED TO AS POINT "A4", THENCE SOUTH 89 DEGREES 43 MINUTES 38 SECONDS EAST, ALONG THE NORTH LINE OF LOTS 9, 10 AND 11 AFORESAID, 107.83 FEET TO A POINT, (HEREINAFTER REFERRED TO AS POINT "B4", SAID POINT ALSO REFERRED TO AS "A5"); THENCE SOUTH 0 DEGREES 14 MINUTES 58 SECONDS WEST, 49.68 FEET TO A POINT (HEREINAFTER REFERRED TO AS POINT "C4", SAID POINT ALSO REFERRED TO AS "B6"); THENCE NORTH 89 DEGREES 45 MINUTES 02 SECONDS WEST, ALONG A LINE DRAWN PARALLEL WITH THE SOUTH LINE OF BLOCK 24 AFORESAID, 107.81 FEET TO A POINT (HEREINAFTER REFERRED TO AS POINT "D4", SAID POINT ALSO REFERRED TO AS "C3"); THENCE NORTH 0 DEGREES 13 MINUTES 09 SECONDS EAST, ALONG THE EAST LINE OF LOT 8 AFORESAID, 49.72 FEET TO THE HEREINABOVE DESIGNATED POINT OF BEGINNING (POINT "A4");

ELEVATION TABLE PART IV

THE AFOREMENTIONED SERIES OF INCLINED PLANES SHALL BE THOSE FORMED BY IRREGULAR QUADRANGULAR SURFACES, (HAVING TWO COMMON VERTICES), LYING ADJACENTLY TO EACH OTHER AND HAVING AS VERTICES THE POINTS WHOSE ELEVATIONS ARE SHOWN IN TABLE BELOW:

| POINT | ELEVATION CHICAGO CITY DATUM |
|-------|---------------------------------|
| "A4" | +29.28 |

UNOFFICIAL COPY

G:\legals\L125561\Exhibit A - Garage Property\5561-GP-1-L2.doc

05/19/04

4

| | |
|------|--------|
| "B4" | +23.71 |
| "C4" | +23.67 |
| "D4" | +30.37 |

PART V:

BEGINNING AT THE AFOREMENTIONED POINT "A5", THENCE SOUTH 89 DEGREES 43 MINUTES 38 SECONDS EAST, ALONG THE NORTH LINE OF LOT 11 AFORESAID, 10.09 FEET TO A POINT, (HEREINAFTER REFERRED TO AS POINT "B5"); THENCE SOUTH 0 DEGREES 14 MINUTES 58 SECONDS WEST, 23.92 FEET TO A POINT (HEREINAFTER REFERRED TO AS POINT "C5", SAID POINT ALSO REFERRED TO AS "B7"); THENCE NORTH 89 DEGREES 45 MINUTES 02 SECONDS WEST, ALONG A LINE DRAWN PARALLEL WITH THE SOUTH LINE OF BLOCK 24 AFORESAID, 10.08 FEET TO POINT (HEREINAFTER REFERRED TO AS POINT "D5", SAID POINT ALSO REFERRED TO AS "A7"); THENCE NORTH 0 DEGREES 14 MINUTES 58 SECONDS EAST, 23.93 FEET TO THE HEREINABOVE DESIGNATED POINT OF BEGINNING (POINT "A5");

ELEVATION TABLE PART V

THE AFOREMENTIONED SERIES OF INCLINED PLANES SHALL BE THOSE FORMED BY IRREGULAR QUADRANGULAR SURFACES, (HAVING TWO COMMON VERTICES), LYING ADJACENTLY TO EACH OTHER AND HAVING AS VERTICES THE POINTS WHOSE ELEVATIONS ARE SHOWN IN TABLE BELOW:

| POINT | ELEVATION CHICAGO CITY DATUM |
|-------|---------------------------------|
| "A5" | +23.71 |
| "B5" | +23.04 |
| "C5" | +22.63 |
| "D5" | +23.26 |

PART VI:

BEGINNING AT THE AFOREMENTIONED POINT "B6", THENCE SOUTH 0 DEGREES 14 MINUTES 58 SECONDS WEST, 50.42 FEET TO A POINT (HEREINAFTER REFERRED TO AS POINT "C6") ON THE SOUTH LINE OF BLOCK 24 AFORESAID; THENCE NORTH 89 DEGREES 45 MINUTES 02 SECONDS WEST, ALONG SAID SOUTH LINE, 100.92 FEET TO A POINT (HEREINAFTER REFERRED TO AS POINT "D6"); THENCE NORTH 0 DEGREES 14 MINUTES 58 SECONDS EAST, PERPENDICULAR TO THE LAST DESCRIBED LINE, 50.42 FEET TO A POINT (HEREINAFTER REFERRED TO AS POINT "A6"); THENCE SOUTH 89 DEGREES 45 MINUTES 02 SECONDS EAST, ALONG A LINE DRAWN PARALLEL WITH THE SOUTH LINE OF BLOCK 24 AFORESAID, 100.92 FEET TO THE HEREINABOVE DESIGNATED POINT OF BEGINNING (POINT "B6");

ELEVATION TABLE PART VI

THE AFOREMENTIONED SERIES OF INCLINED PLANES SHALL BE THOSE FORMED BY IRREGULAR QUADRANGULAR SURFACES, (HAVING TWO COMMON VERTICES), LYING

UNOFFICIAL COPY

G:\legals\L125561\Exhibit A - Garage Property\5561-GP-1-L2.doc

05/19/04

5

ADJACENTLY TO EACH OTHER AND HAVING AS VERTICES THE POINTS WHOSE ELEVATIONS ARE SHOWN IN TABLE BELOW:

| POINT | ELEVATION |
|-------|--------------------|
| | CHICAGO CITY DATUM |
| "A6" | +30.62 |
| "B6" | +37.77 |
| "C6" | +39.17 |
| "D6" | +31.78 |

PART VII:

BEGINNING AT THE AFOREMENTIONED POINT "B7", THENCE SOUTH 0 DEGREES 14 MINUTES 58 SECONDS WEST, 14.92 FEET TO A POINT (HEREINAFTER REFERRED TO AS POINT "C7", SAID POINT ALSO REFERRED TO AS "D9"); THENCE NORTH 89 DEGREES 45 MINUTES 02 SECONDS WEST, ALONG A LINE DRAWN PARALLEL WITH THE SOUTH LINE OF BLOCK 24 AFORESAID, 10.05 FEET TO A POINT (HEREINAFTER REFERRED TO AS POINT "D7", SAID POINT ALSO REFERRED TO AS "A10"); THENCE NORTH 0 DEGREES 14 MINUTES 58 SECONDS EAST, PERPENDICULAR TO THE LAST DESCRIBED LINE, 14.92 FEET TO A POINT (HEREINAFTER REFERRED TO AS POINT "A7"); THENCE SOUTH 89 DEGREES 45 MINUTES 02 SECONDS EAST, ALONG A LINE DRAWN PARALLEL WITH THE SOUTH LINE OF BLOCK 24 AFORESAID, 10.08 FEET TO THE HEREINABOVE DESIGNATED POINT OF BEGINNING (POINT "B7");

ELEVATION TABLE PART VII

THE AFOREMENTIONED SERIES OF INCLINED PLANES SHALL BE THOSE FORMED BY IRREGULAR QUADRANGULAR SURFACES, (HAVING TWO COMMON VERTICES), LYING ADJACENTLY TO EACH OTHER AND HAVING AS VERTICES THE POINTS WHOSE ELEVATIONS ARE SHOWN IN TABLE BELOW:

| POINT | ELEVATION |
|-------|--------------------|
| | CHICAGO CITY DATUM |
| "A7" | +23.21 |
| "B7" | +22.63 |
| "C7" | +21.36 |
| "D7" | +21.64 |

PART VIII:

BEGINNING AT THE AFOREMENTIONED POINT "A8"), THENCE SOUTH 0 DEGREES 14 MINUTES 58 SECONDS WEST, 27.72 FEET TO A POINT (HEREINAFTER REFERRED TO AS POINT "D8", SAID POINT ALSO REFERRED TO AS "A9"); THENCE SOUTH 89 DEGREES 45 MINUTES 02 SECONDS EAST, ALONG A LINE DRAWN PARALLEL WITH THE SOUTH LINE OF BLOCK 24 AFORESAID, 22.25 FEET TO A POINT (HEREINAFTER REFERRED TO AS POINT "C8"); THENCE NORTH 0 DEGREES 14 MINUTES 58 SECONDS EAST, 27.71 FEET TO A POINT ON THE NORTH LINE OF LOT 11 AFORESAID, SAID POINT (HEREINAFTER REFERRED TO AS POINT "B8"); THENCE NORTH 89 DEGREES 43 MINUTES 38 SECONDS WEST, ALONG SAID

UNOFFICIAL COPY

G:\legals\L125561\Exhibit A - Garage Property\5561-GP-1-L2.doc

05/19/04

6

NORTH LINE, 22.23 FEET TO THE HEREINABOVE DESIGNATED POINT OF BEGINNING (POINT "A8");

ELEVATION TABLE PART VIII

THE AFOREMENTIONED SERIES OF INCLINED PLANES SHALL BE THOSE FORMED BY IRREGULAR QUADRANGULAR SURFACES, (HAVING TWO COMMON VERTICES), LYING ADJACENTLY TO EACH OTHER AND HAVING AS VERTICES THE POINTS WHOSE ELEVATIONS ARE SHOWN IN TABLE BELOW:

| POINT | ELEVATION |
|-------|--------------------|
| | CHICAGO CITY DATUM |
| "A8" | +23.04 |
| "B8" | +20.90 |
| "C8" | +20.88 |
| "D8" | +22.63 |

PART IX:

BEGINNING AT THE AFOREMENTIONED POINT "A9", THENCE SOUTH 0 DEGREES 14 MINUTES 58 SECONDS WEST, 11.12 FEET TO A POINT (HEREINAFTER REFERRED TO AS POINT "D9", SAID POINT ALSO REFERRED TO AS "C7"); THENCE SOUTH 89 DEGREES 45 MINUTES 02 SECONDS EAST, ALONG A LINE DRAWN PARALLEL WITH THE SOUTH LINE OF BLOCK 24 AFORESAID, 14.00 FEET TO POINT (HEREINAFTER REFERRED TO AS POINT "C9", SAID POINT ALSO REFERRED TO AS "B10"); THENCE NORTH 0 DEGREES 14 MINUTES 58 SECONDS EAST, 11.12 FEET TO A POINT (HEREINAFTER REFERRED TO AS POINT "B9"); THENCE NORTH 89 DEGREES 45 MINUTES 02 SECONDS WEST, 14.00 FEET TO THE HEREINABOVE DESIGNATED POINT OF BEGINNING (POINT "A9").

ELEVATION TABLE PART IX

THE AFOREMENTIONED SERIES OF INCLINED PLANES SHALL BE THOSE FORMED BY IRREGULAR QUADRANGULAR SURFACES, (HAVING TWO COMMON VERTICES) LYING ADJACENTLY TO EACH OTHER AND HAVING AS VERTICES THE POINTS WHOSE ELEVATIONS ARE SHOWN IN TABLE BELOW:

| POINT | ELEVATION |
|-------|--------------------|
| | CHICAGO CITY DATUM |
| "A9" | +22.86 |
| "B9" | +21.96 |
| "C9" | +20.93 |
| "D9" | +21.36 |

PART X:

UNOFFICIAL COPY

G:\legals\L125561\Exhibit A - Garage Property\5561-GP-1-L2.doc

05/19/04

7

BEGINNING AT THE AFOREMENTIONED POINT "A10", THENCE SOUTH 0 DEGREES 14 MINUTES 58 SECONDS WEST, 9.92 FEET TO A POINT (HEREINAFTER REFERRED TO AS POINT "D10"); THENCE SOUTH 89 DEGREES 45 MINUTES 02 SECONDS EAST, ALONG A LINE DRAWN PARALLEL WITH THE SOUTH LINE OF BLOCK 24 AFORESAID, 24.08 FEET TO POINT (HEREINAFTER REFERRED TO AS POINT "C10"); THENCE NORTH 0 DEGREES 14 MINUTES 58 SECONDS EAST, 9.92 FEET TO A POINT (HEREINAFTER REFERRED TO AS POINT "B10"); THENCE NORTH 89 DEGREES 45 MINUTES 02 SECONDS WEST, 24.08 FEET TO THE HEREINABOVE DESIGNATED POINT OF BEGINNING (POINT "A10");

ELEVATION TABLE PART X

THE AFOREMENTIONED SERIES OF INCLINED PLANES SHALL BE THOSE FORMED BY IRREGULAR QUADRANGULAR SURFACES, (HAVING TWO COMMON VERTICES), LYING ADJACENTLY TO EACH OTHER AND HAVING AS VERTICES THE POINTS WHOSE ELEVATIONS ARE SHOWN IN TABLE BELOW:

| POINT | ELEVATION CHICAGO CITY DATUM |
|-------|---------------------------------|
| "A10" | +21.64 |
| "B10" | +20.93 |
| "C10" | +20.12 |
| "D10" | +20.24 |

ALL IN COOK COUNTY, ILLINOIS.

EXCEPTING THEREFROM THE FOLLOWING DESCRIBED PARCEL:

HOTEL PARCEL 2-L2 (L2-FIRST PARKING LEVEL) ELEVATORS PE-1, PE-2, PE-3 AND SE-1, STORAGE ROOM AND SPRINKLER VALVE ROOM:

THAT PART OF LOTS 7 AND 8, IN BLOCK 24 IN KINZIE'S ADDITION TO CHICAGO IN SECTION 10, TOWNSHIP 39 NORTH, RANGE 14 EAST OF THE THIRD PRINCIPAL MERIDIAN, ALL TAKEN AS ONE TRACT BOUNDED AND DESCRIBED AS FOLLOWS:
COMMENCING AT THE SOUTHWEST CORNER OF LOT 7 AFORESAID, THENCE SOUTH 89 DEGREES 45 MINUTES 02 SECONDS EAST, ALONG THE SOUTH LINE OF BLOCK 24 AFORESAID, 39.95 FEET; THENCE NORTH 0 DEGREES 14 MINUTES 58 SECONDS EAST, PERPENDICULAR TO THE LAST DESCRIBED LINE, 57.81 FEET TO A POINT, SAID POINT BEING 39.93 FEET (AS MEASURED PERPENDICULARLY) EAST OF THE WEST LINE OF LOT 7 AFORESAID, SAID POINT BEING ALSO THE POINT OF BEGINNING OF THE FOLLOWING DESCRIBED PARCEL; THENCE CONTINUING NORTH 0 DEGREES 14 MINUTES 58 SECONDS EAST, 6.85 FEET; THENCE NORTH 89 DEGREES 45 MINUTES 02 SECONDS WEST, PERPENDICULAR TO THE LAST DESCRIBED LINE, 2.73 FEET; THENCE NORTH 0 DEGREES 14 MINUTES 58 SECONDS EAST, 3.34 FEET; THENCE SOUTH 89 DEGREES 45 MINUTES 02 SECONDS EAST, 2.72 FEET; THENCE NORTH 0 DEGREES 14 MINUTES 58 SECONDS EAST,

UNOFFICIAL COPY

G:\legals\L125561\Exhibit A - Garage Property\5561-GP-1-L2.doc

05/19/04

8

16.09 FEET TO A POINT, SAID POINT BEING 39.91 FEET (AS MEASURED PERPENDICULARLY) EAST OF THE WEST LINE OF LOT 7 AFORESAID; THENCE SOUTH 89 DEGREES 45 MINUTES 02 SECONDS EAST, 3.27 FEET; THENCE NORTH 0 DEGREES 14 MINUTES 58 SECONDS EAST, 1.41 FEET; THENCE SOUTH 89 DEGREES 45 MINUTES 02 SECONDS EAST, 7.82 FEET; THENCE NORTH 0 DEGREES 14 MINUTES 58 SECONDS EAST, 3.79 FEET; THENCE SOUTH 89 DEGREES 45 MINUTES 02 SECONDS EAST, 6.20 FEET; THENCE SOUTH 0 DEGREES 14 MINUTES 58 SECONDS WEST, 5.18 FEET; THENCE SOUTH 89 DEGREES 45 MINUTES 02 SECONDS EAST, 2.73 FEET; THENCE SOUTH 0 DEGREES 14 MINUTES 58 SECONDS WEST, 26.30 FEET; THENCE NORTH 89 DEGREES 45 MINUTES 02 SECONDS WEST, ALONG A LINE DRAWN 57.81 FEET (AS MEASURED PERPENDICULARLY) NORTH OF AND PARALLEL WITH THE SOUTH LINE OF BLOCK 24 AFORESAID, 20.01 FEET TO THE HEREINABOVE DESIGNATED POINT OF BEGINNING;

SAID PARCEL HAVING AS A LOWER LIMIT A HORIZONTAL PLANE OF ELEVATION +31.50 FEET CHICAGO CITY DATUM, AND HAVING AS AN UPPER LIMIT A HORIZONTAL PLANE OF ELEVATION +42.30 FEET CHICAGO CITY DATUM;

(AREA = 578.5 SQUARE FEET OR 0.0133 ACRES).

AREA = 39,884.4 SQUARE FEET OR 0.9156 ACRES.

Property of Cook County Clerk's Office

UNOFFICIAL COPY

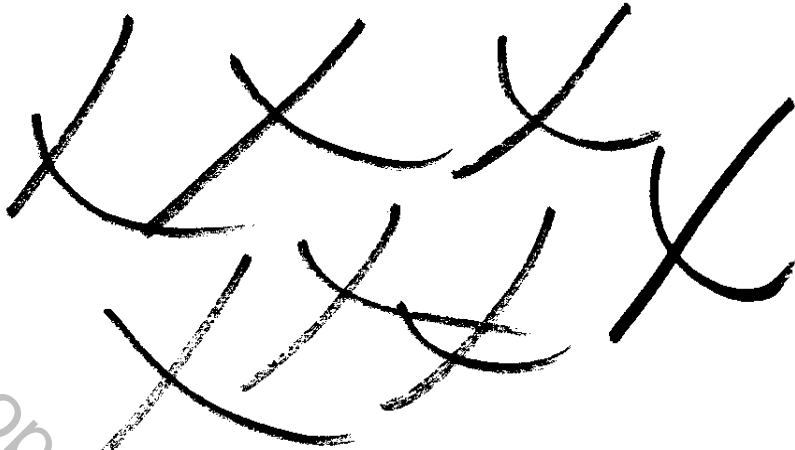

Property of Cook County Clerk's Office

L3

SECOND PARKING LEVEL

UNOFFICIAL COPY

G:\legals\L125561\Exhibit A - Garage Property\5561-GP-1-L3.doc

05/19/04

1

GARAGE PARCEL 1-L3 (L3-SECOND PARKING LEVEL):

THAT PART OF LOTS 5 THROUGH 12, BOTH INCLUSIVE, TOGETHER WITH THAT PART OF THE VACATED 18 FOOT EAST AND WEST ALLEY LYING SOUTH OF AND ADJOINING THE SOUTH LINE OF SAID LOTS 5 AND 6 AND LYING NORTH OF THE NORTH LINE OF SAID LOTS 7 AND 8, IN BLOCK 24 IN KINZIE'S ADDITION TO CHICAGO IN SECTION 10, TOWNSHIP 39 NORTH, RANGE 14 EAST OF THE THIRD PRINCIPAL MERIDIAN, ALL TAKEN AS ONE TRACT BOUNDED AND DESCRIBED AS FOLLOWS:

BEGINNING AT THE SOUTHWEST CORNER OF LOT 7 IN BLOCK 24 AFORESAID; THENCE NORTH 10 DEGREES 16 MINUTES 11 SECONDS EAST, ALONG THE WEST LINE OF BLOCK 24 AFORESAID, 218.36 FEET TO THE NORTHWEST CORNER OF LOT 6 AFORESAID; THENCE SOUTH 89 DEGREES 42 MINUTES 13 SECONDS EAST, ALONG THE NORTH LINE OF LOTS 5 AND 6 AFORESAID, 54.28 FEET TO A POINT ON THE NORTH LINE OF SAID LOT 5, SAID POINT BEING 45.88 FEET (AS MEASURED ALONG THE NORTH LINE OF LOT 5 AFORESAID) WEST OF ITS NORTHEAST CORNER THEREOF; THENCE SOUTH 0 DEGREES 14 MINUTES 58 SECONDS WEST, 14.90 FEET; THENCE SOUTH 89 DEGREES 45 MINUTES 02 SECONDS EAST, 26.19 FEET; THENCE NORTH 0 DEGREES 14 MINUTES 58 SECONDS EAST, 14.88 FEET TO A POINT ON THE NORTH LINE OF LOT 5 AFORESAID; THENCE SOUTH 89 DEGREES 42 MINUTES 13 SECONDS EAST, ALONG SAID NORTH LINE 19.69 FEET TO THE NORTHEAST CORNER OF SAID LOT 5; THENCE SOUTH 0 DEGREES 13 MINUTES 09 SECONDS WEST, ALONG THE EAST LINE OF SAID LOT 5 AND ITS SOUTHERLY EXTENSION, 118.14 FEET TO THE NORTHWEST CORNER OF LOT 9 AFORESAID; THENCE SOUTH 89 DEGREES 43 MINUTES 38 SECONDS EAST, ALONG THE NORTH LINE OF LOTS 9, 10, 11 AND 12 AFORESAID, 200.53 FEET TO THE NORTHEAST CORNER OF SAID LOT 12; THENCE SOUTH 0 DEGREES 07 MINUTES 06 SECONDS WEST, ALONG THE EAST LINE OF SAID LOT 12, BEING ALSO THE EAST LINE OF BLOCK 24 AFORESAID, 100.06 FEET TO THE SOUTHEAST CORNER OF SAID LOT 12; THENCE NORTH 89 DEGREES 45 MINUTES 02 SECONDS WEST, ALONG THE SOUTH LINE OF BLOCK 24 AFORESAID 237.78 FEET; THENCE NORTH 0 DEGREES 14 MINUTES 58 SECONDS EAST, PERPENDICULAR TO THE LAST DESCRIBED LINE, 19.15 FEET; THENCE NORTH 89 DEGREES 45 MINUTES 02 SECONDS WEST, ALONG A LINE DRAWN 19.15 FEET (AS MEASURED PERPENDICULARLY) NORTH OF AND PARALLEL WITH THE SOUTH LINE OF BLOCK 24 AFORESAID, 10.22 FEET; THENCE SOUTH 0 DEGREES 14 MINUTES 58 SECONDS WEST, PERPENDICULAR TO THE LAST DESCRIBED LINE, 7.55 FEET; THENCE SOUTH 89 DEGREES 45 MINUTES 02 SECONDS EAST, 1.01 FEET; THENCE SOUTH 0 DEGREES 14 MINUTES 58 SECONDS WEST, 11.60 FEET TO A POINT ON THE SOUTH LINE OF BLOCK 24 AFORESAID; THENCE NORTH 89 DEGREES 45 MINUTES 02 SECONDS WEST, ALONG SAID SOUTH LINE, 54.06 FEET TO THE HEREINABOVE DESIGNATED POINT OF BEGINNING,

SAID PARCEL HAVING AS A LOWER LIMIT A HORIZONTAL PLANE OF ELEVATION +42.30 FEET CHICAGO CITY DATUM, AND HAVING AS AN UPPER LIMIT A HORIZONTAL PLANE OF ELEVATION +53.50 FEET CHICAGO CITY DATUM, ALL IN COOK COUNTY, ILLINOIS.

EXCEPTING THEREFROM THE FOLLOWING DESCRIBED PARCEL:

HOTEL PARCEL 2-L3 (L3-SECOND PARKING LEVEL) ELEVATORS PE-1, PE-2, PE-3 AND SE-1, STORAGE ROOM AND SPRINKLER VALVE ROOM:

THAT PART OF LOTS 7 AND 8, IN BLOCK 24 IN KINZIE'S ADDITION TO CHICAGO IN SECTION 10, TOWNSHIP 39 NORTH, RANGE 14 EAST OF THE THIRD PRINCIPAL MERIDIAN, ALL TAKEN AS ONE TRACT BOUNDED AND DESCRIBED AS FOLLOWS:

COMMENCING AT THE SOUTHWEST CORNER OF LOT 7 AFORESAID, THENCE SOUTH 89 DEGREES 45 MINUTES 02 SECONDS EAST, ALONG THE SOUTH LINE OF BLOCK 24 AFORESAID, 40.18 FEET; THENCE NORTH 0 DEGREES 14 MINUTES 58 SECONDS EAST,

UNOFFICIAL COPY

G:\legals\L125561\Exhibit A - Garage Property\5561-GP-1-L3.doc

05/19/04

2

PERPENDICULAR TO THE LAST DESCRIBED LINE, 57.40 FEET TO A POINT, SAID POINT BEING 40.16 FEET (AS MEASURED PERPENDICULARLY) EAST OF THE WEST LINE OF LOT 7 AFORESAID, SAID POINT BEING ALSO THE POINT OF BEGINNING OF THE FOLLOWING DESCRIBED PARCEL; THENCE CONTINUING NORTH 0 DEGREES 14 MINUTES 58 SECONDS EAST, 6.74 FEET; THENCE NORTH 89 DEGREES 45 MINUTES 02 SECONDS WEST, PERPENDICULAR TO THE LAST DESCRIBED LINE, 2.70 FEET; THENCE NORTH 0 DEGREES 14 MINUTES 58 SECONDS EAST, 3.34 FEET; THENCE SOUTH 89 DEGREES 45 MINUTES 02 SECONDS EAST, 2.71 FEET; THENCE NORTH 0 DEGREES 14 MINUTES 58 SECONDS EAST, 16.28 FEET TO A POINT, SAID POINT BEING 40.16 FEET (AS MEASURED PERPENDICULARLY) EAST OF THE WEST LINE OF LOT 7 AFORESAID; THENCE SOUTH 89 DEGREES 45 MINUTES 02 SECONDS EAST, 3.26 FEET; THENCE NORTH 0 DEGREES 14 MINUTES 58 SECONDS EAST, 1.39 FEET; THENCE SOUTH 89 DEGREES 45 MINUTES 02 SECONDS EAST, 7.74 FEET; THENCE NORTH 0 DEGREES 14 MINUTES 58 SECONDS EAST, 3.72 FEET; THENCE SOUTH 89 DEGREES 45 MINUTES 02 SECONDS EAST, 6.23 FEET; THENCE SOUTH 0 DEGREES 14 MINUTES 58 SECONDS WEST, 5.17 FEET; THENCE SOUTH 89 DEGREES 45 MINUTES 02 SECONDS EAST, 2.79 FEET; THENCE SOUTH 0 DEGREES 14 MINUTES 58 SECONDS WEST, 26.30 FEET; THENCE NORTH 89 DEGREES 45 MINUTES 02 SECONDS WEST, ALONG A LINE DRAWN 57.40 FEET (AS MEASURED PERPENDICULARLY) NORTH OF AND PARALLEL WITH THE SOUTH LINE OF BLOCK 24 AFORESAID, 20.03 FEET TO THE HEREINABOVE DESIGNATED POINT OF BEGINNING;

SAID PARCEL HAVING AS A LOWER LIMIT A HORIZONTAL PLANE OF ELEVATION +42.30 FEET CHICAGO CITY DATUM, AND HAVING AS AN UPPER LIMIT A HORIZONTAL PLANE OF ELEVATION +53.50 FEET CHICAGO CITY DATUM;

AREA = 579.3 SQUARE FEET OR 0.0133 ACRES.

ALL IN COOK COUNTY, ILLINOIS.

AREA = 40,814.6 SQUARE FEET OR 0.9370 ACRES.

UNOFFICIAL COPY

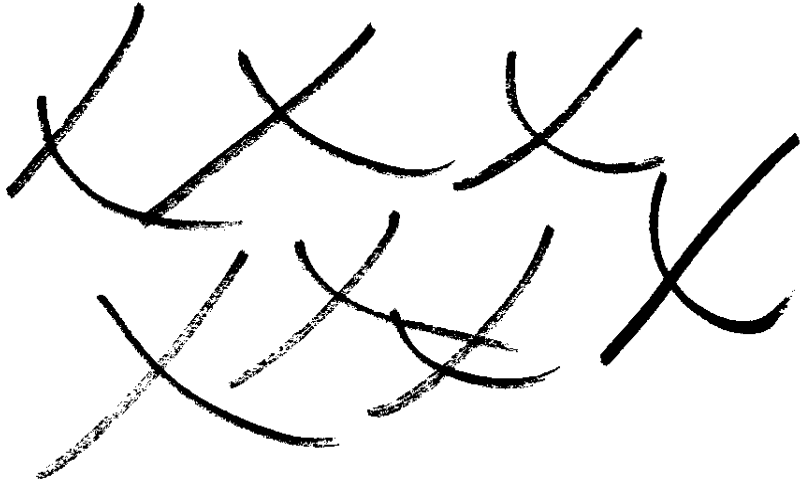

Property of Cook County Clerk's Office

L4

THIRD PARKING LEVEL

UNOFFICIAL COPY

G:\legals\L125561\Exhibit A - Garage Property\5561-GP-1-L4.doc

05/19/04

1

GARAGE PARCEL 1-L4 (L4-THIRD PARKING LEVEL):

THAT PART OF LOTS 5 TROUGH 12, BOTH INCLUSIVE, TOGETHER WITH THAT PART OF THE VACATED 18 FOOT EAST AND WEST ALLEY LYING SOUTH OF AND ADJOINING THE SOUTH LINE OF SAID LOTS 5 AND 6 AND LYING NORTH OF THE NORTH LINE OF SAID LOTS 7 AND 8, IN BLOCK 24 IN KINZIE'S ADDITION TO CHICAGO IN SECTION 10, TOWNSHIP 39 NORTH, RANGE 14 EAST OF THE THIRD PRINCIPAL MERIDIAN, ALL TAKEN AS ONE TRACT BOUNDED AND DESCRIBED AS FOLLOWS:

BEGINNING AT THE SOUTHWEST CORNER OF LOT 7 IN BLOCK 24 AFORESAID; THENCE NORTH 0 DEGREES 16 MINUTES 11 SECONDS EAST, ALONG THE WEST LINE OF BLOCK 24 AFORESAID, 218.36 FEET TO THE NORTHWEST CORNER OF LOT 6 AFORESAID; THENCE SOUTH 89 DEGREES 42 MINUTES 13 SECONDS EAST, ALONG THE NORTH LINE OF LOTS 5 AND 6 AFORESAID, 54.31 FEET TO A POINT ON THE NORTH LINE OF SAID LOT 5, SAID POINT BEING 45.85 FEET (AS MEASURED ALONG THE NORTH LINE OF LOT 5 AFORESAID) WEST OF ITS NORTHEAST CORNER THEREOF; THENCE SOUTH 0 DEGREES 14 MINUTES 58 SECONDS WEST, 14.45 FEET; THENCE SOUTH 89 DEGREES 45 MINUTES 02 SECONDS EAST, 26.16 FEET; THENCE NORTH 0 DEGREES 14 MINUTES 58 SECONDS EAST, 14.43 FEET TO A POINT ON THE NORTH LINE OF LOT 5 AFORESAID; THENCE SOUTH 89 DEGREES 42 MINUTES 13 SECONDS EAST, ALONG SAID NORTH LINE 19.69 FEET TO THE NORTHEAST CORNER OF SAID LOT 5; THENCE SOUTH 0 DEGREES 11 MINUTES 09 SECONDS WEST, ALONG THE EAST LINE OF SAID LOT 5 AND ITS SOUTHERLY EXTENSION, 118.14 FEET TO THE NORTHWEST CORNER OF LOT 9 AFORESAID; THENCE SOUTH 89 DEGREES 43 MINUTES 38 SECONDS EAST, ALONG THE NORTH LINE OF LOTS 9, 10, 11 AND 12 AFORESAID, 200.53 FEET TO THE NORTHEAST CORNER OF SAID LOT 12; THENCE SOUTH 0 DEGREES 07 MINUTES 06 SECONDS WEST, ALONG THE EAST LINE OF SAID LOT 12, BEING ALSO THE EAST LINE OF BLOCK 24 AFORESAID, 100.06 FEET, TO THE SOUTHEAST CORNER OF LOT 12; THENCE NORTH 89 DEGREES 45 MINUTES 02 SECONDS WEST ALONG THE SOUTH LINE OF BLOCK 24 AFORESAID 237.78 FEET; THENCE NORTH 0 DEGREES 14 MINUTES 58 SECONDS EAST, PERPENDICULAR TO THE LAST DESCRIBED LINE, 19.56 FEET; THENCE NORTH 89 DEGREES 45 MINUTES 02 SECONDS WEST, ALONG A LINE DRAWN 19.58 FEET (AS MEASURED PERPENDICULARLY) NORTH OF AND PARALLEL WITH THE SOUTH LINE OF BLOCK 24 AFORESAID, 10.10 FEET; THENCE SOUTH 0 DEGREES 14 MINUTES 58 SECONDS WEST, PERPENDICULAR TO THE LAST DESCRIBED LINE, 7.62 FEET; THENCE SOUTH 89 DEGREES 45 MINUTES 02 SECONDS EAST, 0.94 FEET; THENCE SOUTH 0 DEGREES 14 MINUTES 58 SECONDS WEST, 11.96 FEET TO A POINT ON THE SOUTH LINE OF BLOCK 24 AFORESAID; THENCE NORTH 89 DEGREES 45 MINUTES 02 SECONDS WEST, ALONG SAID SOUTH LINE, 54.11 FEET TO THE HEREINABOVE DESIGNATED POINT OF BEGINNING;

SAID PARCEL HAVING AS A LOWER LIMIT A HORIZONTAL PLANE OF ELEVATION +63.30 FEET CHICAGO CITY DATUM, AND HAVING AS AN UPPER LIMIT A HORIZONTAL PLANE OF ELEVATION +64.30 FEET CHICAGO CITY DATUM, ALL IN COOK COUNTY, ILLINOIS.

EXCEPTING THEREFROM THE FOLLOWING DESCRIBED PARCEL:

HOTEL PARCEL 2-L4 (L4-THIRD PARKING LEVEL) ELEVATORS PE-1, PE-2, PE-3 AND SE-1, STORAGE ROOM AND SPRINKLER VALVE ROOM:

THAT PART OF LOTS 7 AND 8, IN BLOCK 24 IN KINZIE'S ADDITION TO CHICAGO IN SECTION 10, TOWNSHIP 39 NORTH, RANGE 14 EAST OF THE THIRD PRINCIPAL MERIDIAN, ALL TAKEN AS ONE TRACT BOUNDED AND DESCRIBED AS FOLLOWS:

COMMENCING AT THE SOUTHWEST CORNER OF LOT 7 AFORESAID, THENCE SOUTH 89 DEGREES 45 MINUTES 02 SECONDS EAST, ALONG THE SOUTH LINE OF BLOCK 24 AFORESAID, 40.18 FEET; THENCE NORTH 0 DEGREES 14 MINUTES 58 SECONDS EAST,

UNOFFICIAL COPY

G:\legals\LI25561\Exhibit A - Garage Property\5561-GP-1-L4.doc

05/19/04

2

PERPENDICULAR TO THE LAST DESCRIBED LINE, 57.83 FEET TO A POINT, SAID POINT BEING 40.16 FEET (AS MEASURED PERPENDICULARLY) EAST OF THE WEST LINE OF LOT 7 AFORESAID, SAID POINT BEING ALSO THE POINT OF BEGINNING OF THE FOLLOWING DESCRIBED PARCEL; THENCE CONTINUING NORTH 0 DEGREES 14 MINUTES 58 SECONDS EAST, 6.71 FEET; THENCE NORTH 89 DEGREES 45 MINUTES 02 SECONDS WEST, PERPENDICULAR TO THE LAST DESCRIBED LINE, 2.71 FEET; THENCE NORTH 0 DEGREES 14 MINUTES 58 SECONDS EAST, 3.32 FEET; THENCE SOUTH 89 DEGREES 45 MINUTES 02 SECONDS EAST, 2.71 FEET; THENCE NORTH 0 DEGREES 14 MINUTES 58 SECONDS EAST, 16.30 FEET TO A POINT, SAID POINT BEING 40.15 FEET (AS MEASURED PERPENDICULARLY) EAST OF THE WEST LINE OF LOT 7 AFORESAID; THENCE SOUTH 89 DEGREES 45 MINUTES 02 SECONDS EAST, 3.32 FEET; THENCE NORTH 0 DEGREES 14 MINUTES 58 SECONDS EAST, 1.46 FEET; THENCE SOUTH 89 DEGREES 45 MINUTES 02 SECONDS EAST, 7.65 FEET; THENCE NORTH 0 DEGREES 14 MINUTES 58 SECONDS EAST, 3.67 FEET; THENCE SOUTH 89 DEGREES 45 MINUTES 02 SECONDS EAST, 6.23 FEET; THENCE SOUTH 0 DEGREES 14 MINUTES 58 SECONDS WEST, 5.14 FEET; THENCE SOUTH 89 DEGREES 45 MINUTES 02 SECONDS EAST, 2.83 FEET; THENCE SOUTH 0 DEGREES 14 MINUTES 58 SECONDS WEST, 26.32 FEET; THENCE NORTH 89 DEGREES 45 MINUTES 02 SECONDS WEST, ALONG A LINE DRAWN 57.83 FEET (AS MEASURED PERPENDICULARLY) NORTH OF AND PARALLEL WITH THE SOUTH LINE OF BLOCK 24 AFORESAID, 26.03 FEET TO THE HEREINABOVE DESIGNATED POINT OF BEGINNING;

SAID PARCEL HAVING AS A LOWER LIMIT A HORIZONTAL PLANE OF ELEVATION +53.30 FEET CHICAGO CITY DATUM, AND HAVING AS AN UPPER LIMIT A HORIZONTAL PLANE OF ELEVATION +64.30 FEET CHICAGO CITY DATUM;

AREA = 579.5 SQUARE FEET OR 0.0133 ACRES

ALL IN COOK COUNTY, ILLINOIS.

AREA = 40,824.2 SQUARE FEET OR 0.9372 ACRES.

UNOFFICIAL COPY



Property of Cook County Clerk's Office

L5

FOURTH PARKING LEVEL

UNOFFICIAL COPY

G:\egals\L125561\Exhibit A - Garage Property\5561-GP-1-L5.doc

05/19/04

1

GARAGE PARCEL 1-L5 (L5-FOURTH PARKING LEVEL):

THAT PART OF LOTS 5 THROUGH 12, BOTH INCLUSIVE, TOGETHER WITH THAT PART OF THE VACATED 18 FOOT EAST AND WEST ALLEY LYING SOUTH OF AND ADJOINING THE SOUTH LINE OF SAID LOTS 5 AND 6 AND LYING NORTH OF THE NORTH LINE OF SAID LOTS 7 AND 8, IN BLOCK 24 IN KINZIE'S ADDITION TO CHICAGO IN SECTION 10, TOWNSHIP 39 NORTH, RANGE 14 EAST OF THE THIRD PRINCIPAL MERIDIAN, ALL TAKEN AS ONE TRACT BOUNDED AND DESCRIBED AS FOLLOWS:

BEGINNING AT THE SOUTHWEST CORNER OF LOT 7 IN BLOCK 24 AFORESAID; THENCE NORTH 0 DEGREES 16 MINUTES 11 SECONDS EAST, ALONG THE WEST LINE OF BLOCK 24 AFORESAID, 218.36 FEET TO THE NORTHWEST CORNER OF LOT 6 AFORESAID; THENCE SOUTH 89 DEGREES 42 MINUTES 13 SECONDS EAST, ALONG THE NORTH LINE OF LOTS 5 AND 6 AFORESAID, 54.21 FEET TO A POINT ON THE NORTH LINE OF SAID LOT 5, SAID POINT BEING 45.95 FEET (AS MEASURED ALONG THE NORTH LINE OF LOT 5 AFORESAID) WEST OF ITS NORTHEAST CORNER THEREOF; THENCE SOUTH 0 DEGREES 14 MINUTES 58 SECONDS WEST, 14.47 FEET; THENCE SOUTH 89 DEGREES 45 MINUTES 02 SECONDS EAST, 26.26 FEET; THENCE NORTH 0 DEGREES 14 MINUTES 58 SECONDS EAST, 14.45 FEET TO A POINT ON THE NORTH LINE OF LOT 5 AFORESAID; THENCE SOUTH 89 DEGREES 42 MINUTES 13 SECONDS EAST, ALONG SAID NORTH LINE 19.69 FEET TO THE NORTHEAST CORNER OF SAID LOT 5; THENCE SOUTH 0 DEGREES 13 MINUTES 09 SECONDS WEST, ALONG THE EAST LINE OF SAID LOT 5 AND ITS SOUTHERLY EXTENSION, 118.14 FEET TO THE NORTHWEST CORNER OF LOT 9 AFORESAID; THENCE SOUTH 89 DEGREES 43 MINUTES 38 SECONDS EAST, ALONG THE NORTH LINE OF LOTS 9, 10, 11 AND 12 AFORESAID, 200.53 FEET TO THE NORTHEAST CORNER OF SAID LOT 12; THENCE SOUTH 0 DEGREES 07 MINUTES 06 SECONDS WEST, ALONG THE EAST LINE OF SAID LOT 12, BEING ALSO THE EAST LINE OF BLOCK 24 AFORESAID, 100.06 FEET, TO THE SOUTHEAST CORNER OF LOT 12; THENCE NORTH 89 DEGREES 45 MINUTES 02 SECONDS WEST ALONG THE SOUTH LINE OF BLOCK 24 AFORESAID 237.78 FEET; THENCE NORTH 0 DEGREES 14 MINUTES 58 SECONDS EAST, PERPENDICULAR TO THE LAST DESCRIBED LINE, 19.63 FEET; THENCE NORTH 89 DEGREES 45 MINUTES 02 SECONDS WEST, ALONG A LINE DRAWN 19.63 FEET (AS MEASURED PERPENDICULARLY) NORTH OF AND PARALLEL WITH THE SOUTH LINE OF BLOCK 24 AFORESAID, 10.13 FEET; THENCE SOUTH 0 DEGREES 14 MINUTES 58 SECONDS WEST, PERPENDICULAR TO THE LAST DESCRIBED LINE, 7.58 FEET; THENCE SOUTH 89 DEGREES 45 MINUTES 02 SECONDS EAST, 0.87 FEET; THENCE SOUTH 0 DEGREES 14 MINUTES 58 SECONDS WEST, 12.05 FEET TO A POINT ON THE SOUTH LINE OF BLOCK 24 AFORESAID; THENCE NORTH 89 DEGREES 45 MINUTES 02 SECONDS WEST, ALONG SAID SOUTH LINE, 54.01 FEET TO THE HEREINABOVE DESIGNATED POINT OF BEGINNING;

SAID PARCEL HAVING AS A LOWER LIMIT A HORIZONTAL PLANE OF ELEVATION +64.30 FEET CHICAGO CITY DATUM, AND HAVING AS AN UPPER LIMIT A HORIZONTAL PLANE OF ELEVATION +74.30 FEET CHICAGO CITY DATUM;

EXCEPTING THEREFROM THE FOLLOWING DESCRIBED PARCEL:

HOTEL PARCEL 2-L5 (L5-FOURTH PARKING LEVEL) ELEVATORS PE-1, PE-2, PE-3 AND SE-1, STORAGE ROOM AND SPRINKLER VALVE ROOM:

THAT PART OF LOTS 7 AND 8, IN BLOCK 24 IN KINZIE'S ADDITION TO CHICAGO IN SECTION 10, TOWNSHIP 39 NORTH, RANGE 14 EAST OF THE THIRD PRINCIPAL MERIDIAN, ALL TAKEN AS ONE TRACT BOUNDED AND DESCRIBED AS FOLLOWS:

COMMENCING AT THE SOUTHWEST CORNER OF LOT 7 AFORESAID, THENCE SOUTH 89 DEGREES 45 MINUTES 02 SECONDS EAST, ALONG THE SOUTH LINE OF BLOCK 24 AFORESAID, 40.20 FEET; THENCE NORTH 0 DEGREES 14 MINUTES 58 SECONDS EAST,

UNOFFICIAL COPY

G:\legals\L125561\Exhibit A - Garage Property\5561-GP-1-L5.doc

05/19/04

2

PERPENDICULAR TO THE LAST DESCRIBED LINE, 57.83 FEET TO A POINT, SAID POINT BEING 40.18 FEET (AS MEASURED PERPENDICULARLY) EAST OF THE WEST LINE OF LOT 7 AFORESAID, SAID POINT BEING ALSO THE POINT OF BEGINNING OF THE FOLLOWING DESCRIBED PARCEL; THENCE CONTINUING NORTH 0 DEGREES 14 MINUTES 58 SECONDS EAST, 6.68 FEET; THENCE NORTH 89 DEGREES 45 MINUTES 02 SECONDS WEST, PERPENDICULAR TO THE LAST DESCRIBED LINE, 2.68 FEET; THENCE NORTH 0 DEGREES 14 MINUTES 58 SECONDS EAST, 3.32 FEET; THENCE SOUTH 89 DEGREES 45 MINUTES 02 SECONDS EAST, 2.67 FEET; THENCE NORTH 0 DEGREES 14 MINUTES 58 SECONDS EAST, 16.25 FEET TO A POINT, SAID POINT BEING 40.16 FEET (AS MEASURED PERPENDICULARLY) EAST OF THE WEST LINE OF LOT 7 AFORESAID; THENCE SOUTH 89 DEGREES 45 MINUTES 02 SECONDS EAST, 3.33 FEET; THENCE NORTH 0 DEGREES 14 MINUTES 58 SECONDS EAST, 1.53 FEET; THENCE SOUTH 89 DEGREES 45 MINUTES 02 SECONDS EAST, 7.68 FEET; THENCE NORTH 0 DEGREES 14 MINUTES 58 SECONDS EAST, 3.66 FEET; THENCE SOUTH 89 DEGREES 45 MINUTES 02 SECONDS EAST, 6.19 FEET; THENCE SOUTH 0 DEGREES 14 MINUTES 58 SECONDS WEST, 5.13 FEET; THENCE SOUTH 89 DEGREES 45 MINUTES 02 SECONDS EAST, 2.82 FEET; THENCE SOUTH 0 DEGREES 14 MINUTES 58 SECONDS WEST, 26.31 FEET; THENCE NORTH 89 DEGREES 45 MINUTES 02 SECONDS WEST, ALONG A LINE DRAWN 57.83 FEET (AS MEASURED PERPENDICULARLY) NORTH OF AND PARALLEL WITH THE SOUTH LINE OF BLOCK 24 AFORESAID, 20.01 FEET TO THE HEREINABOVE DESIGNATED POINT OF BEGINNING;

SAID PARCEL HAVING AS A LOWER LIMIT A HORIZONTAL PLANE OF ELEVATION +64.30 FEET CHICAGO CITY DATUM, AND HAVING AS AN UPPER LIMIT A HORIZONTAL PLANE OF ELEVATION +74.30 FEET CHICAGO CITY DATUM;

AREA = 578.4 SQUARE FEET OR 0.0133 ACRES.

ALL IN COOK COUNTY, ILLINOIS.

AREA = 40,821.5 SQUARE FEET OR 0.9371 ACRES.

Cook County Clerk's Office

UNOFFICIAL COPY

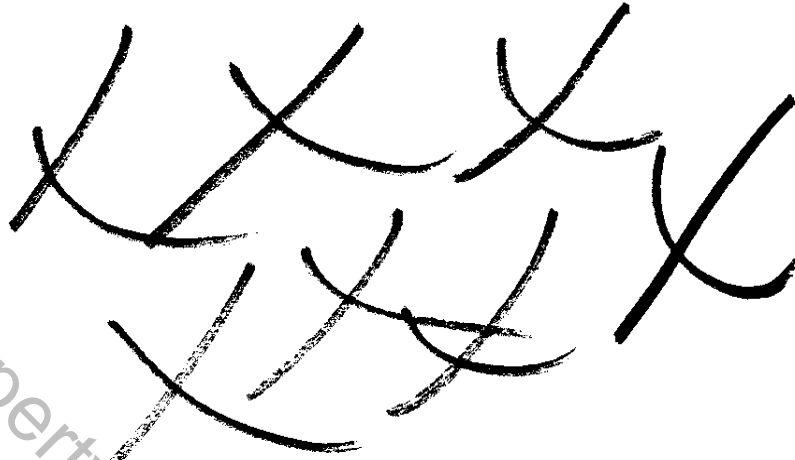

Property of Cook County Clerk's Office

L6

FIFTH PARKING LEVEL

UNOFFICIAL COPY

G:\legals\125561\Exhibit A - Garage Property\5561-GP-1-L6.doc

05/19/04

1

GARAGE PARCEL 1-L6 (L6-FIFTH PARKING LEVEL):

THAT PART OF LOTS 5 THROUGH 12, BOTH INCLUSIVE, TOGETHER WITH THAT PART OF THE VACATED 18 FOOT EAST AND WEST ALLEY LYING SOUTH OF AND ADJOINING THE SOUTH LINE OF SAID LOTS 5 AND 6 AND LYING NORTH OF THE NORTH LINE OF SAID LOTS 7 AND 8, IN BLOCK 24 IN KINZIE'S ADDITION TO CHICAGO IN SECTION 10, TOWNSHIP 39 NORTH, RANGE 14 EAST OF THE THIRD PRINCIPAL MERIDIAN, ALL TAKEN AS ONE TRACT BOUNDED AND DESCRIBED AS FOLLOWS:

BEGINNING AT THE SOUTHWEST CORNER OF LOT 7 IN BLOCK 24 AFORESAID; THENCE NORTH 0 DEGREES 16 MINUTES 11 SECONDS EAST, ALONG THE WEST LINE OF BLOCK 24 AFORESAID, 218.36 FEET TO THE NORTHWEST CORNER OF LOT 6 AFORESAID; THENCE SOUTH 89 DEGREES 42 MINUTES 13 SECONDS EAST, ALONG THE NORTH LINE OF LOTS 5 AND 6 AFORESAID, 54.29 FEET TO A POINT ON THE NORTH LINE OF SAID LOT 5, SAID POINT BEING 45.87 FEET (AS MEASURED ALONG THE NORTH LINE OF LOT 5 AFORESAID) WEST OF ITS NORTHEAST CORNER THEREOF; THENCE SOUTH 0 DEGREES 14 MINUTES 58 SECONDS WEST, 14.45 FEET; THENCE SOUTH 89 DEGREES 45 MINUTES 02 SECONDS EAST, 26.18 FEET; THENCE NORTH 0 DEGREES 14 MINUTES 58 SECONDS EAST, 14.43 FEET TO A POINT ON THE NORTH LINE OF LOT 5 AFORESAID; THENCE SOUTH 89 DEGREES 42 MINUTES 13 SECONDS EAST, ALONG SAID NORTH LINE 19.69 FEET TO THE NORTHEAST CORNER OF SAID LOT 5; THENCE SOUTH 0 DEGREES 13 MINUTES 09 SECONDS WEST, ALONG THE EAST LINE OF SAID LOT 5 AND ITS SOUTHERLY EXTENSION, 118.14 FEET TO THE NORTHWEST CORNER OF LOT 9 AFORESAID; THENCE SOUTH 89 DEGREES 43 MINUTES 38 SECONDS EAST, ALONG THE NORTH LINE OF LOTS 9, 10, 11 AND 12 AFORESAID, 200.53 FEET TO THE NORTHEAST CORNER OF SAID LOT 12; THENCE SOUTH 0 DEGREES 07 MINUTES 06 SECONDS WEST, ALONG THE EAST LINE OF SAID LOT 12, BEING ALSO THE EAST LINE OF BLOCK 24 AFORESAID, 100.06 FEET, TO THE SOUTHEAST CORNER OF LOT 12; THENCE NORTH 89 DEGREES 45 MINUTES 02 SECONDS WEST ALONG THE SOUTH LINE OF BLOCK 24 AFORESAID 237.78 FEET; THENCE NORTH 0 DEGREES 14 MINUTES 58 SECONDS EAST, PERPENDICULAR TO THE LAST DESCRIBED LINE, 19.58 FEET; THENCE NORTH 89 DEGREES 45 MINUTES 02 SECONDS WEST, ALONG A LINE DRAWN 19.58 FEET (AS MEASURED PERPENDICULARLY) NORTH OF AND PARALLEL WITH THE SOUTH LINE OF BLOCK 24 AFORESAID, 10.11 FEET; THENCE SOUTH 0 DEGREES 14 MINUTES 58 SECONDS WEST, PERPENDICULAR TO THE LAST DESCRIBED LINE, 7.59 FEET; THENCE SOUTH 89 DEGREES 45 MINUTES 02 SECONDS EAST, 0.96 FEET; THENCE SOUTH 0 DEGREES 14 MINUTES 58 SECONDS WEST, 11.99 FEET TO A POINT ON THE SOUTH LINE OF BLOCK 24 AFORESAID; THENCE NORTH 89 DEGREES 45 MINUTES 02 SECONDS WEST, ALONG SAID SOUTH LINE, 54.12 FEET TO THE HEREINABOVE DESIGNATED POINT OF BEGINNING;

SAID PARCEL HAVING AS A LOWER LIMIT A HORIZONTAL PLANE OF ELEVATION +74.30 FEET CHICAGO CITY DATUM, AND HAVING AS AN UPPER LIMIT A HORIZONTAL PLANE OF ELEVATION +84.30 FEET CHICAGO CITY DATUM, ALL IN COOK COUNTY, ILLINOIS.

EXCEPTING THEREFROM THE FOLLOWING DESCRIBED PARCEL:

HOTEL PARCEL 2-L6 (L6-FIFTH PARKING LEVEL) ELEVATORS PE-1, PE-2, PE-3 AND SE-1, STORAGE ROOM AND SPRINKLER VALVE ROOM.

THAT PART OF LOTS 7 AND 8, IN BLOCK 24 IN KINZIE'S ADDITION TO CHICAGO IN SECTION 10, TOWNSHIP 39 NORTH, RANGE 14 EAST OF THE THIRD PRINCIPAL MERIDIAN, ALL TAKEN AS ONE TRACT BOUNDED AND DESCRIBED AS FOLLOWS:

UNOFFICIAL COPY

G:\legals\L125561\Exhibit A - Garage Property\5561-GP-1-L6.doc

05/19/04

2

COMMENCING AT THE SOUTHWEST CORNER OF LOT 7 AFORESAID, THENCE SOUTH 89 DEGREES 45 MINUTES 02 SECONDS EAST, ALONG THE SOUTH LINE OF BLOCK 24 AFORESAID, 40.20 FEET; THENCE NORTH 0 DEGREES 14 MINUTES 58 SECONDS EAST, PERPENDICULAR TO THE LAST DESCRIBED LINE, 57.83 FEET TO A POINT, SAID POINT BEING 40.18 FEET (AS MEASURED PERPENDICULARLY) EAST OF THE WEST LINE OF LOT 7 AFORESAID, SAID POINT BEING ALSO THE POINT OF BEGINNING OF THE FOLLOWING DESCRIBED PARCEL, THENCE CONTINUING NORTH 0 DEGREES 14 MINUTES 58 SECONDS EAST, 6.62 FEET; THENCE NORTH 89 DEGREES 45 MINUTES 02 SECONDS WEST, PERPENDICULAR TO THE LAST DESCRIBED LINE, 2.70 FEET; THENCE NORTH 0 DEGREES 14 MINUTES 58 SECONDS EAST, 3.31 FEET; THENCE SOUTH 89 DEGREES 45 MINUTES 02 SECONDS EAST, 2.72 FEET; THENCE NORTH 0 DEGREES 14 MINUTES 58 SECONDS EAST, 16.37 FEET TO A POINT, SAID POINT BEING 40.19 FEET (AS MEASURED PERPENDICULARLY) EAST OF THE WEST LINE OF LOT 7 AFORESAID; THENCE SOUTH 89 DEGREES 45 MINUTES 02 SECONDS EAST, 3.30 FEET; THENCE NORTH 0 DEGREES 14 MINUTES 58 SECONDS EAST, 1.53 FEET; THENCE SOUTH 89 DEGREES 45 MINUTES 02 SECONDS EAST, 7.59 FEET; THENCE NORTH 0 DEGREES 14 MINUTES 58 SECONDS EAST, 3.59 FEET; THENCE SOUTH 89 DEGREES 45 MINUTES 02 SECONDS EAST, 6.24 FEET; THENCE SOUTH 0 DEGREES 14 MINUTES 58 SECONDS WEST, 5.12 FEET; THENCE SOUTH 89 DEGREES 45 MINUTES 02 SECONDS EAST, 2.86 FEET; THENCE SOUTH 0 DEGREES 14 MINUTES 58 SECONDS WEST, 26.30 FEET; THENCE NORTH 89 DEGREES 45 MINUTES 02 SECONDS WEST, ALONG A LINE DRAWN 57.83 FEET (AS MEASURED PERPENDICULARLY) NORTH OF AND PARALLEL WITH THE SOUTH LINE OF BLOCK 24 AFORESAID, 20.01 FEET TO THE HEREINABOVE DESIGNATED POINT OF BEGINNING;

SAID PARCEL HAVING AS A LOWER LIMIT A HORIZONTAL PLANE OF ELEVATION +74.30 FEET CHICAGO CITY DATUM, AND HAVING AS AN UPPER LIMIT A HORIZONTAL PLANE OF ELEVATION +84.30 FEET CHICAGO CITY DATUM;

AREA = 578.4 SQUARE FEET OR 0.013 ACRES.

ALL IN COOK COUNTY, ILLINOIS.

AREA = 40,825.0 SQUARE FEET OR 0.9372 ACRES.

Cook County Clerk's Office

UNOFFICIAL COPY

Property of Cook County Clerk's Office

L7

SIXTH PARKING LEVEL

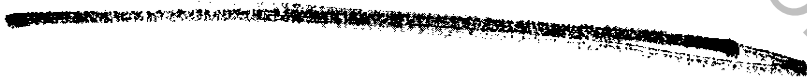

UNOFFICIAL COPY

G:\legals\L125561\Exhibit A - Garage Property\5561-GP-1-L7.doc
05/19/04

GARAGE PARCEL 1-L7 (L7-SIXTH PARKING LEVEL):

THAT PART OF LOTS 5 THROUGH 12, BOTH INCLUSIVE, TOGETHER WITH THAT PART OF THE VACATED 18 FOOT EAST AND WEST ALLEY LYING SOUTH OF AND ADJOINING THE SOUTH LINE OF SAID LOTS 5 AND 6 AND LYING NORTH OF THE NORTH LINE OF SAID LOTS 7 AND 8, IN BLOCK 24 IN KINZIE'S ADDITION TO CHICAGO IN SECTION 10, TOWNSHIP 39 NORTH, RANGE 14 EAST OF THE THIRD PRINCIPAL MERIDIAN, ALL TAKEN AS ONE TRACT BOUNDED AND DESCRIBED AS FOLLOWS:

BEGINNING AT THE SOUTHWEST CORNER OF LOT 7 IN BLOCK 24 AFORESAID; THENCE NORTH 0 DEGREES 16 MINUTES 11 SECONDS EAST, ALONG THE WEST LINE OF BLOCK 24 AFORESAID, 218.36 FEET TO THE NORTHWEST CORNER OF LOT 6 AFORESAID; THENCE SOUTH 89 DEGREES 42 MINUTES 13 SECONDS EAST, ALONG THE NORTH LINE OF LOTS 5 AND 6 AFORESAID, 54.30 FEET TO A POINT ON THE NORTH LINE OF SAID LOT 5, SAID POINT BEING 45.86 FEET (AS MEASURED ALONG THE NORTH LINE OF LOT 5 AFORESAID) WEST OF ITS NORTHEAST CORNER THEREOF; THENCE SOUTH 0 DEGREES 14 MINUTES 58 SECONDS WEST, 14.50 FEET; THENCE SOUTH 89 DEGREES 45 MINUTES 02 SECONDS EAST, 26.17 FEET; THENCE NORTH 0 DEGREES 14 MINUTES 58 SECONDS EAST, 14.48 FEET TO A POINT ON THE NORTH LINE OF LOT 5 AFORESAID; THENCE SOUTH 89 DEGREES 42 MINUTES 13 SECONDS EAST, ALONG SAID NORTH LINE 19.69 FEET TO THE NORTHEAST CORNER OF SAID LOT 5; THENCE SOUTH 0 DEGREES 13 MINUTES 09 SECONDS WEST, ALONG THE EAST LINE OF SAID LOT 5 AND ITS SOUTHERLY EXTENSION, 118.14 FEET TO THE NORTHWEST CORNER OF LOT 9 AFORESAID; THENCE SOUTH 89 DEGREES 43 MINUTES 38 SECONDS EAST, ALONG THE NORTH LINE OF LOTS 9, 10, 11 AND 12 AFORESAID, 200.53 FEET TO THE NORTHEAST CORNER OF SAID LOT 12; THENCE SOUTH 0 DEGREES 07 MINUTES 06 SECONDS WEST, ALONG THE EAST LINE OF SAID LOT 12, BEING ALSO THE EAST LINE OF BLOCK 24 AFORESAID, 100.06 FEET, TO THE SOUTHEAST CORNER OF LOT 12; THENCE NORTH 89 DEGREES 45 MINUTES 02 SECONDS WEST ALONG THE SOUTH LINE OF BLOCK 24 AFORESAID 237.78 FEET; THENCE NORTH 0 DEGREES 14 MINUTES 58 SECONDS EAST, PERPENDICULAR TO THE LAST DESCRIBED LINE, 19.58 FEET; THENCE NORTH 89 DEGREES 45 MINUTES 02 SECONDS WEST, ALONG A LINE DRAWN 19.58 FEET (AS MEASURED PERPENDICULARLY) NORTH OF AND PARALLEL WITH THE SOUTH LINE OF BLOCK 24 AFORESAID, 10.08 FEET; THENCE SOUTH 0 DEGREES 14 MINUTES 58 SECONDS WEST, PERPENDICULAR TO THE LAST DESCRIBED LINE, 7.55 FEET; THENCE SOUTH 89 DEGREES 45 MINUTES 02 SECONDS EAST, 0.98 FEET; THENCE SOUTH 0 DEGREES 14 MINUTES 58 SECONDS WEST, 12.03 FEET TO A POINT ON THE SOUTH LINE OF BLOCK 24 AFORESAID; THENCE NORTH 89 DEGREES 45 MINUTES 02 SECONDS WEST, ALONG SAID SOUTH LINE, 54.17 FEET TO THE HEREINABOVE DESIGNATED POINT OF BEGINNING;

SAID PARCEL HAVING AS A LOWER LIMIT A HORIZONTAL PLANE OF ELEVATION +84.30 FEET CHICAGO CITY DATUM, AND HAVING AS AN UPPER LIMIT A HORIZONTAL PLANE OF ELEVATION +94.30 FEET CHICAGO CITY DATUM, ALL IN COOK COUNTY, ILLINOIS.

EXCEPTING THEREFROM THE FOLLOWING DESCRIBED PARCEL:

HOTEL PARCEL 2-L7 (L7-SIXTH PARKING LEVEL) ELEVATORS PE-1, PE-2, PE-3 AND SE-1, STORAGE ROOM AND SPRINKLER VALVE ROOM:

THAT PART OF LOTS 7 AND 8, IN BLOCK 24 IN KINZIE'S ADDITION TO CHICAGO IN SECTION 10, TOWNSHIP 39 NORTH, RANGE 14 EAST OF THE THIRD PRINCIPAL MERIDIAN, ALL TAKEN AS ONE TRACT BOUNDED AND DESCRIBED AS FOLLOWS:

COMMENCING AT THE SOUTHWEST CORNER OF LOT 7 AFORESAID, THENCE SOUTH 89 DEGREES 45 MINUTES 02 SECONDS EAST, ALONG THE SOUTH LINE OF BLOCK 24 AFORESAID, 40.19 FEET; THENCE NORTH 0 DEGREES 14 MINUTES 58 SECONDS EAST,

UNOFFICIAL COPY

G:\legals\L125561\Exhibit A - Garage Property\5561-GP-1-L7.doc

05/19/04

2

PERPENDICULAR TO THE LAST DESCRIBED LINE, 57.83 FEET TO A POINT, SAID POINT BEING 40.17 FEET (AS MEASURED PERPENDICULARLY) EAST OF THE WEST LINE OF LOT 7 AFORESAID, SAID POINT BEING ALSO THE POINT OF BEGINNING OF THE FOLLOWING DESCRIBED PARCEL; THENCE CONTINUING NORTH 0 DEGREES 14 MINUTES 58 SECONDS EAST, 6.69 FEET; THENCE NORTH 89 DEGREES 45 MINUTES 02 SECONDS WEST, PERPENDICULAR TO THE LAST DESCRIBED LINE, 2.67 FEET; THENCE NORTH 0 DEGREES 14 MINUTES 58 SECONDS EAST, 3.32 FEET; THENCE SOUTH 89 DEGREES 45 MINUTES 02 SECONDS EAST, 2.69 FEET; THENCE NORTH 0 DEGREES 14 MINUTES 58 SECONDS EAST, 16.26 FEET TO A POINT, SAID POINT BEING 40.18 FEET (AS MEASURED PERPENDICULARLY) EAST OF THE WEST LINE OF LOT 7 AFORESAID; THENCE SOUTH 89 DEGREES 45 MINUTES 02 SECONDS EAST, 3.32 FEET; THENCE NORTH 0 DEGREES 14 MINUTES 58 SECONDS EAST, 1.51 FEET; THENCE SOUTH 89 DEGREES 45 MINUTES 02 SECONDS EAST, 7.63 FEET; THENCE NORTH 0 DEGREES 14 MINUTES 58 SECONDS EAST, 3.71 FEET; THENCE SOUTH 89 DEGREES 45 MINUTES 02 SECONDS EAST, 6.22 FEET; THENCE SOUTH 0 DEGREES 14 MINUTES 58 SECONDS WEST, 5.17 FEET; THENCE SOUTH 89 DEGREES 45 MINUTES 02 SECONDS EAST, 2.83 FEET; THENCE SOUTH 0 DEGREES 14 MINUTES 58 SECONDS WEST, 26.32 FEET; THENCE NORTH 89 DEGREES 45 MINUTES 02 SECONDS WEST, ALONG A LINE DRAWN 57.83 FEET (AS MEASURED PERPENDICULARLY) NORTH OF AND PARALLEL WITH THE SOUTH LINE OF BLOCK 24 AFORESAID, 20.02 FEET TO THE HEREINABOVE DESIGNATED POINT OF BEGINNING;

SAID PARCEL HAVING AS A LOWER LIMIT A HORIZONTAL PLANE OF ELEVATION +84.30 FEET CHICAGO CITY DATUM, AND HAVING AS AN UPPER LIMIT A HORIZONTAL PLANE OF ELEVATION +94.30 FEET CHICAGO CITY DATUM;

AREA = 578.6 SQUARE FEET OR 0.0133 ACRES.

ALL IN COOK COUNTY, ILLINOIS.

AREA = 40,824.6 SQUARE FEET OR 0.9372 ACRES.

UNOFFICIAL COPY

Also to release an Assignment of Leases and Rents recorded on 6/18/2004 as Doc. #0417011219.

Property of Cook County Clerk's Office

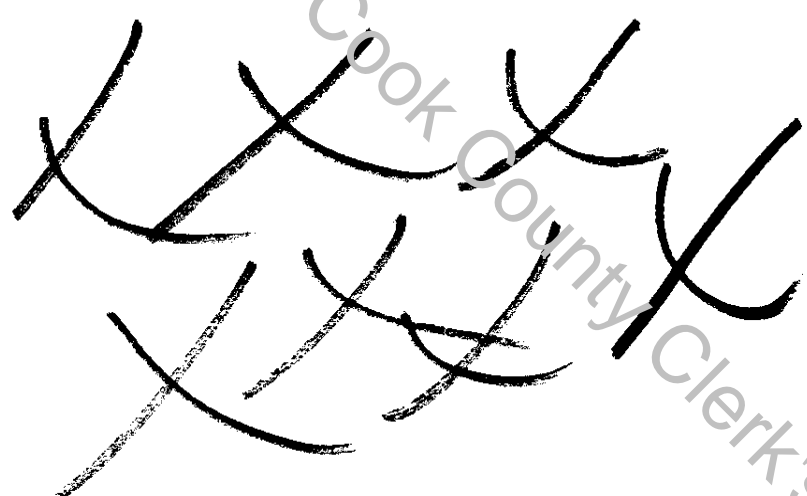
A large, dark, handwritten scribble consisting of several overlapping, curved lines that partially obscures the diagonal watermark text.