

UNOFFICIAL COPY

The subdivision of

LOT 28 IN BLOCK 24 IN THE CANAL TRUSTEES' SUBDIVISION OF SECTION 7, TOWNSHIP 39 NORTH, RANGE 14, EAST OF THE THIRD PRINCIPAL MERIDIAN, IN COOK COUNTY, ILLINOIS.

PIN # 17-07-118-012-0000

Property of Cook County Clerk's Office

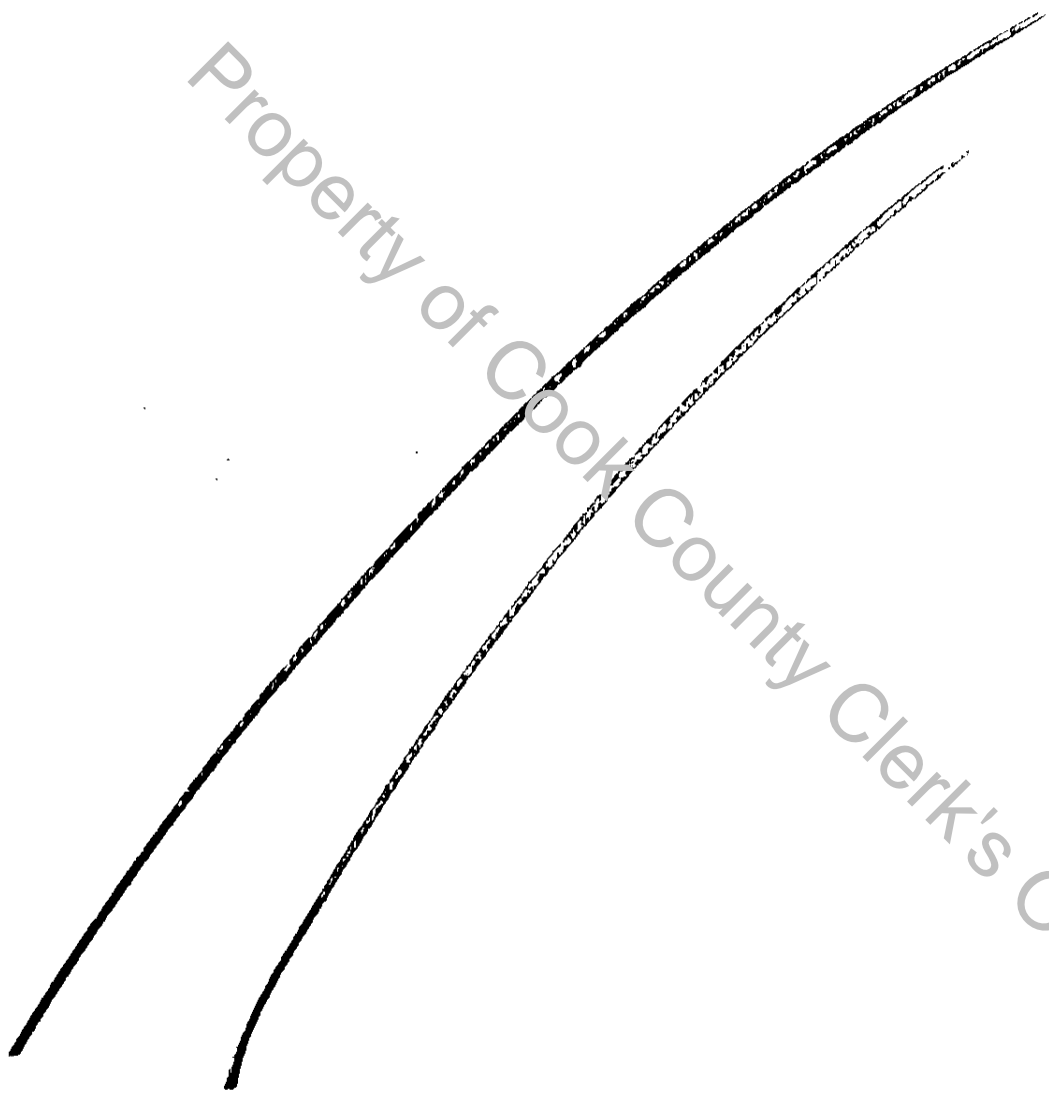

MORTGAGEDEED_A



4489618320124622