

Cook County, Illinois

RELEASE OF

COLLATERAL ASSIGNMENT OF

RIGHTS IN LEASE

Relating to Premises in: Cook County, Illinois
Lease Recorded at Doc#: 0731735122
Collateral Assignment of Rights in Lease Recorded at Doc#: 0734826071

DATED: As of August 10, 2012

First Lien

This instrument was prepared by
and after recording should be
returned to:

Virginia M. McGuffey, Esq.
King & Spalding LLP
1180 Peachtree Street
Atlanta, Georgia 30309

Store Number: 5122

3154817 P

UNOFFICIAL COPY

RELEASE OF COLLATERAL ASSIGNMENT OF RIGHTS IN LEASE

WHEREAS, that certain Collateral Assignment of Rights in Lease (“**Collateral Assignment**”) recorded on December 14, 2007 as Document Number 0734826071 in the office of the Cook County, Illinois Recorder with respect to the Lease of the property described on Exhibit A, attached hereto, was executed by **HEARTLAND ILLINOIS FOOD CORP.**, a Delaware corporation (“**Assignor**”), in favor of **ING CAPITAL LLC**, having an address of ING Capital LLC, 1325 Avenue of the Americas, New York, New York 10019, acting in its capacity as Administrative Agent pursuant to the Credit Agreement described in the Collateral Assignment (in such agency capacity, together with its successors, the “**Agent**”) for the Lenders (as defined in the Credit Agreement) to secure the Secured Obligations as defined in the Collateral Assignment. Capitalized terms used herein shall have the meanings given to such terms in the Collateral Assignment.

NOW, THEREFORE, for and in consideration of the PAYMENT IN FULL of the Secured Obligations secured by the Collateral Assignment, the Agent has RELEASED and DISCHARGED, and by these presents hereby RELEASES and DISCHARGES, its rights in the Lease and the other rights granted under the Collateral Assignment with respect to the Lease.

[signature page follows]

UNOFFICIAL COPY

EXHIBIT A

Legal Description

Burger King Restaurant #5122

Property of Cook County Clerk's Office

UNOFFICIAL COPY15901 Kedzie Avenue
Markham, Illinois

PIN: 28-24-101-039-0000

LEGAL DESCRIPTIONPARCEL ONE (LEASED PREMISES)

THAT PART OF OUTLOT "A" IN CANTERBURY GARDENS UNIT NO. 1, BEING A SUBDIVISION OF PART OF THE NORTHWEST 1/4 OF SECTION 24, TOWNSHIP 36 NORTH, RANGE 13, EAST OF THE THIRD PRINCIPAL MERIDIAN, BOUNDED AND DESCRIBED AS FOLLOWS:

COMMENCING AT THE INTERSECTION OF A LINE 50.00 FEET EAST OF THE WEST LINE OF THE NORTHWEST 1/4 OF SECTION 24, TOWNSHIP 36 NORTH, RANGE 13, EAST OF THE THIRD PRINCIPAL MERIDIAN, AND A LINE 50.00 FEET SOUTH OF THE NORTH LINE OF THE NORTHWEST 1/4 OF SAID SECTION 24, SAID POINT OF COMMENCING ALSO BEING THE INTERSECTION OF THE SOUTH LINE OF 159TH STREET AND THE EAST LINE OF KEDZIE AVENUE, AND ALSO THE NORTHWEST CORNER OF SAID OUTLOT "A"; THENCE SOUTH 0°-12'-33" WEST ALONG THE EAST LINE OF KEDZIE AVENUE, SAID LINE ALSO BEING THE WEST LINE OF SAID OUTLOT "A" A DISTANCE OF 12.00 FEET AS MEASURED AT RIGHT ANGLES TO THE NORTH LINE OF OUTLOT "A", ALSO BEING THE SOUTH LINE OF 159TH STREET TO THE POINT OF BEGINNING; THENCE NORTH 90° EAST ALONG A LINE BEING 12.00 FEET SOUTH OF "A" MEASURED AT RIGHT ANGLES TO THE NORTH LINE OF SAID OUTLOT "A", ALSO BEING THE SOUTH LINE OF 159TH STREET A DISTANCE OF 244.00 FEET; THENCE SOUTH 0°-12'-33" WEST A DISTANCE OF 123.50 FEET; THENCE NORTH 50° WEST A DISTANCE OF 244.00 FEET TO THE WEST LINE OF SAID OUTLOT "A", ALSO BEING THE EAST LINE OF KEDZIE AVENUE; THENCE NORTH 0°-12'-33" EAST ALONG THE WEST LINE OF SAID OUTLOT "A", ALSO BEING THE EAST LINE OF KEDZIE AVENUE A DISTANCE OF 123.50 FEET TO THE POINT OF BEGINNING, ALL IN COOK COUNTY, ILLINOIS.

PARCEL TWO (SHOPPING CENTER EASEMENTS)

THE ABOVE-DESCRIBED LEASED PREMISES IS A PART OF THE CANTERBURY SHOPPING CENTER (THE "SHOPPING CENTER") WHICH IS MORE PARTICULARLY DESCRIBED ON PAGE 2 OF THIS EXHIBIT "A." THE LEASE GRANTS THE FOLLOWING NON-EXCLUSIVE EASEMENTS WHICH ARE APPURTENANT TO THE LEASED PREMISES, WHICH AFFECT THE SHOPPING CENTER AND WHICH ARE CO-TERMINOUS WITH THE LEASE AND ANY EXTENSIONS THEREOF:

- (a) THE RIGHT AND EASEMENT TO TIE INTO AND USE EXISTING UTILITIES.
- (b) AN EASEMENT FOR VEHICULAR AND PEDESTRIAN INGRESS AND EGRESS TO AND FROM THE LEASED PREMISES TO THE SHOPPING CENTER, OVER, UPON AND ACROSS THE PARKING AREAS, DRIVEWAYS, EXITS AND ENTRANCES OF THE SHOPPING CENTER AS THEY MAY EXIST FROM TIME TO TIME.
- (c) AN EASEMENT FOR VEHICULAR PARKING OVER THE PARKING AREAS OF THE SHOPPING CENTER AS THEY MAY EXIST FROM TIME TO TIME.

LEGAL DESCRIPTION OF CANTERBURY SHOPPING CENTER

OUT-LOT "A" IN CANTERBURY GARDENS UNIT NO. 1, A SUBDIVISION OF PART OF THE NORTHWEST 1/4 OF SECTION 24, TOWNSHIP 36 NORTH, RANGE 13 EAST OF THE THIRD PRINCIPAL MERIDIAN, ACCORDING TO THE PLAT THEREOF RECORDED JUNE 16, 1935 AS DOCUMENT 16271151, IN COOK COUNTY, ILLINOIS.

PIN: 28 24 101 031 0000
28 24 101 038 0000

Subject to any and all reservations, restrictions, easements, rights-of-way, limitations and conditions of record.

AAH:af
180.75122
5/7/87

UNOFFICIAL COPY

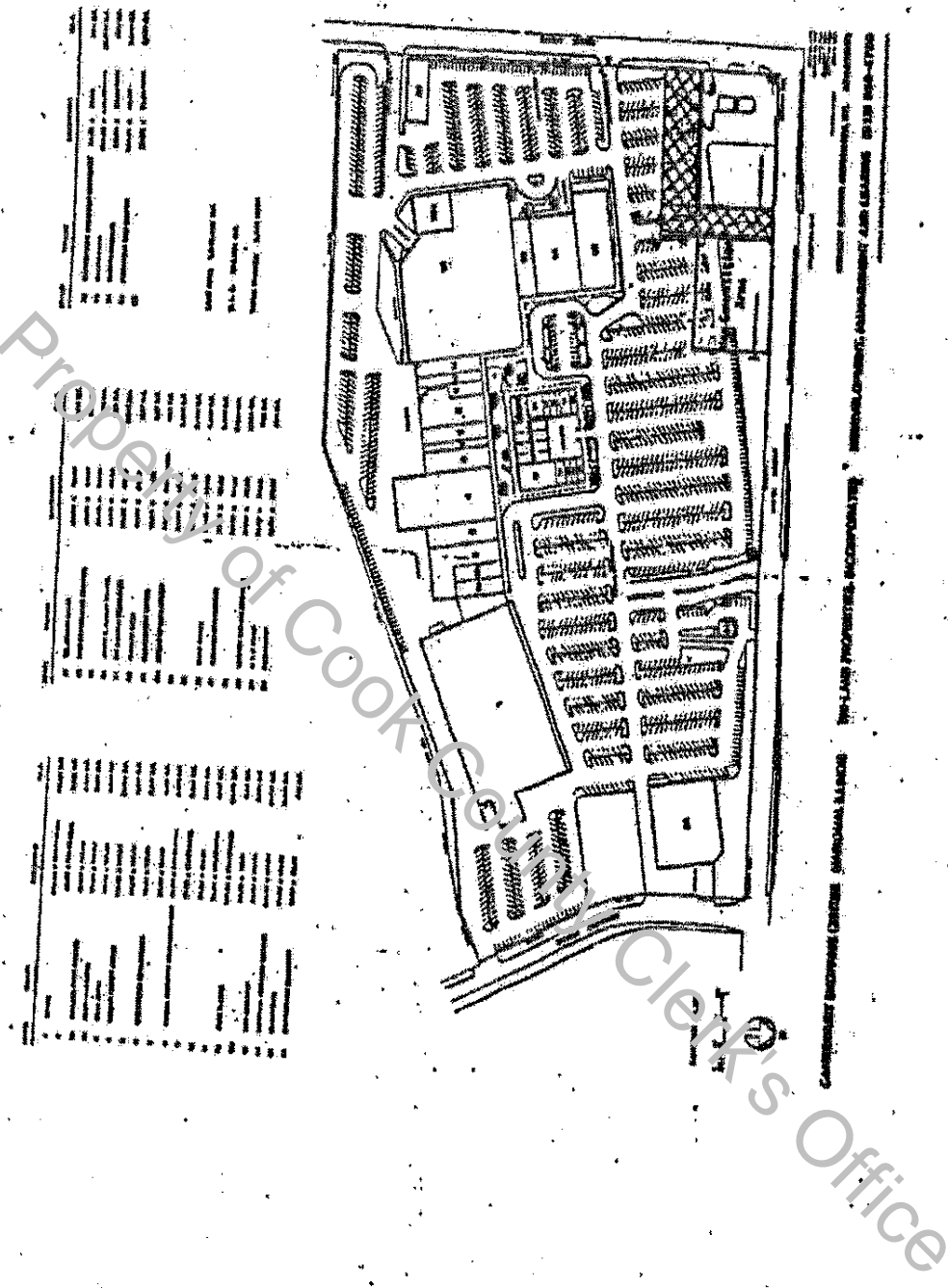

UNOFFICIAL COPY

NO.	DESCRIPTION	AMOUNT	DATE
1
2
3
4
5
6
7
8
9
10
11
12
13
14
15
16
17
18
19
20
21
22
23
24
25
26
27
28
29
30
31
32
33
34
35
36
37
38
39
40
41
42
43
44
45
46
47
48
49
50
51
52
53
54
55
56
57
58
59
60
61
62
63
64
65
66
67
68
69
70
71
72
73
74
75
76
77
78
79
80
81
82
83
84
85
86
87
88
89
90
91
92
93
94
95
96
97
98
99
100

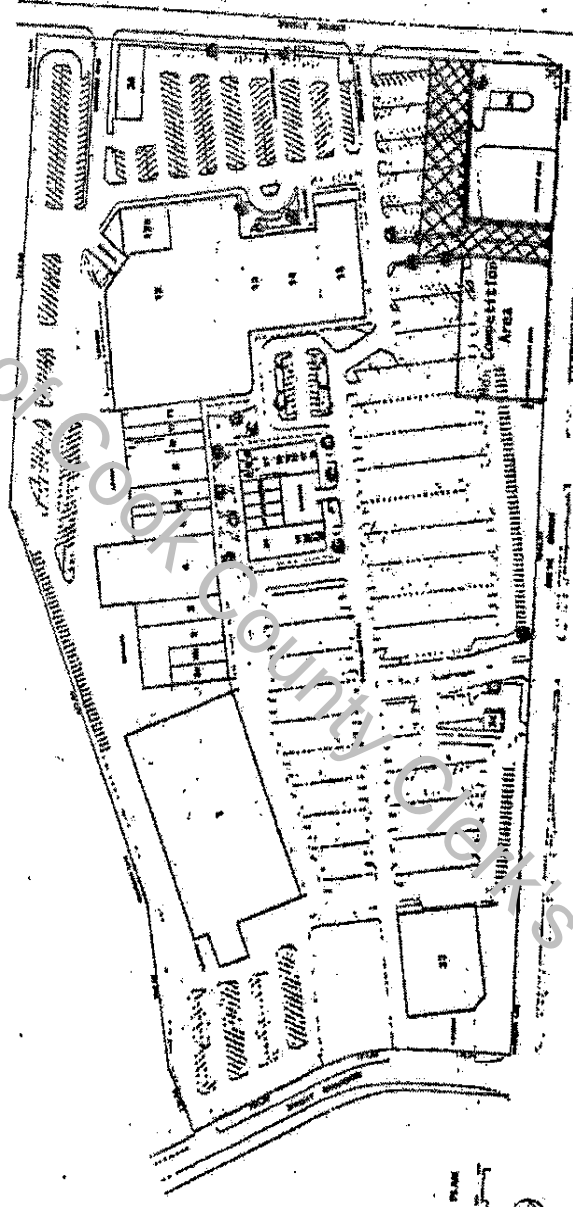

CANTEBURY SHOPPING CENTER (A/K/A) ELIZABETH TRILAND PROPERTIES, INCORPORATED REDEVELOPMENT, MANAGEMENT, AND LEASING (SIN) 8660-4700
 TRILAND PROPERTIES, INCORPORATED ARCHITECTS
 1000 ...
 1000 ...
 1000 ...

UNOFFICIAL COPY

NO.	REMARKS	DATE	BY
1	AS BUILT		
2	REVISIONS		
3	REVISIONS		
4	REVISIONS		
5	REVISIONS		
6	REVISIONS		
7	REVISIONS		
8	REVISIONS		
9	REVISIONS		
10	REVISIONS		
11	REVISIONS		
12	REVISIONS		
13	REVISIONS		
14	REVISIONS		
15	REVISIONS		
16	REVISIONS		
17	REVISIONS		
18	REVISIONS		
19	REVISIONS		
20	REVISIONS		
21	REVISIONS		
22	REVISIONS		
23	REVISIONS		
24	REVISIONS		
25	REVISIONS		
26	REVISIONS		
27	REVISIONS		
28	REVISIONS		
29	REVISIONS		
30	REVISIONS		
31	REVISIONS		
32	REVISIONS		
33	REVISIONS		
34	REVISIONS		
35	REVISIONS		
36	REVISIONS		
37	REVISIONS		
38	REVISIONS		
39	REVISIONS		
40	REVISIONS		
41	REVISIONS		
42	REVISIONS		
43	REVISIONS		
44	REVISIONS		
45	REVISIONS		
46	REVISIONS		
47	REVISIONS		
48	REVISIONS		
49	REVISIONS		
50	REVISIONS		
51	REVISIONS		
52	REVISIONS		
53	REVISIONS		
54	REVISIONS		
55	REVISIONS		
56	REVISIONS		
57	REVISIONS		
58	REVISIONS		
59	REVISIONS		
60	REVISIONS		
61	REVISIONS		
62	REVISIONS		
63	REVISIONS		
64	REVISIONS		
65	REVISIONS		
66	REVISIONS		
67	REVISIONS		
68	REVISIONS		
69	REVISIONS		
70	REVISIONS		
71	REVISIONS		
72	REVISIONS		
73	REVISIONS		
74	REVISIONS		
75	REVISIONS		
76	REVISIONS		
77	REVISIONS		
78	REVISIONS		
79	REVISIONS		
80	REVISIONS		
81	REVISIONS		
82	REVISIONS		
83	REVISIONS		
84	REVISIONS		
85	REVISIONS		
86	REVISIONS		
87	REVISIONS		
88	REVISIONS		
89	REVISIONS		
90	REVISIONS		
91	REVISIONS		
92	REVISIONS		
93	REVISIONS		
94	REVISIONS		
95	REVISIONS		
96	REVISIONS		
97	REVISIONS		
98	REVISIONS		
99	REVISIONS		
100	REVISIONS		

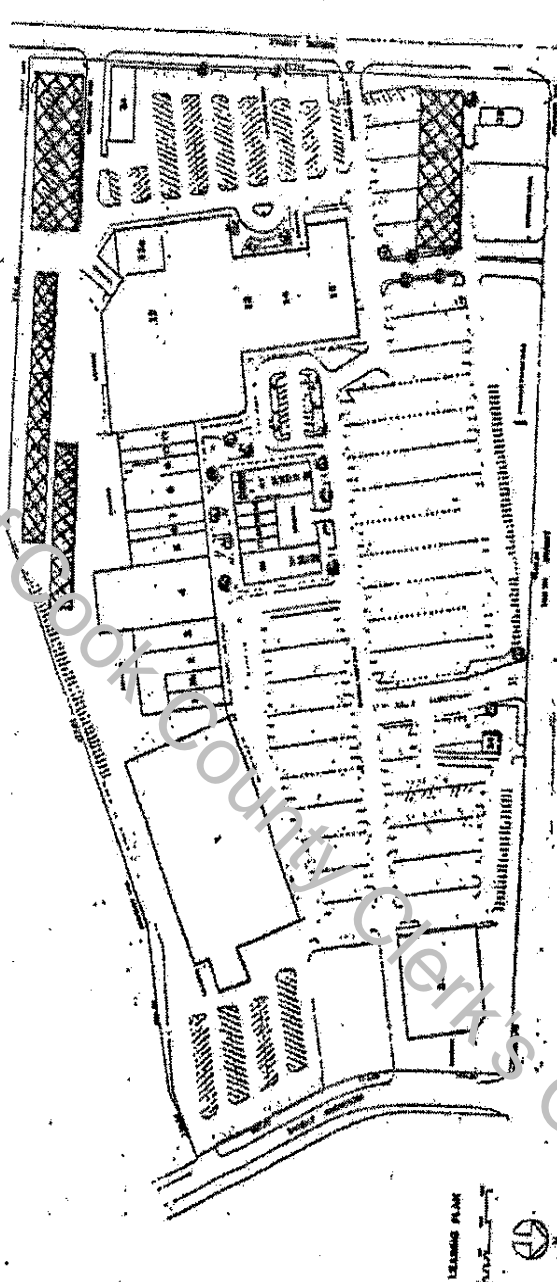

LEASING PLAN
 1/8" = 1'-0"
 NORTH
 CANTEENARY CENTER MARKHAM BLVD
 TRILAND PROPERTIES, INCORPORATED
 PROPERTY MANAGER, ASSOCIATION, INC. ALABAMA
 REDEVELOPMENT, MANAGEMENT AND LEASING (312) 960-8700