

UNOFFICIAL COPY

Recording Requested By:
WELLS FARGO BANK, N.A.



When Recorded Return To:

Doc#: 1224422085 Fee: \$40.00
Eugene "Gene" Moore RHSP Fee: \$10.00
Cook County Recorder of Deeds
Date: 08/31/2012 01:22 PM Pg: 1 of 2

DEFAULT ASSIGNMENT
WELLS FARGO BANK, N.A.
MAC: X9999-018
PO BOX 1629
MINNEAPOLIS, MN 55440-9790

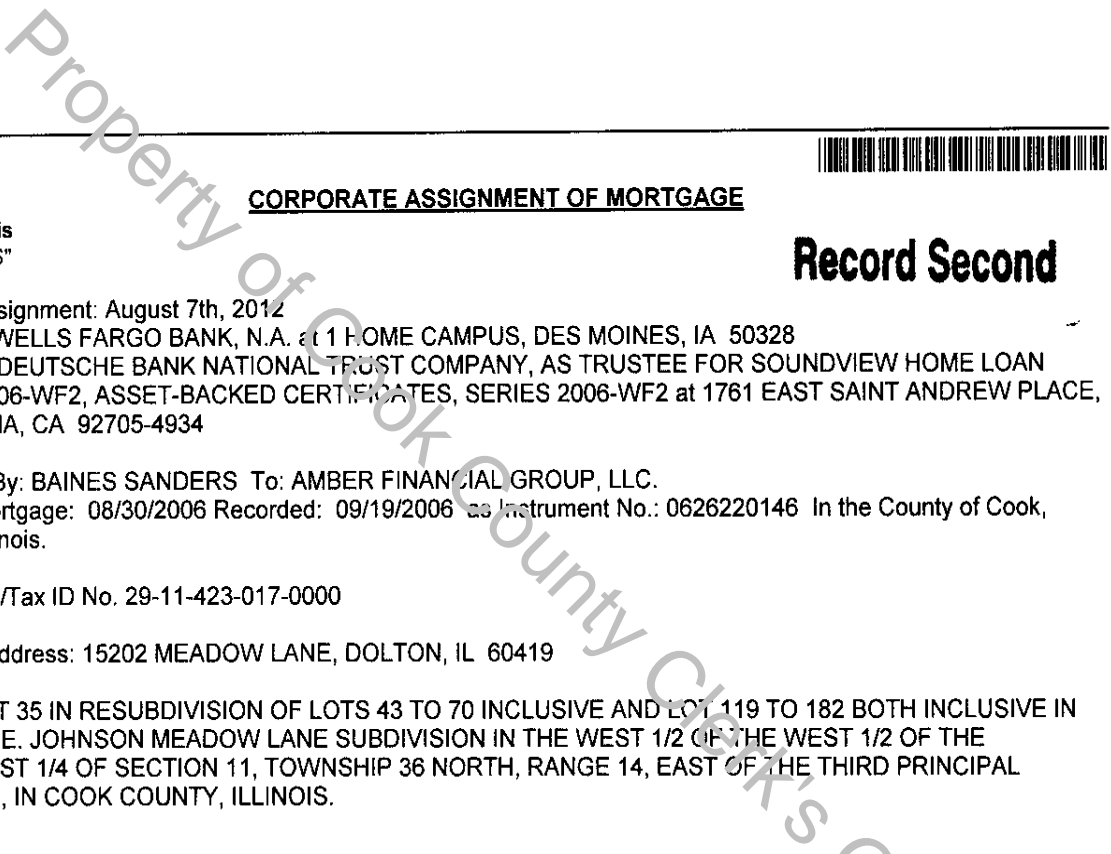

CORPORATE ASSIGNMENT OF MORTGAGE

Cook, Illinois
"SANDERS"

Record Second

Date of Assignment: August 7th, 2012
Assignor: WELLS FARGO BANK, N.A. at 1 HOME CAMPUS, DES MOINES, IA 50328
Assignee: DEUTSCHE BANK NATIONAL TRUST COMPANY, AS TRUSTEE FOR SOUNDVIEW HOME LOAN TRUST 2006-WF2, ASSET-BACKED CERTIFICATES, SERIES 2006-WF2 at 1761 EAST SAINT ANDREW PLACE, SANTA ANA, CA 92705-4934

Executed By: BAINES SANDERS To: AMBER FINANCIAL GROUP, LLC.
Date of Mortgage: 08/30/2006 Recorded: 09/19/2006 as Instrument No.: 0626220146 In the County of Cook, State of Illinois.

Assessor's/Tax ID No. 29-11-423-017-0000

Property Address: 15202 MEADOW LANE, DOLTON, IL 60419

Legal: LOT 35 IN RESUBDIVISION OF LOTS 43 TO 70 INCLUSIVE AND LOT 119 TO 182 BOTH INCLUSIVE IN HENNING E. JOHNSON MEADOW LANE SUBDIVISION IN THE WEST 1/2 OF THE WEST 1/2 OF THE SOUTHEAST 1/4 OF SECTION 11, TOWNSHIP 36 NORTH, RANGE 14, EAST OF THE THIRD PRINCIPAL MERIDIAN, IN COOK COUNTY, ILLINOIS.

KNOW ALL MEN BY THESE PRESENTS, that for good and valuable consideration, the receipt and sufficiency of which is hereby acknowledged, the said Assignor hereby assigns unto the above-named Assignee, the said Mortgage having an original principal sum of \$80,275.00 with interest, secured thereby, with all moneys now owing or that may hereafter become due or owing in respect thereof, and the full benefit of all the powers and of all the covenants and provisos therein contained, and the said Assignor hereby grants and conveys unto the said Assignee, the Assignor's beneficial interest under the Mortgage.

TO HAVE AND TO HOLD the said Mortgage, and the said property unto the said Assignee forever, subject to the terms contained in said Mortgage.

*JBE*JBEWFEM*08/07/2012 10:03:33 AM* WFFEM01WFFEMA000000000000000637800* ILCOOK* ILSTATE_MORT_ASSIGN_ASSN **JBEWFEM*

S
P
S
M
SC
E
INT

UNOFFICIAL COPY

CORPORATE ASSIGNMENT OF MORTGAGE Page 2 of 2

WELLS FARGO BANK, N.A.

On 8/7/2012

By: *Stephanie Tautges*
Stephanie Tautges
Vice President Loan Documentation

STATE OF Minnesota
COUNTY OF Dakota

On 8/7/2012, before me, Brenda Chepkech Mutua, a Notary Public in Dakota County in the State of Minnesota, personally appeared Stephanie Tautges, Vice President Loan Documentation, personally known to me (or proved to me on the basis of satisfactory evidence) to be the person(s) whose name(s) is/are subscribed to the within instrument and acknowledged to me that he/she/they executed the same in his/her/their authorized capacity, and that by his/her/their signature on the instrument the person(s), or the entity upon behalf of which the person(s) acted, executed the instrument.

WITNESS my hand and official seal,

Brenda Chepkech Mutua
Brenda Chepkech Mutua
Notary Expires: 1/31/2016

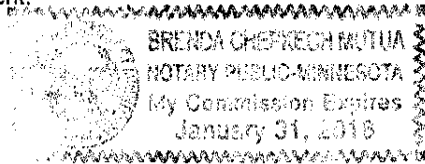

(This area for notarial seal)

Prepared By: Jaime Beckmann, WELLS FARGO BANK, N.A., 2701 WELLS FARGO WAY, MAC X9999-018, MINNEAPOLIS, MN 55467-8000 1-866-234-8271