

UNOFFICIAL COPY

CORRECTIVE RECORDING AFFIDAVIT

PREPARED BY &
MAIL TO:

MICHAEL A. DURLACHER
2 White Barn
Vernon Hills IL 60061

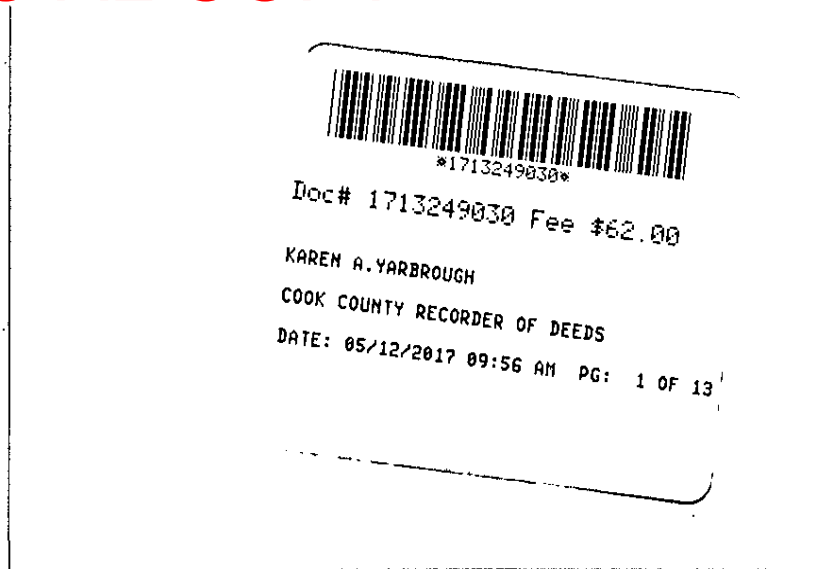

I, Michael Durlacher, THE AFFIANT, do hereby swear or affirm that the attached document number: 1536444046 was recorded on: December 30, 2015 by the Cook County Recorder of Deeds contained the following ERROR which this affidavit seek to correct:

1. On Page 1, First Paragraph, first sentence, second word. Delete "Twenty-Eight and insert Twenty-Ninth"
2. On Page 2, Sixth Paragraph, third line, insert: 1505829011 in the blank.

Furthermore, I Michael Durlacher, THE AFFIANT, do hereby swear or affirm that this submission includes a CERTIFIED COPY OR THE ORIGINAL DOCUMENT and this Corrective Recording Affidavit is being submitted to correct the aforementioned error. Finally, this correction was approved and/or agreed to by the original GRANTORS and GRANTEES as evidence by their notarized signatures below.

IN WITNESS WHEREOF, S. Mark Smith, Manager of Wheeling Prairie LLC, the Grantor and Lee Waller, President and authorized signatory of the Prairie Park at Wheeling Condominium Association, the Grantee have caused their signatures to be hereto affixed, and have caused their names to be signed to these presents this 20th day of April 2017.

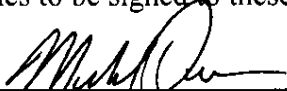
Prepared: Michael Durlacher Date 4/20/17

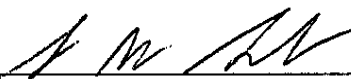
S. Mark Smith, Managing Member-Date 4/20/17
Wheeling Prairie LLC

Lee Waller Date 4/20/17
President and authorized signatory of
Prairie Park at Wheeling Condominium Association.

State of Illinois)

County of Cook)

UNOFFICIAL COPY

I, the undersigned, a Notary Public, in and for the County and State aforesaid, DO HEREBY CERTIFY that S. SMITH, LEE WALLER and MICHAEL DURLACHER personally known to me to be the same persons whose names are subscribed to the foregoing instrument, appeared before me this day in person and severally acknowledged that as such persons, they signed and delivered the said instrument and caused the corporate seal of said corporation to be affixed thereto, pursuant to the authority given by the Board of Directors of said corporation, as their free and voluntary act, and as the free and voluntary act and deed of said corporation, for the uses and purposes therein set forth.

Given under my hand and official seal this day of 20th of Aug, 2017.

Lauri Shamis
Notary Public

State of Illinois)



Property of Cook County Clerk's Office

UNOFFICIAL COPY

Prepared by and when recorded
Return to:

Michael A. Durlacher, Esq.
Durlacher & Associates, PC
1837 Larkin Ave.
Elgin IL 60123

Doc#: 1536444046 Fee: \$58.00
RHSP Fee: \$9.00 RPRF Fee: \$1.00
Karen A. Yarbrough
Cook County Recorder of Deeds
Date: 12/30/2015 12:24 PM Pg: 1 of 11

RECORDER'S STAMP

**TWENTY-NINTH AMENDMENT TO THE DECLARATION OF CONDOMINIUM
THE PRAIRIE PARK AT WHEELING CONDOMINIUM**

THIS TWENTY EIGHTH AMENDMENT ("TWENTY NINTH AMENDMENT") TO THE DECLARATION OF CONDOMINIUM FOR THE PRAIRIE PARK AT WHEELING CONDOMINIUM ("DECLARATION") is made and entered into as of December 21, 2015, by Wheeling Prairie, L.L.C., a Delaware limited liability company, successor by merger with Wheeling Prairie, L.L.C., an Illinois limited liability company ("Developer"):

WITNESSETH THAT:

WHEREAS, Developer made and entered into the DECLARATION dated March 3, 2005, which was recorded with the Cook County Recorder of Deeds on March 5, 2005 as Document No. 0506203148;

WHEREAS, Developer made and entered into the FIRST AMENDMENT TO THE DECLARATION on March 19, 2006, which was recorded with the Cook County Recorder of Deeds on March 19, 2006 as Document No. 0613912137 ("FIRST AMENDMENT");

WHEREAS, Developer made and entered into the SECOND AMENDMENT TO THE DECLARATION on September 22, 2006, which was recorded with the Cook County Recorder of Deeds on September 22, 2006 as Document No. 0626539001 ("SECOND AMENDMENT"); and entered into a NOTICE OF CORRECTION TO THE SECOND AMENDMENT on April 20, 2007, which was recorded June 22, 2007 as Document No. 0717315102 ("NOTICE OF CORRECTION TO SECOND AMENDMENT");

WHEREAS, Developer made and entered into the THIRD AMENDMENT TO THE

UNOFFICIAL COPY

DECLARATION on April 10, 2007, which was recorded with the Cook County Recorder of Deeds on April 10, 2007 as Document No. 0710022123 (“**THIRD AMENDMENT**”);

WHEREAS, Developer made and entered into the **FOURTH AMENDMENT TO THE DECLARATION** on November 30, 2007, which was recorded December 4, 2007, with the Cook County Recorder of Deeds as Document No. 0733815076 (“**FOURTH AMENDMENT**”);

WHEREAS, Developer made and entered into the **FIFTH AMENDMENT TO THE DECLARATION AND NOTICE OF CORRECTION TO THE FIFTH AMENDMENT TO DECLARATION OF CONDOMINIUM THE PRAIRIE PARK AT WHEELING CONDOMINIUM** dated April 28, 2008, which was recorded April 28, 2008 as Document No. 0811922076 (“**FIFTH AMENDMENT**”);

WHEREAS, Developer made and entered into the **SIXTH AMENDMENT TO THE DECLARATION** on June 27, 2008, which was recorded June 27, 2008, with the Cook County Recorder of Deeds as Document No. 0817916033 (“**SIXTH AMENDMENT**”);

WHEREAS, Developer made and entered into the **SEVENTH AMENDMENT TO THE DECLARATION** on October 15, 2008 recorded October 15, 2008, with the Cook County Recorder of Deeds as Document No. 0817916033 (“**SEVENTH AMENDMENT**”);

WHEREAS, Developer made and entered into the **EIGHTH AMENDMENT TO THE DECLARATION** on April 3, 2009, which was recorded April 3, 2009, with the Cook County Recorder of Deeds as Document No. 0909303034 (“**EIGHTH AMENDMENT**”);

WHEREAS, Developer made and entered into the **NINTH AMENDMENT TO THE DECLARATION** on August 17, 2009, which was recorded August 25, 2009, with the Cook County Recorder of Deeds as Document No. 0923734046 (“**NINTH AMENDMENT**”);

WHEREAS, Developer made and entered into the **TENTH AMENDMENT TO THE DECLARATION** on November 30, 2009, which was recorded on November 30, 2009 with the Cook County Recorder of Deeds as Document No. 0933434116 (“**TENTH AMENDMENT**”);

WHEREAS, Developer made and entered into the **ELEVENTH AMENDMENT TO THE DECLARATION** on August 20, 2009, which was recorded on September 3, 2010 with the Cook County Recorder of Deeds as Document No. 0933434116 (“**ELEVENTH AMENDMENT**”);

WHEREAS, Developer made and entered into the **TWELFTH AMENDMENT TO THE DECLARATION** on February 29, 2012, which was recorded on March 2, 2012 with the Cook County Recorder of Deeds as Document No. 1206245024 (“**TWELFTH AMENDMENT**”);

WHEREAS, Developer made and entered into the **THIRTEENTH AMENDMENT TO THE DECLARATION** on October 16, 2012, which was recorded on October 26, 2012 with the Cook

UNOFFICIAL COPY

County Recorder of Deeds as Document No. 1230013013 (“**THIRTEENTH AMENDMENT**”);

WHEREAS, Developer made and entered into the **FOURTEETH AMENDMENT TO THE DECLARATION** on December 17, 2012, which was recorded on January 2, 2013 with the Cook County Recorder of Deeds as Document No. 1300222026 (“**FOURTEENTH AMENDMENT**”);

WHEREAS, Developer made and entered into the **FIFTEENTH AMENDMENT TO THE DECLARATION** on March 11, 2012, which was recorded on April 25, 2013 with the Cook County Recorder of Deeds as Document No. 1311522077 (“**FIFTEENTH AMENDMENT**”);

WHEREAS, Developer made and entered into the **SIXTEENTH AMENDMENT TO THE DECLARATION** on May 31, 2013, which was recorded on June 20, 2013 with the Cook County Recorder of Deeds as Document No. 1317118014 (“**SIXTEENTH AMENDMENT**”);

WHEREAS, Developer made and entered into the **SEVENTEENTH AMENDMENT TO THE DECLARATION** on June 23, 2013, which was recorded on July 23, 2013 with the Cook County Recorder of Deeds as Document No. 1320422040 (“**SEVENTEENTH AMENDMENT**”);

WHEREAS, Developer made and entered into the **EIGHTEENTH AMENDMENT TO THE DECLARATION** on June 28, 2013, which was recorded on August 26, 2013 with the Cook County Recorder of Deeds as Document No. 1323822039 (“**EIGHTEENTH AMENDMENT**”);

WHEREAS, Developer made and entered into the **NINETEENTH AMENDMENT TO THE DECLARATION** on November 19, 2013, which was recorded on November 27, 2013 with the Cook County Recorder of Deeds as Document No. 1333122063 (“**NINETEENTH AMENDMENT**”); and entered into a **NOTICE OF CORRECTION TO THE NINETEENTH AMENDMENT** on November 19, 2014 which was recorded February 25, 2014 as Document No. 1405622026 (“**NOTICE OF CORRECTION TO NINETEENTH AMENDMENT**”);

WHEREAS, Developer made and entered into the **TWENTIETH AMENDMENT TO THE DECLARATION** on February 27, 2014, which was recorded on March 4, 2014 with the Cook County Recorder of Deeds as Document No. 1406322002 (“**TWENTIETH AMENDMENT**”);

WHEREAS, Developer made and entered into the **TWENTY FIRST AMENDMENT TO THE DECLARATION** on May 10, 2014, which was recorded on May 29, 2014 with the Cook County Recorder of Deeds as Document No. 1414922016 (“**TWENTY FIRST AMENDMENT**”);

WHEREAS, Developer made and entered into the **TWENTY SECOND AMENDMENT TO THE DECLARATION** on June 16, 2014, which was recorded on June 26, 2014 with the Cook County Recorder of Deeds as Document No. 1417719005 (“**TWENTY SECOND AMENDMENT**”);

WHEREAS, Developer made and entered into the **TWENTY THIRD AMENDMENT TO**

UNOFFICIAL COPY

THE DECLARATION on July 22, 2014, which was recorded on July 29, 2014 with the Cook County Recorder of Deeds as Document No. 1412016000 (“**TWENTY THIRD AMENDMENT**”);

WHEREAS, Developer made and entered into the TWENTY FOURTH AMENDMENT TO THE DECLARATION on September 8, 2014, which was recorded on September 11, 2014 with the Cook County Recorder of Deeds as Document No. 1425418010 (“**TWENTY FOURTH AMENDMENT**”);

WHEREAS, Developer made and entered into the TWENTY FIFTH AMENDMENT TO THE DECLARATION on October 10, 2014, which was recorded on October 16, 2014 with the Cook County Recorder of Deeds as Document No. 1428922001 (“**TWENTY FIFTH AMENDMENT**”);

WHEREAS, Developer made and entered into the TWENTY SIXTH AMENDMENT TO THE DECLARATION on December 10, 2014, which was recorded on December 22, 2014 with the Cook County Recorder of Deeds as Document No. 143516027 (“**TWENTY SIXTH AMENDMENT**”);

WHEREAS, Developer made and entered into the TWENTY SEVENTH AMENDMENT TO THE DECLARATION on January 16, 2015, which was recorded on January 22 with the Cook County Recorder of Deeds as Document No. 1502222002 (“**TWENTY SEVENTH AMENDMENT**”);

WHEREAS, Developer made and entered into the TWENTY EIGHTH AMENDMENT TO THE DECLARATION on February 26, 2015, which was recorded on February 27, 2015 with the Cook County Recorder of Deeds as Document No. _____ (“**TWENTY EIGHTH AMENDMENT**”);

WHEREAS, the 70 Residential Units and 137 Parking Units added to the Declaration in the Twenty-Eighth Amendment were added prior to the actual construction of those Units referenced above were not constructed by Wheeling Prairie LLC or any successor or assignee. Accordingly those Units, not having been constructed are now being removed from the Declaration and Exhibit D reflecting the percentages of ownership interest in the Common Elements for each of the Units is being revised to reflect the percentages of ownership interest prior to the recording of the Twenty-Eighth Amendment which are reflected in the Twenty-Seventh Amendment.

WHEREAS, Developer, a limited liability company organized under the State of Delaware, and as the successor by merger to Wheeling Prairie L.L.C., an Illinois limited liability company, is the legal title holder of the Additional Parcel as defined and described in Article XII of the DECLARATION;

NOW THEREFORE, the DECLARATION is hereby amended as follows:

UNOFFICIAL COPY

1. The DECLARATION is hereby amended to submit the revised Plat of Survey depicting a total of 238 Residential Units:

45 Prairie Park Dr. - Building I containing 48 Residential Units and 87 Parking Units
 40 Prairie Park Dr. - Building II containing 72 Residential Units 88 Parking Units
 115 Prairie Park Dr. - Building III containing 47 Residential Units and 87 Parking Units
 100 Prairie Park Dr. - Building IV containing 71 Residential Units and 88 Parking Units A
 set forth on Exhibit E attached thereto.

2. The following represents the Units REMOVED by this TWENTY-NINTH AMENDMENT

The Following (70) Residential Units are remove from the DECLARATION:: Unit 5-201, 5-202, 5-203, 5-204, 5-205, 5-206, 5-207, 5-208, 5-209, 5-210, 5-301, 5-302, 5-303, 5-304, 5-305, 5-306, 5-307, 5-308, 5-309, 5-310, 5-401, 5-402, 5-403, 5-404, 5-405, 5-406, 5-407, 5-408, 5-409, 5-410, 5-501, 5-502, 5-503, 5-504, 5-505, 5-506, 5-507, 5-508, 5-509, 5-510, 5-601, 5-602, 5-603, 5-604, 5-605, 5-606, 5-607, 5-608, 5-609, 5-610, 5-701, 5-702, 5-703, 5-704, 5-705, 5-706, 5-707, 5-708, 5-709, 5-710, 5-801, 5-802, 5-803, 5-804, 5-805, 5-806, 5-807, 5-808, 5-809, 5-810 and Parking Spaces 5-1-1 to 5-1-137.

3. Exhibit D to the DECLARATION, as amended, is replaced with Exhibit D attached hereto stating the revised percentages of ownership interest in the Common Elements for each of the Units.

4. Exhibit E attached to the TWENTY-EIGHTH AMENDMENT to the DECLARATION is hereby amended and Exhibit E attached hereto is hereby added to the Prior Exhibit Es of all the prior Amendments and Declaration. .

5. Except as expressly amended hereby, the DECLARATION, the FIRST AMENDMENT the SECOND AMENDMENT, the THIRD AMENDMENT, the FIFTHAMENDMENT, the FIFTH AMENDMENT, the SIXTH AMENDMENT, the SEVENTH AMENDMENT, the EIGHTH AMENDMENT, the NINTH AMENDMENT, the TENTH AMENDMENT, the ELEVENTH AMENDMENT, the TWELFTH AMENDMENT, the THIRTEENTH AMENDMENT, FOURTEENTH AMENDMENT, FIFTEENTH AMENDMENT, SIXTEENTH AMENDMENT, SEVENTEENTH AMENDMENT, EIGHTEENTH AMENDMENT, NINETEENTH AMENDMENT, TWENTIETH AMENDMENT, TWENTY-FIRST AMENDMENT, TWENTY-SECOND, TWENTY-THRID, TWENTY-FOURTH, TWENTY-FIFTH AMENDMENT, TWENTY SIXTH AMENDMENT, TWENTY-SEVENTY AMENDMENT and TWENTY-EIGHTH AMENDMENT to the DECLARATION shall remain in full force and effect in accordance with their terms. This TWENTY NINTH AMENDMENT to the DECLARATION shall be effective from and after the date of recording thereof with the Recorder of

UNOFFICIAL COPY

Deeds of Cook County, Illinois.

TABLE OF EXHIBITS

- A. Legal Description for Prairie Park at Wheeling Condominium.
- B. No Exhibit Attached.
- C. No Exhibit Attached. Bylaws of Prairie Park at Wheeling Condominium are attached to the Declaration as Exhibit C.
- D. Percentages of Ownership Interest in the Common Elements.

IN WITNESS WHEREOF, Wheeling Prairie, L.L.C. has caused this instrument to be signed by its Managing Members at Wheeling, Illinois, on this 21 day of December, 2015.

WHEELING PRAIRIE, L.L.C., a Delaware limited liability company.

By: [Signature]
S. Mark Smith, Managing Member

By: [Signature]
Vivian Smith, Managing Member

STATE OF ILLINOIS)
)
COUNTY OF COOK)

SS

I, the undersigned, a Notary Public in and for the County and State aforesaid, DO HEREBY CERTIFY, that S. Mark Smith and Vivian Smith, as Managing Members of Wheeling Prairie, L.L.C., a Delaware limited liability company, personally known to me to be the same persons whose names are subscribed to the foregoing instrument, appeared before me this day in person and acknowledged that they signed and delivered the said instrument as their own free and voluntary act and as the free and voluntary act of said limited liability company, for the uses and purposes therein set forth.

Given under my hand and Notarial Seal this 21 day of December, 2015.

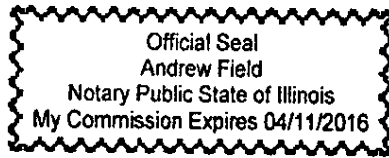

[Signature]
Notary Public

My Commission Expires: _____

UNOFFICIAL COPY

LEGAL DESCRIPTION

PRAIRIE PARK AT WHEELING

THAT PART OF LOT 1 IN PRAIRIE PARK AT WHEELING SUBDIVISION OF PARTS OF THE NORTH HALF OF SECTION 2, TOWNSHIP 42 NORTH, RANGE 11 EAST OF THE THIRD PRINCIPAL MERIDIAN, EXCEPT THAT PART DESCRIBED AS FOLLOWS:

BEGINNING AT THE SOUTHEAST CORNER OF SAID LOT 1, THENCE N 89°59'34" W, ALONG THE SOUTH LINE OF SAID LOT 1, 620.00 FEET; THENCE N 00°00'26" E, 347.42 FEET; THENCE S 89°59'34" E, 662.44 FEET, TO THE EAST LINE OF SAID LOT ONE, THENCE S 06°58'20" W, ALONG THE EAST LINE OF SAID LOT 1, 350.00 FEET, MORE OR LESS TO THE POINT OF BEGINNING, ALL IN COOK COUNTY, ILLINOIS.

PIN: 03-02-100-073-0000 (Underlying)

Common Addresses: 40, 45, 100, 115 and 70 Prairie Park Dr. Wheeling IL 60090

Property of Cook County Clerk's Office

UNOFFICIAL COPY

Exhibit D – Twenty-Ninth Amendment

Page 1 of 4

**EXHIBIT D - TWENTY-NINETH DECLARATION OF CONDOMINIUM FOR
PRAIRIE PARK AT WHEELING
PERCENTAGE OF OWNERSHIP INTEREST IN THE COMMON ELEMENTS**

<u>Unit No.</u>	<u>Percentage Interest (%)</u>	<u>Unit No.</u>	<u>Percentage Interest (%)</u>	<u>Unit No.</u>	<u>Percentage Interest (%)</u>	<u>Unit No.</u>	<u>Percent Interest</u>
1-201	.340	1-401	.343	P-1-01	.0146	P-1-45	.0146
1-202	.364	1-402	.368	P-1-02	.0146	P-1-46	.0146
1-203	.437	1-403	.440	P-1-03	.0146	P-1-47	.0146
1-204	.495	1-404	.499	P-1-04	.0146	P-1-48	.0146
1-205	.310	1-405	.314	P-1-05	.0146	P-1-49	.0146
1-206	.313	1-406	.387	P-1-06	.0146	P-1-50	.0146
1-207	.349	1-407	.353	P-1-07	.0146	P-1-51	.0146
1-208	.310	1-408	.314	P-1-08	.0146	P-1-52	.0146
1-209	.495	1-409	.499	P-1-09	.0146	P-1-53	.0146
1-210	.558	1-410	.562	P-1-10	.0146	P-1-54	.0146
1-211	.246	1-411	.250	P-1-11	.0146	P-1-55	.0146
1-212	.412	1-412	.416	P-1-12	.0146	P-1-56	.0146
1-301	.341	1-501	.345	P-1-13	.0146	P-1-57	.0146
1-302	.366	1-502	.370	P-1-14	.0146	P-1-58	.0146
1-303	.439	1-503	.442	P-1-15	.0146	P-1-59	.0146
1-304	.497	1-504	.501	P-1-16	.0146	P-1-60	.0146
1-305	.312	1-505	.316	P-1-17	.0146	P-1-61	.0146
1-306	.385	1-506	.389	P-1-18	.0146	P-1-62	.0146
1-307	.351	1-507	.355	P-1-19	.0146	P-1-63	.0146
1-308	.312	1-508	.316	P-1-20	.0146	P-1-64	.0146
1-309	.497	1-509	.501	P-1-21	.0146	P-1-65	.0146
1-310	.560	1-510	.565	P-1-22	.0146	P-1-66	.0146
1-311	.248	1-511	.252	P-1-23	.0146	P-1-67	.0146
1-312	.414	1-512	.418	P-1-24	.0146	P-1-68	.0146
BUILDING II – 40 Prairie Park Dr.				P-1-25	.0146	P-1-69	.0146
2-201	.340	2-501	.345	P-1-26	.0146	P-1-70	.0146
2-202	.364	2-502	.370	P-1-27	.0146	P-1-71	.0146
2-203	.437	2-503	.442	P-1-28	.0146	P-1-72	.0146
2-204	.495	2-504	.501	P-1-29	.0146	P-1-73	.0146
2-205	.310	2-505	.316	P-1-30	.0146	P-1-74	.0146
2-206	.383	2-506	.389	P-1-31	.0146	P-1-75	.0146
2-207	.349	2-507	.355	P-1-32	.0146	P-1-76	.0146
2-208	.310	2-508	.316	P-1-33	.0146	P-1-77	.0146
2-209	.495	2-509	.501	P-1-34	.0146		
2-210	.435	2-510	.440	P-1-35	.0146	P-1-79	.0146
2-211	.364	2-511	.370	P-1-36	.0146	P-1-80	.0146
2-212	.412	2-512	.418	P-1-37	.0146	P-1-81	.0146
2-301	.341	2-601	.347	P-1-38	.0146	P-1-82	.0146
2-302	.366	2-602	.372	P-1-39	.0146	P-1-83	.0146
2-303	.439	2-603	.444	P-1-40	.0146	P-1-84	.0146
2-304	.497	2-604	.503	P-1-41	.0146	P-1-85	.0146
2-305	.312	2-605	.318	P-1-42	.0146	P-1-86	.0146
2-306	.385	2-606	.391	P-1-43	.0146	P-1-87	.0146
2-307	.351	2-607	.357	P-1-44	.0146	P-1-88	.0146
2-308	.312	2-608	.318	Building II - Parking Spaces			
2-309	.497	2-609	.503	P-2-1	.0146	P-2-45	.0146

UNOFFICIAL COPY

Exhibit D – Twenty-Ninth Amendment

Page 2 of 4

2-310	.436	2-610	.442	P-2-2	.0146	P-2-46	.0146
2-311	.366	2-611	.372	P-2-3	.0146	P-2-47	.0146
2-312	.414	2-612	.420	P-2-4	.0146	P-2-48	.0146
2-401	.343	2-701	.349	P-2-5	.0146	P-2-49	.0146
2-402	.368	2-702	.374	P-2-6	.0146	P-2-50	.0146
2-403	.440	2-703	.446	P-2-7	.0146	P-2-51	.0146
2-404	.499	2-704	.505	P-2-8	.0146	P-2-52	.0146
2-405	.314	2-705	.320	P-2-9	.0146	P-2-53	.0146
2-406	.387	2-706	.393	P-2-10	.0146	P-2-54	.0146
2-407	.353	2-707	.359	P-2-11	.0146	P-2-55	.0146
2-408	.314	2-708	.320	P-2-12	.0146	P-2-56	.0146
2-409	.499	2-709	.505	P-2-13	.0146	P-2-57	.0146
2-410	.420	2-710	.444	P-2-14	.0146	P-2-58	.0146
2-411	.368	2-711	.374	P-2-15	.0146	P-2-59	.0146
2-412	.416	2-712	.422	P-2-16	.0146	P-2-60	.0146

Building III Units – 115 PRAIRIE PARK

3-201	.340	3-401	.343	P-2-17	.0146	P-2-61	.0146
3-202	.364	3-402	.368	P-2-18	.0146	P-2-62	.0146
3-203	.437	3-403	Combined	P-2-19	.0146	P-2-63	.0146
3-204	.495	3-404	.337	P-2-20	.0146	P-2-64	.0146
3-205	.310	3-405	.314	P-2-21	.0146	P-2-65	.0146
3-206	.383	3-406	.387	P-2-22	.0146	P-2-66	.0146
3-207	.349	3-407	.353	P-2-23	.0146	P-2-67	.0146
3-208	.310	3-408	.314	P-2-24	.0146	P-2-68	.0146
3-209	.495	3-409	.499	P-2-25	.0146	P-2-69	.0146
3-210	.552	3-410	.556	P-2-26	.0146	P-2-70	.0146
3-211	.252	3-411	.256	P-2-27	.0146	P-2-71	.0146
3-212	.412	3-412	.416	P-2-28	.0146	P-2-72	.0146
3-301	.341	3-501	.345	P-2-29	.0146	P-2-73	.0146
3-302	.366	3-502	.370	P-2-30	.0146	P-2-74	.0146
3-303	.439	3-503	.442	P-2-31	.0146	P-2-75	.0146
3-304	.497	3-504	.501	P-2-32	.0146	P-2-76	.0146
3-305	.312	3-505	.316	P-2-33	.0146	P-2-77	.0146
3-306	.385	3-506	.389	P-2-34	.0146	P-2-78	.0146
3-307	.351	3-507	.355	P-2-35	.0146	P-2-79	.0146
3-308	.312	3-508	.316	P-2-36	.0146	P-2-80	.0146
3-309	.497	3-509	.501	P-2-37	.0146	P-2-81	.0146
3-310	.554	3-510	.558	P-2-38	.0146	P-2-82	.0146
3-311	.254	3-511	.258				
3-312	.414	5-512	.418				

Building III Parking Spaces

P-3-01	.0146						
P-3-02	.0146	P-3-45	.0146	P-2-39	.0146	P-2-83	.0146
P-3-03	.0146	P-3-46	.0146	P-2-40	.0146	P-2-84	.0146
P-3-04	.0146	P-3-47	.0146	P-2-41	.0146	P-2-85	.0146
P-3-05	.0146	P-3-48	.0146	P-2-42	.0146	P-2-86	.0146
P-3-06	.0146	P-3-49	.0146	P-2-43	.0146	P-2-87	.0146
P-3-07	.0146	P-3-50	.0146	P-2-44	.0146	P-2-88	.0146

UNOFFICIAL COPY

Exhibit D – Twenty-Ninth Amendment

Page 3 of 4

P-3-08	.0146	P-3-51	.0146			P-2-89	.0146
				Building			
				IV –			
				Parking			
				Spaces			
		P-3-52	.0146	P-4-01	.0146	P-4-45	.0146
		P-3-53	.0146	P-4-02	.0146	P-4-46	.0146
P-3-09	.0146	P-3-54	.0146	P-4-03	.0146	P-4-47	.0146
P-3-11	.0146	P-3-55	.0146	P-4-04	.0146	P-4-48	.0146
P-3-13	.0146	P-3-56	.0146	P-4-05	.0146	P-4-49	.0146
P-3-14	.0146	P-3-57	.0146	P-4-06	.0146	P-4-50	.0146
P-3-15	.0146	P-3-58	.0146	P-4-07	.0146	P-4-51	.0146
P-3-16	.0146	P-3-59	.0146	P-4-08	.0146	P-4-52	.0146
P-3-17	.0146	P-3-60	.0146	P-4-09	.0146	P-4-53	.0146
P-3-18	.0146	P-3-61	.0146	P-4-10	.0146	P-4-54	.0146
P-3-19	.0146	P-3-62	.0146	P-4-11	.0146	P-4-55	.0146
P-3-20	.0146	P-3-63	.0146	P-4-12	.0146	P-4-56	.0146
P-3-21	.0146	P-3-64	.0146	P-4-13	.0146	P-4-57	.0146
P-3-22	.0146	P-3-65	.0146	P-4-14	.0146	P-4-58	.0146
P-3-23	.0146	P-3-66	.0146	P-4-15	.0146	P-4-59	.0146
P-3-24	.0146	P-3-67	.0146	P-4-16	.0146	P-4-60	.0146
P-3-25	.0146	P-3-68	.0146	P-4-17	.0146	P-4-61	.0146
P-3-26	.0146	P-3-69	.0146	P-4-18	.0146	P-4-62	.0146
P-3-27	.0146	P-3-70	.0146	P-4-19	.0146	P-4-63	.0146
P-3-28	.0146	P-3-71	.0146	P-4-20	.0146	P-4-64	.0146
P-3-29	.0146	P-3-72	.0146	P-4-21	.0146	P-4-65	.0146
P-3-30	.0146	P-3-73	.0146	P-4-22	.0146	P-4-66	.0146
P-3-31	.0146	P-3-74	.0146	P-4-23	.0146	P-4-67	.0146
P-3-32	.0146	P-3-75	.0146	P-4-24	.0146	P-4-68	.0146
P-3-33	.0146	P-3-76	.0146	P-4-25	.0146	P-4-69	.0146
P-3-34	.0146	P-3-77	.0146	P-4-26	.0146	P-4-70	.0146
P-3-35	.0146			P-4-27	.0146	P-4-71	.0146
P-3-36	.0146	P-3-79	.0146	P-4-28	.0146	P-4-72	.0146
P-3-37	.0146	P-3-80	.0146	P-4-29	.0146	P-4-73	.0146
P-3-38	.0146	P-3-81	.0146	P-4-30	.0146	P-4-74	.0146
P-3-39	.0146	P-3-82	.0146	P-4-31	.0146	P-4-75	.0146
P-3-40	.0146	P-3-83	.0146	P-4-32	.0146	P-4-76	.0146
P-3-41	.0146	P-3-84	.0146	P-4-33	.0146	P-4-77	.0146
P-3-42	.0146	P-3-85	.0146	P-4-34	.0146	P-4-78	.0146
P-3-43	.0146	P-3-86	.0146	P-4-35	.0146	P-4-79	.0146
P-3-44	.0146	P-3-87	.0146	P-4-36	.0146	P-4-80	.0146
		P-3-88	.0146	P-4-37	.0146	P-4-81	.0146
		P-3-89	.0146	P-4-38	.0146	P-4-82	.0146
		P-3-90	.0146	P-4-39	.0146	P-4-83	.0146
				P-4-40	.0146	P-4-84	.0146
				P-4-41	.0146	P-4-85	.0146
				P-4-42	.0146	P-4-86	.0146

UNOFFICIAL COPY

Exhibit D - Twenty-Ninth Amendment

Page 4 of 4

P-4-43	.0146	P-4-87	.0146
P-4-44	.0146	P-4-88	.0146

Building 4 - 100 Prairie Park Dr.

4-201	.340	4-501	.345
4-202	.364	4-502	.372
4-203	.437	4-503	Combined
4-204	.495	4-504	.941
4-205	.310	4-505	.316
4-206	.333	4-506	.389
4-207	.349	4-507	.355
4-208	.310	4-508	.316
4-209	.495	4-509	.501
4-210	.435	4-510	.440
4-211	.364	4-511	.370
4-212	.412	4-512	.418
4-301	.341	4-601	.247
4-302	.366	4-602	.372
4-303	.439	4-603	.444
4-304	.497	4-604	.503
4-305	.312	4-605	.318
4-306	.385	4-606	.391
4-307	.351	4-607	.357
4-308	.312	4-608	.318
4-309	.497	4-609	.503
4-310	.437	4-610	.442
4-311	.366	4-611	.372
4-312	.414	4-612	.420
4-401	.343	4-701	.349
4-402	.368	4-702	.374
4-403	.440	4-703	.446
4-404	.499	4-704	.505
4-405	.314	4-705	.320
4-406	.387	4-706	.393
4-407	.353	4-707	.359
4-408	.314	4-708	.320
4-409	.499	4-709	.505
4-410	.439	4-710	.444
4-411	.368	4-711	.374
4-412	.416	4-712	.422

TOTAL 100.00