

# UNOFFICIAL COPY

Doc#: 2104839077 Fee: \$98.00  
Karen A. Yarbrough  
Cook County Clerk  
Date: 02/17/2021 08:23 AM Pg: 1 of 16

## LICENSE AGREEMENT

### LICENSE AGREEMENT

THIS LICENSE AGREEMENT (the "Agreement") is made and entered into as of the 1<sup>st</sup> day of June, 2020, by and between North Center 4000 Condominium Association, an Illinois not-for-profit corporation ("Licensor") and Damen Blatteis LLC ("Licensee").

WHEREAS, Licensee owns Unit CU-3 (the "Unit") in the condominium property legally described in Exhibit "A" attached hereto (the "Condominium Property"); and

WHEREAS, Licensee desires to (i) install a window in the Common Element exterior wall appurtenant to the Unit as shown in the architectural rendering and specifications attached hereto as Exhibit "B", and (ii) install lighting on the Common Element exterior wall appurtenant to the Unit as show in the architectural rendering and specifications attached hereto as Exhibit "B" (hereinafter referred to as the "Alterations" or the "Work"); and

WHEREAS, Section 11(k) of the Declaration of Condominium Pursuant to the Condominium Property Act for North Center 4000 Condominiums (the "Declaration") provides that nothing shall be altered or constructed in or from the Common Elements without the written consent of the Association; and

WHEREAS, Licensee desires Licensor's written consent to perform the Alterations as more fully described in the plans and specifications attached hereto as Exhibit "B"; and

WHEREAS, Licensor is willing to provide Licensee with its written consent and grant Licensee a license to perform the Alterations on the terms and conditions contained herein.

---

This Document was prepared by and  
After recording return to:

Joseph W. Scharnak  
Kovitz Shifrin Nesbit  
175 North Archer Avenue  
Mundelein, Illinois 60060

Common Address:

4037 N Lincoln  
Unit CU-3  
Chicago, Illinois 60618

PIN: 14-18-328-003-1035

# UNOFFICIAL COPY

NOW THEREFORE, in consideration of the foregoing, the mutual covenants and agreements contained herein and other good and valuable consideration, the receipt and sufficiency of which is hereby acknowledged, Licensor and Licensee agree as follows:

1. Grant of License. Subject to the terms and conditions of this Agreement, Licensor hereby grants to Licensee, and Licensee hereby accepts from Licensor, a license (the "License") to perform the Alterations.

2. Work. Licensor hereby consents to Licensee's performance of the Alteration work (the "Work"), subject to the following limitations, terms and conditions:

- (a) Prior to commencement of the Work, Licensee shall submit to Licensor detailed plans and specifications for all aspects of the Work (the "Plans and Specifications") and shall not commence any portion of the Work without receipt of Licensor's written confirmation that the Plans and Specifications are approved.
- (b) Prior to commencement of the Work, Licensee shall furnish Licensor with written certification from a licensed architect or engineer that the Work, if performed in accordance with the Plans and Specifications, will conform to all applicable governmental statutes, ordinances and codes, and will not result in damage to any portion of the Licensor's property.
- (c) Prior to commencement of the Work, Licensee shall furnish the Licensor with copies of all building permits required for the Work.
- (d) The contractor engaged to perform the Work shall be acceptable to Licensor.
- (e) Each contractor providing services as part of the Work shall obtain and maintain (i) Contractor's all risk coverage (including vehicle coverage) in limits of not less than \$1,000,000 per occurrence; (ii) public liability insurance with limits of not less than \$1,000,000; and (iii) workmen's compensation insurance in accordance with the laws of the State of Illinois. Licensee shall submit to Licensor evidence of liability insurance in form and substance satisfactory to Licensor against any and all claims, costs, expenses, damages and liabilities which may arise in connection with the Work, all in such form and with such carriers as shall be satisfactory to Licensor. Such evidence of insurance shall be in the form of a certificate of insurance and shall name Licensor and Licensor's Board of Directors and managing agent as additional insureds, and not be subject to cancellation or material modification except after at least 30 days prior written notice to Licensor.
- (f) The entire cost and expense of the Work shall be paid solely by Licensee. Furthermore, Licensee shall pay (or promptly reimburse the Licensor for) all expenses incurred by Licensor in connection with the Work or this Agreement, including reasonable professional fees.
- (g) Licensee shall not permit any mechanic's liens to be placed on Licensor's property or any part thereof as a result of the Work, and in the event any such mechanic's lien is filed, Licensee will promptly discharge same or provide Licensor with reasonable security against any such liens. If Licensee fails to discharge any such liens or provide such reasonable security within sixty (60) days after written notice thereof from Licensor to Licensee, Licensor may, at its option, pay said lien or any portion thereof without

# UNOFFICIAL COPY

inquiry as to the validity thereof, and any amounts so paid by Licensor, including any expense incurred by Licensor in connection with said payment and interest thereon, shall be charged back to the assessment account for the Unit.

- (h) All Work shall be constructed in conformity with the Plans and Specifications, in a good and workmanlike manner, and in conformity with all governmental statutes, ordinances and codes. Licensee shall cause the Work to be paid for in full when due. At the request of Licensor, Licensee shall furnish to Licensor evidence satisfactory to Licensor that the Work has been paid for in full. Licensee shall use its best efforts to complete the Work no later than ten (10) days after commencement thereof. No Work shall be performed on Saturdays, Sundays, holidays or before 8:30 a.m. or after 4:30 p.m. Licensee's contractors shall keep Licensor's property free and clear of all debris. Licensor and its agents and employees shall have the right to inspect the Work at all reasonable times.
- (i) No further modifications shall be made by Licensee in or to Licensor's property without Licensor's prior written approval.
- (j) The window to be installed by the Licensee must be an aesthetic match to all existing windows currently installed in the building and the design and appearance of such window must be approved in writing by Licensor in advance.
- (k) Licensee, at its sole cost and expense, agrees to replace all exterior light fixtures on the Lincoln side of the building so that all light fixtures on the Lincoln side of the Building are identical and aesthetically harmonious. All such light fixtures must be approved in writing by Licensor in advance.

3. Inspection. Not more frequently than once per calendar year, Licensor, at Licensee's expense, shall cause a licensed architect or engineer to inspect the Licensor's property for damage caused by the Alterations.

4. Duty to Repair. Licensee, at its sole cost and expense, shall promptly repair any damage to the Licensor's property caused by the Alterations.

5. Licensee to Bear All Cost and Expenses. Licensee shall bear and pay all costs and expenses associated with the Alterations including, but not limited to, all costs and charges incurred by Licensor in connection with Licensor's architects and engineers reviewing Licensee's Plans and Specifications and inspecting the performance and completion of the Work.

6. Insurance. Licensee shall reimburse Licensor for any increase to the cost of Licensor's property insurance policy or liability insurance policy to the extent that such cost increase is solely related to the Alterations.

7. Termination. Licensor may, on not less than thirty (30) days' prior written notice from Licensor to Licensee, terminate this Agreement upon the occurrence of any one or more of the following events:

# UNOFFICIAL COPY

- a. If Licensee fails to perform any of Licensee's obligations hereunder, which breach continues uncured for ten (10) days after written notice from Licensor to Licensee.
- b. If the Unit is substantially damaged by fire or other casualty.
- c. If the Licensor reasonably believes that termination of this Agreement and removal of the Alterations is necessary to eliminate or prevent a material adverse effect on the Licensor's property, has so notified Licensee, and such material adverse effect either cannot be remedied or Licensee is unwilling to remedy such situation to the reasonable satisfaction of Licensor.

8. Restoration of Condominium Property Upon Expiration or Termination. Upon expiration or termination of this Agreement, Licensee shall, within thirty (30) days thereafter, at Licensee's sole cost and expense, restore the Condominium Property to substantially the same condition as prior to the installation of the Alterations, failing which the Licensor may restore its property to such condition all costs incurred in connection therewith shall be charged back to the Unit's assessment account.

9. Remedies. Licensee hereby expressly acknowledges and agrees that if this Agreement is terminated and Licensee fails to restore the Condominium Property to the condition it was in prior to installation of the Alterations, Licensor's remedies at law will be inadequate and Licensor shall be entitled to obtain specific performance of Licensee's obligation to restore Licensor's property as herein provided and to recover from Licensee all of its costs, including court costs and attorneys' fees, incurred in enforcing this Agreement. Failure of Licensee to pay any such amounts owed Licensor shall also entitle Licensor to exercise all remedies at law or in equity including recovery of reasonable attorneys' fees and costs incurred to enforce the provisions hereof.

10. Indemnity. Licensee agrees to indemnify, defend and hold harmless Licensor and Licensor's directors, officers, agents, managing agent and employees from and against any and all claims, demands, actions, liabilities, damages costs and expenses (including court costs and reasonable attorneys' fees), for injury to all persons and damage to or theft or misappropriation or loss of property occurring in any way arising out of this Agreement, Licensee's performance of the Work, maintenance and use of the Alterations, any breach or default on the part of Licensee in the performance of any covenant or agreement on the part of Licensee to be performed under this Agreement, or due to any other act or omission of Licensee or any party acting at the direction of Licensee. Licensee agrees, upon Licensor's request, to defend any such claim or proceeding at Licensee's sole cost and expense by legal counsel selected by Licensor.

11. Notices. All notices and approvals shall be given in writing, mailed or delivered as follows:

- (a) To Licensee:

Damen Blatteis LLC  
 41 Montgomery Street, Suite 1288  
 San Francisco, CA 94104

# UNOFFICIAL COPY

(b) To Licensor:

North Center 4000 Condominium Association  
Attention: Board of Directors  
4000 North Damen  
Chicago, Illinois 60618

12. Amendment. This Agreement may not be modified, changed, supplemented, superseded, canceled or terminated (unless terminated as provided herein), nor may any obligations hereunder be waived, except by written instrument signed by the parties hereto.

13. Severability; Counterparts. If any provisions, or portions thereof, of this Agreement, or the application thereof to any person or circumstances shall, to any extent, be invalid or unenforceable, the remainder of this Agreement, or the application of such provision, or portion thereof, to any other persons or circumstances shall not be affected thereby and each provision of this Agreement shall be valid and enforceable to the fullest extent permitted by law. This Agreement may be signed in counterpart by the parties hereto, and the signature pages and accompanying acknowledgments of all parties may thereafter be assembled as a single Agreement for recordation purposes, creating a fully executed Agreement, enforceable against the parties thereto.

14. Attorneys' Fees. Licensee shall pay on demand all reasonable costs, charges and expenses, including court costs and attorneys' fees, incurred by Licensor to enforce this Agreement.

15. Recording. Licensor shall cause this Agreement to be recorded in the office of the Recorder of Deeds of Cook County, Illinois.

16. Additional Terms. This Agreement shall be governed by and construed under the laws of the State of Illinois. The invalidity or unenforceability of any provision hereto shall not affect or impair any other provisions of this Agreement. Licensor's failure to insist, in any one or more instances, upon the performance of any of the terms, covenants or conditions of this Agreement, or to exercise any right granted herein, shall not be construed as a waiver or relinquishment of such term, covenant, condition or right as respects further performance. This Agreement contains the entire agreement of the parties hereto, and no representations, inducements or agreements, oral or otherwise, not contained in this Agreement shall be of any force and effect.

**END OF DOCUMENT**

**SIGNATURE ON FOLLOWING PAGE**

# UNOFFICIAL COPY

IN WITNESS WHEREOF, the undersigned have executed this Agreement as of the date first above written.

LICENSEE:

LICENSOR:

By *[Signature]*  
One of Its Managers

NORTH CENTER 4000  
CONDOMINIUM ASSOCIATION  
By *[Signature]*  
Its President

Property of Cook County Clerk's Office

# UNOFFICIAL COPY

Property of Cook County, Illinois

STATE OF ILLINOIS )  
                                  ) SS  
COUNTY OF COOK )

I, Daniel R. Scott, a Notary Public in and for the County and State aforesaid, do hereby certify that Erin Miller, President of North Center 4000 Condominium Association, an Illinois not for profit corporation, personally known to me to be the same person whose name is subscribed to the foregoing instrument as such President appeared before me this day in person and acknowledged that he/she signed and delivered the foregoing instrument as his/her own free and voluntary act and as the free and voluntary act of such corporation; for the uses and purposes therein set forth.

GIVEN under my hand and notarial seal this 12 day of June, 2020.

  
Notary Public



# UNOFFICIAL COPY

## ACKNOWLEDGMENT

A notary public or other officer completing this certificate verifies only the identity of the individual who signed the document to which this certificate is attached, and not the truthfulness, accuracy, or validity of that document.

State of California  
County of San Francisco

On 06/03/2020 before me, Brian Lee, Notary Public  
(insert name and title of the officer)

personally appeared DAVID SLATTEIS  
who proved to me on the basis of satisfactory evidence to be the person(s) whose name(s) is/are subscribed to the within instrument and acknowledged to me that he/she/they executed the same in his/her/their authorized capacity(ies), and that by his/her/their signature(s) on the instrument the person(s), or the entity upon behalf of which the person(s) acted, executed the instrument.

I certify under PENALTY OF PERJURY under the laws of the State of California that the foregoing paragraph is true and correct.

WITNESS my hand and official seal.

Signatures [Signature]

(Seal)

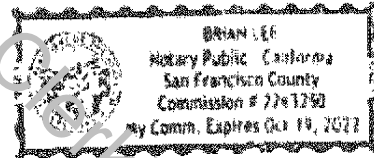

Property of [Faint watermark text]



# UNOFFICIAL COPY

## EXHIBIT A

### LEGAL DESCRIPTION

UNIT NUMBER CU-3 IN NORTH CENTER 4000 CONDOMINIUMS AS DELINEATED ON A SURVEY OF THE FOLLOWING DESCRIBED REAL ESTATE:

THAT PART OF BLOCK 12, LYING SOUTH OF THE SOUGH LINE OF BELLE PLAINE AVENUE IN WILLIAM B OGDEN'S SUBDIVISION OF THE SOUTHWEST ¼ OF SECTION 18, TOWNSHIP 40 NORTH, RANGE 14, EAST OF THE THIRD PRINCIPAL MERIDIAN, (EXCEPT THE NORTH 225 FEET THEREOF, MEASURED ALONG THE WESTERLY LINE OF NORTH ROBY STREET), IN COOK COUNTY, ILLINOIS; WHICH SURVEY IS ATTACHED TO THE DECLARATION OF CONDOMINIUM RECORDED AS DOCUMENT NUMBER 0020713829, TOGETHER WITH AN UNDIVIDED PERCENTAGE INTEREST IN THE COMMON ELEMENTS.

COMMON ADDRESS: 4037 NORTH LINCOLN AVENUE  
UNIT CU-3  
CHICAGO, ILLINOIS 60618

PINS: 14-18-328-003-1035

# UNOFFICIAL COPY

## EXHIBIT B

### ARCHITECTURAL RENDERING AND SPECIFICATIONS

Property of Cook County Clerk's Office

BANK OF AMERICA

4037 N LINCOLN AVE  
CHICAGO, IL

UNOFFICIAL COPY

1 10481 P110 M100A  
DATE: 10/10/10 10:23:25 AM

IA INTERIOR ARCHITECTS

CHICAGO  
795 S. MICHIGAN AVENUE, STE. 1200  
CHICAGO, IL 60605  
TEL: 312-465-5305 FAX: 312-465-5301

PROJECT: BANK OF AMERICA  
DRAWING: EXTERIOR ELEVATION  
DATE: 10/10/10

SCALE: 1/8" = 1'-0"

EXTERIOR ELEVATION  
A-9.0

Property of Cook County Clerk's Office

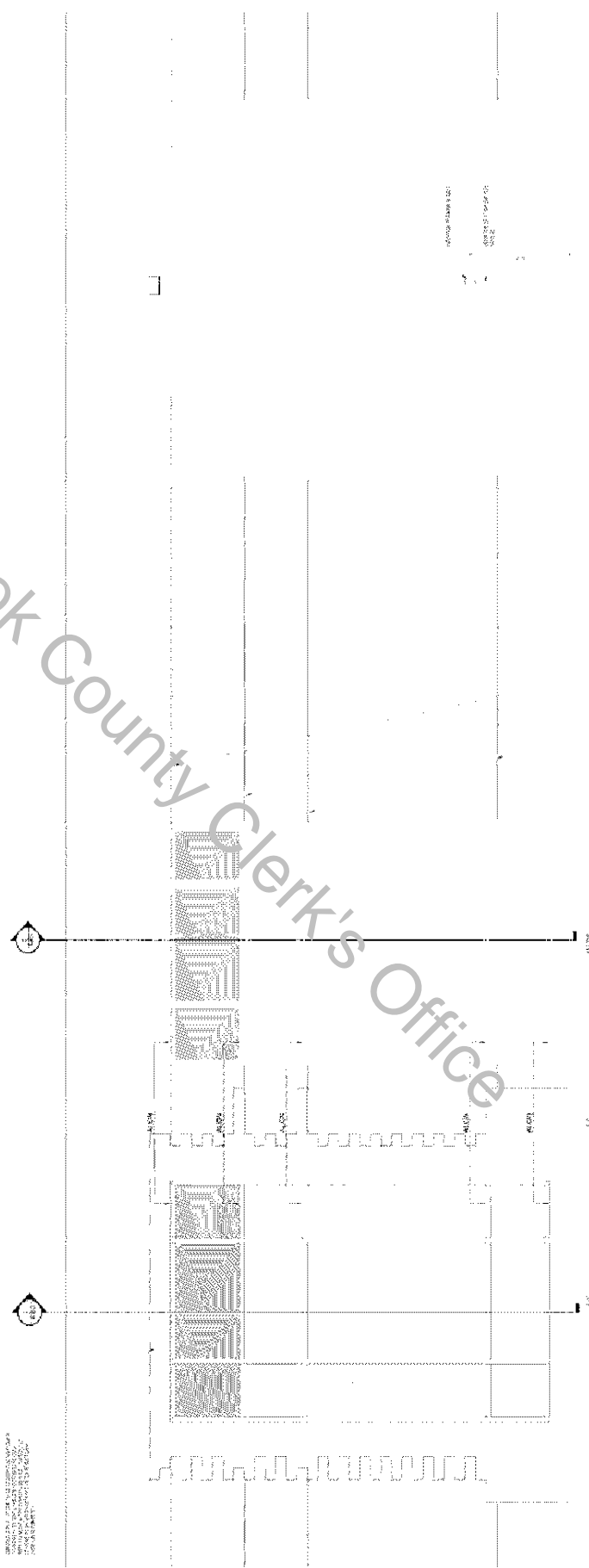

PROPERTY OF BANK OF AMERICA  
DRAWING: EXTERIOR ELEVATION  
DATE: 10/10/10

PROPERTY OF BANK OF AMERICA  
DRAWING: EXTERIOR ELEVATION  
DATE: 10/10/10



UNOFFICIAL COPY

BANK OF AMERICA  
4037 N LINCOLN AVE  
CHICAGO, IL

Project Name: GENERAL NOTES & FIRST FLOOR NEW OPENING

Sheet No: S10

Date: 4/20/20

Scale: 1/8" = 1'-0"

1. GENERAL NOTES: SEE ALL NOTES ON SHEETS S10 THROUGH S15.
2. ALL WORK SHALL BE IN ACCORDANCE WITH THE LATEST EDITIONS OF THE INTERNATIONAL BUILDING CODE (IBC) AND ALL APPLICABLE LOCAL ORDINANCES.
3. ALL MATERIALS SHALL BE APPROVED BY THE ARCHITECT AND SHALL BE INSTALLED IN ACCORDANCE WITH THE MANUFACTURER'S INSTALLATION INSTRUCTIONS.
4. ALL WORK SHALL BE DONE IN ACCORDANCE WITH THE LATEST EDITIONS OF THE INTERNATIONAL BUILDING CODE (IBC) AND ALL APPLICABLE LOCAL ORDINANCES.
5. ALL WORK SHALL BE DONE IN ACCORDANCE WITH THE LATEST EDITIONS OF THE INTERNATIONAL BUILDING CODE (IBC) AND ALL APPLICABLE LOCAL ORDINANCES.
6. ALL WORK SHALL BE DONE IN ACCORDANCE WITH THE LATEST EDITIONS OF THE INTERNATIONAL BUILDING CODE (IBC) AND ALL APPLICABLE LOCAL ORDINANCES.
7. ALL WORK SHALL BE DONE IN ACCORDANCE WITH THE LATEST EDITIONS OF THE INTERNATIONAL BUILDING CODE (IBC) AND ALL APPLICABLE LOCAL ORDINANCES.
8. ALL WORK SHALL BE DONE IN ACCORDANCE WITH THE LATEST EDITIONS OF THE INTERNATIONAL BUILDING CODE (IBC) AND ALL APPLICABLE LOCAL ORDINANCES.
9. ALL WORK SHALL BE DONE IN ACCORDANCE WITH THE LATEST EDITIONS OF THE INTERNATIONAL BUILDING CODE (IBC) AND ALL APPLICABLE LOCAL ORDINANCES.
10. ALL WORK SHALL BE DONE IN ACCORDANCE WITH THE LATEST EDITIONS OF THE INTERNATIONAL BUILDING CODE (IBC) AND ALL APPLICABLE LOCAL ORDINANCES.
11. ALL WORK SHALL BE DONE IN ACCORDANCE WITH THE LATEST EDITIONS OF THE INTERNATIONAL BUILDING CODE (IBC) AND ALL APPLICABLE LOCAL ORDINANCES.
12. ALL WORK SHALL BE DONE IN ACCORDANCE WITH THE LATEST EDITIONS OF THE INTERNATIONAL BUILDING CODE (IBC) AND ALL APPLICABLE LOCAL ORDINANCES.
13. ALL WORK SHALL BE DONE IN ACCORDANCE WITH THE LATEST EDITIONS OF THE INTERNATIONAL BUILDING CODE (IBC) AND ALL APPLICABLE LOCAL ORDINANCES.
14. ALL WORK SHALL BE DONE IN ACCORDANCE WITH THE LATEST EDITIONS OF THE INTERNATIONAL BUILDING CODE (IBC) AND ALL APPLICABLE LOCAL ORDINANCES.
15. ALL WORK SHALL BE DONE IN ACCORDANCE WITH THE LATEST EDITIONS OF THE INTERNATIONAL BUILDING CODE (IBC) AND ALL APPLICABLE LOCAL ORDINANCES.

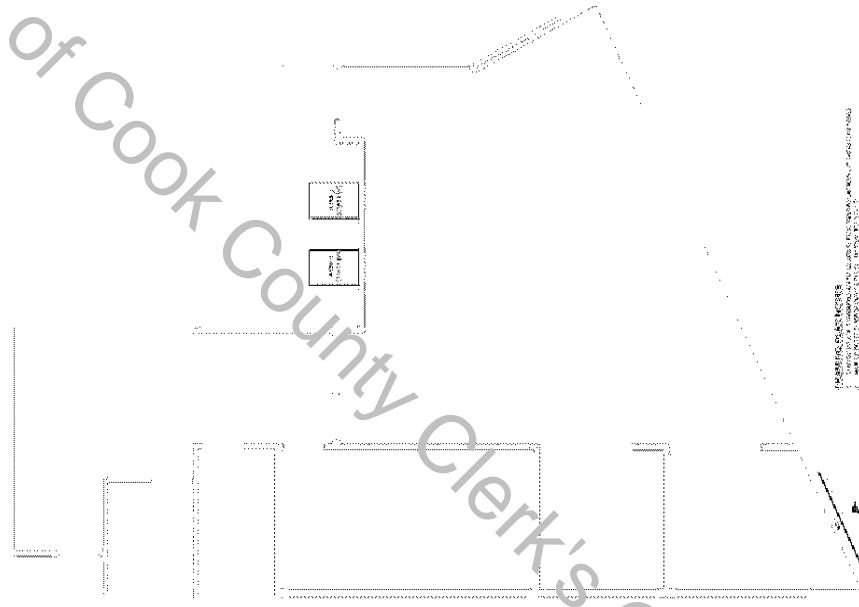

3/1 MLT

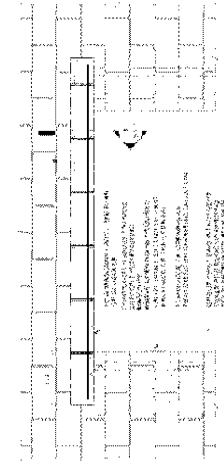

2/ NEW OPENING IN MASONRY WALL

FROM ARCHITECT'S RECORD DRAWINGS  
 THIS DRAWING IS A REVISION OF THE ARCHITECT'S RECORD DRAWINGS AND IS NOT TO BE USED FOR CONSTRUCTION UNLESS APPROVED BY THE ARCHITECT.

1 FIRST FLOOR FRAMING PLAN

Property of Cook County Clerk's Office

BANK OF AMERICA

4037 N LINCOLN AVE  
CHICAGO, IL

# UNOFFICIAL COPY



DATE: 04/14/2015  
TIME: 09:14:35

IA INTERIOR ARCHITECTS

CHARLOTTE  
819 S. COLLEGE BL. SUITE 725  
CHARLOTTE, NC 28202  
TEL: 704.358.1548

ARCHITECT  
DATE: 04/14/2015

PHOTOMETRIC  
LIGHTING PLAN

E-1.1

**SHEET NOTES**

1. ALL LIGHT FIXTURES SHALL BE INSTALLED IN ACCORDANCE WITH THE IESNA HANDBOOK AND THE IESNA LIGHTING HANDBOOK.
2. ALL LIGHT FIXTURES SHALL BE INSTALLED IN ACCORDANCE WITH THE IESNA HANDBOOK AND THE IESNA LIGHTING HANDBOOK.
3. ALL LIGHT FIXTURES SHALL BE INSTALLED IN ACCORDANCE WITH THE IESNA HANDBOOK AND THE IESNA LIGHTING HANDBOOK.
4. ALL LIGHT FIXTURES SHALL BE INSTALLED IN ACCORDANCE WITH THE IESNA HANDBOOK AND THE IESNA LIGHTING HANDBOOK.

**SHEET TYPES**

1. LIGHTING PLAN
2. LIGHTING PLAN
3. LIGHTING PLAN
4. LIGHTING PLAN

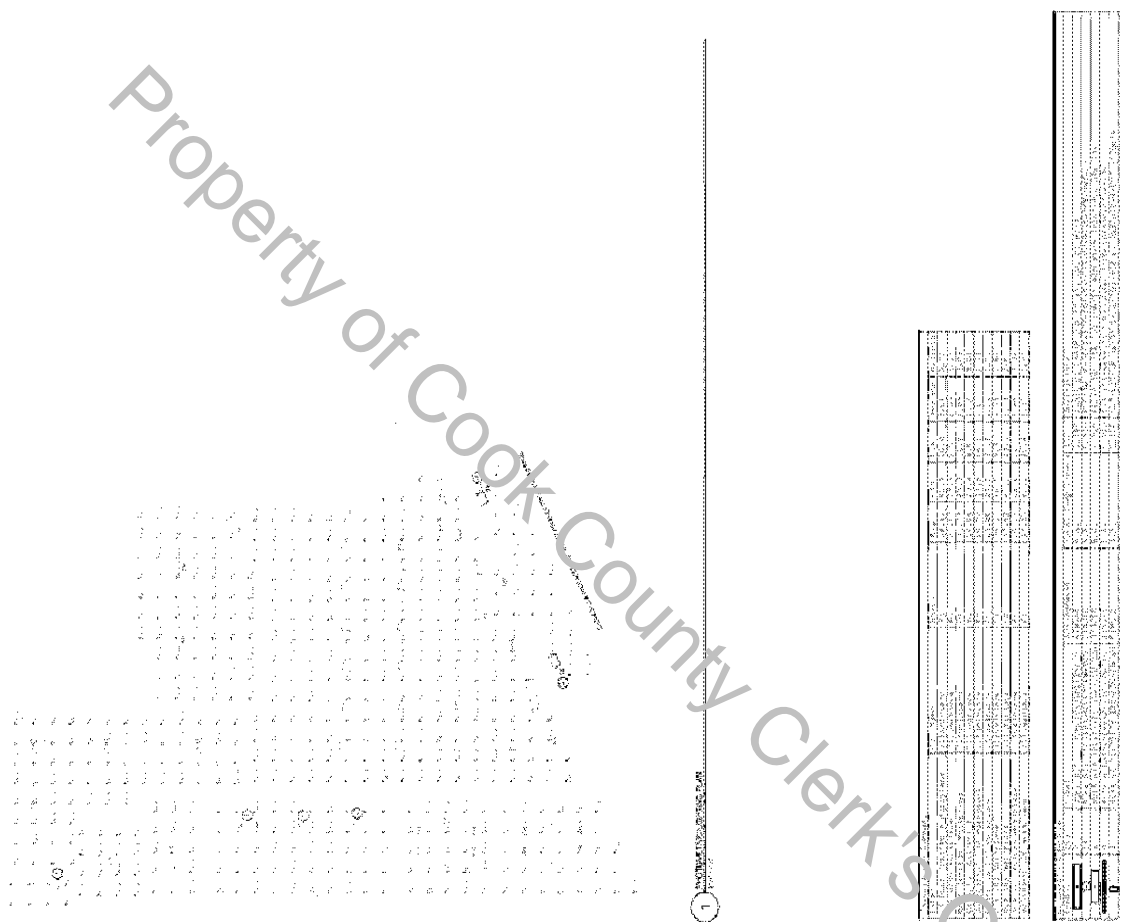

1 UNOFFICIAL PHOTOMETRIC PLAN

Fixture No.	Fixture Type	Footcandle	Footcandle	Footcandle	Footcandle	Footcandle	Footcandle	Footcandle	Footcandle
1	1	1	1	1	1	1	1	1	1
2	2	2	2	2	2	2	2	2	2
3	3	3	3	3	3	3	3	3	3
4	4	4	4	4	4	4	4	4	4
5	5	5	5	5	5	5	5	5	5
6	6	6	6	6	6	6	6	6	6
7	7	7	7	7	7	7	7	7	7
8	8	8	8	8	8	8	8	8	8
9	9	9	9	9	9	9	9	9	9
10	10	10	10	10	10	10	10	10	10
11	11	11	11	11	11	11	11	11	11
12	12	12	12	12	12	12	12	12	12
13	13	13	13	13	13	13	13	13	13
14	14	14	14	14	14	14	14	14	14
15	15	15	15	15	15	15	15	15	15
16	16	16	16	16	16	16	16	16	16
17	17	17	17	17	17	17	17	17	17
18	18	18	18	18	18	18	18	18	18
19	19	19	19	19	19	19	19	19	19
20	20	20	20	20	20	20	20	20	20
21	21	21	21	21	21	21	21	21	21
22	22	22	22	22	22	22	22	22	22
23	23	23	23	23	23	23	23	23	23
24	24	24	24	24	24	24	24	24	24
25	25	25	25	25	25	25	25	25	25
26	26	26	26	26	26	26	26	26	26
27	27	27	27	27	27	27	27	27	27
28	28	28	28	28	28	28	28	28	28
29	29	29	29	29	29	29	29	29	29
30	30	30	30	30	30	30	30	30	30
31	31	31	31	31	31	31	31	31	31
32	32	32	32	32	32	32	32	32	32
33	33	33	33	33	33	33	33	33	33
34	34	34	34	34	34	34	34	34	34
35	35	35	35	35	35	35	35	35	35
36	36	36	36	36	36	36	36	36	36
37	37	37	37	37	37	37	37	37	37
38	38	38	38	38	38	38	38	38	38
39	39	39	39	39	39	39	39	39	39
40	40	40	40	40	40	40	40	40	40
41	41	41	41	41	41	41	41	41	41
42	42	42	42	42	42	42	42	42	42
43	43	43	43	43	43	43	43	43	43
44	44	44	44	44	44	44	44	44	44
45	45	45	45	45	45	45	45	45	45
46	46	46	46	46	46	46	46	46	46
47	47	47	47	47	47	47	47	47	47
48	48	48	48	48	48	48	48	48	48
49	49	49	49	49	49	49	49	49	49
50	50	50	50	50	50	50	50	50	50
51	51	51	51	51	51	51	51	51	51
52	52	52	52	52	52	52	52	52	52
53	53	53	53	53	53	53	53	53	53
54	54	54	54	54	54	54	54	54	54
55	55	55	55	55	55	55	55	55	55
56	56	56	56	56	56	56	56	56	56
57	57	57	57	57	57	57	57	57	57
58	58	58	58	58	58	58	58	58	58
59	59	59	59	59	59	59	59	59	59
60	60	60	60	60	60	60	60	60	60
61	61	61	61	61	61	61	61	61	61
62	62	62	62	62	62	62	62	62	62
63	63	63	63	63	63	63	63	63	63
64	64	64	64	64	64	64	64	64	64
65	65	65	65	65	65	65	65	65	65
66	66	66	66	66	66	66	66	66	66
67	67	67	67	67	67	67	67	67	67
68	68	68	68	68	68	68	68	68	68
69	69	69	69	69	69	69	69	69	69
70	70	70	70	70	70	70	70	70	70
71	71	71	71	71	71	71	71	71	71
72	72	72	72	72	72	72	72	72	72
73	73	73	73	73	73	73	73	73	73
74	74	74	74	74	74	74	74	74	74
75	75	75	75	75	75	75	75	75	75
76	76	76	76	76	76	76	76	76	76
77	77	77	77	77	77	77	77	77	77
78	78	78	78	78	78	78	78	78	78
79	79	79	79	79	79	79	79	79	79
80	80	80	80	80	80	80	80	80	80
81	81	81	81	81	81	81	81	81	81
82	82	82	82	82	82	82	82	82	82
83	83	83	83	83	83	83	83	83	83
84	84	84	84	84	84	84	84	84	84
85	85	85	85	85	85	85	85	85	85
86	86	86	86	86	86	86	86	86	86
87	87	87	87	87	87	87	87	87	87
88	88	88	88	88	88	88	88	88	88
89	89	89	89	89	89	89	89	89	89
90	90	90	90	90	90	90	90	90	90
91	91	91	91	91	91	91	91	91	91
92	92	92	92	92	92	92	92	92	92
93	93	93	93	93	93	93	93	93	93
94	94	94	94	94	94	94	94	94	94
95	95	95	95	95	95	95	95	95	95
96	96	96	96	96	96	96	96	96	96
97	97	97	97	97	97	97	97	97	97
98	98	98	98	98	98	98	98	98	98
99	99	99	99	99	99	99	99	99	99
100	100	100	100	100	100	100	100	100	100



# Cree Edge™ Series TYPE SE UNOFFICIAL COPY

## LED Security Wall Pack Luminaire

### Product Description

The Cree Edge™ wall mount luminaire has a slim, low profile design. The luminaire end caps are made from rugged die cast aluminum with integral, weathertight LED driver compartments and high performance aluminum heat sinks specifically designed for LED applications. Housing is rugged aluminum. Includes a lightweight mounting box for installation over standard and mud ring single gang J-Boxes. Secures to wall with four 3/16" (5mm) screws (by others). Conduit entry from top, bottom, sides and rear. Allows mounting for uplight or downlight. Designed and approved for easy through-wiring. Includes leaf/debris guard.

**Applications:** General area and security lighting

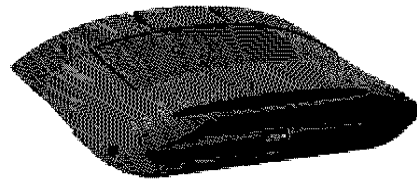

### Performance Summary

Patented NanoOptic® Product Technology

Made in the U.S.A. of U.S. and imported parts

**CRI:** Minimum 70 CRI

**CCT:** 4000K (+/- 300K), 5700K (+/- 500K) standard

**Limited Warranty:** 10 years on luminaire/10 years on Colorfast DeltaGuard® finish

1 See <http://lighting.cree.com/warranty> for warranty terms

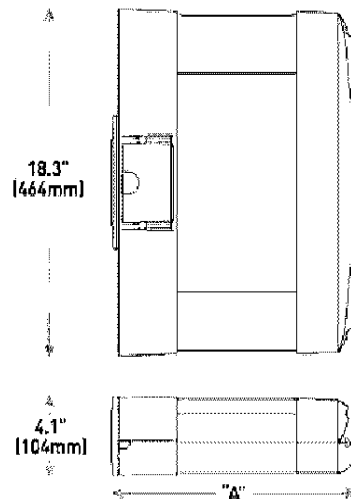

### Accessories

Field-Installed	
<b>Bird Spikes</b> XA-BRDSPK	<b>Hand-Held Remote</b> XA-SENSREM - For successful implementation of the programmable multi-level option, a minimum of one hand-held remote is required

LED Count (x10)	Dim. "A"	Weight
02	9.9" (251mm)	20 lbs. (9.1kg)
04	11.9" (303mm)	22 lbs. (10.0kg)
06	13.9" (353mm)	25 lbs. (11.3kg)
08	15.9" (404mm)	27 lbs. (12.2kg)
10	17.9" (455mm)	31 lbs. (14.1kg)
12	19.9" (505mm)	32 lbs. (14.5kg)

CONTRACTOR TO VERIFY AND SPECIFY IF NOT UL

CONTRACTOR TO REFERENCE PLANS FOR COLOR DESIGNATION

### Ordering Information

Example: SEC-EDG-2M-WM-06-E-UL-SV-700

SEC-EDG	3M	WM	02	E	UL	XX	350	40K
Product	Optic	Mounting	LED Count (x10)	Series	Voltage	Color Options	Drive Current	Options
SEC-EDG	<b>2M</b> Type II Medium <b>2MB</b> Type II Medium w/BLS <b>2S</b> Type II Short <b>2SB</b> Type II Short w/BLS <b>3M</b> Type III Medium <b>3MB</b> Type III Medium w/BLS <b>4M</b> Type IV Medium <b>4MB</b> Type IV Medium w/BLS	WM Wall Mount	<b>02</b> <b>04</b> <b>06</b> <b>08</b> <b>10</b> <b>12</b>	E	<b>UL</b> Universal 120-277V <b>UH</b> Universal 347-480V <b>3L</b> 347V	<b>BK</b> Black <b>BZ</b> Bronze <b>SV</b> Silver <b>WH</b> White	<b>350</b> 350mA <b>525</b> 525mA -Available with 20-80 LEDs <b>700</b> 700mA -Available with 20-60 LEDs	<b>DIM 0-10V Dimming</b> - Control by others - Refer to Dimming spec sheet for details - Can't exceed specified drive current <b>F Fuse</b> - Refer to ML spec sheet for availability with ML options - Available with UL voltage only - When code dictates fusing, use time delay fuse <b>ML Multi-Level</b> - Refer to ML spec sheet for details - Intended for downlight applications of 0° tilt <b>P Photocell</b> - Refer to ML spec sheet for availability with ML options - Must specify UL or 34 voltage <b>PML Programmable Multi-Level</b> - Refer to PML spec sheet for details - Intended for downlight applications of 0° tilt <b>40K 4000K Color Temperature</b> - Minimum 70 CRI - Color temperature per luminaire



# UNOFFICIAL COPY

## Cree Edge™ LED Security Wall Pack Luminaire

### Product Specifications

#### CONSTRUCTION & MATERIALS

- Slim, low profile design
- Luminaire sides are rugged die cast aluminum with integral, weathertight LED driver compartment and high performance aluminum heat sinks specifically designed for LED applications
- Housing is rugged aluminum
- Furnished with low copper, light weight mounting box designed for installation over standard and mud ring single gang J-Boxes
- Luminaire can also be direct mounted to a wall and surface wired
- Secures to wall with four 3/16" (5mm) screws (by others)
- Conduit entry from top, bottom, sides, and rear
- Allows mounting for uplight or downlight
- Designed and approved for easy through-wiring
- Includes leaf/debris guard
- Exclusive Colorfast DeltaGuard® finish features an E-Coat epoxy primer with an ultradurable powder topcoat providing excellent resistance to corrosion, ultraviolet degradation and abrasion. Black, bronze, silver and white are available
- **Weight:** See Dimensions and Weight Chart on page 1

#### ELECTRICAL SYSTEM

- **Input Voltage:** 120-277V or 347-480V, 50/60Hz, Class 1 drivers
- **Power Factor:** > 0.9 at full load
- **Total Harmonic Distortion:** < 20% at full load
- Integral weathertight J-Box with leads (wire nuts) for easy power hook up
- Integral 10kV surge suppression protection standard
- To address inrush current, slow blow fuse or type C/D breaker should be used
- **Maximum 10V Source Current:** 20 LED (350mA): 10mA; 20LED (525 & 700 mA) and 40-120 LED: 0.15mA

#### REGULATORY & VOLUNTARY QUALIFICATIONS

- cULus Listed
- Suitable for wet locations
- Meets FCC Part 15 standards for conducted and radiated emissions
- Enclosure rated IP66 per IEC 60529 when ordered without P, PML or ML options
- 10kV surge suppression protection tested in accordance with IEEE/ANSI C62.41.2
- Luminaire and finish endurance tested to withstand 5,000 hours of elevated ambient salt fog conditions as defined in ASTM Standard B 117
- DLC qualified. Exceptions apply when ordered with full backlight control. Please refer to [www.designlights.org/QPL](http://www.designlights.org/QPL) for most current information
- Dark Sky Friendly, IDA Approved. Please refer to [www.darksky.org/](http://www.darksky.org/) for most current information
- Meets Buy American requirements within ARRA

#### Electrical Data\*

LED Count (x10)	System Watts 120-480V	Total Current					
		120V	208V	240V	277V	347V	480V
<b>350mA</b>							
02	25	0.21	0.13	0.11	0.10	0.08	0.07
04	46	0.36	0.23	0.21	0.20	0.15	0.12
06	66	0.52	0.31	0.28	0.26	0.20	0.15
08	90	0.75	0.44	0.38	0.34	0.26	0.20
10	110	0.92	0.53	0.47	0.41	0.32	0.24
12	130	1.10	0.63	0.55	0.48	0.38	0.28
<b>525mA</b>							
02	37	0.30	0.19	0.17	0.15	0.12	0.10
04	70	0.58	0.34	0.31	0.28	0.21	0.16
06	101	0.84	0.49	0.43	0.38	0.30	0.22
08	133	1.13	0.66	0.58	0.51	0.39	0.28
<b>700mA</b>							
02	50	0.41	0.25	0.22	0.20	0.15	0.12
04	93	0.78	0.46	0.40	0.36	0.27	0.20
06	134	1.14	0.68	0.57	0.50	0.39	0.29

\* Electrical data at 25°C (77°F)

#### Recommended Cree Edge™ Series Lumen Maintenance Factors [LMF]<sup>1</sup>

Ambient	Initial LMF	25K hr Projected LMF	50K hr Projected <sup>2</sup> LMF	75K hr Calculated <sup>3</sup> LMF	100K hr Calculated <sup>2</sup> LMF
5°C (41°F)	1.04	0.99	0.97	0.95	0.93
10°C (50°F)	1.03	0.98	0.95	0.94	0.92
15°C (59°F)	1.02	0.97	0.95	0.93	0.91
20°C (68°F)	1.01	0.96	0.94	0.92	0.90
25°C (77°F)	1.00	0.95	0.93	0.91	0.89

<sup>1</sup>Lumen maintenance values at 25°C are calculated per TM-21 based on LM-80 data and in-situ luminaire testing

<sup>2</sup>In accordance with IESNA TM-21-11, Projected Values represent interpolated value based on time durations that are within six times (6X) the IESNA LM-80-08 total test duration (in hours) for the device under testing (DUT) i.e. the packaged LED chip.

<sup>3</sup>In accordance with IESNA TM-21-11, Calculated Values represent time durations that exceed six times (6X) the IESNA LM-80-08 total test duration (in hours) for the device under testing (DUT) i.e. the packaged LED chip.

# UNOFFICIAL COPY

## Cree Edge™ LED Security Wall Pack Luminaire

### Photometry

All published luminaire photometric testing performed to IESNA LM-79-08 standards by a NVLAP accredited laboratory. To obtain an IES file specific to your project consult: <http://lighting.cree.com/products/outdoor/wall-mount/cree-edge-series-5>

#### 3M

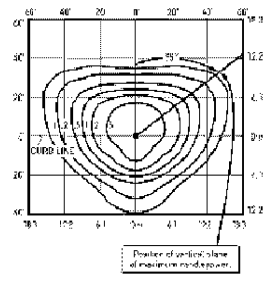
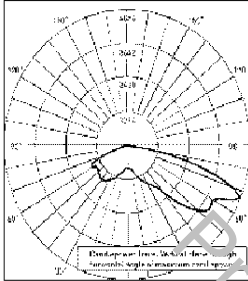

TTL Test Report #: 79173  
SEC-EDG-3M-\*\*-06-E-UL-525-40K  
Initial Delivered Lumens: 10,363

SEC-EDG-3M-\*\*-06-E-UL-525-40K  
Mounting Height: 10' (3.0m) A.F.B.  
Initial Delivered Lumens: 11,220  
Initial FC at grade

Type III Medium Distribution				
LED Count (x10)	4000K		5700K	
	Initial Delivered Lumens*	BUG Ratings** Per TM-15-11	Initial Delivered Lumens*	BUG Ratings** Per TM-15-11
<b>350mA</b>				
02	2,027	B1 U0 G1	2,105	B1 U0 G1
04	4,054	B1 U0 G1	4,209	B1 U0 G1
06	6,011	B2 U0 G2	6,262	B2 U0 G2
08	8,015	B2 U0 G2	8,323	B2 U0 G2
10	9,994	B3 U0 G3	10,379	B3 U0 G3
12	11,993	B3 U0 G3	12,454	B3 U0 G3
<b>525mA</b>				
02	2,837	B1 U0 G1	2,947	B1 U0 G1
04	5,675	B2 U0 G2	5,893	B2 U0 G2
06	8,415	B2 U0 G2	8,739	B2 U0 G2
08	11,220	B3 U0 G3	11,652	B3 U0 G3
<b>700mA</b>				
02	3,465	B1 U0 G1	3,609	B1 U0 G1
04	6,932	B2 U0 G2	7,198	B2 U0 G2
06	10,279	B3 U0 G3	10,674	B3 U0 G3

\* Initial delivered lumens at 25°C (77°F)  
\*\* For more information on the IES BUG (Backlight-Usight-Glare) Rating visit [www.ies.org/PDF/Files/TM-15-11BugRatingsAddendum.pdf](http://www.ies.org/PDF/Files/TM-15-11BugRatingsAddendum.pdf)

#### 3MB

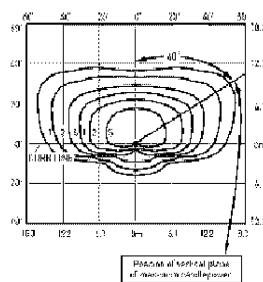
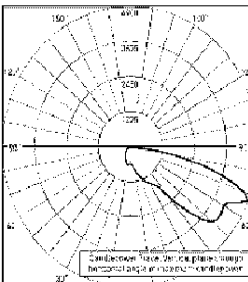

CSA Test Report #: 6648  
ARE-EDG-3MB-\*\*-06-E-UL-700  
Initial Delivered Lumens: 7,740

SEC-EDG-3MB-\*\*-08-E-UL-525-40K  
Mounting Height: 10' (3.0m) A.F.B.  
Initial Delivered Lumens: 8,300  
Initial FC at grade

Type III Medium Distribution w/BLS				
LED Count (x10)	4000K		5700K	
	Initial Delivered Lumens*	BUG Ratings** Per TM-15-11	Initial Delivered Lumens*	BUG Ratings** Per TM-15-11
<b>350mA</b>				
02	1,499	B1 U0 G1	1,557	B1 U0 G1
04	2,997	B1 U0 G1	3,114	B1 U0 G1
06	4,446	B1 U0 G1	4,611	B1 U0 G1
08	5,929	B1 U0 G2	6,157	B1 U0 G2
10	7,393	B1 U0 G2	7,677	B1 U0 G2
12	8,872	B1 U0 G2	9,213	B1 U0 G2
<b>525mA</b>				
02	2,099	B1 U0 G1	2,180	B1 U0 G1
04	4,198	B1 U0 G1	4,359	B1 U0 G1
06	6,225	B1 U0 G2	6,464	B1 U0 G2
08	8,300	B1 U0 G2	8,619	B1 U0 G2
<b>700mA</b>				
02	2,564	B1 U0 G1	2,662	B1 U0 G1
04	5,127	B1 U0 G2	5,325	B1 U0 G2
06	7,603	B1 U0 G2	7,896	B1 U0 G2

\* Initial delivered lumens at 25°C (77°F)  
\*\* For more information on the IES BUG (Backlight-Usight-Glare) Rating visit [www.ies.org/PDF/Files/TM-15-11BugRatingsAddendum.pdf](http://www.ies.org/PDF/Files/TM-15-11BugRatingsAddendum.pdf)

