

UNOFFICIAL COPY

Doc#: 2203239121 Fee: \$65.00
Karen A. Yarbrough
Cook County Clerk
Date: 02/01/2022 09:22 AM Pg: 1 of 14

Recording Requested by and
Document Prepared By:
Century City Baths, LLC
211 West Wacker Drive, Suite 1719
Chicago, Illinois 60606

Please Return To:
Century City Baths, LLC:
c/o Mail Center
9450 SW Gemini Dr #7790
Beaverton, Oregon 97008-7105
Reference ID: 6544879

SPACE ABOVE FOR RECORDER'S USE

ORIGINAL CONTRACTOR'S CLAIM OF LIEN

In the Office of the Recorder of Deeds County of: Cook County, State of: Illinois

Claimant:

Century City Baths, LLC
211 West Wacker Drive, Suite 1719
Chicago, Illinois 60606

Services: Services, labor, materials, equipment, and/or work provided by the Claimant:

- Custom concrete shower base - Plumbing install - Tile install - Fixture install

Property Owner:

Randy and Candy Gerber
138 Lockerbie Lane
Wilmette, Illinois 60091
Randy and Candy Gerber
4159 Picardy Drive
Northbrook, Illinois 60062
Paramjit Cheena Paul, Randy Scott Gerber, and Candy Paul
4159 Picardy Dr
Northbrook, Illinois 60062

Amount of Claim: \$3,400.00

Total Amount of Contract: 6,500.00

Contract Type: Written

Date of Contract: October 26, 2021

Date Last Furnish of Services: November 29, 2021

PIN: 04-06-308-058-0000

IMPORTANT INFORMATION ON THE FOLLOWING PAGE

UNOFFICIAL COPY

Property: Services were furnished in the improvement and/or construction of real property described as follows:
4159 Picardy Drive
Northbrook, Illinois 60062
County: Cook County
State of: Illinois

Legally Described As: The Southwesterly 45.00 feet of Lot 13 in Picardy Circle P.U.D. being a Subdivision in the Southwest 1/4 of Section 6, Township 42 North, Range 12, East of the Third Principal Meridian, in Cook County, Illinois. Permanent Index Number: 04-06-308-058-0000

THE UNDERSIGNED LIEN CLAIMANT, above-identified as the **Claimant**, hereby files a claim for a **Mechanic's Lien** against the above-identified **Property Owner**, and all other parties having or claiming an interest in the real estate above-identified as the **Property**.

The **Claimant** contacted with the **Property Owner** by entering into the contract above-identified and described as the **Contract**. The contract was such that the **Claimant** would provide the above-described **Services** to the **Property** for the total cost of the contract, above-identified.

The **Claimant** states that it did so provide the above-described **Services**. The **Claimant** last furnished labor and/or materials to the **Property** on the date above-indicated.

After giving the **Property Owner** all just credits, offsets and payments, the balance unpaid, due and owing to the **Claimant** is above-identified as the **Amount of Claim** (\$3,400.00); for which, with interest, the **Claimant** claims liens on the **Property** and improvements.

State of Louisiana County of Orleans Signed on: January 21, 2022

On the date indicated below, Claire Canulette, authorized and disclosed agent for Century City Baths, LLC, personally came and appeared before me, and voluntarily executed this instrument in the agent's stated capacity. The deponent says that s/he has read the foregoing Claim of Lien and knows the contents thereof, that as the appointed agent for the Claimant the deponent has been provided the information indicated in this notice, and that the same is true upon the deponent's information, knowledge and belief.

Signed on: January 21, 2022
Signature: Claire Canulette
Signed by Authorized Agent: Claire Canulette

Alexander L. Benarroche
Notary Public
Signed on: January 21, 2022

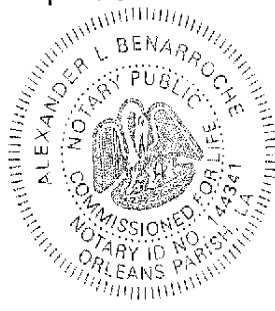

PROPERTY OF COOK COUNTY CLERK'S OFFICE

UNOFFICIAL COPY



211 W Wacker Dr Ste 1719
Chicago, IL 60606
Phone: (312) 869-2562
www.centurycitybaths.com

EXHIBIT A

Buyer Candy Creber / Paul
Address 4169 Picardy Drive
Home # 347 602 3794
Alternate Phone # _____
Email Address _____

- Residential Home Apartment Building
- Permit by Buyer Buyer's Initials: CC
- Permit by Century City Buyer's Initials: _____

Notes: Measurements are taken from the interior of the bathroom and are approximate for pricing purposes.

<p>Specifications</p> <p><input type="checkbox"/> Tub <input checked="" type="checkbox"/> Shower <input type="checkbox"/> 2 wet spaces</p> <p>Drain location: <input type="checkbox"/> left <input checked="" type="checkbox"/> right <input type="checkbox"/> center</p> <p>Tub/Shower Width: <u>24</u> Length: <u>48</u></p> <p>Tile Square Footage: _____</p> <p>Demo Wet Space to Studs <input checked="" type="checkbox"/></p> <p>Additional Options</p> <p>Number of Grab Bars: <u>HOP</u></p> <p>Grab Bar Color: _____</p> <p>Number of Corner Shelves _____</p> <p><input type="checkbox"/> Recessed Shelf</p> <p>- Dimensions: _____</p> <p><input type="checkbox"/> Accent Tile</p> <p>- Dimensions: _____</p> <p>- Color: _____</p> <p><input type="checkbox"/> Moen Post-Temp Valve</p> <p>- Trim Style: _____</p> <p>- Color: _____</p> <p><input checked="" type="checkbox"/> Shower Door</p> <p>- Style: _____</p> <p>- Color: _____</p>	<p>Tub/Shower Material Selection</p> <p>Tub/Shower Base Material: <input type="checkbox"/> Cultured Stone <input type="checkbox"/> Acrylic <input type="checkbox"/> Porcelain-Over-Steel <input type="checkbox"/> Fiberglass</p> <p>Freestanding Tub <input type="checkbox"/> Tiled Shower Floor <input checked="" type="checkbox"/></p> <p>Showerhead Style: <u>HOP</u> F/S Tub Filler Style: _____</p> <p>Showerhead Color: _____ F/S Tub Filler Color: _____</p> <p>Tile Color <u>HOP</u></p> <table border="0"> <tr> <td><input type="checkbox"/> San Blanco Ecoterra 12 x 24</td> <td><input type="checkbox"/> Venetian Stone</td> <td><input type="checkbox"/> Legra</td> </tr> <tr> <td><input type="checkbox"/> Homeward Grey</td> <td><input type="checkbox"/> Papyrus</td> <td><input type="checkbox"/> Prowise</td> </tr> <tr> <td><input type="checkbox"/> Bianco Simplicio</td> <td><input type="checkbox"/> Staggered Clouds</td> <td><input type="checkbox"/> Gioiello</td> </tr> <tr> <td><input type="checkbox"/> San White Ecoterra 24 x 24</td> <td><input type="checkbox"/> London Abbey</td> <td><input type="checkbox"/> Toscana</td> </tr> <tr> <td><input type="checkbox"/> Grey Honeycomb</td> <td><input type="checkbox"/> Tuscan Hill</td> <td><input type="checkbox"/> Arcano Calcic</td> </tr> <tr> <td><input type="checkbox"/> Sandstorm</td> <td><input type="checkbox"/> Canyon Black</td> <td><input type="checkbox"/> Selvaggio</td> </tr> <tr> <td><input type="checkbox"/> Tavern Stone</td> <td><input type="checkbox"/> Vivaldi</td> <td><input type="checkbox"/> Zebra</td> </tr> <tr> <td><input type="checkbox"/> Colosseum Black</td> <td><input type="checkbox"/> Ocean White</td> <td><input type="checkbox"/> Fumo Scuro</td> </tr> <tr> <td><input type="checkbox"/> Nero Assoluto</td> <td><input type="checkbox"/> Marrone</td> <td><input type="checkbox"/> Bluastro</td> </tr> <tr> <td><input type="checkbox"/> Inspired Smoke</td> <td><input type="checkbox"/> Sabbia Della Vita</td> <td><input type="checkbox"/> Calcara</td> </tr> <tr> <td></td> <td></td> <td><input type="checkbox"/> Black Granite</td> </tr> </table>	<input type="checkbox"/> San Blanco Ecoterra 12 x 24	<input type="checkbox"/> Venetian Stone	<input type="checkbox"/> Legra	<input type="checkbox"/> Homeward Grey	<input type="checkbox"/> Papyrus	<input type="checkbox"/> Prowise	<input type="checkbox"/> Bianco Simplicio	<input type="checkbox"/> Staggered Clouds	<input type="checkbox"/> Gioiello	<input type="checkbox"/> San White Ecoterra 24 x 24	<input type="checkbox"/> London Abbey	<input type="checkbox"/> Toscana	<input type="checkbox"/> Grey Honeycomb	<input type="checkbox"/> Tuscan Hill	<input type="checkbox"/> Arcano Calcic	<input type="checkbox"/> Sandstorm	<input type="checkbox"/> Canyon Black	<input type="checkbox"/> Selvaggio	<input type="checkbox"/> Tavern Stone	<input type="checkbox"/> Vivaldi	<input type="checkbox"/> Zebra	<input type="checkbox"/> Colosseum Black	<input type="checkbox"/> Ocean White	<input type="checkbox"/> Fumo Scuro	<input type="checkbox"/> Nero Assoluto	<input type="checkbox"/> Marrone	<input type="checkbox"/> Bluastro	<input type="checkbox"/> Inspired Smoke	<input type="checkbox"/> Sabbia Della Vita	<input type="checkbox"/> Calcara			<input type="checkbox"/> Black Granite
<input type="checkbox"/> San Blanco Ecoterra 12 x 24	<input type="checkbox"/> Venetian Stone	<input type="checkbox"/> Legra																																
<input type="checkbox"/> Homeward Grey	<input type="checkbox"/> Papyrus	<input type="checkbox"/> Prowise																																
<input type="checkbox"/> Bianco Simplicio	<input type="checkbox"/> Staggered Clouds	<input type="checkbox"/> Gioiello																																
<input type="checkbox"/> San White Ecoterra 24 x 24	<input type="checkbox"/> London Abbey	<input type="checkbox"/> Toscana																																
<input type="checkbox"/> Grey Honeycomb	<input type="checkbox"/> Tuscan Hill	<input type="checkbox"/> Arcano Calcic																																
<input type="checkbox"/> Sandstorm	<input type="checkbox"/> Canyon Black	<input type="checkbox"/> Selvaggio																																
<input type="checkbox"/> Tavern Stone	<input type="checkbox"/> Vivaldi	<input type="checkbox"/> Zebra																																
<input type="checkbox"/> Colosseum Black	<input type="checkbox"/> Ocean White	<input type="checkbox"/> Fumo Scuro																																
<input type="checkbox"/> Nero Assoluto	<input type="checkbox"/> Marrone	<input type="checkbox"/> Bluastro																																
<input type="checkbox"/> Inspired Smoke	<input type="checkbox"/> Sabbia Della Vita	<input type="checkbox"/> Calcara																																
		<input type="checkbox"/> Black Granite																																

<p>Specifications</p> <p>Length of vanity: _____ <input type="checkbox"/> Single-Sink <input type="checkbox"/> Double-Sink</p> <p><input type="checkbox"/> Remove and dispose of existing vanity</p> <p>Additional Options</p> <p>Faucet Style: _____ Faucet Color: _____</p> <p><input type="checkbox"/> Mirror</p> <p>- Style: _____ Mirror Color: _____</p> <p><input type="checkbox"/> Light Fixtures:</p> <p>- Style: _____ Light Fixture Color: _____</p> <p><input type="checkbox"/> Medicine Cabinet:</p> <p>- Style: _____ Color: _____</p>	<p>Cabinets & Countertops</p> <p>Cabinet Color (Write-In): _____</p> <p><input type="checkbox"/> Anzi Alexander <input type="checkbox"/> Vanity Art Espresso</p> <p><input type="checkbox"/> Water Creation MIA <input type="checkbox"/> Pegasus Austen</p> <p><input type="checkbox"/> Water Creation Madison <input type="checkbox"/> Glacier Bay Candleby</p> <p><input type="checkbox"/> Water Creation Derby <input type="checkbox"/> Home Decorators Westcourt</p> <p><input type="checkbox"/> Home Decorators Newport <input type="checkbox"/> Leary</p> <p><input type="checkbox"/> OVE Ellex <input type="checkbox"/> Virgin Art Revenna</p> <p><input type="checkbox"/> Home Decorators Aberdeen <input type="checkbox"/> Wyndham Dana</p> <p><input type="checkbox"/> Home-Owner Provided</p>
--	---

<p>Specifications</p> <p><input type="checkbox"/> Flooring <input type="checkbox"/> Paint</p> <p>- Sq Footage: _____ - Paint Sq Footage: _____</p> <p>Additional Options</p> <p><input type="checkbox"/> Layover Existing Flooring <input type="checkbox"/> Window</p> <p><input type="checkbox"/> Demo Existing Flooring</p> <p>- Dimensions: _____</p> <p>- Style: _____</p> <p>- Color: _____</p> <p>- Glass: _____</p> <p><input type="checkbox"/> Toilet</p> <p>- Style: _____</p>	<p>Flooring Style and Color</p> <p><input type="checkbox"/> Non-LVP (Write-In): _____</p> <p><input type="checkbox"/> White Oak <input type="checkbox"/> Ash Grey</p> <p><input type="checkbox"/> Coffee Oak <input type="checkbox"/> Contemporary Black</p> <p><input type="checkbox"/> Lombardy Greige <input type="checkbox"/> Mahogany</p> <p><input type="checkbox"/> Roman Greige <input type="checkbox"/> Wine Barrel</p> <p><input type="checkbox"/> Cabin wood <input type="checkbox"/> Home</p> <p><input type="checkbox"/> Aged Oak <input type="checkbox"/> Life</p> <p><input type="checkbox"/> Maple <input type="checkbox"/> Inland</p> <p><input type="checkbox"/> Winter Wood <input type="checkbox"/> Pyramid</p> <p><input type="checkbox"/> Espresso <input type="checkbox"/> Carrara</p> <p><input type="checkbox"/> Cleio Grip</p>
---	---

Notes and Special Requests:

Space is already been demo'd. We are installing HOP materials in shower space. Insulate walls in stall. Hydrox board, recast, waterproofing & grout and seal system. Rekeying of locks.

I Understand That No Verbal Agreements Will Be Recognized Buyer's Initials: CC

Install Start Date: <u>11/15/21</u>	Measuring Date: _____
Total Project Price: <u>6,200</u>	Payment Method: <u>check</u> Received By: <u>PJS</u>
Buyer Provided Down Payment: <u>3,100</u>	Amount Financed: _____
Initial Bank Draw: _____	Final Bank Draw: _____
Buyer Provided Final Payment: <u>2,100</u>	Payment Method: <u>check</u> Received By: _____

It is agreed and understood by and between the parties that this agreement, front and back, constitute the entire understanding between the parties, and there are no verbal agreements changing or modifying any of the terms of the agreement. The Buyer has read the front and reverse of this agreement and has received a completed, signed and dated copy of this agreement on the date first written below.

Buyer Signature & Acknowledgement: [Signature] CANDY APPL Date: 10/26/21

Buyer Signature & Acknowledgement: _____ Date: _____

Sales Rep Signature & Acknowledgement: [Signature] P.J. Strabel Date: 10/26/21

I hereby certify that I am not a party to this transaction at any time prior to midnight of the third business day after the date of this transaction. Buyer's Initials: _____

UNOFFICIAL COPY

Consumer Rights Acknowledgement Form

CONTRACTOR: Keep This Part Only

I, the contractor, have given the homeowner a copy of the pamphlet titled "Home Repair: Know Your Consumer Rights."

Property of Cook County Clerk's Office

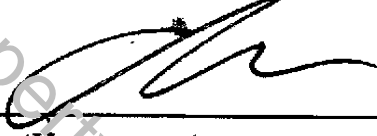
Signature (Homeowner)	Date
	10/26/21
Signature (Contractor or Representative)	Date
Century City Belts	
Name of Contractor's Business	
311 Wacker Drive	
Address of Contractor's Business	

UNOFFICIAL COPY

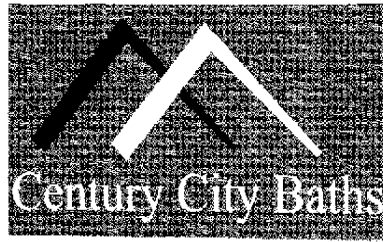

Notice of Cancellation

Date: 10/26/21

YOU MAY CANCEL THIS TRANSACTION, WITHOUT ANY PENALTY OR OBLIGATION, WITHIN 3 BUSINESS DAYS FROM THE DATE.

IF YOU CANCEL, ANY PROPERTY TRADED IN, ANY PAYMENTS MADE BY YOU, AND ANY NEGOTIABLE INSTRUMENT EXECUTED BY YOU UNDER THE CONTRACT OR TRANSACTION WILL BE RETURNED WITHIN 10 BUSINESS DAYS FOLLOWING RECEIPT BY THE SELLER OF YOUR CANCELLATION NOTICE, AND ANY SECURITY INTEREST ARISING OUT OF THE TRANSACTION WILL BE CANCELLED.

IF YOU CANCEL, YOU MAKE MUST AVAILABLE TO THE SELLER AT YOUR RESIDENCE IN SUBSTANTIALLY AS GOOD AS CONDITION AS WHEN RECEIVED, ANY GOODS DELIVERED TO YOU UNDER THE CONTRACT OR TRANSACTION, OR YOU MAY IF YOU WISH, COMPLY WITH THE INSTRUCTIONS OF THE SELLER REGARDING THE RETURN SHIPMENT OF THE GOODS AT THE SELLER'S EXPENSE AND RISK.

IF YOU MAKE THE GOODS AVAILABLE TO THE SELLER, OR IF YOU AGREE TO RETURN THE GOODS TO THE SELLER AND FAIL TO DO SO, THEN YOU REMAIN LIABLE FOR PERFORMANCE OF ALL OBLIGATIONS UNDER THE CONTRACT

TO CANCEL THE TRANSACTION, MAIL OR DELIVER A SIGNED AND DATED COPY OF THIS CANCELLATION NOTICE OR ANY OTHER WRITTEN NOTICE, OR SEND A TELEGRAM, TO CENTURY CITY BATHS, AT 211 W. WACKER DRIVE SUITE 1719, CHICAGO, IL 60606 NO LATER THAN MIDNIGHT OF 10/29/21

I HEREBY CANCEL THIS TRANSACTION

Buyer's Signature _____

10/26/21
Date

211 W. Wacker Dr. Ste 1719, Chicago, IL 60606 - (312) 869-2562 - www.centurycitybaths.com

UNOFFICIAL COPY



UNOFFICIAL COPY

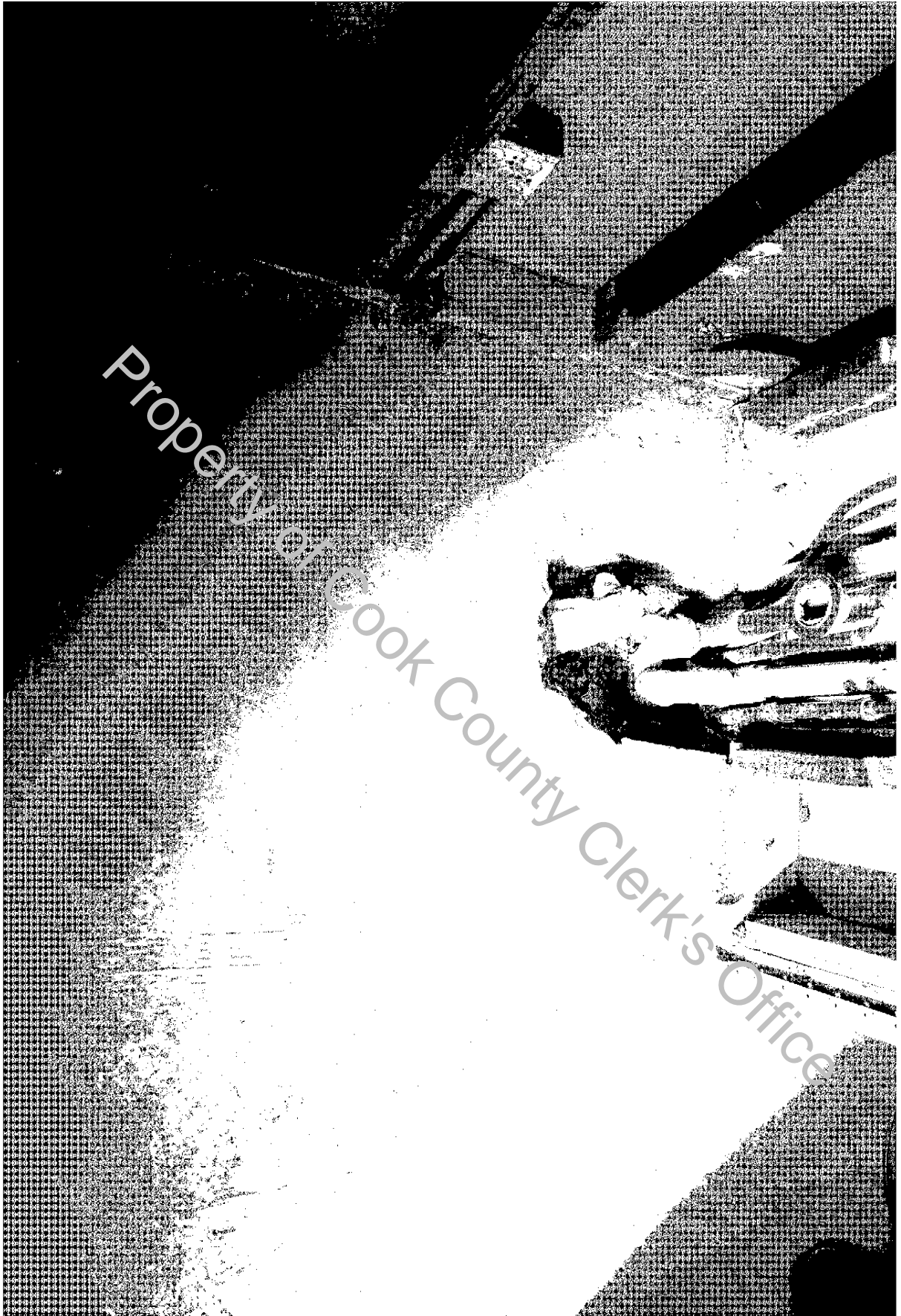

UNOFFICIAL COPY



UNOFFICIAL COPY



UNOFFICIAL COPY

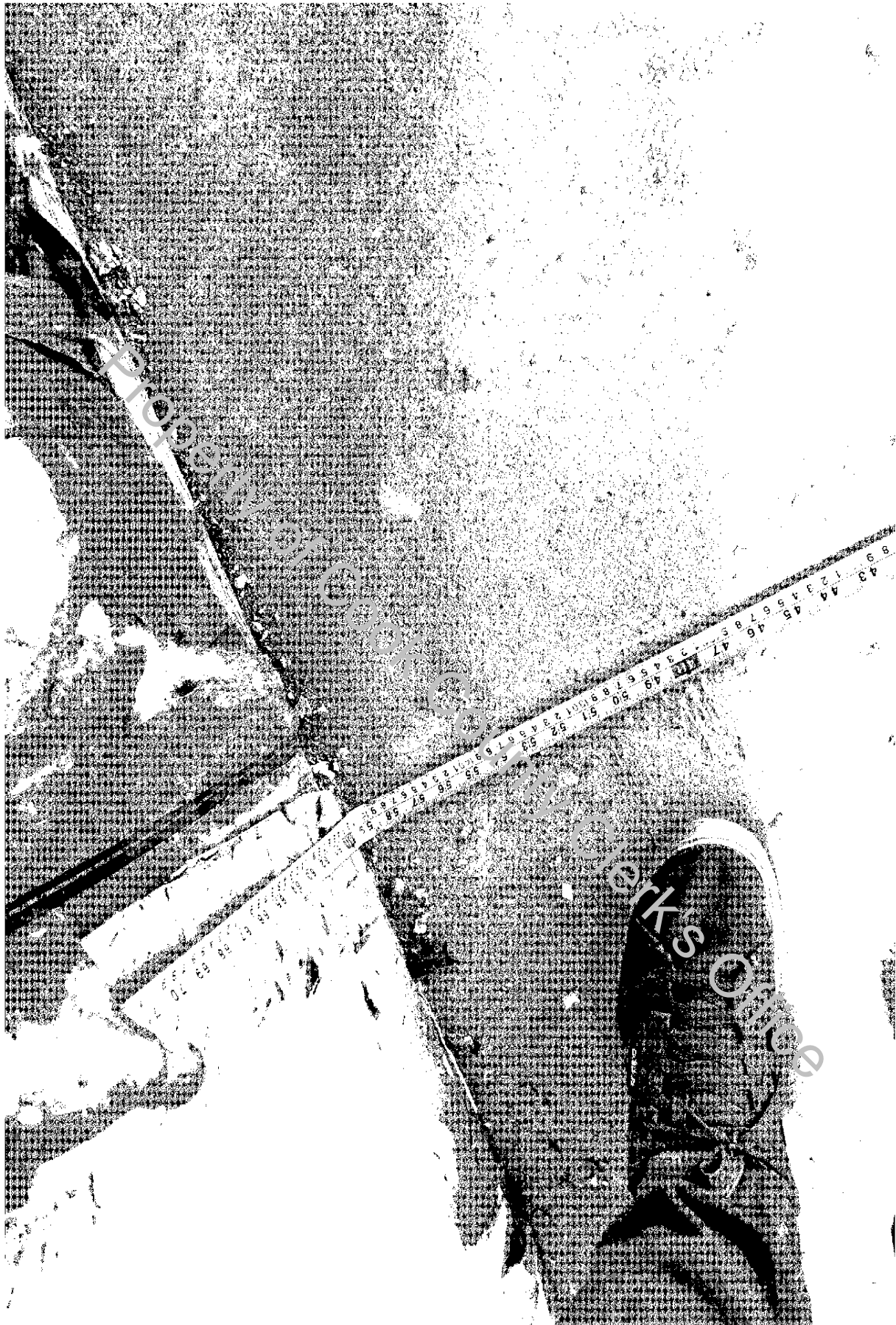

UNOFFICIAL COPY

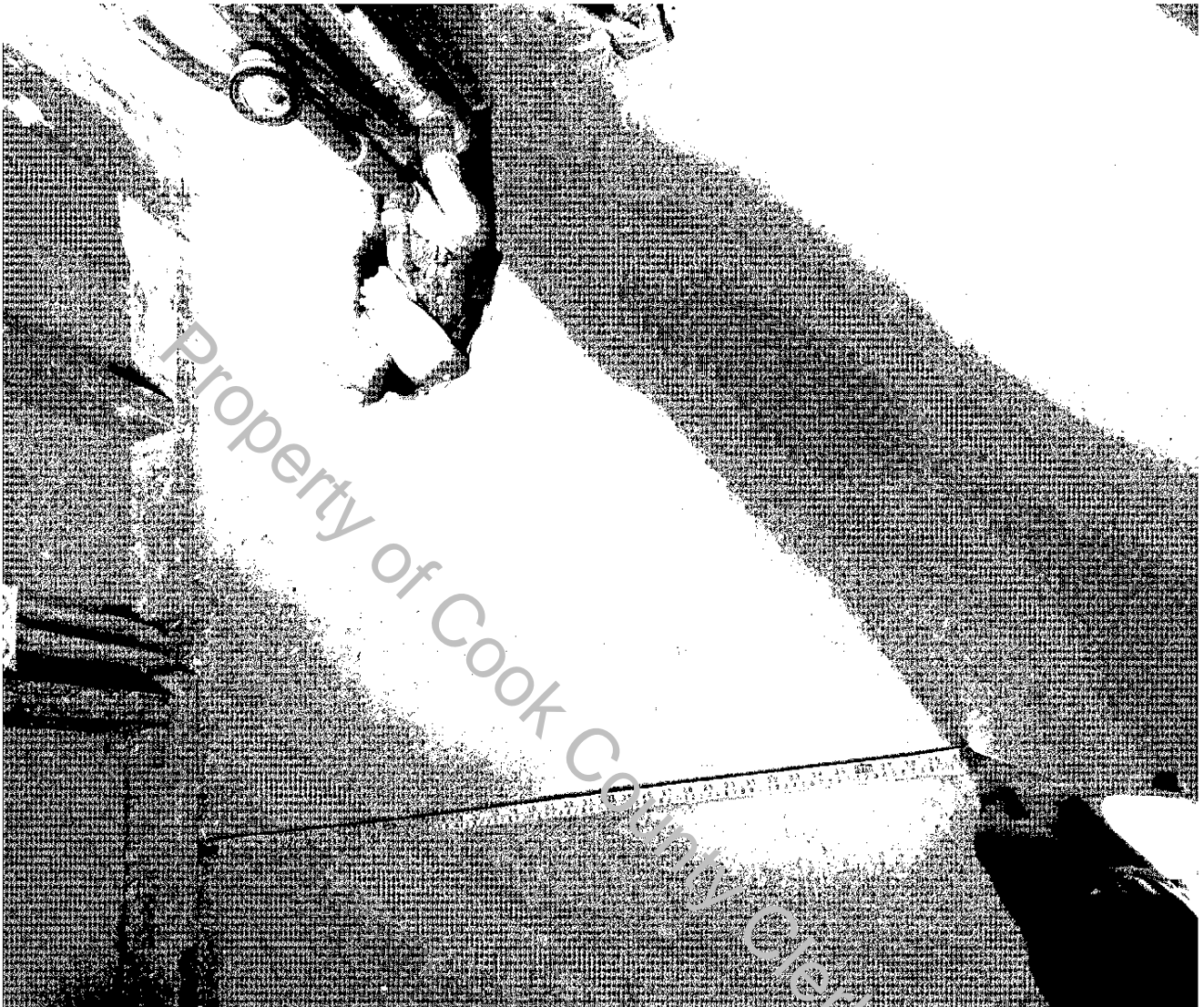

Scanned with CamScanner

Property of Cook County Clerk's Office

UNOFFICIAL COPY

PJ Stroebel

to: Dylan, Triestopoulos, me

Adding 12x20 niche shower shelf

+\$300

Final amount with change- \$6500

Amount paid so far- \$3100

New amount owed- \$3400

PJ Stroebel

to: me

Forwarded message

From: Candy Gerber <stgerber11@aol.com>

Date: Thu, Nov 11, 2021 at 3:52 PM

Subject: Re: Change order

To: PJ Stroebel <pjstroebel@cityofathens.com>

Yes, Confirming changes

Best regards

Candy

> On Nov 11, 2021, at 3:50 PM, PJ Stroebel <pjstroebel@cityofathens.com> wrote:

>

>

..

Thu, Nov 11, 3:50 P

11:23 AM (3 minutes ag

Property of Cook County Clerk's Office

UNOFFICIAL COPY

Contractor's Sworn Statement

State of Illinois

County of Cook

The affiant, Thomas de Boer being duly sworn on oath, deposes and states the following: He is President of Century City Baths, LLC contract dated 10/26/2021 with Candy and Randy Gerber (the "Owner") for construction of a shower remodel on the following described premises, 4159 Picardy Dr, Northbrook, Cook County, Illinois 60062.

The following persons have been contracted with and have furnished materials or labor for the improvements. This statement reflects the names of all parties furnishing materials or labor for or in connection to the project, the nature of the work contracted for, amount of contract, amount actually paid and the amount owing. The contract with the Owner, including 1 (one) change order is for \$6500 of which \$3100 has been paid by the Owner prior to this statement.

This statement is made and provided to the Owner for the purpose of procuring from the Owner final payment on the contract. In consideration of this final payment, and clearance thereof, the undersigned does hereby waive and release any and all lien, and right of lien on the above described building and real estate on account of any and all labor, material, or both, furnished or incorporated into the improvement by the undersigned to date.

UNOFFICIAL COPY

Name	Contract For	Contract Amount	Amount Paid	Balance
Ironclad Developments Corp	Installation of tile and fixtures.	\$2600	\$2600	\$0
PB Plumbing	Rough Plumbing	\$900	\$900	\$0
Sandra Martinez	Installation of hydroban shower base	\$300	\$300	\$0
Century City Baths, LLC	General Contractor and Supplier of Installation Materials	\$2700	\$0	\$2700

Amount of Original Contract	-	\$6200
Change Order(s)	-	\$300
Total Contract and Change Order(s)	-	\$6500
Credits To Contract	-	\$0
Net Contract Amount	-	\$6500
Amount of Previous Payments	-	\$3100
Amount Requested this Payment	-	\$3400
Balance to Complete	-	\$3400

All Materials, except as previously and above listed, has been furnished from my own stock and paid in full.

Signed, Indefin 12/21/2021
 Date
President
 Title.

Subscribed and Sworn to me this 21 day of DECEMBER, 2021

JUNE 28, 2024 Magdalena Gasiénica
 My commission expires Notary Public

