

UNOFFICIAL COPY

COOK COUNTY
FILED FOR RECORD

FEB 17 PM 2:06

37090860

87090860

Loan No. _____

ASSIGNMENT OF REAL ESTATE MORTGAGE

KNOW ALL MEN BY THESE PRESENTS: THAT CONTINENTAL ILLINOIS NATIONAL BANK AND TRUST COMPANY OF CHICAGO, a National Banking Association, organized and existing under and by virtue of the laws of the United States of America and authorized to do business in Illinois and having its principal place of business in the City of Chicago, State of Illinois, Party of the First Part, for value received, has granted, bargained, sold, assigned, transferred and set over, and by these presents does grant, bargain, sell, assign, transfer and set over unto TALMAN HOME MORTGAGE CORPORATION Party of the Second Part, its successors and assigns, a certain indenture of mortgage dated the _____ day of _____, A.D. 19_____ made by

SEE ATTACHED

to it, securing the payment of one promissory note therein described for the sum of

SEE ATTACHED

and all right, title and interest in and to the premises situated the County of COOK and State of ILLINOIS and described in said mortgage as follows; to-wit: _____ DOLLARS (\$)

SEE ATTACHED

Which said mortgage is recorded in the office of the Recorder of COOK County, in the State of ILLINOIS, in Book No. _____ at Page _____ as Document No. _____, together with the said note therein described, and the money due or to grow due thereon, with the interest:

TO HAVE AND HOLD the same unto the said party of the second part, its successors and assigns, forever; subject only to the provisions contained in the said indenture of mortgage.

IN WITNESS WHEREOF, the party of the first part has caused this instrument to be executed in its name by its Vice President and attested by its Real Estate Officer and its corporate seal to be hereunto affixed this

1st day of May, A.D. 1986

CONTINENTAL ILLINOIS NATIONAL BANK AND TRUST COMPANY OF CHICAGO

BY _____ Vice President

87090860

ATTEST:
(SEAL)

ITS Real Estate Officer

STATE OF ILLINOIS)ss
COUNTY OF COOK)

I, the undersigned, a Notary Public in and for the County and State aforesaid, DO HEREBY CERTIFY that the persons whose names are subscribed to the foregoing instrument are personally known to be duly authorized officers of CONTINENTAL ILLINOIS NATIONAL BANK AND TRUST COMPANY OF CHICAGO, a National Banking Association, and personally known to me to be the same persons whose names are subscribed to the foregoing instrument as such officers, appeared before me this day in person and acknowledged that they signed and delivered the said instrument as their free and voluntary act and as the free and voluntary act of said association for the uses and purposes therein set forth, and the said Real Estate Officer did also then and there acknowledge that he as custodian of the corporate seal of said association did affix the same to said instrument as his own free and voluntary act and the free and voluntary act of said association, for the uses and purposes therein set forth.

Given under my hand and notarial seal this 1st day of May, A.D. 1986

This instrument was prepared by:
Name: Shirley A. Senase
Address: 231 S. LaSalle Street
Chicago, Illinois 60693

1 AT 1900

NOTARY PUBLIC - My commission expires: 7/12/89
(SEAL)

Mail to: Box 333
Sales Department

47 ASSIGN FOLLOW

UNOFFICIAL COPY

indebtedness, if not sooner paid, due and payable on..... OCTOBER 1, 2000.....

To Secure to Lender (s) the repayment of the indebtedness evidenced by the Note, with interest thereon, the payment of all other sums, with interest thereon, advanced in accordance herewith to protect the security of this Mortgage, and the performance of the covenants and agreements of Borrower herein contained, and (b) the repayment of any future advances, with interest thereon, made to Borrower by Lender pursuant to paragraph 21 hereof (herein "Future Advances"), Borrower does hereby mortgage, grant and convey to Lender the following described property located in the County of..... Cook....., State of Illinois:

66-17-121 E

THE FIDELITY AND SECURITY COMPANY HAS HEREBY MADE A PART HEREOF
HEREIN ATTACHED TO AND EXPRESSLY MADE A
PART OF THIS CHARGE-INTEREST DATED
AUGUST 28, 1979
EXECUTED BY: GAIL S. ZICKOWSKI, NEYER
MARLINO

PARCEL 1:

Unit 2014 in Americana Towers Condominium, as delineated on survey of the following described parcel of real estate (hereinafter referred to as "Parcel"):

Sub-Lot 14 in the Subdivision of Lots 14 to 19 and the South 63 feet of Lot 13 in Gale's North addition to Chicago in Section 33, Township 40 North, Range 14 East of the Third Principal Meridian.

Also;

Lots and parts of lots in the Subdivision of Lot 20 in Gale's North addition to Chicago, aforesaid,

Also;

Lots and part of lot in the Subdivision of Lot 21 in Gale's North addition to Chicago, aforesaid,

17-33-422-0687222 Sew

25161977

which survey is attached as Exhibit 'A' to Declaration of Condominium made by LaSalle National Bank, a National Banking Association, as Trustee under Trust Agreement dated July 10, 1970 and known as Trust Number 41015 recorded as Document No. 24 267612 and filed as Document No. LR 29 91 06), together with an undivided 16.36 percent interest in said Parcel (excepting from said Parcel all the property and appurtenances comprising all the units thereof as defined and set forth in said declaration and survey) in Cook County, Illinois.

25161977

PARCEL 2:

Easements created by grant dated October 26, 1926 and filed October 29, 1926 as Document No. LR 326084 for the purposes of ingress and egress over the South 8 feet of Lot 4 (except that part taken for North Franklin Street) in the Subdivision of Lot 21 in Gale's North addition to Chicago in Section 33, Township 40 North, Range 14 East of the Third Principal Meridian, all in Cook County, Illinois.

87090860

Mortgagor also hereby grants to mortgagee, its successors and assigns, as rights and easements appurtenant to the above described real estate, the rights and easements for the benefit of said property set forth in the aforementioned Declaration.

25161977

This Mortgage is subject to all rights, easements, restrictions, conditions, covenants and reservations contained in said Declaration the same as though the provisions of said Declaration were recited and stipulated at length.

Said grantor agrees and agrees to comply with and perform all of the covenants and agreements imposed by them in favor of the above described real estate by the Declaration of Condominium covering the same.

87090860

UNOFFICIAL COPY

ILLINOIS

COOK

ASSIGNMENTS

87090860

DOCUMENT NO. # 55129063
LOAN NO. # 300820
PARCEL NO. #
NAME & ADDRESS #
20-31-427-043-0000
66075 HOOV
CHICAGO

BOOK #
BLAUGHTIE
PAGE #
LOAN CLSD. DATE # 79-10-09
ORIG. MTG. AMT. #
49,900

IL 60620 607 030

DOCUMENT NO. # 25167296
LOAN NO. # 300840
PARCEL NO. #
NAME & ADDRESS #
13-02-108-007-0000
6227 HORTON BUNDING A
CHICAGO

BOOK #
KIM
PAGE #
LOAN CLSD. DATE # 79-10-22
ORIG. MTG. AMT. #
73,000

IL 60659 607 032

DOCUMENT NO. # 25161977
LOAN NO. # 300832
PARCEL NO. #
NAME & ADDRESS #
14-33-422-060-1222
1636N WELLS UNIT 2014
CHICAGO

BOOK #
GS ZUCKERHA
PAGE #
LOAN CLSD. DATE # 79-09-06
ORIG. MTG. AMT. #
32,000

IL 60614 607 032

DOCUMENT NO. # 25166422
LOAN NO. # 300842
PARCEL NO. #
NAME & ADDRESS #
16-04-111-020-0000
1450N LONG AVENUE
CHICAGO

BOOK #
FERNAN/C
PAGE #
LOAN CLSD. DATE # 79-10-17
ORIG. MTG. AMT. #
33,700

IL 60651 607 032

DOCUMENT NO. # 25169131
LOAN NO. # 300845
PARCEL NO. #
NAME & ADDRESS #
25-15-110-036-0000
10446S PRAIRIE
CHICAGO

BOOK #
DURKS
PAGE #
LOAN CLSD. DATE # 79-10-11
ORIG. MTG. AMT. #
40,500

IL 60626 607 032

DOCUMENT NO. # 25155791
LOAN NO. # 300901
PARCEL NO. #
NAME & ADDRESS #
09-35-124-011-0000
529S DELPHIA
PARK

BOOK #
LLOYD/MU
PAGE #
LOAN CLSD. DATE # 79-09-24
ORIG. MTG. AMT. #
62,100

IL 60068 607 030

48

1-1900

374
39300

MT

UNOFFICIAL COPY

Property of Cook County Clerk's Office

ASSIGNMENTS

ILLINOIS

COOK

DOCUMENT NO. ~~297033~~ BOOK # 13001 ASTOR ST UNIT 7 CHICAGO IL 60610 ORIG. DATE 79-09-20 AMT. 57,500
 LOAN NO. ~~300903~~ NAME & ADDRESS 13001 ASTOR ST UNIT 7 CHICAGO IL 60610 ORIG. DATE 79-09-20 AMT. 57,500
 PARCEL NO. ~~17-03-106-020-1017~~

DOCUMENT NO. ~~28230067~~ BOOK # 13001 ASTOR ST UNIT 1 CHICAGO IL 60610 ORIG. DATE 79-10-26 AMT. 71,500
 LOAN NO. ~~300903~~ NAME & ADDRESS RS HACHIER 13001 ASTOR ST UNIT 1 CHICAGO IL 60610 ORIG. DATE 79-10-26 AMT. 71,500
 PARCEL NO. ~~17-03-106-020-1017~~

DOCUMENT NO. ~~25105497~~ BOOK # 101475 CARPENTER CHICAGO IL 60643 ORIG. DATE 79-10-31 AMT. 30,700
 LOAN NO. ~~300906~~ NAME & ADDRESS STEPHENS 101475 CARPENTER CHICAGO IL 60643 ORIG. DATE 79-10-31 AMT. 30,700
 PARCEL NO. ~~29-00-419-017-0000~~

DOCUMENT NO. ~~25107756~~ BOOK # 212M ARMITAGE CHICAGO IL 60647 ORIG. DATE 79-10-09 AMT. 31,500
 LOAN NO. ~~300909~~ NAME & ADDRESS ORTIZ 212M ARMITAGE CHICAGO IL 60647 ORIG. DATE 79-10-09 AMT. 31,500
 PARCEL NO. ~~14-31-116-035-0000~~

DOCUMENT NO. ~~25307540~~ BOOK # 10E ELM ST UNIT 20- CHICAGO IL 60611 ORIG. DATE 60-01-02 AMT. 57,300
 LOAN NO. ~~300906~~ NAME & ADDRESS FOLLI 10E ELM ST UNIT 20- CHICAGO IL 60611 ORIG. DATE 60-01-02 AMT. 57,300
 PARCEL NO. ~~17-03-200-066-1117~~

DOCUMENT NO. ~~3120292~~ BOOK # 2045 HOLP RD CHICAGO IL 60616 ORIG. DATE 79-10-30 AMT. 39,600
 LOAN NO. ~~300909~~ NAME & ADDRESS M NETS 2045 HOLP RD CHICAGO IL 60616 ORIG. DATE 79-10-30 AMT. 39,600
 PARCEL NO. ~~09-10-005-010-0000~~ DESLAINES

DOCUMENT NO. ~~3124281~~ BOOK # 4020N FRANCISCO CHICAGO IL 60610 ORIG. DATE 79-10-12 AMT. 27,000
 LOAN NO. ~~00011~~ NAME & ADDRESS SMYKOS 4020N FRANCISCO CHICAGO IL 60610 ORIG. DATE 79-10-12 AMT. 27,000
 PARCEL NO. ~~13-13-349-026-0000~~

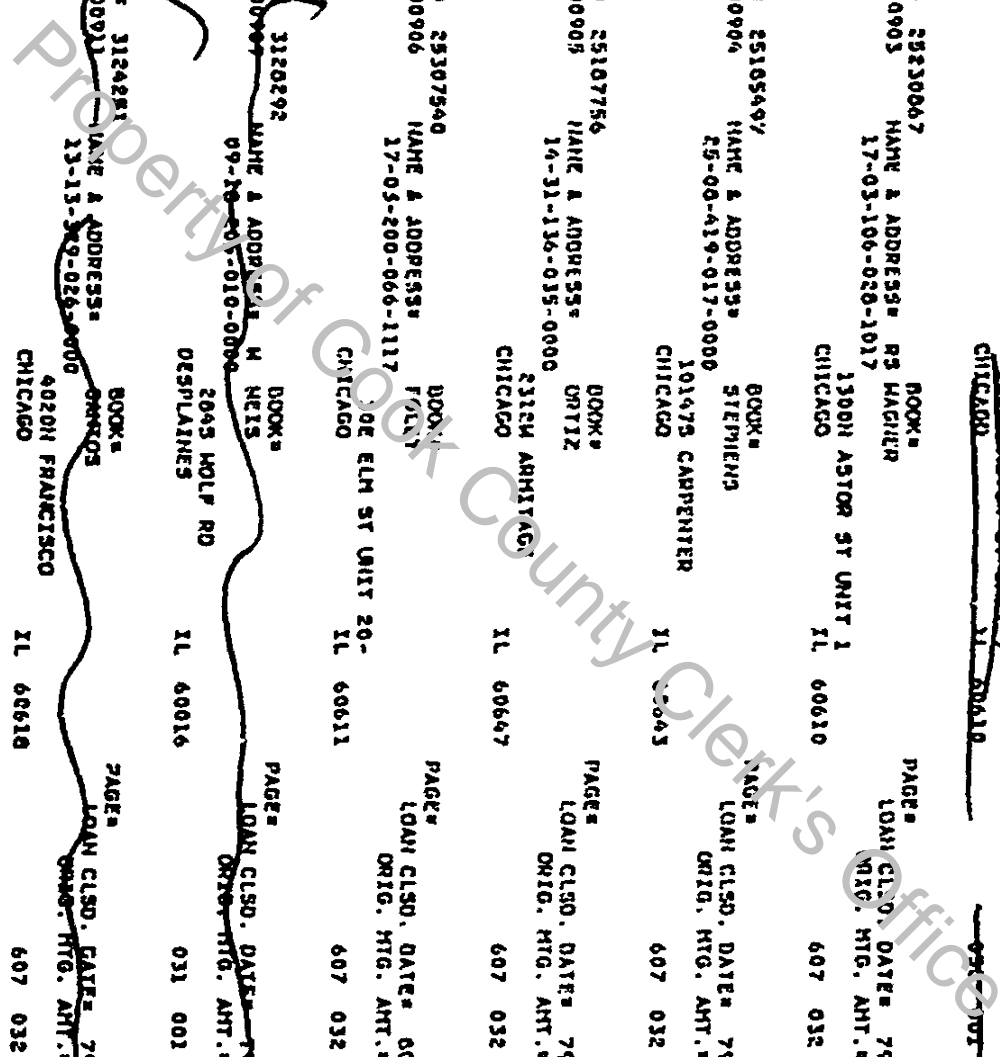

UNOFFICIAL COPY

Property of Cook County Clerk's Office

87090860

ASSIGNMENTS

ILLINOIS

COOK

DOCUMENT NO. # 25194780 BOOK #
 LOAN NO. # 300912 NAME & ADDRESS: HEZA PAGE #
 PARCEL NO. # 11-31-403-005-0000 CHICAGO 1641M PRATT LOAN CLSD. DATE= 79-10-22
 ORIG. MTG. AMT. # 80,800

IL 60626 607 032

DOCUMENT NO. # 25239708 BOOK #
 LOAN NO. # 300914 NAME & ADDRESS: PACK PAGE #
 PARCEL NO. # 17-03-200-066-1000 CHICAGO 30E ELM ST UNIT 4A LOAN CLSD. DATE= 79-11-01
 ORIG. MTG. AMT. # 56,200

IL 60611 607 027

DOCUMENT NO. # 3126392 BOOK #
 LOAN NO. # 300915 NAME & ADDRESS: VJ BLACHMAN PAGE #
 PARCEL NO. # 21-31-312-000-0000 CHICAGO 6423S CONWAY LOAN CLSD. DATE= 79-10-12
 ORIG. MTG. AMT. # 31,500

IL 60617 607 032

DOCUMENT NO. # 25104251 BOOK #
 LOAN NO. # 300916 NAME & ADDRESS: GARDA PAGE #
 PARCEL NO. # 13-34-216-001-0000 CHICAGO 225TH KEYSTONE LOAN CLSD. DATE= 79-10-26
 ORIG. MTG. AMT. # 20,000

IL 60639 607 032

DOCUMENT NO. # 25326033 BOOK #
 LOAN NO. # 300917 NAME & ADDRESS: GRALIC PAGE #
 PARCEL NO. # 17-03-200-066-1064 CHICAGO 30E ELM ST UNIT 12- LOAN CLSD. DATE= 80-01-02
 ORIG. MTG. AMT. # 52,000

IL 60611 607 032

DOCUMENT NO. # 25311516 BOOK #
 LOAN NO. # 300918 NAME & ADDRESS: TRUSTAR PAGE #
 PARCEL NO. # 17-03-201-066-1037 CHICAGO 30 EAST ELM ST UNIT LOAN CLSD. DATE= 80-01-02
 ORIG. MTG. AMT. # 61,000

IL 60611 607 032

DOCUMENT NO. # 25106011 BOOK #
 LOAN NO. # 300919 NAME & ADDRESS: KE BROOK PAGE #
 PARCEL NO. # 25-20-316-028-0000 CHICAGO 11720S BISHOP ST LOAN CLSD. DATE= 79-10-23
 ORIG. MTG. AMT. # 41,000

IL 60643 607 032



UNOFFICIAL COPY

Property of Cook County Clerk's Office

UNOFFICIAL COPY

Property of Cook County Clerk's Office

ILLINOIS

COOK

ASSIGNMENTS

87090860

DOCUMENT NO. # 25231727 BOOK #
 LOAN NO. # 300935 NAME & ADDRESS # YUKOYAMA
 PARCEL NO. # 14-20-104-090-1030 751 CALIFORNIA TER
 CHICAGO IL 60637 PAGE # 407 032
 LOAN CLSD. DATE# 79-10-30 ORIG. MTG. AMT. # 60,900

DOCUMENT NO. # 25222416 BOOK #
 LOAN NO. # 300934 NAME & ADDRESS # COZZI
 PARCEL NO. # 13-17-104-024-0000 3969H NEHLAND
 CHICAGO IL 60634 PAGE # 607 032
 LOAN CLSD. DATE# 79-11-21 ORIG. MTG. AMT. # 49,500

DOCUMENT NO. # 25215066 BOOK #
 LOAN NO. # 300933 NAME & ADDRESS # BRADLEY
 PARCEL NO. # 23-15-200-004-0000 104119 VERMAN
 CHICAGO IL 60620 PAGE # 607 032
 LOAN CLSD. DATE# 79-11-19 ORIG. MTG. AMT. # 41,400

DOCUMENT NO. # 25209746 BOOK #
 LOAN NO. # 300932 NAME & ADDRESS # SINGLETON
 PARCEL NO. # 20-36-209-000-0000 60319 CHIAPREL
 CHICAGO IL 60617 PAGE # 607 032
 LOAN CLSD. DATE# 79-11-09 ORIG. MTG. AMT. # 37,000

DOCUMENT NO. # 25259701 BOOK #
 LOAN NO. # 300940 NAME & ADDRESS # JACSONI
 PARCEL NO. # 17-03-200-066-1099 ONE ELM ST UNIT 18D
 CHICAGO IL 60611 PAGE # 607 032
 LOAN CLSD. DATE# 79-11-01 ORIG. MTG. AMT. # 62,200

DOCUMENT NO. # 3133046 BOOK #
 LOAN NO. # 300944 NAME & ADDRESS # RAGLIN
 PARCEL NO. # 25-24-46-005-0000 10615 90 EGGLESTON
 CHICAGO IL 60620 PAGE # 607 027
 LOAN CLSD. DATE# 79-11-16 ORIG. MTG. AMT. # 24,200

DOCUMENT NO. # 25232667 BOOK #
 LOAN NO. # 300945 NAME & ADDRESS # ECHOLS
 PARCEL NO. # 25-04-105-021-0000 505H 07TH ST
 CHICAGO IL 60620 PAGE # 607 032
 LOAN CLSD. DATE# 79-11-27 ORIG. MTG. AMT. # 36,000

Property of Cook County Clerk's Office

UNOFFICIAL COPY

Property of Cook County Clerk's Office

ILLINOIS

COOK

ASSIGNMENTS

87090860

DOCUMENT NO. # 25200990
LOAN NO. # 300947
PARCEL NO. #

BOOK #
NOYAK

NAME & ADDRESS #
13-36-227-061-0000
2123 NORTH POINT
CHICAGO

IL 60647

PAGE #
LOAN CLSD. DATE # 79-12-19
ORIG. MTG. AMT. #

22,800

DOCUMENT NO. # 25234412
LOAN NO. # 300940
PARCEL NO. #

BOOK #
IN WASHINGTON

NAME & ADDRESS #
25-05-420-000-0000
94233 RACINE
CHICAGO

IL 60620

PAGE #
LOAN CLSD. DATE # 79-11-20
ORIG. MTG. AMT. #

45,000

DOCUMENT NO. # 25259007
LOAN NO. # 300950
PARCEL NO. #

BOOK #
HOLES

NAME & ADDRESS #
25-05-407-005-0000
92155 MAY
CHICAGO

IL 60620

PAGE #
LOAN CLSD. DATE # 79-12-12
ORIG. MTG. AMT. #

36,000

DOCUMENT NO. # 25253044
LOAN NO. # 300951
PARCEL NO. #

BOOK #
HARTMAN

NAME & ADDRESS #
16-05-125-031-3333
91111 TAVEL
OAK

IL 60302

PAGE #
LOAN CLSD. DATE # 79-12-06
ORIG. MTG. AMT. #

49,500

DOCUMENT NO. # 25257411
LOAN NO. # 300952
PARCEL NO. #

BOOK #
CILLAZO

NAME & ADDRESS #
14-20-100-007-0000
25431 SOUTHWEST
CHICAGO

IL 60615

PAGE #
LOAN CLSD. DATE # 79-12-05
ORIG. MTG. AMT. #

34,100

DOCUMENT NO. # 25333787
LOAN NO. # 300953
PARCEL NO. #

BOOK #
CORRICK

NAME & ADDRESS #
17-03-204-006-1004
30 EAST ELM ST UNIT
CHICAGO

IL 60611

PAGE #
LOAN CLSD. DATE # 00-01-02
ORIG. MTG. AMT. #

57,400

DOCUMENT NO. # 25262707
LOAN NO. # 300955
PARCEL NO. #

BOOK #
GIESEU

NAME & ADDRESS #
14-33-201-016-1023
2317N COMMONWEALTH UN
CHICAGO

IL 60614

PAGE #
LOAN CLSD. DATE # 79-11-19
ORIG. MTG. AMT. #

31,300

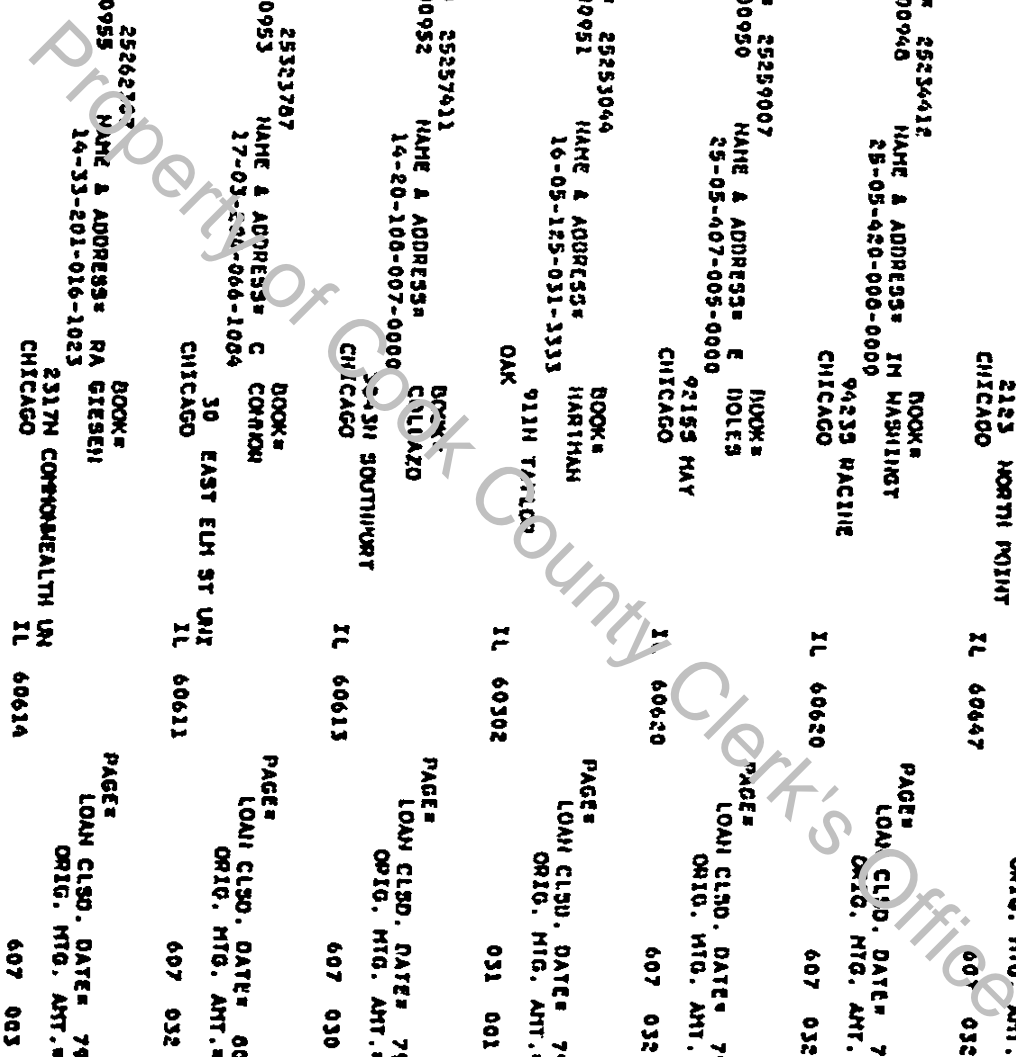

UNOFFICIAL COPY

Property of Cook County Clerk's Office

UNOFFICIAL COPY

Property of Cook County Clerk's Office

ILLINOIS

COOK

ASSIGNMENTS

87090860

DOCUMENT NO. # 25270400 BOOK #
 LOAN NO. # 300960 NAME & ADDRESS # HOWARD
 PARCEL NO. # 20-27-210-019-0000 CHICAGO 72915 EDENHART AVE
 PAGE # IL 60619 027 25,600
 LOAN CLSD. DATE # 79-12-10
 ORIG. MTG. AMT. #

DOCUMENT NO. # 25321714 BOOK #
 LOAN NO. # 300970 NAME & ADDRESS # SCARBACE
 PARCEL NO. # 17-03-200-066-1092 CHICAGO 30 EAST ELM ST UNIT
 PAGE # IL 60611 607 032 56,600
 LOAN CLSD. DATE # 00-01-02
 ORIG. MTG. AMT. #

DOCUMENT NO. # 25270610 BOOK #
 LOAN NO. # 300972 NAME & ADDRESS # DURIAS
 PARCEL NO. # 16-27-413-012-0000 CHICAGO 27315 KEDVALE
 PAGE # IL 60623 607 030 20,000
 LOAN CLSD. DATE # 79-12-27
 ORIG. MTG. AMT. #

DOCUMENT NO. # 25263794 BOOK #
 LOAN NO. # 300973 NAME & ADDRESS # GRIGGS
 PARCEL NO. # 25-21-114-027-0000 CHICAGO 11250 SP COLLESTON
 PAGE # IL 60620 607 030 30,000
 LOAN CLSD. DATE # 79-12-27
 ORIG. MTG. AMT. #

DOCUMENT NO. # 3137074 BOOK #
 LOAN NO. # 300975 NAME & ADDRESS # LAM
 PARCEL NO. # 25-02-303-051-0000 CHICAGO 11045 DONISON
 PAGE # IL 60619 607 030 49,000
 LOAN CLSD. DATE # 79-12-14
 ORIG. MTG. AMT. #

DOCUMENT NO. # 25267697 BOOK #
 LOAN NO. # 300976 NAME & ADDRESS # TRUST/PA
 PARCEL NO. # 20-00-01-045-0000 CHICAGO 5149 SO MAY
 PAGE # IL 60609 607 030 12,000
 LOAN CLSD. DATE # 00-01-16
 ORIG. MTG. AMT. #

DOCUMENT NO. # 25299000 BOOK #
 LOAN NO. # 300977 NAME & ADDRESS # COOD
 PARCEL NO. # 20-36-224-034-0000 CHICAGO 2010 EAST 63RD
 PAGE # IL 60617 607 032 16,500
 LOAN CLSD. DATE # 00-01-25
 ORIG. MTG. AMT. #

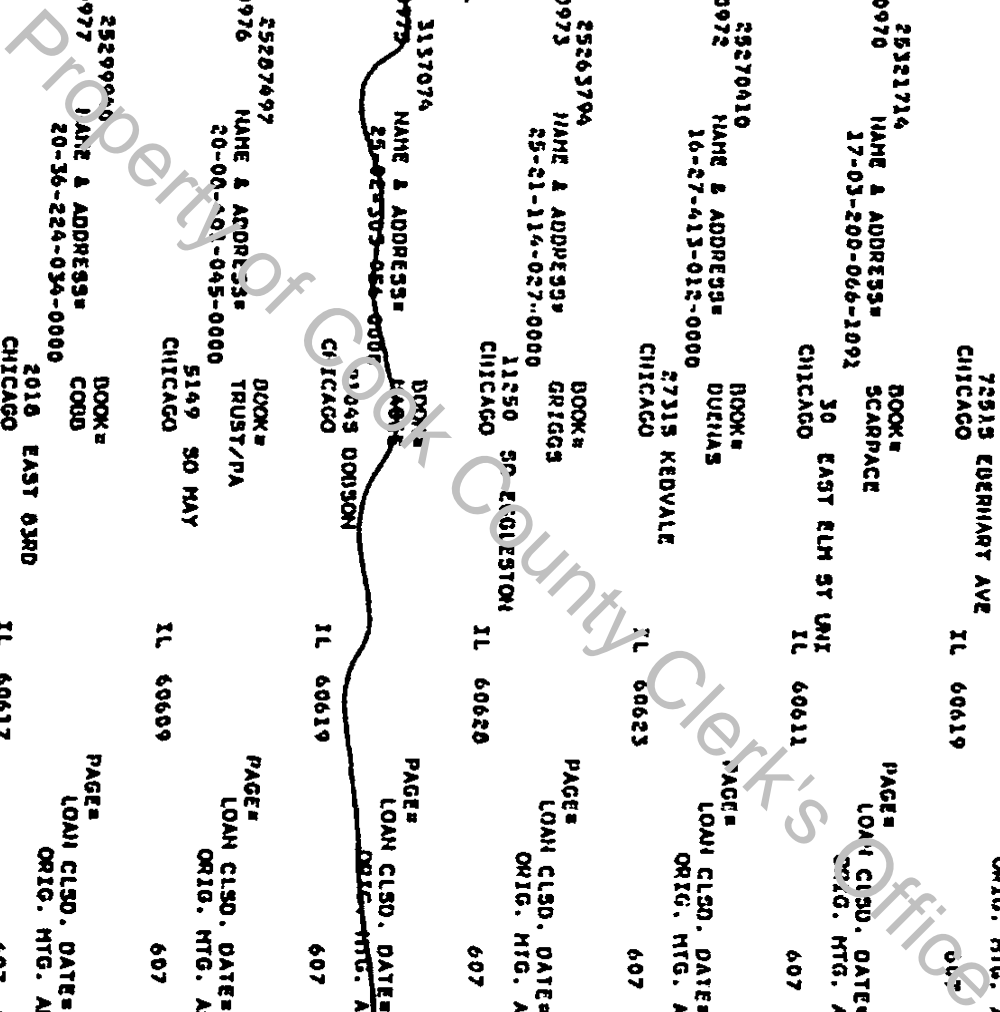

UNOFFICIAL COPY

Property of Cook County Clerk's Office