

87318020

[X]

50864042

ASSIGNMENT OF REAL ESTATE MORTGAGE

KNOW ALL MEN BY THESE PRESENTS: MARGARETTEN & COMPANY, INC.

a corporation organized and existing under and by virtue of the laws of the State of New Jersey and authorized to do business in Illinois and having its principal office and place of business in the City of Perth Amboy, State of New Jersey

party of the first part, for value received, has granted, bargained, sold, assigned, transferred and set over, and by these presents does grant, sell, assign, bargain, transfer and set over unto:

METMOR FINANCIAL, INC.

87318020

party of the second part, its successors and assigns, a certain indenture of mortgage dated the day of January 1987 made by: JORGE F SILVA, DIVORCED AND NOT SINCE REMARRIED AND HIRAM MARTINEZ, BACHELOR 9th

to it, securing the payment of one promissory note therein described for the sum of Sixty- Three Thousand, Three Hundred Eighteen and 00/100 Dollars (\$ 63,318.00) and all right, title and interest in and to the premises situated in the County of COOK and State of Illinois and described in said mortgage as follows:

to wit: LOT 28 IN BLOCK 4 IN CENTRAL AVENUE SURDIVISION OF THAT PART OF THE EAST 1/2 OF THE NORTH EAST 1/4 OF SECTION 32, TOWNSHIP 40 NORTH, RANGE 13, EAST OF THE THIRD PRINCIPAL MERIDIAN, IN COOK COUNTY, ILLINOIS.

CFOL 13-32-223-030 BFOLJ

Parcel # 133-22-230-300 Property Address-2108 N MANGO CHICAGO ILL 60639

DEPT-01 RECORDING \$12.00 T#0222 TRAN 0479 06/11/87 10:12:00 #2094 # B *-87-318020 COOK COUNTY RECORDER

Which said mortgage is Recorded in the office of the Recorder of Illinois, in Book at Page COOK as Document No. 87-041838 County, in the State of together with the said note therein described, and the money due or to grow due thereon, with the interest: TO HAVE AND TO HOLD the same unto the said party of the second part, its successors and assigns, forever; subject only to the provisions contained in the said indenture of mortgage.

IN WITNESS WHEREOF, the party of the first part has caused this instrument to be executed in its name by its ASST VICE-PRESIDENT and attested by its ASST SECRETARY and its corporate seal to be hereunto affixed this 30th day of January 1987

ATTEST (SEAL)

Donna Rosa ASST SECRETARY DONNA ROSA

BY

TERRI L GIBBS ASST VICE-PRESIDENT

87318020

STATE OF NEW JERSEY COUNTY OF MIDDLESEX

I, the undersigned, a Notary Public in and for the County and State aforesaid, DO HEREBY CERTIFY that the persons whose names are subscribed to the foregoing instrument are personally known to me to be duly authorized officers of

MARGARETTEN & COMPANY, INC. and personally known to me to be the same persons whose names are subscribed to the foregoing instrument as such officers, appeared before me this day in person and acknowledged that they signed and delivered the said instrument as their free and voluntary act and as the free and voluntary act of said corporation, for the uses and purposes therein set forth, and the said ASSISTANT SECRETARY did also then and there acknowledge that she as custodian of the seal of said corporation did affix the said corporate seal to said instrument as his own free and voluntary act and as the free and voluntary act of said corporation, for the uses and purposes therein set forth.

Given under my hand and notarial seal this 30th day of January 1987

ILLINOIS ASSIGNMENT OF MORTGAGE

MAR-1206 (8/86)

Replaces IL-710 (10/84)

1200 Notary Public Seal

Notary Public Signature My Commission Expires June 12, 1991

UNOFFICIAL COPY

ASSIGNMENT OF REAL ESTATE MORTGAGE

KNOW ALL MEN BY THESE PRESENTS

MARGARETTEN & COMPANY, INC.

and authorized to do business in and through the State of New Jersey, do hereby certify that the following is a true and correct copy of the original as the same appears on the records of the State of New Jersey.

part of the first part of the original, the assignment of mortgage, which is a true and correct copy of the original as the same appears on the records of the State of New Jersey.

MITROM FINANCIAL INC.

part of the second part of the original, the assignment of mortgage, which is a true and correct copy of the original as the same appears on the records of the State of New Jersey.

part of the third part of the original, the assignment of mortgage, which is a true and correct copy of the original as the same appears on the records of the State of New Jersey.

part of the fourth part of the original, the assignment of mortgage, which is a true and correct copy of the original as the same appears on the records of the State of New Jersey.

part of the fifth part of the original, the assignment of mortgage, which is a true and correct copy of the original as the same appears on the records of the State of New Jersey.

part of the sixth part of the original, the assignment of mortgage, which is a true and correct copy of the original as the same appears on the records of the State of New Jersey.

part of the seventh part of the original, the assignment of mortgage, which is a true and correct copy of the original as the same appears on the records of the State of New Jersey.

part of the eighth part of the original, the assignment of mortgage, which is a true and correct copy of the original as the same appears on the records of the State of New Jersey.

part of the ninth part of the original, the assignment of mortgage, which is a true and correct copy of the original as the same appears on the records of the State of New Jersey.

NOTARY PUBLIC OF NEW JERSEY
My Commission Expires June 18, 1991

part of the tenth part of the original, the assignment of mortgage, which is a true and correct copy of the original as the same appears on the records of the State of New Jersey.

part of the eleventh part of the original, the assignment of mortgage, which is a true and correct copy of the original as the same appears on the records of the State of New Jersey.

part of the twelfth part of the original, the assignment of mortgage, which is a true and correct copy of the original as the same appears on the records of the State of New Jersey.

part of the thirteenth part of the original, the assignment of mortgage, which is a true and correct copy of the original as the same appears on the records of the State of New Jersey.

05081878



RECORD AND RETURN TO:
MARGARETTEN & COMPANY, INC.
205 SMITH ST., P. O. BOX 3022
PERTH AMBOY, N. J. 08862
ATT: DOCUMENT CONTROL

part of the fourteenth part of the original, the assignment of mortgage, which is a true and correct copy of the original as the same appears on the records of the State of New Jersey.

part of the fifteenth part of the original, the assignment of mortgage, which is a true and correct copy of the original as the same appears on the records of the State of New Jersey.

part of the sixteenth part of the original, the assignment of mortgage, which is a true and correct copy of the original as the same appears on the records of the State of New Jersey.

part of the seventeenth part of the original, the assignment of mortgage, which is a true and correct copy of the original as the same appears on the records of the State of New Jersey.

NOTARY PUBLIC OF NEW JERSEY
My Commission Expires June 18, 1991

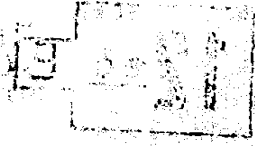

ASSIGNMENT OF MORTGAGE
MARGARETTEN & COMPANY, INC.