

UNOFFICIAL COPY

89622761

Release Deed

FOR THE PROTECTION OF THE OWNER, THIS RELEASE SHALL BE FILED WITH THE RECORDER OF DEEDS OR THE REGISTRAR OF TITLES IN WHOSE OFFICE THE MORTGAGE OR DEED OF TRUST WAS FILED.

89622761

DEEDS RECORDING \$40.00

198812 (FORM 612) 12/29/89 16:15:00
#89-622761
COOK COUNTY RECORDER

KNOW ALL MEN BY THESE PRESENTS,

THAT, in consideration of Ten dollars (\$10.00) and other good and valuable consideration, the receipt and sufficiency of which are hereby acknowledged, CITICORP NORTH AMERICA, INC., a Delaware corporation formerly known as Citicorp Industrial Credit, Inc. ("Mortgagee"), individually and in its separate capacity as agent for itself and Heller Financial, Inc., a Delaware corporation ("Heller") under that certain Credit Agreement dated April 24, 1987, as amended, by and among Mortgagee, Heller and the Chicago South Shore And South Bend Railroad, an Indiana corporation ("South Shore"), does hereby certify that the mortgages described below, each dated the 24th day of April, 1987, made by South Shore to Mortgagee, individually and as agent as aforesaid, and encumbering the premises described on Exhibit A attached hereto and by this reference made a part hereof, are, pursuant to an Order of the United States Bankruptcy Court for the Northern District of Illinois in Case No. 89 B 5898, along with the loans, debts and other obligations secured thereby, fully satisfied, released and discharged.

| <u>Instrument</u> | <u>Recording Jurisdiction</u> | <u>Date Recorded/Filed</u> | <u>Recording Nos.</u> |
|--|-------------------------------|----------------------------|-----------------------------|
| First Mortgage and Security Agreement | Cook County, Illinois | April 27, 1987 | #87220943 |
| First Mortgage and Security Agreement | Cook County, Illinois | April 28, 1987 | #87224424 |
| First Mortgage and Security Agreement | Lake County, Indiana | April 28, 1987 | #913970 |
| First Mortgage and Security Agreement | LaPorte County, Indiana | April 28, 1987 | 87-04371 |
| First Mortgage and Security Agreement | Porter County, Indiana | April 28, 1987 | 13506 (Bk. 495, Pg. 527) |
| First Mortgage and Security Agreement | St. Joseph Cty., Indiana | April 28, 1987 | 8712239 |
| Second Mortgage and Security Agreement | Cook County, Illinois | April 27, 1987 | 87220944 |

89622761

BSL0131 12/20/89 1014

-89-622761

3900 MAIL

UNOFFICIAL COPY

8 9 5 2 8 7 1

| | | | |
|--|--------------------------|----------------|-----------------------------|
| Second Mortgage and Security Agreement | Cook County, Illinois | April 28, 1987 | 87224425 |
| Second Mortgage and Security Agreement | Lake County, Indiana | April 28, 1987 | 913971 |
| Second Mortgage and Security Agreement | LaPorte County, Indiana | April 28, 1987 | 87-04972 |
| Second Mortgage and Security Agreement | Porter County, Indiana | April 28, 1987 | 13507 (Bk. 495, Pg. 528) |
| Second Mortgage and Security Agreement | St. Joseph Cty., Indiana | April 28, 1987 | 8712240 |

WITNESS the hand of the Mortgagee this 28th day of December, 1989.

MORTGAGEE:

CITICORP NORTH AMERICA, INC.,
a Delaware corporation, formerly known
as Citicorp Industrial Credit Inc.

By: *Richard L. Baer*

Name: *Richard L. Baer*

Title: *vice President*

This Instrument Prepared By ~~And~~
~~After Recording Return To:~~

Brian S. Levy, Esq.
Rudnick & Wolfe
203 North LaSalle Street
Suite 1800
Chicago, Illinois 60601

Please return to:
STATE TITLE SERVICES, INC.
1327 H Street, Suite 300
Lincoln, NE 68508

BSL0131 12/20/89 1014

2

89522761

UNOFFICIAL COPY

0 9 5 8 2 7 0 1

STATE OF ILLINOIS)
) SS
COUNTY OF COOK)

I, the undersigned, a Notary Public in and for the County and State aforesaid, DO HEREBY CERTIFY that Richard Banziger, personally known to me to be the Vice-President of CITICORP NORTH AMERICA, INC., a Delaware corporation formerly known as Citicorp Industrial Credit, Inc., personally known to me to be the same person whose name is subscribed to the foregoing instrument, appeared before me this day in person and acknowledged that he signed and delivered the said instrument as his free and voluntary act and as the free and voluntary act of said corporation, for the uses and purposes therein set forth.

Given under my hand and official seal, this 28th day of December, 1989.



Notary Public

Commission Expires: _____, 19__

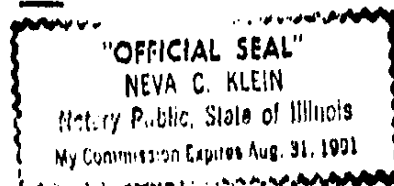

Property of Cook County Clerk's Office

83022701

UNOFFICIAL COPY

8 9 6 2 2 7 6 1
EXHIBIT "A"

.. COOK COUNTY, ILLINOIS

LOTS 22 TO 47 AND THE WEST 9 FEET OF LOT 48 AND THAT PART OF LOT 51 LYING WEST AND NORTHEASTERLY OF THE FOLLOWING DESCRIBED LINE: BEGINNING AT A POINT IN THE COMMON RIGHT-OF-WAY LINE OF THE CHICAGO SOUTH SHORE AND SOUTH BEND RAILROAD AND THE INDIANA HARBOR BELT RAILROAD, 66.00 FEET WEST OF THE INDIANA-ILLINOIS STATE LINE AND 29.58 FEET SOUTH OF THE INTERSECTION OF THE SOUTH LINE OF COSTLIN STREET (PRODUCED) AND SAID RIGHT-OF-WAY LINE, SAID POINT ALSO BEING 39.20 FEET WEST OF THE CENTER LINE OF MAIN TRACT OF THE INDIANA HARBOR BELT RAILROAD; THENCE WITH THE SAID RIGHT-OF-WAY LINE, 66.00 FEET FROM AND PARALLEL TO SAID STATE LINE, DOE SOUTH 184.27 FEET TO THE CHICAGO AND WESTERN INDIANA RAILROAD RIGHT-OF-WAY LINE; THENCE ALONG THE CHICAGO AND WESTERN INDIANA RAILROAD RIGHT-OF-WAY LINE NORTH 59 DEGREES 00 MINUTES WEST, 146.20 FEET TO THE NORTH WEST CORNER OF SAID LOT 51 ALL IN J. WILLIAM ESCHENBERG'S STATE LINE ADDITION TO HEGEWISCH IN THE SOUTH 1/2 OF THE SOUTH EAST FRACTIONAL 1/4 OF SECTION 5, TOWNSHIP 36 NORTH, RANGE 15 EAST OF THE THIRD PRINCIPAL MERIDIAN, LYING NORTH EAST OF THE CHICAGO AND WESTERN INDIANA RAILROAD, IN COOK COUNTY, ILLINOIS. (EXCEPT THE PART THEREOF FALLING WITHIN THE SOUTHWESTERLY 50 FEET OF LOTS 37 AND 38 AFORESAID) AND (EXCEPT THE PART THEREOF FALLING WITHIN THE REAR 16 FEET OF LOTS 42 AND 43 AFORESAID.)

THE SOUTH AND SOUTHWESTERLY 1/2 OF VACATED HOWARD AVENUE LYING NORTH AND NORTHEASTERLY OF AND ADJOINING LOTS 22 TO 47 AND THE WEST 9 FEET OF LOT 48 IN J. WILLIAM ESCHENBERG'S STATE LINE ADDITION TO HEGEWISCH IN THE SOUTH 1/2 OF THE SOUTH EAST FRACTIONAL 1/4 LYING NORTH EAST OF THE CHICAGO AND WESTERN INDIANA RAILROAD, IN COOK COUNTY, ILLINOIS.

69522761

UNOFFICIAL COPY

8 9 6 2 2 7 6 1

EXHIBIT A

THAT PART OF THE NORTH EAST 1/4 OF SECTION 36, TOWNSHIP 37 NORTH, RANGE 14 EAST OF THE THIRD PRINCIPAL MERIDIAN LYING WEST OF THE WESTERLY LINE OF THE NEW YORK CHICAGO AND ST. LOUIS RAILROAD RIGHT OF WAY AND NORTH OF THE NORTH LINE OF THE KENSINGTON AND EASTERN RAILROAD COMPANY PROPERTY (EXCEPT THE NORTH 50 FEET FROM 130TH STREET) IN COOK COUNTY, ILLINOIS.

25-36-100-018

Property of Cook County Clerk's Office

89622761

A-2

UNOFFICIAL COPY

3 9 5 2 2 7 8 1

LAKE COUNTY, INDIANA

All of the remaining right-of-way and property of Chicago South Shore and South Bend Railroad's main line that extends in a generally westerly direction on, over and across portions of Lake County, Indiana, said right-of-way varying in width and irregular shape includes any and all trackage, buildings, fences, culverts, bridges and trestles as well as all other railroad-owned improvements and fixtures situated thereon and is described as follows:

Begin at a point where the center of the main track of said line of railroad intersects the common "Lake County-Porter County" county line at railroad mile post 52.59, and run westerly along said line of railroad a distance of 16.61 miles across Section 33, Township 37 North, Range 7 West of the Second Principal Meridian; Sections 4, 5 and 6 in Township 36 North, Range 7 West of the Second Principal Meridian; Sections 1, 2, 3, 4, 5, and 6, Township 36 North, Range 8 West of the Second Principal Meridian; Sections 1, 2 and 3 of Township 36 North, Range 9 West of the Second Principal Meridian; Sections 35, 34, 33, 32, 31 and 30, Township 37 North, Range 9 West of the Second Principal Meridian; Section 25, Township 37 North, Range 10 West of the Second Principal Meridian to the common "Lake County, Indiana-Cook County, Illinois" county and state line at milepost 69.19, including railroad property in Gary, East Chicago and Hammond, Indiana, including all adjacent parcels of real estate more particularly described below.

Clerk's Office

89622701

UNOFFICIAL COPY

8 9 6 2 2 7 6 1

That part of the Northeast Quarter of Section 2, Township 36 North, Range 9 West of the 2nd P.M., lying Northerly of the Southerly right of way line of the Chicago, South Shore and South Bend Railroad conveyed to said railroad by deed recorded on July 28, 1911 in Deed Record 172, page 100, and Southerly of the Southerly line of the property falling in the Northeast Quarter of said Section 2, Township 36 North, Range 9 West of the 2nd P.M., conveyed to the State of Indiana by deed recorded January 10, 1979 as Document No. 512013, and West of the West Line of the alley East of Fairbanks Street, Alley No. 67 West, as shown on the Plat of Gary Estates Seventh Addition, shown in Plat Book 18, page 8), projected North, excepting from all of the above, that part thereof described as Parcel 3, in the deed to the State of Indiana recorded February 16, 1983 as Document No. 697417, in Lake County, Indiana.

That part of the East Half of Section 2, Township 36 North, Range 9 West of the 2nd P.M., in Lake County, Indiana, described as follows: Beginning at the point of intersection of the North line of West Fifth Avenue, as marked and laid down on the recorded plat of Gary City Estates Seventh Addition to the City of Gary, as recorded in Plat Book 18, page 8, in the Office of the Recorder of Lake County, Indiana, with the East Right of Way line of the Elgin, Joliet and Eastern Railroad, thence North along the East Right of Way line of said railroad to the point of its intersection with the South Right of Way line of the Chicago, South Shore and South Bend Railroad, thence in a Southeasterly direction along the South Right of Way line of the Chicago, South Shore and South Bend Railroad to a point on said Right of Way line where the West line of Alley No. 67 West, as marked and laid down on said recorded plat, would intersect said Right of Way if extended; thence South along the West line of alley No. 67 West to a point where it intersects the North line of West Fourth Avenue; thence West along the North line of West Fourth Avenue to a point where it intersects the West line of Fairbanks Street; thence South along the West line of Fairbanks Street to a point where it intersects the North line of West Fifth Avenue; thence West along the North line of West Fifth Avenue to the place of beginning, excepting therefrom that part conveyed to Northern Indiana Public Service Company by deed recorded February 21, 1938 in Deed Record 1081, page 95.

All that part of the Southeast Quarter of Section 33, Township 37 North, Range 9 West of the 2nd P.M., in Lake County, Indiana, lying Northerly of the Northerly line of Indiana Toll Road described in the deed recorded January 18, 1979, as Document No. 511999 and lying East of the East line of Kennedy Avenue (as it presently exists), and Southerly and Southwesterly of the Southerly line of Grand Calumet River EXCEPTING from all of the above that part thereof conveyed to Harbison-Walker Refractories Co., a corporation, conveyed in the deed recorded in Deed Record 1037, page 313, on August 17, 1956 and in Deed recorded in Deed Record 1039, page 353, on May 14, 1957.

All that part of the Southwest Quarter of Section 34, Township 37 North, Range 9 West of the 2nd P.M., in Lake County, Indiana, lying Northerly of the Northerly line of Indiana Toll Road described in deed recorded January 18, 1979, as Document No. 511999, and lying Southerly and Southwesterly of the center line of the channel of Grand Calumet River (as it presently exists and as relocated, as shown in deed from Indiana Toll Road Commission to the Chicago South Shore and South Bend Railroad, recorded February 20, 1973, as Document No. 289036) EXCEPTING from all of the above that part of the Southwest quarter in said Section 34 conveyed to George J. Boemstarboer, Inc., an Indiana Corporation, by Parcel 1 of deed recorded January 1, 1982 as Document No. 633197.

6969201

UNOFFICIAL COPY

8 9 5 2 2 7 6 1

LAPORTE COUNTY, INDIANA

All of the remaining right-of-way and property of Chicago South Shore and South Bend Railroad's main line that extends in a generally westerly direction on, over and across portions of LaPorte County, Indiana, said right-of-way varying in width and irregular in shape includes any and all trackage, buildings, fences, culverts, bridges and trestles, as well as all other railroad-owned improvements and fixtures situated thereon, and is described as follows:

Begin at the point where the center of the main track of said line of railroad intersects the common "LaPorte County-St. Joseph County" county line at railroad mile post 14.56, and run westerly along said line of railroad a distance of 21.56 miles across Sections 28, 29 and 30 of Township 38 North, Range 1 West of the Second Principal Meridian; Sections 25, 26, 27, 28, 29 and 30 of Township 38 North, Range 2 West to the Second Principal Meridian; Sections 25, 26, 27, 28, 29, and 30 of Township 38 North, Range 3 West of the Second Principal Meridian; Sections 25, 26, 27, 28, 29, 30, 31 and 32 in Township 38 North, Range 4 West of the Second Principal Meridian to the common "LaPorte County-Porter County" county line, being the west line of said Section 31, T38N, R4W; at railroad mile post 36.02; including Chicago South Shore and South Bend Railroad's Lincoln Avenue yard lead and all properties of Chicago South Shore and South Bend Railroad in Hudson Lake and Michigan City, Indiana and the interest of Chicago South Shore and South Bend Railroad in an indeterminate permit to run trains through the streets of Michigan City, Indiana and including those parcels of real property more particularly described below.

Recorder's Office

89522761

UNOFFICIAL COPY

8 9 5 2 2 7 6 1

All that part of the West Half (W 1/2) of the Southeast Quarter (SE 1/4) of Section Twenty-five (25), Township Thirty-eight (38) North, Range Four (4) West, that lies South of the right-of-way of the Chicago, South Shore and South Bend Railway Company, EXCEPTING Thirty (30) acres off the South end thereof; ALSO EXCEPTING therefrom, so much of said real estate, upon the Westerly side thereof as was taken for the purpose of constructing U.S. Route No. 212, containing Forty (40) acres, more or less, in LaPorte County, Indiana.

ALSO EXCEPT:

A Two and Sixty-six thousandths (2.066) acre tract in the Southeast Quarter (SE 1/4) of Section Twenty-five (25), Township Thirty-eight (38) North, Range Four (4) West, LaPorte County, Indiana, more fully described as follows: Commencing at the South Quarter (S 1/4) corner of said Section Twenty-five (25); thence North One degree Fourteen minutes West (N 1° 14' W) along the North and South centerline of said Section Twenty-five (25), a distance of Nine Hundred Ninety (990) feet; thence South Eighty-nine degrees Nineteen minutes East (S 89° 19' E) a distance of Forty-eight and Thirty-five hundredths (48.35) feet to the place of beginning for the following description; thence North One degree Twenty-three minutes West (N 1° 23' W) a distance of Three Hundred (300) feet; thence South Eighty-nine degrees Nineteen minutes East (S 89° 19' E) a distance of Three Hundred (300) feet; thence South One degree Twenty-three minutes East (S 1° 23' E) a distance of Three Hundred (300) feet; thence North Eighty-nine degrees Nineteen minutes West (N 89° 19' W) a distance of Three Hundred (300) feet to the place of beginning.

ALSO EXCEPT:

A tract in the Southeast Quarter (SE 1/4) of Section Twenty-five (25), Township Thirty-eight (38) North, Range Four (4) West, LaPorte County, Indiana, more fully described as follows: Commencing at the South Quarter (S 1/4) corner of said Section Twenty-five (25); thence North One degree Fourteen minutes West (N 1° 14' W) along the North and South centerline of said Section Twenty-five (25) a distance of Nine Hundred Ninety (990) feet; thence South Eighty-nine degrees Nineteen minutes East (S 89° 19' E) a distance of Three Hundred Forty-eight and Thirty-five hundredths (348.35) feet; thence North One degree Twenty-three minutes West (N 1° 23' W) a distance of Fifty (50) feet to the place of beginning for the following description; thence North One degree Twenty-three minutes West (N 1° 23' W) a distance of Two Hundred Fifty (250) feet; thence South Eighty-nine degrees Nineteen minutes East (S 89° 19' E) a distance of Sixty (60) feet; thence South One degree Twenty-three minutes East (S 1° 23' E) a distance of Two Hundred Fifty (250) feet; thence North Eighty-nine degrees Nineteen minutes West (N 89° 19' W) a distance of Sixty (60) feet to the place of beginning, containing Three Hundred Forty-four thousandths (0.344) acres, more or less.

ALSO EXCEPT:

That part of the West Half (W 1/2) of the Southeast Quarter (SE 1/4)

of Section Twenty-five (25), Township Thirty-eight (38) North, Range Four (4) West, LaPorte County, Indiana, bounded and described as follows: Commencing at the South Quarter corner of said Section; thence North One degree Fourteen minutes West (N 1° 14' W) on the North and South centerline of said Section a distance of Nine Hundred Ninety (990.00) feet; thence South Eighty-nine degrees Nineteen minutes East (S 89° 19' E) a distance of Six Hundred Ninety-seven and Twelve hundredths (697.12) feet to the principal point of beginning of this description; from said principal point of beginning thence North Zero degrees Forty-six minutes West (N 0° 46' W) a distance of Two Hundred Eighty-eight and Forty-four hundredths (288.44) feet to a point on a curve; thence Northeasterly on a curve to the left having a radius of Four Hundred Thirty-five and Twenty-eight hundredths (435.28) feet (the long chord of which lies North Twenty-seven degrees Five minutes Fifty-seven and Five tenths seconds East (N 27° 5' 57.5" E) Four Hundred Six and Ninety hundredths (406.96) feet) a distance of Four Hundred Thirty-two and Eleven hundredths (432.11) feet; thence North Zero degrees Forty-six minutes West (N 0° 46' W) a distance of Four Hundred Twenty (420.00) feet to a point of curve; thence Northeasterly on a curve to the right having a radius of Four Hundred Fifty-three and Thirty-four hundredths (453.34) feet (the long chord of which lies North Seventeen degrees Fifty-two minutes Fifty and Five tenths seconds East (N 17° 52' 50.5" E) Two Hundred Eighty-nine and Ninety hundredths (289.90) feet) a distance of Two Hundred Ninety-five and Nine hundredths (295.09) feet; thence South Eighty-nine degrees Nineteen minutes East (S 89° 19' E) a distance of Three Hundred Forty-two and Three hundredths (342.03) feet to the East line of the West Half (W 1/2) of the Southeast Quarter (SE 1/4) of said Section; thence South Zero degrees Forty-six minutes East (S 0° 46' E) on said East line a distance of One Thousand Three Hundred Fifty (1350.00) feet; thence North Eighty-nine degrees Nineteen minutes West (N 89° 19' W) a distance of Six Hundred Twenty-five (625.00) feet to the principal point of beginning, containing Fourteen and Seven Hundred Sixty-two thousandths (14.762) acres, more or less.

ALSO EXCEPT:

That part of the West Half (W 1/2) of the Southeast Quarter (SE 1/4) of Section Twenty-five (25), Township Thirty-eight (38) North, Range Four (4) West, LaPorte County, Indiana, bounded and described as follows: Commencing at the South Quarter corner of said Section; thence North One degree Fourteen minutes West (N 1° 14' W) on the North and South centerline of said Section, a distance of Nine Hundred Ninety (990.00) feet; thence South Eighty-nine degrees Nineteen minutes East (S 89° 19' E) a distance of Forty-eight and Thirty-five hundredths (48.35) feet to the principal point of beginning of this description; from said principal point of beginning, thence North One degree Twenty-three minutes West (N 1° 23' W) a distance of Fifty (50) feet; thence South Eighty-nine degrees Nineteen minutes East (S 89° 19' E) a distance of Six Hundred Forty-nine and Thirty-one hundredths (649.31) feet; thence South Zero degrees Forty-six minutes East (S 0° 46' E) a distance of Fifty (50) feet; thence North Eighty-nine degrees Nineteen minutes West (N 89° 19' W) a distance of Six Hundred Forty-eight and Seventy-seven hundredths (648.77) feet to the principal point of beginning, containing Seventy-five hundredths (0.75) acre, more or less.

Parcels of land situate in the Southwest Quarter (SW 1/4) of Section Twenty-seven (27), Township Thirty-eight (38) North, Range Four (4) West, in the City of Michigan City, LaPorte County, Indiana, more particularly described as follows:

A part of the Northeast Quarter (NE 1/4) of the Southwest Quarter (SW 1/4) of Section Twenty-seven (27), Township Thirty-eight (38) North, Range Four (4) West, being a strip of land Eighty (80) feet in width taken from South side of lands of grantors, and bounded and described as follows: Beginning at the Southwest corner of the Northeast Quarter (NE 1/4) of the Southwest Quarter (SW 1/4) of said Section; thence East on the South line of said Quarter-Quarter Section a distance of Ten Hundred Twenty-six (1026) feet; thence North Eighty (80) feet; thence West parallel to the South line of said Quarter-Quarter Section a distance of Ten Hundred Twenty-six (1026) feet to the West line of said Quarter-Quarter Section; thence South Eighty (80) feet to the place of beginning, EXCEPTING therefrom the right of way of the Lake Erie and Western Railroad, and ALSO EXCEPTING all of said strip lying Westerly of the Lake Erie and Western Railroad Company right of way.

ALSO:

All that portion of the Northwest Quarter (NW 1/4) of the Southeast Quarter (SE 1/4) of the Southwest Quarter (SW 1/4) lying North of the Northeasterly right of way line of the Lake Erie & Western Railway, containing Seventeen hundredths (.17) acre, more or less.

ALSO:

A part of the Northeast Quarter (NE 1/4) of the Southwest Quarter (SW 1/4) of Section Twenty-seven (27), Township Thirty-eight (38) North of Range Four (4) West, being a strip Eighty (80) feet in width off of the South end of grantors land; said strip lies immediately North of and adjacent to the East and West Eighty (80) rod line in the Southwest Quarter (SW 1/4) of said Section Twenty-seven (27) and contains Sixty hundredths (.60) acre, more or less.

ALSO:

A strip of land Three Hundred (300) feet in width through a part of the Northeast Quarter (NE 1/4) of the Southwest Quarter (SW 1/4) of Section Twenty-seven, Township Thirty-eight (38) North, Range Four (4) West, said part being bounded as follows: Beginning at the Northeast corner of said tract and running thence South Eighty (80) rods; thence West Twenty (20) rods; thence North Eighty (80) rods; thence East to the place of beginning, said strip being the North Three Hundred (300) feet in width off of the South Three Hundred Sixty-six (366) feet taken off of and from the South side of said described part.

ALSO:

A parcel of land in the Northeast Quarter (NE 1/4) of the Southwest Quarter (SW 1/4) of Section Twenty-seven (27), Township Thirty-eight (38) North, Range Four (4) West, described as follows: Beginning at the Southeast corner of said Northeast Quarter (NE 1/4) of the Southwest Quarter (SW 1/4); thence West on South line of said Quarter, Three Hundred Thirty (300) feet; thence North Eighty (80) feet to a starting point for this description; thence from above described

89022751

starting point running West on a line parallel with the South line of the Northeast Quarter (NE 1/4) of the Southwest Quarter (SW 1/4) Six Hundred Eighteen (618) feet, more or less, to the Northeasterly right of way of the Lake Erie and Western Railway; thence Northwest-erly along said right of way Four Hundred Sixty (460) feet, more or less, to the East line of Carroll Avenue as laid out in Orchard Grove Addition; thence North along the East line of Carroll Avenue to a point on the East line of Carroll Avenue that is Three Hundred Ninety-six (396) feet North of the South line of the Northeast Quarter (NE 1/4) of the said Southwest Quarter (SW 1/4); thence East parallel with said South line to a point that is Three Hundred Thirty (330) feet West of the East line of said Southwest Quarter (SW 1/4); thence South Three Hundred Sixteen (316) feet to the place of beginning, containing Six and Twenty-four hundredths (6.24) acres, more or less.

ALSO:

One Hundred Forty (140) feet off of the North side of the Northeast Quarter (NE 1/4) of the Southeast Quarter (SE 1/4) of the Southwest Quarter (SW 1/4) of Section Twenty-seven (27), Township Thirty-eight (38) North, Range Four (4) West, EXCEPT so much thereof as is within the right-of-way of the Lake Erie and Western Railway Company, containing Two and One tenth (2.1) acres, more or less.

ALSO:

A part of the Northeast Quarter (NE 1/4) of the Southwest Quarter (SW 1/4) of Section Twenty-seven (27), Township Thirty-eight (38) North, Range Four (4) West, described as follows: Beginning at a point on the East line of the Northeast Quarter (NE 1/4) that is Nine Hundred Twenty-four (924) feet South of the center of said Section Twenty-seven (27); thence running South Thirty (30) feet; thence West Three Hundred Thirty (330) feet; thence North Thirty (30) feet; thence East Three Hundred Thirty (330) feet to the place of beginning, containing Twenty-three hundredths (.23) acre, more or less.

ALSO:

Commencing at the intersection of the East line of the Southwest Quarter (SW 1/4) of Section Twenty-seven (27), Township Thirty-eight (38) North, Range Four (4) West, LaPorte County, Indiana, with the Northerly line of the right-of-way of the Lake Erie and Western Railroad Company; thence running North along and upon said East line of the Southwest Quarter (SW 1/4) of said Section Twenty-seven (27) a distance of Two Hundred Seventy-nine and Four tenths (279.4) feet for the place of beginning; thence West at right angles Two Hundred (200) feet; thence South at right angles One Hundred Forty and Fifty-eight hundredths (140.58) feet to the Northerly right-of-way line of the Lake Erie and Western Railroad; thence Northwesterly along and upon said Northerly right-of-way line of the Lake Erie and Western Railroad Four Hundred Seventy-five and Seventy-three hundredths (475.73) feet to the South right-of-way line of the Chicago, South Shore and South Bend Railroad; thence Easterly along and upon the Southerly right-of-way line of the Chicago, South Shore and South Bend Railroad Six Hundred One and Nine tenths (601.9) feet to the East line of the Southwest Quarter (SW 1/4) of said Section Twenty-seven (27); thence South along and upon said East line of the Southwest Quarter (SW 1/4) of Section Twenty-seven (27), Ninety-nine (99) feet to the place of beginning, containing One and Sixty-two hundredths (1.62) acres, more or less.

89622761

UNOFFICIAL COPY

8 9 6 2 2 7 6 1

Parcels of real estate situate in the Southeast Quarter (SE 1/4) of Section Twenty-seven (27), Township Thirty-eight (38) North, Range Four (4) West, in the City of Michigan City, LaPorte County, Indiana, more particularly described as follows:

A part of the Northwest Quarter (NW 1/4) of the Southeast Quarter (SE 1/4) of Section Twenty-seven (27), Township Thirty-eight (38) North, Range Four (4) West, being a strip of land One Hundred (100) feet in width through land of grantor, and lying Forty-three (43) feet wide upon the Northerly and Fifty-seven (57) feet wide upon the Southerly side of the centerline of the Chicago, Lake Shore & South Bend Railway Company's track as the same is now located and measured at right angles thereto, which centerline is described as follows: A tangent bearing North Eighty-five degrees West (N 85° 0' W) and crossing the East line of said Section Twenty-seven (27) at a point a distance of Eleven Hundred Forty-three (1143) feet North of said Section Twenty-seven (27); thence with said bearing a distance of Twenty-one Hundred Eighteen and Six tenths (2118.6) feet; thence on a Thirty minute (0° 30') curve to the left a distance of Ninety-six (96) feet to the South line of the grantors' land; thence continuing on said Thirty minute (0° 30') curve to the left a distance of Four Hundred Twenty-five (425) feet to the West line of grantors' land; containing Seventy-seven hundredths (.77) acres, more or less.

ALSO:

A part of the South Half (S 1/2) of the Southeast Quarter (SE 1/4) of Section Twenty-seven (27), Township Thirty-eight (38) North, Range Four (4) West, being a strip One Hundred (100) feet in width through lands of grantor, and lying Forty-three (43) feet wide upon the Northerly and Fifty-seven (57) feet wide upon the Southerly side of the center line of the Chicago, Lake Shore & South Bend Railway Company's track as the same is now located and measured at right angles thereto, which centerline is described as follows: A tangent bearing North Eighty-five degrees West (N 85° 0' W), and crossing the East line of said Section Twenty-seven (27) at a point Eleven Hundred Forty-three (1143) feet North of the Southeast corner of said Section; thence with said bearing into and upon grantors' land a distance of Twenty-one Hundred Eighteen and Six tenths (2118.6) feet; thence on a Thirty minute (0° 30') curve to left a distance of Ninety-five and one-half (95 1/2) feet to the North line of grantors' land, but continuing on said Thirty minute (0° 30') curve to left westwardly to the West line of said Southeast Quarter (SE 1/4) of Section Twenty-seven (27), containing Five and Nine hundredths (5.09) acres, more or less.

ALSO:

The South Half (S 1/2) of the Northeast Quarter (NE 1/4) of the Southeast Quarter (SE 1/4) of Section Twenty-seven (27), Township Thirty-eight (38) North, Range Four (4) West, containing Twenty (20) acres, more or less.

ALSO:

All that part of the South Half (S 1/2) of the Southeast Quarter (SE 1/4) of Section Twenty-seven (27), Township Thirty-eight (38) North, Range Four (4) West, which lies North of the right-of-way of the

9022761

Chicago, South Shore and South Bend Railroad, more particularly described as follows: Commencing at the Northeast corner of the South Half (S 1/2) of the Southeast Quarter (SE 1/4) of said Section Twenty-seven (27), and running thence South along the East line of said Section Twenty-seven (27), One Hundred Fifty-nine (159) feet to the Northerly line of the aforesaid right-of-way; thence in a Northwesterly direction along the said Northerly line of said right-of-way to its intersection with the North line of the South Half (S 1/2) of the Southeast Quarter (SE 1/4) of said Section Twenty-seven (27); thence East along said last named North line, a distance of Seventeen Hundred Seventy-five (1775) feet, more or less, to the place of beginning, containing Three and One-fifth (3 1/5) acres of land, more or less.

ALSO:

The Northwest Quarter (NW 1/4) of the Southeast Quarter (SE 1/4) of Section Twenty-seven (27) EXCEPTING the North Five Hundred (500) feet of said Northwest Quarter (NW 1/4) of said Southeast Quarter (SE 1/4), situated in Township Thirty-eight (38) North, Range Four (4) West of the Second Principal Meridian.

ALSO:

A strip of land Fifty (50) feet wide in the South Half (S 1/2) of the Southeast Quarter (SE 1/4) of Section Twenty-seven (27), Township Thirty-eight (38) North, Range Four (4) West, in the County of LaPorte, State of Indiana, described as follows:

Commencing at the intersection of the North-South centerline of said Section Twenty-seven (27) with the Southerly right-of-way line of the Chicago Lake Shore and South Bend Railway; thence along said Southerly right-of-way line in an Easterly direction Two Thousand Seventy-five (2075) feet, more or less, to the centerline of Trail Creek; thence Southerly along the centerline of Trail Creek to a point Fifty (50) feet Southerly of said Southerly right-of-way, measured at right angles thereto; thence Westerly along a line Fifty (50) feet Southerly of and parallel to said Southerly right-of-way line to the North-South centerline of Section Twenty-seven (27); thence Northerly along said centerline Fifty (50) feet, more or less, to the point of beginning, containing Two and Thirty-seven hundredths (2.37) acres, more or less.

69622761

UNOFFICIAL COPY

8 9 6 2 2 7 5 1

That portion of the Michigan City Branch of the former Louisville and Nashville Railroad Company lying all in LaPorte County, Indiana, and being partly within and partly south of the City of Michigan City, Indiana, commencing at the point where said Michigan City Branch crosses the north line of Kiefer Road at or about Rail Mile Post 55, plus 3,696 feet, being Railroad Valuation Station 2939+48, Cool Spring Township (T37N R4W) and extending northwardly to the end of said Branch at or in the vicinity of Rail Mile Post 60 plus 144 feet, being Railroad Valuation Station 3169+44, Michigan Township (T38N R4W); and being a part of the same property acquired by the Louisville and Nashville Railroad Company through merger between the Louisville and Nashville Railroad Company and the Monon Railroad Company on July 31, 1971, the Agreement of Merger recorded as Instrument No. 73-7730, and acquired by the Seaboard Coast Line Railroad Company through merger between the Seaboard Coast Line Railroad Company and the Louisville and Nashville Railroad Company, effective December 29, 1982, recorded as Instrument No. 83-00404 and name of the surviving company changed to Seaboard System Railroad, Inc., by virtue of name change effective December 29, 1982, recorded as Instrument No. 83-00404, all in the Office of the Recorder, LaPorte County, Indiana.

.. ..

89622761

UNOFFICIAL COPY

3 9 8 2 2 7 6 1

AND BEING in the following sections running from south to north:
West Half of West Half ($W\frac{1}{2}$ of $W\frac{1}{2}$), Section 8 Township 37 North, Range 4 West
West Half of West Half ($W\frac{1}{2}$ of $W\frac{1}{2}$), Section 5, Township 37 North, Range 4
West, West Half ($W\frac{1}{2}$) of Section 32, Township 38 North, Range 4 West, West
Half ($W\frac{1}{2}$) of Section 29, Township 38 North, Range 4 West, and the Northeast
Quarter ($NE\frac{1}{4}$) of Section 29, Township 38 North, Range 4 West, and as shown
and identified on copies of L&N Valuation Maps 14, S-15-A, S-15-A-1, S-15-B
and S-15-C, which are incorporated herein by reference, an Index or Line
Drawing of which is attached hereto as Schedule A and incorporated herein.

PROVIDED, however, that it is the intent of Seaboard to convey to
South Shore only the operating right of way and appurtenances thereto used
for the above-described line of railroad, and to retain and not to convey
certain parcels of non-operating property adjacent to or in the vicinity of
the operating right of way, THEREFORE EXCEPTING from this conveyance the nine
(9) parcels or tracts of land referred to as Tract Nos. 1 through 9, and as
shown shaded in red on copies of L&N Valuation Maps S-15-A, 15-A-1, S-15-B

69622761

UNOFFICIAL COPY

and S-15-C, attached hereto and made a part hereof, and being more particularly described as follows:

Tract #1

L&N Valuation Section 244, Map S-15-a, Parcels 3 and 5

An irregular shaped tract of land lying west of the Michigan City Branch in Michigan City, LaPorte County, Indiana, containing 2.18 acres, more or less, BEGINNING at a point in the Township Line between Cool Spring Township, T37N, R4W, and Michigan Township, T38N, R4W, said point being 50.0 feet, more or less, measured westwardly along said Township Line from the centerline of the Seaboard System Railroad's Michigan City Branch at Railroad Valuation Station 3047+57; thence southerly along a line 50.0 feet westerly from and parallel to the centerline of said Michigan City Branch, a distance of 800.0 feet, more or less, to a point opposite Railroad Valuation Station 3030+57; thence northwesterly a distance of 514.0 feet to a point 125.0 feet west and 300.0 feet south of said Township Line; thence westerly along a line 300.0 feet southerly from and parallel to said Township Line, a distance of 175.0 feet, more or less, to a point, said point being 300.0 feet westerly from and at right angles to the centerline of said Michigan City Branch; thence northerly along a line 300.0 feet westerly from and parallel to the centerline of said Michigan City Branch, a distance of 300.0 feet, more or less, to a point in said Township Line; thence easterly along said Township Line, a distance of 250.0 feet, more or less, to the point of BEGINNING; containing 2.18 acres, more or less.

TRACT #2

L&N VALUATION SECTION 244, Map S-15-A-1, Parcel 1

A parcel of land in the SW 1/4 of SW 1/4 of Section 32, T38N, R4W, in the City of Michigan City, LaPorte County, Indiana, BEGINNING at a point on the west line of said Section 32, which is 760.0 feet north, measured along said west line, from the southeast corner of said Section 32; thence north along the west line of said Section 32, a distance of 331.75 feet to the southeast corner of Lot 6 in Block 8 in Oakland's Addition to Michigan City, as per plat thereof, recorded in Plat Book 3, page 46, in the Office of the Recorder of LaPorte County, Indiana; thence North 89° 23' East, 741.7 feet to a point on the west right-of-way line of the Seaboard System Railroad Company, 50.0 feet west of the centerline of the Michigan City Branch and 47.7 feet west of the centerline of the connection track of The Chesapeake and Ohio Railway Company; thence southwesterly along a line 47.7 feet northwesterly from and parallel to the centerline of said The Chesapeake and Ohio Railway connection track 334.2 feet, more or less, being a chord or a curve convex to the southeast, to a point at the northeast corner of property now or formerly owned by Michael Mentag, which is 146.0 feet west of the centerline of the main track right of way of said Seaboard System Railroad Company; thence South 88° 48' West along the north line of said

89622761

UNOFFICIAL COPY

Mentag's property, 621.7 feet more (or less) to the point of BEGINNING; containing 5.69 acres, more or less.

TRACT #3

L&N VALUATION SECTION 244, Map 15-A-1, Parcel 2

A parcel of land in the SE 1/4 of Section 31, T38N, R4W, BEGINNING at a point on the east line of said SE 1/4 of Section 31, that is 36.0 feet north of a point on said line, and 85.0 rods and 5.0 links north of the southeast corner of said Section 31, said point being the intersection of the north line of Fractional Lot 6 in Fractional Block 7 of Oakland Addition to Michigan City, with the east line of aforesaid SE 1/4 of Section 31; thence running west along the north line of Fractional Block 7 and 6 in said Oakland Addition, a distance of 396.0 feet to the northwest corner of Fractional Lot 14 in aforesaid Fractional Block 6 for the actual place of BEGINNING; thence North 89° 6' 30" West, 200.0 feet, more or less, to the southeasterly line of the right of way of the Michigan City Railroad Company; thence South 47° 21' 30" West along said line, 320.0 feet to the north line of the right of way of the Northern Indiana Public Service Company; thence South 89° 6' 30" East, a distance of 383.33 feet to the west line of Lot 12, Block 9 of Oakland Addition to Michigan City; thence north a distance of 215.5 feet to the place of BEGINNING; containing 2.68 acres, more or less.

TRACT #4

L&N VALUATION SECTION 244A, Map 15-A-1, Parcel 3

An "L" shaped rectangular tract of land lying south of Westchester Court and north of Northern Indiana Public Service Company property at Michigan City, BEING the south 100.0 feet of Lots 1B, 2B, 3B, 4B, and 9B, and all of Lot 6B, of Block 1, Blair's Woodlawn Park Addition to Michigan City, in the SE 1/4 of Section 31, T38N, R4W; containing 1.06 acres, more or less.

TRACT #5

L&N VALUATION SECTION 244A, Map 15-A-1, Parcel 4

A rectangular tract of land lying south of Woodlawn Avenue and north of Westchester Court at Michigan City, BEING all of Lot 6-A, Block 1, Blair's Woodlawn Park Addition to Michigan City, in the SE 1/4 of Section 31, T38N, R4W, containing 0.44 acre, more or less.

TRACT #6

L&N VALUATION SECTION 244A, Map 15-A-1, Parcel 5

A rectangular tract of land lying south of Westchester Court and north of Northern Indiana Public Service Company property at Michigan City, BEING part of Lot 12-B in Block 1 in Blair's Woodlawn Park Addition to Michigan City, described as commencing at a point on the west line of said Block One (1), which is 420.0 feet south of the northwest corner of said Block One (1); thence North 85° 22 1/2' East on the south line of Westchester Court, 327.60 feet to the

69022761

UNOFFICIAL COPY

true point of BEGINNING; thence continuing North $85^{\circ} 22'$ East, 54.6 feet; thence South $0^{\circ} 3'$ West, 362.76 feet to the north line of the Northern Indiana Public Service Company property; thence west on the north line of the Northern Indiana Public Service Company property, a distance of 54.0 feet; thence North $0^{\circ} 3'$ East, 357.42 feet to the place of BEGINNING; EXCEPT THEREFROM that part described as beginning at the southwest corner of the above-described tract, and running thence South $89^{\circ} 6' 30''$ East, 33.49 feet; thence northwesterly along a $5^{\circ} 16'$ curve to the right, 33.69 feet; thence South $0^{\circ} 3'$ West, 6.8 feet to the place of BEGINNING; containing a net area of 0.42 acre, more or less.

TRACT #7

L&N VALUATION SECTION 244A, Map S-15-B, Parcel 2

An irregular shaped tract of land lying east of the centerline of the Seaboard System Railroad Company's Michigan City Branch at Michigan City, BEGINNING at a point on the east line of the W 1/2 of the NW 1/4 of Section 32, T35N, R4W, 1,191.5 feet south of the northeast corner of said W 1/2 of the NW 1/4 of said Section 32; thence south on the east line of said W 1/2 of the NW 1/4, a distance of 500.0 feet to a point; thence due west to a point 50.0 feet easterly from and at right angles to the centerline of the Michigan City Branch at Valuation Station 3086+98±; thence northerly along a line 50.0 feet easterly from and parallel to the centerline of said Michigan City Branch, a distance of 363.0 feet to a point; thence southeasterly a distance of 76.08 feet to the point of BEGINNING; containing 1.46 acres, more or less.

TRACT #8

L&N VALUATION SECTION 244, Map S-15-C, Parcels 15g, 15h, 15i, 15k, 15l, 35, 36 and 42

A rectangular shaped tract of land lying north of the Michigan City Branch, at Michigan City, BEGINNING at a point in the east line of Franklin Street, said point being in the northwest corner of Lot 6, Block 2, Elstons Survey of Michigan City, in the south line of vacated Front Street, thence eastwardly along the north line of said Block 2, along the south line of said Front Street, a distance of 455.0 feet, more or less, to a point in the west line of Lot 5, Block 1, Elstons Survey of Michigan City; thence eastwardly a distance of 415.0 feet, more or less, to a point in the west line of Lot 5, Block 41, Elstons Survey of Michigan City, 36.0 feet south of the northwest line of said Lot 5, Block 41; thence eastwardly a distance of 450.0 feet, more or less, to a point in the northwest corner of a tract of land conveyed to Citizens Bank of Michigan City by the Louisville and Nashville Railroad Company by deed dated May 4, 1978, said point being in the east line of Lot 9, Block 16, in Duncans Addition to Michigan City; thence south along the east line of said Lot 9, Block 16, and the west line of said conveyance dated May 4, 1978, a distance of 110.0 feet, more or less, to a point 20.0 feet northerly as measured along a radial line from a point in the centerline of the Michigan City Branch; thence westerly along a line

89022761

UNOFFICIAL COPY

8 9 6 2 2 7 6 1

20.0 feet northerly from and parallel to the centerline of said Michigan City Branch, a distance of 1,300.0 feet, more or less, to a point in the east line of Franklin Street, in the west line of Lot 6, Elstons Survey of Michigan City; thence northwardly along the east line of said Franklin Street and the west line of said Lot 6, a distance of 70.0 feet to the point of BEGINNING; containing 2.47 acres, more or less.

TRACT #9

L&N VALUATION SECTION 244, Map 8-15-C, Parcels 151, 151, 15m, 37, 38, 40, 41, 43, 44, 50

An irregular shaped tract of land lying south of the Michigan City Branch and north of Second Street in Michigan City, BEGINNING at a point in the north line of Second Street and the south line of Block 16, Duncan's Addition to Michigan City, said point being 30.0 feet westwardly from a point in the centerline of said Michigan City Branch at Station 3167+50, more or less, and 20.0 feet measured southwardly along a radial line from a point in the centerline of said Michigan City Branch; thence westerly along the north line of said Second Street and the south line of said Block 16, Duncan's Addition, a distance of 310.0 feet, more or less, to a point in the southwest corner of Lot 10, Block 16, Duncan's Addition and the southeast corner of Block 41, Elston's Survey; thence southwestwardly along the northwest line of said Second Street along the south line of Block 41, Elston's Survey, a distance of 300.0 feet, more or less, to a point in the southwest corner of Lot 8, Block 41, Elston's Survey, said point also being in the east line of Spring Street; thence northwesterly along the west line of said Lot 8, Block 41, Elston's Survey and the east line of said Spring Street, a distance of 70.0 feet, more or less, to a point; thence westwardly at right angles crossing over Spring Street and along the north line of Lot 9, Block 1, Elston's Survey, a distance of 240.0 feet, more or less, to a point; thence northerly at right angles a distance of 135.0 feet, more or less, to a point 20.0 feet measured southwardly along a radial line from a point in the centerline of said Michigan City Branch, at Rail Station 3157+75, more or less; thence easterly and southeasterly along a line 20.0 feet southerly and southwesterly from and parallel to the centerline of said Michigan City Branch, a distance of 900.0 feet, more or less, to the point of BEGINNING; containing 2.08 acres, more or less.

89622761

UNOFFICIAL COPY

8 9 6 2 2 7 6 1

EXHIBIT A

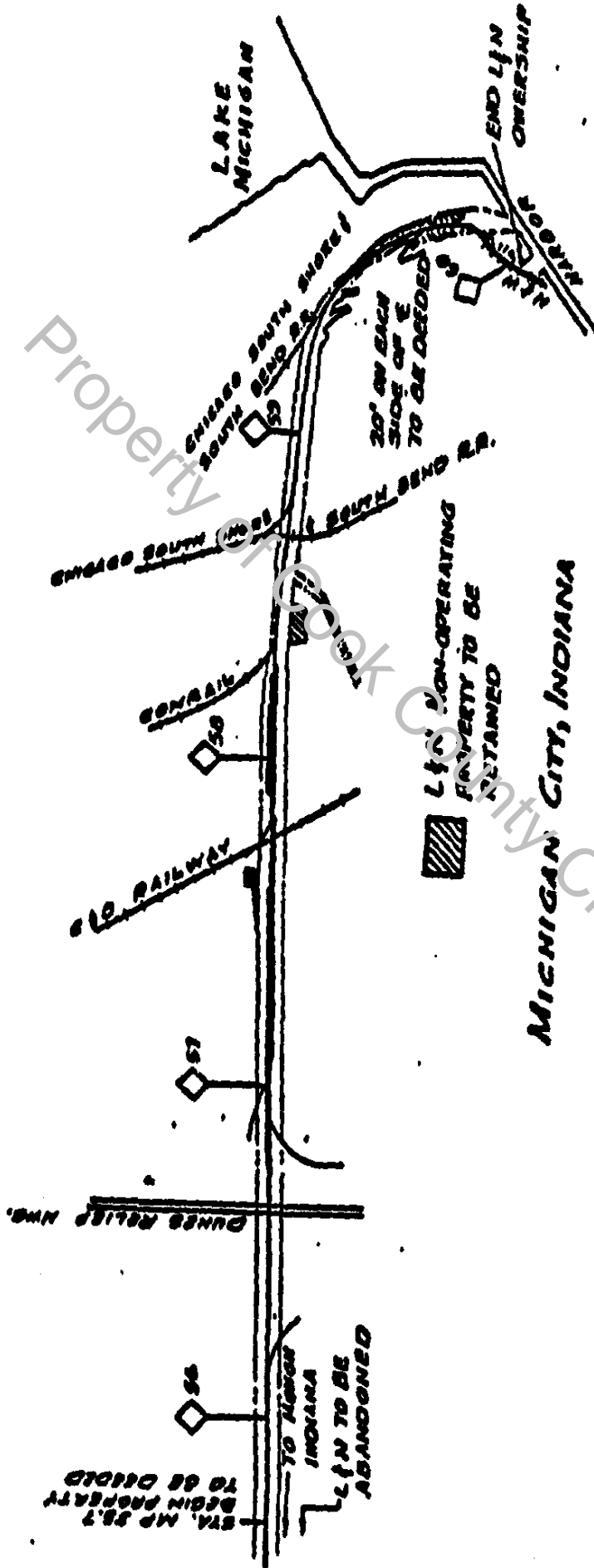

| | | | |
|---|--------|--|---------------|
| L&N PROPERTY PROPOSED TO BE DECEDED TO CHICAGO SOUTH SHORE SOUTH BEND R.R. | | A.V.P. ENGINEERING AND CHIEF ENGINEER | |
| L&N RAILROAD | | REVISIONS 5-AB-79 R.K.J. | |
| DRAWN | S.W.M. | SCALE | 1" = 1/2 mile |
| CHECKED BY | D.H.M. | DATE | MAY 23, 1961 |
| LETTERFILE | | SHEET | |

MICHIGAN CITY, INDIANA

1922269

UNOFFICIAL COPY

8 9 6 2 2 7 6 1

PORTER COUNTY, INDIANA

All of the remaining right-of-way and property of Chicago South Shore and South Bend Railroad's main line that extends in a general westerly direction on, over and across portions of Porter County, Indiana, said right-of-way varying in width and irregular in shape includes any and all trackage, buildings, fences, coverts, bridges and trestles as well as all other railroad-owned improvements and fixtures situated thereon, and is described as follows:

Begin at the point where the center of the main track of said line of railroad intersects the common "Porter County-LaPorte County" county line at railroad mile post 36.07, and run westerly along said railroad a distance of 16.56 miles across Section 36, Township 38 North, Range 5 West of the Second Principal Meridian; Sections 1, 2, 11, 10, 9, 16, 17, 18 and 19 of Township 37 North, Range 5 West of the Second Principal Meridian; Sections 24, 23, 26, 27, 28, 33, 32 and 31 of Township 37 North, Range 6 West of the Second Principal Meridian; Sections 36, 35, and 34 of Township 37 North, Range 7 West of the Second Principal Meridian, to the common "Porter County-Lake County" county line, being the west line of said Section 34 and mile post 52.58 of said line of railroad.

Porter County Clerk's Office
89622761

UNOFFICIAL COPY

8 9 6 2 2 7 6 1

EXHIBIT A

Included Parcel #1

[TRACT 100-05 - Johnson Sisters #1]

A tract of land situate in Section 27, Township 37 North, Range 6 West, Second Principal Meridian, Porter County, Indiana, described as follows:

Lots 9, 10, 11, 12, and 13 of Johnson Sisters Subdivision as shown on plat thereof recorded in Miscellaneous Record 10, Page 341 in the Office of the Recorder of Porter County, Indiana; also a tract of land in the NW 1/4 of Section 27 in said Township and Range described as follows:

Commencing at the intersection of the Northerly R/W line of U.S. Highway No. 12 and the East line of the West 1/2 of the East 1/2 of the NW 1/4 of said Section 27; thence along said East line North zero (0) degrees eight (8) minutes thirty-six (36) seconds East three hundred twenty-eight and eighty-nine hundredths (328.89) feet to the Southerly R/W line of the Chicago South Shore and South Bend Railroad; thence along said Southerly R/W line South sixty-seven (67) degrees forty-two (42) minutes twenty-one (21) seconds West five hundred ninety-three and ninety-one hundredths (593.91) feet to the East line of the West six and two-thirds (6-2/3) rods of the East 1/2 of the NW 1/4 of said Section 27 (said line also being the East line of Johnson Sisters Subdivision); thence along said East line South zero (0) degrees twenty (20) minutes twenty-one (21) seconds West three hundred thirty-seven and two tenths (337.2) feet to the Northerly R/W of U.S. No. 12; thence along said R/W line North sixty-four (64) degrees thirty-one (31) minutes thirty-six (36) seconds East three hundred thirteen and thirty-two hundredths (313.32) feet; thence continuing along said R/W line North sixty-nine (69) degrees forty-five (45) minutes eleven (11) seconds East two hundred eighty-five and fifty hundredths (285.50) feet to the point of commencement; also

That part of the East 1/2 of the NW 1/4 of Section 27, Township 37 North, Range 6 West of the Second P.M. in Porter County, Indiana lying South of the South R/W line of the Chicago South Shore and South Bend Railroad and North of the Northerly R/W line of U.S. Highway No. 12 except the East thirty-six and two-thirds (36-2/3) rods thereof.

Porter

UNOFFICIAL COPY

8 9 6 2 2 7 6 1

FD-15 (Rev. 5-22-64)

DATED _____

Said tract contains a total of 9.06 acres, more or less.

The above described Tract 100-05 is part of that land acquired by Chicago South Shore and South Bend Railroad by the following deeds:

| Grantor | Dated | Recorded | Book | Page |
|--|---------|----------|------|------|
| Melvin C. Christopherson | 6/27/68 | 7/3/68 | 228 | 553 |
| Theodore C. Edwards | 6/27/68 | 7/3/68 | 228 | 554 |
| Arthur Smith and Judith E. Smith, his wife | 6/27/68 | 7/3/68 | 228 | 555 |
| John Longlett, et al | 8/27/68 | 8/26/68 | 230 | 42 |
| Vernon C. Samuelson and Anna Samuelson, his wife | 5/28/68 | 5/31/68 | 228 | 101 |
| Leonard C. Johnson and Bertha Vernetta Johnson, his wife | 7/5/68 | 7/8/68 | 228 | 584 |

of the Porter County, Indiana records.

Porter

COPY 1 - ORIGINAL

89022761

DATED

INCLUDED PARCEL #2

[TRACT 100-07 - Johnson Sisters #2]

A tract of land situate in Section 27, Township 37 North, Range 6 West, Second Principal Meridian, Porter County, Indiana, described as follows:

Lots 1 through 6, both inclusive, of Johnson Sisters Subdivision as shown in Miscellaneous Record 10, Page 341, in the Office of the Recorder of Porter County, Indiana.

Also, a tract of land situate in the Northeast Quarter (NE 1/4) of Section 28, Township 37 North, Range 6 West, 2nd Principal Meridian, Porter County, Indiana described as follows:

Commencing at the Southeast (SE) corner of said Northeast Quarter (NE 1/4), thence North zero (0) degrees two (02) minutes eleven (11) seconds East along the East line of said Northeast Quarter (NE 1/4) two hundred forty-two and thirteen hundredths (242.13) feet to the point of beginning for said parcel, thence North zero (0) degrees two (02) minutes eleven (11) seconds East along said East line seventy-eight (78.0) feet to the Southerly right of way line of the Chicago South Shore and South Bend Railroad, thence South sixty-seven (67) degrees forty-two (42) minutes twenty-one (21) seconds West two hundred sixty-nine and eighty-three hundredths (269.83) feet along said Southerly right of way line, thence continuing along said Southerly right of way line along a curve to the left with a radius of five thousand six hundred eighty-two and sixty-five hundredths (5682.65) feet a chord distance of five hundred five and fifteen hundredths (505.15) feet and a chord bearing of South sixty-five (65) degrees nine (09) minutes thirty (30) seconds West to the South line of said Northeast Quarter (NE 1/4), thence South eighty-nine (89) degrees thirty-three (33) minutes East along the South line of said Northeast Quarter (NE 1/4) ninety-one and forty-nine hundredths (91.49) feet, thence Northeasterly along a curve to the right with a radius of five thousand six hundred seventy-nine and sixty-five hundredths (5679.65) feet a chord distance of six hundred sixty and sixty-two hundredths (660.62) feet and a chord bearing of North sixty-eight (68) degrees fifty-seven (57) minutes East to the point of beginning.

Said tract contains a total 5.25 acres, more or less.

Porter

89022761

UNOFFICIAL COPY

3 9 6 2 2 7 6 1

DATED _____

The above described Tract 100-07 is part of that land acquired by Chicago South Shore and South Bend Railroad by the following deeds:

| Grantor | Dated | Recorded | Book | Page |
|--|---------|----------|------|------|
| William Ahrendt and Omi H. Ahrendt, his wife | 3/25/68 | 3/27/68 | 226 | 525 |
| William J. Ahrendt and Omi H. Ahrendt, his wife | 3/25/68 | 3/27/68 | 226 | 524 |
| John Longlett, et al | 8/6/68 | 8/26/68 | 230 | 42 |
| Paul Nealon and Celia Nealon, his wife | 6/25/68 | 6/28/68 | 228 | 479 |
| Carmen Bartuch and Antoinette Bartuch, his wife | 8/19/68 | 8/29/68 | 230 | 92 |

of the Porter County, Indiana records.

89622761

UNOFFICIAL COPY

8 9 6 2 2 7 6 1

ST. JOSEPH COUNTY, INDIANA

All of the remaining right-of-way property of Chicago South Shore and South Bend Railroad's main line and right-of-way and additional property that extends in a general westerly direction on, over and across portions of St. Joseph County, Indiana, said right-of-way varying in width and irregular in shape includes any and all trackage, buildings, fences, culverts, bridges and trestles, as well as all other railroad-owned improvements and fixtures situated thereon, and is described as follows:

Begin at the west line of Olive Street in South Bend, Indiana, which is railroad mile post 1.69 run westerly along said line of railroad a distance of 12.77 miles across Sections 3, 4, 5, 6 and 10 of Township 37 North, Range 2 East of the Second Principal Meridian; Section 1, 2, and 3 of Township 37 North, Range 1 East to the Second Principal Meridian; Sections 34, 33, 32 and 31 of Township 38 North, Range 1 East to the Second Principal Meridian; Sections 36, 35, and 34 of Township 38 North, Range 1 West of the Second Principal Meridian; Section 27, Township 38 North, Range 1 West of the Second Principal Meridian to the "LaPorte County-St. Joseph County" common county line, being the west line of said Section 27 at mile post 12.46, including railroad property located at South Bend and New Carlisle, Indiana.

Also,

All of the remaining right-of-way and property of Chicago South Shore and South Bend Railroad's Airport Industrial Lead that extends in a generally northerly direction on, over and across portions of St. Joseph County, Indiana, said right-of-way varying in width and irregular in shape, includes any and all trackage, buildings, fences, culverts, bridges and trestles, as well as all other railroad-owned improvements and fixtures situated thereon, and is generally described as follows:

Begin at a point where the center line of said Airport Industrial Lead branches from railroad's main line at railroad mile post 3.18 being near the intersection of Fairview Avenue and a former right-of-way of Northern Indiana Railway, Inc. in Portage Township, St. Joseph County, Indiana and run a distance of _____ miles through Sections 4 and 3 of Township 37 North, Range 2

89622761

UNOFFICIAL COPY

8 9 6 2 2 7 6 1

- 2 -

East of the Second Principal Meridian; Sections 34, 33,
27 and 28 of Township 38 North, Range 2 East including
all spur and side tracks to the end of the existing
right-of-way.

Property of Cook County Clerk's Office

89622761