

90029814
UNOFFICIAL COPY

THIS INDENTURE, Made this 10th day of January 1990 between
LA SALLE NATIONAL BANK, a national banking association, Chicago, Illinois, as Trustee under the
provisions of a Deed or Deeds in Trust, duly recorded and delivered to said Bank in pursuance of a trust
agreement dated 10th day of June 1987, and known as Trust
Number 112401, party of the first part, and
FERDINAND P. GARZON, a beachelor party of the second part.

(Address of Grantee(s): 1121 Church Street, Evanston, IL 60201

PIN: 11-18-122-028-1002 1111 CHURCH STREET UNIT 202, EVANSTON, ILLINOIS 60201

WITNESSETH, that said party of the first part, in consideration of the sum of
TEN AND NO/100 ----- Dollars, (\$ 10.00) and other good and valuable
considerations in hand paid, does hereby grant, sell and convey unto said party of the second
part, the following described real estate, situated in Evanston County, Illinois, to wit:

UNIT NO. 202 AS DELINEATED ON THE SURVEY OF THE FOLLOWING
DESCRIBED PARCEL OF REAL ESTATE (HEREINAFTER REFERRED TO AS
"PARCEL"): LOTS 12 AND 13 IN BLOCK 2 IN ELIZA A. PRATT'S
ADDITION TO EVANSTON, A SUBDIVISION OF THE SOUTH WEST 1/4
OF THE NORTH WEST 1/4 EAST OF RIDGE ROAD AND WEST OF RAILROAD
IN SECTION 18, TOWNSHIP 41 NORTH, RANGE 14 EAST OF THE THIRD
PRINCIPAL MERIDIAN, WHICH SURVEY IS ATTACHED AS EXHIBIT "A"
TO DECLARATION MADE BY LASALLE NATIONAL BANK, A NATIONAL
BANKING ASSOCIATION, AS TRUSTEE UNDER TRUST AGREEMENT DATED
NOVEMBER 26, 1973 AND KNOWN AS TRUST NO. 46876, RECORDED IN
THE OFFICE OF THE RECORDER OF DEEDS OF COOK COUNTY, ILLINOIS
AS DOCUMENT 22596214, TOGETHER WITH AN UNDIVIDED 2.3228
INTEREST IN SAID PARCEL (EXCEPTING FROM SAID PARCEL ALL THE
PROPERTY AND SPACE COMPRISING ALL THE UNITS AS DEFINED AND
SET FORTH IN SAID DECLARATION AND SURVEY) ALL IN COOK COUNTY,
ILLINOIS.

and building and liquor restrictions or record; zoning and other regulatory laws
and ordinances; private public and utility easements; public roads and
highways; installments due after the date of closing of assessments due
after the date of closing of assessments established pursuant to the
Declaration of Condominium; covenants and restrictions of record as to
use and occupancy; party wall rights and agreements, if any; the mortgage
or trust deed, if any, as described in Paragraph 1 above, acts done or
suffered by or through the Purchaser; acts done or suffered by or through
party of the second part.

This Deed is executed pursuant to and in the exercise of the power and authority granted to and
vested in said Trustee by the terms of said Deed or Deeds in Trust delivered to said Trustee in pursuance
of the trust agreement above mentioned. This Deed is made subject to the lien of every Trust Deed
or Mortgage (if any there be) of record in said county affecting the said real estate or any part thereof
given to secure the payment of money and remaining unreleased at the date of the delivery hereof.

IN WITNESS WHEREOF, said party of the first part has caused its corporate seal to be hereto
affixed, and has caused its name to be signed to these presents by its Assistant Vice President and
attested by its Assistant Secretary, the day and year first above written.

ATTEST:

LaSalle National Bank
as Trustee as aforesaid.

Rosmary Allen
Assistant Secretary

By *[Signature]*
Assistant Vice President

This instrument was prepared by:
Roger J. Hymen
400 Skokie Bld. Ste 650
Northbrook, IL 60062

La Salle National Bank
Real Estate Trust Department
135 S. La Salle Street
Chicago, Illinois 60690

REI C 39178
RE TITLE GUARANTEE ORDER #

SEE REVERSE FOR STATE &
COUNTY REVENUE STAMPS.

14.00

Real Estate Transfer Tax \$50.00
CITY OF EVANSTON

90029814

Real Estate Transfer Tax \$50.00
CITY OF EVANSTON

90029814

Real Estate Transfer Tax \$50.00
CITY OF EVANSTON

Box 169

UNOFFICIAL COPY

STATE OF ILLINOIS }
COUNTY OF COOK } ss:

I, Martha Ann Brookins a Notary Public in and for said County,

in the State aforesaid, DO HEREBY CERTIFY that..... Joseph W. Lang

~~Assistant~~ Vice President of LA SALLE NATIONAL BANK, and Rosemary Collins

Assistant Secretary thereof, personally known to me to be the same persons whose names are subscribed to the foregoing instrument as such ~~Assistant~~ Vice President and Assistant Secretary respectively, appeared before me this day in person and acknowledged that they signed and delivered said instrument as their own free and voluntary act, and as the free and voluntary act of said Bank, for the uses and purposes therein set forth; and said Assistant Secretary did also then and there acknowledge that he as custodian of the corporate seal of said Bank did affix said corporate seal of said Bank to said instrument as his own free and voluntary act, and as the free and voluntary act of said Bank for the uses and purposes therein set forth.

GIVEN under my hand and Notarial Seal this 12th day of January A. D. 1990

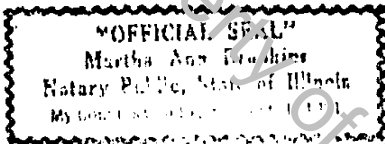

Martha Ann Brookins
NOTARY PUBLIC

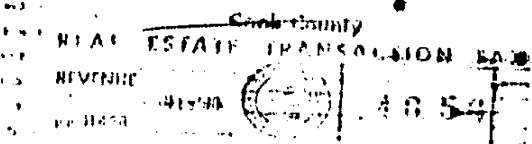
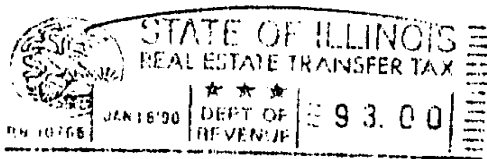

Box No.

TRUSTEE'S DEED

Address of Property
.....
.....

LaSalle National Bank
TRUSTEE
TO

LaSalle National Bank
135 South La Salle Street
CHICAGO, ILLINOIS 60690

8028-A CP (6-74)

MAIL TO: MARILYN KOCH
ATTORNEY AT LAW #1
1609 CHICAGO AVE #1
EVANSTON, IL 60201

Office of Cook County Clerk's Office
30003981
61862006

UNOFFICIAL COPY

Roger J. Hymen 400 Skokie Bld. Ste 650 Northbrook, Ill. 60062	La Salle National Bank Real Estate Trust Department 135 S. La Salle Street Chicago, Illinois 60690
---	---

This instrument was prepared by:

Assistant Vice President

Assistant Secretary

By *[Signature]*
 as Trustee as aforesaid
LaSalle National Bank

ATTEST:

IN WITNESS WHEREOF, said party of the first part has caused its corporate seal to be here to affixed, and has caused its name to be signed to these presents by its Assistant Vice President and attested by its Assistant Secretary, the day and year first above written.

This Deed is executed pursuant to and in the exercise of the power and authority granted to and vested in said Trustee by the terms of said Deed or Deeds in Trust delivered to said Trustee in pursuance of the trust agreement above mentioned. This Deed is made subject to the lien of every Trust Deed or Mortgage (if any there be) of record in said county affecting the said real estate or any part thereof given to secure the payment of money and remaining unreleased at the date of the delivery hereof.

TO HAVE AND TO HOLD the same unto said party of the second part as aforesaid and together with the tenants and appurtenances thereto belonging.

TO the proper use, benefit and behoof of said party of the second part forever.

SUBJECT TO: General taxes for 1989 and subsequent years; building lines and building and liquor restrictions of record; zoning and building laws and ordinances; private public and utility easements; public roads and highways; installations due after the date of closing of assessments due after the date of closing of assessments established pursuant to the Declaration of Condominium; covenants and restrictions of record as to use and occupancy; party wall rights and agreements. If any; the mortgage or trust deed, if any, as described in Paragraph 1 above, acts done or suffered by or through the purchaser; acts done or suffered by or through party of the second part.

TO HAVE AND TO HOLD the same unto said party of the second part as aforesaid and

together with the tenants and appurtenances thereto belonging.

90029814

CLERK OF COURT
COOK COUNTY, ILLINOIS

(SEE ATTACHED LEGAL DESCRIPTION)

THIS INDENTURE, Made this 10th day of June 1987, and known as Trust agreement dated 10th day of June 1987, and known as Trust provisions of a Deed or Deeds in Trust, duly recorded and delivered to said Bank in pursuance of a trust LA SALLE NATIONAL BANK, a national banking association, Chicago, Illinois, as Trustee under the

90029814

SEE REVERSE FOR STATE & COUNTY REVENUE STAMPS.

0 3111 121

183

15

City of Evanston
 Real Estate Transfer Tax
 \$400.00

City of Evanston
 Real Estate Transfer Tax
 \$300.00

State Transfer Tax
 \$5.00

90029814

UNOFFICIAL COPY

Box No.

TRUSTEE'S DEED

Address of Property

LaSalle National Bank
TRUSTEE
TO

LaSalle National Bank
135 South La Salle Street
CHICAGO, ILLINOIS 60690

6028-A CP (6-74)

MAIL TO: MARYLYN KACH

ATTORNEY AT LAW

1607 CHICAGO AVE #1

EVANSTON, IL 60201

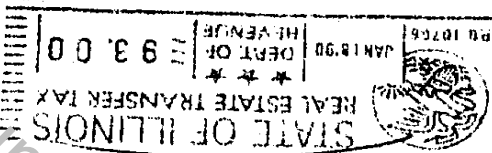
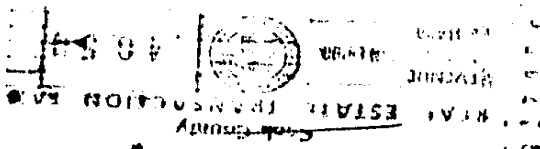
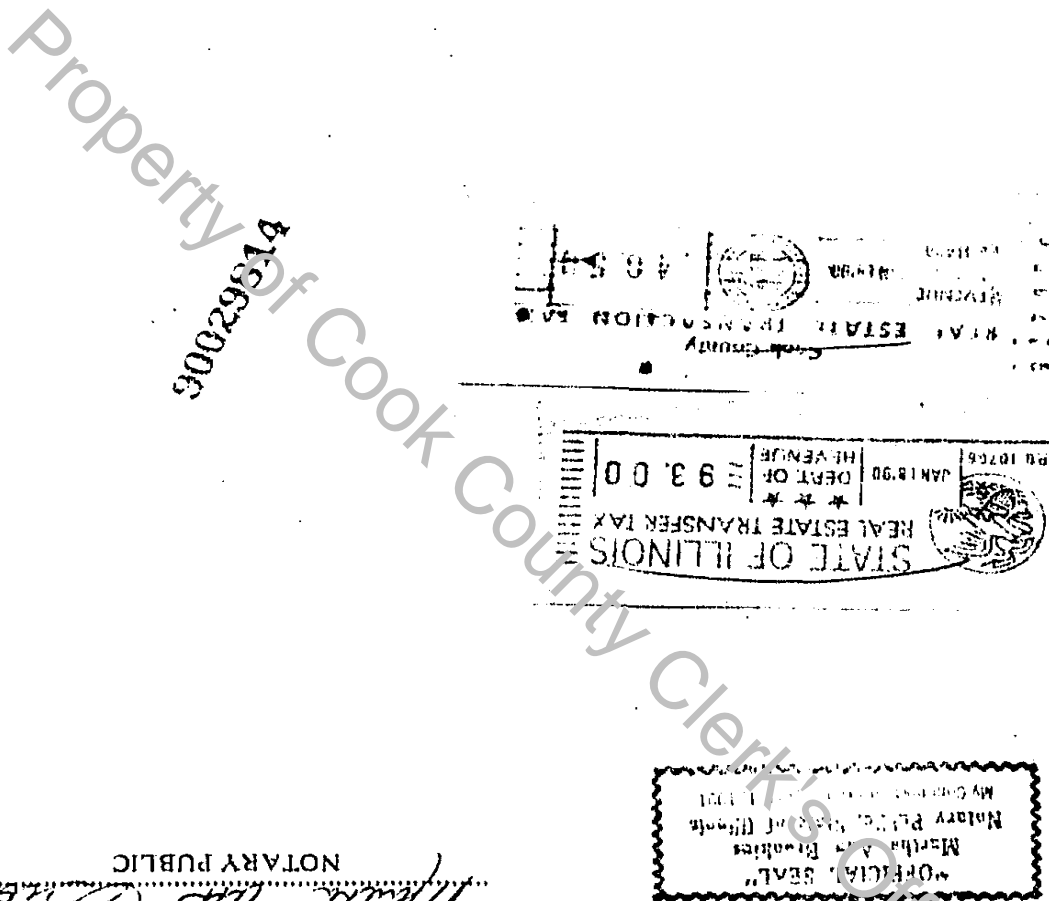

110644

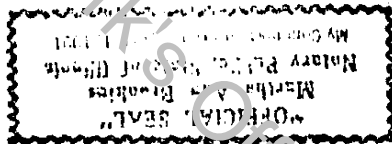

I, Martha Ann Broekling, a Notary Public in and for said County, in the State aforesaid, DO HEREBY CERTIFY that Joseph W. Lang Assistant Vice President of LA SALLE NATIONAL BANK, and Rosemary Collins Assistant Secretary thereof, personally known to me to be the same persons whose names are subscribed to the foregoing Instrument as such Assistant Vice President and Assistant Secretary respectively, appeared before me this day in person and acknowledged that they signed and delivered said Instrument as their own free and voluntary act, and as the free and voluntary act of said Bank, for the uses and purposes therein set forth; and said Assistant Secretary did also then and there acknowledge that he as custodian of the corporate seal of said Bank did affix said corporate seal of said Bank to said Instrument as his own free and voluntary act, and as the free and voluntary act of said Bank for the uses and purposes therein set forth.

GIVEN under my hand and Notarial Seal this 12th day of January, A. D. 1990

Martha Ann Broekling
NOTARY PUBLIC