

90040378

MARK E. WRABEL (COMMISSION EXP. 7-6-89)
Notary Public in and for said County and State

Mark E. Wrabel

On MARCH 15, 1989 before me MARK E. WRABEL and LUCILLE A. PRZYBYLA personally appeared AMY K. LOSI and LUCILLE A. PRZYBYLA personally known to me (or proved to me on the basis of satisfactory evidence to be the person(s) who executed the within instrument as VICE PRESIDENT and ASST. SECRETARY and acknowledged to me the corporation executed it.

STATE OF NEW YORK
COUNTY OF ERIE

BY
BY

AMY K. LOSI
VICE PRESIDENT
LUCILLE A. PRZYBYLA
ASST. SECRETARY

GOLDOME REALTY CREDIT CORP

dated MARCH 15, 1989
Property Address: 2740 NORTH PINE GROVE UNIT 17-B, CHICAGO, ILLINOIS, 60614
Together with the note or notes therein described or referred to, the money due and to become due thereon with interest, and all rights accrued or to accrue under said Real Estate Mortgage.

and recorded in Liber/cabinet _____ at page(s)/drawer _____ of document/instrument no. 86947540 microfilm # _____ of COOK County Illinois described hereinafter as follows:
PIN # 1-28-309-031-1036 ATTACHED

located at 2121 CRYSTAL DRIVE, ARLINGTON, VIRGINIA 22202
Estate Mortgage dated AUGUST 11, 1986, executed by JOSEPH SILVERTON AND YANN J. SILVERTON, HUSBAND AND WIFE
to GOLDOME REALTY CREDIT CORP.

FOR VALUE RECEIVED, GOLDOME REALTY CREDIT CORP., A MARYLAND CORPORATION located at 205 PARK CLUB LANE, BUFFALO, NY 14231-9000 hereby grants, assigns, and transfers to FEDERAL HOME LOAN MORTGAGE CORPORATION located at 2121 CRYSTAL DRIVE, ARLINGTON, VIRGINIA 22202 all the rights, title and interest of undersigned in and to that certain Real Estate Mortgage dated AUGUST 11, 1986, executed by JOSEPH SILVERTON AND YANN J. SILVERTON, HUSBAND AND WIFE

CORPORATION ASSIGNMENT OF REAL ESTATE MORTGAGE

WHEN RECORDED MAIL TO:
ONTRAK ASSIGNMENT SERVICE
6105 MAIN AVE SUITE 5
ORANGEVALE, CA 95662
90040378
ILLINOIS
COUNTY OF COOK (A)
LOAN NO 557506-1
POOL NO H186

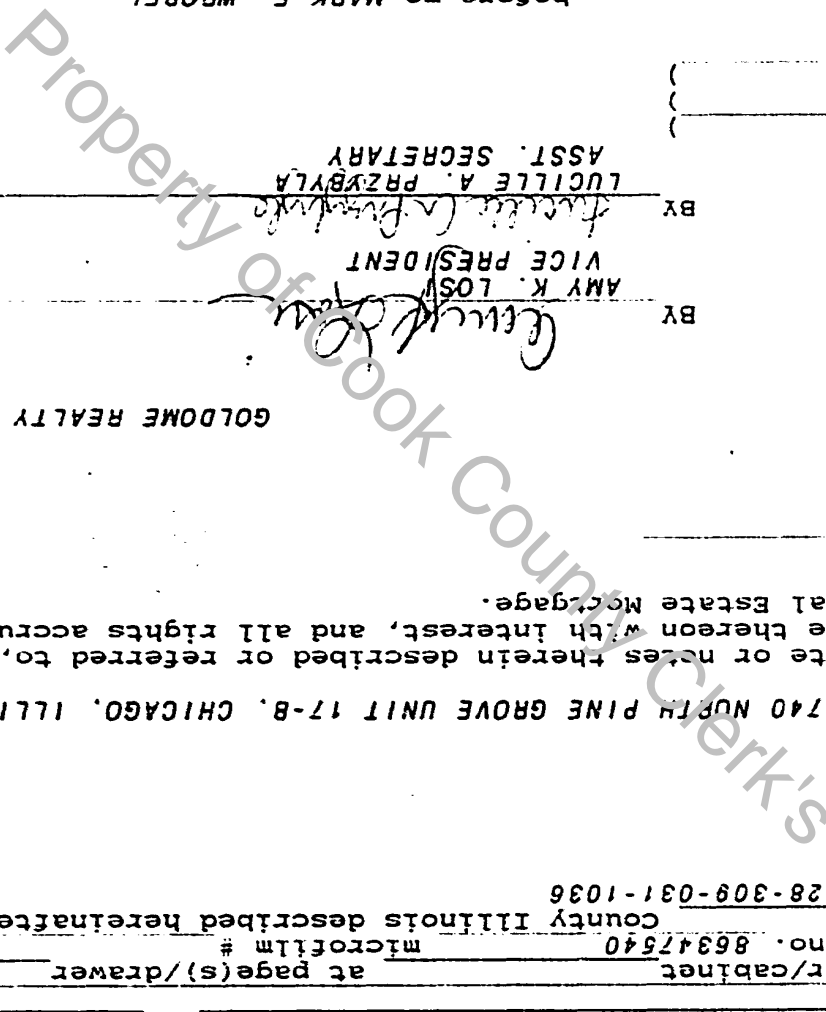

UNOFFICIAL COPY

011131358

Property of Cook County Clerk's Office

UNOFFICIAL COPY

Property of Cook County Clerk's Office

2011/11/10

UNOFFICIAL COPY

8 6 3 4 7 5 4 0
86347540

COOK COUNTY, ILLINOIS
FOR RECORD

1986 AUG 12 AM 9:46

86347540

557506-1
509
487-25

14⁰⁰

[Space Above This Line For Recording Data]

MORTGAGE

557506-1

THIS MORTGAGE ("Security Instrument") is given on AUGUST 11 19 86 The mortgagor is JOSEPH SILVERTON AND JANN J. SILVERTON, HUSBAND AND WIFE

("Borrower"). This Security Instrument is given to GOLDOME REALTY CREDIT CORP.

which is organized and existing under the laws of THE STATE OF MARYLAND, and whose address is 1 FOUNTAIN PLAZA BUFFALO, NEW YORK 14203 ("Lender").

Borrower owes Lender the principal sum of FORTY THOUSAND AND NO/100---

Dollar (U.S. \$ 40,000.00). This debt is evidenced by Borrower's note

dated the same date as this Security Instrument ("Note"), which provides for monthly payments, with the full debt, if not paid earlier, due and payable on SEPTEMBER 1, 2001. This Security Instrument secures to Lender: (a) the repayment of the debt evidenced by the Note, with interest, and all renewals, extensions and modifications; (b) the payment of all other sums, with interest, advanced under paragraph 7 to protect the security of this Security Instrument; and (c) the performance of Borrower's covenants and agreements under this Security Instrument and the Note. For this purpose, Borrower does hereby mortgage, grant and convey to Lender the following described property

located in: COOK County, Illinois: UNIT NUMBER 17-B IN PARKVIEW TOWERS CONDOMINIUM AS DELINEATED ON A PLAT OF SURVEY AS THE FOLLOWING DESCRIBED PARCEL OF REAL ESTATE: LOTS 56 AND 57 IN SUBDIVISION BY ANDREWS, SPOLFOED AND COLEHOUR OF BLOCKS 1 AND 2 OF OUTLOT A IN WRIGHTWOOD, SAID WRIGHTWOOD BEING A SUBDIVISION OF THE SOUTH WEST QUARTER OF SECTION 28, TOWNSHIP 40 NORTH, RANGE 14 EAST OF THE THIRD PRINCIPAL MERIDIAN, IN COOK COUNTY, ILLINOIS; ALSO LOT 11 IN LEHMAN'S DIVERSY BOULEVARD DIVISION IN THE SOUTH WEST QUARTER OF SECTION 28, TOWNSHIP 40 NORTH, RANGE 14 EAST OF THE THIRD PRINCIPAL MERIDIAN; WHICH PLAT OF SURVEY IS ATTACHED AS EXHIBIT "A" OF THE DECLARATION OF CONDOMINIUM MADE BY LA SALLE NATIONAL BANK AS TRUSTEE UNDER TRUST AGREEMENT DATED MAY 1, 1971 AND KNOWN AS TRACT NUMBER 42164 AND RECORDED AS DOCUMENT 25386511 ON MARCH 10, 1980, AND AMENDED AS DOCUMENT 25443765, RECORDED MAY 2, 1980 TOGETHER WITH UNDIVIDED PERCENTAGE IN COOK COUNTY, ILLINOIS.

Superior 9a OH/CHOL

14-28-309-031-1036 ml

RECEIVED
SEP 18 1986
10
10/10

90040378

which has the address of 2740 NORTH PINE GROVE UNIT 17-B CHICAGO (Street) (City)

Illinois 60614 ("Property Address"); (Zip Code)

TOGETHER WITH all the improvements now or hereafter erected on the property, and all easements, rights, appurtenances, rents, royalties, mineral, oil and gas rights and profits, water rights and stock and all fixtures now or hereafter a part of the property. All replacements and additions shall also be covered by this Security Instrument. All of the foregoing is referred to in this Security Instrument as the "Property."

BORROWER COVENANTS that Borrower is lawfully seized of the estate hereby conveyed and has the right to mortgage, grant and convey the Property and that the Property is unencumbered, except for encumbrances of record. Borrower warrants and will defend generally the title to the Property against all claims and demands, subject to any encumbrances of record.

THIS SECURITY INSTRUMENT combines uniform covenants for national use and non-uniform covenants with limited variations by jurisdiction to constitute a uniform security instrument covering real property.

86347540