

UNOFFICIAL COPY

4.23.90

Property of Cook County Clerk's Office

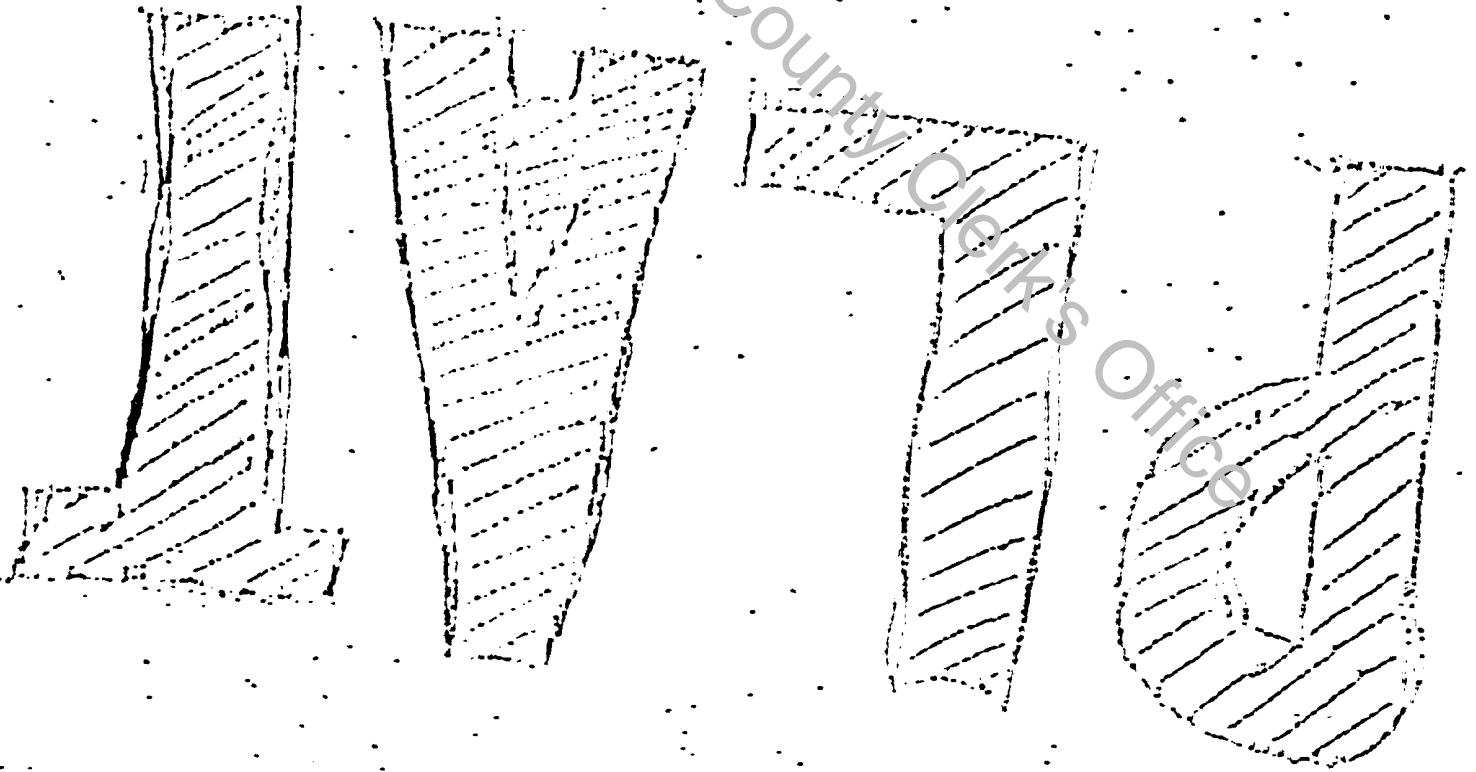

90183578

UNOFFICIAL COPY

Property of Cook County Clerk's Office

PLAT WITH DOCUMENT

UNOFFICIAL COPY

OFFICIAL BUSINESS

M. J. ...
To the ...

ORDINANCE NO. 119

90183578

AN ORDINANCE ANNEXING TO THE MIDLOTHIAN PARK DISTRICT, COOK COUNTY, ILLINOIS, PROPERTY WITHIN THE VILLAGE OF MIDLOTHIAN NOT PREVIOUSLY IN SAID PARK DISTRICT, WHICH PROPERTY IS DESCRIBED IN THIS ORDINANCE AND LIES WHOLLY WITHIN THE COUNTY OF COOK AND STATE OF ILLINOIS

WHEREAS, Section 3-10 of Chapter 105 of the Illinois Revised Statutes of 1985 provides that a Park District may annex by Ordinance all that territory within a City or Village in which said Park District operates; and

WHEREAS, the Commissioners of the Midlothian Park District Cook County, Illinois, have considered the question of the annexation of the territory hereinafter described and have determined that said territory is within the Village of Midlothian, Cook County, Illinois, and is contiguous to the territory of the Midlothian Park District of Cook County, Illinois, and that the residents thereof currently use the facilities of said Park District and will in the future use and need additional facilities in such areas for recreation and park purposes; and

WHEREAS, it is to the best interests of all of the residents of said Park District and to the best interests of the residents, the voters and owners of the territory hereinafter described to become a part of the Midlothian Park District.

NOW THEREFORE, BE IT ORDAINED BY THE COMMISSIONERS OF THE MIDLOTHIAN PARK DISTRICT:

SECTION 1

That the territory hereinafter described, said territory described in this Ordinance, and specifically by reference made a part hereof, which said territory being contiguous to the territory of the Midlothian Park District of Cook County, Illinois, and not within said Park District, or any other Park District, and within the provisions of Chapter 105, Section 3-10 of the Illinois Revised Statutes of 1985 be and the same is hereby annexed to the Midlothian Park District, Cook County, Illinois, in accordance with the provisions of said Chapter 105, Section 3-10 of the Revised Statutes of Illinois. The territory hereby annexed, as shown by the shaded areas on the maps hereto attached, which are made a part of this Ordinance, is known and described as follows, to wit:

ALL OF THE "OAKVIEW MANOR SUBDIVISION", (BEING A SUBDIVISION IN THE NORTHEAST 1/4 OF THE SOUTHEAST 1/4 OF SECTION 9, TOWNSHIP 36 NORTH, RANGE 13, EACH OF THE THIRD PRINCIPAL MERIDIAN, IN COOK COUNTY, ILLINOIS), AS PER PLAT THEREOF RECORDED IN THE OFFICE OF THE RECORDER OF DEEDS OF COOK COUNTY, ILLINOIS, ON AUGUST 6, 1987, AS DOCUMENT NO. 87435049, ALL IN COOK COUNTY, ILLINOIS

90183578

UNOFFICIAL COPY

Property of Cook County Clerk's Office

UNOFFICIAL COPY

00-183578

ORDINANCE NO. _____
Page 2

and which said tract of land above described and in the attached description is intended to be all in the territory within the Village limits of the Village of Midlothian not previously included within the Midlothian Park District.

SECTION 2

This Ordinance shall take effect and be in full force and effect from and after its passage and approval according to law and after filing of a certified copy of this Ordinance and the map attached hereto, in the Office of the Recorder of Deeds and Clerk of the Circuit Court of Cook County, Illinois, as provided by law.

PASSED BY THE COMMISSIONERS OF THE MIDLOTHIAN PARK DISTRICT OF COOK COUNTY, ILLINOIS THIS 19th DAY OF April, 1990.

APPROVED by me this 19th day of April, 1990

Mark Williams
President
Midlothian Park District

ATTEST;

Barbara Austin
Secretary
Midlothian Park District

55 copies
6

00183578

UNOFFICIAL COPY

Property of Cook County Clerk's Office