

UNOFFICIAL COPY

gka

DEPT-01 RECORDINGS 148828 TRAM 9133 01/10/92 09:22:00
\$13.00
COOK COUNTY RECORDER
#0792 * 2-017605

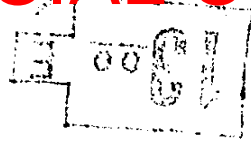

MICHAEL S. MUNGLER
NOTARY PUBLIC STATE OF MISSOURI
COUNTY OF ST. LOUIS
MY COMMISSION EXPIRES JUNE 18, 1993

JRM/18511.19

J. G. MUNGLER
15851 CLAYTON ROAD WEST
BALTIMIN, MO. 63011

PREPARED BY:

NOTARY PUBLIC
MY COMMISSION EXPIRES:

I, the undersigned, a Notary Public in and for the County and State, aforesaid do hereby certify that KENNETH J. GANIEL, as Vice President and MARCIA LUNDBERG, as Assistant Secretary of CITICORP MORTGAGE, INC., ATTORNEY-IN-FACT FOR CITIBANK FEDERAL SAVINGS BANK, who are personally known to me to be the same persons whose names are subscribed to the foregoing instrument, appeared before me in person and acknowledged that they signed, sealed and delivered said instrument as their free and voluntary act and as vested in them by the said Corporation's Board of Directors for the purpose and uses therein set forth.

STATE OF MISSOURI
COUNTY OF ST. LOUIS

MARCIA LUNDBERG
ASSISTANT SECRETARY
CITICORP MORTGAGE, INC.
ATTORNEY-IN-FACT FOR
CITIBANK, FEDERAL SAVINGS BANK
KENNETH J. GANIEL,
VICE PRESIDENT
CITICORP MORTGAGE, INC.
ATTORNEY-IN-FACT FOR
CITIBANK, FEDERAL SAVINGS BANK

IN TESTIMONY WHEREOF, the said CITIBANK, FEDERAL SAVINGS BANK, as successor in interest to CITICORP SAVINGS OF ILLINOIS, A FEDERAL SAVINGS AND LOAN ASSOCIATION, a Federal Savings Bank with its principal office located in Oakland, California, hath hereunto caused its corporate seal to be affixed, and these presents to be signed by its Vice President and Attested by its Assistant Secretary, October 17, 1991.

LEGAL DESCRIPTION: SEE EXHIBIT A ATTACHED
135 EAST HILLSIDE, BARRINGTON, IL 60010

THIS CERTIFIES, That the Mortgage executed by PHILIP L. NEHRT AND SHEILEY A. NEHRT, HIS WIFE TO CITIBANK, FEDERAL SAVINGS BANK on AUGUST 6, 1990, calling for \$211,500.00 (TWO HUNDRED ELEVEN THOUSAND FIVE HUNDRED AND 00/100) dollars and duly recorded on AUGUST 13, 1990, as Instrument No. 90-393209, in Mortgage Record No. XXXX on page XXXX of the records of COOK County, State of ILLINOIS is hereby assigned for value received to SECURITY PACIFIC NATIONAL TRUST COMPANY (NEW YORK), AS TRUSTEE, 2 BOSTON STREET, CORPORATE TRUST DIVISION, NEW YORK, NEW YORK 10006.

ASSIGNMENT OF MORTGAGE

ILLINOIS

Loan # 10040331
PIN #02-06-400-009

Pool #190185

92017605

92017605

UNOFFICIAL COPY

11/11/2011 10:00 AM
11/11/2011 10:00 AM
11/11/2011 10:00 AM

11/11/2011 10:00 AM

11/11/2011 10:00 AM

11/11/2011 10:00 AM

11/11/2011 10:00 AM

11/11/2011 10:00 AM
11/11/2011 10:00 AM
11/11/2011 10:00 AM
11/11/2011 10:00 AM

11/11/2011 10:00 AM

11/11/2011 10:00 AM
11/11/2011 10:00 AM
11/11/2011 10:00 AM
11/11/2011 10:00 AM

11/11/2011 10:00 AM

11/11/2011 10:00 AM

11/11/2011 10:00 AM
11/11/2011 10:00 AM

11/11/2011 10:00 AM

Property of Cook County Clerk's Office

UNOFFICIAL COPY

9 2 0 1 7 5 0 5

LEGAL DESCRIPTION

That part of the North East 1/4 of the South West 1/4 of Section 6 Township 42 North, Range 10 East of the Third Principal Meridian, in Cook County, Illinois described as follows: Beginning at the Center of Section 6 aforesaid, thence South along the East line of said North East 1/4 of the South West 1/4, a distance of 315 feet to a point; thence West parallel with the North line of the North East 1/4 of the South West 1/4 of Section 6, a distance of 142.40 feet to a point; thence North parallel with the said East line a distance of 315.0 feet to a point on the said North line which is 142.40 feet West of the point of beginning; thence East 142.40 feet to the point of beginning ALSO That part of the North West 1/4 of the South East 1/4 of Section 6, Township 42 North, Range 10 East of the Third Principal Meridian described as follows: Beginning at the center of Section 6 aforesaid; thence East along North line of the North West 1/4 of the South East 1/4 of Section 6, a distance of 61.6 feet to a point; thence South parallel with the West line of the said North West 1/4 of the South East 1/4 of Section 6, a distance of 315.00 feet to a point; thence West parallel with the North line aforesaid 61.5 feet to a point on the said West line thence North along the said West line 315 feet to the point of beginning, in Cook County, Illinois.

92017805

UNOFFICIAL COPY

Property of Cook County Clerk's Office

0000000000