

UNOFFICIAL COPY

93755966

ORDINANCE NO. 43-55

AN ORDINANCE ESTABLISHING
VILLAGE OF ELMWOOD PARK
SPECIAL SERVICE AREA NUMBER ONE

PASSED AND APPROVED BY
THE PRESIDENT AND BOARD OF TRUSTEES
THE 26 DAY OF August, 1993

Published in Pamphlet form by
Authority of the Corporate
Authorities of Elmwood Park, Illinois
the 17th day of August, 1993.

93755966

UNOFFICIAL COPY

7 3 5 7 6

AN ORDINANCE ESTABLISHING VILLAGE OF ELMWOOD PARK SPECIAL SERVICE AREA NUMBER ONE

BE IT ORDAINED by the President and Board of Trustees of the Village of Elmwood Park, Cook County, Illinois as follows:

Section 1. Authority.

Special Service Area Number One is established pursuant to the provisions of Article VII, Sections 6A and 6L of the Constitution of the State of Illinois and pursuant to the "Special Service Area Tax Act", 35 ILCS 235/1 et seq.

Section 2. Findings

A. The question of the establishment of the area hereinafter described as a special service area is considered by the Village Board pursuant to an Ordinance entitled: "An Ordinance Proposing the Establishment of Special Area Number One for Alley Improvements in the Village of Elmwood Park and Providing for a Public Hearing and Other procedures in Connection Therewith" adopted June 30, 1993, and is considered pursuant to a hearing held on July 22, 1993, by the Village Board pursuant to Notice duly published in the Elm Leaves, a newspaper published in the Village of Elmwood Park, at least fifteen (15) days prior to the hearing and pursuant to Notice by mail addressed to the person or persons in whose name the general taxes for the last preceding year were paid on each lot, block, tract or parcel of land lying within the special service area. Said Notice was given by depositing said Notice in the United States mails not less than ten (10) days prior to the time

93705965

UNOFFICIAL COPY

93755066

set for the public hearing. In the event taxes for the last preceding year were not paid, the said Notice was sent to the person last listed on the tax rolls prior to that year as the owner of said property. A Certificate of Publication of said Notice and an Affidavit of Mailing of said Notice are attached to this Ordinance as Exhibits 1 and 2. Said Notices conformed in all respects to the requirements of 35 ILCS, Section 235/1 of the aforesaid Act.

B. That a public hearing on the question set forth in the Notice was held on July 22, 1993. All interested persons were given an opportunity to be heard on the question of the creation of the special service area, the nature of the alley improvement project, the cost of construction of the project, and the levy of a direct annual tax to finance the construction of the project.

C. That after considering the data, as presented at the public hearing, the Board of Trustees finds that it is in the public interest and in the interest of the Village of Elmwood Park Special Service Area Number one that said special service area, as hereinafter described, be established.

D. Said area is compact and contiguous and will be enhanced by the alley improvements in the project.

E. It is in the best interests of said special service area that the furnishing of the municipal services proposed herein be considered for the common interests and the safety and welfare of the residents.

F. Said area is zoned for residential purposes and will benefit specially from municipal services proposed to be provided.

93755066

UNOFFICIAL COPY

7 5 3 7 6

The proposed municipal services are unique and in addition to the municipal services provided to the Village of Elmwood Park as a whole.

Section 3. Village of Elmwood Park Special Service Area Number One Established.

A special service area to be known and designated as "Village of Elmwood Park Special Service Area Number One" is hereby established and shall consist of the following described territory:

Blocks 1 thru 6, inclusive, Blocks 10 thru 35, inclusive, and Blocks 38 thru 47, inclusive, of Westwood, being Mills and Sons Subdivision in the West 1/2 of Section 25, Township 40 North, Range 12, East of the Third Principal Meridian, in Cook County, Illinois.

also

The north 50 feet of Lot 1, and Lots 2 thru 12, inclusive, in Elmwood Park Gardens, being a Subdivision of the South 1/2 of the Southwest 1/4 of the Northeast 1/4 of Section 25, Township 40 North, Range 12, East of the Third Principal Meridian, in Cook County, Illinois.

also

Lots 1 and 2 in Rasmussen's Resubdivision of Lot 1 (except the north 50 feet thereof) in Elmwood Park Gardens, being a Subdivision of the south 1/2 of the Southwest 1/4 of the Northeast 1/4 of Section 25, Township 40 North, Range 12, East of the Third Principal Meridian, in Cook County, Illinois.

also

Any existing alley lying within or contiguous to the above described properties.

An accurate map of said district is attached hereto as Exhibit 3.

Section 4. Purpose of Area.

Village of Elmwood Park Special Service Area Number One is established to provide special municipal services to said area in addition to services provided to the Village generally. Specifically, the special services shall consist of alley reconstruction, repaving and other alley improvements in the area. In addition, annual taxes may be levied to finance the cost of construction of said alley improvements and to pay the interest

93755966

UNOFFICIAL COPY

1 7 5 5 7 6

incurred in borrowing funds related to financing such costs of construction.

Section 5. Tax Levy.

There is hereby authorized, and there shall also be imposed, a special tax, at an annual rate not to exceed thirty-three hundredths (.33%) per cent of the assessed value, as equalized, said tax to be levied annually for a maximum of five (5) years. Said taxes shall be levied upon all taxable real property within said special service area, and said taxes are in addition to the annual real estate tax and all other taxes provided by law, and shall be levied pursuant to the provisions of the Revenue Act of 1939.

Section 6. Effective Date.

This Ordinance shall be in full force and effect from and after its passage, approval and publication in the manner provided by law, providing no petition is filed opposing the creation of the special service area pursuant to 35 ILCS 235/9.

ADOPTED this 16th day of August, 1993, pursuant to a roll call vote as follows:

AYES: 7

NAYS: 0

APPROVED by me this 16th day of August, 1993.

John N. Schick
President

ATTEST:

James A. Miller
Village Clerk

93755966

UNOFFICIAL COPY

PIONEER PRESS

YOUR LOCAL SOURCE

CERTIFICATE OF PUBLICATION

NOTICE OF HEARING
VILLAGE OF ELMWOOD PARK
SPECIAL SERVICE AREA
NUMBER ONE

NOTICE IS HEREBY GIVEN that on the 22nd day of July, at 7:30 P.M. in the Civic Center, 1 Conli Parkway, Elmwood Park, Illinois, a hearing will be held by the President and Board of Trustees of the Village of Elmwood Park to consider forming a special service area consisting of the territory generally bounded by: ...

Beginning at a point which would be described as the south west corner of the intersection of Bellmont Avenue and 75th Avenue, south to George Street, east to 75th Avenue, south to Diverser, west to 75th Avenue, south to Schubert Avenue, west to 75th Court, south to Conli Parkway, southwest along Conli Parkway to Westwood Drive, northwest along Westwood Drive to 80th Avenue, north to Oakleaf Avenue, southeast along Oakleaf Avenue to 79th Avenue, north east to Sunset Avenue, west along Sunset Avenue to 80th Avenue, north to Metropole Avenue, east to 79th Avenue, north to Bellmont Avenue, east to the point of beginning.

The legal description of the boundaries of said area is contained in Exhibit "A" attached hereto. An accurate map of said territory is on file in the office of the Village Clerk and available for public inspection.

All interested persons, including of persons owning taxable real property located within Special Service Area No. 1, will be given an opportunity to be heard regarding the formation of the area and the boundaries of the special service area and may object to the formation of the area, and the levy of taxes affecting said area.

The purpose of the formation of Elmwood Park Special Service Area number 1 is generally to provide special municipal services to the area which will benefit the area, specifically the construction of improved alleys in this area and the costs of financing such improvements.

A special tax, in addition to the tax to retire general obligation bonds, will be considered at the public hearing to be levied for a period not to exceed five (5) years and not to exceed an amount of thirty-three hundredths (33%) percent per annum of assessed value, as equalized, to be levied against the real property included in the special service area.

At the hearing, all interested persons affected by the formation of such special service area, including all persons owning taxable real estate therein, will be given an opportunity to be heard. The hearing may be adjourned by the Board to another date without further notice other than a motion to be entered upon the minutes of its meeting fixing the time and place of its adjournment.

If a petition signed by at least 25% of the electors residing within the special service area and by at least 5% of the owners of record of the land included within the boundaries of the special service area is filed with the municipal clerk within 60 days following the final adjournment of the public hearing objecting to the creation of the special service district, the enlargement thereof, the levy or imposition of a tax or to a proposed increase in the tax rate, no such special service district as proposed may be created or enlarged, or tax may be levied or imposed nor the rate increased except as otherwise permitted by law.

Dated this 30th day of June, 1993, at the Village Office of the Village Clerk.

EXHIBIT A
SPECIAL SERVICE AREA

Blocks 1 thru 6, inclusive; Blocks 10 thru 15, inclusive; and Blocks 28 thru 41, inclusive, of Westwood, being Units and Lots Subdivision in the West 1/2 of Section 25, Township 40 North, Range 12, East of the Third Principal Meridian, in Cook County, Illinois.

The north 50 feet of Lot 1, and Lots 2 thru 10, inclusive, in Elmwood Park Gardens, being a subdivision of the South 1/2 of the Southwest 1/4 of the Northeast 1/4 of Section 25, Township 40 North, Range 12, East of the Third Principal Meridian, in Cook County, Illinois.

also

also
Lots 1 and 2 in Rasmussen's Resubdivision of Lot 1 (except the north 50 feet thereof) in Elmwood Park Gardens, being a subdivision of the South 1/2 of the Southwest 1/4 of the Northeast 1/4 of Section 25, Township 40 North, Range 12, East of the Third Principal Meridian, in Cook County, Illinois.

also
Any existing alley lying within or contiguous to the above described properties.

WJ 7/04/93 #1447 1 week

STATE OF ILLINOIS
COUNTY OF X COOK [] KANE [] LAKE [] McHENRY

PIONEER PRESS, does hereby certify it has published the attached advertisement in the following secular weekly newspapers. All newspapers meet Illinois Revised Statutes requirements for publication of legal notices.

NOTE: Legal notice appeared in the following checked publications.

WEDNESDAY PUBLICATIONS: (WEST)

- X Elm Leaves
[] Forest Leaves
[] Franklin Park Herald-Journal
[] Maywood Herald
[] Melrose Park Herald
[] Northlake Herald-Journal
[] Oak Leaves
X River Grove Messenger
[] Westchester Herald
[] West Proviso Herald

THURSDAY PUBLICATIONS: (NORTH SHORE)

- Evanston Review
Glencoe News
Glenview Announcements
Northbrook Star
Wilmette Life
Winnetka Talk
[] Harwood Heights-Norridge News
[] Lincolnwood Review
[] Morton Grove Champion
[] Niles Spectator
[] Park Ridge Advocate
[] Skokie Review

- (LAKE SHORE)
Deerfield Review
Grayslake Review
Gurnee Review
Highland Park News
Lake Forest
Libertyville Review
Mundelein Review
The Review of Lake Villa and Lindenhurst
Vernon Hills Review

- (CENTRAL)
[] Harwood Heights-Norridge News
[] Lincolnwood Review
[] Morton Grove Champion
[] Niles Spectator
[] Park Ridge Advocate
[] Skokie Review
(NORTHWEST)
[] Algonquin Countryside
[] Barrington Courier Review
[] Buffalo Grove Countryside
[] Cary Grove Countryside
[] Hoffman Estates Review
[] Lake Zurich Courier
[] Palatine Countryside
[] Rolling Meadows Review
[] Schaumburg Review
[] Wheeling Countryside

And that the date(s) of publication(s) was(were):

7/7/93

being 1 consecutive weeks.

N WITNESS WHEREOF, the undersigned, being duly authorized, has caused this Certificate to be signed and its official seal affixed at Wilmette, Illinois this 7th day of July, A.D. 1993

By [Signature]

Legal Advertising Manager (official title)

UNOFFICIAL COPY

7 3 0 3 3 3

VILLAGE OF ELMWOOD PARK SPECIAL SERVICE AREA NUMBER ONE

CERTIFICATE OF MAILING

Carmela Corsini, being first duly sworn on oath, deposes and says that she caused to be sent by first class mail, postage prepaid, on the 10th day of July, 1993, a copy of the attached notice directed to the person or persons in whose name the general taxes for the last preceding year were paid, on each lot, block, tract or parcel of land included in the proposed Special Service Area as ascertained from an examination of the Cook County Collector's books.

Carmela Corsini

Subscribed and Sworn to
before me this 25th day
of August, 1993.

Elsie Sutter
NOTARY PUBLIC



937155966

UNOFFICIAL COPY

7 / 5 5 7 5 0

NOTICE OF HEARING

VILLAGE OF ELMWOOD PARK SPECIAL

SERVICE AREA NUMBER ONE

NOTICE IS HEREBY GIVEN that on the 22nd day of July, at 7:30 P.M. in the Civic Center, 2 Conti Parkway, Elmwood Park, Illinois, a hearing will be held by the President and Board of Trustees of the Village of Elmwood Park to consider forming a special service area consisting of the territory generally bounded by:

Beginning at a point which would be described as the south west corner of the intersection of Belmont Avenue and 76th Avenue, south to George street, east to 75th Court, south to Diversey, west to 76th Avenue, south to Schubert Avenue, west to 76th Court, south to Conti Parkway, southwest along Conti Parkway to Westwood Drive, northwest along Westwood Drive to 80th Avenue, north to Oakleaf Avenue, southeast along Oakleaf Avenue to 79th Avenue, north east to Sunset Avenue, west along Sunset Avenue to 80th Avenue, north to Metropole Avenue, east to 79th Avenue, north to Belmont Avenue, east to the point of beginning.

The legal description of the boundaries of said area is contained in Exhibit "A" attached hereto. An accurate map of said territory is on file in the office of the Village Clerk and available for public inspection.

All interested persons, including all persons owning taxable real property located within Special Service Area No. 1, will be given an opportunity to be heard regarding the formation of and the boundaries of the special service area and may object to the formation of the area, and the levy of taxes affecting said area.

The purpose of the formation of Elmwood Park Special Service Area number 1 is generally to provide special municipal services to the area which will benefit the area, specifically the construction of improved alleys in this area and the costs of financing such

93755966

UNOFFICIAL COPY

7 1 5 7 6 1

improvements.

A special tax, in addition to the tax to retire general obligation bonds, will be considered at the public hearing to be levied for a period not to exceed five (5) years and not to exceed an amount of thirty-three hundredths (.33 %) percent per annum of assessed value, as equalized, to be levied against the real property included in the special service area.

At the hearing, all interested person affected by the formation of such special service area, including all persons owning taxable real estate therein, will be given an opportunity to be heard. The hearing may be adjourned by the Board to another date without further notice other than a motion to be entered upon the minutes of its meeting fixing the time and place of its adjournment.

If a petition signed by at least 51% of the electors residing within the special service area and by at least 51% of the owners of record of the land included within the boundaries of the special service area is filed with the municipal clerk within 60 days following the final adjournment of the public hearing objecting to the creation of the special service district, the enlargement thereof, the levy or imposition of a tax or to a proposed increase in the tax rate, no such special service district as proposed may be created or enlarged, or tax may be levied or imposed nor the rate increased except as otherwise permitted by law.

Dated this 3rd day of August, 1993.

Village Clerk

93755966

UNOFFICIAL COPY

1.7.2016

EXHIBIT A

SPECIAL SERVICE AREA #1

Blocks 1 thru 6, inclusive, Blocks 10 thru 35, inclusive, and Blocks 38 thru 47, inclusive, of Westwood, being Mills and Sons Subdivision in the West 1/2 of Section 25, Township 40 North, Range 12, East of the Third Principal Meridian, in Cook County, Illinois.

also

The north 50 feet of Lot 1, and Lots 2 thru 12, inclusive, in Elmwood Park Gardens, being a subdivision of the South 1/2 of the Southwest 1/4 of the Northeast 1/4 of Section 25, Township 40 North, Range 12, East of the Third Principal Meridian, in Cook County, Illinois.

also

Lots 1 and 2 in Rasmussen's Resubdivision of Lot 1 (except the north 50 feet thereof) in Elmwood Park Gardens, being a subdivision of the South 1/2 of the Southwest 1/4 of the Northeast 1/4 of Section 25, Township 40 North, Range 12, East of the Third Principal Meridian, in Cook County, Illinois.

also

Any existing alley lying within or contiguous to the above described properties.

UNOFFICIAL COPY

SEE SPECIAL SERVICE DISTRICT 1
PAGE 1 OF 5

W. 1/2 S.W. 1/4 Sec. 25-40-12

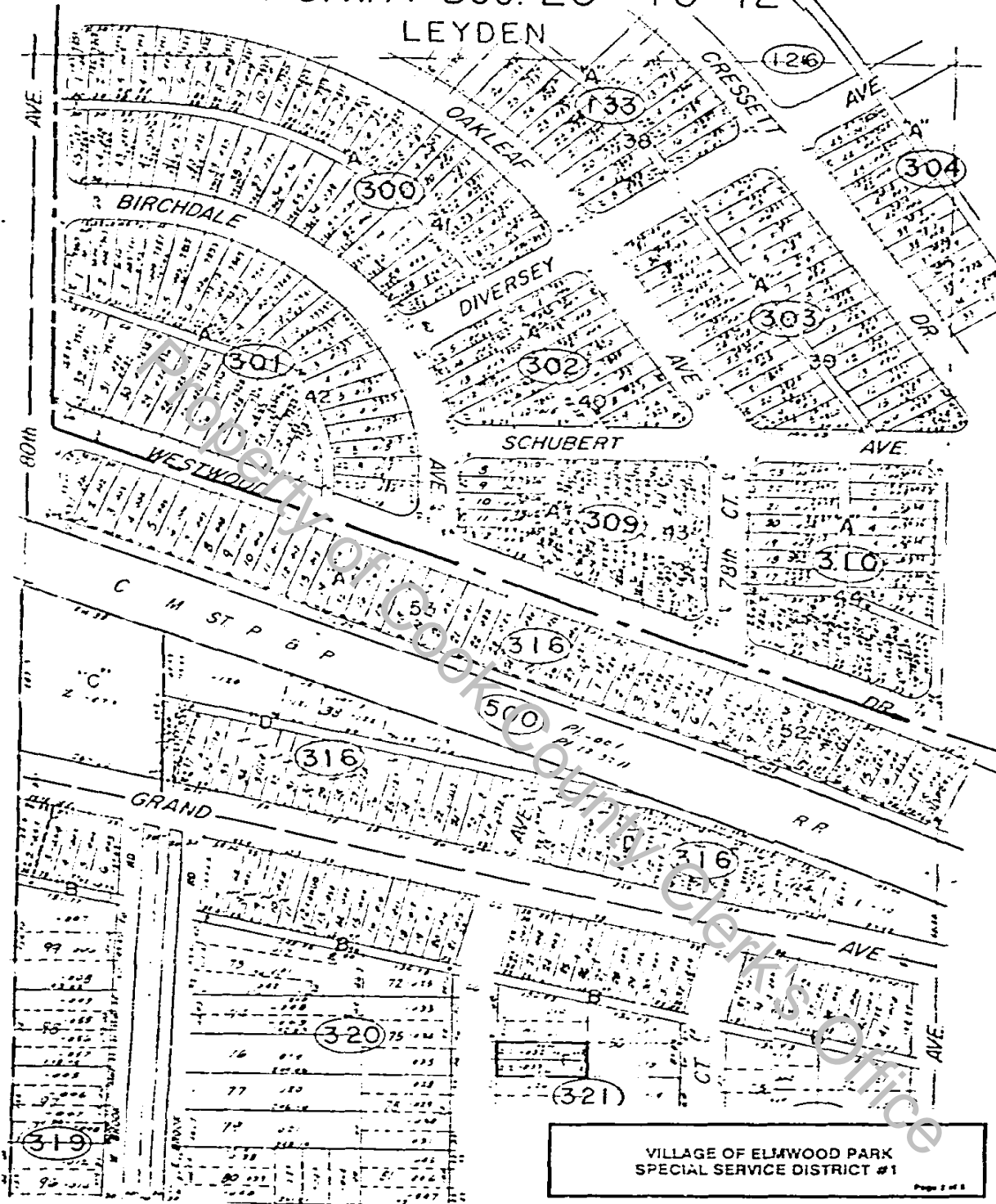

SEE SPECIAL SERVICE DISTRICT 1
PAGE 4 OF 5

93755966

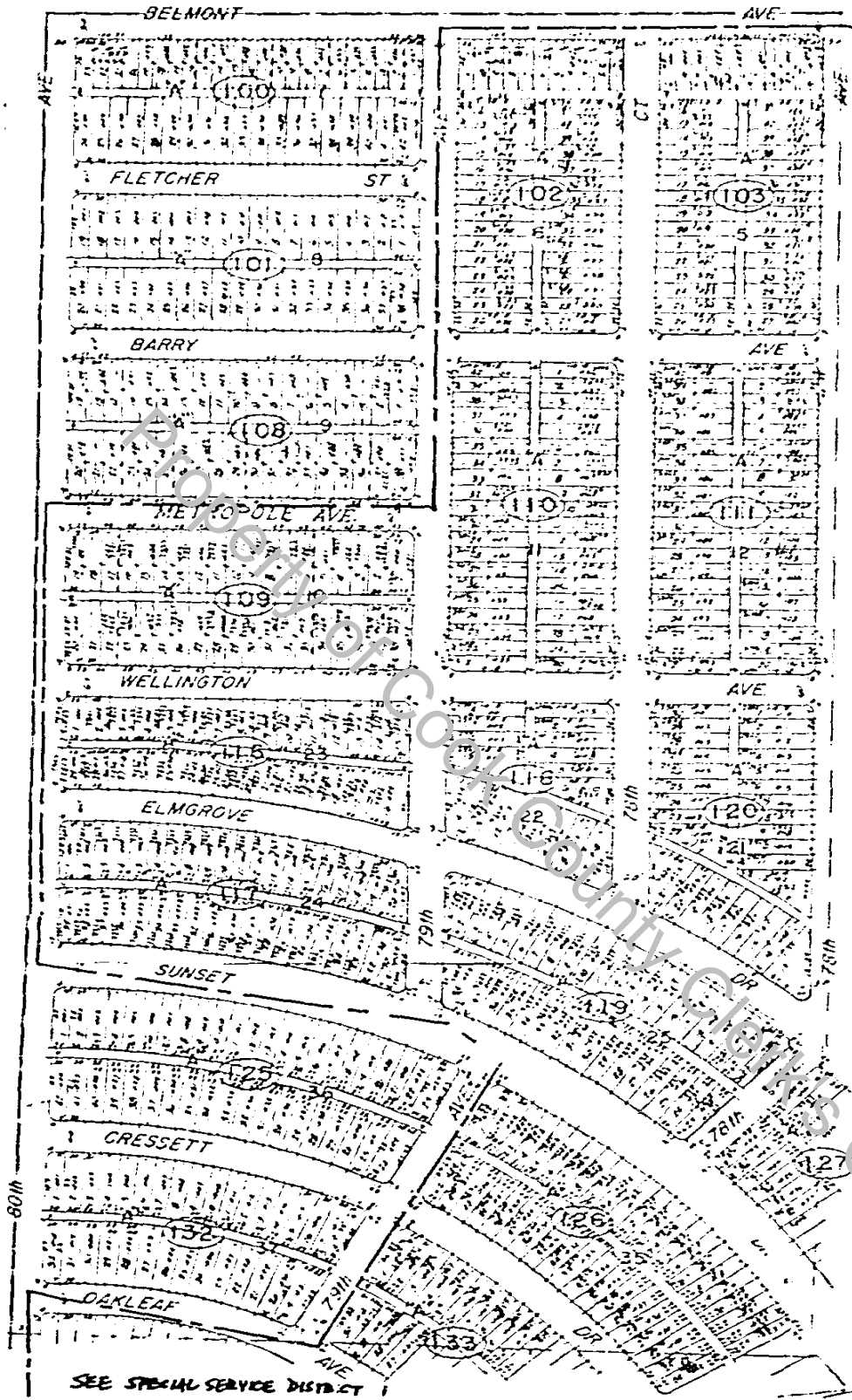

SEE SPECIAL SERVICE DISTRICT #1
PAGE 2 OF 5

SEE SPECIAL SERVICE DISTRICT
PAGE 2 OF 5

VILLAGE OF ELLWOOD PARK
SPECIAL SERVICE DISTRICT #1

93755986



UNOFFICIAL COPY

E 1/2 N W 1/4 Sec. 25-40-12
LEYDEN

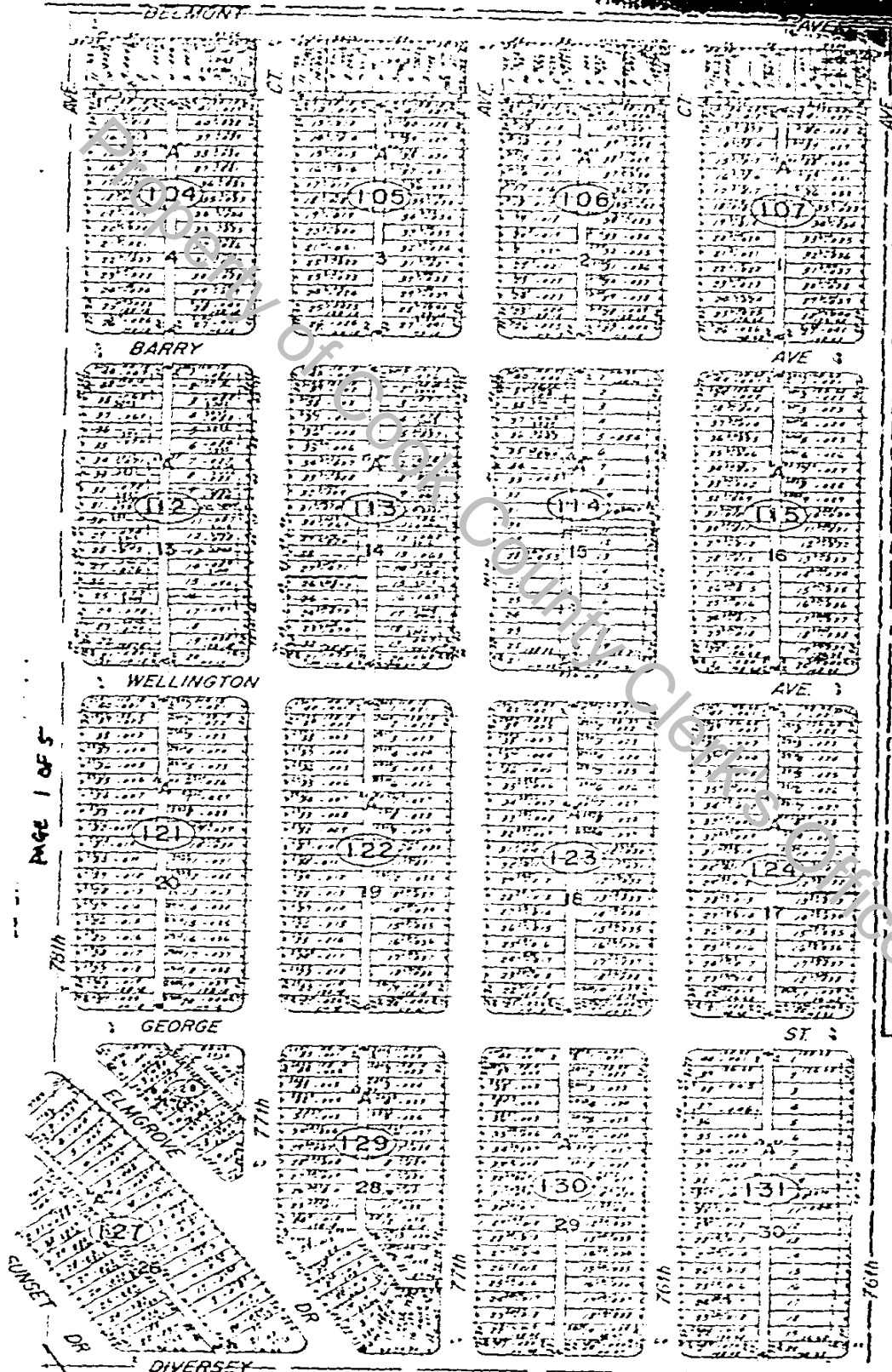

PAGE 1 OF 5

SEE SPECIAL SERVICE DISTRICT 1
PAGE 4 OF 5

VILLAGE OF ELMWOOD PARK
SPECIAL SERVICE DISTRICT #1
PAGE 3 OF 5

SEE SPECIAL SERVICE DISTRICT #1
PAGE 5 OF 5

93755066

UNOFFICIAL COPY

SEE SPECIAL SERVICE DISTRICT

PAGE 3 OF 5

E. 1/2 S.W. 1/4 Sec. 25-40-12

LEYDEN

40-12-25F

12-25

SEE SPECIAL SERVICE DISTRICT 1 PAGE 5 OF 5

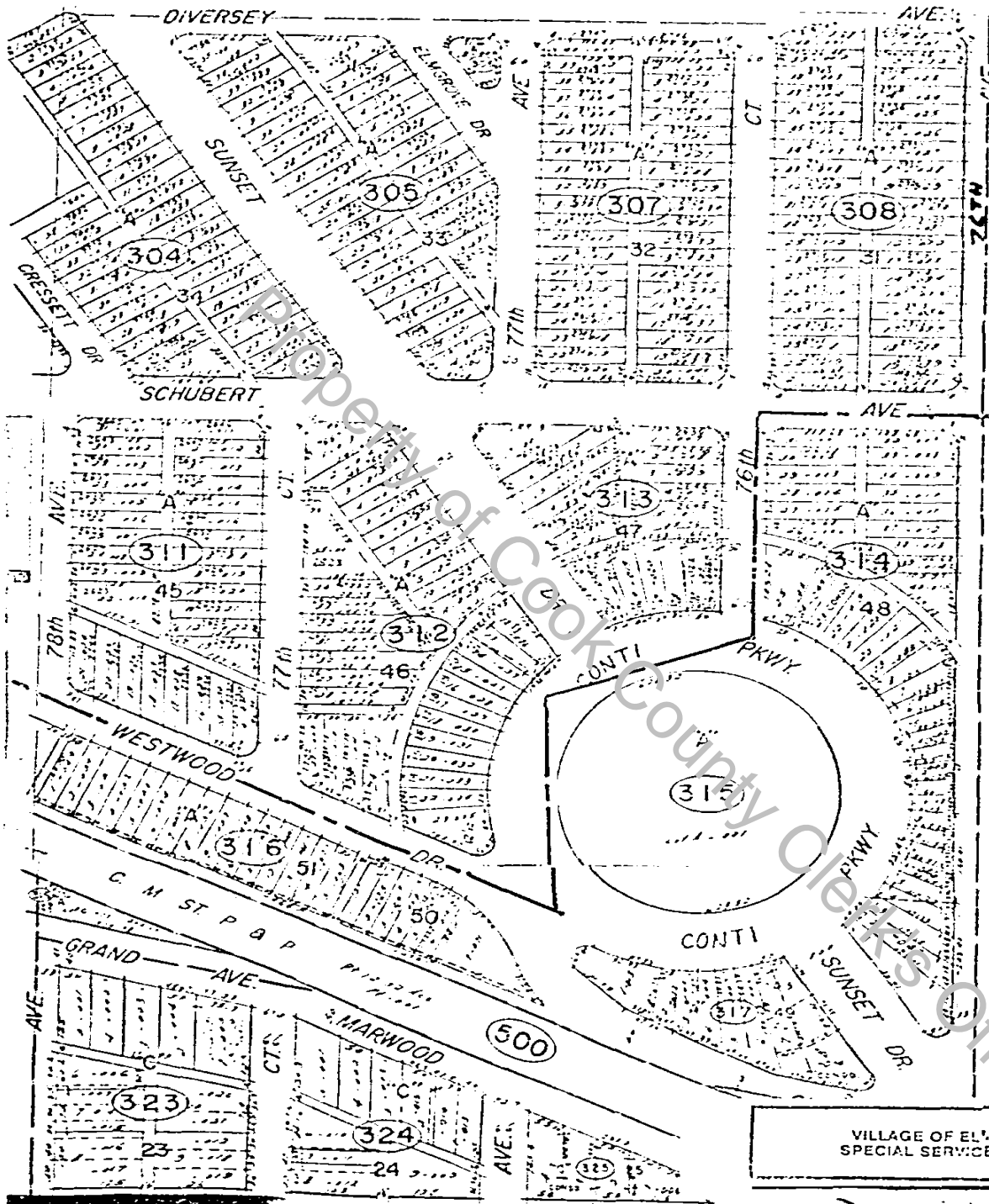

WESTWOOD COURT CONDOMINIUM
REC. CH. 11, 1973 DAL 2551834

ELLENHURST HILLS CONDOMINIUM
REC. CH. 11, 1973 DAL 2551834

GRAND POINT DEVELOPMENT CONDOMINIUM
REC. CH. 11, 1973 DAL 2551834

UNIT	UNIT	UNIT	UNIT
1B	1001	2B	1002
1C	1002	2C	1003
1D	1003	2D	1004
1E	1004	2E	1005
1F	1005	2F	1006
1G	1006	2G	1007
1H	1007	2H	1008

WESTWOOD COURT CONDOMINIUM
REC. CH. 11, 1973 DAL 2551834

UNIT	UNIT	UNIT	UNIT
201	1001	301	1002
202	1002	302	1003
203	1003	303	1004
204	1004	304	1005
205	1005	305	1006
206	1006	306	1007
207	1007	307	1008
208	1008	308	1009
209	1009	309	1010
210	1010	310	1011
211	1011	311	1012
212	1012	312	1013
213	1013	313	1014
214	1014	314	1015
215	1015	315	1016
216	1016	316	1017
217	1017	317	1018
218	1018	318	1019
219	1019	319	1020
220	1020	320	1021
221	1021	321	1022
222	1022	322	1023
223	1023	323	1024
224	1024	324	1025
225	1025	325	1026
226	1026	326	1027
227	1027	327	1028
228	1028	328	1029
229	1029	329	1030
230	1030	330	1031
231	1031	331	1032
232	1032	332	1033
233	1033	333	1034
234	1034	334	1035
235	1035	335	1036
236	1036	336	1037
237	1037	337	1038
238	1038	338	1039
239	1039	339	1040
240	1040	340	1041
241	1041	341	1042
242	1042	342	1043
243	1043	343	1044
244	1044	344	1045
245	1045	345	1046
246	1046	346	1047
247	1047	347	1048
248	1048	348	1049
249	1049	349	1050
250	1050	350	1051
251	1051	351	1052
252	1052	352	1053
253	1053	353	1054
254	1054	354	1055
255	1055	355	1056
256	1056	356	1057
257	1057	357	1058
258	1058	358	1059
259	1059	359	1060
260	1060	360	1061
261	1061	361	1062
262	1062	362	1063
263	1063	363	1064
264	1064	364	1065
265	1065	365	1066
266	1066	366	1067
267	1067	367	1068
268	1068	368	1069
269	1069	369	1070
270	1070	370	1071
271	1071	371	1072
272	1072	372	1073
273	1073	373	1074
274	1074	374	1075
275	1075	375	1076
276	1076	376	1077
277	1077	377	1078
278	1078	378	1079
279	1079	379	1080
280	1080	380	1081
281	1081	381	1082
282	1082	382	1083
283	1083	383	1084
284	1084	384	1085
285	1085	385	1086
286	1086	386	1087
287	1087	387	1088
288	1088	388	1089
289	1089	389	1090
290	1090	390	1091
291	1091	391	1092
292	1092	392	1093
293	1093	393	1094
294	1094	394	1095
295	1095	395	1096
296	1096	396	1097
297	1097	397	1098
298	1098	398	1099
299	1099	399	1100
300	1100	400	1101

ANGELA COURT CONDOMINIUM
REC. CH. 11, 1973 DAL 2551834

VILLAGE OF ELMWOOD PARK
SPECIAL SERVICE DISTRICT #1

Page 4 of 8

9375966

