



UNOFFICIAL COPY

Property of Cook County Clerk's Office

~~EXHIBIT A~~  
**UNOFFICIAL COPY**

Legal Description

Property Address 440 S. LASALLE

Property Index No. 17 16 242 022  
17 16 242 023  
17 16 242 018  
17 16 242 019  
17 16 242 020  
17 16 242 024

(SEE LEGAL ATTACHED.)

Property of Cook County Clerk's Office

97578890

UNOFFICIAL COPY

Property of Cook County Clerk's Office

UNOFFICIAL COPY

EXHIBIT A

PAGE 1 INTENTIONALLY OMITTED  
PAGE 2

That part of Peter Temple's Subdivision of Block 99, and that part of the Subdivision of Block 114 (taken as a tract, including vacated alleys) all in the School Section Addition to Chicago, in the Northeast 1/4 of Section 15, Township 39 North, Range 14 East of the Third Principal Meridian described as follows: Commencing at the Northeast corner of Lot 3 in the aforesaid Subdivision of Block 114; thence South 0 Degrees 00 Minutes 27 Seconds East (along the East line of Lots 3, 4, 5, 10 and 11 in said Subdivision of Block 114) a distance of 232.22 feet to the point of beginning of the tract herein described; thence South 0 Degrees 00 Minutes 23 Seconds East (along the East line of Lots 15, 16, 21 and 22 in said Subdivision of Block 114) a distance of 133.22 feet to a point on the East line of Lot 22 which is 31.98 feet Northerly of the Southeast Corner of said Lot; thence South 89 Degrees 55 Minutes 53 Seconds West, a distance of 215.15 feet to a point on the West line of Lot 24 in Peter Temple's Subdivision of Block 99 which is 31.18 feet Northerly of the Southwest corner of said Lot; thence North 0 Degrees 01 Minutes 21 Seconds West (along the West line of Lots 24, 19, 12 and 13 in the aforesaid Peter Temple's Subdivision of Block 99) a distance of 134.17 feet to a point on the West line of Lot 13 which is 232.22 feet

26560112

97578890

UNOFFICIAL COPY

Property of Cook County Clerk's Office

UNOFFICIAL COPY

Southerly of the Northwest Corner of Lot 1 in the aforesaid Peter Temple's Subdivision; thence South 89 Degrees 48 Minutes 43 Seconds East (along a line drawn parallel with the North Line of Lot 3 in said Subdivision of Block 114 and also parallel with the North Line of Lot 1 in the aforesaid Peter Temple's Subdivision of Block 99) A distance of 215.19 feet to the heretofore described point of Beginning, in Cook County, Illinois.

PARCEL 3

That part of Peter Temple's Subdivision of Block 98, that part of the Subdivision of Block 114, that part of George Merrill's Subdivision of Block 100, and that part of T. C. Wright's Subdivision of Block 113 (taken as a tract, including vacated alleys) all in the School Section Addition to Chicago, in the Northeast 1/4 of Section 16, Township 39 North, Range 14 East of the Third Principal Meridian described as follows: Beginning at a point on the East Line of Lot 22 in the Subdivision of Block 114 which is 31.98 feet Northerly of the Southeast corner thereof; thence South 0 Degrees 00 Minutes 23 Seconds East 31.98 Feet to the Southeast Corner of said Lot 22; thence South 89 Degrees 51 Minutes 16 Seconds East, along the North Line of Lot 1 in T. C. Wright's Subdivision of Block 113, a distance of 0.14 Feet to the Northeast corner of said Lot; thence South 0 Degrees 05 Minutes 33 Seconds West, along the East Line of Lots 1

97578890

25110112

UNOFFICIAL COPY

Property of Cook County Clerk's Office



UNOFFICIAL COPY

and 6 in the aforesaid T. G. Wright's Subdivision of Block 113, a distance of 94.83 Feet; thence South 89 Degrees 55 Minutes 40 Seconds West, a distance of 210.30 Feet to a point on the West Line of Lot 23 in George Merrill's Subdivision of Block 100 which is 95.63 Feet Southerly of the Northwest Corner of Lot 24 in said Subdivision; thence North 7 Degrees 02 Minutes 20 Seconds West, along the West Lines of the aforesaid Lots 23 and 24, a distance of 95.63 Feet to the Northwest corner of said Lot 24 in George Merrill's Subdivision of Block 100; thence North 89 Degrees 51 Minutes 16 Seconds West, along the South Line of Lot 24 in Peter Temple's Subdivision of Block 89, a distance of 4.77 Feet to the Southwest Corner of said Lot; thence North 2 Degrees 01 Minutes 21 Seconds West, along the West Line of the aforesaid Lot 24, a distance of 31.18 Feet; thence North 89 Degrees 55 Minutes 58 Seconds East, a distance of 219.73 Feet to the hereinabove described point of beginning; portions of the foregoing being subject to an Easement for a Superhighway granted to the City of Chicago, recorded January 25, 1960 as Document No. 14721965; and also subject to a Subseq. Easement granted to the City of Chicago, recorded June 28, 1960 as Document No. 13924479; in Cook County, Illinois.

EASEMENT PARCEL

Easement for the benefit of Parcel 2, aforesaid,  
as set forth in Paragraph 1B of the Grant of Easements

97578890

26567122

UNOFFICIAL COPY

Property of Cook County Clerk's Office

UNOFFICIAL COPY

executed by The Penn Central Corporation, et al, dated April 3, 1961 and recorded as Document No. 25,017,406 for the purpose of pedestrian ingress and egress on, over and through an enclosed corridor, at least 20 feet wide, along the geographic center (plus or minus 5 feet) on a straight line from the North boundary line to the South boundary line of the following described real estate located North of and adjoining the land said corridor to be in the "CSOC Building" and any improvements constructed on said adjoining land from time to time:

That part of Peter Temple's Subdivision of Block 99, and that part of the Subdivision of Block 114 (taken as a tract, including vacated alleys) all in the School Section Addition to Chicago, in the Northeast 1/4 of Section 15, Township 39 North, Range 14 East of the Third Principal Meridian described as follows: Beginning at the Northeast corner of Lot 3 in the aforesaid Subdivision of Block 114; thence South 0 degrees 00 minutes 23 seconds East (along the East line of Lots 3, 4, 9, 10 and 15 in said Subdivision of Block 114) a distance of 332.32 feet; thence North 89 degrees 48 minutes 43 seconds West (along a line drawn parallel with the North line of Lot 3 in said Subdivision of Block 114 and also parallel with the North line of Lot 1 in the aforesaid Peter Temple's Subdivision of Block 99) a distance of 215.19 feet to the West line of Lot 13 in said

97578890

6560112

UNOFFICIAL COPY

Property of Cook County Clerk's Office

UNOFFICIAL COPY

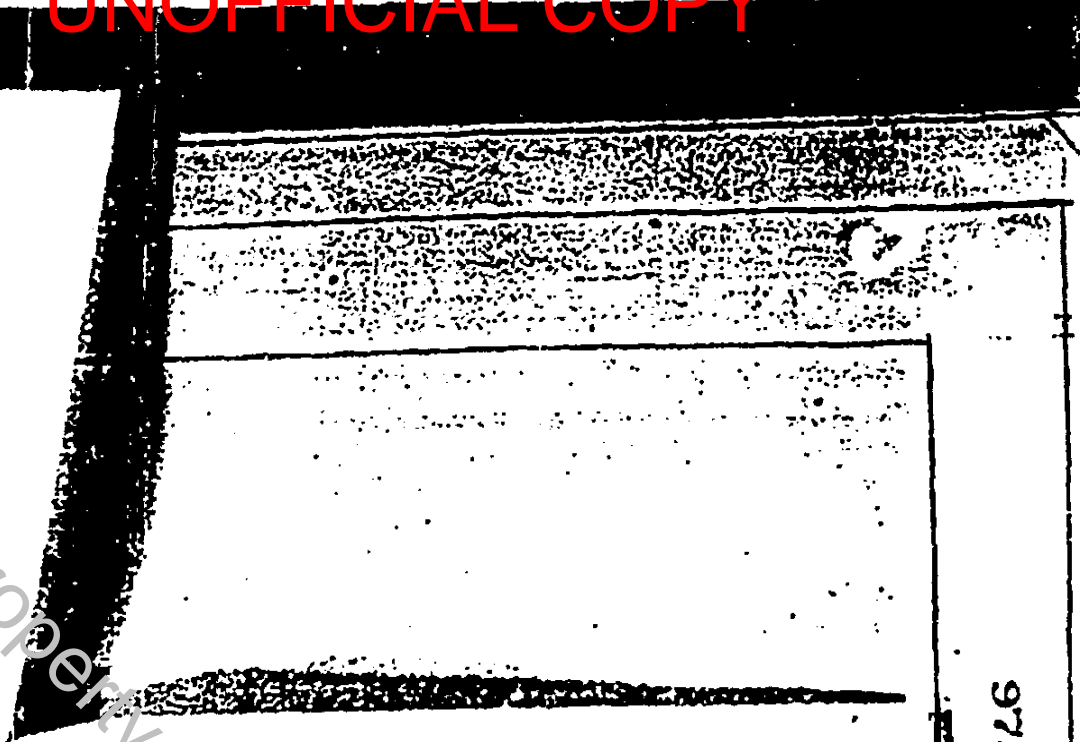

Property of Cook County Clerk's Office

97578890

Peter Temple's Subdivision; thence North 0 degrees 01 minutes 31 seconds West (along the West line of Lots 13, 12, 7, 6 and 1 in the aforesaid Peter Temple's Subdivision of Block 99) a distance of 332.32 feet to the Northwest corner of lot 1; thence South 83 degrees 47 minutes 43 seconds East 215.35 feet to the hereinabove designated point of beginning, in Cook County, Illinois.

25560112

UNOFFICIAL COPY

Property of Cook County Clerk's Office



UNOFFICIAL COPY

Property of Cook County Clerk's Office



# UNOFFICIAL COPY

## EXHIBIT B.

(Name of Defendant(s))

Address(es)

ONE FINANCIAL PLACE  
CONTINENTAL OFFICES LTD  
RONALD BARTOLI  
440 S LASALLE  
CHICAGO IL 60607

AMERICAN NATIONAL BANK  
TRUST# 57320  
33 N LASALLE ST.  
CHICAGO IL

FINANCIAL ONE PLACE 57320  
1701 GOLF RE. 5100 TWR-2  
ROLLING MEADOWS, IL 60008-4227

TRAVELERS INSURANCE CO  
AS COLLATERAL ASSIGNEE  
2215 YORK RE.  
SUITE 504  
OAK BROOK IL 60521

97578890

Property of Cook County Clerk's Office

UNOFFICIAL COPY

Property of Cook County Clerk's Office