

UNOFFICIAL COPY

97253385



Area Survey Company

11340 West 159th Street Orland Park, Illinois 60462 • Phone (708) 349-7364 • FAX (708) 349-7372

P	A
P	P
T	V
I	EMM

DEPT-01 RECORDING \$23.00
 T#7777 TRAN 0343 04/11/97 12:38:00
 #4944 DR *-97-253385
 COOK COUNTY RECORDER

CERTIFICATE OF CORRECTION

I, THOMAS J. CESAL, ILLINOIS PROFESSIONAL LAND SURVEYOR NO. 2205, DO HEREBY CERTIFY THAT I AM THE SURVEYOR WHO HAS PREPARED THE PLAT OF SUBDIVISION ENTITLED:

Carlyle Ridge

A SUBDIVISION OF PART OF THE SOUTHWEST 1/4 OF THE SOUTHWEST 1/4 OF SECTION 27, TOWNSHIP 36 NORTH, RANGE 12 EAST OF THE THIRD PRINCIPAL MERIDIAN, IN COOK COUNTY, ILLINOIS. RECORDED AS DOC. # 96-966561

AND THAT SAID PLAT OF SUBDIVISION IS HEREBY CORRECTED AS FOLLOWS:

ALL REFERENCES TO SECTION 27-26-12 ON THE DRAWING SHOULD BE TO SECTION 27-36-12.

THE LEGAL DESCRIPTIONS CONTAINED IN THE SURVEYOR'S CERTIFICATE AND THE CAPTION ARE CORRECT.

PIN 27-27-302-017
27-27-302-022
27-27-302-021

PRIOR # 27-27-302-017

DATED AT ORLAND PARK, ILLINOIS THIS 27TH DAY OF FEBRUARY 1997

Thomas J. Cesal

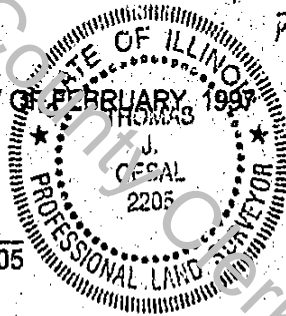

97253385

ILLINOIS PROFESSIONAL LAND SURVEYOR NO. 2205

COLE TAYLOR BANK, NOT PERSONALLY, BUT SOLELY AS TRUSTEE UNDER TRUST AGREEMENT NO. 4533, DATED MARCH 12, 1986, DOES HEREBY CONSENT AND AGREE TO THE CERTIFICATE OF CORRECTION ATTACHED HERETO.

DATED AT CHICAGO, ILLINOIS, THIS 11th DAY OF APRIL, 1997

COLE TAYLOR BANK, AS TRUSTEE AS AFORESAID

This instrument received by...

Gabriel Barrett
0235 S. Turner Ave.
Evergreen Pk., IL 60806-1550

BY: *[Signature]* TITLE: Vice-President

ATTEST: *[Signature]* TITLE: TRUST OFFICER

RECORDING FEE \$ 23.00
DATE 4-11-97 COPIES 6
OK EM

UNOFFICIAL COPY

Property of Cook County Clerk's Office

97250395



Area Survey Company

14340 West 159th Street Orland Park, Illinois 60462 • Phone (708) 349-7364 • FAX (708) 349-7372

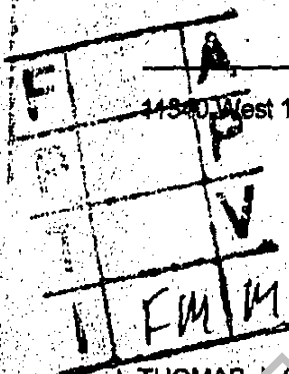

CERTIFICATE OF CORRECTION

I, THOMAS J. CESAL, ILLINOIS PROFESSIONAL LAND SURVEYOR NO. 2205, DO HEREBY CERTIFY THAT I AM THE SURVEYOR WHO HAS PREPARED THE PLAT OF SUBDIVISION ENTITLED:

Carlyle Ridge

A SUBDIVISION OF PART OF THE SOUTHWEST 1/4 OF THE SOUTHWEST 1/4 OF SECTION 27, TOWNSHIP 36 NORTH, RANGE 12 EAST OF THE THIRD PRINCIPAL MERIDIAN, IN COCK COUNTY, ILLINOIS. RECORDED AS DOC # 9696561

AND THAT SAID PLAT OF SUBDIVISION IS HEREBY CORRECTED AS FOLLOWS:

ALL REFERENCES TO SECTION 27-26-12 ON THE DRAWING SHOULD BE TO SECTION 27-36-12.

THE LEGAL DESCRIPTIONS CONTAINED IN THE SURVEYOR'S CERTIFICATE AND THE CAPTION ARE CORRECT. PIN 27-27-302-019

DATED AT ORLAND PARK, ILLINOIS THIS 27th DAY OF FEBRUARY, 1997

Handwritten signature of Thomas J. Cesal

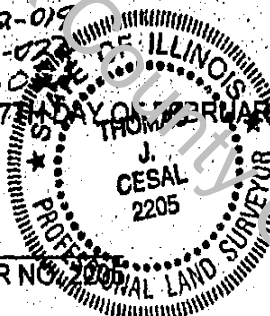

PRICR PFN 27-27-302-017

ILLINOIS PROFESSIONAL LAND SURVEYOR NO. 2205

97253385

COLE TAYLOR BANK, NOT PERSONALLY, BUT SOLELY AS TRUSTEE UNDER TRUST AGREEMENT NO. 4533, DATED MARCH 12, 1986, DOES HEREBY CONSENT AND AGREE TO THE CERTIFICATE OF CORRECTION ATTACHED HERETO.

DATED AT CHICAGO, ILLINOIS, THIS 11th DAY OF APRIL, 1997

COLE TAYLOR BANK, AS TRUSTEE AS AFORESAID

PREPARED BY: G.J. BARRETT 9235 S. TURNER AVE. EVERGREEN PARK, IL 60805

BY: [Handwritten signature]

TITLE: Vice-President

ATTEST: [Handwritten signature]

TITLE: TRUST OFFICER

UNOFFICIAL COPY

Property of Cook County Clerk's Office