

UNOFFICIAL COPY

93741609

PREPARED BY:

1998-05-28 10:40:51

Name: XCTC Limited Partnership (f/k/a FSC Limited Partnership)
Kenneth Bosworth c/o Horwood Marcus & Berk Chtd.

Address: 13101 S. Pulaski Road
Alsip, Illinois 60658

RETURN TO:

Name: XCTC Limited Partnership (f/k/a FSC Limited Partnership)
Kenneth Bosworth c/o Horwood Marcus & Berk Chtd.

Address: 333 W. Wacker Drive, Suite 2800
Chicago, Illinois 60606

THE ABOVE SPACE FOR RECORDER'S OFFICE

THIS ENVIRONMENTAL NO FURTHER REMEDIATION LETTER MUST BE SUBMITTED BY THE OWNER/OPERATOR, WITHIN 45 DAYS OF ITS RECEIPT, TO THE RECORDER OF DEEDS OF COOK COUNTY IN WHICH THE SITE (AS DESCRIBED BELOW) IS LOCATED.

Illinois EPA Number: 0310035006

LUST Incident No.: 940210

XCTC Limited Partnership (f/k/a FSC Limited Partnership), the owner and operator, whose address is c/o Horwood Marcus & Berk Chtd., 333 W. Wacker Drive, Suite 2800, Chicago, Illinois 60606, has performed investigative and/or remedial activities for the site that can be identified by the following and depicted on the attached Site Base Map:

1. Legal description or Reference to a Plat Showing the Boundaries:

Parcel 1: The West 1/2 of the Southwest 1/4 (excepting the South 167.0 feet thereof and also excepting the West 50 feet thereof) and excepting that part taken by the County of Cook in deed recorded as document 24457221 of Section 35, Township 37 North, Range 13 East of the Third Principal Meridian, in Cook County, Illinois. Parcel 2: Lot 2 (except the North 20 feet thereof and except that portion lying South of a line 50 feet North of and parallel with the South line of the Northwest 1/4 of Section 35, Township 37 North, Range 13 East of the Third Principal Meridian) and Lots 3 and 4 (except the North 44 feet thereof and except that portion lying South of a line 40 feet North of and parallel with the South line of the Northwest 1/4 of Section 35, Township 37 North, Range 13 East of the Third Principal Meridian and except the North 10 feet of the South 17 feet of the West 157.27 feet of said Lot 3) all in Blue Island Gardens, a subdivision of the South 1/2 of the following described land: The Northwest 1/4 (except the East 20 acres and except the West 1/11th of that part of said Northwest 1/4 lying West of the said 20 acres) of Section 35, Township 37 North, Range 13 East of the Third Principal Meridian, in Cook County, Illinois. Parcel 3A: Lot 1 (except the South 560.00 feet of the West 160.00 feet) and (except the North 20.00 feet

UNOFFICIAL COPY

98441609

thereof and except the South 17 feet lying East of the West 160 feet thereof as condemned in Case 78L 4097) in Blue Island Gardens, a subdivision of the South 1/2 of the following described land: The Northwest 1/4 (except the East 20 acres thereof and except the West 1/11th of that part of said Northwest 1/4 lying West of said East 20 acres) of Section 35, Township 37 North, Range 13 East of the Third Principal Meridian, in Cook County, Illinois also the South 1/2 of the West 1/11th of that part of the Northwest 1/4 lying West of the East 20 acres thereof, of Section 35 except the North 20.00 feet thereof and except the South 593.00 feet thereof and except the West 50.00 feet thereof all in Township 37 North, Range 13 East of the Third Principal Meridian, in Cook County, Illinois and containing 5.654 acres more or less. Parcel 3B: The South 593.00 feet of the West 1/11th of that part of the Northwest 1/4 lying West of the East 20 acres thereof, of Section 35, Township 37 North, Range 13 East of the Third Principal Meridian except the South 33.00 feet thereof, and except the West 50.00 feet thereof and except that portion of the land condemned in Case 78L 4097 all in Cook County, Illinois, and containing 2.07 acres more or less. Parcel 4: The South 560 feet of the West 160 feet (except the South 17 feet thereof) of Lot 1 in Blue Island Gardens Subdivision in the Northwest 1/4 of Section 35, Township 37 North, Range 13 East of the Third Principal Meridian, according to the plat thereof recorded February 21, 1921 as Document 7070833, in Cook County, Illinois.

2. Common Address: 13101 S. Pulaski Road, Alsip, Illinois
3. Real Estate Tax Index/Parcel Index Number: 24-35-101-048-1001 & 24-35-101-048-1002
4. Site Owner: Alsip Paper Condominium Association, Attn: Glen Johnson, 13101 S. Pulaski Road, Alsip, Illinois 60658
5. Land Use Limitation: There are no land use limitations.
6. See the attached No Further Remediation Letter for other terms.

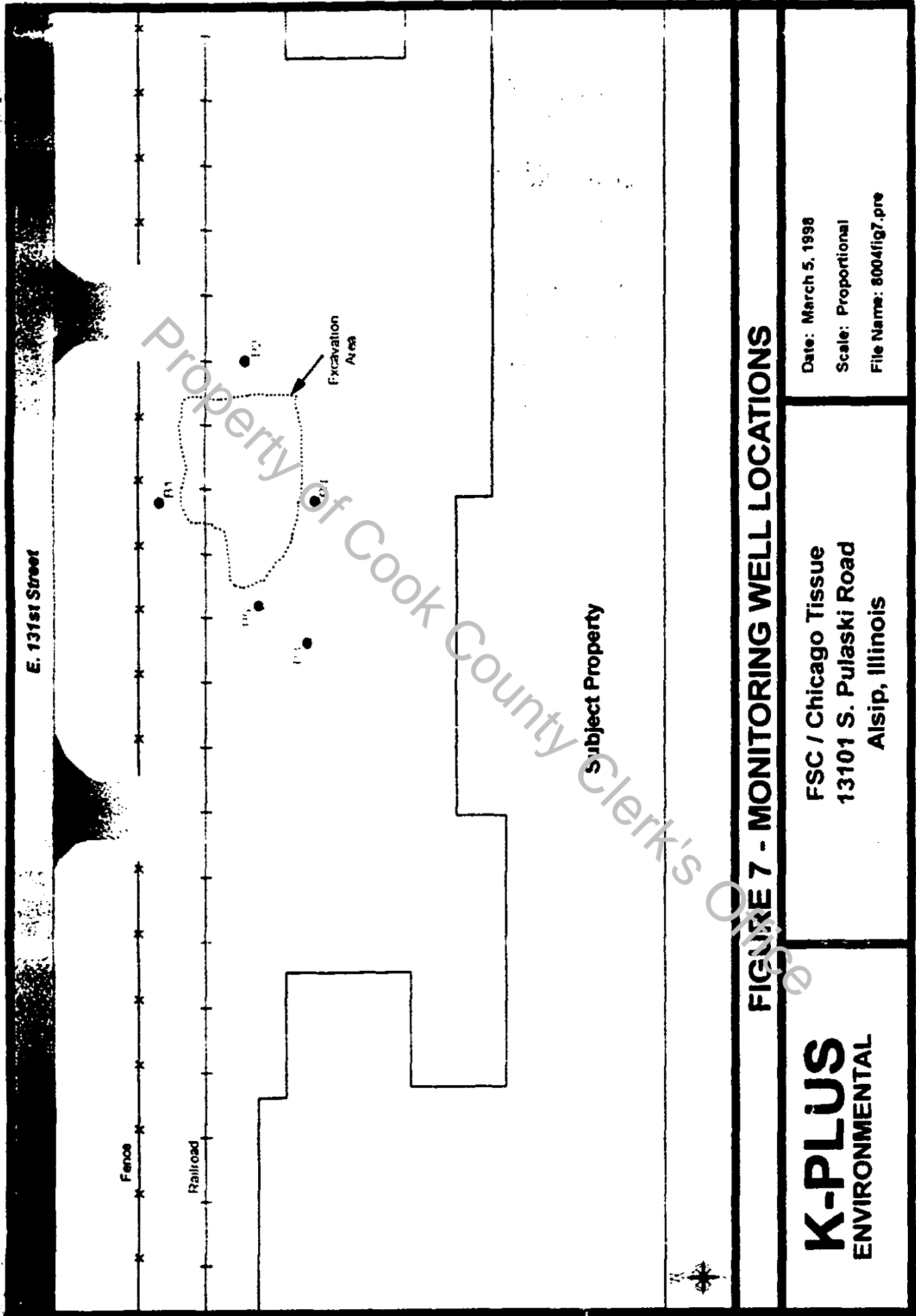

FIGURE 7 - MONITORING WELL LOCATIONS

FSC / Chicago Tissue
13101 S. Pulaski Road
Alsip, Illinois

Date: March 5, 1998
Scale: Proportional
File Name: 8004fig7.pre

K-PLUS
ENVIRONMENTAL