

**Robert A. Nowicki & Associates LTD.**  
PROFESSIONAL LAND SURVEYORS

DEPT-01 RECORDING \$23.00  
T#0009 TRAN 3153 07/10/98 11:39:00  
\$3160 RC #98-595265  
COOK COUNTY RECORDER

**CERTIFICATE OF CORRECTION  
FOR: ROYAL OAK ESTATES**

98595265

RECORDED MAY 24, 1998 DOCUMENT NO. 06396715

DEPT-10 PENALTY \$20.00

I, PAUL J. NOWICKI A PROFESSIONAL ILLINOIS LAND SURVEY DO HEREBY CERTIFY THAT:

ON THE RECORDED PLAT OF ROYAL OAK ESTATES, RECORDED AS STATED AFORESAID, BY MR. MICHAEL W. GERFERICK, ILLINOIS PROFESSIONAL LAND SURVEYOR NO. 2683. THE SURVEYORS CERTIFICATION DID NOT STATE WHETHER OR NOT THE LAND IS SITUATED WITHIN 500 FEET OF ANY SURFACE DRAIN OR WATERCOURSE SERVING A TRIBUTARY AREA OF 640 ACRES OR MORE.

THIS INSTRUMENT IS PREPARED TO CORRECT THE SURVEYORS CERTIFICATION. THE PROPERTY SHOWN ON THE AFORESAID PLAT IS LOCATED WITHIN 500 FEET OF A SURFACE DRAIN OR WATERCOURSE SERVING A TRIBUTARY AREA OF 640 ACRES OR MORE.

DATED June 9, 1998

Paul J. Nowicki  
PAUL J. NOWICKI, PROFESSIONAL ILLINOIS LAND SURVEYOR NO. 2544

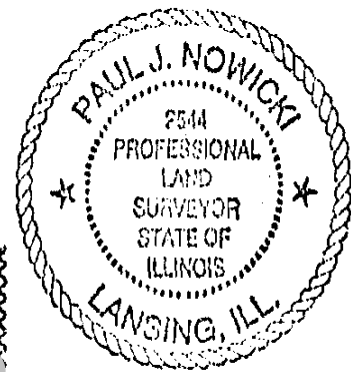

NOTARY PUBLIC Shirley Fazio

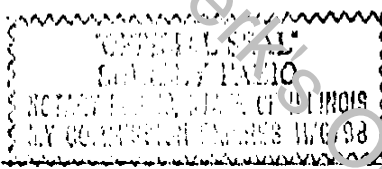

DATED: June 9, 1998

PREPARED BY: RAM/T  
ROBERT A. NOWICKI & ASSOCIATES, LTD.  
17844 CHAPPEL AVE.  
LANSING, ILLINOIS 60438

98595265

Member  
Illinois Registered  
Land Surveyors Assn.  
  
American Congress on  
Surveying and Mapping

**BOX 333-CTI**

Residential  
Commercial  
Industrial  
Farm  
Subdivisions  
Mortgage

0-1540117  
7740151-0

UNOFFICIAL COPY

Property of Cook County Clerk's Office

# UNOFFICIAL COPY



## CHICAGO TITLE INSURANCE COMPANY

ORDER NUMBER: 1401 007740451 D1

STREET ADDRESS:

CITY:

COUNTY: COOK

TAX NUMBER: 32-34-403-012-0000

### LEGAL DESCRIPTION:

LOTS 1 TO 31, BOTH INCLUSIVE, IN ROYAL OAK ESTATE, BEING A SUBDIVISION OF THE EAST 1/2 OF THE NORTHEAST 1/4 OF THE SOUTHEAST 1/4 OF SECTION 34, TOWNSHIP 35 NORTH, RANGE 14, EAST OF THE THIRD PRINCIPAL MERIDIAN, (EXCEPT THEREFROM THE SOUTH 14 FEET OF THE WEST 1/2 OF THE EAST 1/2 OF THE NORTHEAST 1/4 OF THE SOUTHEAST 1/4); ALSO THE WEST 1/2 OF THE NORTHWEST 1/4 OF THE SOUTHWEST 1/4 OF SECTION 35 TOWNSHIP 35 NORTH, RANGE 14, EAST OF THE THIRD PRINCIPAL MERIDIAN, ACCORDING TO THE PLAT THEREOF RECORDED MAY 24, 1996 AS DOCUMENT 96396715, IN COOK COUNTY, ILLINOIS.

*17-35-403-012-0000-0000  
31-35-403-012-0000-0000  
31-34-403-012-0000-0000  
32-34-403-012-0000-0000  
Royal Oak Estate, Royal Oak, Ill  
Section 34*

98595265

PROPERTY of Cook County Clerk's Office