

UNOFFICIAL COPY

1
1417089
NID
MCS

3857640

1990 JAN 31 PM 2 58
CAROL HOSELEY BRAUN
REGISTERAR OF TITLES

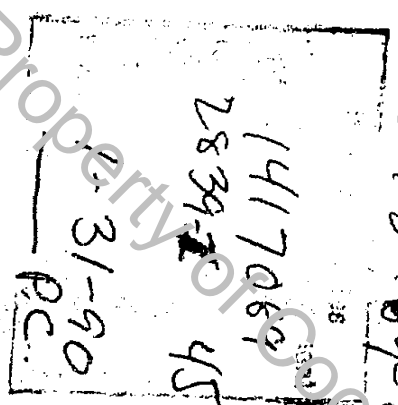

3857640

875769-89

HEALTHY TITLES INC.
8801 - 1st Street
Chicago, Illinois 60619

3857640

PIN: 09-27-203-043 S KA 833 N. Northwest Highway, Ft. Ridge

IN RICHARDSON'S SUBDIVISION OF PART OF THE EAST HALF (1/2) OF THE NORTHEAST QUARTER (1/4) OF SECTION 27, TOWNSHIP 41 NORTH, RANGE 12, EAST OF THE THIRD PRINCIPAL MERIDIAN, IN COOK COUNTY, ILLINOIS

3857640

BEGINNING AT THE NORTHWEST CORNER OF LOT ONE (1), IN SAID RICHARDSON SUBDIVISION AND RUNNING THENCE EAST ALONG THE NORTH LINE OF SAID LOT, 86.66 FEET TO A POINT MIDWAY BETWEEN THE NORTHWEST AND THE NORTHEAST CORNERS OF SAID LOT; THENCE SOUTH IN A STRAIGHT LINE PARALLEL WITH AND MIDWAY BETWEEN THE EAST LINE AND THE WEST LINE OF SAID LOT ONE (1) AND MIDWAY BETWEEN THE EAST LINE AND THE WEST LINE OF SAID LOT FOUR (4), 1074.44 FEET TO A POINT ON THE SOUTHERLY LINE OF SAID LOT FOUR (4) MIDWAY BETWEEN THE SOUTHEAST AND SOUTHWEST CORNERS OF SAID LOT FOUR (4); THENCE NORTHWESTERLY ALONG THE SOUTHERLY LINE OF SAID LOT FOUR (4), 112.98 FEET TO THE SOUTHWEST CORNER OF SAID LOT FOUR (4); THENCE NORTH ALONG THE WEST LINE OF SAID LOT FOUR (4) AND ALONG THE WEST LINE OF SAID LOT ONE (1) 930.00 FEET TO THE POINT OF BEGINNING (EXCEPT FROM SAID PART OF LOT FOUR (4) LYING EASTERLY FROM ABOVE DESCRIBED TRACT THAT PART THEREOF LYING EAST OF A STRAIGHT LINE DRAWN THROUGH A POINT IN THE SOUTHERLY LINE OF SAID LOT FOUR (4) DISTANT NORTHWESTERLY ALONG SAID LINE 56.49 FEET FROM THE SOUTHWESTERLY CORNER OF SAID LOT AND PARALLEL WITH THE EAST LINE OF SAID LOT FOUR (4); AND EXCEPT THAT PART OF SAID LOT FOUR (4) LYING NORTHERLY OF A STRAIGHT LINE DRAWN PARALLEL WITH THE NORTHERLY LINE OF SAID LOT FOUR (4) THROUGH A POINT IN THE EASTERLY LINE OF SAID LOT 271.025 FEET SOUTH OF THE NORTHEAST CORNER OF SAID LOT FOUR (4)

THAT PART OF LOT FOUR IN RICHARDSON SUBDIVISION (HEREINAFTER DESCRIBED), LYING EAST OF A TRACT DESCRIBED AS FOLLOWS: